

Location Map
Zone Atlas Map No. M-15-Z

Subdivision Data:

GROSS SUBDIVISION ACREAGE: 16.6575 ACRES±
 ZONE ATLAS INDEX NO: M-15-Z
 NO. OF TRACTS CREATED: 2
 NO. OF LOTS CREATED: 0
 MILES OF FULL-WIDTH STREETS CREATED: 0
 DATE OF SURVEY: OCTOBER 2008

Disclosure Statement:

THE PURPOSE OF THIS PLAT IS TO REPLAT THE EXISTING TWO TRACTS INTO TWO NEW TRACTS, TO DEDICATE RIGHT OF WAY FOR A PORTION OF THE FUTURE ALAMO AVENUE, SE EXTENSION

Notes:

- MISC. DATA: ZONING SU-1 FOR HOTELS AND RESTAURANTS AND IP
- BEARINGS SHOWN ARE GRID BEARINGS (NEW MEXICO STATE PLANE CENTRAL ZONE - NAD 1983).
- ALL DISTANCES ARE GROUND DISTANCES-US SURVEY FOOT.
- THIS PROPERTY LIES WITHIN SECTION 33, TOWNSHIP 10 NORTH, RANGE 3 EAST, NEW MEXICO PRINCIPAL MERIDIAN, CITY OF ALBUQUERQUE, BERNALILLO COUNTY, NEW MEXICO.
- PLAT SHOWS ALL EASEMENTS OF RECORD.
- SP NO. 2008432387

Easements

THIS PLAT SHOWS EXISTING RECORDED AND APPARENT EASEMENTS AS NOTED.

PUBLIC UTILITY EASEMENTS SHOWN ON THIS PLAT ARE GRANTED FOR THE COMMON AND JOINT USE OF:

- PNM (ELECTRIC) FOR INSTALLATION, MAINTENANCE, AND SERVICE OF OVERHEAD AND UNDERGROUND ELECTRICAL LINES, COMMUNICATION FACILITIES, TRANSFORMERS, POLES AND ANY OTHER EQUIPMENT, FIXTURES, STRUCTURES AND RELATED FACILITIES REASONABLY NECESSARY TO PROVIDE ELECTRICAL SERVICE.
- PNM (GAS) FOR INSTALLATION, MAINTENANCE, AND SERVICE OF NATURAL GAS LINES, VALVES AND OTHER EQUIPMENT AND FACILITIES REASONABLY NECESSARY TO PROVIDE NATURAL GAS.
- QWEST CORPORATION FOR THE INSTALLATION, MAINTENANCE AND SERVICE OF ALL BURIED AND AERIAL COMMUNICATION LINES AND OTHER RELATED EQUIPMENT AND FACILITIES REASONABLY NECESSARY TO PROVIDE COMMUNICATION SERVICES, INCLUDING BUT NOT LIMITED TO ABOVE GROUND PEDESTALS AND CLOSURES.
- COMCAST CABLE FOR THE INSTALLATION, MAINTENANCE, AND SERVICE OF SUCH LINES, CABLE, AND OTHER RELATED EQUIPMENT AND FACILITIES REASONABLY NECESSARY TO PROVIDE CABLE TV SERVICE.

INCLUDED IS THE RIGHT TO BUILD, REBUILD, CONSTRUCT, RECONSTRUCT, LOCATE, RELOCATE, CHANGE, REMOVE, MODIFY, RENEW, OPERATE, AND MAINTAIN FACILITIES FOR THE PURPOSES DESCRIBED ABOVE, TOGETHER WITH FREE ACCESS TO, FROM, AND OVER SAID EASEMENTS, INCLUDING SUFFICIENT WORKING AREA SPACE FOR ELECTRIC TRANSFORMERS, WITH THE RIGHT AND PRIVILEGE TO TRIM AND REMOVE TREES, SHRUBS OR BUSHES WHICH INTERFERE WITH THE PURPOSES SET FORTH HEREIN. NO BUILDING, SIGN, POOL (ABOVEGROUND OR SUBSURFACE), HOT TUB, CONCRETE OR WOOD POOL DECKING, OR OTHER STRUCTURE SHALL BE ERRECTED OR CONSTRUCTED ON SAID EASEMENTS, NOR SHALL ANY WELL BE DRILLED OR OPERATED THEREON. PROPERTY OWNERS SHALL BE SOLELY RESPONSIBLE FOR CORRECTING ANY VIOLATIONS OF NATIONAL ELECTRICAL SAFETY CODE CAUSED BY CONSTRUCTION OF POOLS, DECKING, OR ANY STRUCTURES ADJACENT TO WITHIN OR NEAR EASEMENTS SHOWN ON THIS PLAT.

RECORDING STAMP

Legal Description

A TRACT OF LAND LYING AND SITUATE WITHIN SECTION 33, TOWNSHIP 10 NORTH, RANGE 3 EAST, NEW MEXICO PRINCIPAL MERIDIAN, CITY OF ALBUQUERQUE, BERNALILLO COUNTY, NEW MEXICO, COMPRISING OF THE REMAINING PORTION OF TRACT LETTERED 'O', SCHWARTZMAN PACKING COMPANY, AS THE SAME IS SHOWN AND DESIGNATED ON THE COMPILED PLAT THEREOF, FILED IN THE OFFICE OF THE COUNTY CLERK OF BERNALILLO COUNTY, NEW MEXICO ON APRIL 17, 1961, IN BOOK D2, PAGE 133, AND AS FURTHER DESCRIBED IN THE WARRANTY DEED RECORDED DECEMBER 09, 1992, IN BOOK 92-29, PAGE 3819, AS DOCUMENT NUMBER 92123576, TOGETHER WITH A TRACT OF LAND DESIGNATED AS PARCEL THREE IN THE REAL ESTATE CONTRACT RECORDED ON DECEMBER 19, 1994 IN BOOK 94-34, PAGE 1599, AS DOCUMENT NUMBER 94146527, BOUNDED ON THE WEST BY INTERSTATE 25 AND THE ALBUQUERQUE METROPOLITAN ARROYO FLOOD CONTROL AUTHORITY SOUTH DIVERSION CHANNEL, ON THE NORTH BY THE CITY OF ALBUQUERQUE SOUTH SIDE STORM RELIEF SEWER EASEMENT, ON THE EAST BY MULBERRY STREET, SE AND FLIGHTWAY AVENUE, SE, AND ON THE SOUTH BY TRACT A-1, LANDS OF EISENMAN, SAID TRACT BEING MORE PARTICULARLY DESCRIBED BY NEW MEXICO STATE PLANE COORDINATE SYSTEM GRID BEARINGS (CENTRAL ZONE-NORTH AMERICAN DATUM OF 1983) AND GROUND DISTANCES (US SURVEY FOOT) AS FOLLOWS BEGINNING THE SOUTHWEST CORNER OF DESCRIBED TRACT LYING ON THE EAST RIGHT OF WAY LINE OF INTERSTATE 25, MARKED BY A FOUND NO. 4 REBAR FROM WHENCE A TIE TO ALBUQUERQUE GEOGRAPHIC REFERENCE SYSTEM MONUMENT "5_M14" BEARS S 71°10'36" W, A DISTANCE OF 2,864.20 FEET;

THENCE FROM SAID POINT OF BEGINNING, ALONG SAID EAST RIGHT OF WAY LINE, N 01°00'13" E, A DISTANCE OF 796.36 FEET TO AN ANGLE POINT LYING ON THE INTERSECTION OF SAID EAST RIGHT OF WAY LINE AND THE SOUTHEASTERLY RIGHT OF WAY LINE OF THE A.M.A.F.C.A. SOUTH DIVERSION CHANNEL MARKED BY A FOUND NO. 4 REBAR;

THENCE LEAVING SAID EAST RIGHT OF WAY LINE ALONG SAID SOUTHEASTERLY RIGHT OF WAY LINE FOR THE NEXT NINE CALLS, N 47°26'21" E, A DISTANCE OF 34.98 FEET TO A POINT OF CURVATURE MARKED BY A FOUND A.M.A.F.C.A. BRASS CAP "S1-10-49";

THENCE ALONG A CURVE TO THE LEFT HAVING AN ARC LENGTH OF 209.50 FEET, A RADIUS OF 1054.93 FEET, A DELTA ANGLE OF 11°22'43", A CHORD BEARING OF N 40°11'40" E, AND A CHORD LENGTH OF 209.16 FEET TO A POINT OF NON-TANGENCY MARKED BY A FOUND A.M.A.F.C.A. BRASS CAP "S1-10-48";

THENCE S 55°31'37" E, A DISTANCE OF 45.08 FEET TO AN ANGLE POINT MARKED BY A FOUND A.M.A.F.C.A. BRASS CAP "S1-10-47";

THENCE ALONG A NON-TANGENT CURVE TO THE LEFT HAVING AN ARC LENGTH OF 98.99 FEET, A RADIUS OF 1,099.93 FEET, A DELTA ANGLE OF 05°09'24", A CHORD BEARING OF N 31°58'06" E, AND A CHORD LENGTH OF 98.96 FEET TO A POINT OF NON-TANGENCY MARKED BY A FOUND A.M.A.F.C.A. BRASS CAP "S1-10-46";

THENCE S 89°02'33" E, A DISTANCE OF 170.54 FEET TO AN ANGLE POINT MARKED BY A FOUND A.M.A.F.C.A. BRASS CAP "S1-10-45";

THENCE N 00°39'11" E, A DISTANCE OF 139.95 FEET TO AN ANGLE POINT FROM WHENCE A FOUND NO. 4 REBAR ASSUMED TO BE THE A.M.A.F.C.A. REFERENCE MARK BEING N 62°50'00" W A DISTANCE OF 0.47 FEET FROM ACTUAL CORNER;

THENCE N 88°59'53" W, A DISTANCE OF 154.45 FEET TO A POINT OF CURVATURE FROM WHENCE A FOUND A.M.A.F.C.A. BRASS CAP REFERENCE MARK BEING N 56°17'28" W, A DISTANCE OF 0.42 FEET FROM ACTUAL CORNER;

THENCE ALONG A NON-TANGENT CURVE TO THE LEFT HAVING AN ARC LENGTH OF 261.57 FEET, A RADIUS OF 1054.93 FEET, A DELTA ANGLE OF 14°12'23", A CHORD BEARING OF N 15°03'17" E, AND A CHORD LENGTH OF 260.90 FEET TO A POINT OF TANGENCY MARKED BY A FOUND A.M.A.F.C.A. BRASS CAP;

THENCE N 08°04'58" E, A DISTANCE OF 152.53 FEET TO THE NORTHWEST CORNER OF DESCRIBED TRACT MARKED BY A FOUND A.M.A.F.C.A. BRASS CAP;

THENCE LEAVING SAID SOUTHEASTERLY RIGHT OF WAY LINE N 77°23'42" E, A DISTANCE OF 238.21 FEET TO THE NORTHEAST CORNER OF DESCRIBED TACT LYING ON THE WEST RIGHT OF WAY LINE OF MULBERRY STREET, S.E. MARKED BY A SET NO. 4 REBAR WITH YELLOW PLASTIC CAP "PS 11993";

THENCE CONTINUING ALONG SAID WEST RIGHT OF WAY LINE FOR THE NEXT TWO CALLS S 00°05'10" W, A DISTANCE OF 530.49 FEET TO AN ANGLE POINT MARKED BY A SET NO. 4 REBAR WITH YELLOW PLASTIC CAP PS 11993";

THENCE S 00°18'07" W, A DISTANCE OF 283.91 FEET TO AN ANGLE POINT MARKED BY A SET NO. 4 REBAR WITH YELLOW PLASTIC CAP "PS 11993";

THENCE S 00°10'19" W, A DISTANCE OF 832.98 FEET TO THE SOUTHEAST CORNER OF DESCRIBED TRACT MARKED BY A SET NO. 4 REBAR WITH YELLOW PLASTIC CAP "PS 11993";

THENCE N 88°36'33" W A DISTANCE OF 599.01 FEET TO THE POINT OF BEGINNING, CONTAINING 16.6575 ACRES (725,600 SQUARE FEET) MORE OR LESS, NOW COMPRISING TRACTS A AND B, MULBERRY PROPERTIES.

Solar Note:

NO PROPERTY WITHIN THE AREA OF REQUESTED FINAL ACTION SHALL AT ANY TIME BE SUBJECT TO A DEED RESTRICTION, COVENANT, OR BINDING AGREEMENT PROHIBITING SOLAR COLLECTORS FROM BEING INSTALLED ON BUILDINGS OR ERRECTED ON THE LOTS OF PARCELS WITHIN THE AREA OF THIS PLAT.

Plat of
Tracts A and B
Mulberry Properties
Albuquerque, Bernalillo County, New Mexico
October 2008

Project No. _____

Application No. 08DRB-

Utility Approvals

PNM (ELECTRIC) _____ DATE _____

PNM (GAS) _____ DATE _____

QWEST TELECOMMUNICATIONS _____ DATE _____

COMCAST _____ DATE _____

City Approvals

[Signature] _____ 10-28-08
CITY SURVEYOR _____ DATE _____

TRAFFIC ENGINEERING, TRANSPORTATION DEPARTMENT _____ DATE _____

A.B.C.W.U.A. _____ DATE _____

PARKS AND RECREATION DEPARTMENT _____ DATE _____

AMAFCA _____ DATE _____

CITY ENGINEER _____ DATE _____

DRB CHAIRPERSON, PLANNING DEPARTMENT _____ DATE _____

TREASURER'S CERTIFICATE

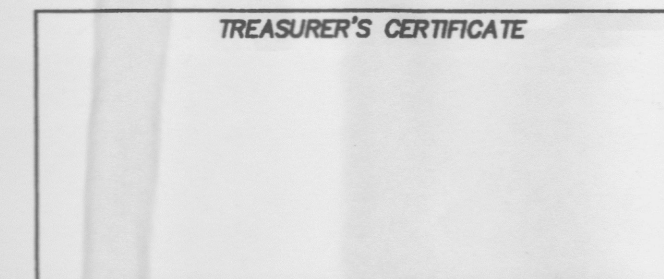

Surveyor's Certificate

I, LARRY W. MEDRANO, A REGISTERED NEW MEXICO PROFESSIONAL LAND SURVEYOR UNDER THE LAWS OF THE STATE OF NEW MEXICO, HEREBY CERTIFY THAT THIS PLAT WAS PREPARED FROM FIELD NOTES OF AN ACTUAL SURVEY MEETING THE MINIMUM REQUIREMENTS FOR MONUMENTATION AND SURVEYS OF THE CITY OF ALBUQUERQUE SUBDIVISION ORDINANCE AND OF THE MINIMUM STANDARDS FOR LAND SURVEYS AS ADOPTED BY THE N.M. BOARD OF LICENSURE FOR ENGINEERS AND SURVEYORS AND IS TRUE AND CORRECT TO THE BEST OF MY KNOWLEDGE AND BELIEF, AND THAT NO ENCROACHMENTS EXIST EXCEPT AS NOTED ABOVE AND THAT ALL IMPROVEMENTS ARE SHOWN IN THEIR CORRECT LOCATION RELATIVE TO RECORD BOUNDARIES AS LOCATED BY THIS SURVEY.

[Signature] _____ 10/28/07
LARRY W. MEDRANO _____ DATE _____
N.M.P.S. No. 11993



PRECISION SURVEYS, INC.

8500-A Jefferson Street, NE
Albuquerque, NM 87113

866.442.8011 TOLL FREE
505.856.5700 PHONE
505.856.7900 FAX

Plat of
Tracts A and B
Mulberry Properties
Albuquerque, Bernalillo County, New Mexico
October 2008

Free Consent and Dedication

THE REPLAT SHOWN HEREON IS WITH THE FREE CONSENT AND IN ACCORDANCE WITH THE DESIRES OF THE UNDERSIGNED OWNER AND/OR PROPRIETOR. EXISTING PUBLIC UTILITY EASEMENTS SHOWN HEREON FOR THE COMMON AND JOINT USE OF GAS, ELECTRICAL POWER AND COMMUNICATION SERVICES FOR BURIED AND/OR OVERHEAD DISTRIBUTION LINES, CONDUITS, AND PIPES FOR UNDERGROUND UTILITIES WHERE SHOWN OR INDICATED, AND INCLUDING THE RIGHT OF INGRESS AND EGRESS FOR CONSTRUCTION AND MAINTENANCE, AND THE RIGHT TO TRIM INTERFERING TREES AND SHRUBS. SAID OWNER AND/OR PROPRIETOR DOES HEREBY CERTIFY THAT THIS SUBDIVISION IS THEIR FREE ACT AND DEED. SAID OWNERS WARRANT THAT THEY HOLD AMONG THEM COMPLETE AND INDEFEASIBLE TITLE IN FEE SIMPLE TO THE LAND SUBDIVIDED.

SAID OWNER AND/OR PROPRIETOR DOES HEREBY GRANT ALL EASEMENTS AS SHOWN HEREON WITH LISTED BENEFICIARIES AND STIPULATIONS.

SAID OWNER AND/OR PROPRIETOR DOES HEREBY DEDICATE ALL STREETS AND PUBLIC RIGHTS OF WAY SHOWN HEREON TO THE CITY OF ALBUQUERQUE IN FEE SIMPLE WITH WARRANTY COVENANTS.

Sherif A. Rabadi 10/27/08

SHERIF A. RABADI
CO-OWNER TRACT "A"

Acknowledgment

STATE OF NEW MEXICO) SS
COUNTY OF BERNALILLO)

THIS INSTRUMENT WAS ACKNOWLEDGED BEFORE ME THIS 27 DAY OF October, 2008 BY SHERIF A. RABADI, CO-OWNER TRACT "A"

BY Chelsea Watkins MY COMMISSION EXPIRES: 02/25/2012
NOTARY PUBLIC

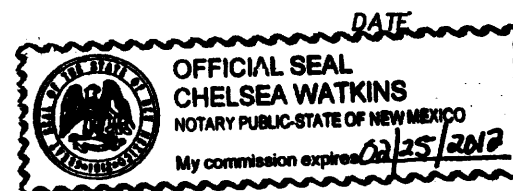

Samla S. Rabadi 10/27/08

SAMLA S. RABADI
CO-OWNER TRACT "A"

Acknowledgment

STATE OF NEW MEXICO) SS
COUNTY OF BERNALILLO)

THIS INSTRUMENT WAS ACKNOWLEDGED BEFORE ME THIS 27th DAY OF October, 2008 BY SAMLA S. RABADI, CO-OWNER TRACT "A"

BY Charles H. Reid MY COMMISSION EXPIRES: 09/30/10
NOTARY PUBLIC

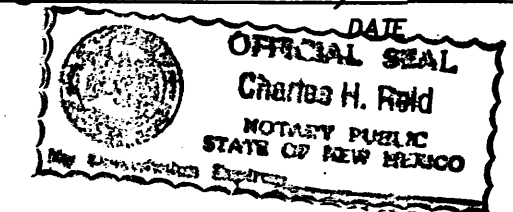

Manuel Lujan Jr. 10-27-08
MANUEL LUJAN JR. DATE
CO-OWNER TRACT "A"

Acknowledgment

STATE OF NEW MEXICO) SS
COUNTY OF BERNALILLO)

THIS INSTRUMENT WAS ACKNOWLEDGED BEFORE ME THIS 27th DAY OF October, 2008 BY MANUEL LUJAN JR., CO-OWNER TRACT "A"

BY Carol J. Edison MY COMMISSION EXPIRES: 5/9/2010
NOTARY PUBLIC

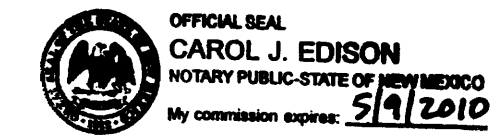

Jean Lujan 10-27-08
JEAN LUJAN DATE
CO-OWNER TRACT "A"

Acknowledgment

STATE OF NEW MEXICO) SS
COUNTY OF BERNALILLO)

THIS INSTRUMENT WAS ACKNOWLEDGED BEFORE ME THIS 27th DAY OF October, 2008 BY JEAN LUJAN, CO-OWNER TRACT "A"

BY Carol J. Edison MY COMMISSION EXPIRES: 5/9/2010
NOTARY PUBLIC



John Lorentzen 10-23-08
JOHN LORENTZEN DATE
GENERAL PARTNER OF ALBUQUERQUE AIRPARK PARTNERS
A NEW MEXICO PARTNERSHIP
OWNER TRACT "B"

Acknowledgment

STATE OF NEW MEXICO) SS
COUNTY OF BERNALILLO)

THIS INSTRUMENT WAS ACKNOWLEDGED BEFORE ME THIS 23 DAY OF OCTOBER, 2008 BY JOHN LORENTZEN, GENERAL PARTNER OF ALBUQUERQUE AIRPARK PARTNERS, A NEW MEXICO PARTNERSHIP OWNER TRACT "B"

BY Mary J. Long MY COMMISSION EXPIRES: 3-15-10
NOTARY PUBLIC

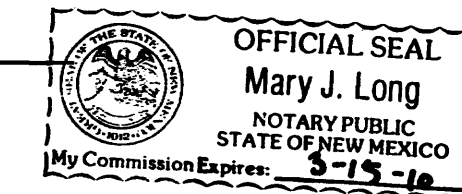

PRECISION SURVEYS, INC.

8500-A Jefferson Street, NE
Albuquerque, NM 87113

866.442.8011 TOLL FREE
505.856.5700 PHONE
505.856.7900 FAX

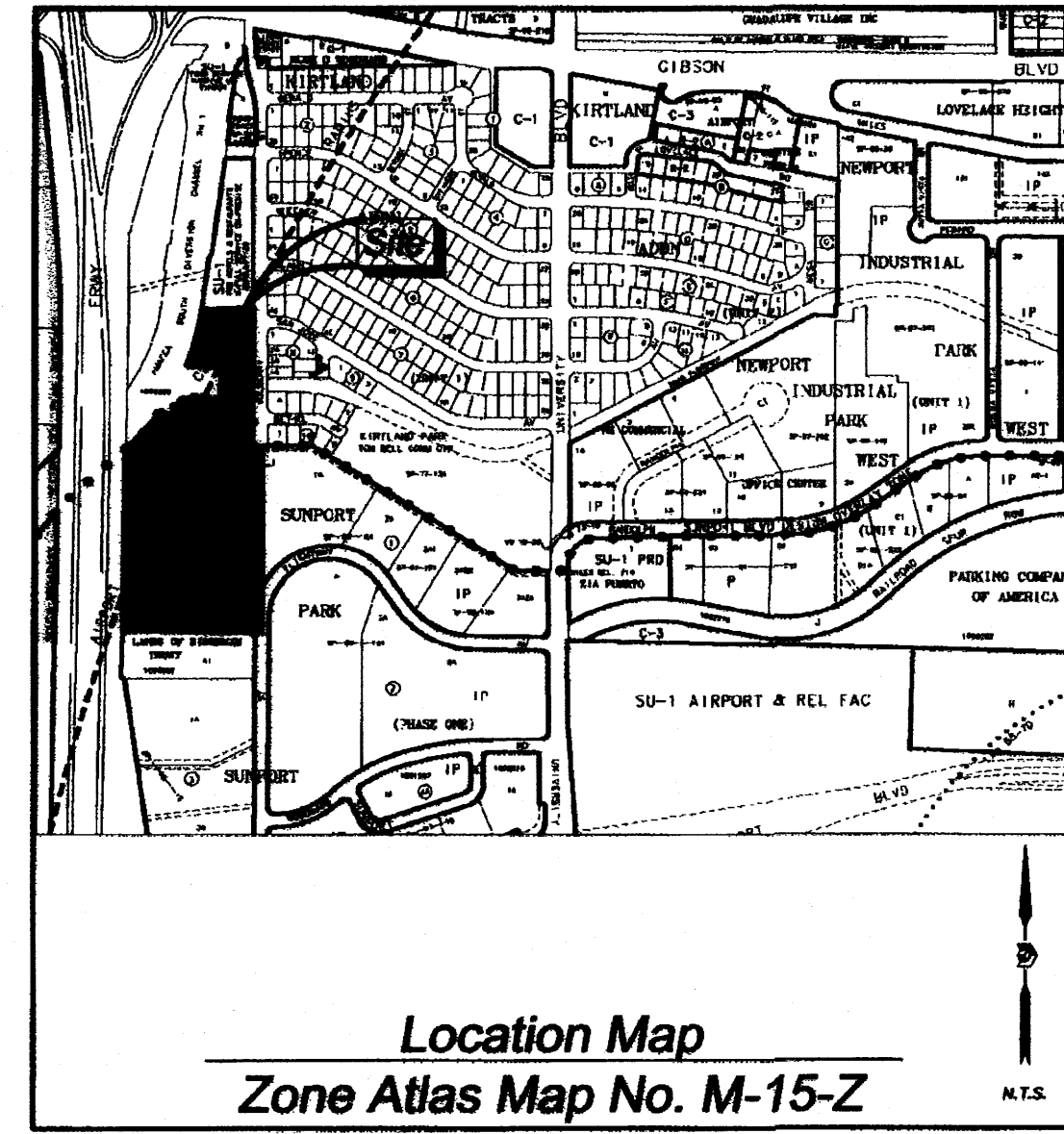

Location Map
Zone Atlas Map No. M-15-Z

Subdivision Data:

GROSS SUBDIVISION ACREAGE: 16.6575 ACRES±
ZONE ATLAS INDEX NO.: M-15-Z
NO. OF TRACTS CREATED: 2
NO. OF LOTS CREATED: 0
MILES OF FULL-WIDTH STREETS CREATED: 0
DATE OF SURVEY: OCTOBER 2008

Disclosure Statement:

THE PURPOSE OF THIS PLAT IS TO REPLAT THE EXISTING TWO TRACTS INTO TWO NEW TRACTS, TO DEDICATE RIGHT OF WAY FOR A PORTION OF THE FUTURE ALAMO AVENUE, SE EXTENSION

Notes:

- MISC. DATA: ZONING SU-1 FOR HOTELS AND RESTAURANTS AND IP
- BEARINGS SHOWN ARE GRID BEARINGS (NEW MEXICO STATE PLANE CENTRAL ZONE - NAD 1983).
- ALL DISTANCES ARE GROUND DISTANCES-US SURVEY FOOT.
- THIS PROPERTY LIES WITHIN SECTION 33, TOWNSHIP 10 NORTH, RANGE 3 EAST, NEW MEXICO PRINCIPAL MERIDIAN, CITY OF ALBUQUERQUE, BERNALILLO COUNTY, NEW MEXICO.
- PLAT SHOWS ALL EASEMENTS OF RECORD.
- SP NO. 2008432387

Easements

THIS PLAT SHOWS EXISTING RECORDED AND APPARENT EASEMENTS AS NOTED.

PUBLIC UTILITY EASEMENTS SHOWN ON THIS PLAT ARE GRANTED FOR THE COMMON AND JOINT USE OF:

- PNM (ELECTRIC) FOR INSTALLATION, MAINTENANCE, AND SERVICE OF OVERHEAD AND UNDERGROUND ELECTRICAL LINES, COMMUNICATION FACILITIES, TRANSFORMERS, POLES AND ANY OTHER EQUIPMENT, FIXTURES, STRUCTURES AND RELATED FACILITIES REASONABLY NECESSARY TO PROVIDE ELECTRICAL SERVICE.
- PNM (GAS) FOR INSTALLATION, MAINTENANCE, AND SERVICE OF NATURAL GAS LINES, VALVES AND OTHER EQUIPMENT AND FACILITIES REASONABLY NECESSARY TO PROVIDE NATURAL GAS.
- QWEST CORPORATION FOR THE INSTALLATION, MAINTENANCE AND SERVICE OF ALL BURIED AND AERIAL COMMUNICATION LINES AND OTHER RELATED EQUIPMENT AND FACILITIES REASONABLY NECESSARY TO PROVIDE COMMUNICATION SERVICES, INCLUDING BUT NOT LIMITED TO ABOVE GROUND PEDESTALS AND CLOSURES.
- COMCAST CABLE FOR THE INSTALLATION, MAINTENANCE, AND SERVICE OF SUCH LINES, CABLE, AND OTHER RELATED EQUIPMENT AND FACILITIES REASONABLY NECESSARY TO PROVIDE CABLE TV SERVICE.

INCLUDED IS THE RIGHT TO BUILD, REBUILD, CONSTRUCT, RECONSTRUCT, LOCATE, RELOCATE, CHANGE, REMOVE, MODIFY, RENEW, OPERATE, AND MAINTAIN FACILITIES FOR THE PURPOSES DESCRIBED ABOVE, TOGETHER WITH FREE ACCESS TO, FROM, AND OVER SAID EASEMENTS, INCLUDING SUFFICIENT WORKING AREA SPACE FOR ELECTRIC TRANSFORMERS, WITH THE RIGHT AND PRIVILEGE TO TRIM AND REMOVE TREES, SHRUBS OR BUSHES WHICH INTERFERE WITH THE PURPOSES SET FORTH HEREIN. NO BUILDING, SIGN, POOL (ABOVEGROUND OR SUBSURFACE), HOT TUB, CONCRETE OR WOOD POOL DECKING, OR OTHER STRUCTURE SHALL BE ERRECTED OR CONSTRUCTED ON SAID EASEMENTS, NOR SHALL ANY WELL BE DRILLED OR OPERATED THEREON. PROPERTY OWNERS SHALL BE SOLELY RESPONSIBLE FOR CORRECTING ANY VIOLATIONS OF NATIONAL ELECTRICAL SAFETY CODE CAUSED BY CONSTRUCTION OF POOLS, DECKING, OR ANY STRUCTURES ADJACENT TO WITHIN OR NEAR EASEMENTS SHOWN ON THIS PLAT.

EASEMENTS FOR ELECTRIC TRANSFORMERS/SWITCHGEARS, AS INSTALLED, SHALL EXTEND TEN FEET (10') IN FRONT OF TRANSFORMER/SWITCHGEAR DOOR AND FIVE FEET (5') ON EACH SIDE.

IN APPROVING THIS PLAT, PNM (ELECTRIC AND GAS) DID NOT CONDUCT A TITLE SEARCH OF THE PROPERTIES HEREON. CONSEQUENTLY, PNM DOES NOT WAIVE NOR RELEASE ANY EASEMENT OR EASEMENT RIGHTS TO WHICH IT MAY BE ENTITLED.

DOC# 2009009057
01/29/2009 09:37 AM Page: 1 of 3
tyPLAT: R-17, 08 2008C
Toulous Olivere, Bernalillo Cour.

Plat of
Tracts A and B
Mulberry Properties
Albuquerque, Bernalillo County, New Mexico
October 2008

Project No. 1007545

Application No. 08DRB-70452

Utility Approvals

<i>Fernando Vigil</i> PNM (ELECTRIC)	12-17-08	DATE
<i>Fernando Vigil</i> PNM (GAS)	12-17-08	DATE
<i>Paula B. B. B.</i> QWEST TELECOMMUNICATIONS	12/19/08	DATE
<i>Donna K. K.</i> COMCAST	12-23-08	DATE

City Approvals

<i>[Signature]</i> CITY SURVEYOR	11-11-08	DATE
<i>[Signature]</i> TRAFFIC ENGINEERING, TRANSPORTATION DEPARTMENT	11-12-08	DATE
<i>[Signature]</i> A.B.C.W.U.	11-12-08	DATE
<i>Christina Santoval</i> PARKS AND RECREATION DEPARTMENT	11/12/08	DATE
<i>[Signature]</i> AMAFCA	12-24-08	DATE
<i>Buddy J. Bigham</i> CITY ENGINEER	12/30/08	DATE
<i>[Signature]</i> DOB CHAIRPERSON, PLANNING DEPARTMENT	12/31/08	DATE

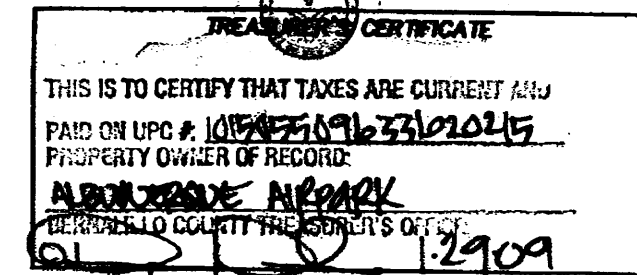

Surveyor's Certificate

I, LARRY W. MEDRANO, A REGISTERED NEW MEXICO PROFESSIONAL LAND SURVEYOR UNDER THE LAWS OF THE STATE OF NEW MEXICO, HEREBY CERTIFY THAT THIS PLAT WAS PREPARED FROM FIELD NOTES OF AN ACTUAL SURVEY MEETING THE MINIMUM REQUIREMENTS FOR MONUMENTATION AND SURVEYS OF THE CITY OF ALBUQUERQUE SUBDIVISION ORDINANCE AND OF THE MINIMUM STANDARDS FOR LAND SURVEYS AS ADOPTED BY THE N.M. BOARD OF LICENSURE FOR ENGINEERS AND SURVEYORS AND IS TRUE AND CORRECT TO THE BEST OF MY KNOWLEDGE AND BELIEF, AND THAT NO ENCROACHMENTS EXIST EXCEPT AS NOTED ABOVE AND THAT ALL IMPROVEMENTS ARE SHOWN IN THEIR CORRECT LOCATION RELATIVE TO RECORD BOUNDARIES AS LOCATED BY THIS SURVEY.

[Signature] 11/11/08
LARRY W. MEDRANO
N.M.P.S. No. 11993
DATE



PRECISION SURVEYS, INC.

8500-A Jefferson Street, NE
Albuquerque, NM 87113

866.442.8011 TOLL FREE
505.856.5700 PHONE
505.856.7900 FAX

Legal Description

A TRACT OF LAND LYING AND SITUATE WITHIN SECTION 33, TOWNSHIP 10 NORTH, RANGE 3 EAST, NEW MEXICO PRINCIPAL MERIDIAN, CITY OF ALBUQUERQUE, BERNALILLO COUNTY, NEW MEXICO, COMPRISING OF THE REMAINING PORTION OF TRACT LETTERED 'O', SCHWARTZMAN PACKING COMPANY, AS THE SAME IS SHOWN AND DESIGNATED ON THE COMPILED PLAT THEREOF, FILED IN THE OFFICE OF THE COUNTY CLERK OF BERNALILLO COUNTY, NEW MEXICO ON APRIL 17, 1961, IN BOOK D2, PAGE 133, AND AS FURTHER DESCRIBED IN THE WARRANTY DEED RECORDED DECEMBER 09, 1992, IN BOOK 92-29, PAGE 3819, AS DOCUMENT NUMBER 92123576, TOGETHER WITH A TRACT OF LAND DESIGNATED AS PARCEL THREE IN THE REAL ESTATE CONTRACT RECORDED ON DECEMBER 19, 1994 IN BOOK 94-34, PAGE 1599, AS DOCUMENT NUMBER 94146527, BOUNDED ON THE WEST BY INTERSTATE 25 AND THE ALBUQUERQUE METROPOLITAN ARROYO FLOOD CONTROL AUTHORITY SOUTH DIVERSION CHANNEL, ON THE NORTH BY THE CITY OF ALBUQUERQUE SOUTH SIDE STORM RELIEF SEWER EASEMENT, ON THE EAST BY MULBERRY STREET, SE AND FLIGHTWAY AVENUE, SE, AND ON THE SOUTH BY TRACT A-1, LANDS OF EISENMAN, SAID TRACT BEING MORE PARTICULARLY DESCRIBED BY NEW MEXICO STATE PLANE COORDINATE SYSTEM GRID BEARINGS (CENTRAL ZONE-NORTH AMERICAN DATUM OF 1983) AND GROUND DISTANCES (US SURVEY FOOT) AS FOLLOWS: BEGINNING THE SOUTHWEST CORNER OF DESCRIBED TRACT LYING ON THE EAST RIGHT OF WAY LINE OF INTERSTATE 25, MARKED BY A FOUND NO. 4 REBAR FROM WHENCE A TIE TO ALBUQUERQUE GEOGRAPHIC REFERENCE SYSTEM MONUMENT "S_1M14" BEARS S 71°10'36" W, A DISTANCE OF 2,864.20 FEET;

THENCE FROM SAID POINT OF BEGINNING, ALONG SAID EAST RIGHT OF WAY LINE, N 01°00'13" E, A DISTANCE OF 796.38 FEET TO AN ANGLE POINT LYING ON THE INTERSECTION OF SAID EAST RIGHT OF WAY LINE AND THE SOUTHEASTERLY RIGHT OF WAY LINE OF THE A.M.A.F.C.A. SOUTH DIVERSION CHANNEL MARKED BY A FOUND NO. 4 REBAR;

THENCE LEAVING SAID EAST RIGHT OF WAY LINE ALONG SAID SOUTHEASTERLY RIGHT OF WAY LINE FOR THE NEXT NINE CALLS, N 47°26'21" E, A DISTANCE OF 34.98 FEET TO A POINT OF CURVATURE MARKED BY A FOUND A.M.A.F.C.A. BRASS CAP "S1-10-49";

THENCE ALONG A CURVE TO THE LEFT HAVING AN ARC LENGTH OF 209.50 FEET, A RADIUS OF 1054.93 FEET, A DELTA ANGLE OF 11°22'43", A CHORD BEARING OF N 40°11'40" E, AND A CHORD LENGTH OF 209.16 FEET TO A POINT OF NON-TANGENCY MARKED BY A FOUND A.M.A.F.C.A. BRASS CAP "S1-10-48";

THENCE S 55°31'37" E, A DISTANCE OF 45.08 FEET TO AN ANGLE POINT MARKED BY A FOUND A.M.A.F.C.A. BRASS CAP "S1-10-47";

THENCE ALONG A NON-TANGENT CURVE TO THE LEFT HAVING AN ARC LENGTH OF 98.99 FEET, A RADIUS OF 1,099.93 FEET, A DELTA ANGLE OF 05°09'24", A CHORD BEARING OF N 31°58'06" E, AND A CHORD LENGTH OF 98.96 FEET TO A POINT OF NON-TANGENCY MARKED BY A FOUND A.M.A.F.C.A. BRASS CAP "S1-10-46";

THENCE S 89°02'33" E, A DISTANCE OF 170.54 FEET TO AN ANGLE POINT MARKED BY A FOUND A.M.A.F.C.A. BRASS CAP "S1-10-45";

THENCE N 00°30'11" E, A DISTANCE OF 139.95 FEET TO AN ANGLE POINT FROM WHENCE A FOUND NO. 4 REBAR ASSUMED TO BE THE A.M.A.F.C.A. REFERENCE MARK BEING N 62°50'00" W A DISTANCE OF 0.47 FEET FROM ACTUAL CORNER;

THENCE N 88°59'53" W, A DISTANCE OF 154.45 FEET TO A POINT OF CURVATURE FROM WHENCE A FOUND A.M.A.F.C.A. BRASS CAP REFERENCE MARK BEING N 56°17'28" W, A DISTANCE OF 0.42 FEET FROM ACTUAL CORNER;

THENCE ALONG A NON-TANGENT CURVE TO THE LEFT HAVING AN ARC LENGTH OF 261.57 FEET, A RADIUS OF 1054.93 FEET, A DELTA ANGLE OF 14°12'23", A CHORD BEARING OF N 15°03'17" E, AND A CHORD LENGTH OF 260.90 FEET TO A POINT OF TANGENCY MARKED BY A FOUND A.M.A.F.C.A. BRASS CAP;

THENCE N 08°04'58" E, A DISTANCE OF 152.53 FEET TO THE NORTHWEST CORNER OF DESCRIBED TRACT MARKED BY A FOUND A.M.A.F.C.A. BRASS CAP;

THENCE LEAVING SAID SOUTHEASTERLY RIGHT OF WAY LINE N 77°23'42" E, A DISTANCE OF 238.21 FEET TO THE NORTHEAST CORNER OF DESCRIBED TACT LYING ON THE WEST RIGHT OF WAY LINE OF MULBERRY STREET, S.E. MARKED BY A SET NO. 4 REBAR WITH YELLOW PLASTIC CAP "PS 11993";

THENCE CONTINUING ALONG SAID WEST RIGHT OF WAY LINE FOR THE NEXT TWO CALLS S 00°05'10" W, A DISTANCE OF 530.49 FEET TO AN ANGLE POINT MARKED BY A SET NO. 4 REBAR WITH YELLOW PLASTIC CAP PS 11993";

THENCE S 00°18'07" W, A DISTANCE OF 283.91 FEET TO AN ANGLE POINT MARKED BY A SET NO. 4 REBAR WITH YELLOW PLASTIC CAP "PS 11993";

THENCE S 00°10'19" W, A DISTANCE OF 832.98 FEET TO THE SOUTHEAST CORNER OF DESCRIBED TRACT MARKED BY A SET NO. 4 REBAR WITH YELLOW PLASTIC CAP "PS 11993";

THENCE N 88°36'33" W A DISTANCE OF 599.01 FEET TO THE POINT OF BEGINNING, CONTAINING 16.6575 ACRES (725,600 SQUARE FEET) MORE OR LESS, NOW COMPRISING TRACTS A AND B, MULBERRY PROPERTIES.

Environmental Health Department

THE SUBJECT PROPERTY IS LOCATED ON A FORMER LANDFILL (SCHWARTZMAN). DUE TO THE SUBJECT PROPERTY BEING ON A FORMER LANDFILL, CERTAIN PRECAUTIONARY MEASURES MAY NEED TO BE TAKEN TO ENSURE HEALTH AND SAFETY OF THE PUBLIC. RECOMMENDATION MADE BY A PROFESSIONAL ENGINEER WITH EXPERTISE IN LANDFILLS AND LANDFILL GAS ISSUES (AS REQUIRED BY THE MOST CURRENT VERSION OF THE INTERIM GUIDELINES FOR DEVELOPMENT WITHIN CITY DESIGNATED LANDFILL BUFFER ZONES) SHALL BE CONSULTED PRIOR TO DEVELOPMENT OF THE SITE.

ALBUQUERQUE ENVIRONMENTAL HEALTH DEPARTMENT

Solar Note:

NO PROPERTY WITHIN THE AREA OF REQUESTED FINAL ACTION SHALL AT ANY TIME BE SUBJECT TO A DEED RESTRICTION, COVENANT, OR BINDING AGREEMENT PROHIBITING SOLAR COLLECTORS FROM BEING INSTALLED ON BUILDINGS OR ERRECTED ON THE LOTS OF PARCELS WITHIN THE AREA OF THIS PLAT.

Free Consent and Dedication (See Sheet 2 of 3)

Plat of
 Tracts A and B
Mulberry Properties
 Albuquerque, Bernalillo County, New Mexico
 October 2008

DOCH 2009009057
 01/29/2009 09:37 AM Page: 2 of 3
 PLAT R:\$17.00 B: 29650 P: 0022 M. Toulouse Olivera, Bernalillo Cour

Free Consent and Dedication

THE REPLAT SHOWN HEREON IS WITH THE FREE CONSENT AND IN ACCORDANCE WITH THE DESIRES OF THE UNDERSIGNED OWNER AND/OR PROPRIETOR. EXISTING PUBLIC UTILITY EASEMENTS SHOWN HEREON FOR THE COMMON AND JOINT USE OF GAS, ELECTRICAL POWER AND COMMUNICATION SERVICES FOR BURIED AND/OR OVERHEAD DISTRIBUTION LINES, CONDUITS, AND PIPES FOR UNDERGROUND UTILITIES WHERE SHOWN OR INDICATED, AND INCLUDING THE RIGHT OF INGRESS AND EGRESS FOR CONSTRUCTION AND MAINTENANCE, AND THE RIGHT TO TRIM INTERFERING TREES AND SHRUBS. SAID OWNER AND/OR PROPRIETOR DOES HEREBY CERTIFY THAT THIS SUBDIVISION IS THEIR FREE ACT AND DEED. SAID OWNERS WARRANT THAT THEY HOLD AMONG THEM COMPLETE AND INDEFEASIBLE TITLE IN FEE SIMPLE TO THE LAND SUBDIVIDED.

SAID OWNER AND/OR PROPRIETOR DOES HEREBY GRANT ALL EASEMENTS AS SHOWN HEREON WITH LISTED BENEFICIARIES AND STIPULATIONS.

SAID OWNER AND/OR PROPRIETOR DOES HEREBY DEDICATE ALL STREETS AND PUBLIC RIGHTS OF WAY SHOWN HEREON TO THE CITY OF ALBUQUERQUE IN FEE SIMPLE WITH WARRANTY COVENANTS.

Sherif A. Rababi 10/27/08
 SHERIF A. RABABI
 CO-OWNER TRACT "A"

Acknowledgment

STATE OF NEW MEXICO)
 COUNTY OF BERNALILLO) SS

THIS INSTRUMENT WAS ACKNOWLEDGED BEFORE ME THIS 27 DAY OF October, 2008 BY SHERIF A. RABABI, CO-OWNER TRACT "A"

BY Chelsea Watkins MY COMMISSION EXPIRES: 02/25/2012
 NOTARY PUBLIC

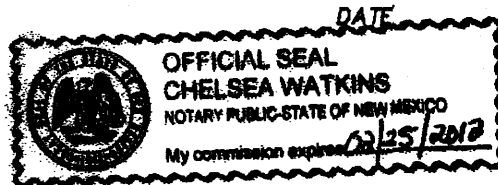

Samla S. Rabadi 10/27/08
 SAMLA S. RABADI
 CO-OWNER TRACT "A"

Acknowledgment

STATE OF NEW MEXICO)
 COUNTY OF BERNALILLO) SS

THIS INSTRUMENT WAS ACKNOWLEDGED BEFORE ME THIS 27th DAY OF October, 2008 BY SAMLA S. RABADI, CO-OWNER TRACT "A"

BY Mary J. Long MY COMMISSION EXPIRES: 09/30/10
 NOTARY PUBLIC

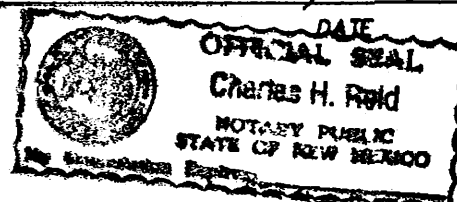

Manuel Lujan Jr. 10-27-08
 MANUEL LUJAN JR.
 CO-OWNER TRACT "A" DATE

Acknowledgment

STATE OF NEW MEXICO)
 COUNTY OF BERNALILLO) SS

THIS INSTRUMENT WAS ACKNOWLEDGED BEFORE ME THIS 27th DAY OF October, 2008 BY MANUEL LUJAN JR., CO-OWNER TRACT "A"

BY Carol J. Edison MY COMMISSION EXPIRES: 5/9/2010
 NOTARY PUBLIC

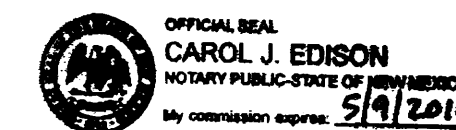

Jean Lujan 10-27-08
 JEAN LUJAN
 CO-OWNER TRACT "A" DATE

Acknowledgment

STATE OF NEW MEXICO)
 COUNTY OF BERNALILLO) SS

THIS INSTRUMENT WAS ACKNOWLEDGED BEFORE ME THIS 27th DAY OF October, 2008 BY JEAN LUJAN, CO-OWNER TRACT "A"

BY Carol J. Edison MY COMMISSION EXPIRES: 5/9/2010
 NOTARY PUBLIC

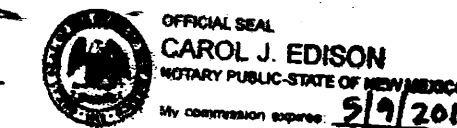

John Lorentzen 10-23-08
 JOHN LORENTZEN
 GENERAL PARTNER OF ALBUQUERQUE AIRPARK PARTNERS
 A NEW MEXICO PARTNERSHIP
 OWNER TRACT "B" DATE

Acknowledgment

STATE OF NEW MEXICO)
 COUNTY OF BERNALILLO) SS

THIS INSTRUMENT WAS ACKNOWLEDGED BEFORE ME THIS 23 DAY OF OCTOBER, 2008 BY JOHN LORENTZEN, GENERAL PARTNER OF ALBUQUERQUE AIRPARK PARTNERS, A NEW MEXICO PARTNERSHIP OWNER TRACT "B"

BY Mary J. Long MY COMMISSION EXPIRES: 3-15-10
 NOTARY PUBLIC

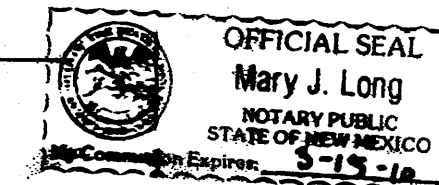

PRECISION SURVEYS, INC.

8500-A Jefferson Street, NE
 Albuquerque, NM 87113

866.442.8011 TOLL FREE
 505.856.5700 PHONE
 505.856.7900 FAX

Legend

- (N 90°00'00" E) RECORD BEARINGS AND DISTANCES SHOWN IN PARENTHESES
- N 90°00'00" E MEASURED BEARING AND DISTANCES
- FOUND AND USED MONUMENT AS DESIGNATED
- DENOTES NO. 4 REBAR WITH YELLOW PLASTIC CAP "PS 1983" SET THIS SURVEY

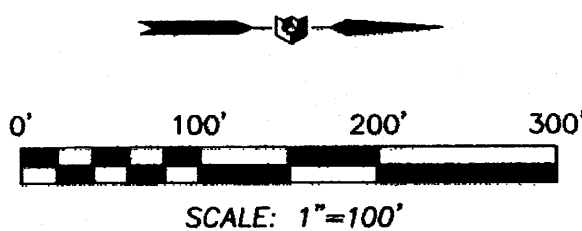

DETERMINING STALID
 DOCH 2009009057
 01/29/2009 09:37 AM Page: 3 of 3
 TPLRT R: \$17.00 B: 2009C P: 0022 H: Toulous Olivera, Bernalillo Cour.
 [Barcode]

Plat of
 Tracts A and B
Mulberry Properties
 Albuquerque, Bernalillo County, New Mexico
 October 2008

A.G.S. MONUMENT "LMH4"
 STANDARD A.G.S. BRASS TABLET
 (FOUND IN PLACE)
 NEW MEXICO STATE PLANE COORDINATES
 (CENTRAL ZONE-N.A.D. 1983)
 N=1,473,322.790
 E=1,521,785.782
 PUBLISHED EL=8940.240 (MAY 1988)
 GROUND TO GRID FACTOR=0.999976244
 DELTA ALPHA ANGLE=-013°23.43'

A.G.S. MONUMENT "L28_30"
 STANDARD N.M.S.M.C. BRASS TABLET
 (FOUND IN PLACE)
 NEW MEXICO STATE PLANE COORDINATES
 (CENTRAL ZONE-N.A.D. 1983)
 N=1,477,335.008
 E=1,524,181.952
 PUBLISHED EL=5041.300 (MAY 1988)
 GROUND TO GRID FACTOR=0.999976244
 DELTA ALPHA ANGLE=-013°23.37'

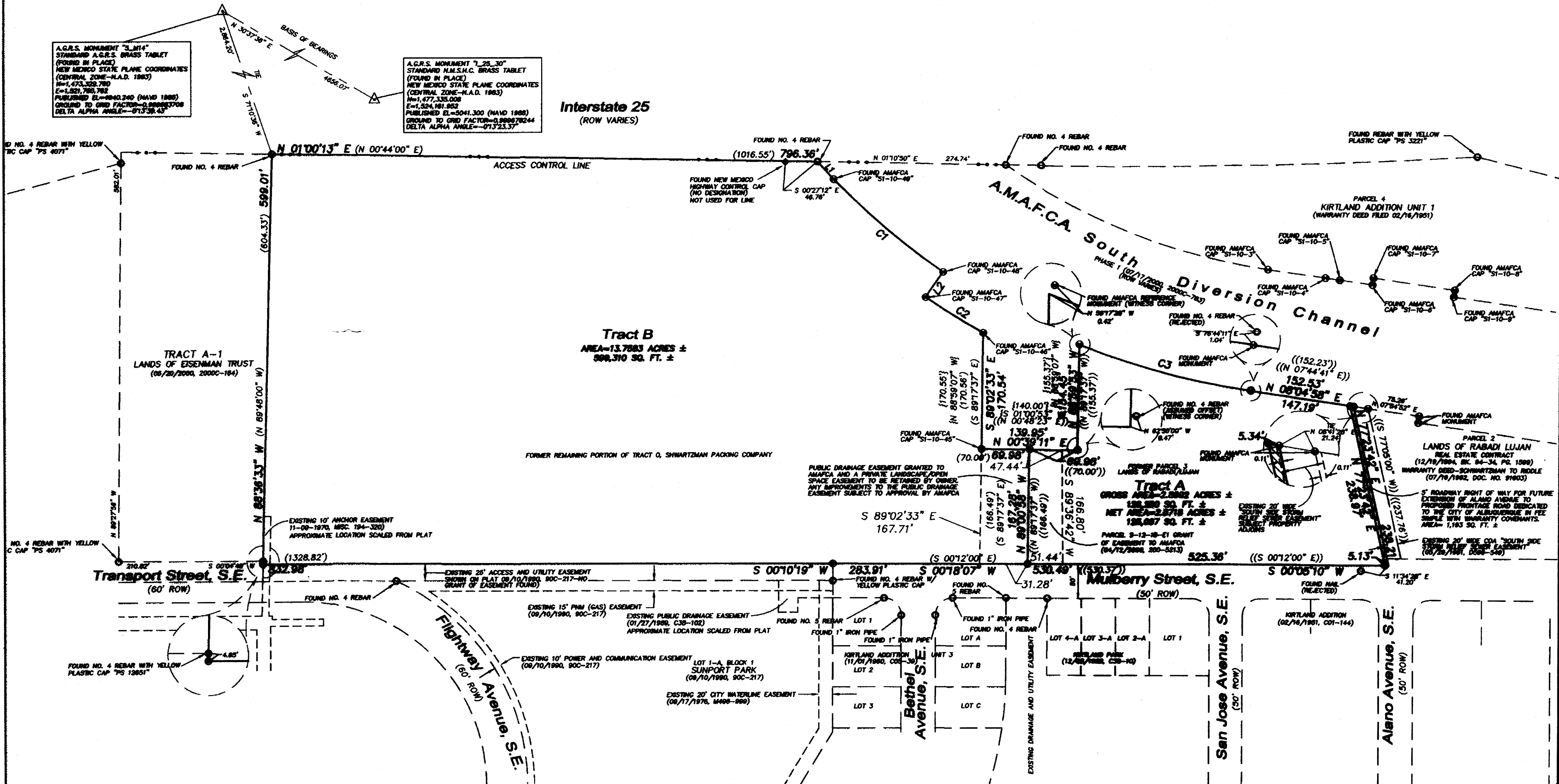

Line Table

LINE	BEARING	DISTANCE
L1	N 47°26'21" E (N 45°35'38" E)	34.98' (35.50')
L2	S 55°31'37" E (N 55°47'37" W) (N 55°29'07" W)	45.00' (45.00') (45.00')
L3	S 31°37'39" E (N 31°37'39" E)	98.99' (98.99')

Curve Table

CURVE	RADIUS	ARC LENGTH	DELTA ANGLE	TANGENT	CHORD BEARING	CHORD LENGTH
C1	1054.93' (R=1054.93') (R=1054.93')	209.50' (L=209.06') (L=208.98')	11°22'43" (Δ=11°23'15") (Δ=11°23'15")	105.10' (T=105.10') (T=105.10')	N 40°11'40" E (CH=S 38°54'01" W) (CH=S 40°12'31" W)	209.16' (CH=32') (CH=32')
C2	1099.93' (R=1099.93')	98.99' (L=98.02')	5°09'24" (Δ=05°09'28")	49.53' (T=49.53')	N 31°58'06" E (CH=S 31°58'06" W)	98.98' (CH=98')
C3	1054.93' (R=1054.93')	261.57' (L=261.09')	14°12'23" (Δ=14°12'08")	131.46' (T=131.42')	N 15°03'17" E (CH=N 14°00'46" E)	260.80' (CH=260.82')



8500-A Jefferson Street, NE
 Albuquerque, NM 87113
 866.442.8011 TOLL FREE
 505.856.5700 PHONE
 505.856.7900 FAX

C:\Plets\2008\08-198P.dwg, 12/22/2008 8:12:08 AM, HP 18x24, p.3