



Supplemental Form (SF)

SUBDIVISION

- Major subdivision action
- Minor subdivision action
- Vacation
- Variance (Non-Zoning)

S Z ZONING & PLANNING

Annexation

V

Zone Map Amendment (Establish or Change Zoning, includes Zoning within Sector Development Plans)

P

Adoption of Rank 2 or 3 Plan or similar Text Amendment to Adopted Rank 1, 2 or 3 Plan(s), Zoning Code, or Subd. Regulations

SITE DEVELOPMENT PLAN

- for Subdivision
- for Building Permit
- Administrative Amendment (AA)
- Administrative Approval (DRT, URT, etc.)
- IP Master Development Plan
- Cert. of Appropriateness (LUCC)

D

Street Name Change (Local & Collector)

L A

APPEAL / PROTEST of...

Decision by: DRB, EPC, LUCC, Planning Director, ZEO, ZHE, Board of Appeals, other

STORM DRAINAGE (Form D)

Storm Drainage Cost Allocation Plan

PRINT OR TYPE IN BLACK INK ONLY. The applicant or agent must submit the completed application in person to the Planning Department Development Services Center, 600 2nd Street NW, Albuquerque, NM 87102.

Fees must be paid at the time of application. Refer to supplemental forms for submittal requirements.

APPLICATION INFORMATION:

Professional/Agent (if any): Huitt Zollars, Inc PHONE: 892-5141
 ADDRESS: 6501 Americas Parkway, Suite 550 STATE NM ZIP 87110 E-MAIL: seddings@huitt-zollars.com FAX: 892-3259
 CITY: Alb
 APPLICANT: COA (Andrew Vaccor) PHONE: 768-3679
 ADDRESS: 1 Civic Plaza STATE NM ZIP 87102 E-MAIL: _____ FAX: AVACORZ@cebp.gov
 CITY: Alb PROPRIETARY interest in site: _____ List all owners: City of Alb, Univ. of NM

DESCRIPTION OF REQUEST:

Sketch Plot

Is the applicant seeking incentives pursuant to the Family Housing Development Program? Yes ___ No ___

SITE INFORMATION: ACCURACY OF THE EXISTING LEGAL DESCRIPTION IS CRUCIAL! ATTACH A SEPARATE SHEET IF NECESSARY.

Lot or Tract No. Lot 1 (UNM Hospital Clinic # TRACT B Block: _____ Unit: _____
 Subdiv/Addn/TBKA: UNM Hospital Clinic) # Tracts A & B West Route 66 Addn
 Existing Zoning: SU-2 Proposed zoning: SU-2 MRGCD Map No _____
 Zone Atlas page(s): K-10 UPC Code: 101005706125531318

CASE HISTORY:

List any current or prior case number that may be relevant to your application (Proj., App., DRB-, AX_Z_, V_, S_, etc.): _____

CASE INFORMATION:

Within city limits? Yes No Within 1000FT of a landfill? _____
 No. of existing lots: 2 No. of proposed lots: 2 Total site area (acres): 0.0515 AC
 LOCATION OF PROPERTY BY STREETS: On or Near: Unser Blvd and Bluewater
 Between: Central Ave and Bluewater

Check if project was previously reviewed by: Sketch Plat/Plan or Pre-application Review Team(PRT) Review Date: _____

SIGNATURE Scott Eddings

DATE 8/2/16

(Print Name) Scott Eddings

Applicant: Agent:

FOR OFFICIAL USE ONLY

- INTERNAL ROUTING
- All checklists are complete
- All fees have been collected
- All case #s are assigned
- AGIS copy has been sent
- Case history #s are listed
- Site is within 1000ft of a landfill
- F.H.D.P. density bonus
- F.H.D.P. fee rebate

Application case numbers

Action

S.F.

Fees

Revised: 11/2014

Hearing date _____

Staff signature & Date _____

Project # _____

FORM S(3): SUBDIVISION - D.R.B. MEETING (UNADVERTISED) OR INTERNAL ROUTING

A Bulk Land Variance requires application on FORM-V in addition to application for subdivision on FORM-S.

SKETCH PLAT REVIEW AND COMMENT (DRB22)

- ___ Scale drawing of the proposed subdivision plat (folded to fit into an 8.5" by 14" pocket) **6 copies**
- ___ Site sketch with measurements showing structures, parking, Bldg. setbacks, adjacent rights-of-way and street improvements, if there is any existing land use (folded to fit into an 8.5" by 14" pocket) **6 copies**
- ___ Zone Atlas map with the entire property(ies) clearly outlined
- Letter briefly describing, explaining, and justifying the request
- ___ List any original and/or related file numbers on the cover application

Your attendance is required.

EXTENSION OF MAJOR PRELIMINARY PLAT (DRB08)

Your attendance is

required.

- ___ Preliminary Plat reduced to 8.5" x 11"
- ___ Zone Atlas map with the entire property(ies) clearly outlined
- ___ Letter briefly describing, explaining, and justifying the request
- ___ Copy of DRB approved infrastructure list
- ___ Copy of the LATEST Official DRB Notice of approval for Preliminary Plat Extension request
- ___ List any original and/or related file numbers on the cover application

Extension of preliminary plat approval expires after one year.

MAJOR SUBDIVISION FINAL PLAT APPROVAL (DRB12)

Your attendance is required.

- ___ Proposed Final Plat (folded to fit into an 8.5" by 14" pocket) **6 copies**
- ___ Signed & recorded Final Pre-Development Facilities Fee Agreement for Residential development only
- ___ Design elevations & cross sections of perimeter walls **3 copies**
- ___ Zone Atlas map with the entire property(ies) clearly outlined
- ___ Bring original Mylar of plat to meeting, ensure property owner's and City Surveyor's signatures are on the plat
- ___ Copy of recorded S/A
- ___ Landfill disclosure and EHD signature line on the Mylar if property is within a landfill buffer
- ___ List any original and/or related file numbers on the cover application
- ___ DXF file and hard copy of final plat data for AGIS is required.

MINOR SUBDIVISION PRELIMINARY/FINAL PLAT APPROVAL (DRB16) Your attendance is required.

- ___ 5 Acres or more: Certificate of No Effect or Approval
- ___ Proposed Preliminary / Final Plat (folded to fit into an 8.5" by 14" pocket) **6 copies** for unadvertised meetings ensure property owner's and City Surveyor's signatures are on the plat prior to submittal
- ___ Signed & recorded Final Pre-Development Facilities Fee Agreement for Residential development only
- ___ Design elevations and cross sections of perimeter walls (1" by 17" maximum) **3 copies**
- ___ Site sketch with measurements showing structures, parking, Bldg. setbacks, adjacent rights-of-way and street improvements, if there is any existing land use (folded to fit into an 8.5" by 14" pocket) **6 copies**
- ___ Zone Atlas map with the entire property(ies) clearly outlined
- ___ Letter briefly describing, explaining, and justifying the request
- ___ Bring original Mylar of plat to meeting, ensure property owner's and City Surveyor's signatures are on the plat
- ___ Landfill disclosure and EHD signature line on the Mylar if property is within a landfill buffer
- ___ Fee (see schedule)
- ___ List any original and/or related file numbers on the cover application
- ___ Infrastructure list if required (**verify with DRB Engineer**)
- ___ DXF file and hard copy of final plat data for AGIS is required.

AMENDMENT TO PRELIMINARY PLAT (with minor changes) (DRB03) Your attendance is required.

- ___ PLEASE NOTE: There are no clear distinctions between significant and minor changes with regard to subdivision amendments. Significant changes are those deemed by the DRB to require public notice and public hearing.
- ___ Proposed Amended Preliminary Plat, Infrastructure List, and/or Grading Plan (folded to fit into an 8.5" by 14" pocket) **6 copies**
- ___ Original Preliminary Plat, Infrastructure List, and/or Grading Plan (folded to fit into an 8.5" by 14" pocket) **6 copies**
- ___ Zone Atlas map with the entire property(ies) clearly outlined
- ___ Letter briefly describing, explaining, and justifying the request
- ___ Bring original Mylar of plat to meeting, ensure property owner's and City Surveyor's signatures are on the plat
- ___ List any original and/or related file numbers on the cover application

Amended preliminary plat approval expires after one year

I, the applicant, acknowledge that any information required but not submitted with this application will likely result in deferral of actions.

Scott Eddings
 Applicant name (print)
Scott Eddings / 8/2/16
 Applicant signature / date



<input type="checkbox"/> Checklists complete	Application case numbers	Form revised October 2007
<input type="checkbox"/> Fees collected	_____	
<input type="checkbox"/> Case #'s assigned	_____	Project # _____
<input type="checkbox"/> Related #'s listed	_____	Planner signature / date _____

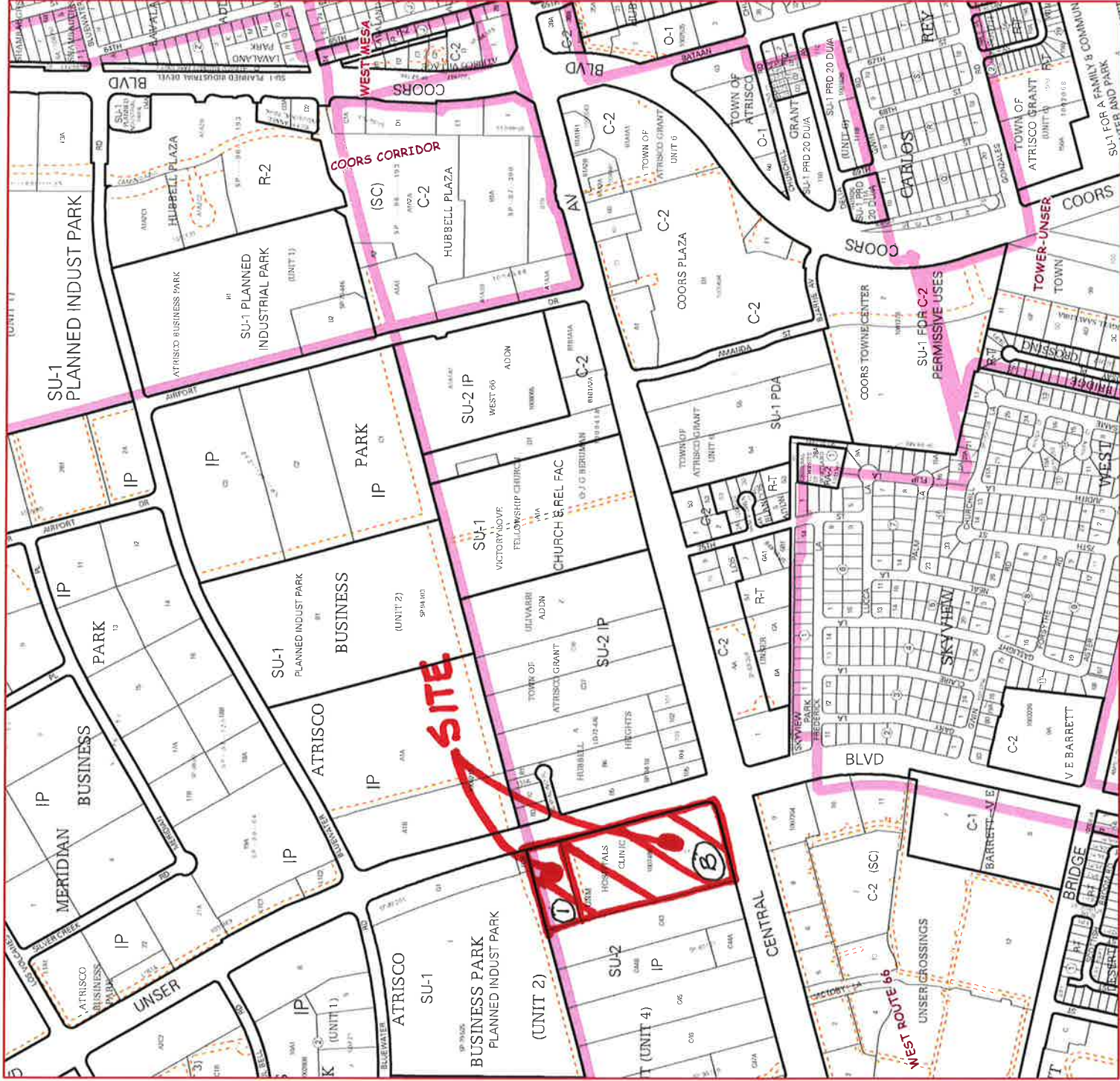

For more current information and more details visit: <http://www.cabq.gov/gis>



Map amended through: 1/24/2011



Note: Grey Shading Represents Area Outside of the City Limits

Zone Atlas Page:

K-10-Z

Selected Symbols

- SECTOR PLANS**
- Design Overlay Zones
- City Historic Zones
- H-1 Buffer Zone
- Petroglyph Mon.
- Escarpment
- 2 Mile Airport Zone
- Airport Noise Contours
- Wall Overlay Zone

