

- EROSION CONTROL NOTES:**
1. CONTRACTOR IS RESPONSIBLE FOR OBTAINING A TOPSOIL DISTURBANCE PERMIT PRIOR TO BEGINNING WORK.
 2. CONTRACTOR IS RESPONSIBLE FOR MAINTAINING RUN-OFF ON SITE DURING CONSTRUCTION.
 3. CONTRACTOR IS RESPONSIBLE FOR CLEANING ALL SEDIMENT THAT GETS INTO EXISTING RIGHT-OF-WAY.
 4. REPAIR OF DAMAGED FACILITIES AND CLEANUP OF SEDIMENT ACCUMULATIONS ON ADJACENT PROPERTIES AND IN PUBLIC FACILITIES IS THE RESPONSIBILITY OF THE CONTRACTOR.
 5. ALL EXPOSED EARTH SURFACES MUST BE PROTECTED FROM WIND AND WATER EROSION PRIOR TO FINAL (CITY) ACCEPTANCE OF ANY PROJECT.

LEGAL DESCRIPTION:
 Tract 2-A, Indian Ridge Subdivision

- LEGEND:**
1. ALL SPOT ELEVATIONS REPRESENT FLOWLINE ELEVATION UNLESS OTHERWISE NOTED.
 2. TOPOGRAPHIC SURVEY INFORMATION SHOWN ON THIS PLAN WAS OBTAINED BY Construction Surveys dated September 2015

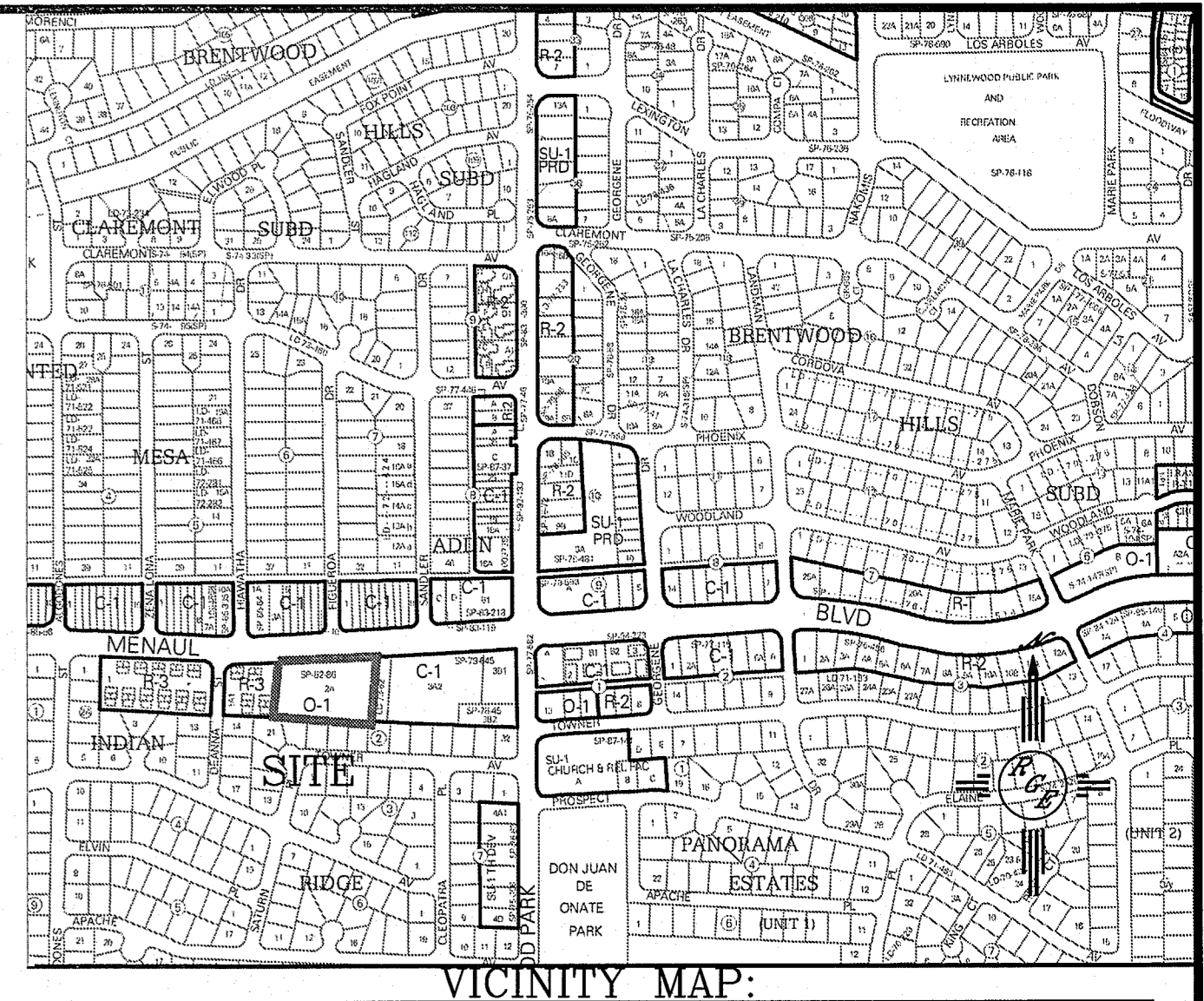

- LEGEND**
- 5411--- EXISTING CONTOUR
 - 5410--- EXISTING INDEX CONTOUR
 - 5411--- PROPOSED CONTOUR
 - 5410--- PROPOSED INDEX CONTOUR
 - PROPOSED FLOWLINE
 - WIL--- PROPOSED WATERLINE
 - SAS--- PROPOSED SANITARY LINE
 - GAS--- PROPOSED GAS LINE
 - LIE--- PROPOSED UNDERGROUND ELECTRIC LINE

- NOTICE TO CONTRACTORS**
1. AN EXCAVATION/CONSTRUCTION PERMIT WILL BE REQUIRED BEFORE BEGINNING ANY WORK WITHIN PUBLIC RIGHT OF WAY. AN APPROVED COPY OF THESE PLANS MUST BE SUBMITTED AT THE TIME OF APPLICATION FOR THIS PERMIT.
 2. ALL WORK DETAILED ON THESE PLANS TO BE PERFORMED, EXCEPT AS OTHERWISE STATED OR PROVIDED HEREON, SHALL BE CONSTRUCTED IN ACCORDANCE WITH CITY OF ALBUQUERQUE INTERIM STANDARD SPECIFICATIONS FOR PUBLIC WORKS CONSTRUCTION.
 3. TWO WORKING DAYS PRIOR TO ANY EXCAVATION, CONTRACTOR MUST CONTACT NM ONE CALL LINE LOCATING SERVICE, 260-1990, FOR LOCATION OF EXISTING UTILITIES.
 4. PRIOR TO CONSTRUCTION, THE CONTRACTOR SHALL EXCAVATE AND VERIFY THE HORIZONTAL AND VERTICAL LOCATIONS OF ALL CONSTRUCTION. SHOULD A CONFLICT EXIST, THE CONTRACTOR SHALL NOTIFY THE ENGINEER SO THAT THE CONFLICT CAN BE RESOLVED WITH A MINIMUM AMOUNT OF DELAY.
 5. BACKFILL COMPACTION SHALL BE ACCORDING TO TOWN OF BERNALILLO STANDARDS.
 6. MAINTENANCE OF THESE FACILITIES SHALL BE THE RESPONSIBILITY OF THE OWNER
 7. WORK ON ARTERIAL STREETS SHALL BE PERFORMED ON A 24-HOUR BASIS.
 8. CONTRACTOR SHALL DETERMINE LOCATION OF ANY UNDERGROUND FACILITY IN OR NEAR WORK AREAS, INCLUDING REQUESTS TO OWNERS/OPERATORS OF SAID FACILITIES PER SECTION 62-14-5 NMSA 1978.
 9. CONTRACTOR SHALL PLAN ALL EXCAVATION TO MINIMIZE INTERFERENCE OR DAMAGE OF UNDERGROUND FACILITIES.
 10. CONTRACTOR SHALL PROVIDE ADVANCE TELEPHONE NOTICE OF COMMENCEMENT, EXTENT AND DURATION OF ALL EXCAVATION WORK TO THE ONE-CALL NOTIFICATION SYSTEM, OR TO OWNERS/OPERATORS OF ANY EXISTING UNDERGROUND FACILITY IN OR NEAR THE EXCAVATION AREA THAT ARE NOT MEMBERS OF THE ONE-CALL NOTIFICATION CENTER; IN ORDER THAT OWNERS/OPERATORS MAY LOCATE AND MARK UNDERGROUND FACILITY PER SECTION 62-14-5 NMSA 1978 PRIOR TO ANY COMMENCEMENT OF WORK. CONTRACTOR SHALL REQUEST REAFFIRMATION OF LOCATION EVERY TEN (10) WORKING DAYS AFTER INITIAL REQUEST.
 11. CONTRACTOR SHALL MAINTAIN EIGHTEEN (18) INCHES BETWEEN EXISTING UNDERGROUND FACILITIES THAT HAVE BEEN PREVIOUSLY IDENTIFIED AND MARKED BY THE OWNERS/OPERATORS OF SAID FACILITIES. CUTTING EDGE OR POINT OF ANY MECHANICAL EXCAVATING EQUIPMENT UTILIZED IN EXCAVATION AREA WILL BE USED IN A MANNER NECESSARY TO PREVENT DAMAGE TO EXISTING UNDERGROUND FACILITIES.
 12. CONTRACTOR SHALL PROVIDE SUPPORT FOR EXISTING UNDERGROUND FACILITIES IN OR NEAR EXCAVATION AREA AS NECESSARY TO PREVENT DAMAGE TO SAID FACILITIES.
 13. CONTRACTOR SHALL BACKFILL ALL EXCAVATIONS IN A MANNER AND WITH MATERIALS AS MAY BE NECESSARY TO PREVENT DAMAGE TO AND PROVIDE RELIABLE SUPPORT DURING AND FOLLOWING BACK FILLING ACTIVITIES FOR PREEXISTING UNDERGROUND FACILITIES IN OR NEAR EXCAVATION AREA.
 14. CONTRACTOR SHALL IMMEDIATELY NOTIFY BY TELEPHONE THE OWNER/OPERATOR OF ANY UNDERGROUND FACILITY WHICH MAY HAVE BEEN DAMAGED OR DISLODGED DURING EXCAVATION WORK.
 15. CONTRACTOR SHALL NOT MOVE OR OBLITERATE MARKINGS MADE PURSUANT TO CHAPTER 62, ARTICLE 14 NMSA 1978, OR FABRICATE MARKINGS IN A UNMARKED LOCATION FOR THE PURPOSE OF CONCEALING OR AVOIDING LIABILITY FOR VIOLATION OF OR NONCOMPLIANCE WITH THE PROVISIONS OF CHAPTER 62, ARTICLE 11 NMSA 1978.
 16. ALL EXCAVATION, TRENCHING, AND SHORING ACTIVITIES MUST BE CARRIED OUT IN ACCORDANCE WITH OSHA 29 CFR 1926.6450 SUBPART P.
 17. ALL IMPACTED STRIPING SHALL BE REPLACED BY CONTRACTOR.

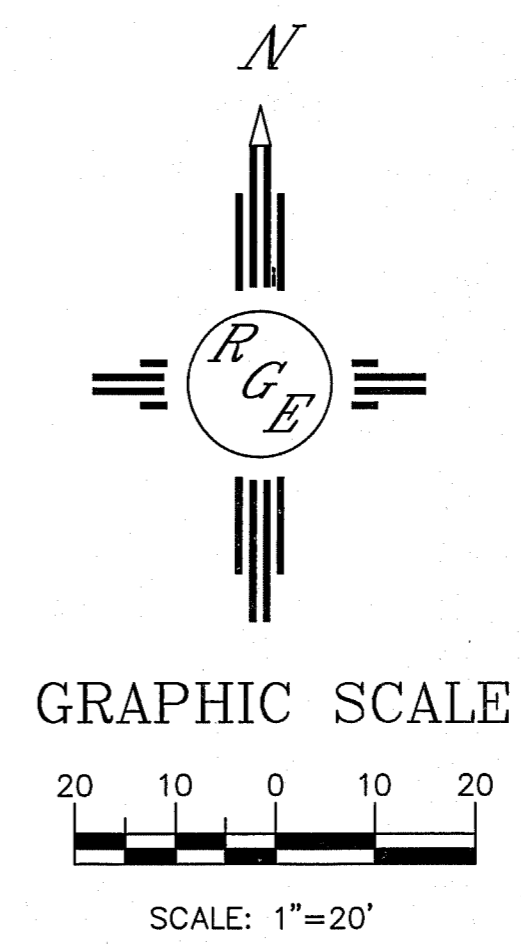

	TRACT 2-A INDIAN RIDGE SUBDIVISION	DRAWN BY JDG
	MASTER UTILITY PLAN	DATE 09-27-2015
	9/28/15	SHEET # DRB 04
	DAVID SOULE P.E. #14522	JOB #