

PLANTING SCHEDULE

SYMBOL	COMMON NAME	BOTANICAL NAME	MATURE SIZE	COUNT	AREA
TREES					
	PURPLE LEAF PLUM (M)	Prunus Cerisifera, 2" cal.	20' tall x 20' spread	13	
	CLEVELAND FLOWERING PEAR(M)	Pyrus Velutina, 2" cal.	30' tall x 25' spread	10	
	LEYLANDI CYPRESS (M)	Cupressocyparis laylandii, 2" cal	25' tall x 15' spread	17	
				TOTAL TREES	40 > 26 COMPLIES
SHRUBS					
	GREY LEAF COTONEASTER (M)	Cotoneaster Buxifolius, 1 Gal.	3' tall X 5' spread	11	275
	INDIAN HAWTHORN (M)	Raphiolepis Indica, 1 Gal.	3' tall x 4' spread	9	144
	SILVER QUEEN EUONYMUS (L)	Euonymus japonicus 1 Gal.	12' tall x 6' spread	12	432
	SILVERBERRY (M)	Elaeagnus Pungens 1 Gal.	10' tall x 10' spread	5	500
	LYNWOOD GOLD FORSYTHIA (M)	Forsythia X Intermedia 'Lynbrook Gold' 1 Gal.	12' tall x 12' spread	2	288
	BLUE RUG JUNIPER (L)	Juniperous Horizontalis 'Witoni' 1 Gal.	1' tall x 8' spread	39	2112
	SEA GREEN JUNIPER (L)	Juniperous Chinensis 'Sea Green Juniper' 1 Gal.	4'-6" tall x 6'-8" spread	39	1452
	LAVENDER (L)	Lavandula Angustifolia 'Munstead Lavender' 1 Gal.	18" tall x 2' spread	29	116
	COREOPSIS (M)	Coreopsis Lanceolata 'Double Sunburst' 1 Gal.	18" tall x 2' spread	23	92
	SALVIA (L)	Salvia Leucantha 'Mexican Bush Sage' 1 Gal.	48" tall x 4' spread	26	416
				SHRUB GROUND COVER TOTAL AREAS	5827 SF 5827 > 5772 COMPLIES

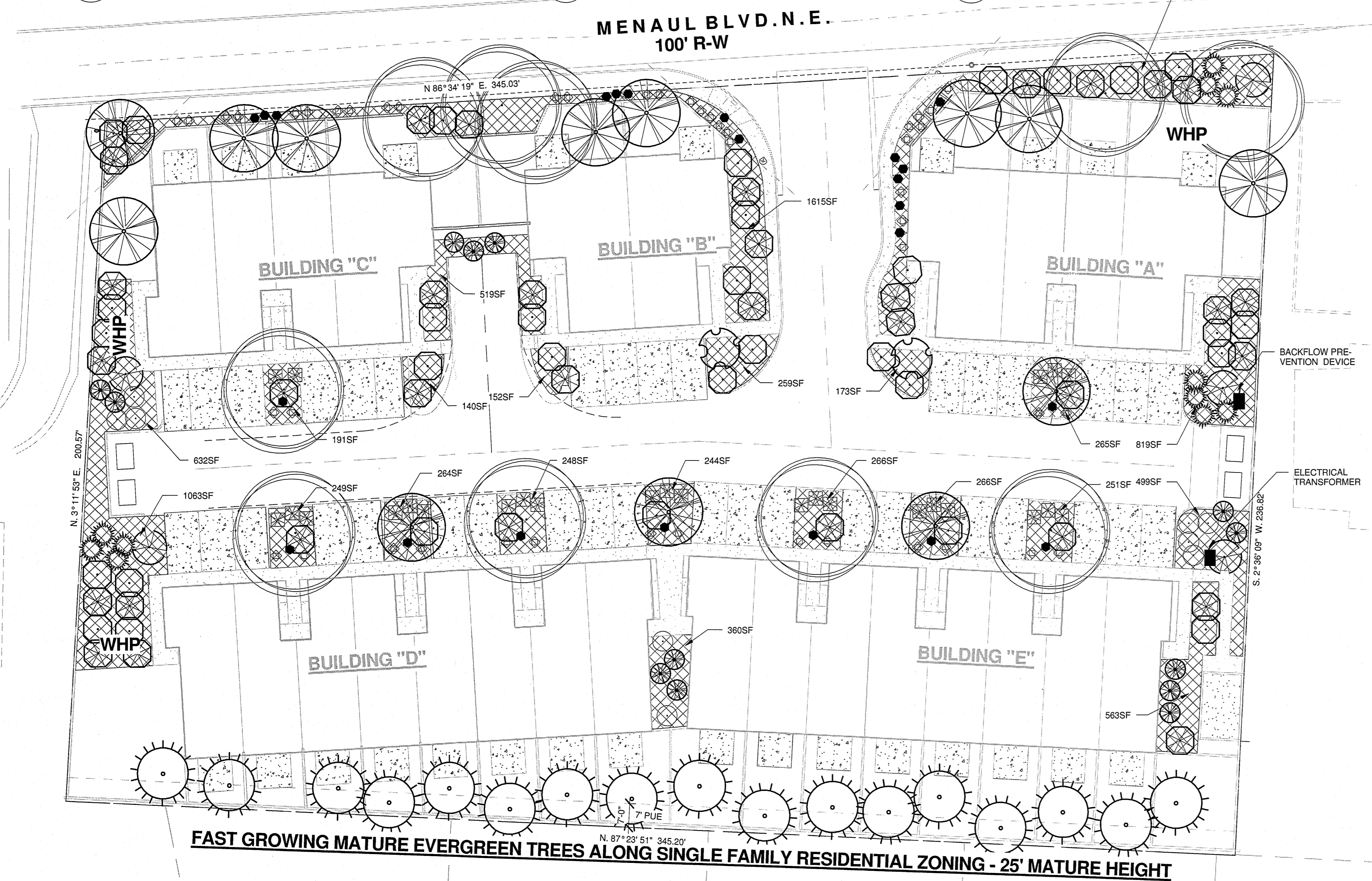

LANDSCAPING CALCULATIONS & NOTES

LANDSCAPE CALCULATION:
 LOT: 1.727A X 43560 = 75,228 SF
 BUILDINGS: 23,920 SF
 NET LOT AREA 51,308 SF
 REQUIRED LANDSCAPING: 51,308 X 15% = 7696 SF
 LANDSCAPING PROVIDED: 10,156 SF **COMPLIES**
 REQUIRED 75% VEGETATIVE GROUND COVER = 75 X 7696 SF = 5772 SF
 VEGETATIVE GROUND COVER PROVIDED: 5827 SF **COMPLIES**

PLANT WATERING SHALL BE PROVIDED BY A DRIP IRRIGATION SYSTEM. CONTROLLERS SHALL BE PROVIDED IN THE NUMBER AND SPACING REQUIRED BY ZONE SPECIFICATION AND LOCATION. CONTROLLERS SHALL BE INSTALLED ON OWNERS HOUSE ELECTRICAL PANELS.

ALL LANDSCAPING SHALL BE MAINTAINED AND REPLACED, IF NECESSARY, BY THE OWNER.

LANDSCAPING AND SIGNING WILL NOT INTERFERE WITH CLEAR SITE REQUIREMENTS, THEREFORE, SIGNS, WALLS, TREES AND SHRUBBERY BETWEEN 3 AND 8 FEET TALL (AS MEASURED FROM THE GUTTER PAN) WILL NOT BE ACCEPTABLE IN THIS AREA.

PROVIDE WATER HARVESTING PONDS AT ALL REAR YARDS AS PER GRADING AND DRAINAGE PLAN - SEE DRB-3

THE PROJECT SHALL COMPLY WITH THE "WATER CONSERVATION AND WATER WASTE ORDINANCE" - ARTICLE 6-1-1-1.

THE PROJECT SHALL COMPLY WITH THE CITY OF ALBUQUERQUE ZONING ORDINANCE - 14-16-3-10 GENERAL LANDSCAPE REGULATIONS

HATCH LEGEND

	4" CONCRETE SIDEWALK, DRIVEWAY AND PATIO SLABS
	4" DEPTH OF 3/4" SANTA ANA TAN DECORATIVE GRAVEL ON 6 MIL VISQUEEN
	WHP WATER HARVESTING POND PER GRADING AND DRAINAGE PLAN

NOTE: GRAVEL AREAS @ UNIT ENTRY ALCOVES ARE NOT INCLUDED IN PROPOSED LANDSCAPE AREAS

Cinelli / Roger Cinelli & Assoc.
 ARCHITECTS 2418 Manuel Torres Lane N.W., Albuquerque, New Mexico 87107 (505) 243-8211

PROJECT TITLE: INDIAN RIDGE PATIO HOMES FOR JOE AZAR
 11,910 MENAU BLVD. N.E. ALBUQUERQUE, NEW MEXICO

DRAWING TITLE: SITE LANDSCAPE PLAN

SEAL: [Architect Seal] DATE: DEC. 15, 2015 PROJECT NO. TIRY37 DRAWING NO. DRB-5

12/15/15

