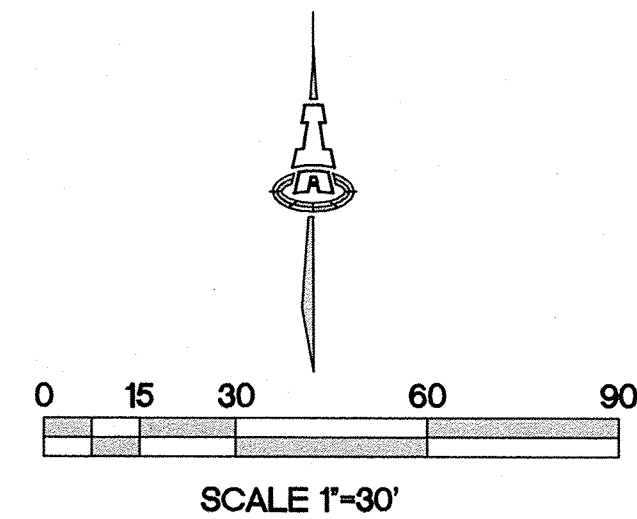
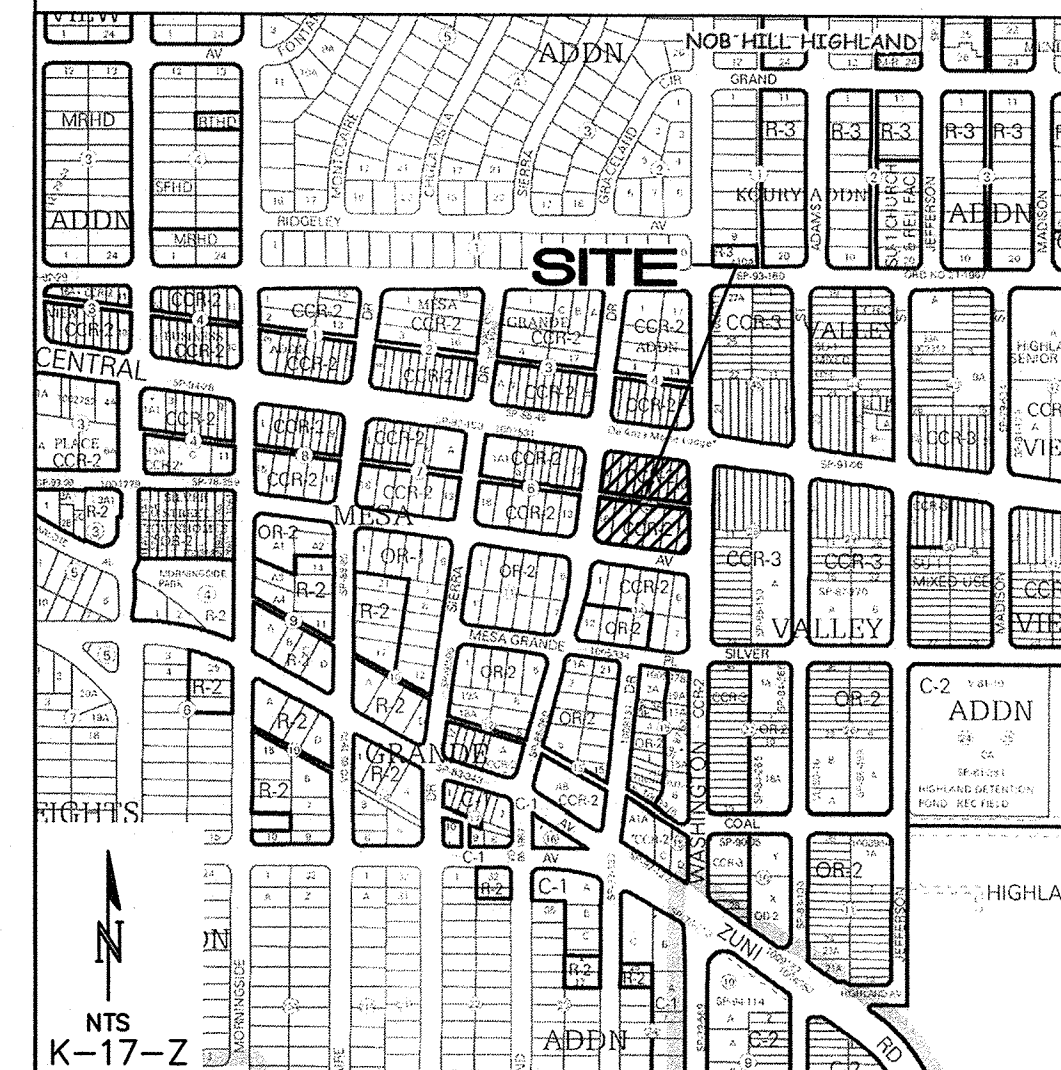

PHOTO BASE EXHIBIT

PROJECT #: 1009243
 DATE: 2-26-14
 APP#: 14-70043 (SK)



SKETCH PLAT



SITE DATA

LEGAL: LOTS 4-9, BLOCK 5, MESA GRANDE ADDITION
 (REC. JULY 18, 1931; DOC # 49830)

ZONING: CCR-2 AND IS WITHIN THE BOUNDARIES OF THE NOB HILL SECTOR DEVELOPMENT PLAN.

OWNER(S): LOT 4-A: ROBERT MUNRO
 ROBERT O'NIELL

LOT 9-A: GIOCO

PURPOSE OF PLAT: TO CONSOLIDATE LOTS 4-7 AND PORTIONS OF LOTS 8-9 INTO FUTURE LOT 4-A TO CONTAIN THE FULL STRUCTURE OF O'NIELLS IRISH PUB AND TO CREATE LOT 9-A FOR THE REMAINING PORTIONS OF LOTS 8 & 9.

PARKING: THE REQUIRED PARKING FOR THE 108 SEAT GIOCO IS 14 STANDARD SPACES, 1 ADA VAN ACCESSIBLE SPACE AND 1 MOTORCYCLE SPACE PER THE NMSDP. ALL PARKING TO BE PROVIDED PER COMMON ACCESS & PARKING AGREEMENT ON LOTS 11 12.

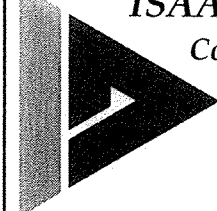

ISAACSON & ARFMAN, P.A.
 Consulting Engineering Associates
 128 Monroe Street N.E.
 Albuquerque, New Mexico 87108
 Ph. 505-268-8828 www.incivil.com

V-SPLAT.dwg Feb 17, 2014

This design, calculations, and concepts are owned by and remain the property of Isaacson & Arfman, P.A. and no part thereof shall be utilized by any person, firm or corporation for any purpose whatsoever except with the written permission of Isaacson & Arfman, P.A. ©

O'NIELLS IRISH PUB
 LOTS 4-9, BLOCK 5, MESA GRANDE ADDITION
 ROB O'NIELL

SKETCH PLAT

Checked By:	Drawn By:	No.	Revision:	PAGE
Date:	Job Number:			SH. OF