

LOCATION
ZONE ATLAS MAP NO. D-09-Z



FLOOD INSURANCE RATE MAP
REFERENCE: FLOOD INSURANCE STUDY
PANEL 111 - MAP # 35001C0116



SOILS MAP
REFERENCE:
HTTP://WEBSOILSURVEY.NRCS.USDA.GOV

LEGEND

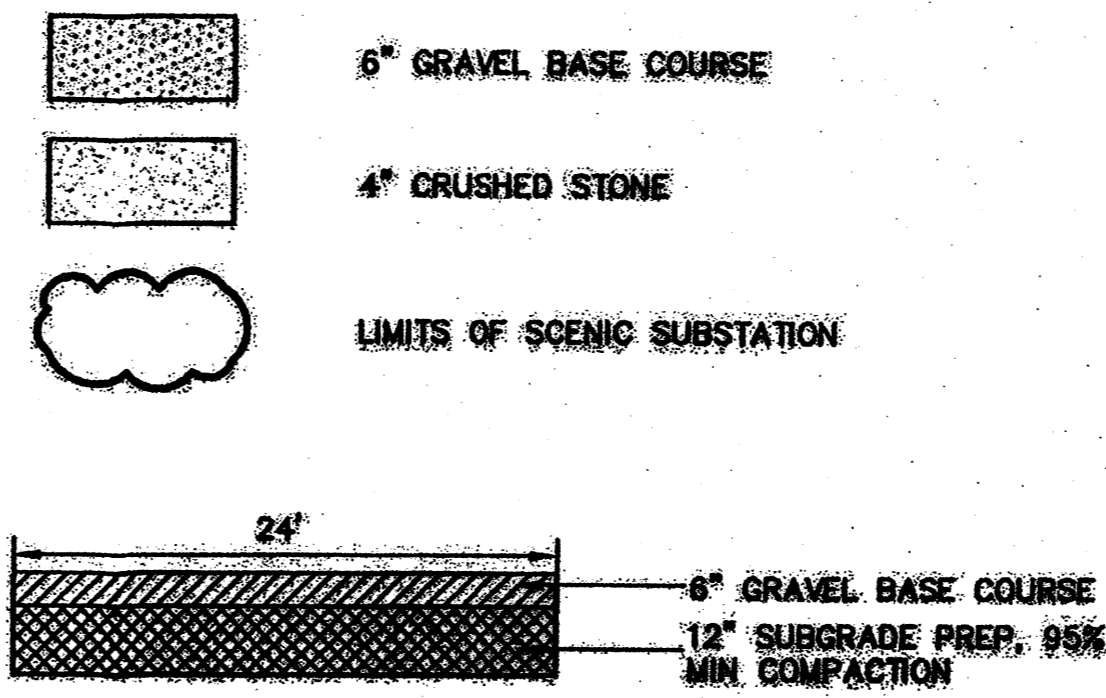

GRAVEL ACCESS SECTION

NTS

EASEMENT NOTES

- D EXISTING 100' OVERHEAD POWERLINE EASEMENT SUBJECT TO ENCROACHMENT AGREEMENT BETWEEN AMAFCA & PNM.
- E 50' ACCESS & UTILITY EASEMENT FOR THE BENEFIT OF PNM SUBSTATION.
- F EXISTING 10' PNM EASEMENT.
- G EXISTING 10' PNM EASEMENT.
- H EXISTING 10' PNM EASEMENT.
- I EXISTING 16' PNM EASEMENT.

GENERAL NOTES

- 1. ALL DESIGN WORK SHALL CONFORM TO PNM STANDARDS & SPECIFICATIONS:
- SSS-401, SITE PREPARATION CONSTRUCTION STANDARDS
- SSS-418, ROADWAY CONSTRUCTION STANDARDS
- SSS-419, CULVERT CONSTRUCTION STANDARDS
- SSS-420, YARD SURFACING CONSTRUCTION STANDARDS

KEYNOTES

- 1. OVERHEAD POWER LINES, 115 KV
- 2. EXISTING 96" STORM DRAIN TO BE INSTALLED WITH BOCA NEGRA DAM PROJECT.
- 3. PART OF BOCA NEGRA DAM, CITY PROJECT NUMBER 781181.
- 4. SEEDED AREA, PART OF THE BOCA NEGRA DAM CITY PROJECT NUMBER 781181.
- 5. INSTALL 12' HIGH, 8" THICK CMU WALL.
- 6. INSTALL 24'-0" WIDE SWING GATE.
- 7. INSTALL 30'-0" WIDE LIFT OUT GATE.
- 8. INSTALL 4" THICK CRUSHED ROCK PER PNM YARD SURFACING CONSTRUCTION STD SSS-420. EXTEND ROCK LAYER MINIMUM 4 FEET BEYOND THE FENCE & 6 FEET BEYOND ALL GATE SWINGS.
- 9. INSTALL 10' W X 24' L X 6" H SPEED HUMP.
- 10. INSTALL 6" THICK GRAVEL BASE COURSE ACCESS. SEE PAVEMENT SECTION THIS SHEET.
- 11. BEGIN NEW PNM ACCESS.
- 12. TAP STRUCTURE LOCATION. -POWERLINE CONNECTION TO SUBSTATION

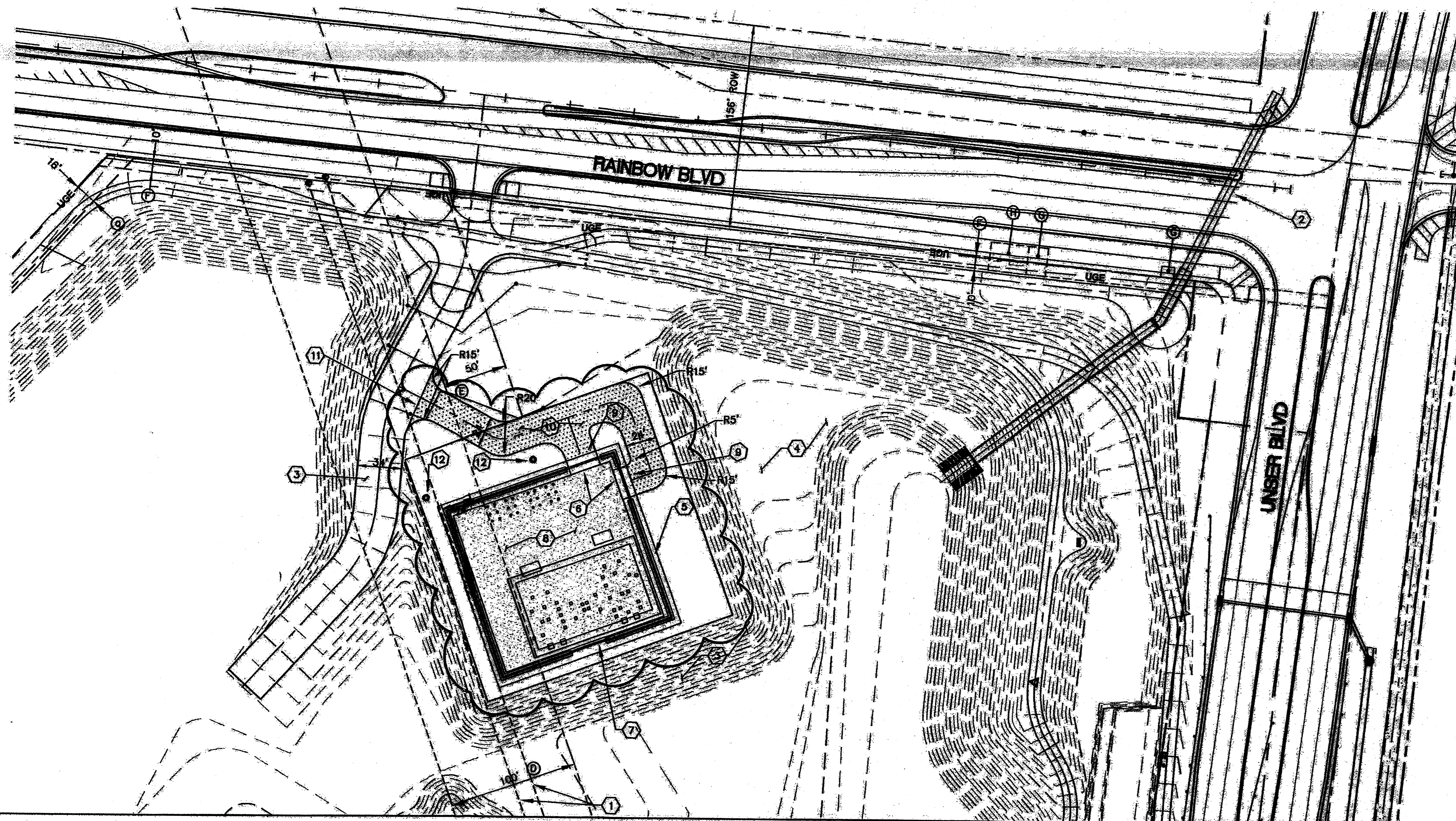

BOCA NEGRA DAM CITY PROJECT
NUMBER 781181 AND SAD 228 CITY
PROJECT NUMBER 693391 IMPROVEMENTS
SHOWN FOR CONTEXT ONLY

PROJECT NUMBER 1009244



APPROVAL SIGNATURE	07-25-12
TRAFFIC ENGINEER	DATE
CITY ENGINEER	7/25/12
PUBLIC WORKS/UTILITY DIVISION - ABCWUA	DATE
PARKS AND RECREATION	7-25-12
CITY PLANNER, PLANNING DIVISION	DATE
REFUSE DIVISION	DATE
FIRE MARSHAL	DATE

PROPRIETARY STATEMENT

THIS DOCUMENT AND ALL PREMIUM ISSUES ARE THE PROPERTY OF PUBLIC SERVICE COMPANY OF NEW MEXICO (PNM) AND REMAIN THE PROPERTY OF PNM. ANY REPRODUCTION OR DISSEMINATION OF THIS DOCUMENT WITHOUT THE EXPRESS WRITTEN PERMISSION OF PNM IS STRICTLY PROHIBITED. ANY REPRODUCTION OR DISSEMINATION OF THIS DOCUMENT WITHOUT THE EXPRESS WRITTEN PERMISSION OF PNM IS STRICTLY PROHIBITED. ANY REPRODUCTION OR DISSEMINATION OF THIS DOCUMENT WITHOUT THE EXPRESS WRITTEN PERMISSION OF PNM IS STRICTLY PROHIBITED.

PNM PUBLIC SERVICE COMPANY OF NEW MEXICO

SITE DEVELOPMENT PLAN FOR BUILDING PERMIT UNIT SUBSTATION		
DATE:	6.14.2012	SCALE: 1" = 50'
APP:	ACAD FILE:	USS-18006 1/4
REV. NO.		

REVISION	NO.	DATE	BY
----------	-----	------	----

1 SITE PLAN



1009244

NOTES:

Landscape maintenance is the responsibility of the property owner

NOTES

SEED MIXTURE DESCRIPTIONS:
 "B" - GRASS MIX WITH STRAW MULCH
 "D" - GRASS MIX WITH GRAVEL MULCH





SEED MIXTURE TYPE "B"
 (GRASS MIX)

Common Name/Variety	Genus/Species	Lbs. PLS/acre
Blue grama "Hatchita"	Bouteloua gracilis	1.0
Sideoats grama "Niner"	Bouteloua curtipendula	3.0
Galleta (florets) "Viva"	Hilaria jamesii	3.0
Sand Dropseed	Sporobolus cryptandrus	1.0
Indian ricegrass "Paloma"	Oryzopsis hymenoides	4.0
Alkali Sacaton	Sporobolus airoides	1.0
CLASS "B" SEEDING (GRASS MIX) SUBTOTAL PLS/acre		13.0

SEED MIXTURE TYPE "D"
 (GRASS MIXTURE)

SAME AS TYPE "B", LESS STRAW MULCH.
 2" BASALT (BLACK) GRAVEL MULCH IN LIEU OF STRAW MULCH.

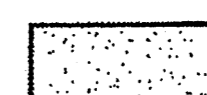
LEGEND

-  SEED MIXTURE TYPE "D"
-  6" GRAVEL BASE COURSE
-  4" CRUSHED STONE GREY
-  LIMITS OF SCENIC SUBSTATION

BOCA NEGRA DAM CITY PROJECT
 NUMBER 781181 AND SAD 228 CITY
 PROJECT NUMBER 693391 IMPROVEMENTS
 SHOWN FOR CONTEXT ONLY

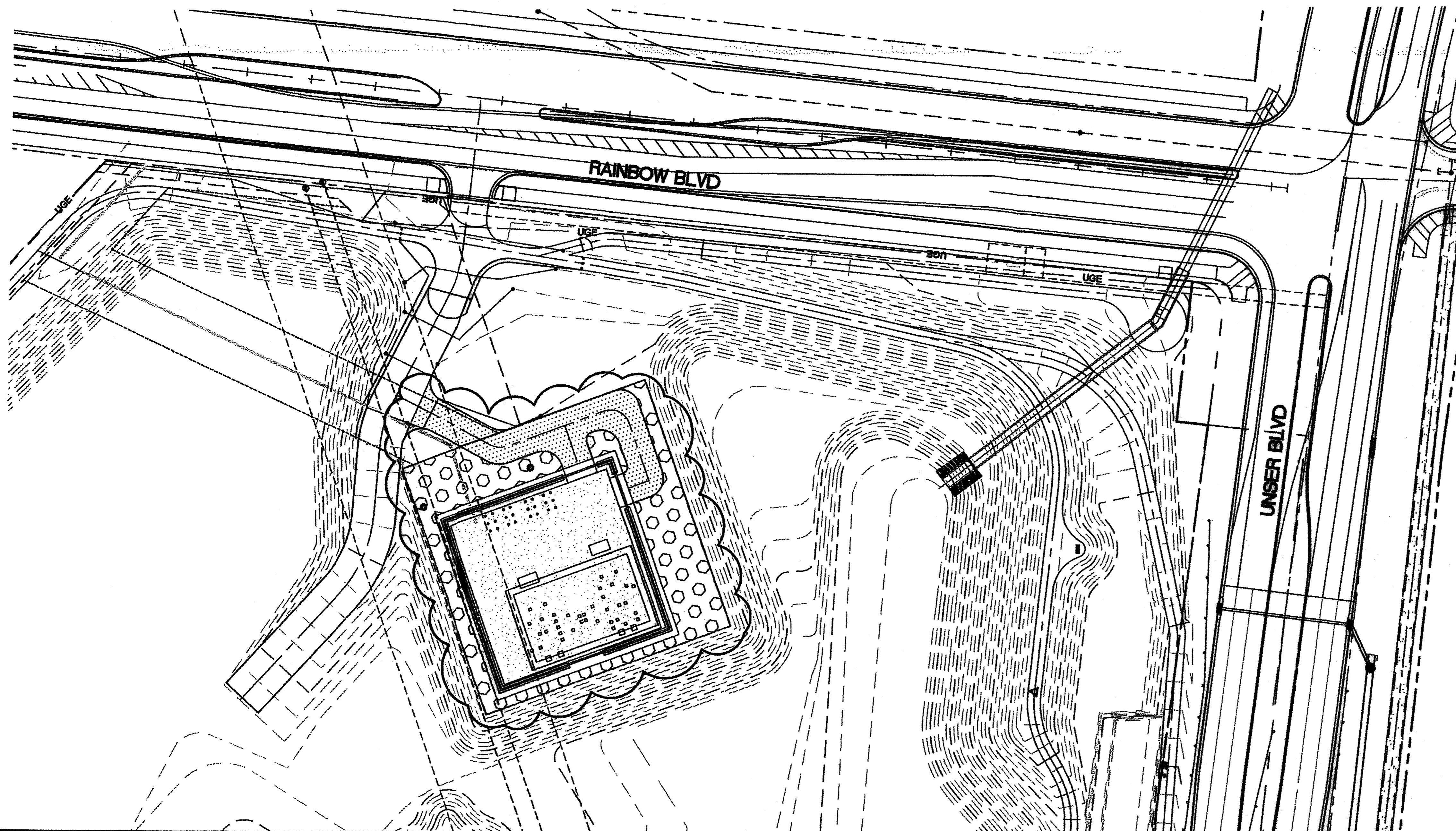

PROPRIETARY STATEMENT

THIS DOCUMENT AND ALL PREVIOUS ISSUES ARE THE PROPERTY OF PUBLIC SERVICE COMPANY OF NEW MEXICO (PSC) AND NEITHER RECEIPT NOR POSSESSION THEREOF IMPARTS OR TRANSFERS ANY RIGHT IN OR LICENSE TO USE THIS DOCUMENT THE SUBJECT MATTER THEREOF OR ANY DESIGN OR TECHNICAL INFORMATION SHOWN THEREON OR ANY RIGHT TO REPRODUCE THIS DOCUMENT OR ANY PART THEREOF. NEITHER THIS DOCUMENT NOR ANY INFORMATION CONTAINED THEREIN MAY BE COPIED, REPRODUCED, OR OTHERWISE USED OR DISCLOSED TO ANY OTHER PARTY WITHOUT FIRST OBTAINING THE EXPRESS WRITTEN PERMISSION OF PSC. THIS DOCUMENT IS PROVIDED UNDER THE EXPRESS CONDITION THAT IT WILL BE HELD IN CONFIDENCE BY THE RECIPIENT, THAT IT IS SUBJECT TO RETURN UPON DEMAND, AND THAT IT WILL NOT BE USED IN ANY WAY DETRIMENTAL TO PSC.

PNM PUBLIC SERVICE COMPANY OF NEW MEXICO

RE-VEGETATION PLAN

UNIT SUBSTATION **SCENIC**

DR:	TR:	DATE:
CKD:	OK:	SCALE:
APP:	ACAD FILE:	USS-18006 2/4
REV. NO.		

2 LANDSCAPING PLAN



REVISION
 NO. DATE BY

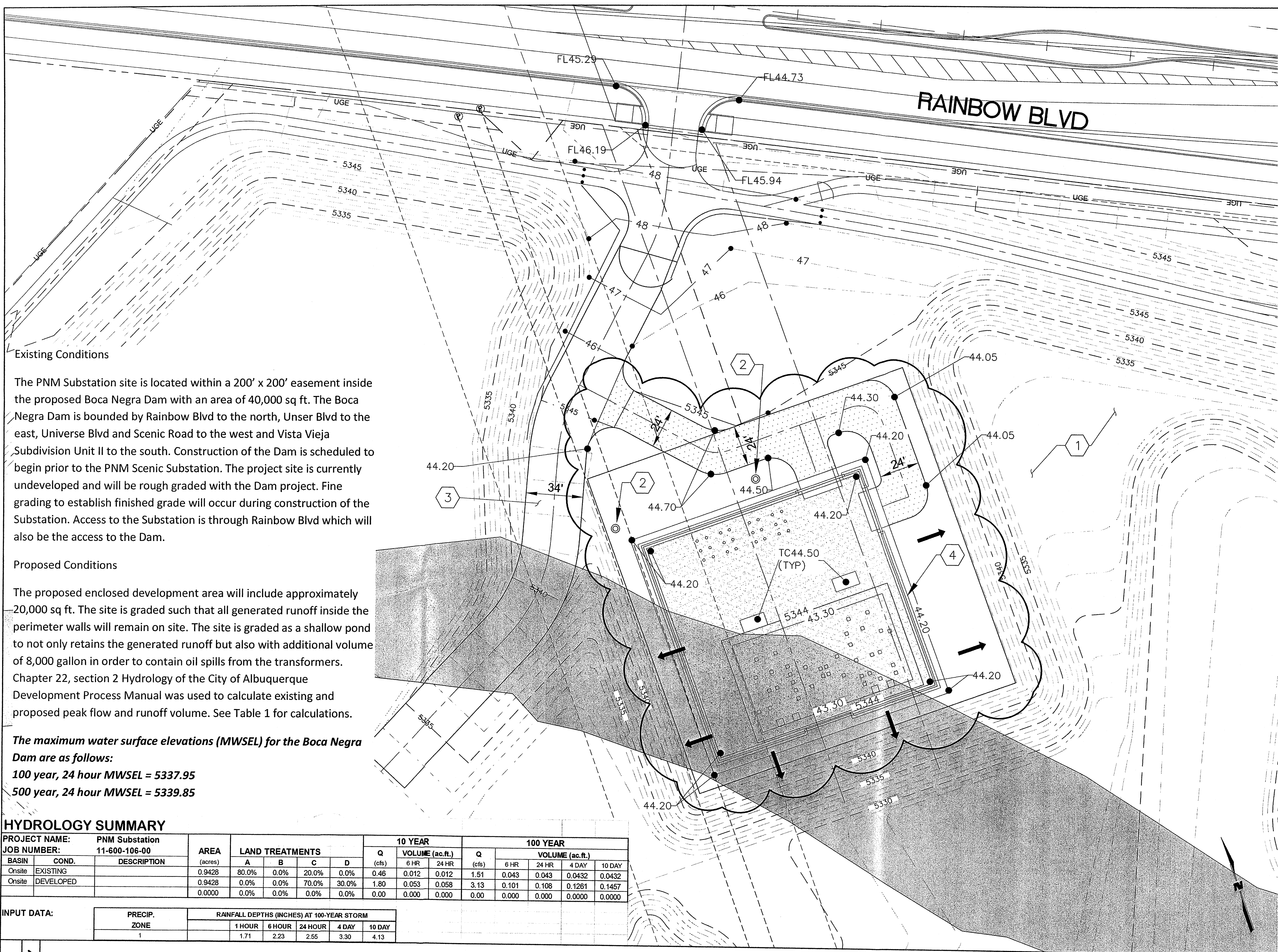

- GENERAL NOTES**
- ALL DESIGN WORK SHALL CONFORM TO PNM STANDARDS & SPECIFICATIONS.
- KEYNOTES**
- SEEDED AREA, PART OF THE BOCA NEGRA DAM, CITY PROJECT NUMBER 781181.
 - TAP STRUCTURE LOCATION.
 - PART OF BOCA NEGRA DAM, CITY PROJECT NUMBER 781181.
 - INSTALL 12' HIGH, 8" THICK CMU WALL.

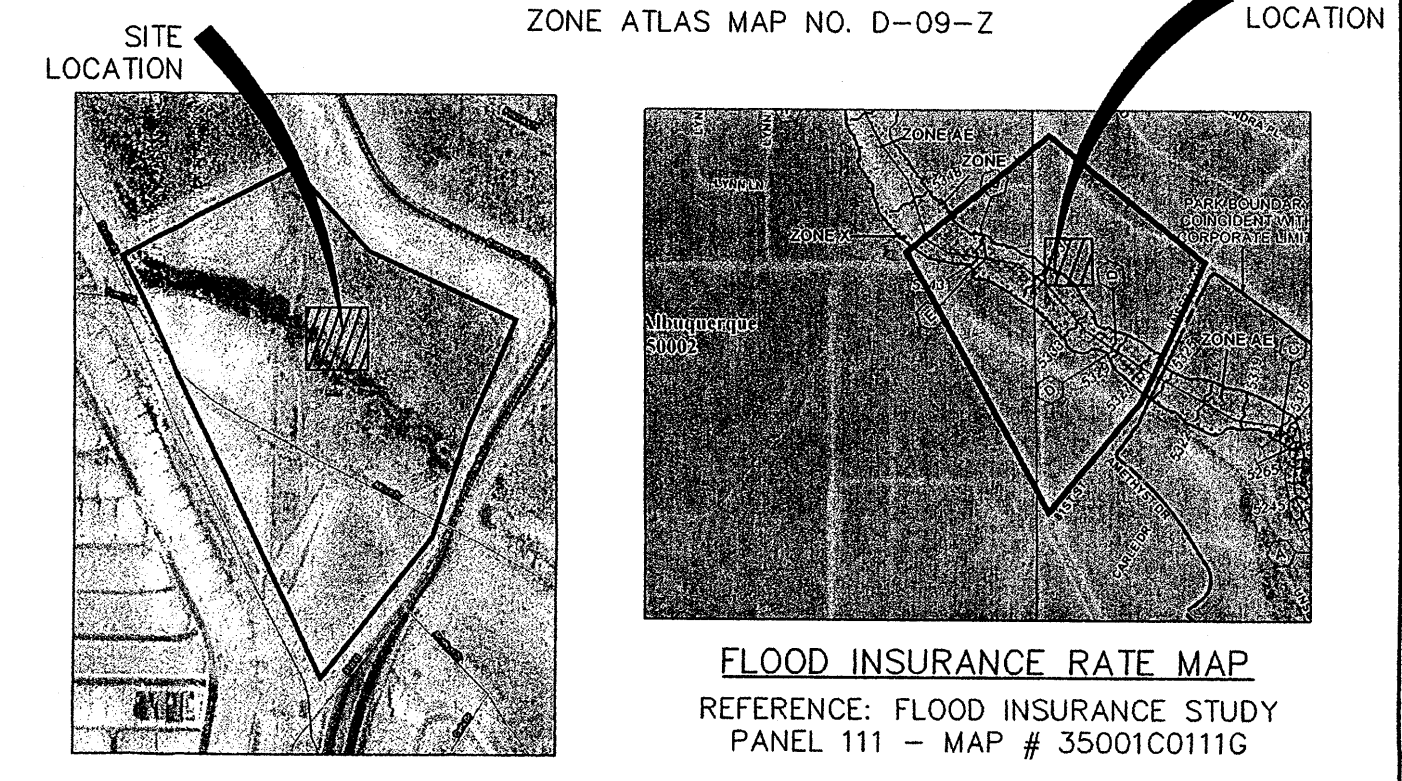
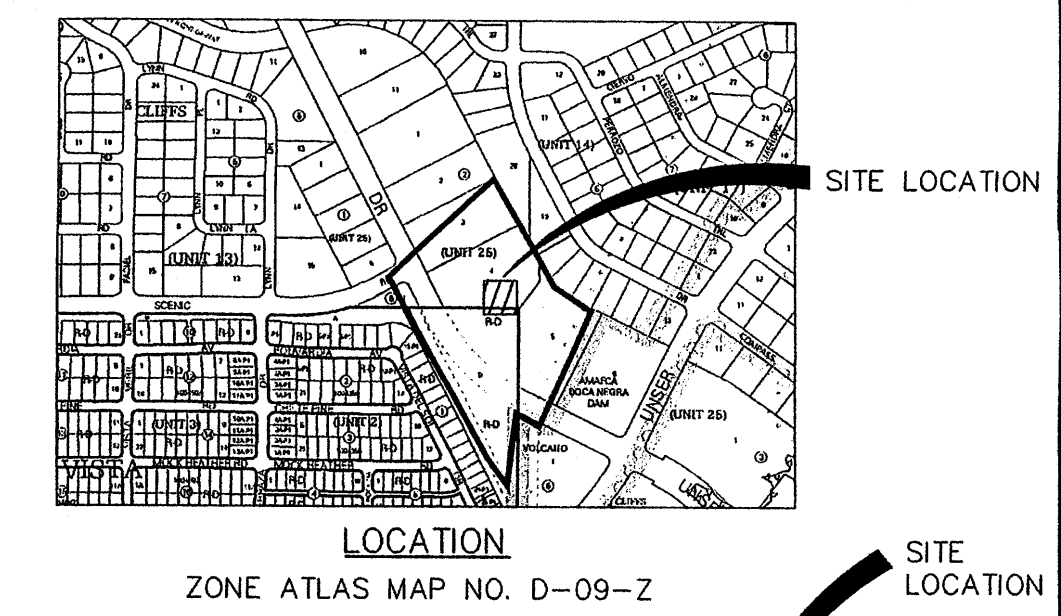

Existing Conditions

The PNM Substation site is located within a 200' x 200' easement inside the proposed Boca Negra Dam with an area of 40,000 sq ft. The Boca Negra Dam is bounded by Rainbow Blvd to the north, Unser Blvd to the east, Universe Blvd and Scenic Road to the west and Vista Vieja Subdivision Unit II to the south. Construction of the Dam is scheduled to begin prior to the PNM Scenic Substation. The project site is currently undeveloped and will be rough graded with the Dam project. Fine grading to establish finished grade will occur during construction of the Substation. Access to the Substation is through Rainbow Blvd which will also be the access to the Dam.

Proposed Conditions

The proposed enclosed development area will include approximately 20,000 sq ft. The site is graded such that all generated runoff inside the perimeter walls will remain on site. The site is graded as a shallow pond to not only retains the generated runoff but also with additional volume of 8,000 gallon in order to contain oil spills from the transformers. Chapter 22, section 2 Hydrology of the City of Albuquerque Development Process Manual was used to calculate existing and proposed peak flow and runoff volume. See Table 1 for calculations.

The maximum water surface elevations (MWSEL) for the Boca Negra Dam are as follows:

100 year, 24 hour MWSEL = 5337.95
 500 year, 24 hour MWSEL = 5339.85

HYDROLOGY SUMMARY

PROJECT NAME: JOB NUMBER:	PNM Substation 11-600-106-00	AREA (acres)	LAND TREATMENTS				10 YEAR				100 YEAR			
			A	B	C	D	Q	VOLUME (ac.ft.)		Q	VOLUME (ac.ft.)			
			Q	6 HR	24 HR	Q	6 HR	24 HR	4 DAY	10 DAY				
Onsite	EXISTING	0.9428	80.0%	0.0%	20.0%	0.0%	0.46	0.012	0.012	1.51	0.043	0.043	0.0432	0.0432
Onsite	DEVELOPED	0.9428	0.0%	0.0%	70.0%	30.0%	1.80	0.053	0.058	3.13	0.101	0.108	0.1261	0.1457
		0.0000	0.0%	0.0%	0.0%	0.0%	0.00	0.000	0.000	0.00	0.000	0.000	0.0000	0.0000

INPUT DATA:

PRECIP. ZONE	RAINFALL DEPTHS (INCHES) AT 100-YEAR STORM				
	1 HOUR	6 HOUR	24 HOUR	4 DAY	10 DAY
1	1.71	2.23	2.55	3.30	4.13

BOCA NEGRA DAM CITY PROJECT NUMBER 781181 AND SAD 228 CITY PROJECT NUMBER 693391 IMPROVEMENTS SHOWN FOR CONTEXT ONLY

- LEGEND**
- 4" CRUSHED STONE
 - 6" GRAVEL BASE COURSE
 - EXISTING FLOOD ZONE AE LIMITS
 - LIMITS OF SCENIC SUBSTATION
 - PROPOSED CONTOUR - MINOR
 - PROPOSED CONTOUR - MAJOR
 - EXISTING CONTOUR - MINOR
 - EXISTING CONTOUR - MAJOR
 - TC TOP OF CONCRETE
 - FL FLOWLINE

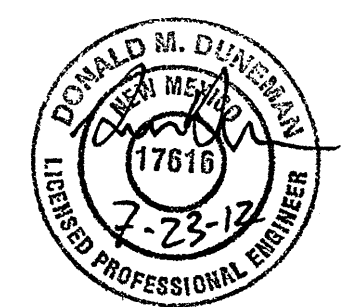

PROPRIETARY STATEMENT

THIS DOCUMENT AND ALL PREVIOUS ISSUES ARE THE PROPERTY OF PUBLIC SERVICE COMPANY OF NEW MEXICO ("PNM") AND NEITHER RECEIPT NOR POSSESSION THEREOF INFERS OR TRANSFERS ANY RIGHT IN OR LICENSE TO USE THIS DOCUMENT THE SUBJECT MATTER THEREOF OR ANY DESIGN OR TECHNICAL INFORMATION SHOWN THEREON OR ANY RIGHT TO REPRODUCE THIS DOCUMENT OR ANY PART THEREOF. NEITHER THIS DOCUMENT NOR ANY INFORMATION CONTAINED THEREIN MAY BE COPIED, REPRODUCED, OR OTHERWISE USED OR DISCLOSED TO ANY OTHER PARTY WITHOUT FIRST OBTAINING THE EXPRESS WRITTEN PERMISSION OF PNM. THIS DOCUMENT IS PROVIDED UNDER THE EXPRESS CONDITION THAT IT WILL BE HELD IN CONFIDENCE BY THE RECIPIENT, THAT IT IS SUBJECT TO RETURN UPON DEMAND, AND THAT IT WILL NOT BE USED IN ANY WAY DETRIMENTAL TO PNM.

PNM PUBLIC SERVICE COMPANY OF NEW MEXICO

GRADING & DRAINAGE PLAN

UNIT SUBSTATION **SCENIC**

DR:	TR:	DATE:
CKD:	OK:	SCALE: 1" = 50'
APP:	ACAD FILE:	USS-18006 3/4
REV. NO.		

REVISION

NO.	DATE	BY
3		

3 GRADING & DRAINAGE PLAN

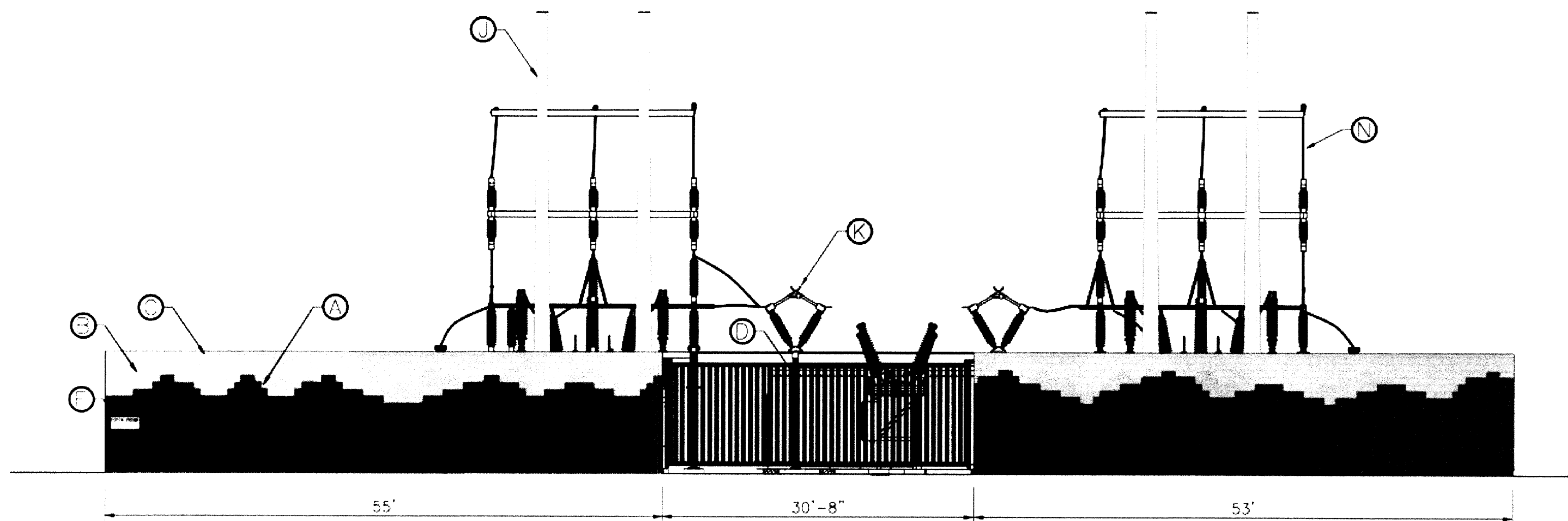

SOUTH ELEVATION

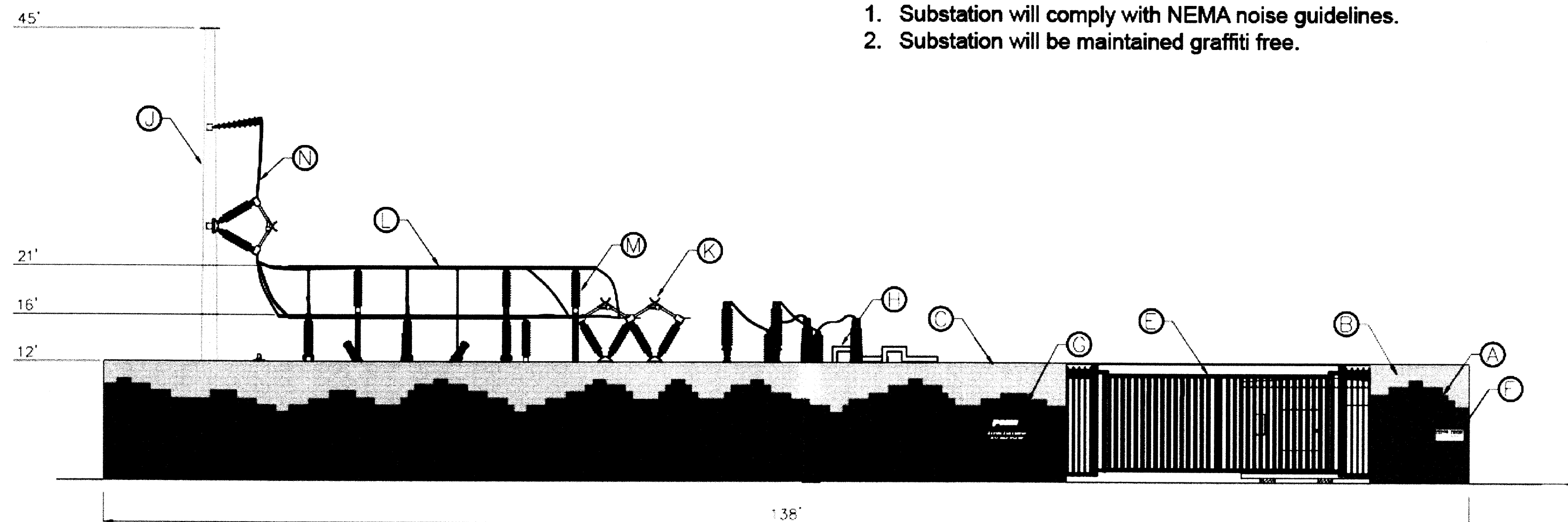

EAST ELEVATION

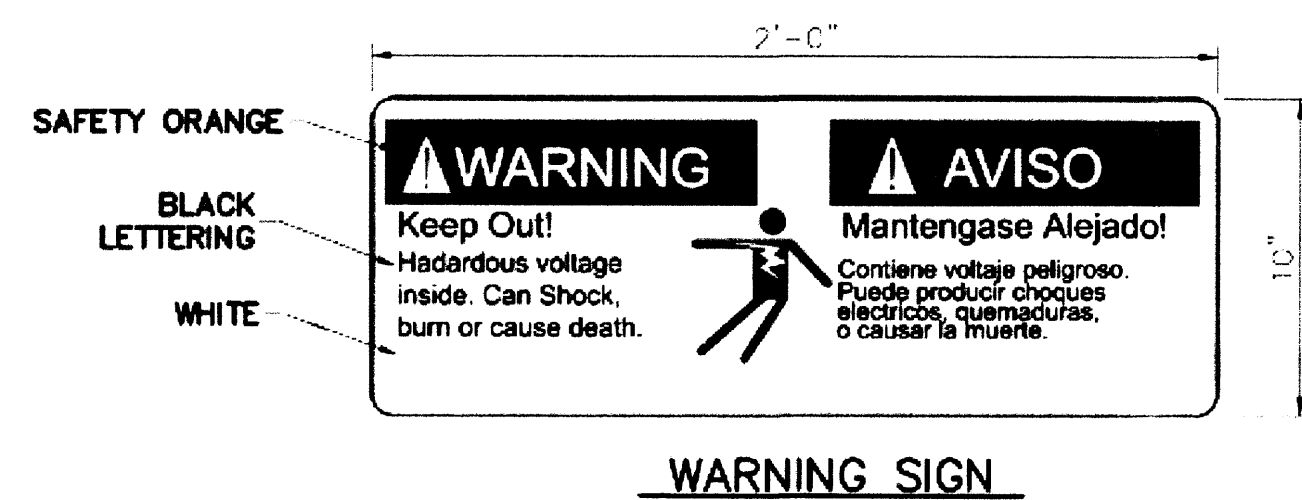

WARNING SIGN

KEYED ITEM	COLOR
(A) SPLIT-FACE BLOCK (CHESTNUT)	EARTH TONE
(B) SMOOTH-FACE BLOCK (ELK HORN)	EARTH TONE
(C) TOP & CAP BLOCK (ELK HORN)	EARTH TONE
(D) STEEL FIXED GRILL	EARTH TONE
(E) STEEL SWING GRILL	EARTH TONE
(F) WARNING SIGN	(SEE DETAIL)
(G) PNM STATION SIGN	PNM COLORS

SPECIFICS	KEYED ITEM	COLOR	COLOR
UTILITY BLOCK CO. INC. #260*	(H) TRANSFORMER	ANSI-70 GREY	NON-REFLECTIVE SURFACE
UTILITY BLOCK CO. INC. #220	(I) DEAD END STRUCTURE	WEATHERED STEEL	NON-REFLECTIVE SURFACE
UTILITY BLOCK CO. INC. #220	(K) V-SWITCH	ANSI-70 GREY	NON-REFLECTIVE SURFACE
PAINTED, BREVITY BROWN SW6068 LRV10	(L) ELECTRIC BUS	ALUMINIUM GREY	NON-REFLECTIVE SURFACE
PAINTED, BREVITY BROWN SW6068 LRV10	(M) BUS INSULATOR	ANSI-70 GREY	NON-REFLECTIVE SURFACE
NON-REFLECTIVE SURFACE	(N) CONNECTION WIRE	ALUMINIUM GREY	NON-REFLECTIVE SURFACE
NON-REFLECTIVE SURFACE			

*LRV unavailable for all utility block descriptors

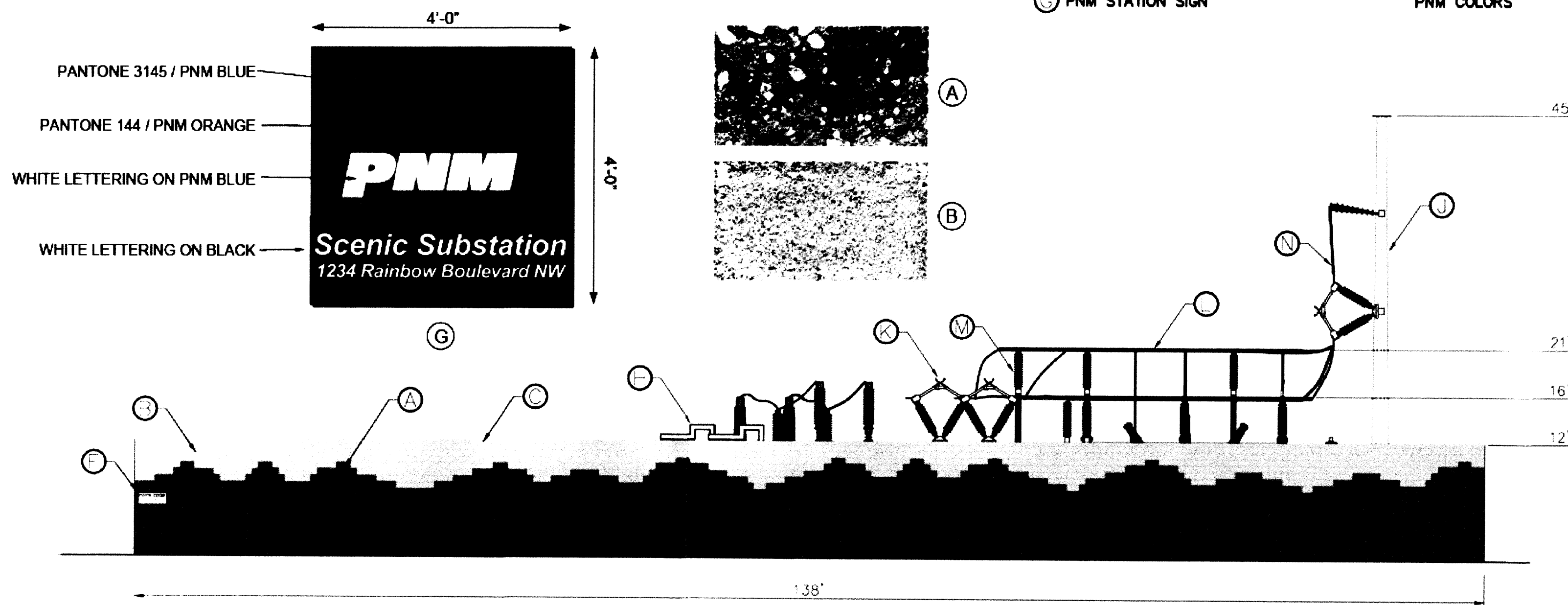

WEST ELEVATION

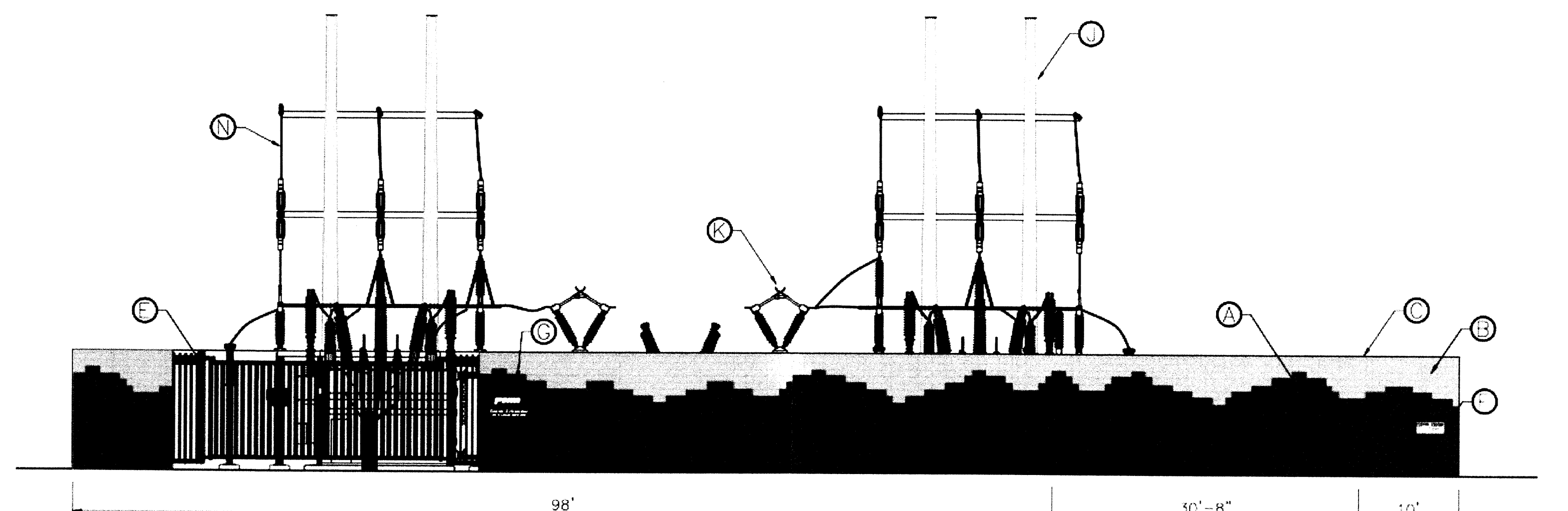

NORTH ELEVATION

REVISION	NO.	DATE	BY
	1	06-15-12	JAE

PROPRIETARY STATEMENT

THIS DOCUMENT AND ALL PREVIOUS ISSUES ARE THE PROPERTY OF PUBLIC SERVICE COMPANY OF NEW MEXICO (PNM) AND NEITHER RECEIPT NOR POSSESSION THEREOF INFERS OR TRANSFERS ANY RIGHT OR LICENSE TO USE THIS DOCUMENT THE SUBJECT MATTER THEREOF OR ANY DESIGN OR TECHNICAL INFORMATION SHOWN THEREON OR ANY RIGHT TO REPRODUCE THIS DOCUMENT OR ANY PART THEREOF. NEITHER THIS DOCUMENT NOR ANY INFORMATION CONTAINED THEREIN MAY BE COPIED, REPRODUCED, OR OTHERWISE USED OR DISCLOSED TO ANY OTHER PARTY WITHOUT FIRST OBTAINING THE EXPRESS WRITTEN PERMISSION OF PNM. THIS DOCUMENT IS PROVIDED UNDER THE EXPRESS CONDITION THAT IT WILL BE HELD IN CONFIDENCE BY THE RECIPIENT, THAT IT IS SUBJECT TO RETURN UPON DEMAND, AND THAT IT WILL NOT BE USED IN ANY WAY DETRIMENTAL TO PNM.

PNM PUBLIC SERVICE COMPANY OF NEW MEXICO

**ELEVATION VIEW
115kV LAYOUT
SCENIC UNIT SUBSTATION**

DR: DK	TR:	DATE: 4/11/12
CKD:	OK:	SCALE: 1"=10'-0"
APP:	ACAD FILE:	USS-18006 4/4
REV. NO.		