



Supplemental Form (SF)

SUBDIVISION

- Major subdivision action
- Minor subdivision action
- Vacation
- Variance (Non-Zoning)

SITE DEVELOPMENT PLAN

- for Subdivision
- for Building Permit
- Administrative Amendment/Approval (AA)
- IP Master Development Plan
- Cert. of Appropriateness (LUCC)

STORM DRAINAGE (Form D)

- Storm Drainage Cost Allocation Plan

S Z ZONING & PLANNING

- Annexation
- Zone Map Amendment (Establish or Change Zoning, includes Zoning within Sector Development Plans)
- Adoption of Rank 2 or 3 Plan or similar
- Text Amendment to Adopted Rank 1, 2 or 3 Plan(s), Zoning Code, or Subd. Regulations

D Street Name Change (Local & Collector)

L A APPEAL / PROTEST of...

- Decision by: DRB, EPC, LUCC, Planning Director, ZEO, ZHE, Board of Appeals, other

PRINT OR TYPE IN BLACK INK ONLY. The applicant or agent must submit the completed application in person to the Planning Department Development Services Center, 600 2nd Street NW, Albuquerque, NM 87102.

Fees must be paid at the time of application. Refer to supplemental forms for submittal requirements.

APPLICATION INFORMATION:

Professional/Agent (if any): Jacks High Country Inc. (Jack Spilman Pres) PHONE: 505-898-3707
 ADDRESS: 8953 2nd NW FAX: 890-0645
 CITY: Albuquerque STATE: NM ZIP: 87119 E-MAIL: _____

APPLICANT: Manuel G. Chavez PHONE: _____
 ADDRESS: 109 Garfield SE. FAX: _____
 CITY: Albuquerque STATE: NM ZIP: 87102 E-MAIL: _____
 Proprietary interest in site: _____ List all owners: _____

DESCRIPTION OF REQUEST: We wish to divide Tract A into two tracts and grant any easements as shown.

Is the applicant seeking incentives pursuant to the Family Housing Development Program? Yes No.

SITE INFORMATION: ACCURACY OF THE EXISTING LEGAL DESCRIPTION IS CRUCIAL! ATTACH A SEPARATE SHEET IF NECESSARY.

Lot or Tract No. Tract lettered "A" Block: _____ Unit: _____
 Subdiv. Add. IDKA: Sec. 29, Twshp 10 North, Range 3 East
 Existing Zoning: MR Proposed zoning: MR MRGCD Map No. _____
 Zone Atlas page(s): L-14 UPC Code: 1 014 056 248 499 14217

CASE HISTORY:

List any current or prior case number that may be relevant to your application (Proj., App., DRB-, AX-, Z-, V-, S-, etc.): _____

CASE INFORMATION:

Within city limits? Yes Within 1000FT of a landfill? NO
 No. of existing lots: one No. of proposed lots: two Total site area (acres): 0.2323
 LOCATION OF PROPERTY BY STREETS: On or Near: Commercial SE
 Between: Lewis SE and John SE
 Check if project was previously reviewed by: Sketch Plat/Plan or Pre-application Review Team(PRT) Review Date: _____

SIGNATURE Jack A. Spilman DATE June 26 2012
 (Print Name) Jack Spilman Applicant: Agent:

FOR OFFICIAL USE ONLY

Revised: 6/2011

INTERNAL ROUTING	Application case numbers	Action	S.F.	Fees
<input checked="" type="checkbox"/> All checklists are complete	<u>12 DRB - 70180</u>	<u>SP</u>	_____	\$ <u>0</u>
<input checked="" type="checkbox"/> All fees have been collected	_____	_____	_____	\$ _____
<input checked="" type="checkbox"/> All case #s are assigned	_____	_____	_____	\$ _____
<input checked="" type="checkbox"/> AGIS copy has been sent	_____	_____	_____	\$ _____
<input type="checkbox"/> Case history #s are listed	_____	_____	_____	\$ _____
<input type="checkbox"/> Site is within 1000ft of a landfill	_____	_____	_____	\$ _____
<input type="checkbox"/> F.H.D.P. density bonus	_____	_____	_____	Total
<input type="checkbox"/> F.H.D.P. fee rebate	_____	_____	_____	\$ <u>0</u>

Hearing date July 11, 2012
6-26-12 Project # 1009321
 Staff signature & Date

FORM S(3): SUBDIVISION - D.R.B. MEETING (UNADVERTISED) OR INTERNAL ROUTING

A **Bulk Land Variance** requires application on FORM-V in addition to application for subdivision on FORM-S.

SKETCH PLAT REVIEW AND COMMENT (DRB22) **Your attendance is required.**

- Scale drawing of the proposed subdivision plat (folded to fit into an 8.5" by 14" pocket) **6 copies**
- Site sketch with measurements showing structures, parking, Bldg. setbacks, adjacent rights-of-way and street improvements, if there is any existing land use (folded to fit into an 8.5" by 14" pocket) **6 copies**
- Zone Atlas map with the entire property(ies) clearly outlined
- Letter briefly describing, explaining, and justifying the request
- List any original and/or related file numbers on the cover application

EXTENSION OF MAJOR PRELIMINARY PLAT (DRB08) **Your attendance is required.**

- Preliminary Plat reduced to 8.5" x 11"
 - Zone Atlas map with the entire property(ies) clearly outlined
 - Letter briefly describing, explaining, and justifying the request
 - Copy of DRB approved infrastructure list
 - Copy of the LATEST Official DRB Notice of approval for Preliminary Plat Extension request
 - List any original and/or related file numbers on the cover application
- Extension of preliminary plat approval expires after one year.**

MAJOR SUBDIVISION FINAL PLAT APPROVAL (DRB12) **Your attendance is required.**

- Proposed Final Plat (folded to fit into an 8.5" by 14" pocket) **6 copies**
- Signed & recorded Final Pre-Development Facilities Fee Agreement for **Residential** development only
- Design elevations & cross sections of perimeter walls **3 copies**
- Zone Atlas map with the entire property(ies) clearly outlined
- Bring original Mylar of plat to meeting, ensure property owner's and City Surveyor's signatures are on the plat
- Copy of recorded SIA
- Landfill disclosure and EHD signature line on the Mylar if property is within a landfill buffer
- List any original and/or related file numbers on the cover application
- DXF file and hard copy of final plat data for AGIS is required.

MINOR SUBDIVISION PRELIMINARY/FINAL PLAT APPROVAL (DRB16) **Your attendance is required.**

- 5 Acres or more: Certificate of No Effect or Approval
- Proposed Preliminary / Final Plat (folded to fit into an 8.5" by 14" pocket) **6 copies** for unadvertised meetings ensure property owner's and City Surveyor's signatures are on the plat prior to submittal
- Signed & recorded Final Pre-Development Facilities Fee Agreement for **Residential** development only
- Design elevations and cross sections of perimeter walls (11" by 17" maximum) **3 copies**
- Site sketch with measurements showing structures, parking, Bldg. setbacks, adjacent rights-of-way and street improvements, if there is any existing land use (folded to fit into an 8.5" by 14" pocket) **6 copies**
- Zone Atlas map with the entire property(ies) clearly outlined
- Letter briefly describing, explaining, and justifying the request
- Bring original Mylar of plat to meeting, ensure property owner's and City Surveyor's signatures are on the plat
- Landfill disclosure and EHD signature line on the Mylar if property is within a landfill buffer
- Fee (see schedule)
- List any original and/or related file numbers on the cover application
- Infrastructure list if required (**verify with DRB Engineer**)
- DXF file and hard copy of final plat data for AGIS is required.

AMENDMENT TO PRELIMINARY PLAT (with minor changes) (DRB03) **Your attendance is required.**

- PLEASE NOTE: There are no clear distinctions between significant and minor changes with regard to subdivision amendments. Significant changes are those deemed by the DRB to require public notice and public hearing.
- Proposed Amended Preliminary Plat, Infrastructure List, and/or Grading Plan (folded to fit into an 8.5" by 14" pocket) **6 copies**
 - Original Preliminary Plat, Infrastructure List, and/or Grading Plan (folded to fit into an 8.5" by 14" pocket) **6 copies**
 - Zone Atlas map with the entire property(ies) clearly outlined
 - Letter briefly describing, explaining, and justifying the request
 - Bring original Mylar of plat to meeting, ensure property owner's and City Surveyor's signatures are on the plat
 - List any original and/or related file numbers on the cover application
- Amended preliminary plat approval expires after one year**

I, the applicant, acknowledge that any information required but not submitted with this application will likely result in deferral of actions.

Jack Spilman
Applicant name (print)
Jack A. Spilman 6/26/12
Applicant signature / date



Form revised **October 2007**

- Checklists complete
 - Fees collected
 - Case #s assigned
 - Related #s listed
- Application case numbers
12-DRB-70180

[Signature] 6-26-12
Planner signature / date
Project # 1009321

Jack's High Country, Inc.
8953 Second Street, N.W.
Albuquerque, New Mexico 87114

TO; CITY OF ALBUQUERQUE, DEVELOPMENT REVIEW BOARD

RE; TRACT LETTERED 'A' SECTION 29, TOWNSHIP 10 NORTH, RANGE 3
EAST, BERNALILLO COUNTY, NEW MEXICO

SUBJECT: THE PURPOSE OF THIS PLAT IS TO DIVIDE TRACT A INTO 2
TRACTS AND GRANT ANY EASEMENTS AS SHOWN.

CHAVEZ ,M

JUNE 26, 2012

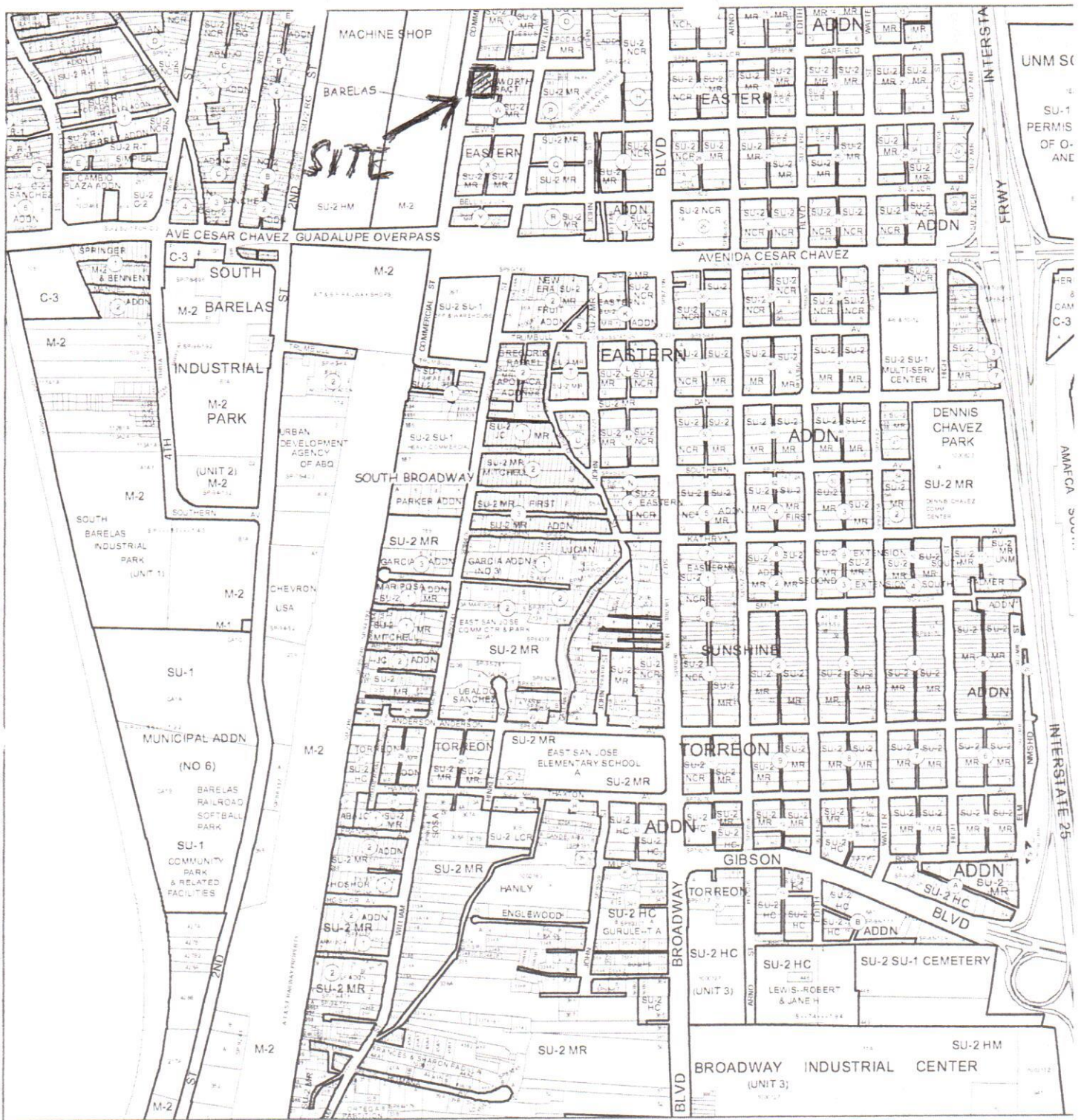

For more current information and more details visit: <http://www.cabq.gov/gis>

