

CERTIFIED MAIL
RETURN RECEIPT REQUESTED

July 21, 2016

Blake Thompson
3009 Palo Alto NE
Albuquerque, NM 87111

Re: Bulk Land Variance for Montecito Vistas Units 1-3

Dear Mr. Thompson:

The City of Albuquerque's Office of Neighborhood Coordination has informed us that you are a representative of the VOLCANO CLIFFS PROPERTY OWNERS ASSOCIATION.

This letter is to advise you that Bohannon Huston, Inc., agent for Victory Land, LLC, is seeking approval for a Bulk Land Variance for Montecito Vistas Units 1 through 3. See the attached Zone Atlas Page for the project location.

Please feel free to contact me if you have any questions regarding this matter or need information as to the date and time of the public hearing.

Sincerely,



Scott J. Steffen, P.E.
Vice President
Community Development and Planning Group

Enclosure

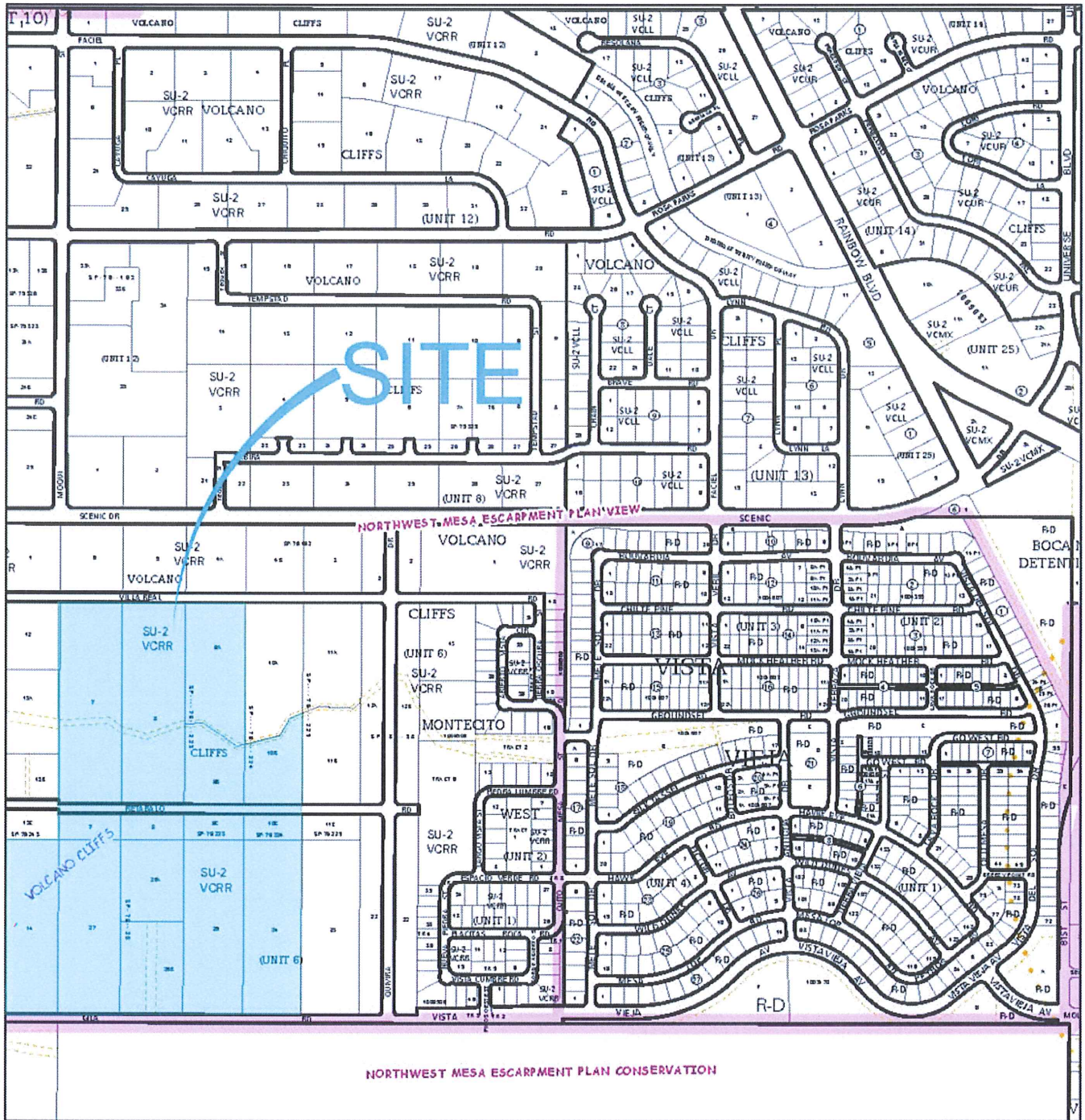

For more current information and details visit <http://www.cabq.gov/gis>

Map amended through: 1/28/2016

Note: Grey Shading Represents Area Outside of the City Limits

Zone Atlas Page:
D-09-Z

Selected Symbols

- SECTOR PLANS
- Design Overlay Zones
- City Historic Zones
- H-1 Buffer Zone
- Escarpment
- 2 Mile Airport Zone
- Airport Noise Contours
- Wall Overlay Zone
- Petroglyph Mon.

0 750 1,500 Feet

CERTIFIED MAIL
RETURN RECEIPT REQUESTED

voice: 505.823.1000
facsimile: 505.798.7988
toll free: 800.877.5332

July 21, 2016

Ralph Davis
5612 Popo Dr. NW
Albuquerque, NM 87120

Re: Bulk Land Variance for Montecito Vistas Units 1-3

Dear Mr. Davis:

The City of Albuquerque's Office of Neighborhood Coordination has informed us that you are a representative of the VOLCANO CLIFFS PROPERTY OWNERS ASSOCIATION.

This letter is to advise you that Bohannon Huston, Inc., agent for Victory Land, LLC, is seeking approval for a Bulk Land Variance for Montecito Vistas Units 1 through 3. See the attached Zone Atlas Page for the project location.

Please feel free to contact me if you have any questions regarding this matter or need information as to the date and time of the public hearing.

Sincerely,



Scott J. Steffen, P.E.
Vice President
Community Development and Planning Group

Enclosure

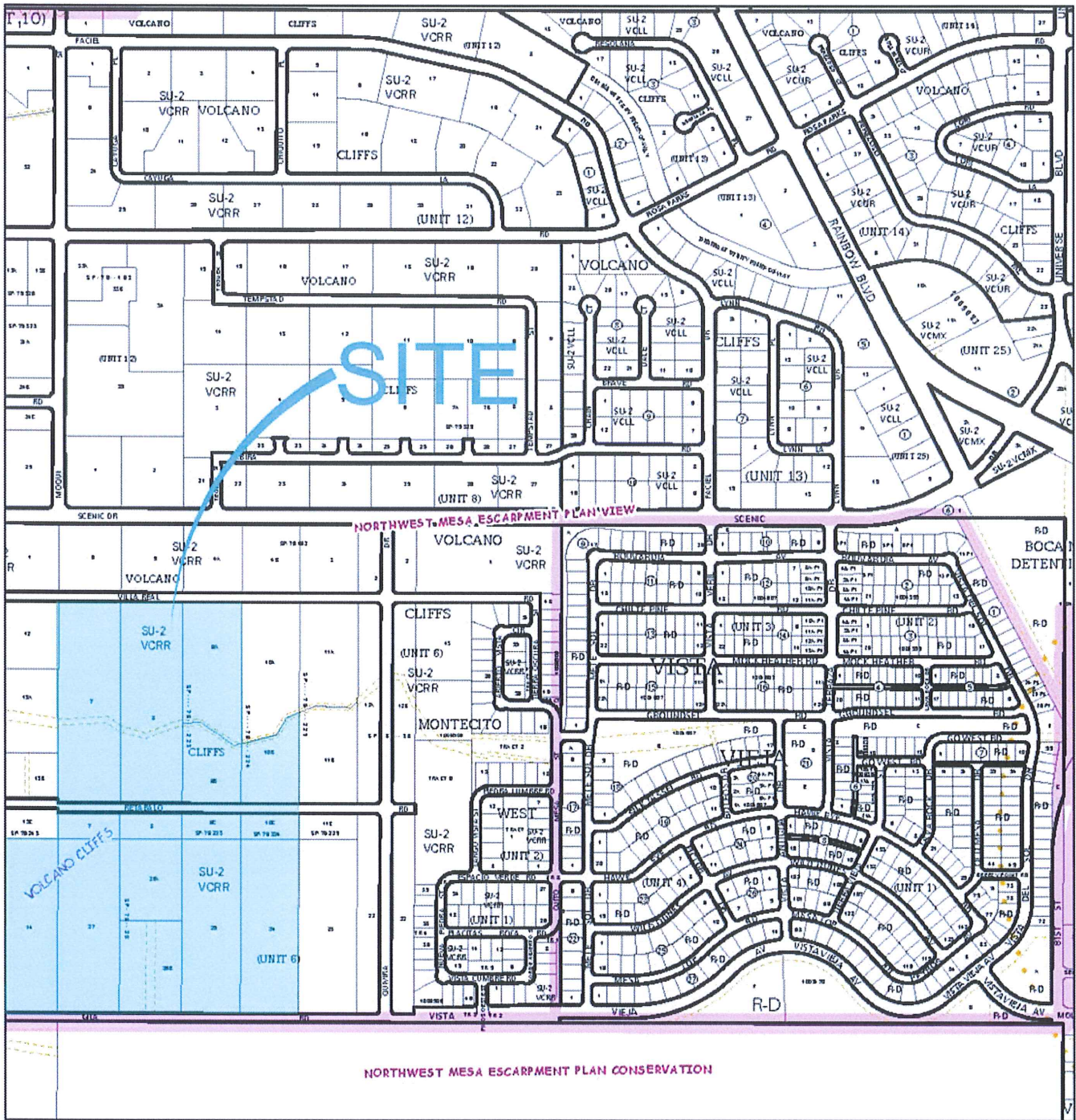

For more current information and details visit <http://www.cabq.gov/gis>

AGIS
Albuquerque Geographic Information System

Note: Grey Shading Represents Area Outside of the City Limits

Zone Atlas Page:
D-09-Z

Selected Symbols

- SECTOR PLANS
- Escarpment
- Design Overlay Zones
- 2 Mile Airport Zone
- City Historic Zones
- Airport Noise Contours
- H-1 Buffer Zone
- Wall Overlay Zone
- Petroglyph Mon.

0 750 1,500 Feet

Map amended through: 1/28/2016

7010 1870 0000 2738 5139

PLACE STICKER AT TOP OF ENVELOPE TO THE RIGHT OF THE RETURN ADDRESS. FOLD AT DOTTED LINE.

CERTIFIED MAIL™

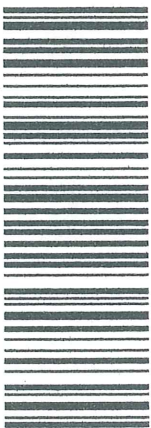

7010 1870 0000 2738 5139
7010 1870 0000 2738 5139

U.S. Postal Service™
CERTIFIED MAIL™ RECEIPT
(Domestic Mail Only; No Insurance Coverage Provided)

For delivery information visit our website at www.usps.com®

OFFICIAL USE

Postage	\$
Certified Fee	
Return Receipt Fee (Endorsement Required)	
Restricted Delivery Fee (Endorsement Required)	
Total Postage & Fees	\$

Postmark
Here

Sent To **BLAKE THOMPSON**
 Street, Apt. No., or PO Box No. **3009 PALO ALTO NE**
 City, State, ZIP+4 **ALBUQUERQUE, NM 87111**

PS Form 3800, August 2006

See Reverse for Instructions

SENDER: COMPLETE THIS SECTION

- Complete items 1, 2, and 3. Also complete item 4 if Restricted Delivery is desired.
- Print your name and address on the reverse so that we can return the card to you.
- Attach this card to the back of the mailpiece, or on the front if space permits.

1. Article Addressed to:

**BLAKE THOMPSON
3009 PALO ALTO NE
ALBUQUERQUE, NM 87111**

2. Article Number
(Transfer from service label)

PS Form 3811, February 2004

Domestic Return Receipt

102595-02-M-1540

COMPLETE THIS SECTION ON DELIVERY

- A. Signature Agent Addressee
- X**
- B. Received by (Printed Name) C. Date of Delivery
- D. Is delivery address different from item 1? Yes No
If YES, enter delivery address below:

3. Service Type
- Certified Mail Express Mail
- Registered Return Receipt for Merchandise
- Insured Mail C.O.D.
4. Restricted Delivery? (Extra Fee) Yes No

Blake Thompson
3009 Palo Alto NE
Albuquerque, NM 87111

Courtyard 1
7500 Jefferson St. NE
Albuquerque, NM
87109-4335

Ralph Davis
5612 Popo Dr. NW
Albuquerque, NM 87120

SENDER: COMPLETE THIS SECTION

- Complete items 1, 2, and 3. Also complete item 4 if Restricted Delivery is desired.
- Print your name and address on the reverse so that we can return the card to you.
- Attach this card to the back of the mailpiece, or on the front if space permits.

1. Article Addressed to:

Ralph Davis
5612 Popo Dr. NW
Albuquerque, NM 87120

COMPLETE THIS SECTION ON DELIVERY

A. Signature
X

B. Received by (Printed Name)

D. Is delivery address different from item 1?
If YES, enter delivery address below: Yes No

3. Service Type

- Certified Mail
- Registered
- Insured Mail
- Express Mail
- Return Receipt for Merchandise
- C.O.D.

4. Restricted Delivery? (Extra Fee) Yes

2. Article Number

(Transfer from service label)

7010 1870 0000 2738 5368

PS Form 3811, February 2004

Domestic Return Receipt

102595-02-M-1540

U.S. Postal Service TM
CERTIFIED MAIL TM RECEIPT
(Domestic Mail Only; No Insurance Coverage Provided)

For delivery information visit our website at www.usps.com

OFFICIAL USE

Postage	\$
Certified Fee	
Return Receipt Fee (Endorsement Required)	
Restricted Delivery Fee (Endorsement Required)	
Total Postage & Fees	\$

Postmark
Here

Sent To **Ralph Davis**
Street, Apt. No.,
or PO Box No. **5612 Popo Drive NW**
City, State, ZIP+4 **ALBUQUERQUE, NM 87120**

PS Form 3800, August 2006

See Reverse for Instructions

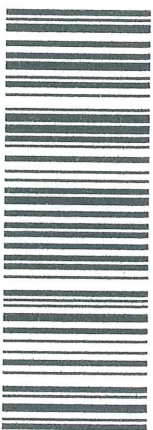

PLACE STICKER AT TOP OF ENVELOPE TO THE RIGHT OF THE RETURN ADDRESS, FOLD AT DOTTED LINE

CERTIFIED MAIL TM

99E5 9E22 0000 029T 0T02
99E5 9E22 0000 029T 0T02

PERFECTLY LEGAL INC
5659 JEFFERSON ST
NE STE A
ALBUQUERQUE, NM 87109
1 505 346 8211

Merchant ID:
Term ID:
Staff #: 2

Sale

VISA-PURCH

*****4035

Entry Method: Swiped

Apprvd: Online

Batch#: 000148

07/20/16

15:12:24

Ref #: 62026948450
Host Response: Approved

Invoice #: 000023

Appr Code: 549366

Apriva Transaction #: 5206

Amount: \$ 12.94

Tax: \$ 0.00

Total: \$ 12.94

Cust #: 0

Customer Copy

Perfectly Legal

5659 Jefferson St NE Ste A

Albuquerque, NM, 87109-3403

340128-B001

07/20/2016

04:22:42 PM

----- Sales Receipt -----

Product	Sale	Final
Description	Qty	Price

First-Class Letter	1	\$0.47
--------------------	---	--------

(Expected Delivery Day: Fri 07/22)

(ALBUQUERQUE, NM 87120)

(Weight:0 Lb 0.65 Oz)

Certified	1	\$3.30
-----------	---	--------

(@@USPS Certified Mail #)

(7010187000027385368)

Return Rcpt	1	\$2.70
-------------	---	--------

(@@USPS Return Rcpt #)

(9590952106150019323587)

First-Class Letter	1	\$0.47
--------------------	---	--------

(Expected Delivery Day: Fri 07/22)

(ALBUQUERQUE, NM 87111)

(Weight:0 Lb 0.65 Oz)

Certified	1	\$3.30
-----------	---	--------

(@@USPS Certified Mail #)

(7010187000027385139)

Return Rcpt	1	\$2.70
-------------	---	--------

(@@USPS Return Rcpt #)

(9590952106150019323570)

Total		\$12.94
-------	--	---------

Credit Card		\$12.94
-------------	--	---------

@@For tracking or inquiries go to USPS.com
or call 1-800-222-1811.

Thank you!

Bill#: 1-14187-1-2522496-2

Clerk: CAT

All sales final on stamps and postage.

7010 1870 0000 2738 5138

U.S. Postal Service™
CERTIFIED MAIL™ RECEIPT
(Domestic Mail Only; No Insurance Coverage Provided)
For delivery information visit our website at www.usps.com

OFFICIAL USE

Postage	\$	
Certified Fee		JUL 20 2016
Return Receipt Fee (Endorsement Required)		
Restricted Delivery Fee (Endorsement Required)		
Total Postage & Fees	\$	

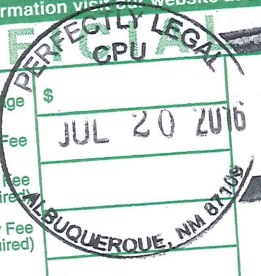

Sent To **BLAKE THOMPSON**
 Street, Apt. No., or PO Box No. **3009 PALO ALTO NE**
 City, State, ZIP+4 **ALBUQUERQUE, NM 87111**

See Reverse for Instructions
PS Form 3800, August 2006

7010 1870 0000 2738 5368

U.S. Postal Service™
CERTIFIED MAIL™ RECEIPT
(Domestic Mail Only; No Insurance Coverage Provided)
For delivery information visit our website at www.usps.com

OFFICIAL USE

Postage	\$	
Certified Fee		JUL 20 2016
Return Receipt Fee (Endorsement Required)		
Restricted Delivery Fee (Endorsement Required)		
Total Postage & Fees	\$	

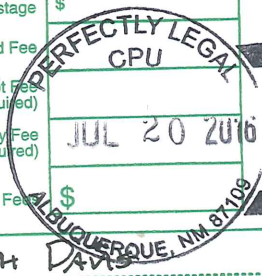

Sent To **RALPH DAVIS**
 Street, Apt. No., or PO Box No. **5612 PO Box Drive NW**
 City, State, ZIP+4 **ALBUQUERQUE, NM 87120**

See Reverse for Instructions
PS Form 3800, August 2006