

NOTICE TO CONTRACTORS

1. AN EXCAVATION/CONSTRUCTION PERMIT WILL BE REQUIRED BEFORE BEGINNING ANY WORK WITHIN BERNALILLO COUNTY ROW. AN APPROVED COPY OF THESE PLANS MUST BE SUBMITTED AT THE TIME OF CITY OF ALBUQUERQUE APPLICATION FOR THIS PERMIT.
2. ALL WORK DETAILED ON THESE PLANS TO BE PERFORMED, EXCEPT AS OTHERWISE STATED OR PROVIDED HEREON, SHALL BE CONSTRUCTED IN ACCORDANCE WITH BERNALILLO COUNTY INTERIM STANDARD SPECIFICATIONS FOR PUBLIC WORKS CONSTRUCTION, 1986, INCLUDING UPDATE #8.
3. TWO WORKING DAYS PRIOR TO ANY EXCAVATION, CONTRACTOR MUST CONTACT LINE LOCATING SERVICE, 260-1990, FOR LOCATION OF EXISTING UTILITIES.
4. PRIOR TO CONSTRUCTION, THE CONTRACTOR SHALL EXCAVATE AND VERIFY THE HORIZONTAL AND VERTICAL LOCATIONS OF ALL PERTINENT EXISTING UTILITIES, AND/OR OBSTRUCTIONS. SHOULD A CONFLICT EXIST, THE CONTRACTOR SHALL NOTIFY THE ENGINEER SO THAT THE CONFLICT CAN BE RESOLVED WITH A MINIMUM AMOUNT OF DELAY.
5. BACKFILL COMPACTION SHALL BE ACCORDING TO ARTERIAL STREET USE FOR ALL WORK.
6. MAINTENANCE OF THESE FACILITIES SHALL BE THE RESPONSIBILITY OF THE OWNER OF THE PROPERTY SERVED.
7. WORK ON ARTERIAL STREETS SHALL BE PERFORMED ON A 24-HOUR BASIS.
8. CONTRACTOR SHALL DETERMINE LOCATION OF ANY UNDERGROUND FACILITY IN OR NEAR WORK AREAS, INCLUDING REQUESTS TO OWNERS/OPERATORS OF SAID FACILITIES PER SECTION 62-14-5 NMSA 1978.
9. CONTRACTOR SHALL PLAN ALL EXCAVATION TO MINIMIZE INTERFERENCE OR DAMAGE OF UNDERGROUND FACILITIES.
10. CONTRACTOR SHALL PROVIDE ADVANCE TELEPHONE NOTICE OF COMMENCEMENT, EXTENT AND DURATION OF ALL EXCAVATION WORK TO THE ONE-CALL NOTIFICATION SYSTEM, OR TO OWNERS/OPERATORS OF ANY EXISTING UNDERGROUND FACILITY IN OR NEAR THE EXCAVATION AREA THAT ARE NOT MEMBERS OF THE ONE-CALL NOTIFICATION CENTER; IN ORDER THAT OWNERS/OPERATORS MAY LOCATE AND MARK UNDERGROUND FACILITY PER SECTION 62-14-5 NMSA 1978 PRIOR TO ANY COMMENCEMENT OF WORK. CONTRACTOR SHALL REQUEST REAFFIRMATION OF LOCATION EVERY TEN (10) WORKING DAYS AFTER INITIAL REQUEST.
11. CONTRACTOR SHALL MAINTAIN EIGHTEEN (18) INCHES BETWEEN EXISTING UNDERGROUND FACILITIES THAT HAVE BEEN PREVIOUSLY IDENTIFIED AND MARKED BY THE OWNERS/OPERATORS OF SAID FACILITIES. CUTTING EDGE OR POINT OF ANY MECHANICAL EXCAVATING EQUIPMENT UTILIZED IN EXCAVATION AREA WILL BE USED IN A MANNER NECESSARY TO PREVENT DAMAGE TO EXISTING UNDERGROUND FACILITIES.
12. CONTRACTOR SHALL PROVIDE SUPPORT FOR EXISTING UNDERGROUND FACILITIES IN OR NEAR EXCAVATION AREA AS NECESSARY TO PREVENT DAMAGE TO SAID FACILITIES.
13. CONTRACTOR SHALL BACKFILL ALL EXCAVATIONS IN A MANNER AND WITH MATERIALS AS MAY BE NECESSARY TO PREVENT DAMAGE TO AND PROVIDE RELIABLE SUPPORT DURING AND FOLLOWING BACK FILLING ACTIVITIES FOR PREEXISTING UNDERGROUND FACILITIES IN OR NEAR EXCAVATION AREA.
14. CONTRACTOR SHALL IMMEDIATELY NOTIFY BY TELEPHONE THE OWNER/OPERATOR OF ANY UNDERGROUND FACILITY WHICH MAY HAVE BEEN DAMAGED OR DISLODGED DURING EXCAVATION WORK.
15. CONTRACTOR SHALL NOT MOVE OR OBLITERATE MARKINGS MADE PURSUANT TO CHAPTER 62, ARTICLE 14 NMSA 1978, OR FABRICATE MARKINGS IN A UNMARKED LOCATION FOR THE PURPOSE OF CONCEALING OR AVOIDING LIABILITY FOR VIOLATION OF OR NONCOMPLIANCE WITH THE PROVISIONS OF CHAPTER 62, ARTICLE 11 NMSA 1978.
16. ELECTRONIC MARKER SPHERES (EMS) SHALL BE INSTALLED ON WATER LINE AND SANITARY SEWER LINE FACILITIES PER SECTION 170 OF THE BERNALILLO COUNTY STANDARD SPECIFICATIONS 1986 EDITION AS REVISED THROUGH UPDATE #8, AMENDMENT 1.
17. THE CONTRACTOR SHALL COORDINATE WITH THE WATER UTILITY AUTHORITY SEVEN (7) DAYS IN ADVANCE OF PERFORMING WORK THAT WILL AFFECT THE PUBLIC WATER OR SANITARY SEWER INFRASTRUCTURE. WORK REQUIRING SHUTOFF OF FACILITIES DESIGNATED AS MASTER PLAN FACILITIES MUST BE COORDINATED WITH THE WATER AUTHORITY 14 DAYS IN ADVANCE OF PERFORMING SUCH WORK. ONLY WATER AUTHORITY CREWS ARE AUTHORIZED TO OPERATE PUBLIC VALVES. SHUTOFF REQUESTS MUST BE MADE ONLINE AT http://abcwua.org/water_shut_off_and_turn_on_procedures
18. ALL EXCAVATION, TRENCHING AND SHORING ACTIVITIES MUST BE CARRIED-OUT IN ACCORDANCE WITH OSHA 29 CFR 1926.6150 SUBPART F.
19. ALL IMPACTED STRIPING SHALL BE REPLACED BY CONTRACTOR.
20. MANHOLE STEPS SHALL NOT BE INSTALLED IN SANITARY SEWER MANHOLES.
21. ALL WATER METERS SHALL INCLUDE DUAL CHECK VALVE SETTERS.
22. ALL WATER METER COVERS AND LIDS SHALL BE PER COA STD DWG #2369.
23. ALL C-900 DR18 UTILITY PIPE JOINTS SHALL BE FULLY RESTRAINED DUE TO POSSIBLE DEFLECTION FROM WASTE DEGENERATION.
24. ALL MANHOLES AND VALVES SHALL HAVE GPS INFORMATION RECORDED AS PART OF AS BUILT PLAN SET.
25. CONTRACTOR IS RESPONSIBLE AT ITS OWN COST FOR ANY DAMAGE TO EXISTING UTILITIES.
26. CONTRACTOR SHALL MAINTAIN 1' SEPERATION BETWEEN ELECTRICAL AND SAS CROSSINGS.

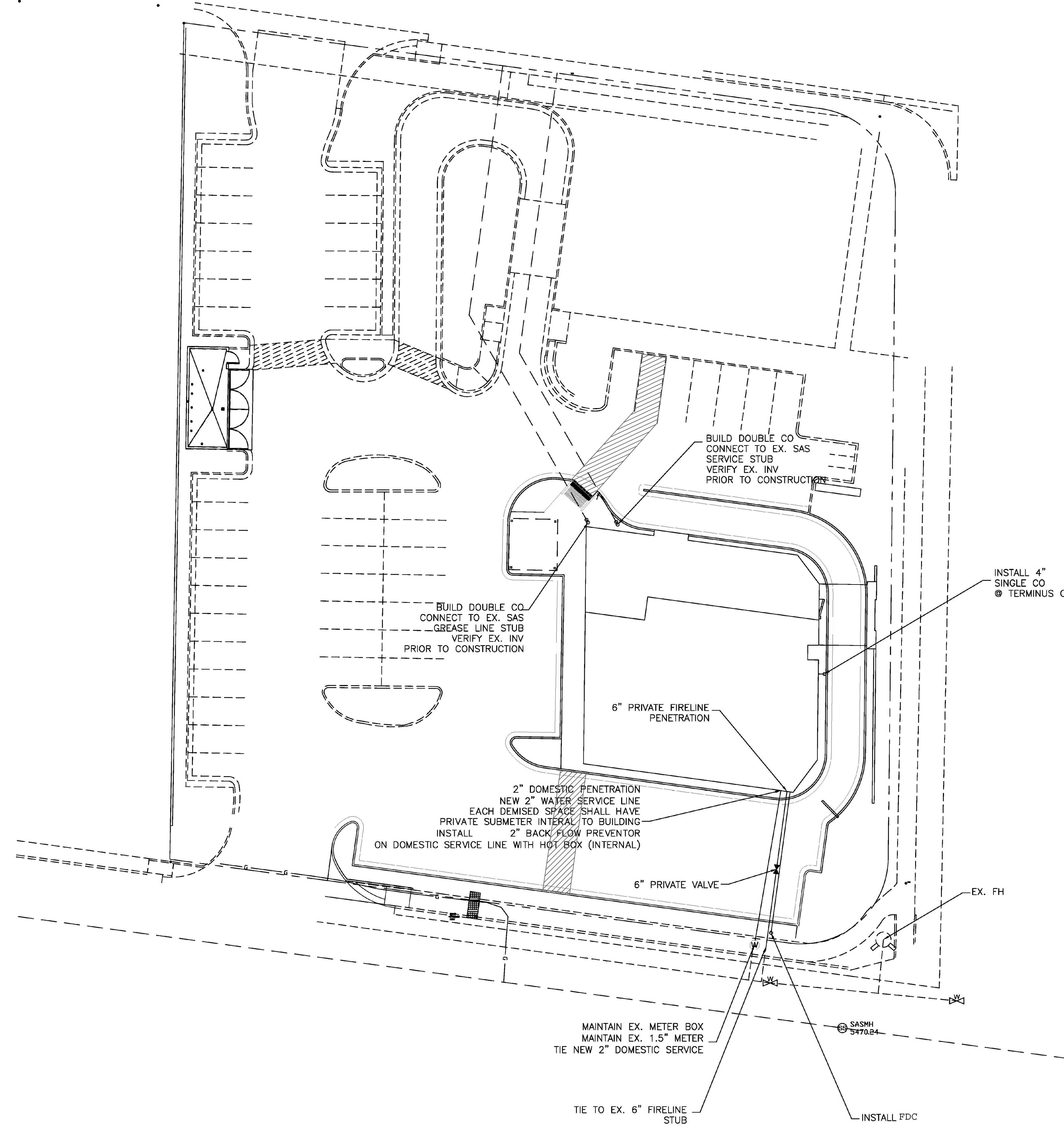

CONTRACTOR RESPONSIBILITIES
 CONTRACTOR SHALL BE RESPONSIBLE FOR VERIFYING ALL UTILITIES PRIOR TO CONSTRUCTION.
 CONTRACTOR SHALL BE RESPONSIBLE FOR OBTAINING ALL NECESSARY PERMITS.

LEGEND

| | | |
|-----|---|------------------------------|
| --- | EX. 12" SD | EXISTING STORM SEWER LINE |
| ○ | EXISTING SAS MANHOLE | |
| --- | EX. 8" SAS | EXISTING SANITARY SEWER LINE |
| ⊗ | EXISTING VALVE W/BOX | |
| --- | EX. 6" WL | EXISTING WATER LINE |
| □ | PROPOSED METER | |
| ● | PROPOSED FIRE HYDRANT | |
| --- | EXISTING EDGE OF PAVEMENT | |
| --- | PROPOSED CURB & GUTTER | |
| --- | BOUNDARY LINE | |
| --- | CENTERLINE | |
| --- | RIGHT-OF-WAY | |
| --- | LOT LINES | |
| ☼ | STREET LIGHTS | |
| ▨ | CONTRACTOR SHALL REMOVE AND REPLACE PAVING PER COA STD DWG #2465 (COLLECTOR). | |

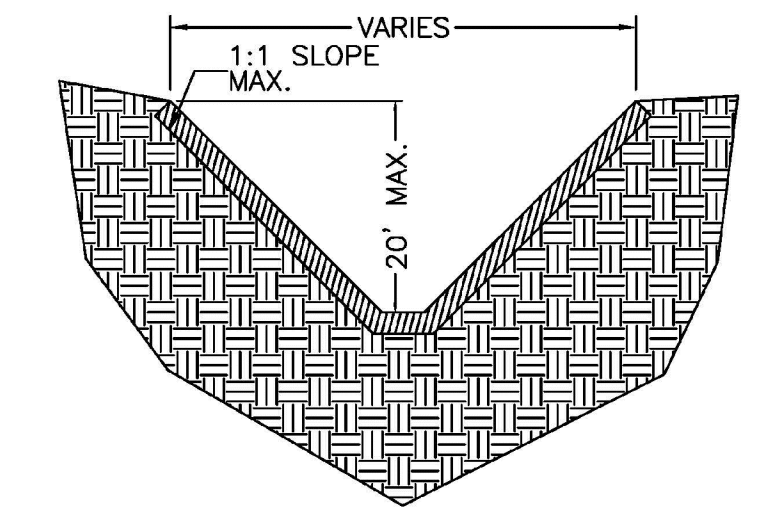

SUPPLEMENTAL TRENCH DETAIL

NTS--PER FIGURE V:2-13 OSHA STANDARD SPECIFICATIONS
 NOTE: ENTIRE TRENCH PRISM SHALL BE COMPACTED AT 95% ASTM D1557 INCLUDING ALL UTILITY MAIN LINES, WATER METER BOXES AND SERVICES, SAS SERVICES.

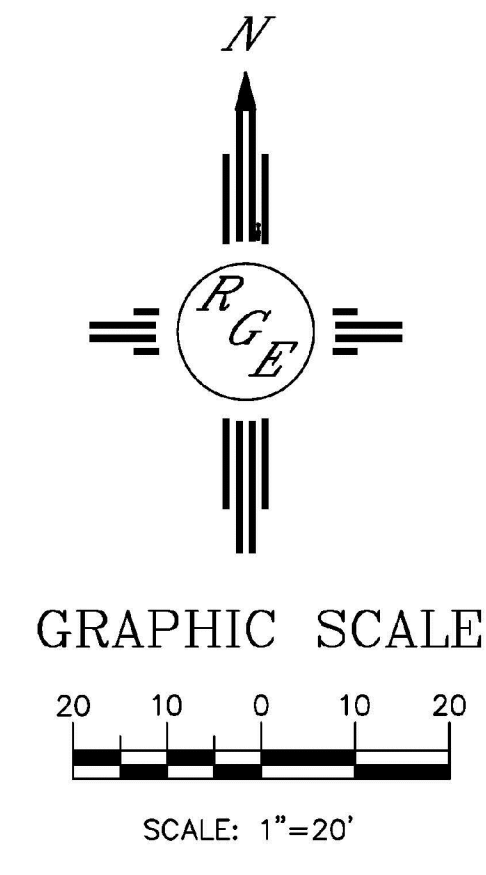

| | | |
|--|----------------------------|--|
| ENGINEER'S SEAL 1/25/18 DAVID SOULE P.E. #14522 | INNOVA PLAZA | DRAWN BY WCWJ |
| | MASTER UTILITY PLAN | DATE 1-25-18 21833-LAYOUT-12-08-17 |
| Rio Grande Engineering 1606 CENTRAL AVENUE SE SUITE 201 ALBUQUERQUE, NM 87106 (505) 872-0999 | SHEET # C2 | JOB # 21833 |