

NOTE:
 ALL HANDICAP RAMPS SHALL BE AT
 7% SLOPE (8.33% MAX)
 LANDING AREA SHALL BE AT
 1.5% SLOPE (2.0% MAX)

POINT TABLE

PNT #	NORTHING	EASTING	DESC.	ELEV.	PNT #	NORTHING	EASTING	DESC.	ELEV.
1	1525162.973	1518817.163	BOP FL	45.79	37	1525522.674	1519019.873	ISL RET FL	47.55
2	1525165.421	1518933.541	PC FL	45.96	38	1525504.713	1518999.29	LT C & G FL	47.93
3	1525198.136	1518949.992	SIDEWALK	46.65	39	1525563.317	1519014.318	LT C & G FL	47.66
4	1525193.591	1518855.125	SIDEWALK	47.07	40	1525467.898	1519038.965	SIDEWALK	48.86
5	1525198.4	1518859.136	SIDEWALK	47.15	41	1525473.78	1519040.249	SIDEWALK	48.79
6	1525216.275	1518881.979	PRC FL	46.40	42	1525470.846	1519049.273	WC RAMP	48.14
7	1525254.935	1518887.811	PT FL	46.55	43	1525473.913	1519051.932	WCR FL	48.07
8	1525266.517	1518896.328	SIDEWALK	47.60	44	1525471.539	1519055.83	WCR FL	48.10
9	1525254.025	1518901.787	SIDEWALK	47.72	45	1525484.218	1519049.482	WC RAMP	48.20
10	1525213.014	1518895.293	FILLET FL	46.25	46	1525494.484	1519075.725	WCR FL	47.80
11	1525214.816	1518852.657	FILLET FL	46.20	47	1525499.032	1519079.668	WC RAMP	47.89
12	1525271.644	1518873.469	VG INV	46.52	48	1525501.98	1519076.268	WC RAMP	47.86
13	1525293.099	1518882.962	MEDIAN FL	46.69	49	1525497.432	1519072.325	WCR FL	47.77
14	1525291.515	1518886.636	MEDIAN FL	46.71	50	1525503.05	1519068.608	SIDEWALK	48.39
15	1525374.849	1518919.063	MEDIAN FL	47.34	51	1525507.221	1519070.224	SIDEWALK	48.45
16	1525411.264	1518935.013	MEDIAN FL	47.65	52	1525519.002	1519047.446	RT C & G FL	47.59
17	1525419.992	1518939.898	MEDIAN FL	47.71	53	1525542.227	1519032.366	RT C & G FL	47.36
18	1525422.946	1518930.593	MEDIAN FL	47.53	54	1525589.915	1519031.957	WCR FL	47.20
19	1525413.405	1518927.597	MEDIAN FL	47.47	55	1525569.236	1519036.344	WC RAMP	47.26
20	1525369.587	1518934.174	RT C & G FL	47.53	56	1525560.904	1519034.59	SIDEWALK	47.82
21	1525370.523	1518941.984	SIDEWALK	48.33	57	1525559.589	1519039.414	SIDEWALK	47.90
22	1525368.586	1518947.636	SIDEWALK	48.45	58	1525567.307	1519041.519	WC RAMP	47.38
23	1525411.992	1518933.69	RT C & G FL	47.82	59	1525573.096	1519043.097	WC RAMP	47.35
24	1525468.242	1518962.506	LT C & G FL	48.03	60	1525580.814	1519045.202	SIDEWALK	47.90
25	1525442.425	1518974.901	RT C & G FL	48.05	61	1525582.129	1519040.378	SIDEWALK	47.80
26	1525400.051	1518980.176	SIDEWALK	48.80	62	1525574.411	1519038.273	WC RAMP	47.23
27	1525436.313	1518984.869	SIDEWALK	48.92	63	1525575.704	1519033.533	WCR FL	47.17
28	1525451.754	1518996.293	SIDEWALK	49.03	64	1525579.912	1519018.104	WCR FL	47.57
29	1525455.323	1518991.47	SIDEWALK	48.91	65	1525581.096	1519013.763	WC RAMP	47.55
30	1525458.357	1518985.671	RT C & G FL	48.16	66	1525583.201	1519006.044	SIDEWALK	48.05
31	1525468.242	1518974.321	LT C & G FL	48.16	67	1525577.382	1519004.576	SIDEWALK	48.08
32	1525496.806	1519009.252	ISL RET FL	47.69	68	1525575.276	1519012.298	WC RAMP	47.68
33	1525494.012	1519011.555	ISL RET FL	47.73	69	1525574.092	1519016.641	WCR FL	47.60
34	1525493.292	1519046.839	ISL RET FL	47.88	70	1525593.587	1518975.525	SIDEWALK	50.23
35	1525496.719	1519048.723	ISL RET FL	47.88	71	1525592.668	1518981.457	SIDEWALK	50.11
36	1525523.036	1519023.48	ISL RET FL	47.57					

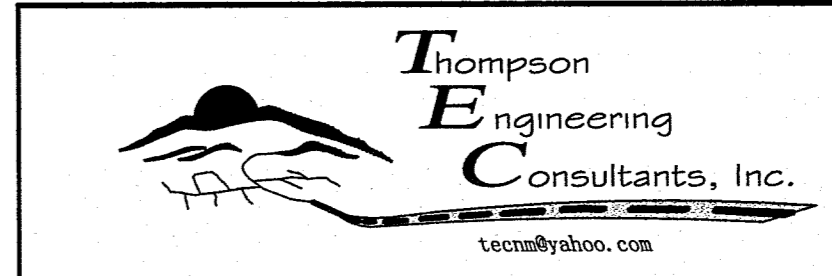
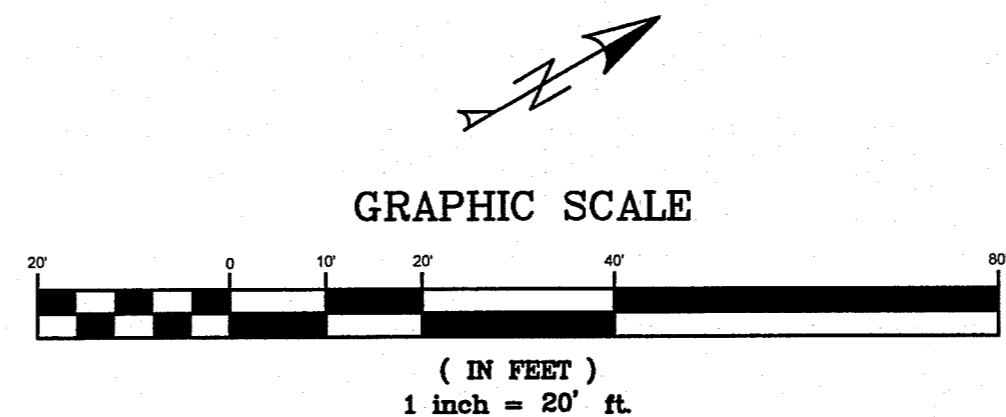

P.O. BOX 65760
 ALBUQUERQUE, NM 87156
 PHONE: (505) 271-2199
 FAX: (505) 830-9428
 tec@thompson.com

**CITY OF ALBUQUERQUE
 PUBLIC WORKS DEPARTMENT
 TRANSPORTATION DEVELOPMENT**
**COORS-COORS BYPASS IMPROVEMENTS
 GRADING, DRAINAGE AND PAVING PLAN**

DESIGN REVIEW COMMITTEE
APPROVED
 DEC 22 2016
 DESIGN REVIEW COMMITTEE

CITY ENGINEER APPROVAL
APPROVED
 MAR 13 2017
 CITY ENGINEER

NO.	DATE	REMARKS	BY
		DESIGN	
		DESIGNED BY	
		DRAWN BY	
		CHECKED BY	

City Project No. **741571** Zone Map No. **B-14-Z** Sheet **4** Of **14**

AS BUILT INFORMATION		BENCH MARK		SURVEY INFORMATION		ENGINEER'S SEAL	
CONTRACTOR	WORK	Albuquerque Control Survey Monument '7-813'	DATE	FIELD NOTES	NO. <td>DATE</td> <td>BY</td>	DATE	BY
INSPECTORS	ACCEPTANCE BY	New Mexico State Plane Coordinates	DATE	NO. <td>DATE</td> <td>REMARKS</td> <td>BY</td>	DATE	REMARKS	BY
VERIFICATION BY	DATE	(Central Zone - NAD 83)	DATE	NO. <td>DATE</td> <td>DESIGN</td> <td>DATE</td>	DATE	DESIGN	DATE
DRAWINGS	DATE	North = 1,526,625,065 feet	DATE	NO. <td>DATE</td> <td>DRAWN BY</td> <td>DATE</td>	DATE	DRAWN BY	DATE
VERIFICATION BY	DATE	East = 1,516,977,962 feet	DATE	NO. <td>DATE</td> <td>CHECKED BY</td> <td>DATE</td>	DATE	CHECKED BY	DATE
DRAWN BY	DATE	Elevation = 5048.611 feet (NAD 1983)	DATE	NO. <td>DATE</td> <td></td> <td>DATE</td>	DATE		DATE
CHECKED BY	DATE	Delta Alpha = -00° 14' 03.33"	DATE	NO. <td>DATE</td> <td></td> <td>DATE</td>	DATE		DATE
MICRO-FILM INFORMATION	NO.	Ground to Grid Factor = 0.999879249	DATE	NO. <td>DATE</td> <td></td> <td>DATE</td>	DATE		DATE

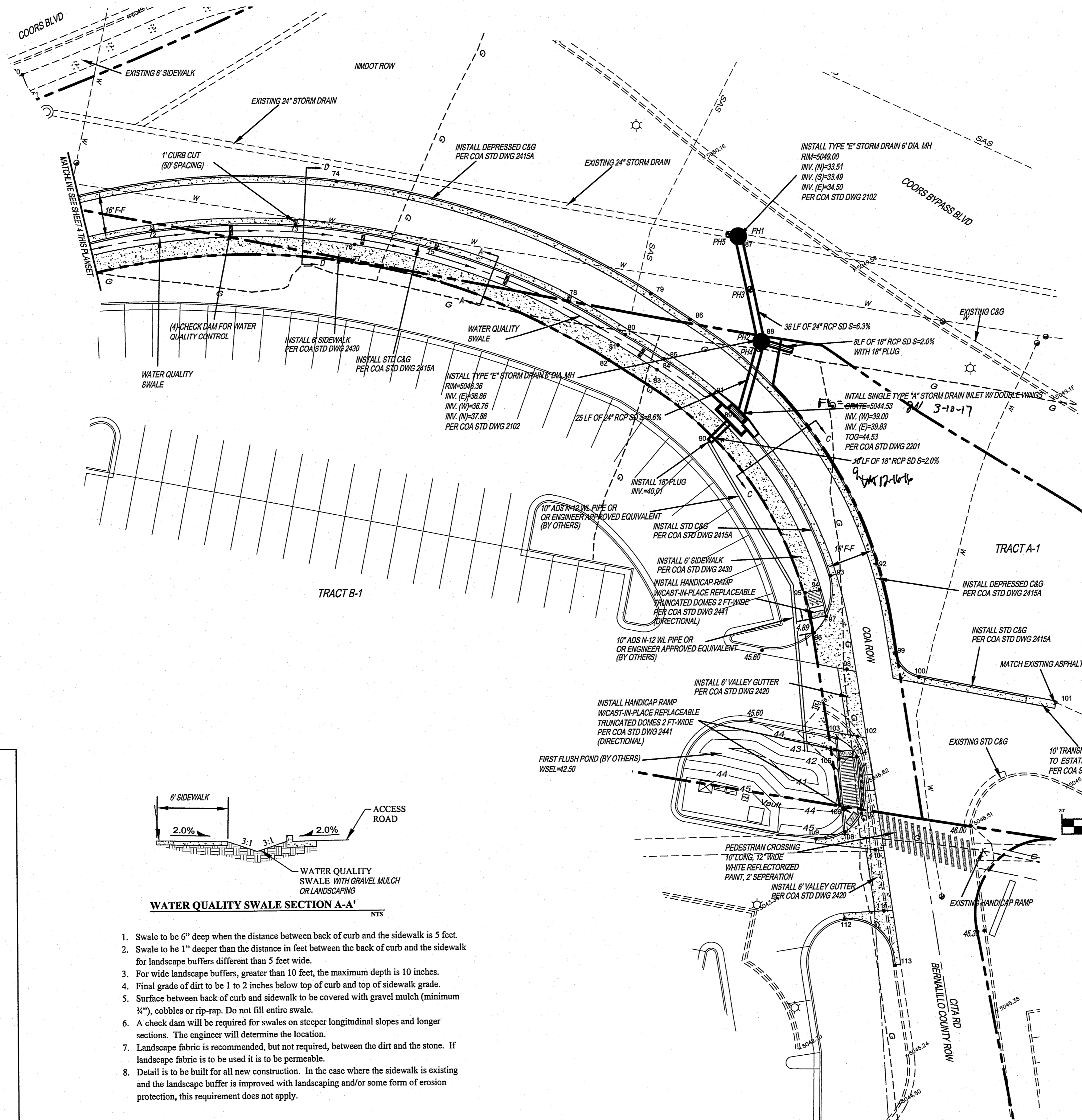

POT HOLE TABLE

PH#	NORTH	EAST	ELEV.	DESC.
PH1	1525774.7421	1519145.2714	5049.45	MH
PH2	1525763.6127	1519173.5899	5046.18	MH
PH3	1525769.1926	1519162.7656	5047.53	WL
PH4	1525761.7577	1519181.4981	5046.09	GAS
PH5	1525772.3672	1519143.1188	5049.35	SD

NOTE:
 ALL HANDICAP RAMPS SHALL BE AT 7% SLOPE (8.33% MAX)
 LANDING AREA SHALL BE AT 1.5% SLOPE (2.0% MAX)

POINT TABLE

PNT #	NORTHING	EASTING	DESC.	ELEV.
72	1525604.793	1519043.279	RT C & G FL	46.74
73	1525647.357	1519066.048	RT C & G FL	46.33
74	1525666.773	1519080.251	LT C & G FL	46.63
75	1525684.367	1519097.029	RT C & G FL	45.84
76	1525661.296	1519081.914	SIDEWALK	46.90
77	1525657.51	1519086.57	SIDEWALK	47.02
78	1525714.269	1519134.923	RT C & G FL	45.30
79	1525739.527	1519146.966	LT C & G FL	45.48
80	1525725.266	1519154.222	RT C & G FL	45.08
81	1525721.322	1519156.169	SIDEWALK	45.80
82	1525715.981	1519158.903	SIDEWALK	45.92
83	1525723.115	1519172.842	SIDEWALK	45.73
84	1525728.456	1519170.103	SIDEWALK	45.61
85	1525732.366	1519168.176	RT C & G FL	44.86
86	1525746.626	1519160.921	LT C & G FL	45.26
87	1525774.742	1519145.271	MH RIM	49.00
88	1525763.613	1519179.59	MH RIM	46.36
89	1525743.043	1519196.774	TOG	44.53
90	1525731.394	1519199.973	SD INV	40.01
91	1525739.772	1519198.504	RT C & G FL	44.70
92	1525738.929	1519284.397	LT C & G FL	45.40
93	1525743.524	1519260.013	RT C & G FL	45.05
94	1525737.987	1519262.116	SIDEWALK	45.80
95	1525733.224	1519260.566	SIDEWALK	45.92
96	1525728.993	1519273.774	WCR FL	45.22
97	1525735.29	1519271.054	WCR FL	45.38
98	1525732.219	1519291.058	VG FL	45.42
99	1525746.108	1519293.432	LT C & G FL	45.68
100	1525751.86	1519304.653	LT C & G FL	45.78
101	1525777.349	1519335.434	C & G FL	46.10
102	1525723.857	1519311.487	VG FL	45.68
103	1525717.55	1519308.466	WCR FL	45.78
104	1525720.011	1519317.229	WCR FL	45.73
105	1525714.478	1519314.894	WC RAMP	45.85
106	1525707.162	1519330.193	WC RAMP	46.12
107	1525711.719	1519334.571	WCR FL	46.00
108	1525703.811	1519337.2	WCR FL	46.06
109	1525694.25	1519334.235	C & G FL	46.15
110	1525709.534	1519347.507	VG FL	46.10
111	1525701.644	1519366.84	VG FL	46.00
112	1525698.725	1519362.407	C & G FL	46.10
113	1525695.588	1519384.601	RT C & G FL	45.90

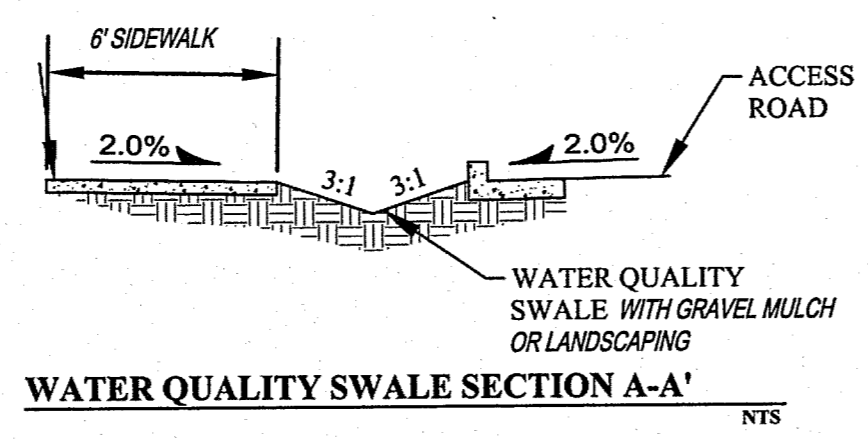

- Swale to be 6" deep when the distance between back of curb and the sidewalk is 5 feet.
- Swale to be 1" deeper than the distance in feet between the back of curb and the sidewalk for landscape buffers different than 5 feet wide.
- For wide landscape buffers, greater than 10 feet, the maximum depth is 10 inches.
- Final grade of dirt to be 1 to 2 inches below top of curb and top of sidewalk grade.
- Surface between back of curb and sidewalk to be covered with gravel mulch (minimum 3/4"), cobbles or rip-rap. Do not fill entire swale.
- A check dam will be required for swales on steeper longitudinal slopes and longer sections. The engineer will determine the location.
- Landscape fabric is recommended, but not required, between the dirt and the stone. If landscape fabric is to be used it is to be permeable.
- Detail is to be built for all new construction. In the case where the sidewalk is existing and the landscape buffer is improved with landscaping and/or some form of erosion protection, this requirement does not apply.

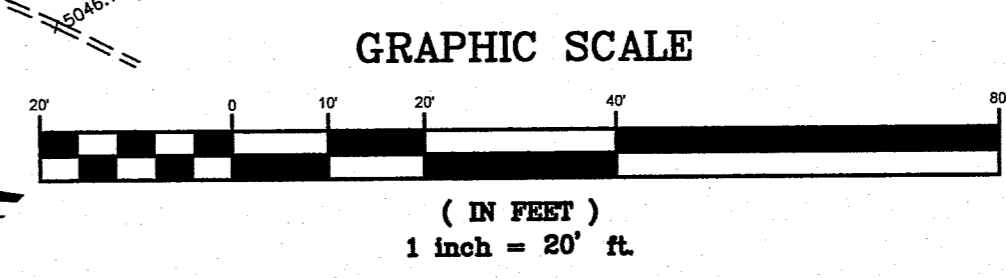

Tompson Engineering Consultants, Inc.
 tecum@yahoo.com
 P.O. BOX 65760 ALBUQUERQUE, NM 87193
 PHONE: (505) 271-2199 FAX: (505) 830-9426

**CITY OF ALBUQUERQUE
 PUBLIC WORKS DEPARTMENT
 TRANSPORTATION DEVELOPMENT
 COORS-COORS BYPASS IMPROVEMENTS
 GRADING, DRAINAGE AND PAVING PLAN**

DESIGN REVIEW COMMITTEE
 DEC 22 2016

CITY ENGINEER APPROVAL
 MAR 13 2017
 CITY ENGINEER

MO./DAY/YR	MO./DAY/YR

AS BUILT INFORMATION		BENCH MARK		SURVEY INFORMATION		ENGINEER'S SEAL		REMARKS		DESIGN	
CONTRACTOR	WORK	Albuquerque Central Survey Monument "7-B13"	DATE	NO.	BY	NO.	DATE	DESIGNED BY	DATE	DRAWN BY	DATE
STAKED BY	ACCEPTED BY	New Mexico State Plane Coordinates (Central Zone - NAD 83)	DATE								
FIELD DRAWINGS	CORRECTED BY	North= 1,525,625,065 feet East= 1,519,977,862 feet Elevations= 5049.811 feet (NAVD 1988) Delta Alpha= -00°-14'03.33" Ground to Grid Factor= 0.999879249	DATE								
MICRO-FILM INFORMATION											
RECORDED BY	NO.										