

PLAT OF

LOTS 15-A AND 15-B

LOOP INDUSTRIAL DISTRICT

UNIT V

(BEING A REPLAT OF LOT 15, LOOP INDUSTRIAL DISTRICT UNIT V)

SITUATE WITHIN
THE ELENA GALLEGOS GRANT

IN

PROJECTED SECTION 14, TOWNSHIP 11 NORTH, RANGE 3 EAST

NEW MEXICO PRINCIPAL MERIDIAN

CITY OF ALBUQUERQUE

BERNALILLO COUNTY, NEW MEXICO

AUGUST, 2014

PROJECT NUMBER: _____

Application Number: _____

PLAT APPROVAL

UTILITY APPROVALS:

Public Service Company of New Mexico _____ Date _____

New Mexico Gas Company _____ Date _____

Qwest Corporation d/b/a CenturyLink QC _____ Date _____

Comcast _____ Date _____

CITY APPROVALS:

City Surveyor _____ Date _____
Department of Municipal Development

Real Property Division _____ Date _____

Environmental Health Department _____ Date _____

Traffic Engineering, Transportation Division _____ Date _____

ABCWUA _____ Date _____

Parks and Recreation Department _____ Date _____

AMAFCA _____ Date _____

City Engineer _____ Date _____

DRB Chairperson, Planning Department _____ Date _____

TREASURERS CERTIFICATION

This is to certify that taxes are current and paid on the following:

Bernalillo County Treasurer _____ Date _____

PUBLIC UTILITY EASEMENTS

PUBLIC UTILITY EASEMENTS shown on this plat are granted for the common and joint use of:

A. Public Service Company of New Mexico ("PNM"), a New Mexico corporation, (PNM Electric) for installation, maintenance, and service of overhead and underground electrical lines, transformers, and other equipment and related facilities reasonably necessary to provide electrical services.

B. New Mexico Gas Company for installation, maintenance, and service of natural gas lines, valves and other equipment and facilities reasonably necessary to provide natural gas services.

C. Qwest Corporation d/b/a CenturyLink QC, for the installation, maintenance, and service of such lines, cable, and other related equipment and facilities reasonably necessary to provide communication services.

D. Cable TV for the installation, maintenance, and service of such lines, cable, and other related equipment and facilities reasonably necessary to provide Cable services.

Included, is the right to build, rebuild, construct, reconstruct, locate, relocate within the easement, change, remove, replace, modify, renew, operate and maintain facilities for purposes described above, together with free access to, from, and over said easements, with the right and privilege of going upon, over and across adjoining lands or Grantor for the purposes set forth herein and utilizing the right to the purposes set forth in easement to extend services to customers of Grantor, including the right and privilege to install, maintain, repair, and replace the right and privilege to trim and remove trees, shrubs or bushes which interfere with the purposes set forth herein. No building, sign, pool (aboveground or subsurface), hot tub, concrete or wood, pool decking, or other structure, shall be erected or constructed thereon. Property owners shall be solely responsible for correcting any violations of National Electrical Safety Code by construction of pools, decking, or any structures adjacent to or near easements shown on this plat. Easements for electric transformer/switchgears, as installed, shall extend ten (10) feet in front of transformer/switchgear doors and five (5) feet on each side.

DISCLAIMER

In approving this plat, Public Service Company of New Mexico (PNM) and New Mexico Gas Company (NMGC) did not conduct a Title Search of the properties shown hereon. Consequently, PNM and NMGC do not waive or release any easement or easement rights which may have been granted by prior plat, replat or other document and which are not shown on this plat.

PURPOSE OF PLAT

The purpose of this plat is to:

1. Divide one (1) existing Lot into two (2) new Lots as shown hereon .
2. Grant the new easements as shown hereon.

SURVEYORS CERTIFICATION

I, Russ P. Hugg, New Mexico Professional Surveyor Number 9750, hereby certify that this plat of survey was prepared from field notes of an actual ground survey performed by me or under my supervision; that it meets the Standards for Land Surveys in New Mexico as adopted by the New Mexico State Board of Registration for Professional Engineers and Professional Surveyors; that it meets the minimum requirements for surveys and monumentation of the Albuquerque Subdivision Ordinance; that it shows all easements of record; and that it is true and correct to the best of my knowledge and belief.

Russ P. Hugg
NMPS No. 9750
August 21, 2014

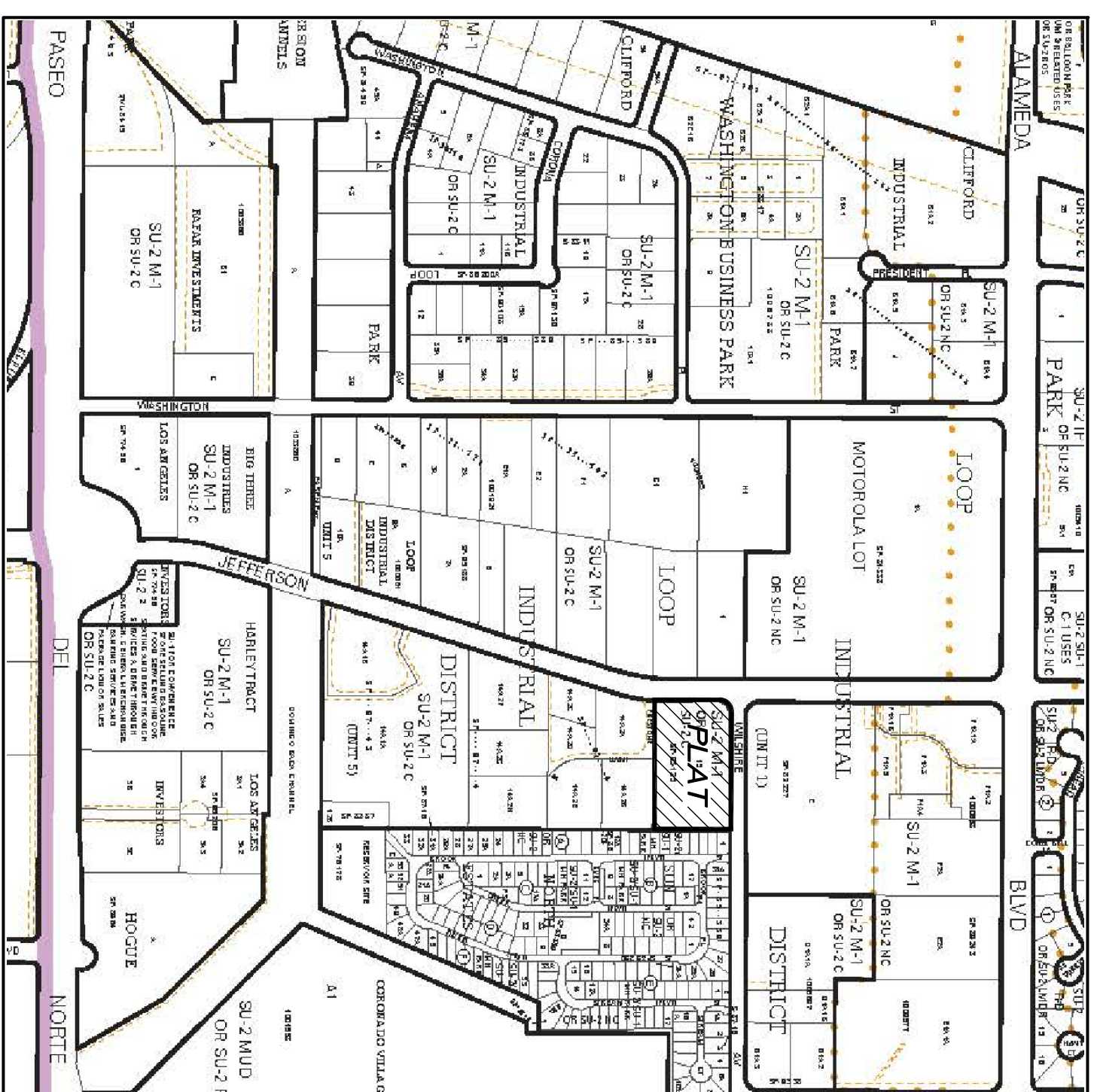

VICINITY MAP
Not To Scale

GENERAL NOTES

1. Bearings are grid and based on the New Mexico State Plane Coordinate System, Central Zone (NAD83).
2. Distances are ground.
3. Distances along curved lines are arc lengths.
4. Record Plat or Deed bearings and distances, where they differ from those established by this field survey, are shown in parenthesis ().
5. All corners found in place and held were tagged with a brass disk stamped "HUGG L.S. 9750" unless otherwise indicated hereon.
6. All corners that were set are either a 5/8" rebar with cap stamped "HUGG L.S. 9750" or a concrete nail with brass disk stamped "HUGG L.S. 9750" unless otherwise indicated hereon.
7. City of Albuquerque Zone Atlas Page C-17-Z.

SUBMISSION DATA

1. Total number of existing Lots: 1
2. Total number of Lots created: 2
3. Gross Subdivision acreage: 3.3597 acres

SHEET 1 OF 3

SURVOTEK, INC.

Consulting Surveyors
8994 Valley View Drive, N.W. Albuquerque, New Mexico 87114
Phone: 505-897-3366
Fax: 505-897-3377