



Supplemental Form (SF)

SUBDIVISION

- Major subdivision action
- Minor subdivision action
- Vacation
- Variance (Non-Zoning)

SITE DEVELOPMENT PLAN

- for Subdivision
- for Building Permit
- Administrative Amendment/Approval (AA)
- IP Master Development Plan
- Cert. of Appropriateness (LUCC)

STORM DRAINAGE (Form D)

- Storm Drainage Cost Allocation Plan

S Z ZONING & PLANNING

- Annexation
- Zone Map Amendment (Establish or Change Zoning, includes Zoning within Sector Development Plans)
- Adoption of Rank 2 or 3 Plan or similar
- Text Amendment to Adopted Rank 1, 2 or 3 Plan(s), Zoning Code, or Subd. Regulations

D L A APPEAL / PROTEST of...

- Street Name Change (Local & Collector)
- Decision by: DRB, EPC, LUCC, Planning Director, ZEO, ZHE, Board of Appeals, other

PRINT OR TYPE IN BLACK INK ONLY. The applicant or agent must submit the completed application in person to the Planning Department Development Services Center, 600 2nd Street NW, Albuquerque, NM 87102. Fees must be paid at the time of application. Refer to supplemental forms for submittal requirements.

APPLICATION INFORMATION:

Professional/Agent (if any): ARCH + PLAN LAND USE CONSULTANTS PHONE: 980.8365
 ADDRESS: P.O. BOX 25911 FAX: _____
 CITY: ALBUQUERQUE STATE NM ZIP 87125 E-MAIL: arch.plan@comcast.net

APPLICANT: GARY R. & RACHEL REIDHEAD PHONE: _____
 ADDRESS: 10419 BORREGOCREEK DR NW FAX: _____
 CITY: ALBUQUERQUE STATE NM ZIP 87120 E-MAIL: _____

Proprietary interest in site: OWNERS List all owners: _____

DESCRIPTION OF REQUEST: LOT CONSOLIDATION

Is the applicant seeking incentives pursuant to the Family Housing Development Program? Yes. No.

SITE INFORMATION: ACCURACY OF THE EXISTING LEGAL DESCRIPTION IS CRUCIAL! ATTACH A SEPARATE SHEET IF NECESSARY.

Lot or Tract No. B & 9 Block: 4 Unit: 18

Subdiv/Addn/TBKA: VOLCANO CLIFFS

Existing Zoning: SU-2/VCLL Proposed zoning: N/A MRGCD Map No _____

Zone Atlas page(s): D-10 UPC Code: 1-010-063-216-261-311-05 (LOT 8)
1-010-063-206-251-311-04 (LOT 9)

CASE HISTORY:

List any current or prior case number that may be relevant to your application (Proj., App., DRB-, AX_Z_, V_, S_, etc.): _____

CASE INFORMATION:

Within city limits? Yes Within 1000FT of a landfill? NO

No. of existing lots: 2 No. of proposed lots: 1 Total site area (acres): 1.027±

LOCATION OF PROPERTY BY STREETS: On or Near: 6605 CUERVO PL NW

Between: AGUILAR ST and COMPASS DR

Check if project was previously reviewed by: Sketch Plat/Plan or Pre-application Review Team(PRT) Review Date: _____

SIGNATURE Derrick Archuleta DATE 9.1.15

(Print Name) DERRICK ARCHULETA Applicant: Agent:

FOR OFFICIAL USE ONLY

Revised: 4/2012

<input type="checkbox"/> INTERNAL ROUTING	Application case numbers	Action	S.F.	Fees
<input type="checkbox"/> All checklists are complete	<u>15 DRB-70313</u>	<u>SP</u>	_____	\$ <u>0</u>
<input type="checkbox"/> All fees have been collected	_____	_____	_____	\$ _____
<input type="checkbox"/> All case #s are assigned	_____	_____	_____	\$ _____
<input type="checkbox"/> AGIS copy has been sent	_____	_____	_____	\$ _____
<input type="checkbox"/> Case history #s are listed	_____	_____	_____	\$ _____
<input type="checkbox"/> Site is within 1000ft of a landfill	_____	_____	_____	\$ _____
<input type="checkbox"/> F.H.D.P. density bonus	_____	_____	_____	\$ _____
<input type="checkbox"/> F.H.D.P. fee rebate	_____	_____	_____	\$ _____
				Total <u>0</u>

Hearing date Sept. 9, 2015

9-1-15
Staff signature & Date

Project # 1010589

A Bulk Land Variance requires application on FORM-V in addition to application for subdivision on FORM-S.

- SKETCH PLAT REVIEW AND COMMENT (DRB22)** Your attendance is required.
 - ___ Scale drawing of the proposed subdivision plat (folded to fit into an 8.5" by 14" pocket) **6 copies**
 - ___ Site sketch with measurements showing structures, parking, Bldg. setbacks, adjacent rights-of-way and street improvements, if there is any existing land use (folded to fit into an 8.5" by 14" pocket) **6 copies**
 - ___ Zone Atlas map with the entire property(ies) clearly outlined
 - ___ Letter briefly describing, explaining, and justifying the request
 - ___ List any original and/or related file numbers on the cover application

- EXTENSION OF MAJOR PRELIMINARY PLAT (DRB08)** Your attendance is required.
 - ___ Preliminary Plat reduced to 8.5" x 11"
 - ___ Zone Atlas map with the entire property(ies) clearly outlined
 - ___ Letter briefly describing, explaining, and justifying the request
 - ___ Copy of DRB approved infrastructure list
 - ___ Copy of the LATEST Official DRB Notice of approval for Preliminary Plat Extension request
 - ___ List any original and/or related file numbers on the cover application

Extension of preliminary plat approval expires after one year.

- MAJOR SUBDIVISION FINAL PLAT APPROVAL (DRB12)** Your attendance is required.
 - ___ Proposed Final Plat (folded to fit into an 8.5" by 14" pocket) **6 copies**
 - ___ Signed & recorded Final Pre-Development Facilities Fee Agreement for **Residential** development only
 - ___ Design elevations & cross sections of perimeter walls **3 copies**
 - ___ Zone Atlas map with the entire property(ies) clearly outlined
 - ___ Bring original Mylar of plat to meeting, ensure property owner's and City Surveyor's signatures are on the plat
 - ___ Copy of recorded SIA
 - ___ Landfill disclosure and EHD signature line on the Mylar if property is within a landfill buffer
 - ___ List any original and/or related file numbers on the cover application
 - ___ DXF file and hard copy of final plat data for AGIS is required.

- MINOR SUBDIVISION PRELIMINARY/FINAL PLAT APPROVAL (DRB16)** Your attendance is required.
 - ___ 5 Acres or more: Certificate of No Effect or Approval
 - ___ Proposed Preliminary / Final Plat (folded to fit into an 8.5" by 14" pocket) **6 copies** for unadvertised meetings ensure property owner's and City Surveyor's signatures are on the plat prior to submittal
 - ___ Signed & recorded Final Pre-Development Facilities Fee Agreement for **Residential** development only
 - ___ Design elevations and cross sections of perimeter walls (11" by 17" maximum) **3 copies**
 - ___ Site sketch with measurements showing structures, parking, Bldg. setbacks, adjacent rights-of-way and street improvements, if there is any existing land use (folded to fit into an 8.5" by 14" pocket) **6 copies**
 - ___ Zone Atlas map with the entire property(ies) clearly outlined
 - ___ Letter briefly describing, explaining, and justifying the request
 - ___ Bring original Mylar of plat to meeting, ensure property owner's and City Surveyor's signatures are on the plat
 - ___ Landfill disclosure and EHD signature line on the Mylar if property is within a landfill buffer
 - ___ Fee (see schedule)
 - ___ List any original and/or related file numbers on the cover application
 - ___ Infrastructure list if required (**verify with DRB Engineer**)
 - ___ DXF file and hard copy of final plat data for AGIS is required.

- AMENDMENT TO PRELIMINARY PLAT (with minor changes) (DRB03)** Your attendance is required.

PLEASE NOTE: There are no clear distinctions between significant and minor changes with regard to subdivision amendments. Significant changes are those deemed by the DRB to require public notice and public hearing.

 - ___ Proposed Amended Preliminary Plat, Infrastructure List, and/or Grading Plan (folded to fit into an 8.5" by 14" pocket) **6 copies**
 - ___ Original Preliminary Plat, Infrastructure List, and/or Grading Plan (folded to fit into an 8.5" by 14" pocket) **6 copies**
 - ___ Zone Atlas map with the entire property(ies) clearly outlined
 - ___ Letter briefly describing, explaining, and justifying the request
 - ___ Bring original Mylar of plat to meeting, ensure property owner's and City Surveyor's signatures are on the plat
 - ___ List any original and/or related file numbers on the cover application

Amended preliminary plat approval expires after one year

I, the applicant, acknowledge that any information required but not submitted with this application will likely result in deferral of actions.

DERRICK ARCHULETA
 Applicant name (print)
Derrick Archuleta 9-1-15
 Applicant signature / date



- Checklists complete
- Fees collected
- Case #s assigned
- Related #s listed

Application case numbers
15-DRB-10313

Form revised October 2007
[Signature] 9-1-15
 Planner signature / date
 Project # 1010589

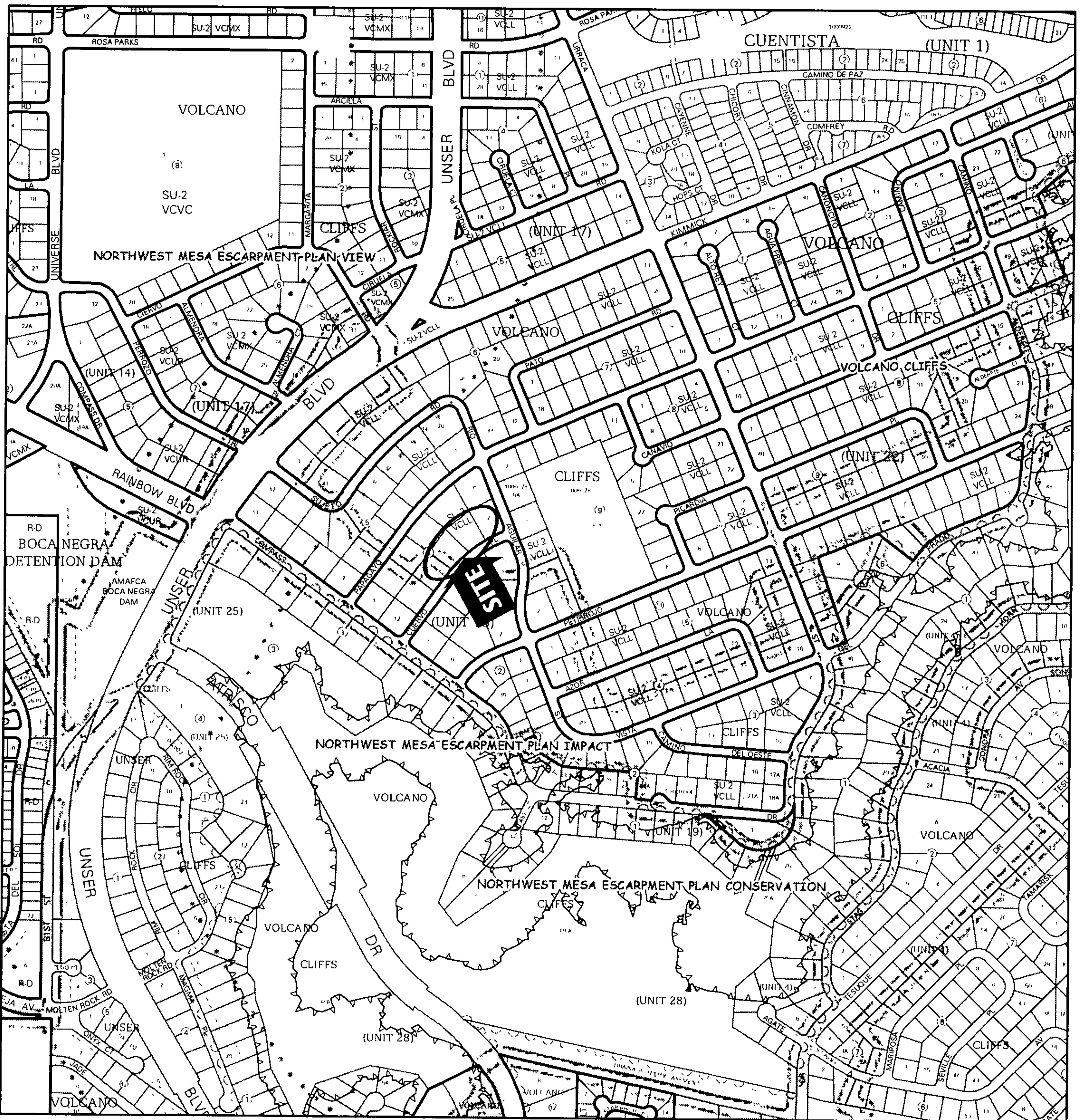

For more current information and details visit: <http://www.cabq.gov/gis>

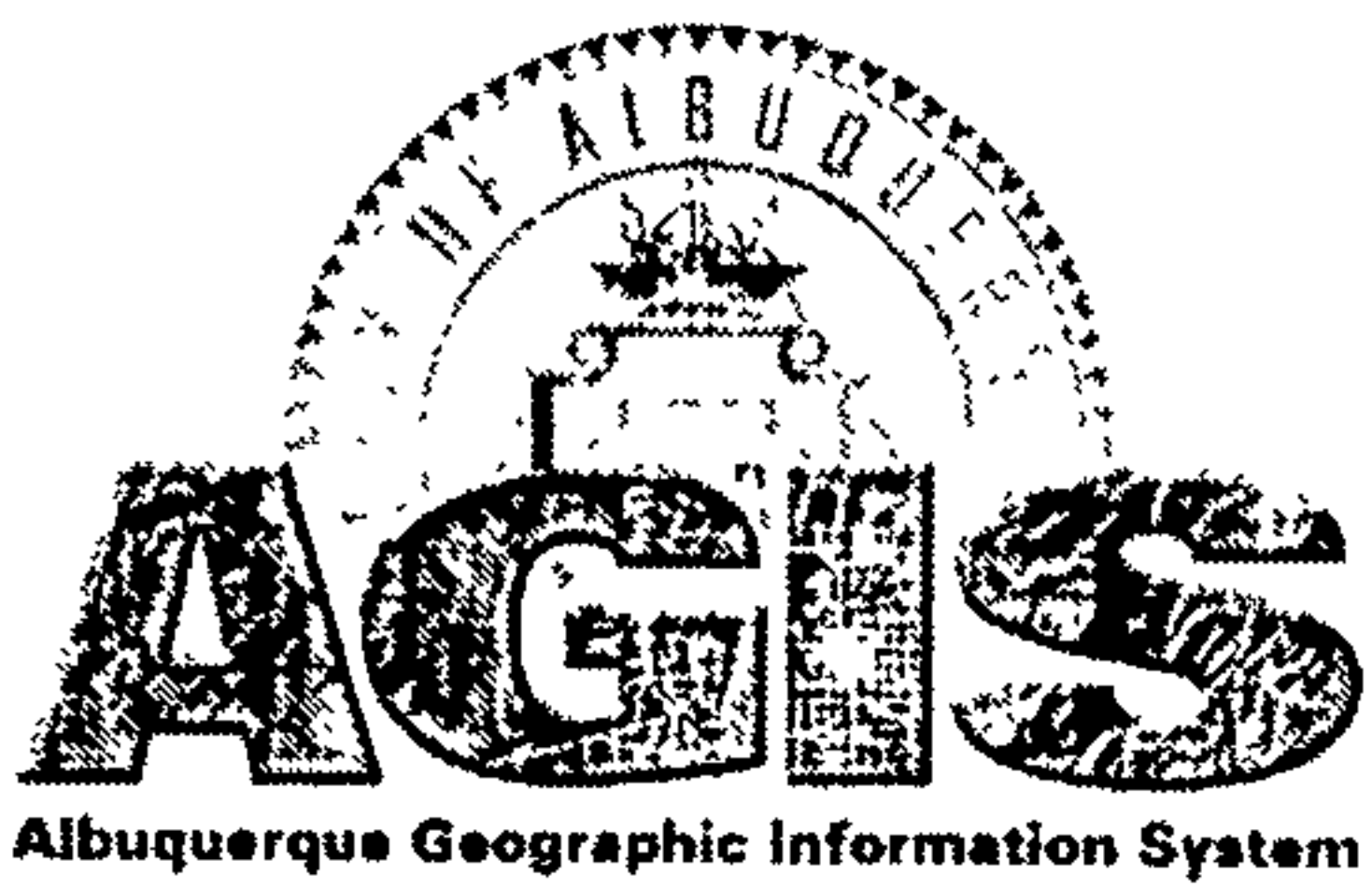

Map amended through 9/2/2014

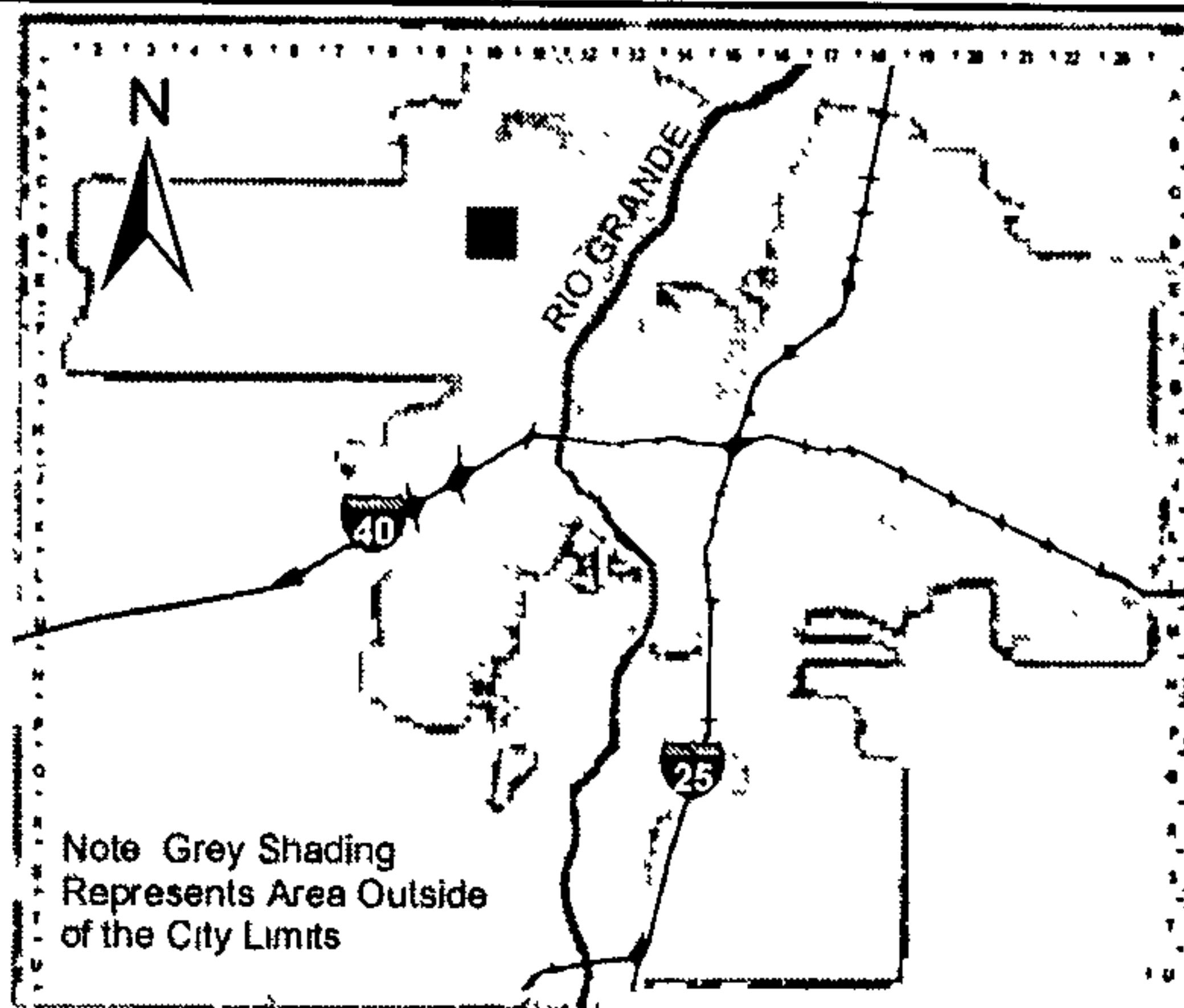

Zone Atlas Page:

D-10-Z

Selected Symbols

- SECTOR PLANS
- Design Overlay Zones
- City Historic Zones
- H-1 Buffer Zone
- Petroglyph Mon
- Escarpment
- 2 Mile Airport Zone
- Airport Noise Contours
- Wall Overlay Zone



ARCH + PLAN
LAND USE CONSULTANTS
ALBUQUERQUE NM

September 1, 2015

Jack Cloud, Chair
City of Albuquerque
Development Review Board
600 2nd St NW
Albuquerque NM

RE: Tracts 8 and 9, Block 4, Volcano Cliffs Unit 18 located at 6605 Cuervo Place NW

Mr. Cloud and members of the Board:

I would like to request Sketch Plat review for a minor subdivision for the above referenced properties.

The property owner would like to consolidate existing Tracts 8 and 9, Block 4, Volcano Cliffs Unit 18 into one lot to be known as Lot 8-A containing 1.027± acres.

The site is currently vacant

The property is zoned SU-2/VCLL and is governed by the Volcano Cliffs Sector Plan and Established Urban Area of the Albuquerque/Bernalillo County Comprehensive Plan which support the application.

Thank you for your time and consideration of the proposed request.

Sincerely,



Derrick Archuleta, MCRP
Principal

PROJECT #

6850101

September 9, 2015

SK