

**CITY OF ALBUQUERQUE
PLANNING DEPARTMENT
September 9, 2015
DRB Comments**

ITEM # 8

PROJECT # 1010591

APPLICATION # 15-70317

RE: Lot 5, Block 17, Tract 1, Unit 3, North Albuquerque Acres

The site is within the La Cueva Sector Development plan; the density of 3 dwellings per acre is based on net acreage (exclusive of road easements), therefore the maximum number of dwelling for this site would be 2. Refer to comments from Transportation Development and Hydrology for infrastructure requirements (paving, curb, gutter and sidewalk on Glendale).

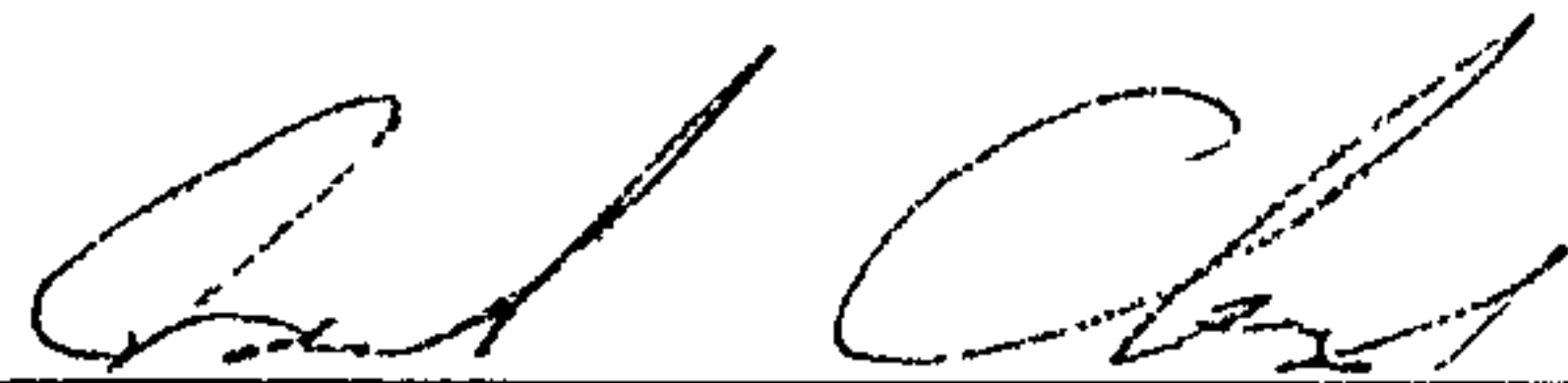

Jack Cloud, DRB Chairman
924-3880/ jcloud@cabq.gov



Supplemental Form (SF)

SUBDIVISION

- Major subdivision action
- Minor subdivision action
- Vacation
- Variance (Non-Zoning)

SITE DEVELOPMENT PLAN

- for Subdivision
- for Building Permit
- Administrative Amendment (AA)
- Administrative Approval (DRT, URT, etc.)
- IP Master Development Plan
- Cert. of Appropriateness (LUCC)

STORM DRAINAGE (Form D)

- Storm Drainage Cost Allocation Plan

S Z

ZONING & PLANNING

- Annexation
- V** Zone Map Amendment (Establish or Change Zoning, includes Zoning within Sector Development Plans)
- P** Adoption of Rank 2 or 3 Plan or similar
- Text Amendment to Adopted Rank 1, 2 or 3 Plan(s), Zoning Code, or Subd. Regulations

D

- Street Name Change (Local & Collector)

L A

APPEAL / PROTEST of...

- Decision by: DRB, EPC, LUCC, Planning Director, ZEO, ZHE, Board of Appeals, other

PRINT OR TYPE IN BLACK INK ONLY. The applicant or agent must submit the completed application in person to the Planning Department Development Services Center, 600 2nd Street NW, Albuquerque, NM 87102. Fees must be paid at the time of application. Refer to supplemental forms for submittal requirements.

APPLICATION INFORMATION:

Professional/Agent (if any): _____ PHONE: _____

ADDRESS: _____ FAX: _____

CITY: _____ STATE _____ ZIP _____ E-MAIL: _____

APPLICANT: Deepak Asoori PHONE: _____

ADDRESS: 7136 Dancing Eagle Ave NE FAX: _____

CITY: Albuquerque STATE NM ZIP 87113 E-MAIL: deepakasoori@gmail.com

Proprietary interest in site: _____ List all owners: _____

DESCRIPTION OF REQUEST: Sketch Plat

Is the applicant seeking incentives pursuant to the Family Housing Development Program? Yes. No.

SITE INFORMATION: ACCURACY OF THE EXISTING LEGAL DESCRIPTION IS CRUCIAL! ATTACH A SEPARATE SHEET IF NECESSARY.

Lot or Tract No. Lot 5 / Tract 1 Block: 17 Unit: 3

Subdiv/Addn/TBKA: North Albuquerque Acres

Existing Zoning: R-D/3 DU/A Proposed zoning: _____ MRGCD Map No _____

Zone Atlas page(s): B-20 UPC Code: _____

CASE HISTORY:

List any current or prior case number that may be relevant to your application (Proj., App., DRB-, AX_, Z_, V_, S_, etc.): _____

CASE INFORMATION:

Within city limits? Yes Within 1000FT of a landfill? No

No. of existing lots: 1 No. of proposed lots: 3 Total site area (acres): 0.89

LOCATION OF PROPERTY BY STREETS: On or Near: 8500 Glendale and Barstow

Between: Barstow and Ventura

Check if project was previously reviewed by: Sketch Plat/Plan or Pre-application Review Team(PRT) Review Date: _____

SIGNATURE

(Print Name) Deepak Asoori DATE 08/30/2015

Applicant: Agent:

FOR OFFICIAL USE ONLY

Revised: 11/2014

<input type="checkbox"/> INTERNAL ROUTING	Application case numbers	Action	S.F.	Fees
<input type="checkbox"/> All checklists are complete	<u>15 DRB-70318</u>	<u>SP</u>	_____	\$ <u>0</u>
<input type="checkbox"/> All fees have been collected	_____	_____	_____	\$ _____
<input type="checkbox"/> All case #s are assigned	_____	_____	_____	\$ _____
<input type="checkbox"/> AGIS copy has been sent	_____	_____	_____	\$ _____
<input type="checkbox"/> Case history #s are listed	_____	_____	_____	\$ _____
<input type="checkbox"/> Site is within 1000ft of a landfill	_____	_____	_____	\$ _____
<input type="checkbox"/> F.H.D.P. density bonus	_____	_____	_____	\$ _____
<input type="checkbox"/> F.H.D.P. fee rebate	_____	_____	_____	\$ _____
				Total \$ <u>0</u>

Hearing date Sept. 9, 2015

9-1-15

Project # 1010591

Staff signature & Date

FORM P(3): SITE PLAN REVIEW - D.R.B. MEETING (UNADVERTISED)

SKETCH PLAT REVIEW AND COMMENT (DRB22)

Maximum Size: 24" x 36"

- Scaled site sketch and related drawings showing proposed land use including structures, parking, Bldg. setbacks, adjacent rights-of-way and street improvements, etc. (folded to fit into an 8.5" by 14" pocket) **6 copies.**
- Zone Atlas map with the entire property(ies) clearly outlined - *CASO. GOV*
- Letter briefly describing, explaining, and justifying the request
- List any original and/or related file numbers on the cover application

Meetings are approximately 8 DAYS after the Tuesday noon filing deadline. **Your attendance is required.**

SITE DEVELOPMENT PLAN FOR SUBDIVISION (DRB18)

Maximum Size: 24" x 36"

- 5 Acres or more & zoned SU-1, IP, SU-2, PC, or Shopping Center: Certificate of No Effect or Approval
- Scaled site plan and related drawings (folded to fit into an 8.5" by 14" pocket) **6 copies**
- Zone Atlas map with the entire property(ies) clearly outlined
- Letter briefly describing, explaining, and justifying the request
- Letter of authorization from the property owner if application is submitted by an agent
- Copy of the document delegating approval authority to the DRB
- Completed Site Plan for Subdivision Checklist
- Infrastructure List, if relevant to the site plan
- Fee (see schedule)
- List any original and/or related file numbers on the cover application

Meetings are approximately 8 DAYS after the Tuesday noon filing deadline. **Bring the original to the meeting. Your attendance is required.**

SITE DEVELOPMENT PLAN FOR BUILDING PERMIT (DRB17)

Maximum Size: 24" x 36"

- 5 Acres or more & zoned SU-1, IP, SU-2, PC, or Shopping Center: Certificate of No Effect or Approval
- Site plan and related drawings (folded to fit into an 8.5" by 14" pocket) **6 copies**
- Site Plan for Subdivision, if applicable, previously approved or simultaneously submitted. **6 copies.**
- Solid Waste Management Department signature on Site Plan
- Zone Atlas map with the entire property(ies) clearly outlined
- Letter briefly describing, explaining, and justifying the request
- Letter of authorization from the property owner if application is submitted by an agent
- Copy of the document delegating approval authority to the DRB
- Infrastructure List, if relevant to the site plan
- Completed Site Plan for Building Permit Checklist
- Copy of Site Plan with Fire Marshal's stamp
- Fee (see schedule)
- List any original and/or related file numbers on the cover application

Meetings are approximately 8 DAYS after the Tuesday noon filing deadline. **Bring the original to the meeting. Your attendance is required.**

AMENDED SITE DEVELOPMENT PLAN FOR BUILDING PERMIT (DRB01)

Maximum Size: 24" x 36"

AMENDED SITE DEVELOPMENT PLAN FOR SUBDIVISION (DRB02)

Maximum Size: 24" x 36"

- Proposed amended Site Plan (folded to fit into an 8.5" by 14" pocket) **6 copies**
- DRB signed Site Plan being amended (folded to fit into an 8.5" by 14" pocket) **6 copies**
- Zone Atlas map with the entire property(ies) clearly outlined
- Letter briefly describing, explaining, and justifying the request
- Letter of authorization from the property owner if application is submitted by an agent
- Infrastructure List, if relevant to the site plan
- Completed Site Plan for Building Permit Checklist (not required for amendment of SDP for Subdivision)
- Fee (see schedule)
- List any original and/or related file numbers on the cover application

Meetings are approximately 8 DAYS after the Tuesday noon filing deadline. **Bring the original to the meeting. Your attendance is required.**

FINAL SIGN-OFF FOR EPC APPROVED SDP FOR BUILDING PERMIT (DRB05)

FINAL SIGN-OFF FOR EPC APPROVED SDP FOR SUBDIVISION (DRB06)

- 5 Acres or more & zoned SU-1, IP, SU-2, PC, or Shopping Center: Certificate of No Effect or Approval
- Site plan and related drawings (folded to fit into an 8.5" by 14" pocket) **6 copies**
- Approved Grading and Drainage Plan (folded to fit into an 8.5" by 14" pocket) **6 copies**
- Solid Waste Management Department signature on Site Plan for Building Permit
- Zone Atlas map with the entire property(ies) clearly outlined
- Letter carefully explaining how each EPC condition has been met **and** a copy of the EPC Notification of Decision
- Infrastructure List, if relevant to the site plan
- Copy of Site Plan with Fire Marshal's stamp (not required for SDP for Subdivision)
- List any original and/or related file numbers on the cover application

Meetings are approximately 8 DAYS after the Tuesday noon filing deadline. **Bring the original to the meeting. Your attendance is required.**

I, the applicant, acknowledge that any information required but not submitted with this application will likely result in deferral of actions.

Deepale Asoori
 Applicant name (print)
08/30/2015
 Applicant signature / date



Form revised October 2007

- Checklists complete
 - Fees collected
 - Case #s assigned
 - Related #s listed
- Application case numbers
15 - DRB - 70318

9-1-15
 Planner signature / date

Project # 1010591

1st September 2015

DRB Chairperson,
City planning department,
Albuquerque, NM

Dear Sir,

We wish to subdivide the lot 5, in the North Albuquerque Acres subdivision at the address 8500 Glendale Ave NE, Albuquerque, NM 87113. It is 0.89 acre lot that we would like to subdivide into 3 lots. We seek your input on the sketch plat that we are submitting along with the zone map.

Please guide us with your expertise in this process.

Thanks,

Deepak Asoori

765 409 2204

Project Number: 1010591

Application Case number: 15DRB-70318

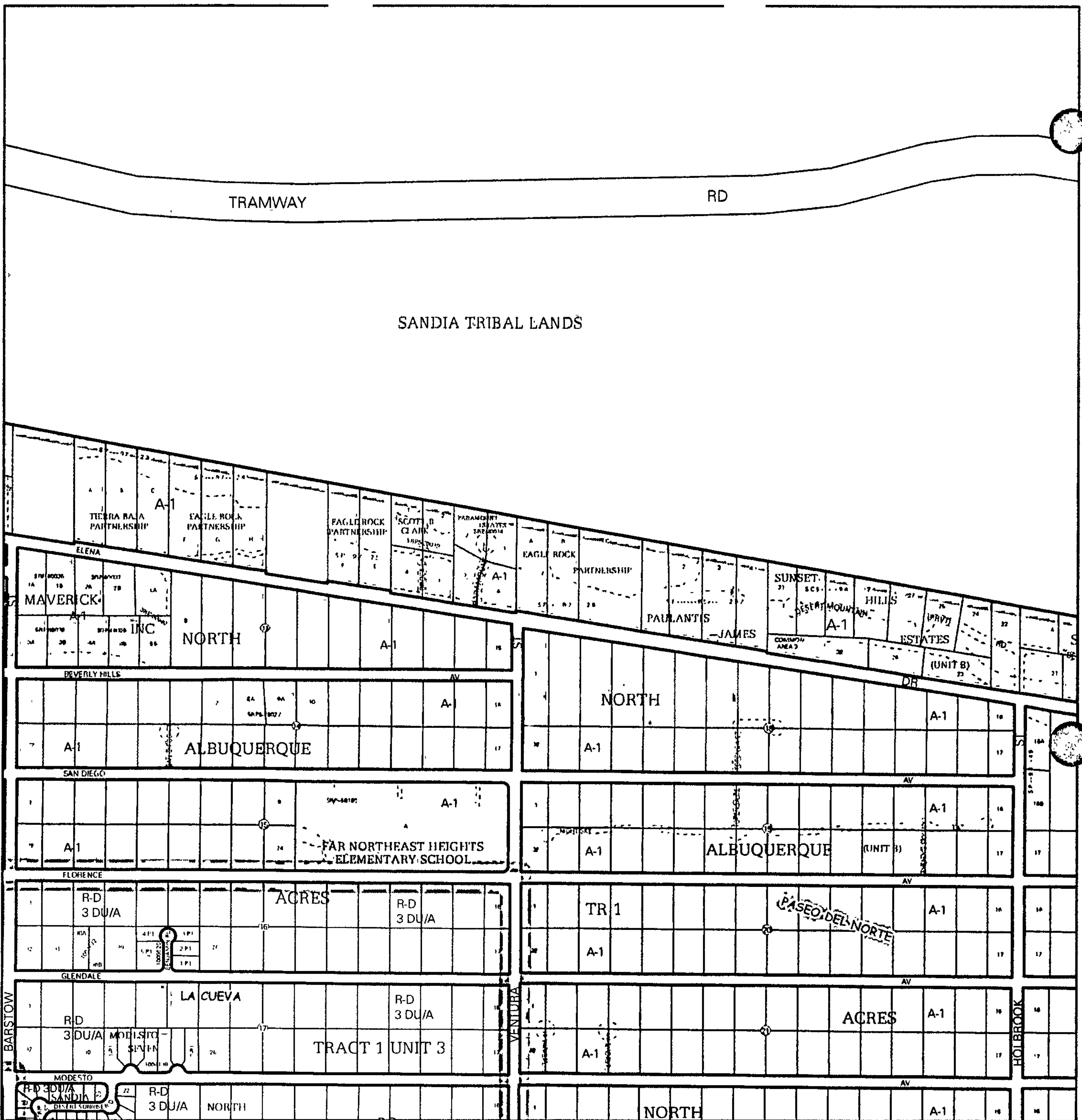

For more current information and details visit <http://www.cabq.gov/gis>

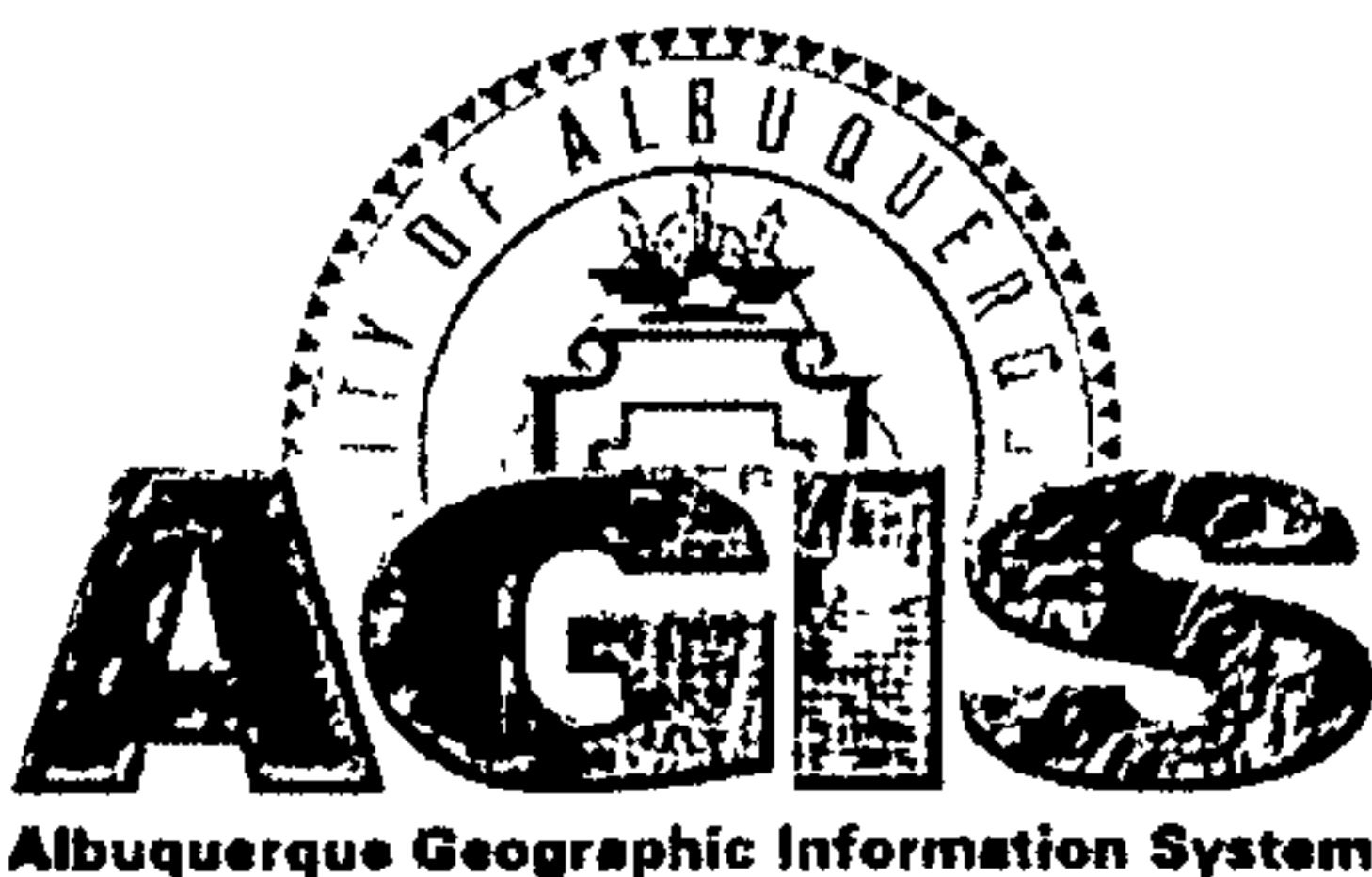

Map amended through: 9/2/2014

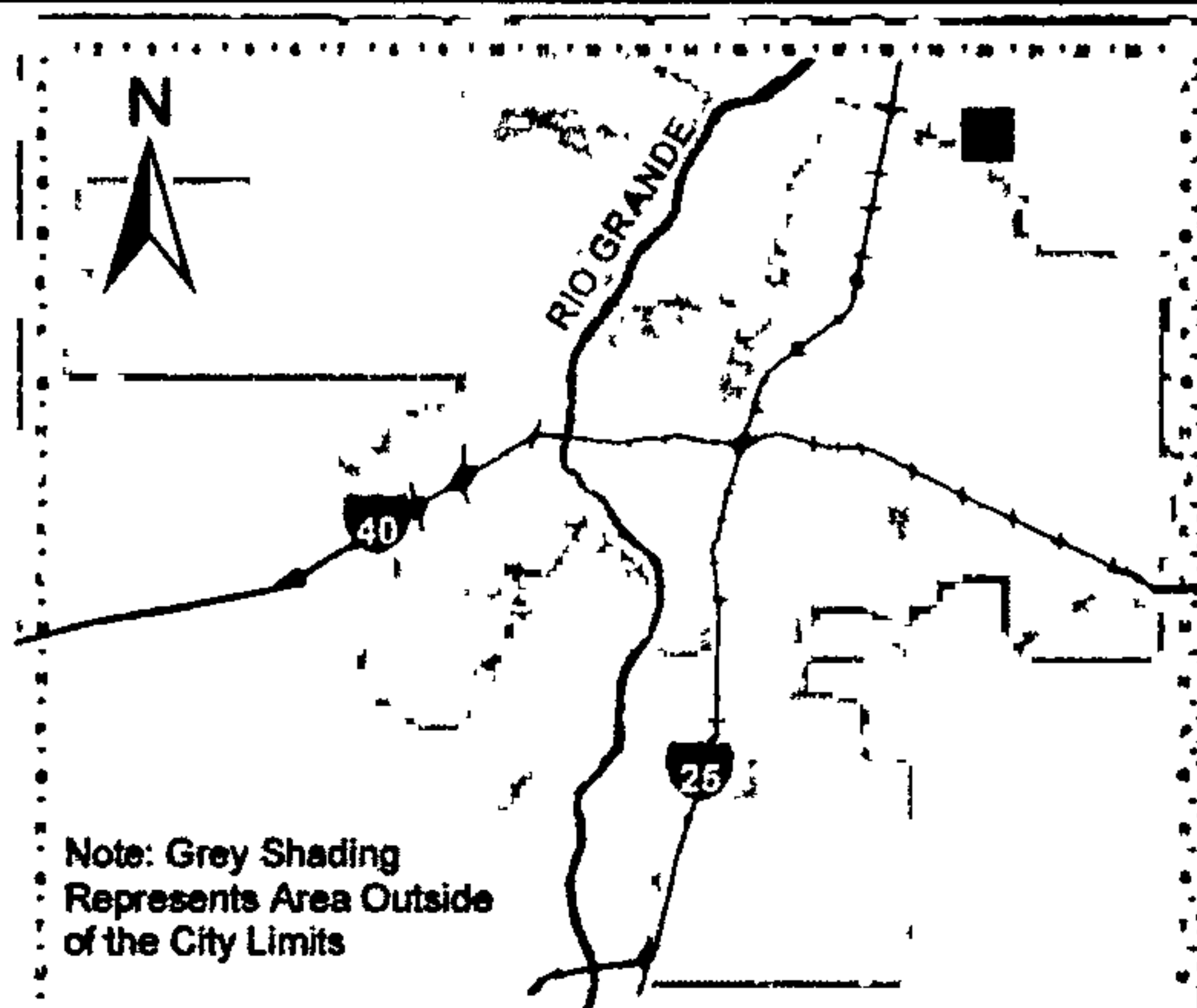

Note: Grey Shading Represents Area Outside of the City Limits

Zone Atlas Page:

B-20-Z

Selected Symbols

- SECTOR PLANS
- Design Overlay Zones
- City Historic Zones
- H-1 Buffer Zone
- Petroglyph Mon.
- Escarpment
- 2 Mile Airport Zone
- Airport Noise Contours
- Wall Overlay Zone

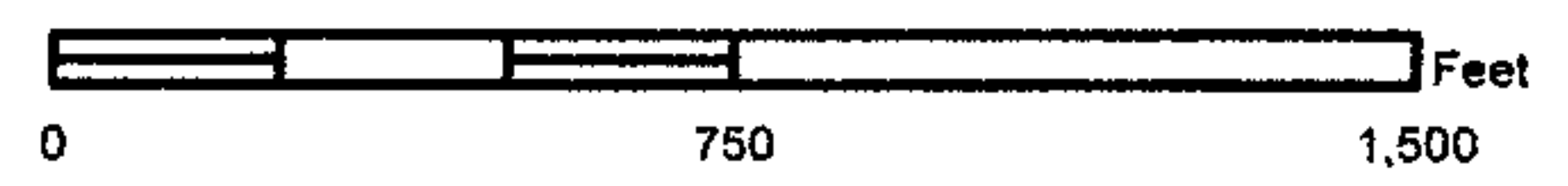

Scale 1" = 10'

Zone B20

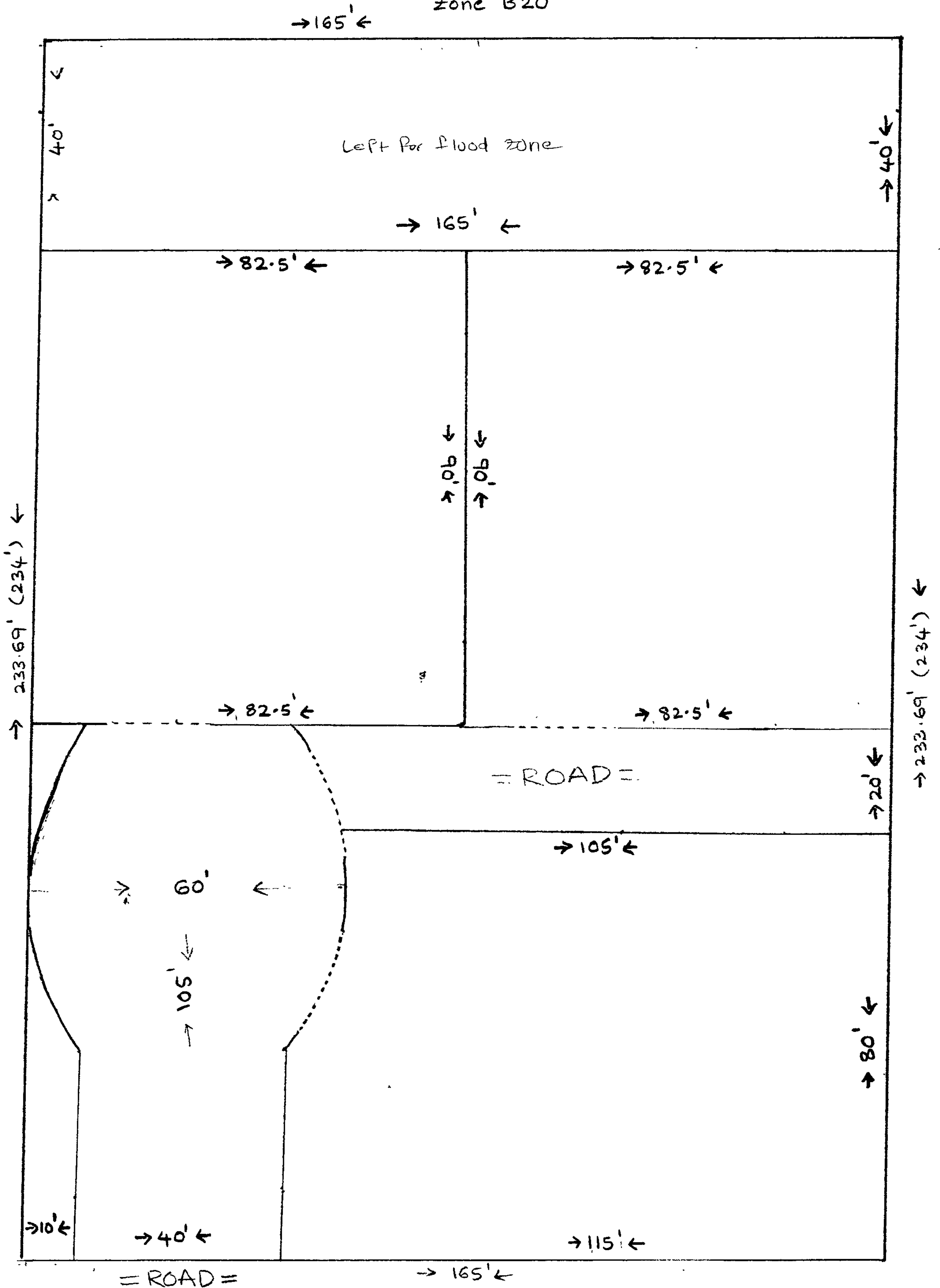
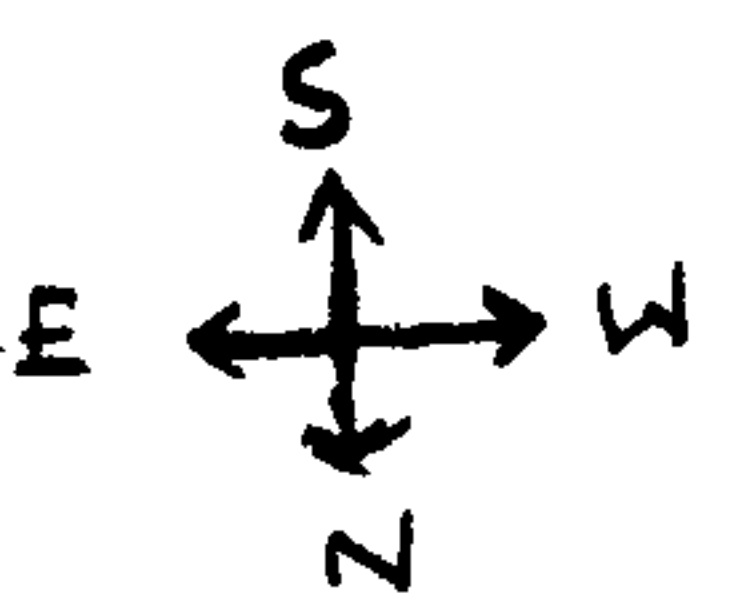

- 8500 Glendale Ave NE -

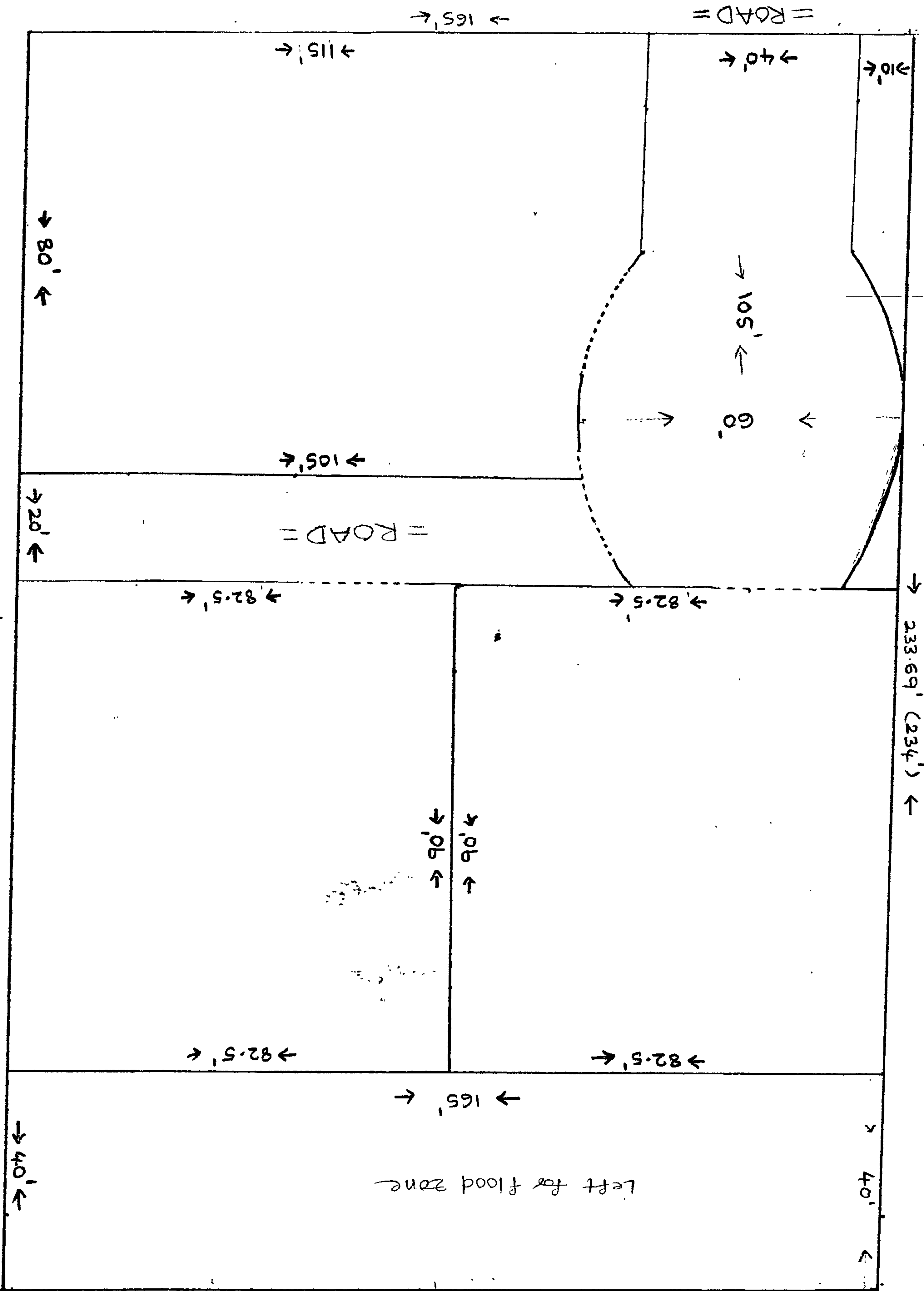

Scale 1" = 10'

Zone B20

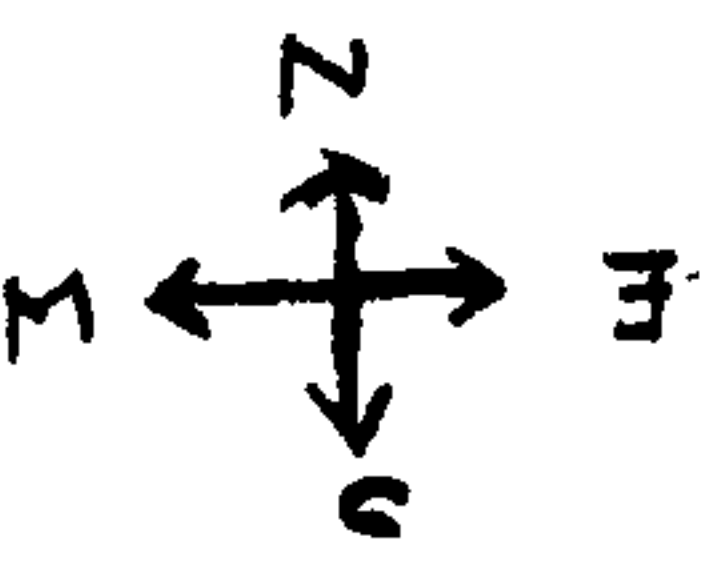

PROJECT #

1650101

September 9, 2015

SK