

Parking Calculation for Site Development Plan for Building Permit

Use	UNIT	RATIO	REQUIRED	PROVIDED
Hospital	68 Clients	1 Space/2 Clients	34	60
	Additional Staff Spaces	N/A	N/A	29
	Visitor Spaces	N/A	N/A	10
	Total Parking		34	99
Motorcycle Spaces		3 spaces per 51-100 auto	3	4
Bicycle		1 space per 20 auto	2	4
ADA Spaces Required		4 spaces per 51-100 auto	4	5

GENERAL NOTES

- ALL EXISTING STRUCTURES, PAVING, FENCING, WALLS, FOUNDATIONS, SIDEWALKS SHOWN HERE ARE TO REMAIN.
- ACCESSIBLE CURB CUTS AND RAMPS PROVIDED THROUGHOUT SITE.
- SEE PLAT FOR ALL EASEMENTS.
- ALL WALLS AND FENCES SHALL CONFORM TO THE REQUIREMENTS OF THE GENERAL HEIGHT AND DESIGN REGULATIONS FOR WALLS, FENCES, AND RETAINING WALLS OF THE ZONING CODE EXCEPT AS NOTED BY KEYED NOTES 31, 32, 33.

SHEET INDEX:

SDP 1.0	SITE DEVELOPMENT PLAN FOR BUILDING PERMIT
SDP 2.0	LANDSCAPE PLAN
SDP 3.0	CONCEPTUAL GRADING & DRAINAGE
SDP 4.0	UTILITY PLAN
SDP 5.0	ELEVATIONS
SDP 5.1	ELEVATIONS
SDP 5.2	SITE DEVELOPMENT DETAILS

- KEYED NOTES**
- PROPERTY LINE, TYP
 - EXISTING LANDSCAPING TO REMAIN
 - EXISTING PARKING LOT AREA LIGHT TO REMAIN
 - EXISTING CONCRETE SIDEWALK TO REMAIN
 - NEW CONCRETE SIDEWALK, WIDTH PER PLAN, PER COA STD. DWG. 2430.
 - EXISTING RETAINING WALLS TO REMAIN. HEIGHT VARIES, REFER TO BUILDING ELEVATIONS.
 - EXISTING FIRE HYDRANT
 - EXISTING BRICK PAVED RAMP (1:20 SLOPE MAX)
 - EXISTING LOADING DOCK TO REMAIN
 - ACCESSIBLE PARKING SPACE, 8' W. x 20' L. SPACE W/5' W. AISLE. (TOTAL OF 3)
 - ACCESSIBLE VAN PARKING, 9' W. x 20' L. SPACE W/9' W. AISLE. (TOTAL OF 2)
 - STANDARD EXISTING PARKING SPACE, 8' W. x 20' L. TYP. (TOTAL OF 93)
 - EXISTING CONCRETE STAIRS WITH HANDRAIL TO REMAIN.
 - BUILDING ON ADJACENT PROPERTY (MORE THAN 20' FROM PROPERTY LINE)
 - MOTORCYCLE SPACE, 4' W. x 8' L. MIN., TYP.
 - EXISTING REFUSE CONTAINERS AND ENCLOSURE
 - NEW GROUND MONUMENT SIGN. REFER TO A2/SDP 5.3
 - EXISTING ELEVATED PLANTER
 - UTILITY EASEMENT
 - EXISTING TRANSFORMER ON CONCRETE PAD
 - EXISTING MECHANICAL UNITS
 - NEW ADA CURB RAMP PER COA STANDARD DETAIL 2440.
 - EXISTING CONCRETE OR ASPHALT PAVING TO REMAIN
 - NEW STANDARD CURB AND GUTTER PER COA STANDARD DETAIL 2415A
 - EXISTING STRIPED AREA ON ASPHALT FOR EMERGENCY VEHICLE PARKING AND LOADING ONLY.
 - NEW 12' HIGH POLE-MOUNTED LIGHT FIXTURE. REFER D2/SDP 5.3
 - NEW 4,709 SF "SENSORY" PLAY AREA WITH WOOD CHIP OR RECYCLED RUBBER TILE SURFACE

- NEW 5,497 SF "ACTIVE" PLAY AREA WITH BASKETBALL GOAL (PORTABLE) OVER EXISTING ASPHALT PAVING.
- NEW 12,860 SF ACTIVITY AREA WITH PLAY EQUIPMENT OVER WOOD CHIP OR RECYCLED RUBBER TILE SURFACE
- EXISTING METAL BIKE RACK TO REMAIN
- 5' WIDE MINIMUM LANDSCAPE SETBACK WITH 6' HIGH (MAX 8'H PER KEY) FENCING WITH PLANTED VINES. REFER TO A4/SDP 5.3
- CHAIN LINK FENCE, MINIMUM 6' HIGH, MAX 8' HIGH PER KEY, GREEN COATED FINISH. REFER TO D4/SDP 5.3
- NEW ORNAMENTAL 8' HIGH MAX. METAL FENCE WITH BLACK PAINTED FINISH. REFER TO B4/SDP 5.3
- 4' WIDE BY 8' HIGH DECORATIVE METAL GATE TO MATCH NEW DECORATIVE METAL FENCE
- 4' WIDE BY 8' HIGH CHAINLINK FENCE GATE TO MATCH NEW CHAINLINK FENCE
- PAIR 20' WIDE BY 8' HIGH CHAINLINK PAIR GATE FOR VEHICULAR ACCESS TO EXISTING LOADING DOCK AREA. GATE TO MATCH NEW CHAINLINK FENCE.
- NEW 5' WIDE LANDSCAPE BUFFER ON THE PUBLIC/STREET SIDE OF NEW FENCING. REFER TO LANDSCAPE PLAN ON SDP 2
- NEW PICNIC AREA WITH CRUSHER FINE OVER BASE COURSE
- NEW 24" HIGH MAX INTERLOCKING LANDSCAPE BLOCK RETAINING WALL. COLOR TO BE TAN.
- NEW PICNIC TABLES AND BENCHES BY OWNER.
- REFUSE CONTAINERS IN LOADING DOCK AREA
- REMOVE 8'W MIN PORTION OF LANDSCAPED AREA TO INFILL NEW CONCRETE SIDEWALK SECTION BETWEEN EXISTING CONCRETE CURB AND GUTTER
- ACCESSIBLE PARKING SIGNS, MOTORCYCLE PARKING SIGNS, OR BICYCLE PARKING SIGNS. REFER TO C5/SDP 1.2
- NEW 15' X 20' PICNIC AREA WITH MULCH GROUND COVER

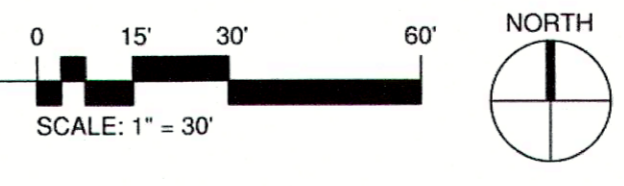
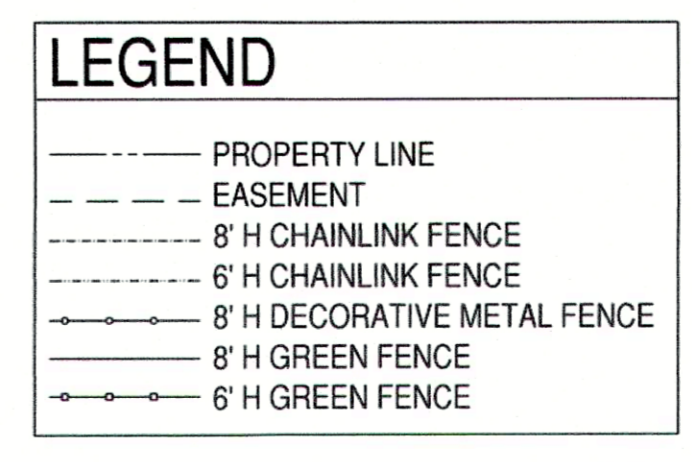

PROJECT NUMBER: _____
APPLICATION NUMBER: _____

DRB SITE DEVELOPMENT PLAN APPROVAL:

TRAFFIC ENGINEERING, TRANSPORTATION DIVISION	DATE _____
UTILITIES DEVELOPMENT	DATE _____
PARKS AND RECREATION DEPARTMENT	DATE _____
CITY ENGINEER	DATE _____
ENVIRONMENTAL HEALTH DEPARTMENT (coord/consul)	DATE _____
SOLID WASTE MANAGEMENT	DATE _____
DRB CHAIRPERSON, PLANNING DEPARTMENT	DATE _____

11-30-16 Bin will need to be on Castors for safe access.

A SITE PLAN
SCALE: 1" = 30'-0"

2415 PRINCETON DR. NE, SUITE G-2
 ALBUQUERQUE, NM 87107
 505.843.7587
 www.designplusllc.com

DESIGN PLUS LLC

BERNALILLO ACADEMY
 1801 RANDOLPH RD SE
 ALBUQUERQUE, NEW MEXICO

DATE: 10/12/2016

REVISIONS

CAD DWG FILE: _____
 DRAWN BY: CA, LS
 CHECKED BY: RE
 COPYRIGHT: DESIGN PLUS, LLC
 SHEET TITLE

SITE DEVELOPMENT PLAN FOR BUILDING PERMIT

V.3
 SDP 1.0
 SHEET _____ OF _____