

MASSEY WAREHOUSE - PRE FABRICATED METAL BUILDING

8410 Washington St NE, BLDG C, Albuquerque, NM 87113

FIRE DEPARTMENT HYDRANT AND ACCESS PERMIT REVIEW CHECKLIST
INTERNATIONAL BUILDING CODE (IBC) 2009
NEW MEXICO GENERAL CONSTRUCTION BUILDING CODE 2009
INTERNATIONAL FIRE CODE (IFC) 2010

CONSTRUCTION TYPE SECTION 602.2 & TABLE 601
TYPE IIB - NON-SPRINKLER (SECTION 903.2.4)

BUILDING SQUARE FOOTAGE = TOTAL BUILDING 8400SF

OCCUPANCY SECTION 306
STORAGE S-2 LOW-HAZARD STORAGE

ALLOWABLE AREAS TABLE 503
TYPE II B, S-2 OCCUPANCY 3 STORY/26,000 SF

ALLOWABLE HEIGHTS TABLE 503
TYPE II B, S-2 OCCUPANCY, THREE STORIES MAXIMUM HEIGHT 55FT.
ACTUAL BUILDING HEIGHT = 1 STORY @ 30'-0"

FIRE ALARM BOXES SECTION 907.2.4
MANUAL FIRE ALARM BOX NOT REQUIRED

FIRE EXTINGUISHERS SECTION 906.3
ORDINARY (MODERATE) 2-A / 1,500 SF MAX AREA / 75' FEET MAX DISTANCE = 6 EXTINGUISHERS REQUIRED

OCCUPANT LOAD FACTORS FOR EGRESS TABLE 1004.1.1
WAREHOUSE 500 SF GROSS/OCC.
BUSINESS 100 SF GROSS/OCC

PROPOSED TOTAL OCCUPANT LOAD
WAREHOUSE = 8136 SF / 500 = 17 OCC.
BUSINESS = 284 SF / 100 = 3 OCC.
TOTAL OCCUPANT LOAD 20

- FIRE FLOW REQUIREMENT** IFC APPENDIX B
2,000 GPM
- NUMBER OF HYDRANTS REQUIRED AND SPACING** IFC APPENDIX C
NUMBER OF HYDRANTS: 2
AVERAGE SPACING BETWEEN HYDRANTS (450' REQUIRED): 147' BETWEEN HYDRANTS
- APPARATUS ACCESS** IFC 503.1.1
SHALL EXTEND TO WITHIN 150' OF ALL PORTIONS OF THE FIRST FLOOR
- APPARATUS ROAD DIMENSIONS** IFC 503.2.1
WIDTH NO LESS THAN 20'
NO HEIGHT RESTRICTIONS
- DEAD END** IFC 503.2.5
EXCEED 150' TURN AROUND PROVIDED/ MAX DEAD END 117' W/O TURN AROUND
- SECURITY GATES** IFC 503.6
KNOX BOW PROVIDED
- FIRE LANES** IFC D103.6.1 AND 2
PROVIDE FIRE LANES AS REQUIRED BY FIRE DEPARTMENT
- PREMISE ID** IFC 505
PROVIDE 14" LETTERING - "BLDG C" ON WEST ELEVATION OF BUILDING
- KNOX BOX** IFC 506
PROVIDE KNOX BOX FOR FIRE DEPARTMENT ACCESS
- ACCESS AND LOADING** APP D SEC D102.1
DRIVING SURFACE A CAPABLE OF SUPPORTING 75,000 LBS
- ACCESS ROAD WIDTH WITH HYDRANT** APP D SEC D103.1
MINIMUM ROAD WIDTH 26'
- GRADE** APP D SEC D103.2
MAXIMUM 10% SLOPE
- TURNING RADIUS** APP D SEC D103.3
MINIMUM TURNING RADIUS 28'
- FIRE HYDRANT SYSTEM** IFC 507.5.1
HYDRANT WITHIN 400' OF BUILDING
- PARKING** CITY ORD 507.6
NO OBSTRUCTION WITHIN 15' OF FIRE HYDRANT

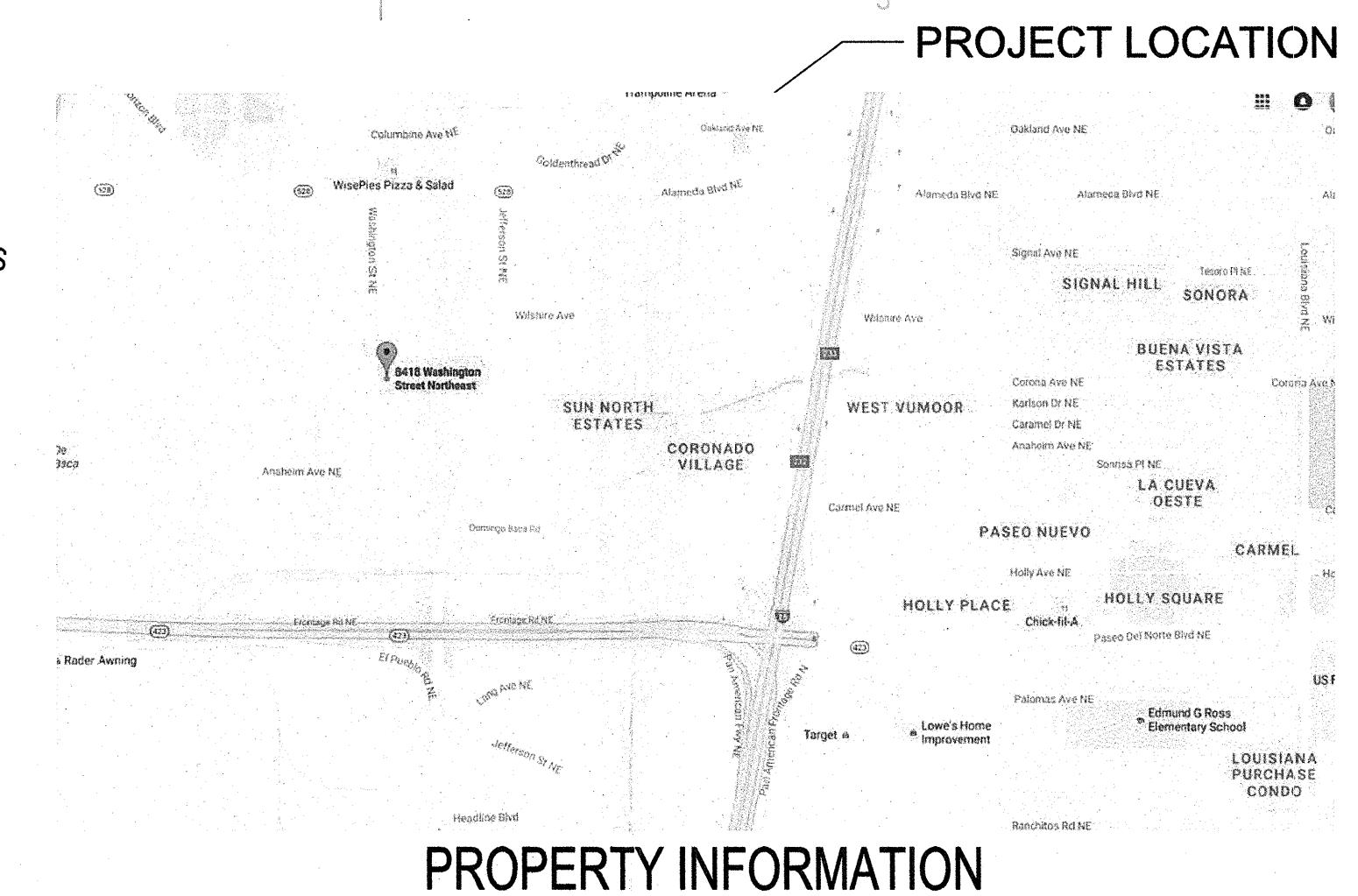

PROPERTY INFORMATION

UPC: 101706428620541101
OWNER: MMR LLC
SITE ADDRESS: 8410 WASHINGTON ST NE ALBUQUERQUE 87113
LEGAL DESCRIPTION: LT F-1 PLAT OF LANDS OF LOS ANGELES INVESTORS LOTS E-1, E-2 & F-1 CONT 2.1231 AC
ACRES: 2.1231
ZONING: M-1 OR SU-2 C
LAND USE CLASSIFICATION CATEGORY: INDUSTRIAL / WHOLESALE / MANUFACTURING
ZONE GRID: C17

STUDIO SW ARCHITECTS

STUDIO SOUTHWEST ARCHITECTS, INC.
2101 Mountain Rd. NW, Albuquerque, NM 87104
505.843.9639 fax 505.843.9683
Web Site: www.studioswarch.com
E-Mail: mail@studioswarch.com

© 2009, Studio Southwest Architects, Inc. Duplication or reproduction by any means without the express written consent of Studio Southwest Architects, Inc. is a violation of Federal and International law. The information contained on this document is the intellectual property of Studio Southwest, Inc. and all rights thereto are Reserved. For exceptions, refer to the Owner-Architect Agreement.

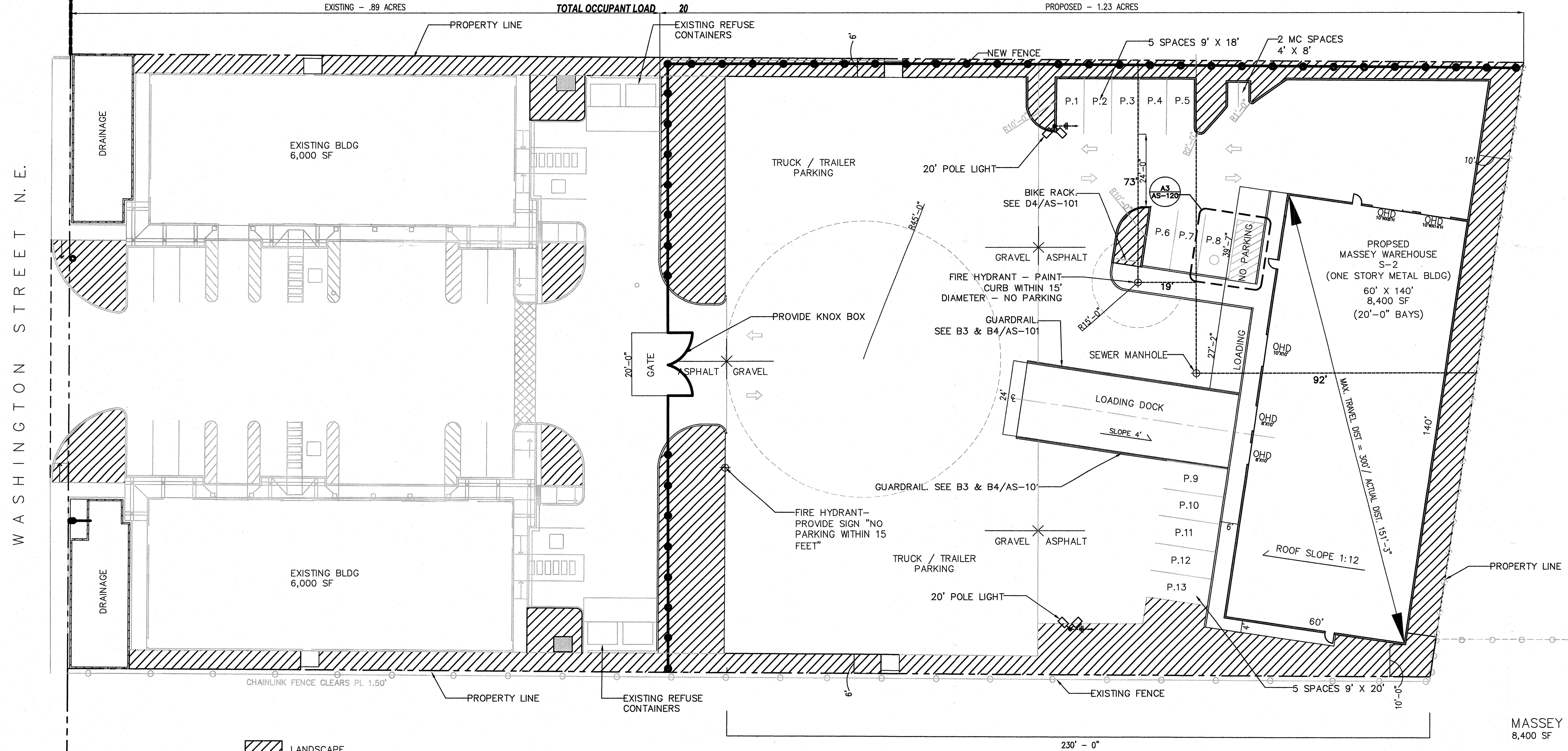

MASSEY WAREHOUSE SITE INFO
8,400 SF
13 PARKING SPACES PROVIDED
PARKING REQUIRED - 1 SPACE PER 2,000 SF WAREHOUSE = 5 SPACES REQUIRED

A1 SITE PLAN 1" = 20'-0"

CONSULTANTS

Architect	Engineer
-----------	----------

MASSEY WAREHOUSE

8410 WASHINGTON ST NE, BLDG C
ALBUQUERQUE, NM 87113

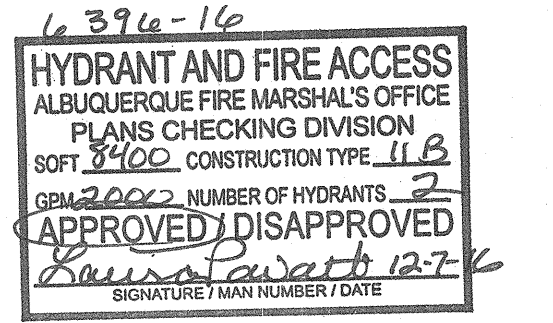

MARK	DATE	DESCRIPTION
ISSUE:		DRB
PROJECT NO:		1630
CAD DWG FILE:		Massey Warehouse
DRAWN BY:		
CHECKED BY:		
DATE:		11/29/2016

SHEET TITLE
FIRE DEPARTMENT REVIEW SHEET 1

FIRE 1