

EXISTING FIRE HYDRANT

CODE ANALYSIS

APPLICABLE CODES

INTERNATIONAL BUILDING CODE 2009
 INTERNATIONAL EXISTING BUILDING CODE 2009
 2009 NEW MEXICO COMMERCIAL BUILDING CODE
 2009 NEW MEXICO EXISTING BUILDING CODE

A. PROJECT SCOPE:

The project is a site development plan submittal for an existing site and building for a zone change request to change a C-1 zone to an SU-1 zone. The POKI-POKI Restaurant is has been permitted and is currently under construction. The Red Door Taproom is currently under review for a building permit.

B. USE AND OCCUPANCY CLASSIFICATION:

POKI-POKI Restaurant & Red Door Taproom Section 303- Assembly Group A-2
 Vacant Space Section 304 - Business Occupancy Group B

C. ALLOWABLE BUILDING AREA:

(Table 503)
 B Type VB = 9,000 SF allowed 6,893 SF (EXISTING BUILDING)

D. SEISMIC INFORMATION

EXISTING BUILDING IS SEISMIC CATEGORY "D"

E. OCCUPANT LOAD

(Table 1004.1.1)
 Red Door Taproom A2 Occupancy
 Indoor & Patio Dining - 96 Occupants (Based on actual tables & seating)
 Bar Staff = 2
 A2 Occupant Load = 98 Occupants
 POKI-POKI Restaurant A2 Occupancy
 Indoor & Patio Dining - 82 Occupants (Based on actual tables & seating)
 Kitchen - 490/200 = 3 Occupants
 Wait Staff = 3
 Bar Staff = 1
 A2 Occupant Load = 89 Occupants
 Vacant space future occupant load = 2915/200 = 15 Occupants
 TOTAL PROJECTED BUILDING OCCUPANT LOAD = 202 OCCUPANTS

F. BUILDING ELEMENTS

(Table 601 Fire resistance rating requirements for building elements)
 B Type VB

1. Structural Frame	0 Hours
2. Bearing Walls - Exterior	0 Hours
3. Bearing Walls - Interior	0 Hours
4. Non Bearing Walls and Partitions - Interior	0 Hours
5. Floor Construction	0 Hours
6. Roof Construction	0 Hours

G. FIRE PROTECTION SYSTEM

(Section 903 Automatic Sprinkler Systems)
 903.2.1.12 Group A2
 Sprinkler System is not required - Fire Area POKI-POKI & Red Door is < 5000 SF each and Occupant load is < 100 for each.

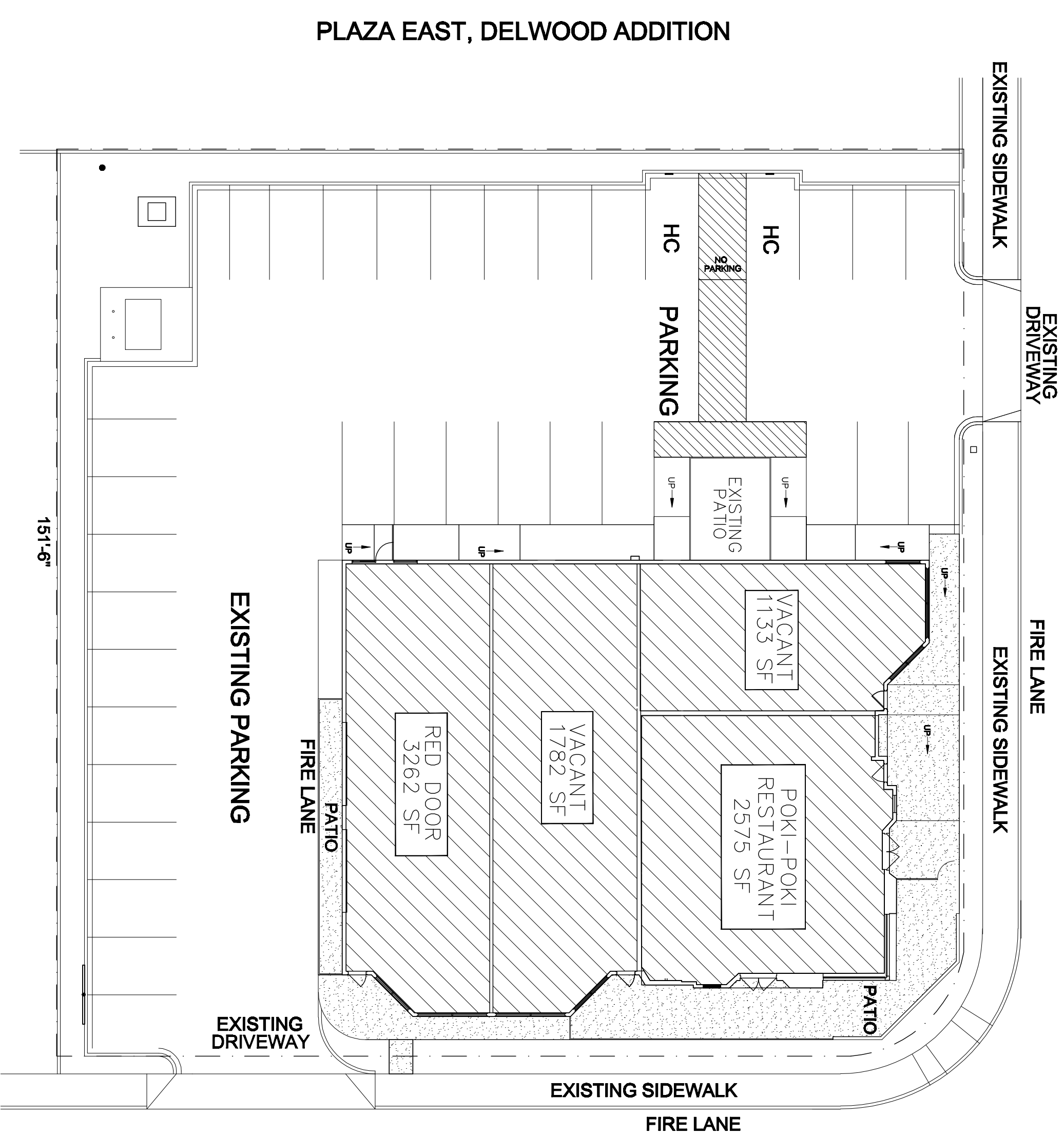

7500 COMANCHE ROAD NE
 (86' PUBLICLY DEDICATED RIGHT-OF-WAY)

3517 WYOMING BOULEVARD NE
 (106' PUBLICLY DEDICATED RIGHT-OF-WAY)

FIRE 1 PLAN

TRACT C, DELWOOD ADDITION

1/16" = 1'-0"

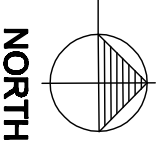

GENERAL NOTES:
 A. CITY OF ALBUQUERQUE FIRE CODE SECTION 505.3, COMMERCIAL BUILDING PREMISE IDENTIFICATION SHALL BE 10-INCHES HIGH WITH A MINIMUM OF 2-INCH BRUSH STROKES ON A CONTRASTING BACKGROUND. THE ADDRESS SHALL BE VISIBLE FROM THE STREET OR THE ROAD FRONTING ON THE PROPERTY.

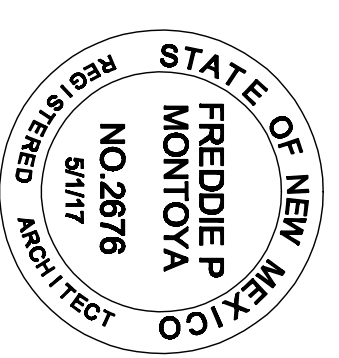

**SITE DEVELOPMENT PLAN SUBMITTAL
 FOR AN EXISTING SITE AT 3517 WYOMING BLVD. NE**

MARCH 29, 2017
 (REVISED MAY 1)
 (2017)
**FIRE 1
 PLAN**