

TREE PLANTING DETAIL

PREPARE HOLE TO BE 18\"/>

1. PREPARE HOLE FROM 18\"/>
- 2. PREPARE HOLE FROM 18\"/>
- 3. PREPARE HOLE FROM 18\"/>
- 4. PREPARE HOLE FROM 18\"/>
- 5. PREPARE HOLE FROM 18\"/>
- 6. PREPARE HOLE FROM 18\"/>
- 7. PREPARE HOLE FROM 18\"/>
- 8. PREPARE HOLE FROM 18\"/>
- 9. PREPARE HOLE FROM 18\"/>
- 10. PREPARE HOLE FROM 18\"/>

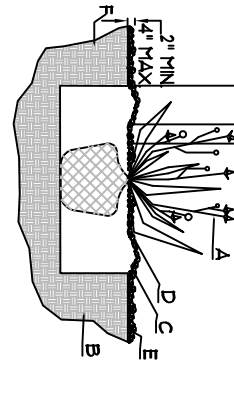

SHRUB PLANTING DETAIL

PREPARE HOLE TO BE 18\"/>

1. PREPARE HOLE FROM 18\"/>
- 2. PREPARE HOLE FROM 18\"/>
- 3. PREPARE HOLE FROM 18\"/>
- 4. PREPARE HOLE FROM 18\"/>
- 5. PREPARE HOLE FROM 18\"/>
- 6. PREPARE HOLE FROM 18\"/>
- 7. PREPARE HOLE FROM 18\"/>
- 8. PREPARE HOLE FROM 18\"/>
- 9. PREPARE HOLE FROM 18\"/>
- 10. PREPARE HOLE FROM 18\"/>

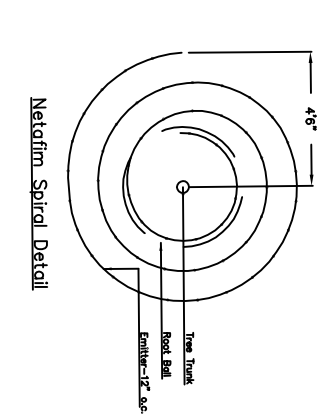

Point of connection for irrigation system is at center of lawn. Location of controller to be field determined and power source for controller to be provided by others. Irrigation maintenance shall be the responsibility of the Property Owner. Water and Power source shall be the responsibility of the Developer/Builder.

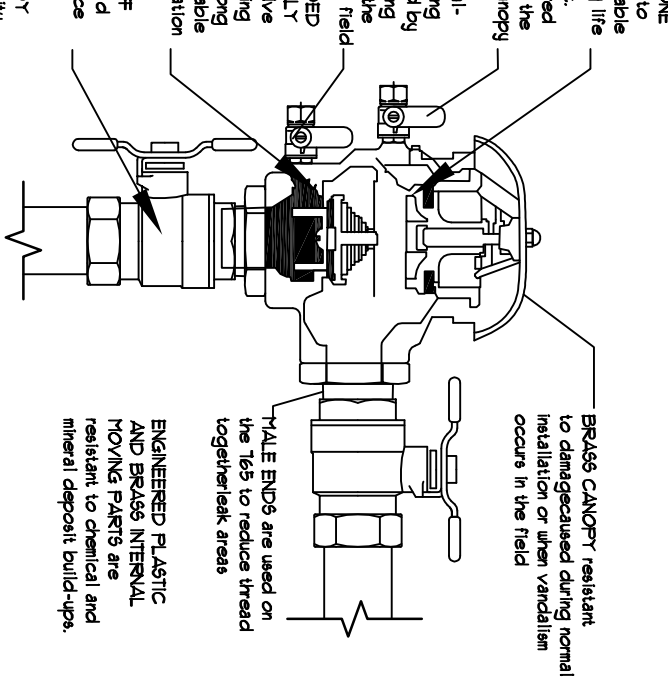

FEBCO MODEL 765

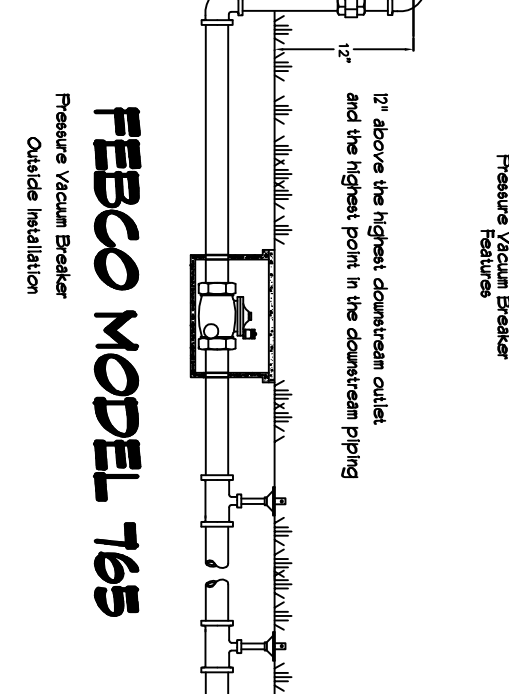

Pressure Vacuum Breaker Outside Installation

Pasadena Ave NE (60' R/W)

LOT 12

LOT 13

EXISTING U OF P

Lot 10-A, Block 3
NAA Tract A, Unit B
(67107, 07C-157)

Portion of
Lot 21, Block 3
NAA Tract A, Unit B
(122105, 05B-118)

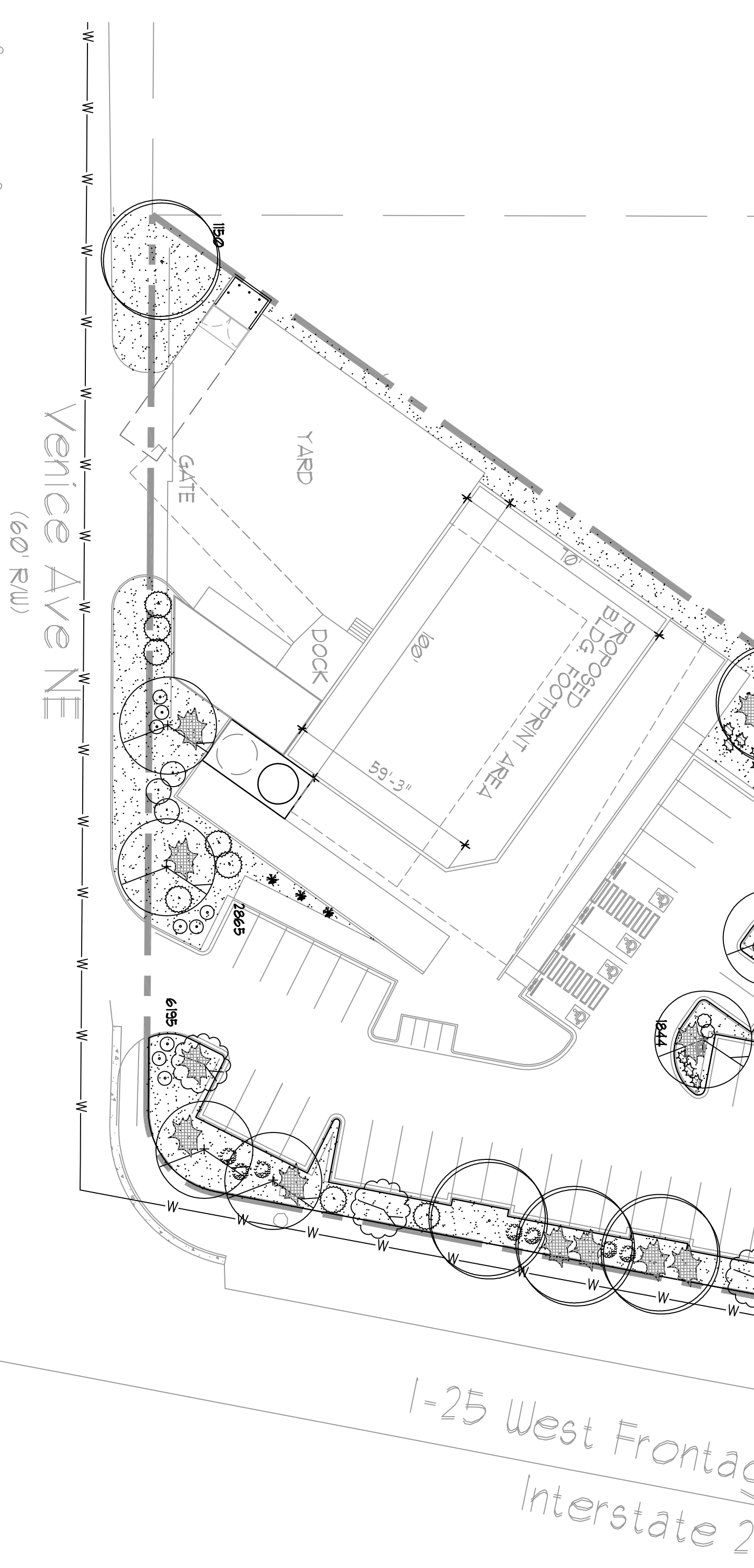

LANDSCAPE PLAN FOR BUILDING PERMIT

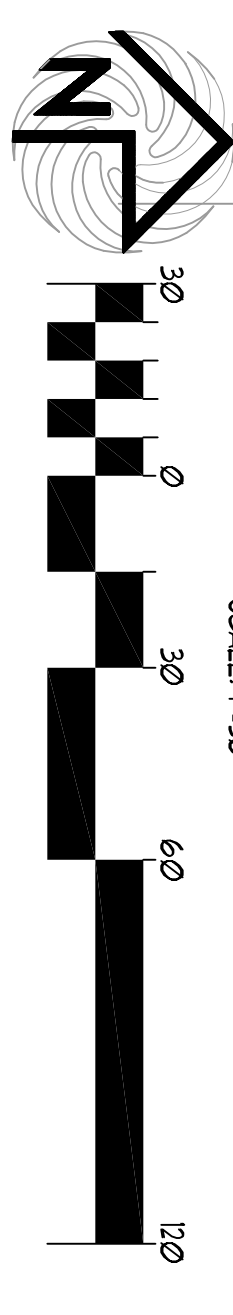

LANDSCAPE LEGEND

QTY	SIZE	COMMON/BOTANICAL	H2O USE
Trees			
13	2' gal	Chinese Pistache Forsyia sp.	1275 15075 14
9	2' gal	Honey Locust Gleditsia triacanthos	2075 18275 14
2	6-8'	Australian Pine Pinus nigra	6175 1250 14
1	15 gal	Cape Myrtle Lagerstroemia indica	400 400 14
2	4-6'	Palm Yucca Yucca faxoniana	36 12 14
1	15 gal	Oxleyana Redbud Cercis reniformis	144 1200 14
3	15 gal	Desert Willow Chilopsis linearis	675 1875 14 38775
Shrubs & Groundcovers			
5	5 gal	Spanish Broom Corydalis x clivodensis	1020 100 500 14
21	5 gal	India Hawthorn Raphanopsis indica	345 75 675 14
6	5 gal	Feather Reed Grass Cortaderia undulata	252 4 64 14
2	5 gal	Car-least Yucca Cercocarpus ledifolius	1545 275 450 14
1	5 gal	Butterfly Bush Buddleia davidii	545 75 25 14
28	5 gal	Buffalo Juniper Juniperus sibirica	142 144 402 14
3	5 gal	Cherry Sage Salvia greggii	243 9 71 14
23	5 gal	Cappari Sage Roso sp.	243 9 207 14
11	5 gal	Blue Yucca Corydalis x clivodensis	343 9 99 14
23	5 gal	Fern Bush Chromolaena mollifolia	546 36 828 14
11	5 gal	Apache Plume Fallugia paradoxa	647 49 539 14
5	5 gal	Chamisa Chrysothamnus nauseosus	547 49 245 14
11	2-3ct	Boulders to be placed at contractor's discretion	1691
11811		Landscape Gravel / Filter Fabric 3/4" Crushed Gray	
400		Oversize Cobble 2-4" Gray	

LANDSCAPE CALCULATIONS

TOTAL LOT AREA (S ²)	76471
TOTAL BUILDING AREA (S ²)	45800
TOTAL LOT AREA (S ²)	68971
LANDSCAPE REQUIREMENT	X.25
TOTAL LANDSCAPE REQUIRED (S ²)	93871
TOTAL ON-SITE LANDSCAPE PROVIDED	11871
TOTAL LIVE GROUNDCOVER PROVIDED	5361
TOTAL LIVE GROUNDCOVER REQUIRED	16491
TOTAL LIVE MATERIAL PROVIDED	15403
TOTAL LIVE MATERIAL REQUIRED	46446

MODULUS ARCHITECTS

100 SUN AVE. N.W. SUITE 305
ALBUQUERQUE, NEW MEXICO 87109
PHONE (505) 338-1499 FAX (505) 338-1498

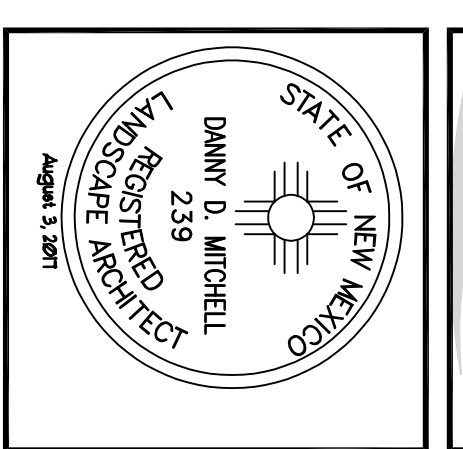

PROJECT TITLE BOSQUE-1-25 NW of 1-25 FRONTAGE RD AND VENICE AVENUE ALBUQUERQUE, NEW MEXICO			
PROJECT MANAGER STEPHEN DUNBAR, AIA	JOB NO. BOSQUE-125	DRAWN BY: S	
SHEET TITLE LANDSCAPE PLAN FOR BUILDING PERMIT			
DATE 07/19/2011	SCALE 1" = 1'	REVISION 01	SCALE 1" = 1'