

1

2

3

4

A

B

C

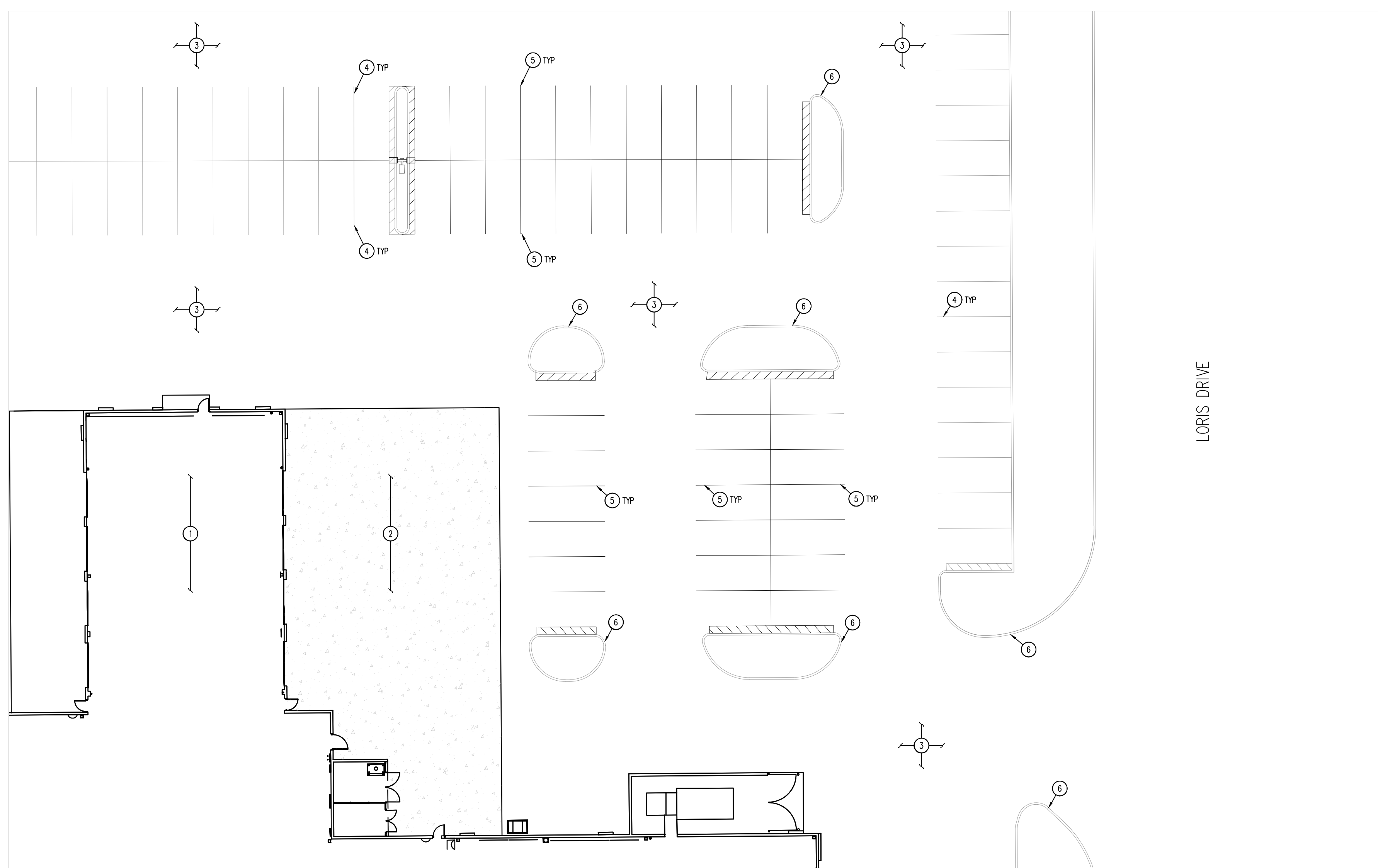

DEMOLITION PLAN – EXISTING PARKING  
SCALE: 1"=10'

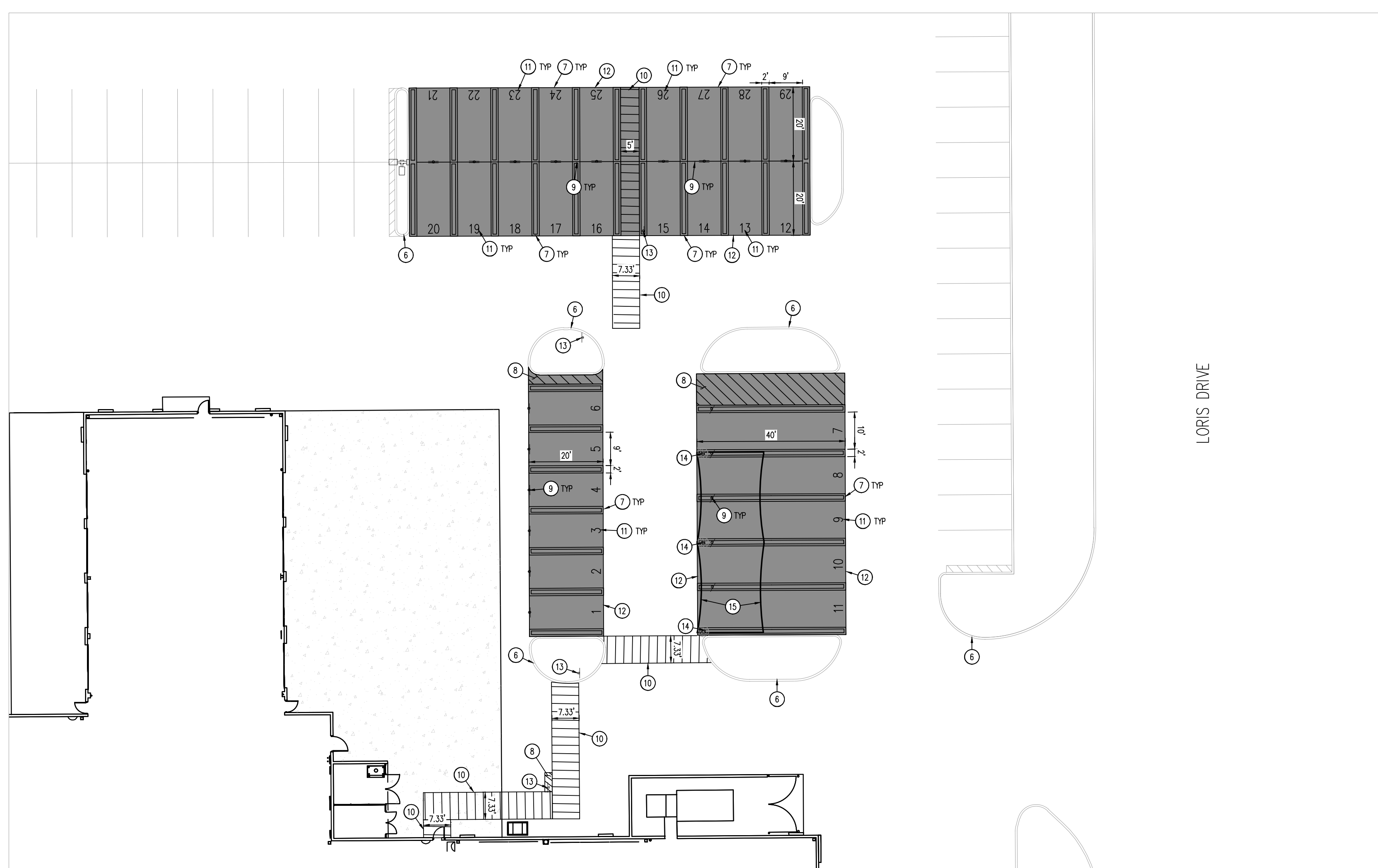

SITE PLAN – PROPOSED PICKUP PARKING  
SCALE: 1"=10'

DEMOLITION NOTES

1. THE CONTRACTOR IS RESPONSIBLE FOR THE DEMOLITION, REMOVAL AND DISPOSAL (IN A LOCATION APPROVED BY ALL GOVERNING AUTHORITIES) ALL STRUCTURES, PAIS, WALLS, FENCES, FOUNDATIONS, PARKING, DRIVEWAYS, DRAINAGE STRUCTURES, UTILITIES, ETC. SUCH THAT THE IMPROVEMENTS SHOWN ON THE PROPOSED PLANS CAN BE CONSTRUCTED. ALL FACILITIES TO BE REMOVED SHALL BE UNDERCUT TO SUITABLE MATERIAL AND BROUGHT TO GRADE WITH SUITABLE COMPACTED FILL MATERIAL FOR THE SPECIFICATIONS. PRIOR TO DEMOLITION OCCURRING, ALL EROSION CONTROL DEVICES ARE TO BE INSTALLED.
2. THE CONTRACTOR IS RESPONSIBLE FOR REMOVING ALL DEBRIS FROM THE SITE AND DISPOSING THE DEBRIS IN A LAWFUL MANNER. THE CONTRACTOR IS RESPONSIBLE FOR OBTAINING ALL PERMITS REQUIRED FOR DEMOLITION AND DISPOSAL.
3. THE CONTRACTOR SHALL COORDINATE WITH RESPECTIVE UTILITY COMPANIES PRIOR TO THE REMOVAL AND/OR RELOCATION OF UTILITIES. THE CONTRACTOR SHALL COORDINATE WITH THE UTILITY COMPANY CONCERNING PORTIONS OF WORK WHICH MAY BE PERFORMED BY THE UTILITY COMPANY THEMSELVES AND ANY FEES WHICH ARE TO BE PAID TO THE UTILITY COMPANY FOR THEIR SERVICES. THE CONTRACTOR IS RESPONSIBLE FOR PAYING ALL FEES AND CHARGES.
4. THE LOCATIONS OF ALL EXISTING UTILITIES SHOWN ON THIS PLAN HAVE BEEN DETERMINED FROM THE BEST INFORMATION AVAILABLE AND ARE GIVEN FOR THE CONVENIENCE OF THE CONTRACTOR. THE ENGINEER ASSUMES NO RESPONSIBILITY FOR THEIR ACCURACY. PRIOR TO THE START OF ANY DEMOLITION ACTIVITY, THE CONTRACTOR SHALL NOTIFY THE UTILITY COMPANIES FOR MARKING ON-SITE LOCATIONS OF EXISTING UTILITIES.
5. ALL EXISTING SEWERS, PIPING AND UTILITIES SHOWN ARE NOT TO BE INTERPRETED AS THE EXACT LOCATION, OR AS THE ONLY OBSTACLES THAT MAY OCCUR ON THE SITE. VERIFY EXISTING CONDITIONS AND PROCEED WITH CAUTION AROUND ANY ANTICIPATED FEATURES. ONE NOTICE TO ALL UTILITY COMPANIES REGARDING DESTRUCTION AND REMOVAL OF ALL SERVICE LINES AND CAP ALL LINES BEFORE PROCEEDING WITH THE WORK. UTILITIES DETERMINED TO BE ABANDONED AND LEFT IN PLACE SHALL BE GROUTED IF UNDER BUILDING.
6. CONTRACTOR MUST PROTECT THE PUBLIC AT ALL TIMES WITH FENCING, BARRICADES, ENCLOSURES, ETC. (AND OTHER APPROPRIATE BEST MANAGEMENT PRACTICES) AS APPROVED BY CITY AND OWNER. SHOULD REMOVAL AND/OR RELOCATION ACTIVITIES DAMAGE EXISTING FACILITIES TO REMAIN, THE CONTRACTOR SHALL PROVIDE NEW MATERIALS/ STRUCTURES IN ACCORDANCE WITH THE CONTRACT DOCUMENTS, EXCEPT FOR MATERIALS DESIGNED TO BE RELOCATED ON THIS PLAN. ALL OTHER CONSTRUCTION MATERIALS SHALL BE NEW DAMAGE TO ALL EXISTING CONDITIONS TO REMAIN WILL BE REPLACED AT CONTRACTOR'S EXPENSE.
7. CONTRACTOR SHALL LIMIT SAW-CUT & PAVEMENT REMOVAL TO ONLY THOSE AREAS WHERE IT IS REQUIRED AS SHOWN ON THESE CONSTRUCTION PLANS, BUT IF ANY DAMAGE IS INCURRED ON ANY OF THE SURROUNDING PAVEMENT, ETC. THE CONTRACTOR SHALL BE RESPONSIBLE FOR ITS REMOVAL AND REPAIR.
8. IT IS THE CONTRACTOR'S RESPONSIBILITY TO CONTACT THE VARIOUS UTILITY COMPANIES WHICH MAY HAVE BURIED OR AERIAL UTILITIES WITHIN OR NEAR THE CONSTRUCTION AREA BEFORE COMMENCING WORK. THE CONTRACTOR SHALL PROVIDE 72 HOURS MINIMUM NOTICE TO ALL UTILITY COMPANIES PRIOR TO BEGINNING CONSTRUCTION.
9. ALL EXISTING UTILITIES SHOWN ARE LOCATED ACCORDING TO THE INFORMATION AVAILABLE TO THE ENGINEER AT THE TIME THE DRAWINGS WERE PREPARED AND HAVE NOT BEEN INDEPENDENTLY VERIFIED BY THE OWNER OR THE ENGINEER. GUARANTEE IS NOT MADE THAT ALL EXISTING UNDERGROUND UTILITIES ARE SHOWN OR THAT THE LOCATION OF THOSE SHOWN ARE ACCURATE. FINDING THE ACTUAL LOCATION OF ANY EXISTING UTILITIES IS THE CONTRACTOR'S RESPONSIBILITY AND SHALL BE DONE BEFORE HE COMMENCES ANY WORK IN THE VICINITY. FURTHERMORE, THE CONTRACTOR SHALL BE SOLELY RESPONSIBLE FOR ANY AND ALL DAMAGE DUE TO THE CONTRACTOR'S FAILURE TO EXACTLY LOCATE AND PREPARE ANY AND ALL UNDERGROUND UTILITIES. THE OWNER OR ENGINEER WILL ASSUME NO LIABILITY FOR ANY DAMAGES SUSTAINED OR COST INCURRED BECAUSE OF THE OPERATIONS IN THE VICINITY OF EXISTING UTILITIES OR STRUCTURES, NOR FOR TEMPORARY BRACING AND SHORING OF SAME. IF IT IS NECESSARY TO SHORE, BRACE, SWING OR RELOCATE A UTILITY, THE UTILITY COMPANY OR DEPARTMENT AFFECTED SHALL BE CONTACTED BY THE CONTRACTOR AND THEIR PERMISSION OBTAINED REGARDING THE METHOD TO USE FOR SUCH WORK.
10. THE CONTRACTOR SHALL HAVE AVAILABLE AT THE JOB SITE AT ALL TIMES ONE COPY OF THE CONTRACT DOCUMENTS INCLUDING PLANS, SPECIFICATIONS, COPIES OF ANY REQUIRED CONSTRUCTION PERMITS, AND EROSION CONTROL PLANS AND INSPECTION REPORTS (SWPPP).
11. ANY DISCREPANCIES ON THE DRAWINGS SHALL BE IMMEDIATELY BROUGHT TO THE ATTENTION OF THE OWNER/ENGINEER BEFORE COMMENCING WORK. NO FIELD CHANGES OR DEVIATIONS FROM DESIGN ARE TO BE MADE WITHOUT PRIOR APPROVAL OF THE OWNER AND NOTIFICATION TO THE ENGINEER. NO CONSIDERATION WILL BE GIVEN TO CHANGE ORDERS FOR WHICH THE OWNER AND ENGINEER WERE NOT CONTACTED PRIOR TO CONSTRUCTION OF THE AFFECTED ITEM.
12. CONTRACTOR SHALL COMPLY TO THE FULLEST EXTENT WITH THE LATEST OSHA STANDARDS FOR EXCAVATION AND TROWING PROCEDURES. CONTRACTOR SHALL USE SUPPORT SYSTEMS, SLOPING, BRACING, ETC. AS NECESSARY FOR THESE OPERATIONS, AND SHALL COMPLY WITH ALL OSHA PERFORMANCE CRITERIA.
13. DO NOT INTERRUPT EXISTING UTILITIES SERVING FACILITIES OCCUPIED AND USED BY THE OWNER OR OTHERS DURING OCCUPIED HOURS EXCEPT WHEN SUCH INTERRUPTIONS HAVE BEEN AUTHORIZED IN WRITING BY THE OWNER AND THE LOCAL MUNICIPALITIES. INTERRUPTIONS SHALL ONLY OCCUR AFTER ACCEPTABLE TEMPORARY SERVICE HAS BEEN PROVIDED.
14. ANY RECYCLED MATERIAL TO BE STOCKPILED ON THE SITE SHALL BE STORED IN AS SMALL AN AREA AS PRACTICAL AND THE LOCATION OF ANY STOCKPILE SHALL BE WELL CLEAR OF THE BUILDING PAD AREA AND THE LOCATION MUST BE PRE-APPROVED BY THE ENGINEER AND OWNER PRIOR TO STOCKPILING.
15. QUANTITIES SHOWN HERE ARE APPROXIMATE AND ARE PROVIDED FOR CONVENIENCE ONLY AND NOT FOR BID PURPOSES. CONTRACTOR SHALL VERIFY QUANTITIES NECESSARY TO DEMO FACILITIES SHOWN.
16. ASBESTOS OR HAZARDOUS MATERIAL, IF FOUND ON SITE, SHALL BE REMOVED BY A LICENSED HAZARDOUS MATERIAL CONTRACTOR. REFERENCE ARCHITECTURAL PLANS FOR LIMITS OF BUILDING DEMOLITION.

SITE NOTES

1. ALL WORK AND MATERIALS SHALL COMPLY WITH ALL CITY/COUNTY REGULATIONS AND CODES AND O.S.H.A. STANDARDS.
2. CONTRACTOR SHALL REFER TO THE ARCHITECTURAL PLANS FOR EXACT LOCATIONS AND DIMENSIONS OF VESTIBULES, SLOPE PAVING, SIDEWALKS, EXIT PORCHES, TRUCK DOCKS, PRECISE BUILDING DIMENSIONS AND EXACT BUILDING UTILITY ENTRANCE LOCATIONS.
3. ALL DIMENSIONS ARE TO THE FACE OF CURB UNLESS OTHERWISE NOTED.
4. EXISTING STRUCTURES WITHIN CONSTRUCTION LIMITS ARE TO BE ABANDONED, REMOVED OR RELOCATED AS NECESSARY. ALL COST SHALL BE INCLUDED IN BASE BID.
5. CONTRACTOR SHALL BE RESPONSIBLE FOR ALL RELOCATIONS, (UNLESS OTHERWISE NOTED ON PLANS) INCLUDING BUT NOT LIMITED TO, ALL UTILITIES, STORM DRAINAGE, SIGNS, TRAFFIC SIGNALS & POLES, ETC. AS REQUIRED. ALL WORK SHALL BE IN ACCORDANCE WITH GOVERNING AUTHORITIES REQUIREMENTS AND PROJECT SITE WORK SPECIFICATIONS AND SHALL BE APPROVED BY SUCH. ALL COST SHALL BE INCLUDED IN BASE BID.
6. THE SITE WORK FOR THIS PROJECT SHALL MEET OR EXCEED "THE SITE SPECIFIC SPECIFICATIONS".

PICKUP EXTERIOR SIGN SCHEDULE		
DESCRIPTION	DIMENSIONS	QUANTITY
WAITING SPACES LEFT	18 X 24	X
WAITING SPACES RIGHT	18 X 24	X
WAITING SPACES AHEAD	18 X 24	X
RESERVED WAITING	18 X 24	X
PICKUP LEFT PHARMACY RIGHT	18 X 24	X
PICKUP RIGHT PHARMACY LEFT	18 X 24	X
STOP THANKS FOR ORDERING	18 X 36	X
PICKUP HOURS	18 X 36	29
RESERVED	18 X 18	29
PHONE NUMBER	8 X 18	29
VERTICAL PICKUP	18 X 36	29
PICKUP LEFT	18 X 24	2
PICKUP AHEAD	18 X 24	3
PICKUP RIGHT	18 X 24	2

ALL PICKUP WAYFINDING AND STALL SIGNS ARE WALMART SUPPLIED AND CONTRACTOR INSTALLED. CONTRACTOR TO PLACE SIGN ORDER AT LEAST 3 WEEKS IN ADVANCE. ORDER SHALL BE SENT VIA EMAIL TO GETTY THOMAS (getty.thomas@walmart.com) AND BRAD KENER (bradley.kener@walmart.com). REQUEST SHALL CONTAIN A DELIVERY ADDRESS, DESIRED DELIVERY DATE, AND ANY SITE SPECIFIC SIGN SIZE AND/OR COLORS BASED ON APPROVED PLANS.



KEY MAP  
APPROX. 1" = 400'

LEGEND

- EXISTING ASPHALT PAVEMENT TO REMAIN
- EXISTING CONCRETE PAVEMENT TO REMAIN
- SEAL COAT LIMITS
- PROPOSED SIGN

SITE & DEMOLITION SCHEDULE

1. EXISTING WALMART BUILDING TO REMAIN.
2. EXISTING CONCRETE PAVEMENT TO REMAIN.
3. EXISTING ASPHALT PAVEMENT TO REMAIN.
4. EXISTING STRIPPING TO REMAIN.
5. EXISTING STRIPPING TO BE REMOVED.
6. EXISTING CURB AND GUTTER TO REMAIN.
7. PROPOSED 4" WIDE, SOLID YELLOW PARKING LOT STRIPPING.
8. PROPOSED 4" WIDE, SOLID YELLOW PARKING LOT STRIPPING, 2" O.C. @ 45" WITH 4" PERIMETER STRIPE.
9. PROPOSED PICKUP SIGNAGE, SIGN POST, AND BOLLARD (REF SITE DETAILS).
10. NEW CROSSWALK MARKINGS - 4" WIDE PAINTED WHITE STRIPING PARALLEL TO DIRECTION OF TRAFFIC AT 2'-0" O.C. AND (1)-8" WHITE STRIPE PERPENDICULAR TO BOTH ENDS UNLESS NOTED OTHERWISE. SEE SITE PLAN FOR DIMENSIONS (REF SITE DETAILS).
11. PROPOSED PICKUP NUMBER PAVEMENT MARKING (REF SITE DETAILS).
12. PROPOSED SEAL COAT OVER EXISTING PAVEMENT.
13. PROPOSED PEDESTRIAN CROSSING SIGNAGE AND BOLLARD BASE, MATCH EXISTING PEDESTRIAN CROSSING SIGNAGE ON SITE (W1-5B OR W1-2 & W16-7P).
14. PROPOSED CANOPY FOOTING (REF STRUCTURAL PLANS).
15. PROPOSED SALVAGED CANOPY (REF ARCHITECTURAL DRAWINGS).

CAUTION – NOTICE TO CONTRACTOR

1. ALL UTILITY LOCATIONS SHOWN ARE BASED ON MAPS PROVIDED BY THE APPROPRIATE UTILITY COMPANY AND FIELD SURFACE EVIDENCE AT THE TIME OF SURVEY AND IS TO BE CONSIDERED AN APPROXIMATE LOCATION ONLY. IT IS THE CONTRACTOR'S RESPONSIBILITY TO FIELD VERIFY THE FIELD LOCATION OF ALL UTILITIES, PUBLIC OR PRIVATE, WHETHER SHOWN ON THE PLANS OR NOT, PRIOR TO CONSTRUCTION. REPORT ANY DISCREPANCIES TO THE ENGINEER PRIOR TO CONSTRUCTION.
2. WHERE A PROPOSED UTILITY CROSSES AN EXISTING UTILITY, IT IS THE CONTRACTOR'S RESPONSIBILITY TO FIELD VERIFY THE HORIZONTAL AND VERTICAL LOCATION OF SUCH EXISTING UTILITY, EITHER THROUGH POT-HOLING OR ALTERNATIVE METHOD. REPORT INFORMATION TO THE ENGINEER PRIOR TO CONSTRUCTION.

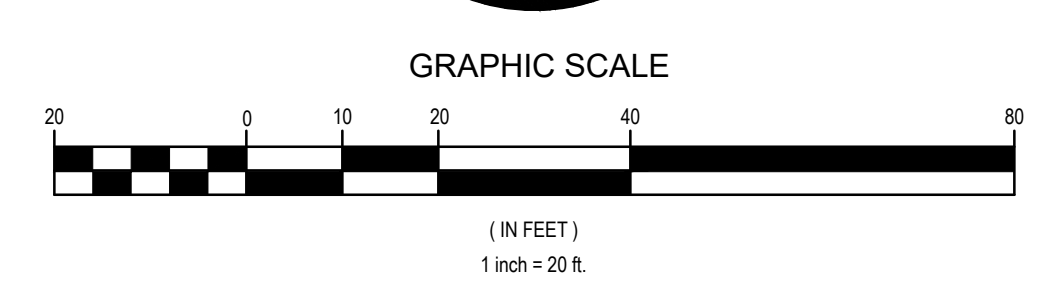
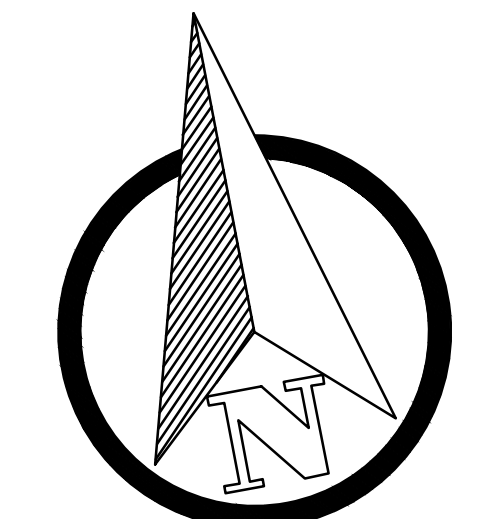

**Galloway**  
1755 Idaho Drive, Suite 107  
Albuquerque, NM 87102  
760.883.2225  
galloway.com

STIPULATION FOR REUSE  
THIS DRAWING WAS PREPARED FOR  
ALBUQUERQUE, NM. IT IS NOT  
TO BE REUSED FOR ANY OTHER  
PROJECT WITHOUT THE WRITTEN  
CONSENT OF THE ENGINEER.  
UNLESS ARCHITECTS AND ENGINEERS  
ADVISE ON ANYTHING PREPARED IS NOT  
TO BE REUSED FOR ANY OTHER  
PROJECT WITHOUT THE WRITTEN  
CONSENT OF THE ENGINEER.



**Walmart**  
ALBUQUERQUE (S), NM  
3500 COORS BLVD SW  
STORE NO: 05430-248  
JOB NUMBER: SG0A05430-20 (PROTO)  
2021 MAJOR PROJECT

ISSUE BLOCK		
Δ	PR #	01/21/21

CHECKED BY:	RCJ
DRAWN BY:	DJS
PROTO CYCLE:	09/25/20
DOCUMENT DATE:	01/21/21

**PROPOSED  
PICKUP  
DEMOLITION  
&  
SITE PLAN**

SHEET:  
**CS2**