

LEGAL DESCRIPTION:
 PARCEL E-1-A, PANORAMA HEIGHTS ADDITION
 UPC NO: 102205847502241515

SITE DATA

ZONING	MX-M
PROPOSED USAGE	EDUCATIONAL
TOTAL LOT AREA	214146 SF (4.91 ACRES)

PARKING PARCEL E-1-A-2

LOT AREA	75002 SF (1.72 AC)
PROPOSED BUILDING AREA	43500 SF
TOTAL PARKING REQUIRED	18 ELEMENTARY SCHOOL CLASSROOMS (2 SPACES PER CLASSROOM)
	36 SPACES REQUIRED

TOTAL BICYCLE SPACES REQUIRED	4 SPACES (10% OF REQUIRED SPACES)
TOTAL MOTORCYCLE SPACES REQUIRED	2 SPACES
PROVIDED	
PARKING PROVIDED	132 SPACES
HC PARKING REQUIRED	2 SPACES
HC SPACES PROVIDED	4 SPACES (1 VAN ACCESSIBLE)
MOTORCYCLE SPACES PROVIDED	2 SPACES
BICYCLE SPACES PROVIDED	15 SPACES
LANDSCAPE REQUIRED	6300 SF (20% NET AREA)
LANDSCAPE PROVIDED	10010 SF

PARCEL E-1-A-1

LOT AREA	139144 SF (3.19 AC)
EXISTING BUILDING AREA	55000 SF
20 MIDDLE SCHOOL CLASSROOMS (2 SPACES PER CLASSROOM)	
10 HIGH SCHOOL CLASSROOMS (3 SPACES PER CLASSROOM)	
	70 SPACES REQUIRED
TOTAL BICYCLE SPACES REQUIRED	7 SPACES (10% OF REQUIRED SPACES)
TOTAL MOTORCYCLE SPACES REQUIRED	2 SPACES

PROVIDED	
PARKING PROVIDED	116 SPACES
HC PARKING REQUIRED	2 SPACES
HC SPACES PROVIDED	4 SPACES (1 VAN ACCESSIBLE)
MOTORCYCLE SPACES PROVIDED	2 SPACES
BICYCLE SPACES PROVIDED	10 SPACES
LANDSCAPE REQUIRED	16828 SF (20% NET AREA)
LANDSCAPE PROVIDED	20706 SF

LINE TABLE

LINE	BEARING	LENGTH
L1	N89°22'27"E	706.37
L2	S2°32'56"E	63.13
L3	S55°53'54"W	96.58
L5	N89°18'57"W	64.56
L6	S87°49'59"E	350.00
L8	S88°26'22"E	120.14
L9	N1°29'15"W	333.89

CURVE TABLE

CURVE	DELTA	RADIUS	LENGTH
C1	58°27'34"	79.97	81.60
C2	58°27'24"	119.96	122.39
C3	93°06'15"	24.99	40.61
C4	19°28'13"	90.50	30.75
C5	17°36'32"	156.25	48.02

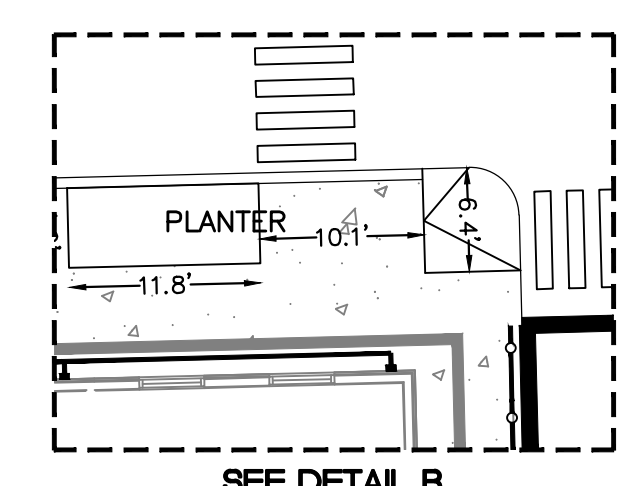
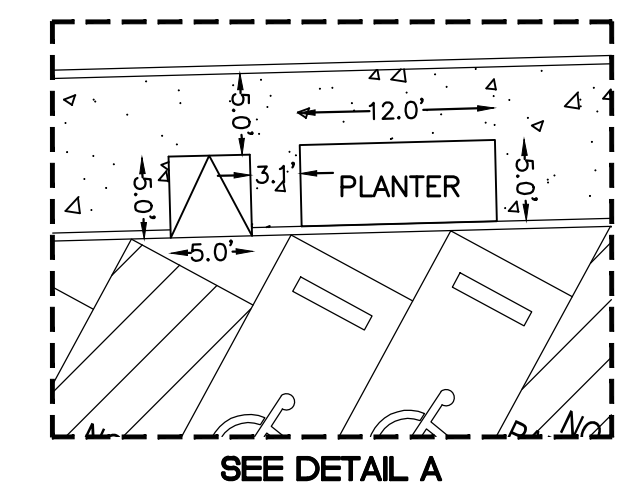
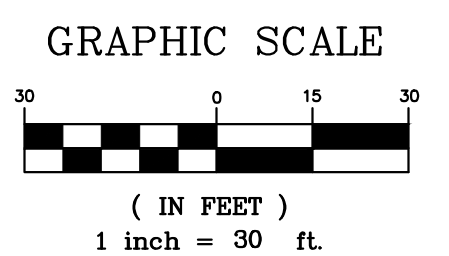
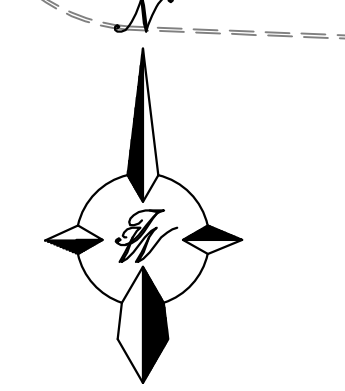

- LEGEND**
- CURB & GUTTER
 - BOUNDARY LINE
 - - - EASEMENT
 - ▭ BUILDING
 - ▬ SIDEWALK
 - ▬ CONCRETE WALL
 - - - EXISTING CURB & GUTTER
 - - - EXISTING BOUNDARY LINE
 - - - EXISTING BLOCK WALL
 - EXISTING WROUGHT IRON FENCE
 - PARKING LOT LIGHT
 - PEDESTRIAN HAND RAIL
 - - - FIRE LANE STRIPING SEE SHEET SP-2

- KEYED NOTES**
- ① ACCESSIBLE PARKING PER ADA STANDARDS (1.0% MIN - 2.0% MAX SLOPE) AISLE "NO PARKING" LETTERING SHALL BE CAPITAL LETTERS AT LEAST 1" HIGH AND AT LEAST 2" WIDE, PLACED AT THE REAR OF THE PARKING SPACE SO AS TO BE CLOSE TO WHERE AN ADJACENT VEHICLE'S REAR TIRE WOULD BE PLACED (66-1-4.1.B NMSA 1978)
 - ② CURB AND GUTTER PER COA STD DWG 2415A
 - ③ 6' PEDESTRIAN CROSSWALK
 - ④ EXISTING CURB
 - ⑤ PARKING LOT LIGHT (TYP)
 - ⑥ EXISTING ISLAND
 - ⑦ EXISTING GATE
 - ⑧ BICYCLE RACK (15)
 - ⑨ EXISTING DUMPSTER
 - ⑩ EXISTING PYLON SIGN (TO BE REMOVED)
 - ⑪ ACCESSIBLE RAMP
 - ⑫ CONCRETE SIDEWALK
 - ⑬ CONCRETE TRANSFORMER PAD
 - ⑭ PLAYGROUND
 - ⑮ CMU BLOCK WALL W/HANDRAIL
 - ⑯ MOTORCYCLE PARKING W/SIGN (TYP)
 - ⑰ NEW 5" SIDEWALK
 - ⑱ ACCESSIBLE PARKING SIGN (TYP)
 - ⑲ NOT USED
 - ⑳ EXISTING WROUGHT IRON FENCE
 - ㉑ EXISTING BLOCK WALL
 - ㉒ BOUNDARY LINES
 - ㉓ NEW DIGITAL SCHOOL SIGN
 - ㉔ NEW 6" SIDEWALK
 - ㉕ NEW 10' SIDEWALK
 - ㉖ EXISTING RETAINING WALL TO BE REMOVED
 - ㉗ PLANTER (TYP)
 - ㉘ SHEET PILE RETAINING WALL
 - ㉙ NEW RETAINING WALL
 - ㉚ 2' CURB CUT
 - ㉛ PEDESTRIAN HAND RAIL
 - ㉜ SIDEWALK CULVERT PER COA STD DWG 2236 (TYP)
 - ㉝ NEW FIRE HYDRANT
 - ㉞ FDC
 - ㉟ SIGN "ONE WAY" R6-1
 - ㊱ COMPACT CAR SPACE (12 TOTAL) SEE DETAIL SHEET SP-2
 - ㊲ EXISTING CURB TO BE REMOVED
 - ㊳ EXISTING ACCESSIBLE RAMP WITH DETECTABLE SURFACE
 - ㊴ GUARD RAIL SEE SHEET SP-3 FOR DETAIL

TRAFFIC CIRCULATION LAYOUT
 APPROVED
 [Signature]
 7/22/2020

	ABQ SCHOOL OF EXCELLENCE ADMINISTRATIVE AMENDMENT TRAFFIC CIRCULATION LAYOUT	DRAWN BY pm DATE 7-20-2020 DRAWING 2019068-SP SHEET # SP-1
	ENGINEER'S SEAL RONALD R. BOHANNAN P.E. #7868 7-20-2020	TIERRA WEST, LLC 5571 MIDWAY PARK PL NE ALBUQUERQUE, NEW MEXICO 87109 (505) 858-3100 www.tierrawestllc.com

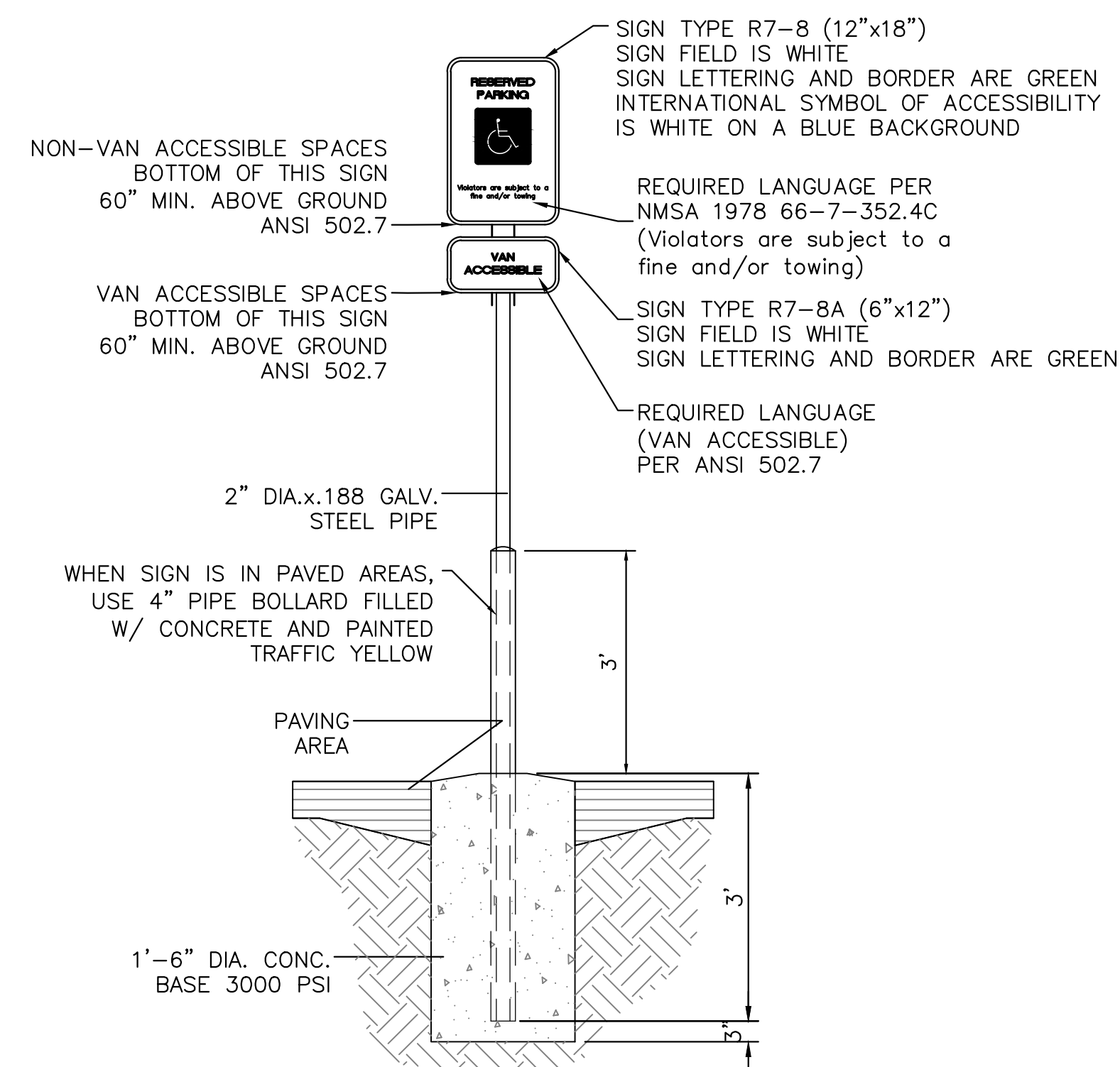

ACCESSIBLE PARKING SIGN
NTS

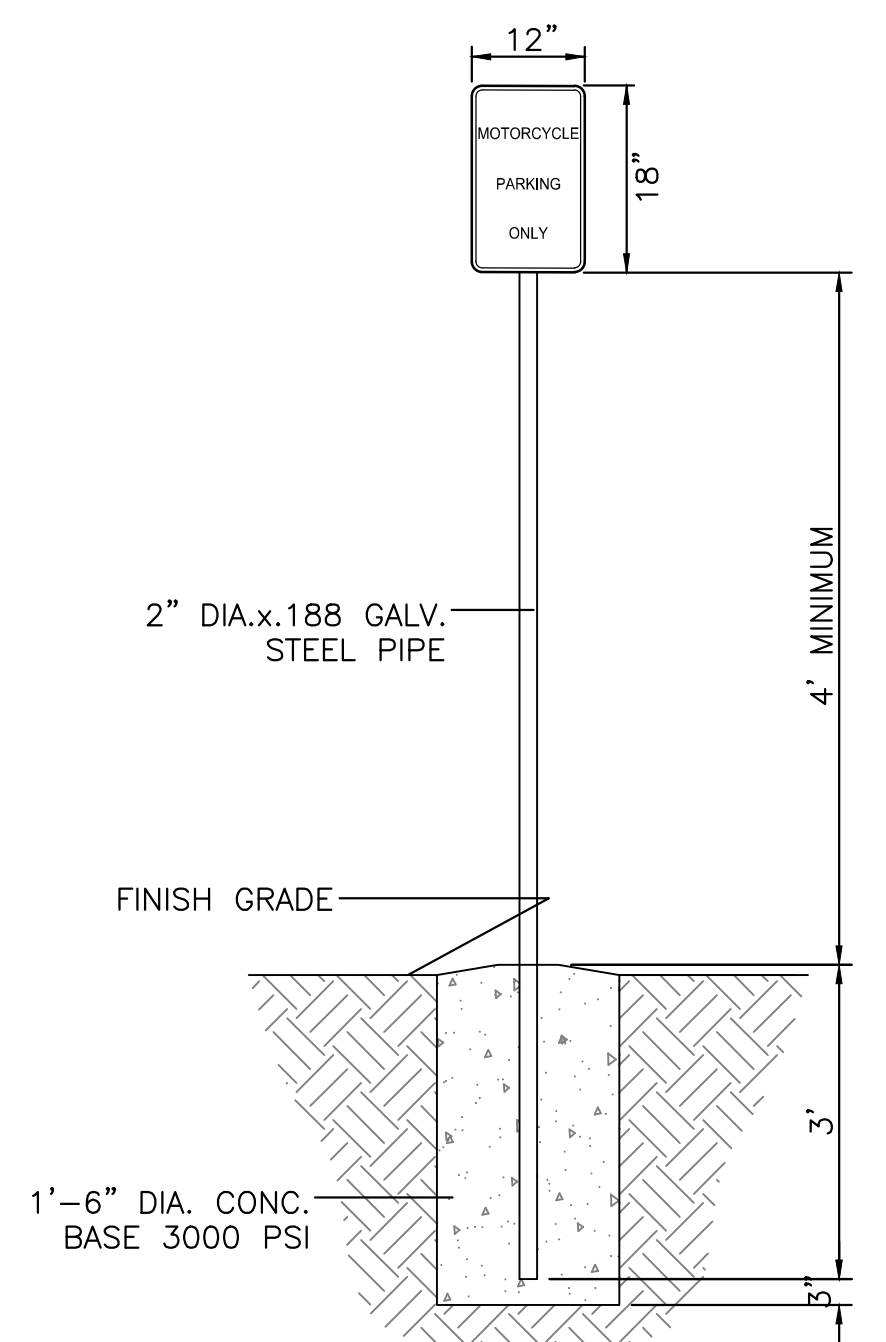

MOTORCYCLE PARKING SIGN
NTS

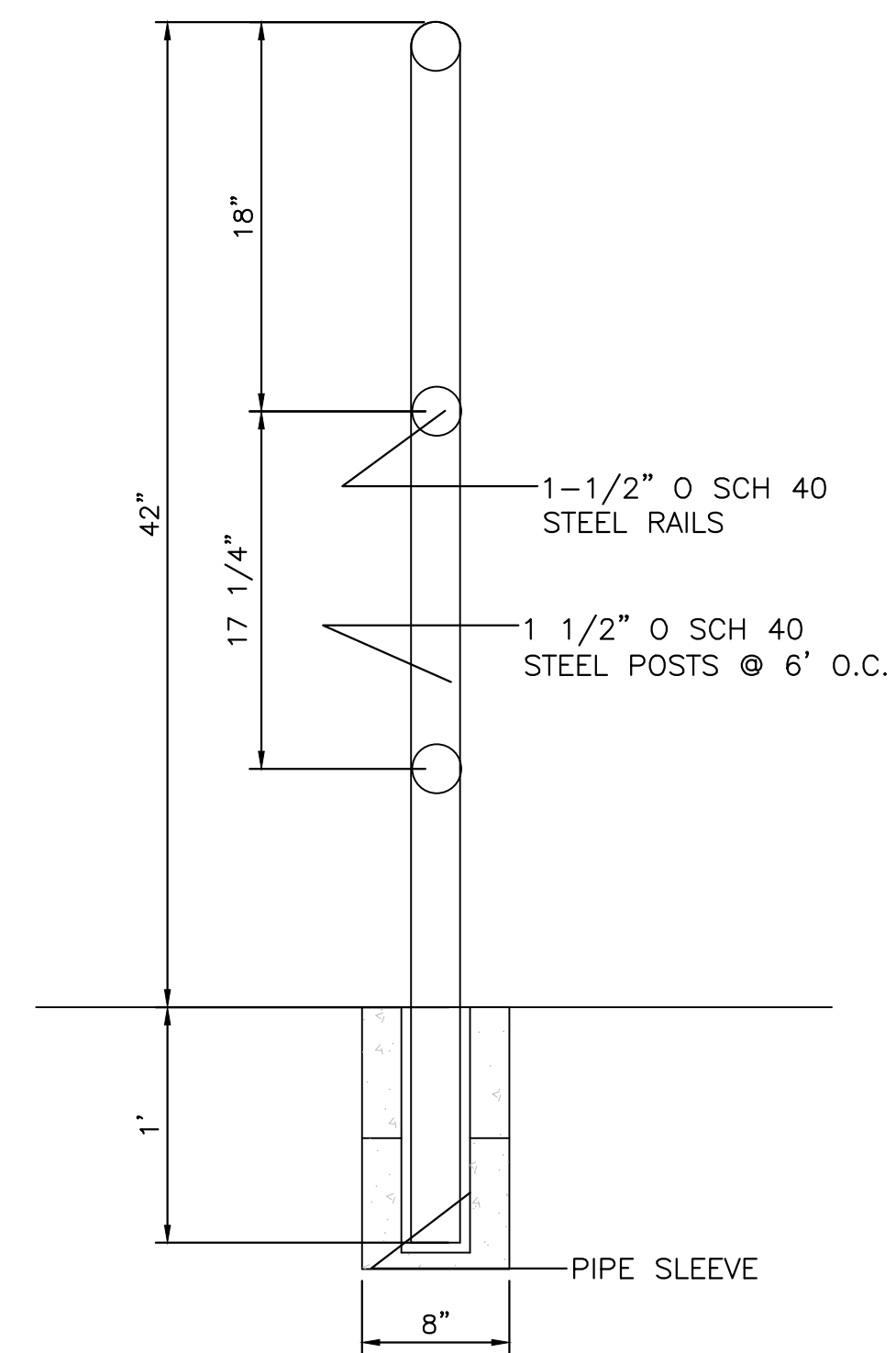

GUARD RAIL DETAIL
NTS

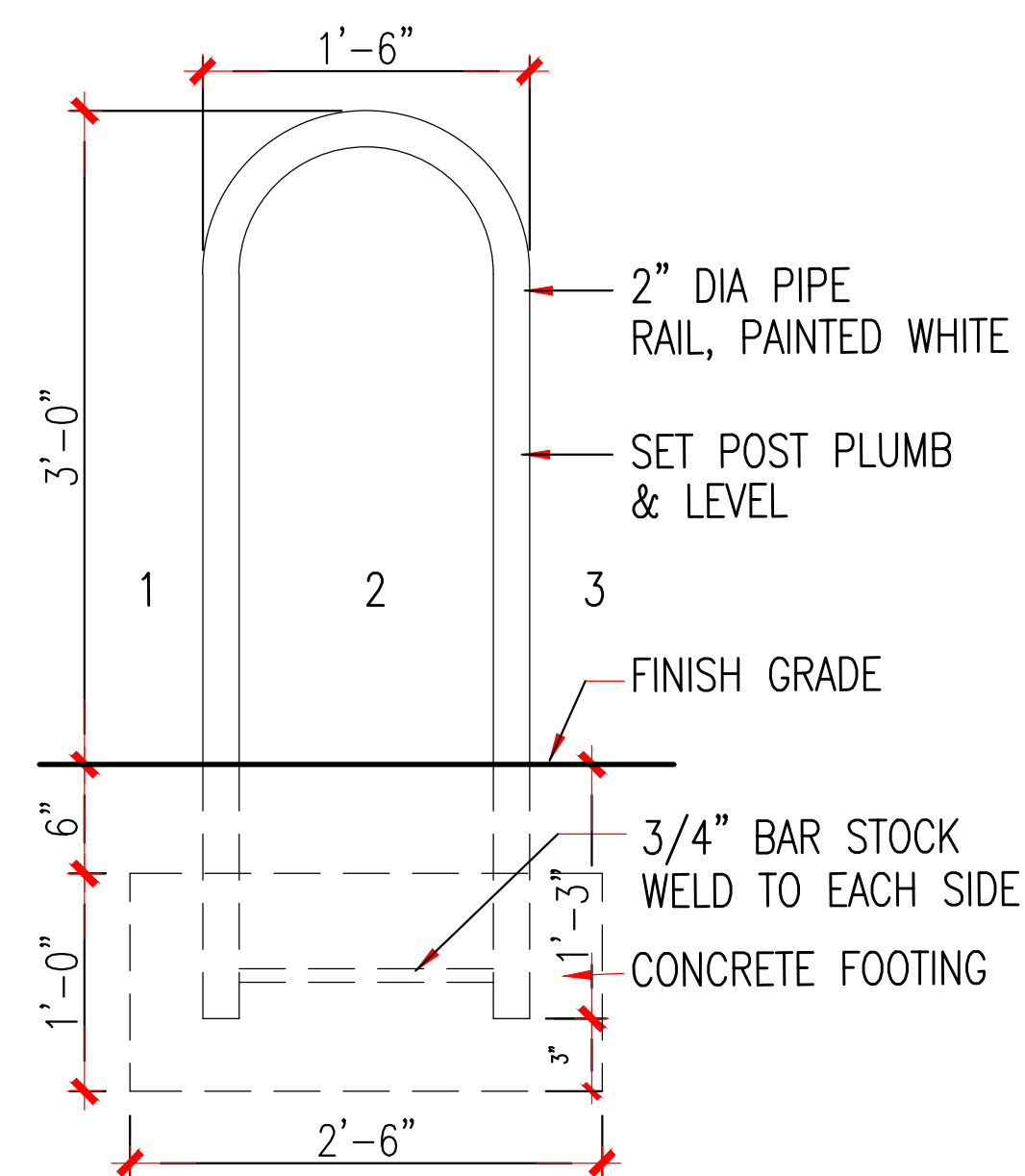
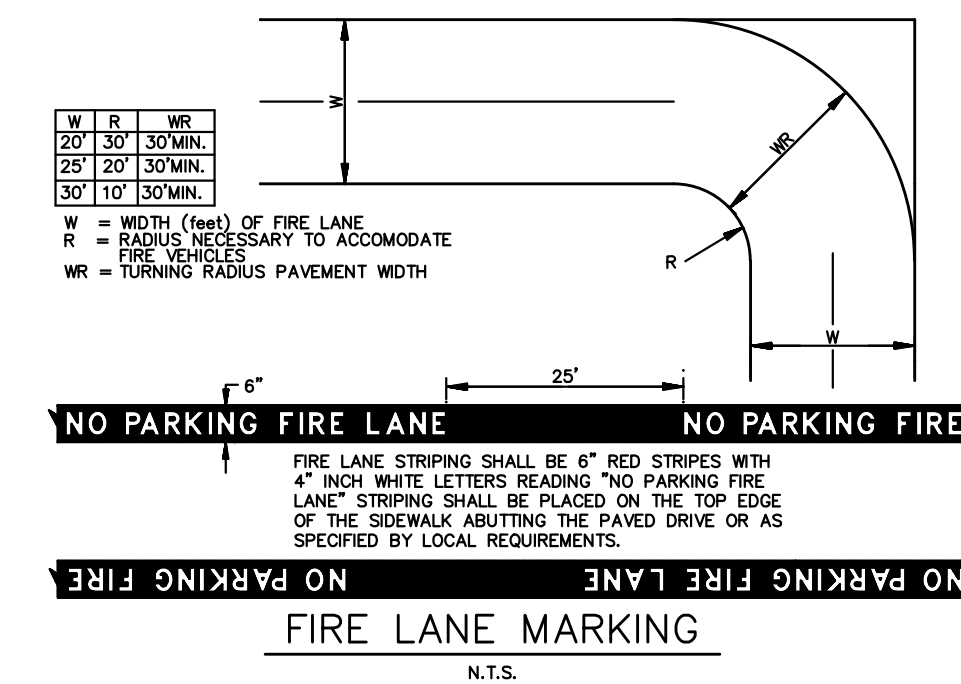

- NOTES
1. THE RACK SHALL BE A MINIMUM 30" TALL AND 18" WIDE
 2. THE BICYCLE FRAME SHALL BE SUPPORTED HORIZONTALLY AT 2 OR MORE PLACES. COMB/TOASTER RACKS ARE NOT ALLOWED
 3. THE RACK SHALL BE DESIGNED TO SUPPORT THE BICYCLE IN AN UPRIGHT POSITION. SEE THE IDO FOR ADDITIONAL INFORMATION
 4. THE RACK ALLOWS FOR VARYING BICYCLE FRAME SIZE AND STYLES TO BE ATTACHED
 5. THE USER IS NOT REQUIRED TO LIFT THE BICYCLE ONTO THE RACK
 6. EACH BICYCLE PARKING SPACE IS ACCESSIBLE WITHOUT MOVING ANOTHER BICYCLE
 7. BICYCLE RACKS SHALL BE STURDY AND ANCHORED TO A CONCRETE PAD
 8. A 1 FOOT CLEAR ZONE AROUND THE BICYCLE PARKING SHALL BE PROVIDED
 9. BICYCLE PARKING SPACES SHALL BE AT LEAST 6' LONG AND 2' WIDE

BIKE RACK DETAIL
NTS

GENERAL NOTES:

1. ALL CONCRETE IS TO BE 3000 PSI @ 28 DAYS.
2. MINIMUM COMPACTION UNDER FOOTINGS IS TO BE 95% PER ASTM D 1557 FOR A DEPTH OF 12" MOISTURE CONTENT IS TO BE $\pm 2.0\%$.
3. BACK FILL AGAINST WALLS IS TO BE HAND-PLACED AND COMPACTED.
4. ALL BARS ARE TO BE GRADE 60, ASTM 615.
5. TRUSS TYPE DUR-O-WALL EVERY OTHER COURSE.
6. USE EITHER KEYED EXPANSION JOINTS ON 20' CENTERS OR PILASTERS EVERY 12'.
7. 30 BAR DIAMETER LAPS TYPICAL.
8. DUR-O-WAL HORIZONTAL JOINT REINFORCEMENT 16" O.C.
9. OWNER TO SELECT MASONRY COLOR AND/OR FINISH

**8 INCH REINFORCED CONCRETE MASONRY WALL
(FOR RETAINING PORTION ONLY)**

H	B	T	Y-BARS
ft.-in.	ft.-in.	in.	
1'-4"	1'-6"	10"	#4 @ 24" O.C.
2'-0"	1'-6"	10"	#4 @ 24" O.C.
2'-8"	2'-0"	10"	#4 @ 16" O.C.
3'-3"	2'-4"	10"	#4 @ 16" O.C.
4'-0"	2'-9"	10"	#4 @ 16" O.C.
4'-8"	3'-0"	10"	#5 @ 16" O.C.

**L-FOOTING
RETAINING WALL DETAIL**
NTS

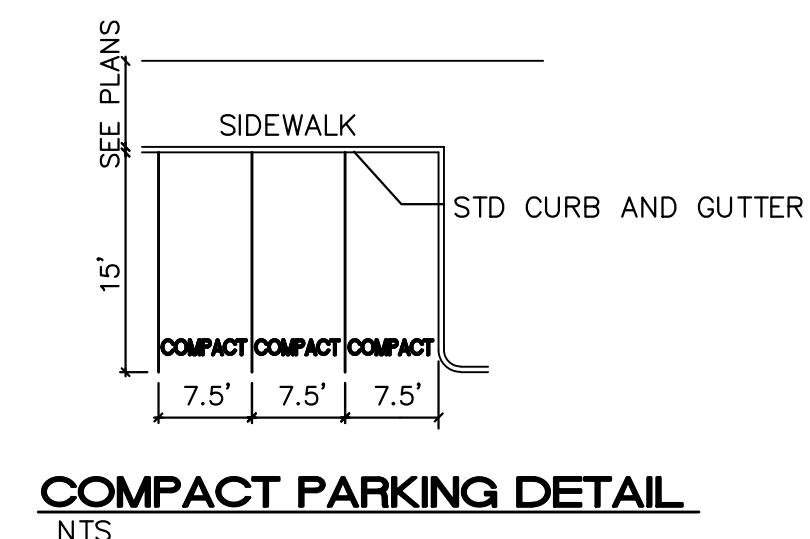
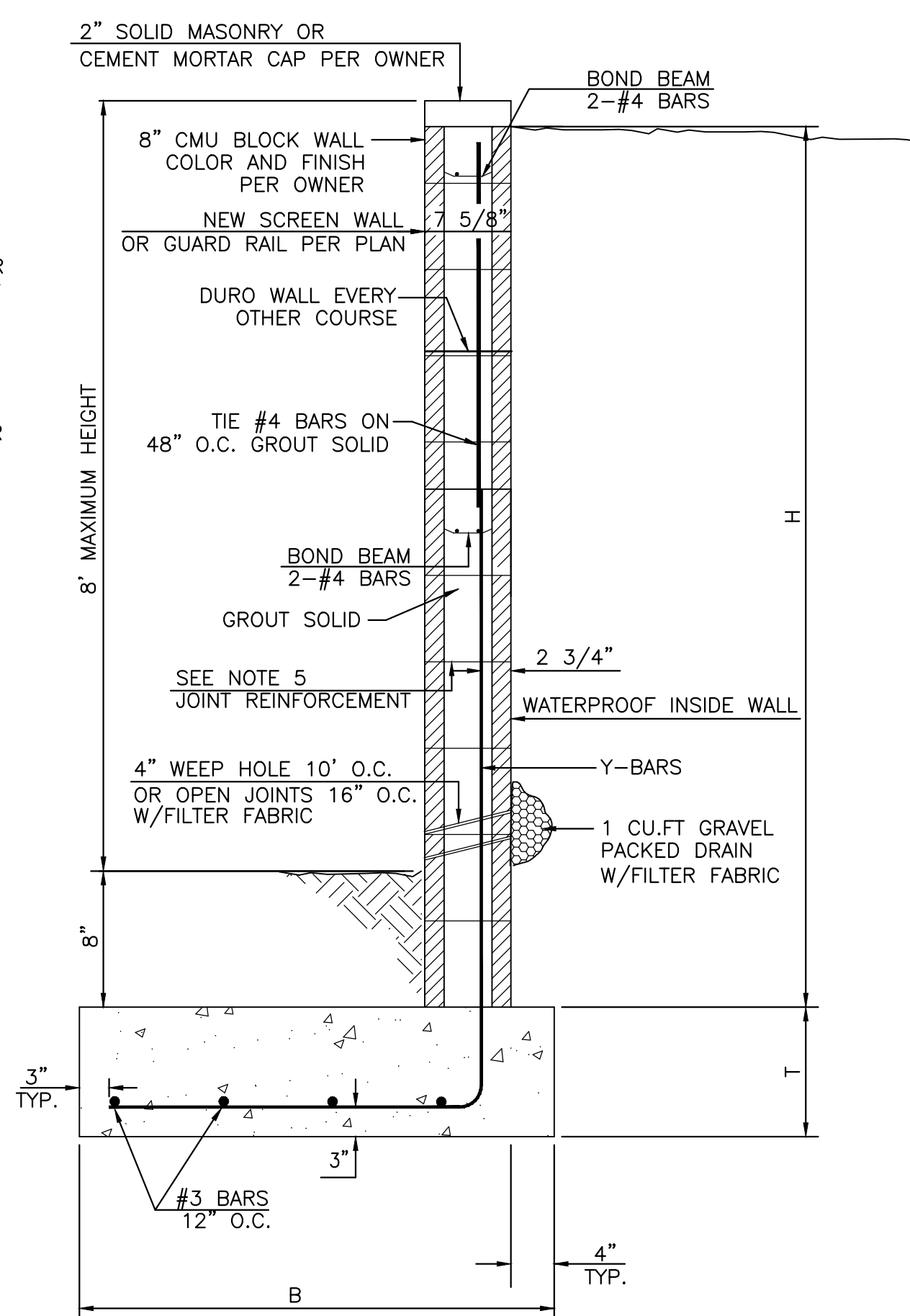

**TRAFFIC CIRCULATION LAYOUT
APPROVED**

M.P. P.E.

7/22/2020

	ABQ SCHOOL OF EXCELLENCE	DRAWN BY pm
	ADMINISTRATIVE AMENDMENT TRAFFIC CIRCULATION LAYOUT	DATE 7-20-2020
	TERRA WEST, LLC 5571 MIDWAY PARK PL NE ALBUQUERQUE, NEW MEXICO 87109 (505) 858-3100 www.tierrowestllc.com	DRAWING 2019068-SP
RONALD R. BOHANNAN P.E. #7868		SHEET # SP-2
		JOB # 2019068

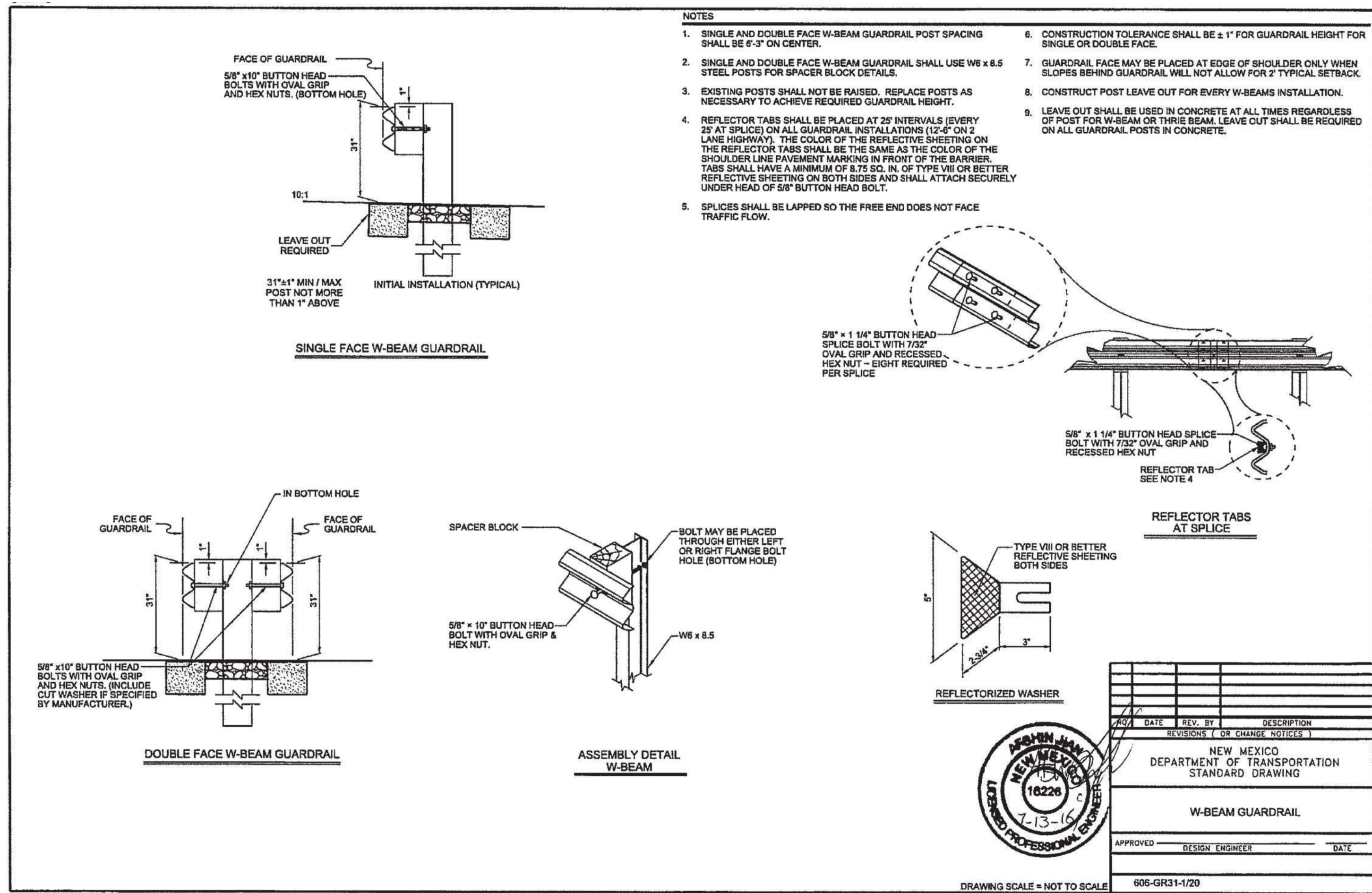

add:\p\preliminary drawings & doc\roadside\Working Folder-GR Type 31 Standards\GR31-1_Beam Guardrail Types 1-2.dgn

Sheet 606

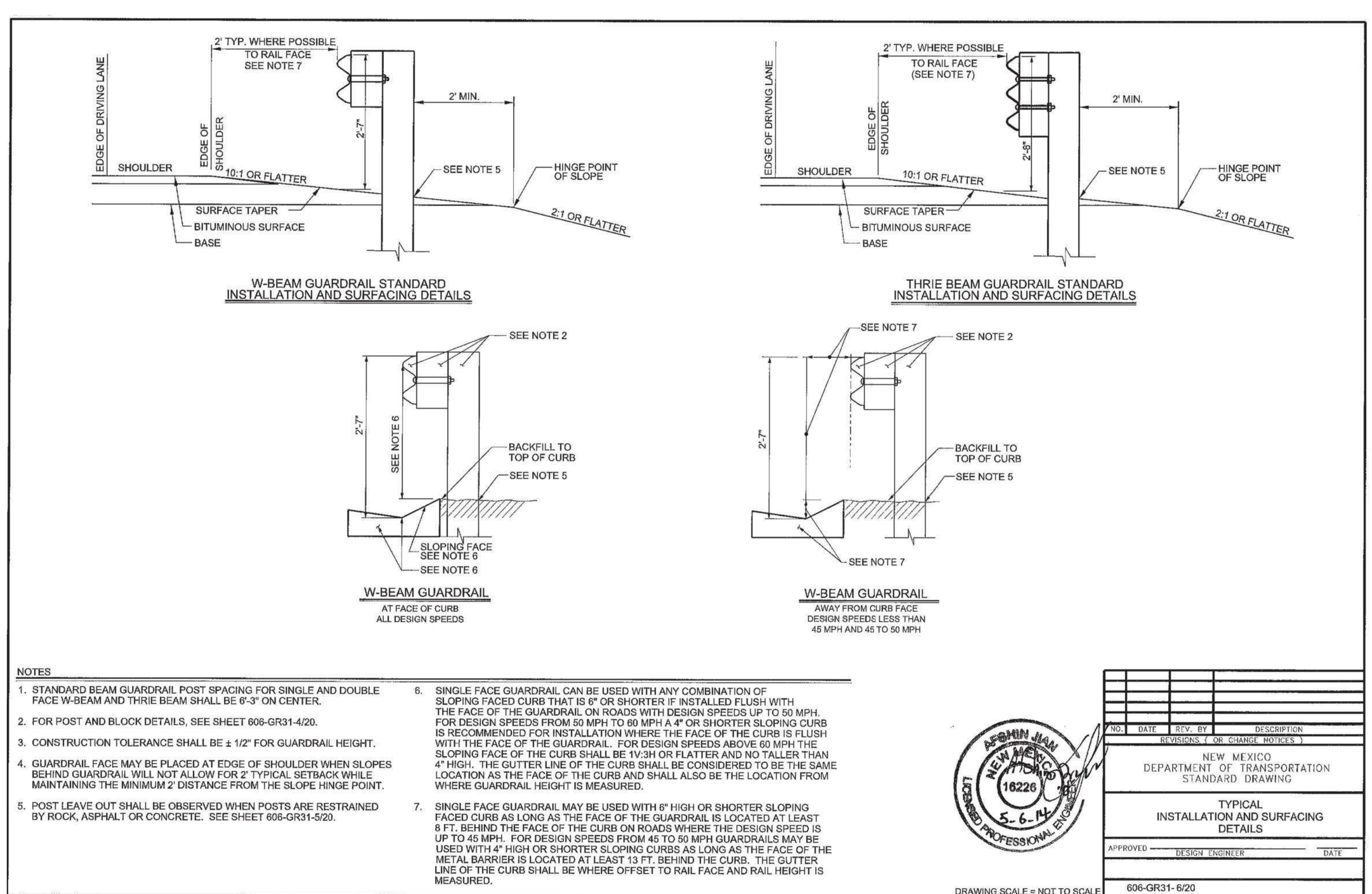

add:\p\preliminary drawings & doc\roadside\Working Folder-GR Type 31 Standards\GR31-6 Typical Installation & Surfacing Details.dgn

Sheet 606-07

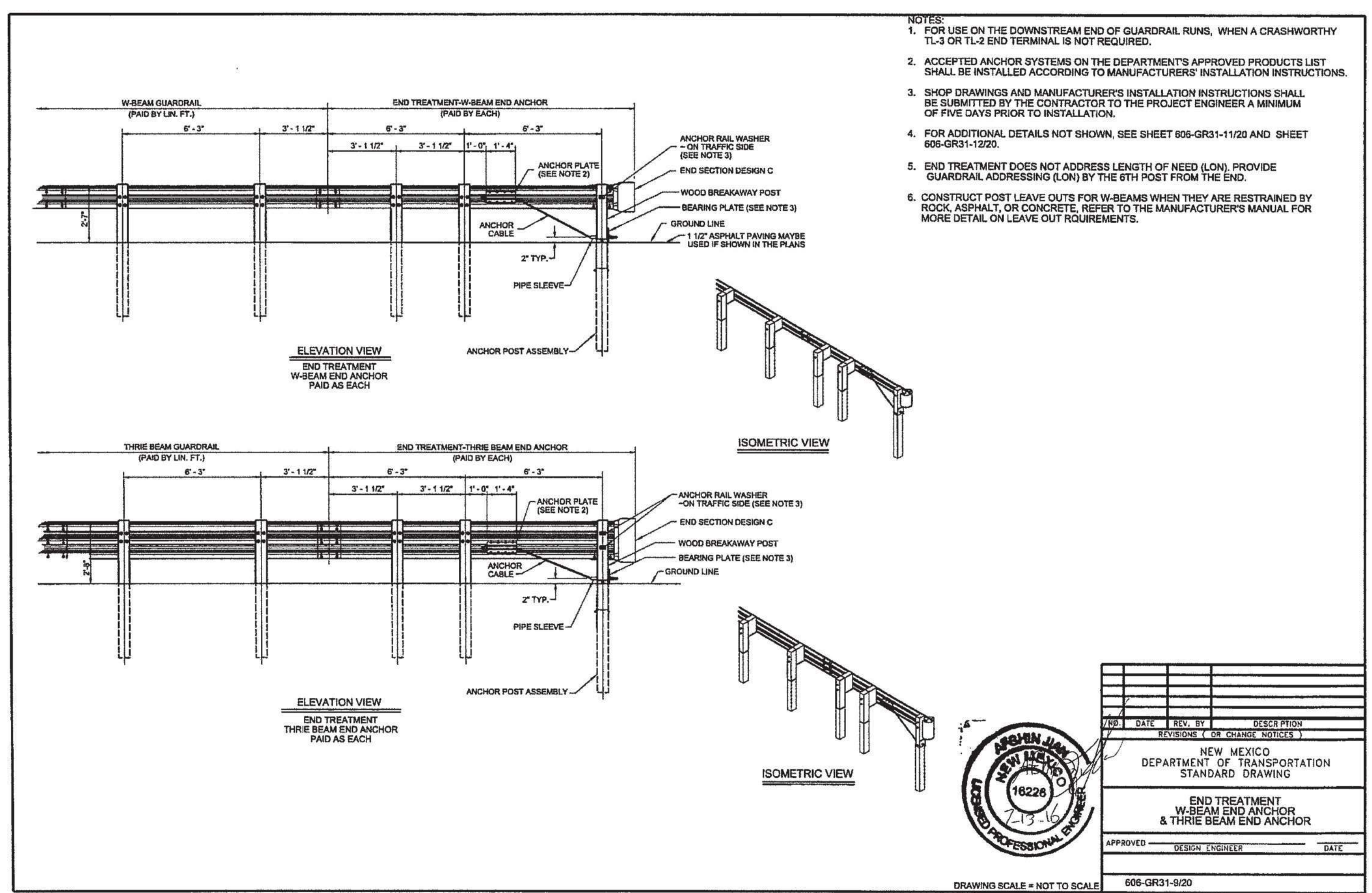

add:\p\preliminary drawings & doc\roadside\Working Folder-GR Type 31 Standards\GR31-8 Beam Guardrail and Anchor End Terminal Types 3 & 4.dgn

TRAFFIC CIRCULATION LAYOUT APPROVED
M.P. P.E.
7/22/2020

	ABQ SCHOOL OF EXCELLENCE ADMINISTRATIVE AMENDMENT TRAFFIC CIRCULATION LAYOUT	DRAWN BY pm DATE 7-20-2020 DRAWING 2019068-SP SHEET # SP-3 JOB # 2019068
	TIERRA WEST, LLC 5571 MIDWAY PARK PL. NE ALBUQUERQUE, NEW MEXICO 87109 (505) 858-3100 www.tierrowestllc.com	7-20-2020 RONALD R. BOHANNAN P.E. #7868

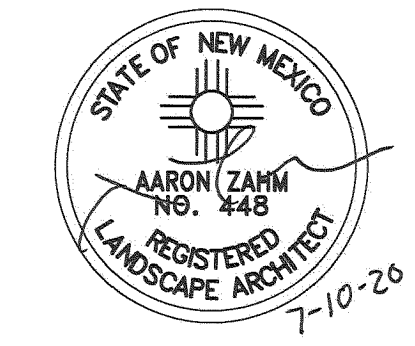

CONSULTANTS

MRWM
LANDSCAPE ARCHITECTS
mrwmla.com 505 268 2266

CONTRACT DOCUMENTS COORDINATION
THE DRAWINGS AND SPECIFICATIONS FOR THIS PROJECT ARE TO BE TAKEN TOGETHER AS A SINGLE CONSTRUCTION CONTRACT DOCUMENT AND ANY DIVISION BY TRADE OR OTHER DESIGNATION IS CONSIDERED GENERAL CONTRACTOR AND ALL SUB-CONTRACTORS SHALL REVIEW AND COORDINATE THE ENTIRE SET OF DRAWINGS AND PROJECT MANUAL.

ASE PK-5 EXPANSION
13201 Lomas Blvd NE, Albuquerque, NM, USA

OWNER
ALBUQUERQUE SCHOOL OF EXCELLENCE

TRAFFIC CIRCULATION LAYOUT
APPROVED
M. P. R. E.
7/22/2020

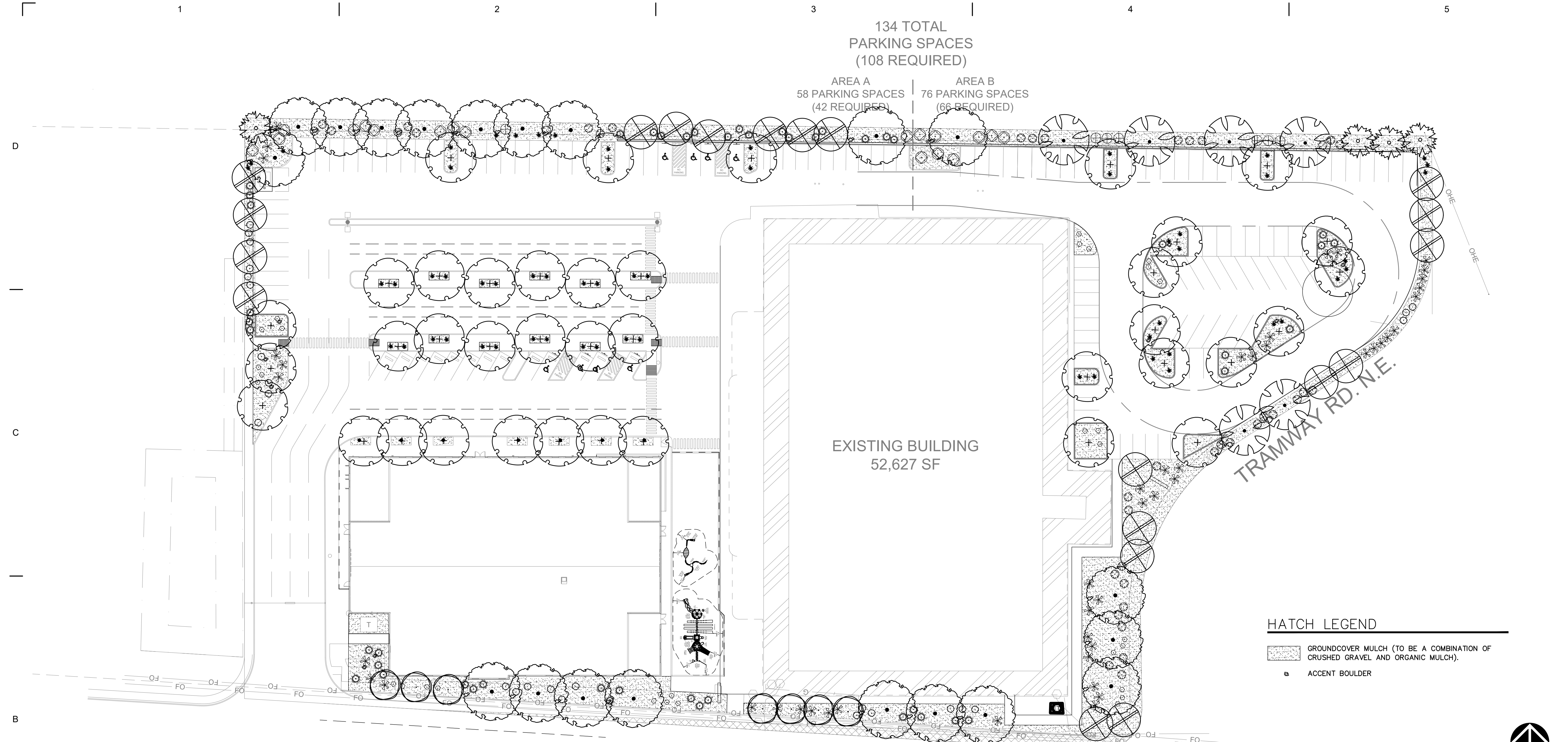

HATCH LEGEND

[Hatched Box]	GROUNDCOVER MULCH (TO BE A COMBINATION OF CRUSHED GRAVEL AND ORGANIC MULCH).
[Square]	ACCENT BOULDER

B1 LANDSCAPE PLAN
SCALE: 1"=30'-0"

LOMAS BLVD.

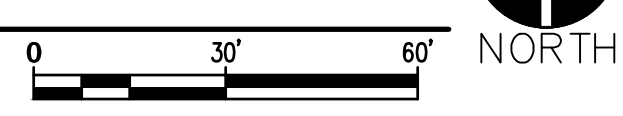

CITY LANDSCAPE ORDINANCE COMPLIANCE

- LANDSCAPING RESPONSIBILITY FOR MAINTENANCE:**
THE OWNER WILL BE RESPONSIBLE FOR ALL LANDSCAPE MAINTENANCE.
- COMPLIANCE WITH WATER CONSERVATION ORDINANCE:**
- NO SPRAY IRRIGATION IS PROPOSED.
 - PLANT SPECIES WILL BE LOW OR MEDIUM USE SPECIES PER THE ABCWUA'S XERIC PLANT LIST.
 - THIS PLAN HAS NO TURF OR HIGH WATER USE LANDSCAPING.
 - AN AUTOMATIC IRRIGATION SYSTEM WILL BE INSTALLED FOR ALL PLANT MATERIAL. THE SYSTEM WILL BE CONTROLLED BY AN AUTOMATIC CONTROLLER. PLANTS WILL BE IRRIGATED BY LOW FLOW EMITTERS. A REDUCED PRESSURE BACKFLOW PREVENTER WILL BE INSTALLED IN A HEATED ENCLOSURE PER DETAIL A1/LP501 TO PROTECT THE DOMESTIC WATER SUPPLY FROM CROSS-CONTAMINATION.
 - TREES SHALL BE INSTALLED PER DETAIL A4/LP501.
 - SHRUBS SHALL BE INSTALLED PER DETAIL A3/LP501.
 - GROUNDCOVER MULCH SHALL COMPRISE OF A COMBINATION OF CRUSHED GRAVEL (NOT TO EXCEED 75% OF TOTAL AREA) AND ORGANIC MULCH SUCH AS SHREDDED BARK, PECAN SHELLS, ETC.

CITY LANDSCAPE ORDINANCE COMPLIANCE – CONTINUED

- LANDSCAPE CALCULATIONS:**
- TOTAL LOT AREA: 219,542 SF
LESS TOTAL BUILDING AREA: 76,129 SF
NET LOT AREA: 143,413 SF
 - REQUIRED MINIMUM LANDSCAPE AREA (15% OF NET LOT AREA) – [5-6(C)(2)]: 21,512 SF
PROVIDED LANDSCAPE AREA: 26,950 SF (18.8% OF NET LOT AREA)
 - REQUIRED VEGETATIVE COVERAGE (75% OF REQUIRED LANDSCAPE AREA) – [5-6(C)(2)(C)]: 16,134 SF
PROVIDED VEGETATIVE COVERAGE: 23,383 SF (145% OF REQUIRED TOTAL COVERAGE)
 - REQUIRED GROUND LEVEL VEGETATIVE COVERAGE (25% OF TOTAL VEGETATIVE COVERAGE) – [5-6(C)(2)(C)]: 5,378 SF
PROVIDED GROUND LEVEL VEGETATIVE COVERAGE: 5,380 SF (100% OF REQUIRED TOTAL COVERAGE)
 - REQUIRED STREET TREES – [5-6(D)(1)]:
15 (440 LF ALONG TRAMWAY RD, TREES AVERAGE 30' O.C.)
16 (458 LF ALONG LOMAS BLVD, TREES AVERAGE 30' O.C.)
PROVIDED STREET TREES:
15 TREES ALONG TRAMWAY RD.
16 TREES ALONG LOMAS BLVD.
 - REQUIRED PARKING LOT INTERIOR LANDSCAPE – [5-6(F)(2)]:
11,387 SF (15% MINIMUM OF PARKING LOT AREAS CONTAINING 50 OR MORE SPACES)
PROVIDED PARKING LOT INTERIOR LANDSCAPE:
12,079 SF (106% OF PARKING LOT INTERIOR LANDSCAPE)
 - REQUIRED PARKING LOT TREES AT ONE TREE PER TEN SPACES – [5-6(F)(2)(C)]:
134 TOTAL SPACES
14 REQUIRED TREES
PROVIDED PARKING LOT TREES PROVIDED:
52 TREES

PLANT LEGEND

KEY	COMMON NAME	BOTANICAL NAME	QUANTITY	INSTALLED SIZE	REMARKS	MATURE SIZE	WATER USE	DECID./EV.	COVERAGE
SHADE TREES									
AE	ALLEE ELM	ULMUS PARVIFOLIA 'EMER II'	38	2" CAL., 12'-14' HT.	B&B	40' HT. X 35' SPD.	M	D	962 SF.
AC	ACCOLADE ELM	ULMUS JAPONICA X WILSONIANA 'MORTON' 20	2	2" CAL., 10'-12' HT.	B&B	50' HT. X 40' SPD.	M	D	1256 SF.
GRT	GOLDEN RAIN TREE	KOELREUTERIA PANICULATA	7	2" CAL., 8'-10' HT.	B&B	25' HT. X 20' SPD.	M	D	315 SF.
DW	DESERT WILLOW	CHILOPSIS LINEARIS 'BUBBA'	20	2" CAL., 8'-10' HT.	B&B	25' HT. X 20' SPD.	RW	D	315 SF.
BO	BURR OAK	QUERCUS MACROCARPA	6	2" CAL., 10'-12' HT.	B&B	40' HT. X 35' SPD.	M	D	1256 SF.
EVERGREEN TREES									
AFP	AFGHAN PINE	PINUS ELДАРICA	4	5'-7' HT.	B&B	40' HT. X 20' SPD.	M	E	315 SF.
SHRUBS/GROUNDCOVERS									
RY	RED YUCCA	HESPERALOE PARVIFOLIA	59	MIN. 18" HT.	5 GAL	3' HT. X 3' SPD.	L	E	7 SF.
TB	TURPENTINE BUSH	ERICAMERIA LARICIFOLIA	30	MIN. 8" HT.	5 GAL	3' HT. X 3' SPD.	L	E	7 SF.
GS	GIANT SACATON	SPOROBOLUS WRIGHTII	40	MIN. 18" HT.	1 GAL	5' HT. X 5' SPD.	M	D	20 SF.
CH	CHAMISA	ERICAMERIA NAUSEOSUS	18	MIN. 6" HT.	1 GAL	5' HT. X 7' SPD.	RW	D	40 SF.
BB	BUTTERFLY BUSH	BUDDLEIA DAVIDII 'BLACK KNIGHT'	7	MIN. 12" HT.	1 GAL	6' HT. X 6' SPD.	M	D	30 SF.
BM	BLUE MIST SPIREA	CARYOPTERIS CLANDONENSIS 'BLUE MIST'	25	MIN. 12" HT.	5 GAL	3' HT. X 3' SPD.	L	D	7 SF.
BCJ	BLUE CHIP JUNIPER	JUNIPERUS HORIZONTALIS 'BLUE CHIP'	48	MIN. 10" SPD.	5 GAL	12" HT. X 6' SPD.	M	E	30 SF.
GLS	GRO-LOW SUMAC	RHUS AROMATICA 'GRO-LOW'	47	MIN. 12" SPD.	5 GAL	2' HT. X 6' SPD.	L	D	30 SF.

UPDATED SET AS 05/28/2020

MARK	DATE	DESCRIPTION
190753		
06/29/2020		
KA		
AZ		

SHEET TITLE

LANDSCAPE PLAN

LP101



CONSULTANTS

MRWM
LANDSCAPE ARCHITECTS
mrwmia.com 505 268 2266

CONTRACT DOCUMENTS COORDINATION
THE DRAWINGS AND SPECIFICATIONS FOR THIS PROJECT ARE TO BE TAKEN TOGETHER AS A SINGLE CONSTRUCTION CONTRACT DOCUMENT AND ANY DISCREPANCY OR OTHER DESIGNATION IS CONSIDERED GENERAL CONTRACTOR AND ALL SUB-CONTRACTORS SHALL REVIEW AND COORDINATE THE ENTIRE SET OF DRAWINGS AND PROJECT MANUAL.

ASE PK-5
EXPANSION

13201 Lomas Blvd NE, Albuquerque, NM, USA

OWNER

ALBUQUERQUE SCHOOL OF EXCELLENCE

TRAFFIC CIRCULATION LAYOUT
APPROVED
M. P. R. E.

7/22/2020

UPDATED SET AS 05/28/2020

MARK	DATE	DESCRIPTION

MARK	DATE	DESCRIPTION
	190753	
	06/29/2020	
KA		
AZ		

SHEET TITLE
LANDSCAPE DETAILS

LP501

D

C

B

A

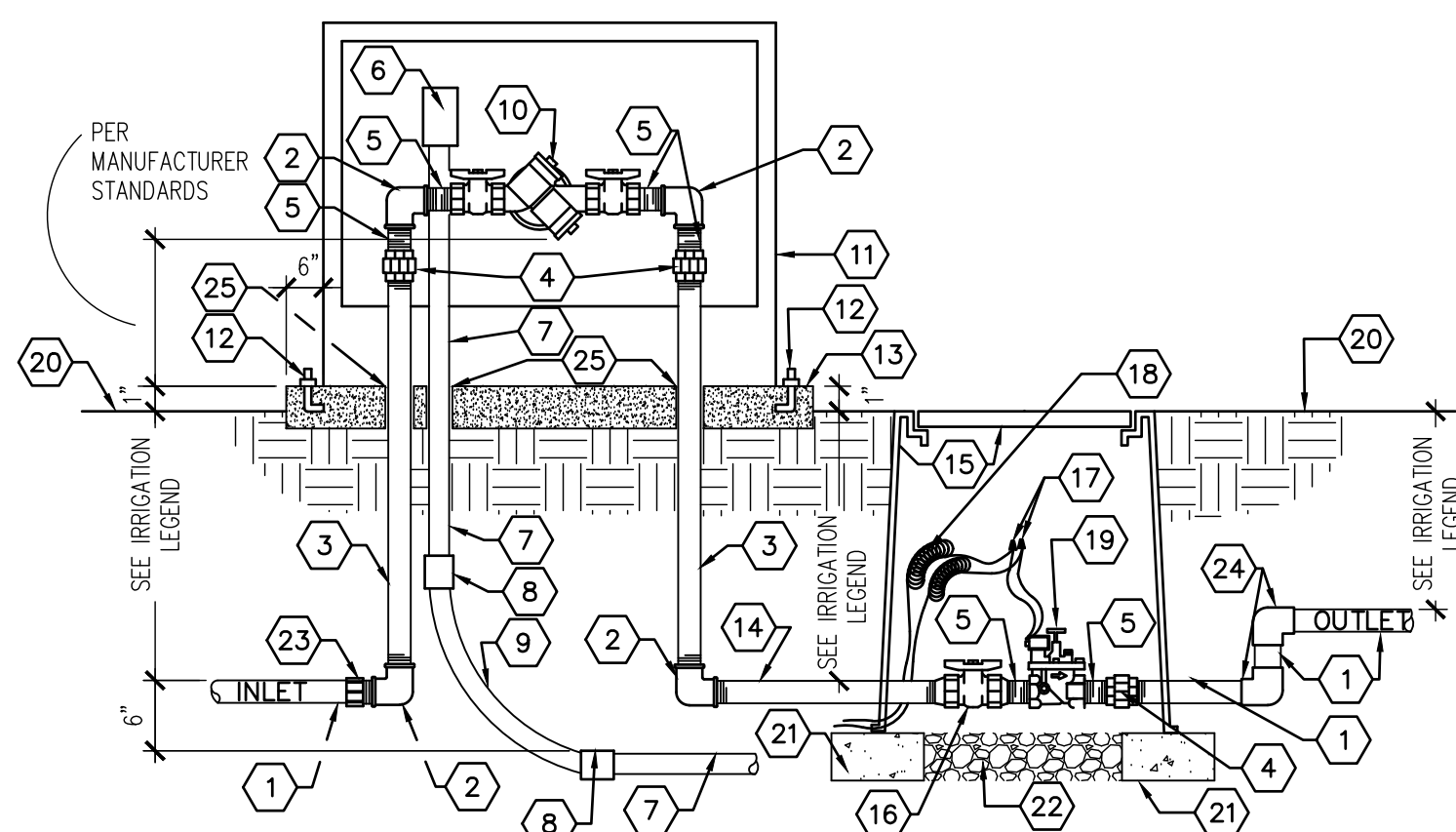

- ### KEYED NOTES
- | | |
|--|---|
| 1. PVC MAINLINE - SEE SPECS. | 14. GALVANIZED NIPPLE - 3/8" LENGTH. |
| 2. GALVANIZED ELBOW. | 15. VALVE BOX W/ 8" EXTENSIONS AS REQUIRED. |
| 3. GALVANIZED NIPPLE, LENGTH AS REQUIRED. | 16. SPEARS TRUE UNION SCH. 80 PVC BALL VALVE. |
| 4. GALVANIZED UNION. | 17. WATERPROOF WIRE SPLICE. |
| 5. GALVANIZED NIPPLE- 3" LENGTH. | 18. 3/8" WIRE LOOPS. |
| 6. JUNCTION BOX FOR HEAT TAPE. | 19. MASTER VALVE - SEE SPECS. |
| 7. RIGID CONDUIT. | 20. FINISH GRADE. |
| 8. WATER-TIGHT CONNECTOR. | 21. SOLID CMU BLOCK, FOUR PER BOX. |
| 9. RIGID SWEEP ELL. | 22. 6" DEPTH OF 1" WASHED GRAVEL WITH 2" CLEARANCE TO BOTTOM OF VALVE ASSEMBLY. |
| 10. REDUCED PRESSURE BACKFLOW PREVENTER, FEBCO 825Y, OR EQUAL. | 23. SCH 40 PVC MALE ADAPTER. |
| 11. INSULATED ENCLOSURE - SEE SPECS. | 24. MAIN LINE ELL, 90 DEGREE. |
| 12. 1/2" X 6" ANCHOR BOLTS, FOUR PER BOX. | 25. PVC SLEEVE. |
| 13. 3000 PSI CONCRETE PAD, 6" THICK WITH TOOLED EDGES. | |

GENERAL NOTES

- A. CONTRACTOR SHALL SUPPLY AND INSTALL WINTERGARD WET H612 HEAT CABLE AROUND EXPOSED PIPES AND BACKFLOW PREVENTER. MINIMUM 1:3 SPIRALING RATIO.

A1 BACKFLOW PREVENTER & MASTER VALVE ASSEMBLY
SCALE: N.T.S.

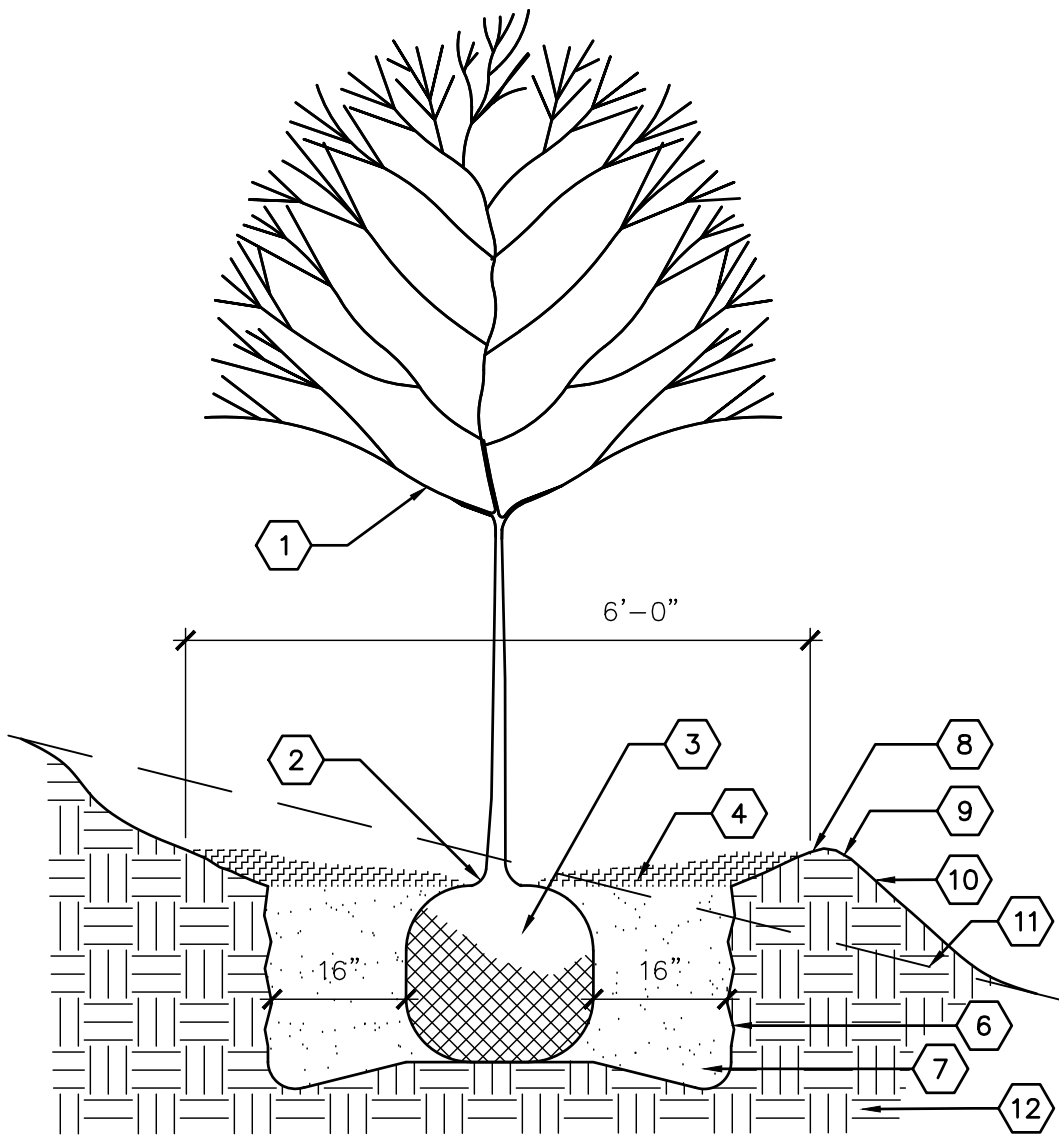

TREE PLANTING ON SLOPE

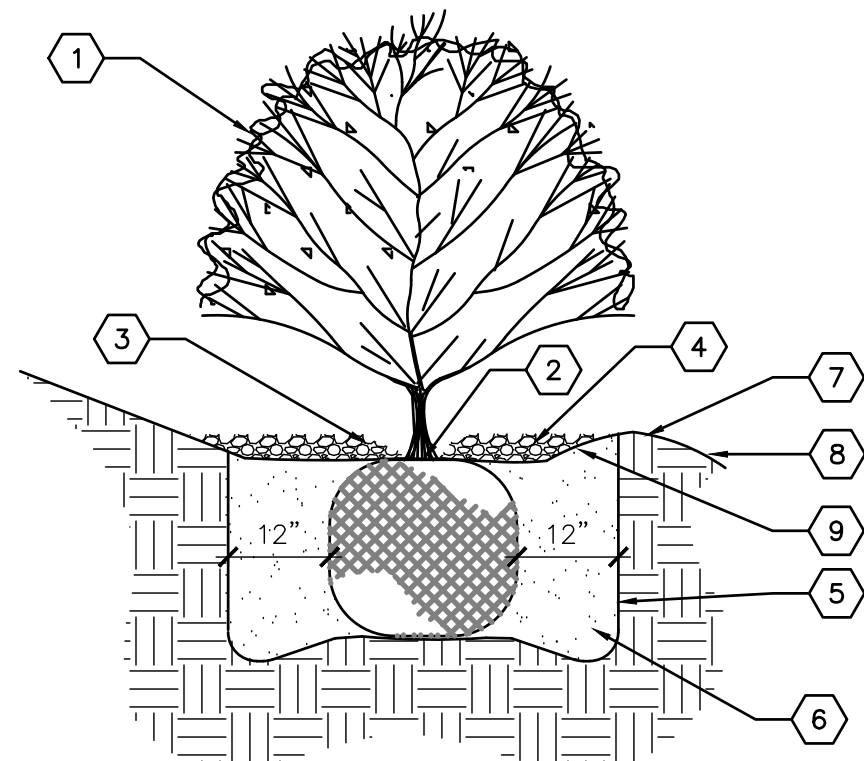

SHRUB PLANTING ON SLOPE

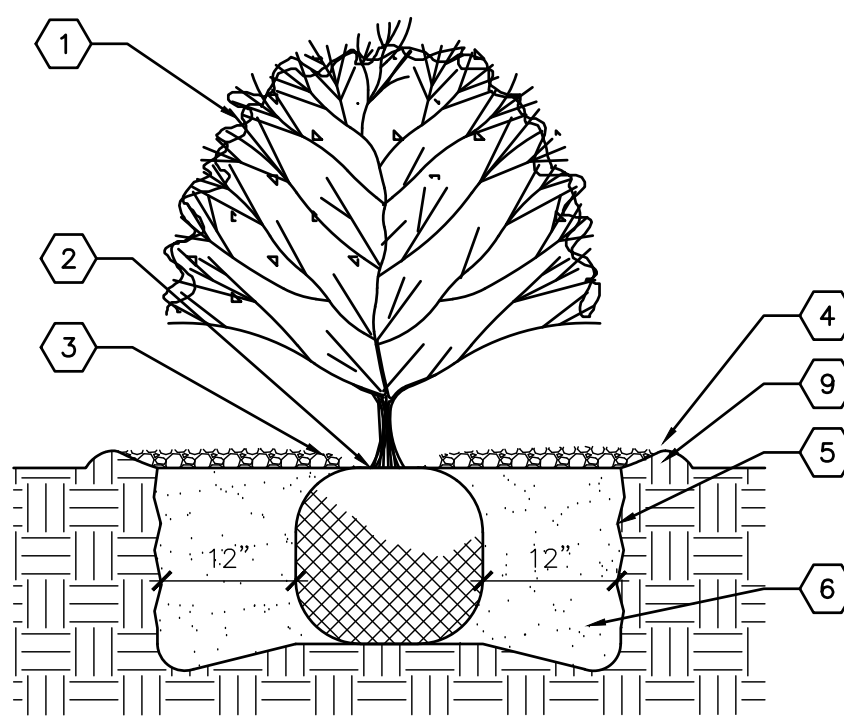

- ### KEYED NOTES
1. SHRUB LOCATION AND SPECIES AS PER PLAN.
 2. PLANT AT SAME DEPTH MAINTAINED AT NURSERY.
 3. HOLD MULCH BACK 2" FROM SHRUB STEM(S).
 4. 2" DEPTH SHREDDED MULCH WITHIN SHRUB WELL. WHEN SHOWN WITHIN PLANTING BEDS WITH GRAVEL MULCH, EXCLUDE SHREDDED WOOD MULCH AND FEATHER GRAVEL MULCH TO 2" DEPTH ON TOP OF ROOT BALL.
 5. SCARIFY EDGE OF PLANTING HOLE, CONTINUOUS ALL SIDES.
 6. BACKFILL AND SOIL AMENDMENTS (SEE SPECIFICATIONS).
 7. PROPOSED GRADE.
 8. SMOOTHLY TAPER SLOPE TO FORM SHRUB WELL.
 9. EARTHEN BERM 6" HEIGHT.

A3 SHRUB PLANTING
SCALE: N.T.S.

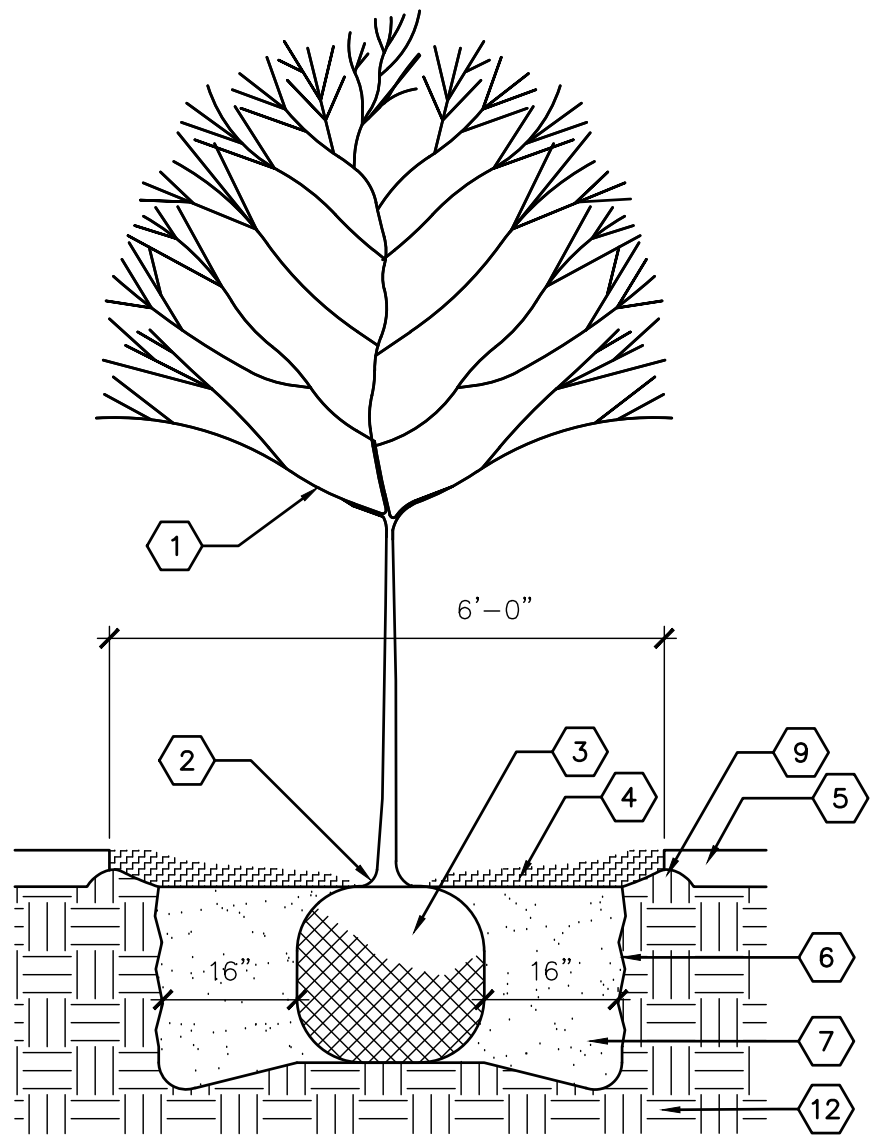

- ### KEYED NOTES
1. TREE LOCATION AND SPECIES PER PLAN.
 2. REMOVE EXISTING SOIL (FROM NURSERY) AS NEEDED TO EXPOSE ROOT FLARE. INSTALL WITH ROOT FLARE 2"-3" ABOVE GRADE AND HELD BACK 2" FROM TREE TRUNK. MULCH SHALL BE HELD BACK 4"-6" FROM TREE TRUNK.
 3. PLACE TREE IN HOLE TO STRAIGHTEN. REMOVE WIRE BASKET, WOOD BOX, PLASTIC, TWINE AND/OR ROPE, AND BURLAP PRIOR TO BACKFILL.
 4. PROVIDE 6' DIAMETER AREA OF SHREDDED WOOD MULCH AT 2" DEPTH AT BASE OF EACH TREE. WHERE SPACE DOESN'T PERMIT 6' DIAMETER, PROVIDE MAXIMUM DIAMETER OF BARK MULCH UP TO 6'.
 5. MATERIAL VARIES - SEE PLAN.
 6. SCARIFY EDGE OF PLANTING HOLE, CONTINUOUS ALL SIDES.
 7. BACKFILL AND SOIL AMENDMENTS (SEE SPECIFICATIONS). THOROUGHLY MIX BACKFILL AND AMENDMENTS PRIOR TO INSTALLATION.
 8. SMOOTHLY TAPER SLOPE TO FORM TREE WELL.
 9. EARTHEN BERM, 6" HEIGHT.
 10. PROPOSED GRADE.
 11. EXISTING GRADE.
 12. UNDISTURBED SUBGRADE.

A4 TREE PLANTING
SCALE: N.T.S.