

ALL DRAWINGS AND WRITTEN MATERIAL APPEARING HEREIN CONSTITUTE THE ORIGINAL UNPUBLISHED WORK OF studio | shop. AND MAY NOT BE DUPLICATED, USED OR DISCLOSED WITHOUT THE WRITTEN CONSENT OF studio | shop.

SITE PLAN GENERAL NOTES

1. THE SITE PLAN INDICATES THE GENERAL DESIGN INTENT FOR THE WORK. THE CONTRACTOR, AND ALL SUBCONTRACTORS, SHALL BE RESPONSIBLE FOR BECOMING FAMILIAR WITH ALL EXISTING SITE CONDITIONS, INCLUDING BUT NOT LIMITED TO, UNDERGROUND UTILITIES, PIPES, STRUCTURES, IRRIGATION SYSTEMS, EXISTING FOUNDATION SYSTEMS, AND OTHER EXISTING SITE IMPROVEMENTS, WHETHER OR NOT INDICATED ON THE SITE PLAN. IT SHALL BE THE RESPONSIBILITY OF THE CONTRACTOR TO CALL FOR ALL PUBLIC AND PRIVATE UTILITY LOCATES.
2. THE CONTRACTOR SHALL NOT PROCEED WITH INSTALLATION OF THE WORK WHEN DISCOVERY OF UNKNOWN CONDITIONS AND/OR GRADE DIFFERENCES EXIST THAT MAY NOT HAVE BEEN PREVIOUSLY KNOWN. SUCH CONDITIONS SHALL BE IMMEDIATELY BROUGHT TO THE ATTENTION OF THE ARCHITECT.
3. ALL WORK SHALL BE PERFORMED ON A DESIGN-BUILD BASIS BY THE GENERAL CONTRACTOR, AND/OR OWNER'S VENDOR WHERE INDICATED; ALL PERMITS AND ASSOCIATED DOCUMENTATION SUBMITTALS SHALL BE THE RESPONSIBILITY OF THE CONTRACTOR OR OWNER'S VENDOR.
4. ALL NEW SITE WORK SHALL COMPLY WITH THE 2010 ADA STANDARDS FOR ACCESSIBLE DESIGN, AND/OR THE 2009 ICC/ANSI 117.1 ACCESSIBLE USEABLE BUILDINGS AND FACILITIES GUIDELINES, WHICHEVER IS MORE RESTRICTIVE.
5. THE CONTRACTOR SHALL VERIFY DIMENSIONS OF EXISTING SITE CONDITIONS, AND SHALL NOTIFY THE ARCHITECT IMMEDIATELY OF ANY DISCREPANCIES.
6. ALL EXTERIOR FURNITURE IS OWNER PROVIDED AND SHOWN FOR REFERENCE ONLY.
7. EXISTING UTILITIES, WHERE INDICATED IN THE CONTRACT DOCUMENTS, ARE SHOWN FOR GENERAL REFERENCE ONLY, AND ARE SHOWN IN AN APPROXIMATE LOCATION ONLY. THE CONTRACTOR SHALL BE RESPONSIBLE FOR LOCATING ALL UTILITIES AND OTHER UNDERGROUND ELEMENTS PRIOR TO BEGINNING THE WORK.
8. WHEN EXCAVATING WITHIN EIGHTEEN INCHES OF EXISTING UNDERGROUND FACILITIES, ALL EXCAVATION MUST BE ACCOMPLISHED USING NON-MECHANIZED EXCAVATION PROCEDURES. WHEN UNDERGROUND FACILITIES ARE EXPOSED, SUFFICIENT SUPPORT MUST BE PROVIDED TO THE FACILITIES TO PREVENT EXCESSIVE STRESS ON THE PIPING OR CONDUITS. THE CONTRACTOR IS FULLY RESPONSIBLE FOR ANY DAMAGES CAUSED BY HIS FAILURE TO EXACTLY LOCATE AND PRESERVE THESE UNDERGROUND FACILITIES.
9. THE CONTRACTOR SHALL BE FULLY RESPONSIBLE FOR ANY DAMAGES TO EXISTING WATER, WASTEWATER, STORM WATER, ELECTRICAL, GAS OR OTHER UTILITY LINES.
10. ADEQUATE DRAINAGE SHALL BE MAINTAINED AT ALL TIMES DURING CONSTRUCTION AND ANY DRAINAGE DITCH OR STRUCTURE DISTURBED DURING THE WORK SHALL BE RESTORED TO THE SATISFACTION OF THE CITY OF ALBUQUERQUE AND THE OWNER.
11. FILL AREAS SHALL BE FILLED IN LAYERS NOT EXCEEDING 8" IN DEPTH AND EACH LAYER COMPACTED TO NOT LESS THAN 95% STANDARD PROCTOR DENSITY PRIOR TO INSTALLATION OF UNDERGROUND LINES.
12. CONTRACTOR SHALL PROVIDE TEMPORARY SILT BARRIERS AND/OR OTHER EROSION CONTROL MEASURES WHICH WILL REMAIN IN PLACE UNTIL AFTER ALL SITE WORK IS COMPLETE. ALL SILT BARRIER FENCING AND OTHER EROSION CONTROL MEASURES SHALL COMPLY WITH THE CITY OF ALBUQUERQUE GUIDELINES.
13. EXISTING PAVEMENTS, CURBS DRIVEWAYS, AND SIDEWALKS DAMAGED OR REMOVE DURING CONSTRUCTION SHALL BE REPLACED BY THE CONTRACTOR.
14. EXPOSE 15" OF REINFORCING STEEL AT PROPOSED SAWED JOINTS, IF NO REINFORCING STEEL EXISTS, USE HORIZONTAL DOWELS; HORIZONTAL DOWELS SHALL BE #6 BARS, 24" LONG AT 24" O.C., DRILLED AND EMBEDDED 8" INTO THE CENTER OF THE EXISTING SLAB WITH "POR-ROK" OR EQUAL.
15. CONTRACTOR SHALL BE RESPONSIBLE FOR OBTAINING ALL NECESSARY BUILDING PERMITS AND FOR NOTIFICATION OF ALL AUTHORIZED INSPECTORS, SUPERINTENDENTS OR PERSONS IN CHARGE OF PRIVATE OR PUBLIC UTILITIES AFFECTED BY THE PROPOSED SCOPE OF WORK PRIOR TO BEGINNING THE WORK.
16. CONTRACTOR SHALL BE RESPONSIBLE FOR PROVIDING AND MAINTAINING ALL BARRICADES, WARNING SIGNS, FLASHING LIGHTS AND TRAFFIC CONTROL DEVICES IN CONFORMANCE WITH THE CITY OF ALBUQUERQUE STANDARDS DURING THE WORK.
17. CONTRACTOR SHALL CUT AND FILL SITE AS REQUIRED TO OBTAIN FINISHED ELEVATIONS SHOW ON THE DRAWINGS. COMPACT SELECT FILL MATERIAL TO 95% STANDARD PROCTOR DENSITY AS PER ASTM D-698.
18. TOP OF PROPOSED MANHOLES, INLETS, VALVE BOXES, ETC. SHALL BE SET TO MATCH FINISHED GRADE OR PROPOSED TOP OF PAVEMENT. TOP OF EXISTING MANHOLES, VALVE BOXES, ETC. SHALL BE ADJUSTED AS REQUIRED TO MATCH FINISHED GRADE OR PROPOSED TOP OF PAVEMENT. OUTSIDE OF PAVED AREAS, SET MANHOLE RIMS 6" ABOVE THE FINISHED GRADE UNLESS OTHERWISE NOTED.
19. ACCESS TO BUILDING EXITS BE MAINTAINED AT ALL TIMES.
20. NEW CONCRETE CURB AND GUTTER ASSEMBLIES SHALL MATCH THE EXISTING SITE STANDARD FOR CURBS AND GUTTERS; PROVIDE REINFORCING AND DOWELS AS INDICATED ELSEWHERE WITHIN THESE GENERAL SITE NOTE.
21. NEW CONCRETE FLATWORK SHALL MATCH THE EXISTING SITE STANDARD FOR FLATWORK ASSEMBLIES; PROVIDE INTEGRALLY COLORED CONCRETE AND REINFORCEMENT MESH. LOCATE CONSTRUCTION/CONTROL JOINTS AS INDICATED; WHERE JOINTS ARE NOT SPECIFICALLY LOCATED, ALIGN WITH SITE/BUILDING FEATURES AS INDICATED AND SPACE EQUALLY.

SITE PLAN KEY/WORK NOTES

- |   |  |
|---|--|
| 1 | EXIST. GAS SERVICE ENTRY, EXIST. METER |
| 2 | EXIST. ELECTRICAL SES                  |
| 3 | EXIST. TRANSFORMER                     |
| 4 | EXIST. TRASH ENCLOSURE                 |
| 5 | EXIST. STORMWATER DETENTION POND       |
| 6 | EXIST. SHOPPING CENTER MONUMENT SIGN   |
| 7 | EXIST. OWNER MONUMENT SIGN             |

SITE PLAN ACCESSIBLILTY KEY NOTES

- |    |  |
|----|--|
| A1 | EXIST. ACCESSIBLE ROUTE TO PUBLIC WAY, RE: G003 FOR CONTINUATION AT INTERIOR |
| A2 | REFER TO G003 FOR ACCESSIBLE DTLS. AT EXTERIOR OPENINGS                      |
| A3 | EXIST. ACCESSIBLE CURB RAMP  |
| A4 | EXIST. ACCESSIBLE PARKING  |

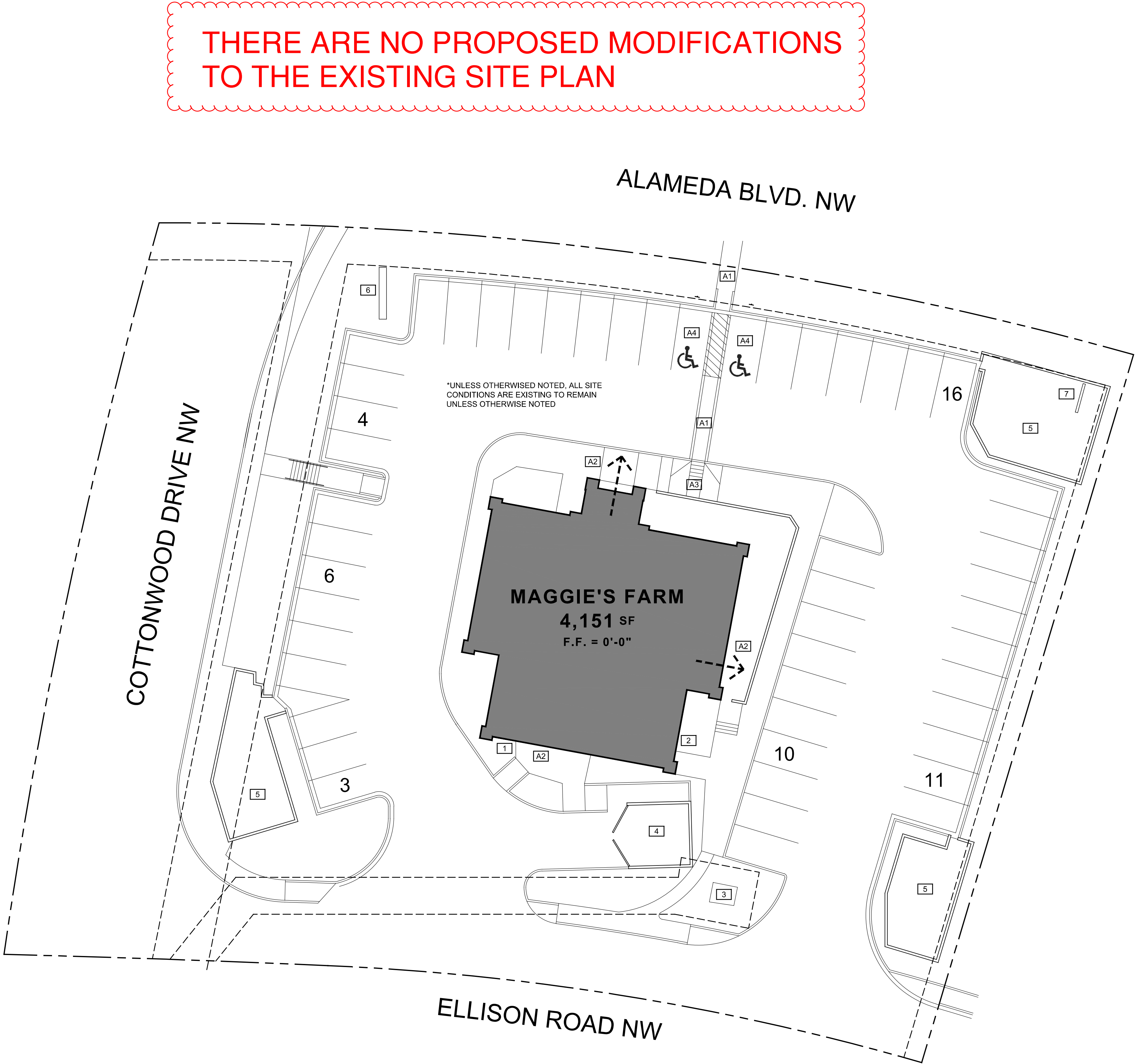

MAGGIE'S FARM - ABQ ELLISON  
3711 ELLISON ROAD NW, ALBUQUERQUE, NM 87114

studio | shop. PROJECT NO. 2130.00  
CONSTRUCTION DOCUMENTS 21-1208

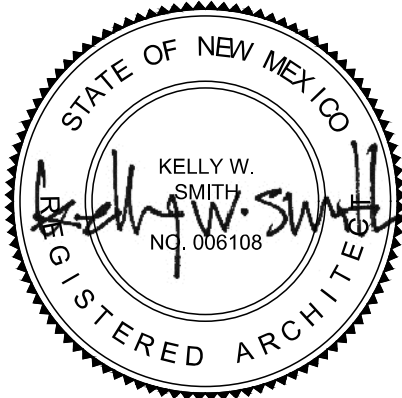

8 DECEMBER 2021

studio | shop.  
architecture ideas culture

SITE PLAN

A101

01 SITE PLAN  
1" = 192'-0"

REF.: