

LEGAL DESCRIPTION  
 LOT 281, BELLAMAH OFFICE ADDITION.

**Albuquerque Centre**  
 6001 Indian School Road NE  
 Albuquerque, NM  
 Case Number #Z.81.128

**Existing Parking Tabulation:**  
 Original Requirement 223 Parking Spaces  
 Originally Provided 230 Parking Spaces

176 Standard Spaces  
 50 Compact Spaces (21.74% of Total Spaces)  
 4 Accessible Spaces (Do not Meet Current Standards)  
 0 Van Space  
 230 Total Spaces

**Revised Parking Tabulation:**

181 Standard Spaces  
 52 Compact Spaces (21.4% of Total Spaces)  
 7 Accessible Spaces  
 1 Van Space  
 241 Total Spaces

**LANDSCAPING DATA:**

PREVIOUS APPROVED LANDSCAPING AREA 33,900.00 S.F.  
 REQUIRED LANDSCAPING AREA 16,602.00 S.F.  
 REVISED LANDSCAPING AREA 32,400.00 S.F.

**LEGEND**

- EXISTING CURB & GUTTER
- BOUNDARY LINE
- PROPOSED SIDEWALK
- PROPOSED BUILDING
- EXISTING ELEMENTS
- PROPOSED CURB AND GUTTER
- SETBACK

AMENDMENT IS TO MAKE MODIFICATIONS TO PARKING LOT AS SHOWN AND TO REDUCE LANDSCAPING.

**CASE NUMBER: Z-81-128**

This plan is approval of site development plan for Administrative Amendment only as highlighted in the clouded section.

<b>SITE DEVELOPMENT PLAN</b>	
Traffic Engineer, Transportation Division	<i>Richard Don</i> 8-19-97 Date
Design and Development, CIP	<i>David...</i> 8-18-97 Date
Public Works, Water Utilities Division	<i>Ray...</i> 8-12-97 Date
City Engineer, Engineer Division / AMAFCA	<i>Frank...</i> 8-29-97 Date
APPROVAL AND CONDITIONAL ACCEPTANCE: as specified by the Development Project Manual.	
City Planner, Albuquerque / Bernalillo County Planning Division	<i>Wm...</i> 8/29/97 Date
PLNZ (10706) 4/96	

**N/A**  
 SOLID WASTE APPROVAL DATE

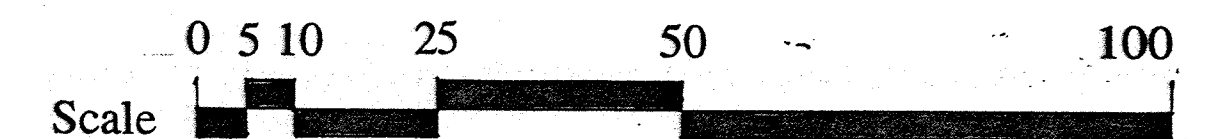
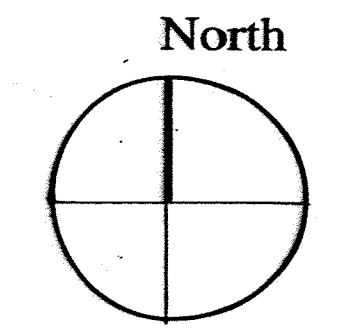

DRB-97-30 DRB-97-30B

**Albuquerque Centre**  
 6001 Indian School Road NE  
 Albuquerque, NM  
 Case Number #Z.81.128

**Existing Parking Tabulation:**  
 Original Requirement 223 Parking Spaces  
 Originally Provided 230 Parking Spaces

176 Standard Spaces  
 50 Compact Spaces (21.74% of Total Spaces)  
 4 Accessible Spaces (Do not Meet Current Standards)  
 0 Van Space  
 230 Total Spaces

**Revised Parking Tabulation:**

180 Standard Spaces  
 57 Compact Spaces (23.27% of Total Spaces)  
 7 Accessible Spaces  
 1 Van Space  
 245 Total Spaces

San Pedro

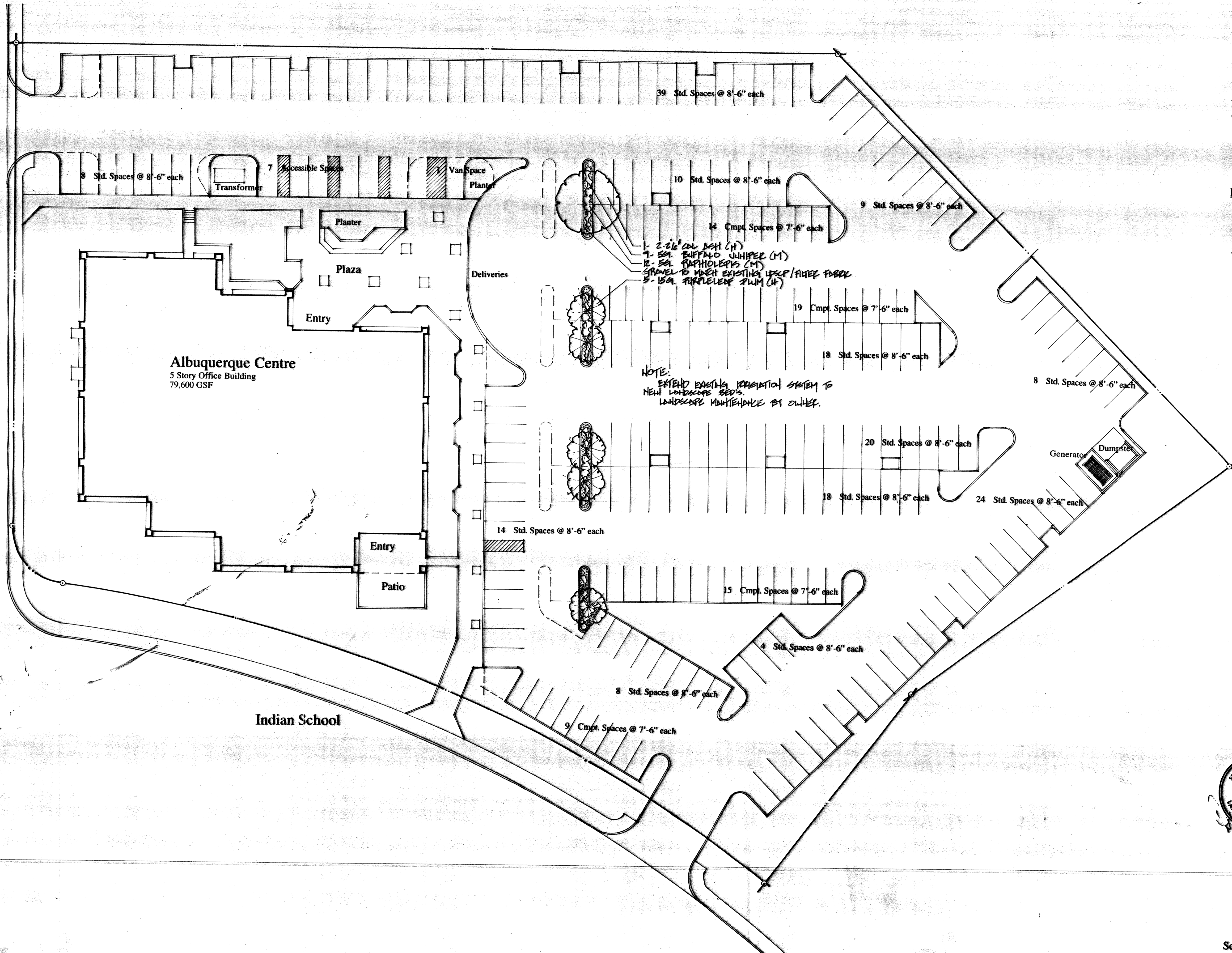

Indian School

THE HILLTOP expressly reserves the common law copyright and other property rights in these plans. These plans are not to be reproduced, changed or copied in any manner whatsoever, nor are they to be assigned to any third party without obtaining the express written permission and consent of THE HILLTOP.

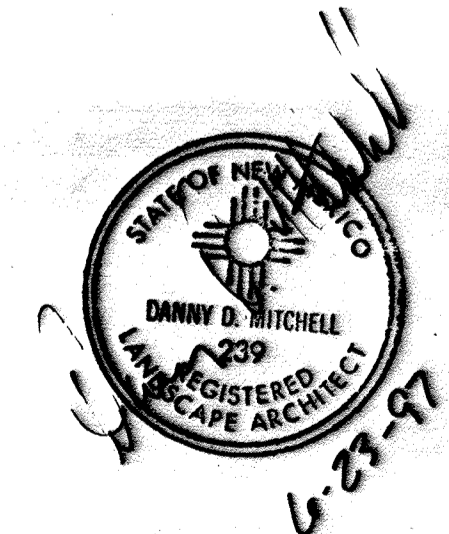

The Hilltop

