



Integrated Project Services
 Engineering
 Design/Build
 Compliance
 Consulting

3 CORPORATE PARK
 SUITE 100
 IRVINE, CA 92606
 949 679 4682 PHONE
 949 679 4683 FAX
 www.ipsdb.com

IPS Professional Engineers and Architects, P.C.

REVISION	DATE	DESCRIPTION	BY

EDCI ENGINEERS
 2600 MICHELSON DRIVE - SUITE 930
 IRVINE, CALIFORNIA 92612
 PHONE: (949) 892-4950 • FAX: (949) 892-4970
 WEBSITE: www.edc-engineers.com
 CIVIL & STRUCTURAL
© Copyright 2018 EDCI Engineers, Inc. All Rights Reserved.
 This drawing and the design depicted hereon are the property of EDCI Engineers, Inc. and shall remain confidential for EDCI Engineers, Inc. unless otherwise indicated in writing.

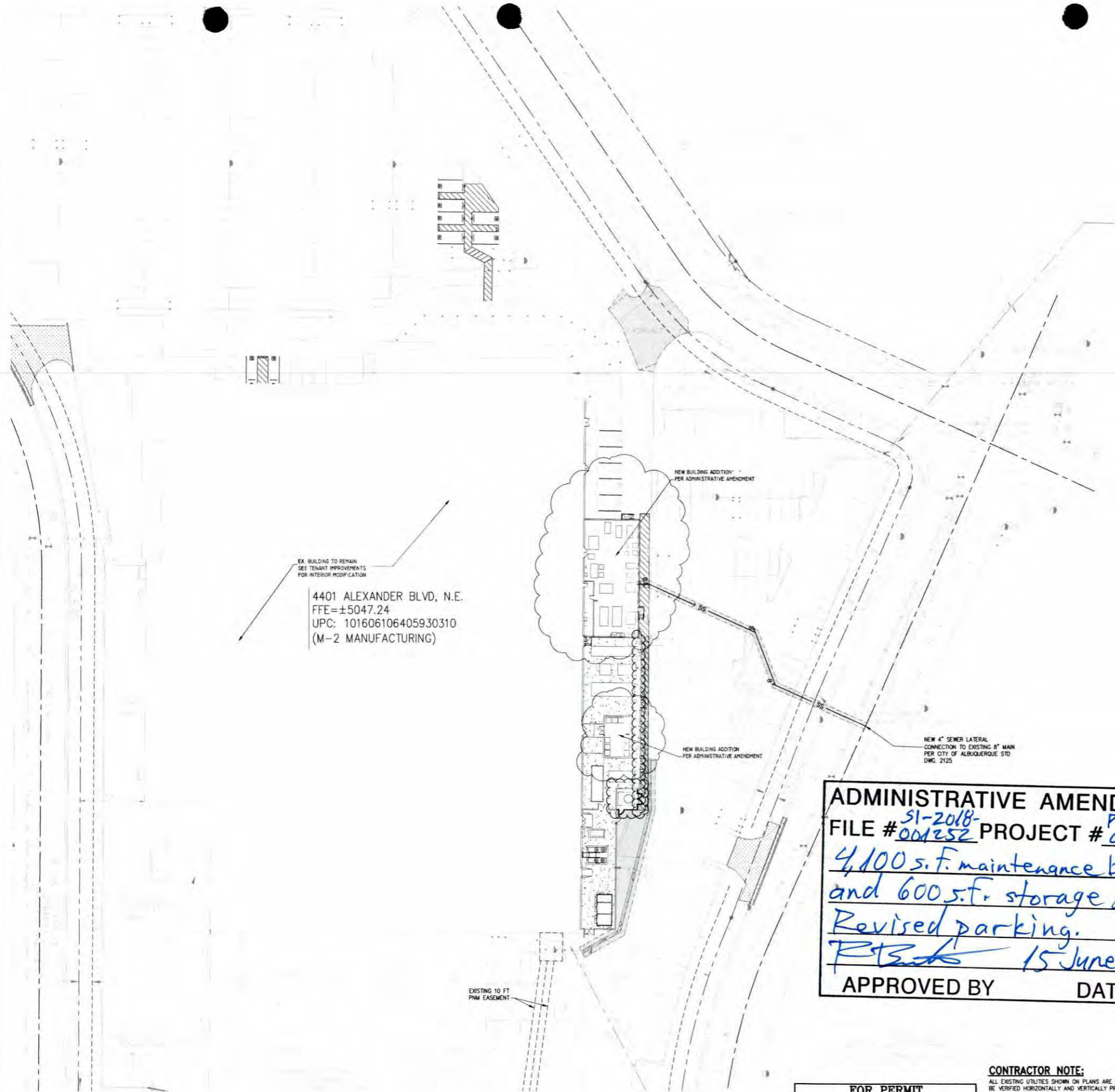

EX. BUILDING TO REMAIN
 SEE TENANT IMPROVEMENTS
 FOR INTERIOR MODIFICATION

4401 ALEXANDER BLVD, N.E.
 FFE=±5047.24
 UPC: 101606106405930310
 (M-2 MANUFACTURING)

ADMINISTRATIVE AMENDMENT
 FILE # 51-2018-001252 PROJECT # PR-2018-001252
4,100 s.f. maintenance bldg.
and 600 s.f. storage bldg.
Revised parking.
RTS 15 June 2018
 APPROVED BY _____ DATE _____

FOR PERMIT
 These drawings are sufficiently complete for submission to the jurisdiction having authority for permit. The contractor shall not use these drawings for construction until contractor receives written approval for use in construction by the jurisdiction having authority and DCI Engineers.

CONTRACTOR NOTE:
 ALL EXISTING UTILITIES SHOWN ON PLANS ARE TO BE VERIFIED HORIZONTALLY AND VERTICALLY PRIOR TO ANY CONSTRUCTION. ALL EXISTING FEATURES INCLUDING BURIED UTILITIES ARE SHOWN AS INDICATED ON RECORD MAPS AND SURVEYS FURNISHED BY OTHERS. WE ASSUME NO LIABILITY FOR THE ACCURACY OF THOSE RECORDS AND SURVEYS. CONTACT THE UTILITY OWNER/AGENCY FOR THE FINAL LOCATION OF EXISTING UTILITIES IN AREAS CRITICAL TO CONSTRUCTION.

UNDERGROUND SERVICE ALERT
 ONE-CALL NUMBER
 811
 CALL TWO BUSINESS DAYS BEFORE YOU DIG

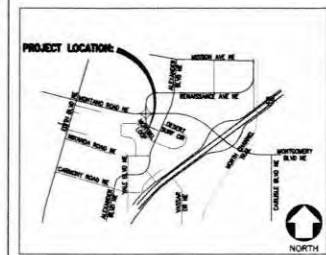
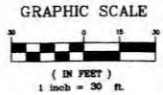

05/21/2018 ADMIN. AMENDMENT

CONFIDENTIAL
 THE INFORMATION CONTAINED HEREIN MAY NOT BE USED OR REPRODUCED IN ANY MANNER WITHOUT WRITTEN PERMISSION OF INTEGRATED PROJECT SERVICES.

CLIENT
 OsoBio
 A Division of Albany Molecular Research Inc.

4401 ALEXANDER BLVD. ALBUQUERQUE, NM
SYRINGE LINE PROJECT

DRAWING TITLE
PROPOSED SITE DEVELOPMENT

ENGINEER DCI	ARCHITECT -	DESIGNER CSC	IPS PROJECT # CAD18068.01
DRAWN BY CSC	REVIEWED BY MHN	SCALE AS NOTED	CADD FILE NAME

DRAWING NUMBER
C2.0

SEAL
 DATE
 MARK D. ADD
 PROFESSIONAL ENGINEER
 STATE OF NEW MEXICO
 EXPIRES: 12/31/2018
 DATE 12/06/2017

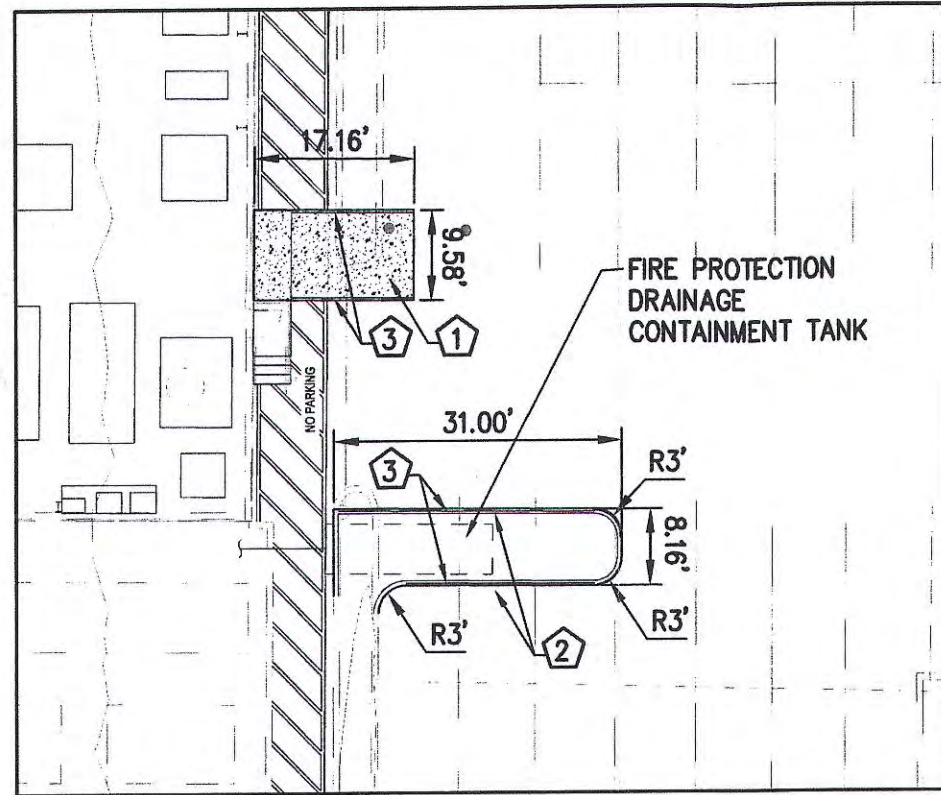

CONSTRUCTION NOTES:

- ① NEW VEHICULAR CONCRETE RAMP WITH HANDRAILS.
- ② NEW 8" CONCRETE CURB
- ③ NEW HANDRAILS PER DETAIL 1

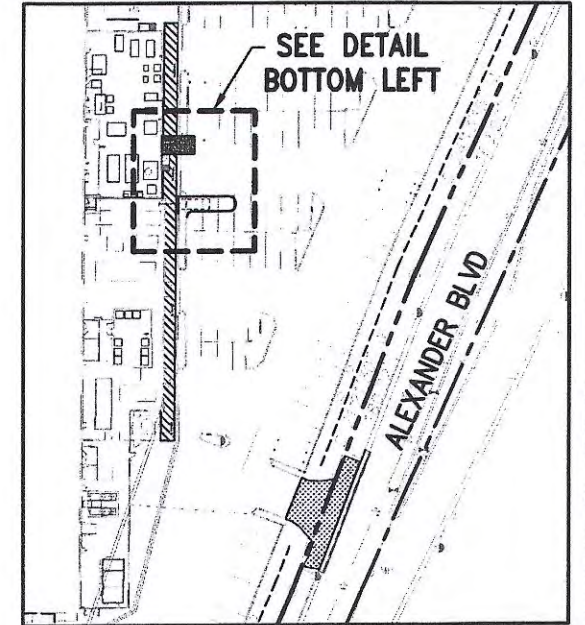

KEY MAP

SCALE: 1" = 100'



EXPIRES: 12/31/2018



GRAPHIC SCALE



(IN FEET)
1 inch = 10 ft.

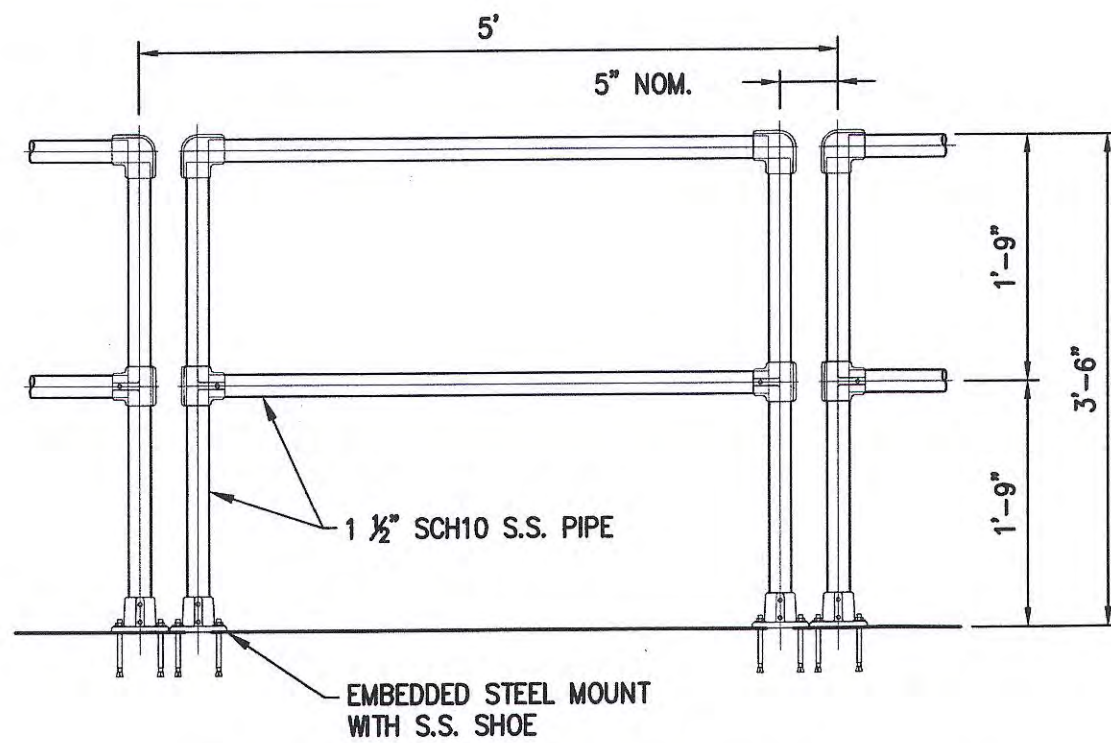

TYPICAL HANDRAIL DETAIL

SCALE : NTS



PROJECT NAME:
OSO BIO SYRINGE CONCEPT

PROJECT NO:
16-72-0007

BY:
JAS

DATE:
11-9-2018

EDCI
ENGINEERS
1331 17TH STREET • SUITE 604
DENVER, COLORADO 80202
PHONE: (720) 439-4700
WEBSITE: www.edci-engineers.com
CIVIL / STRUCTURAL

CONSTRUCTION FIELD SKETCH:

CURB AND RAMP ADDITION

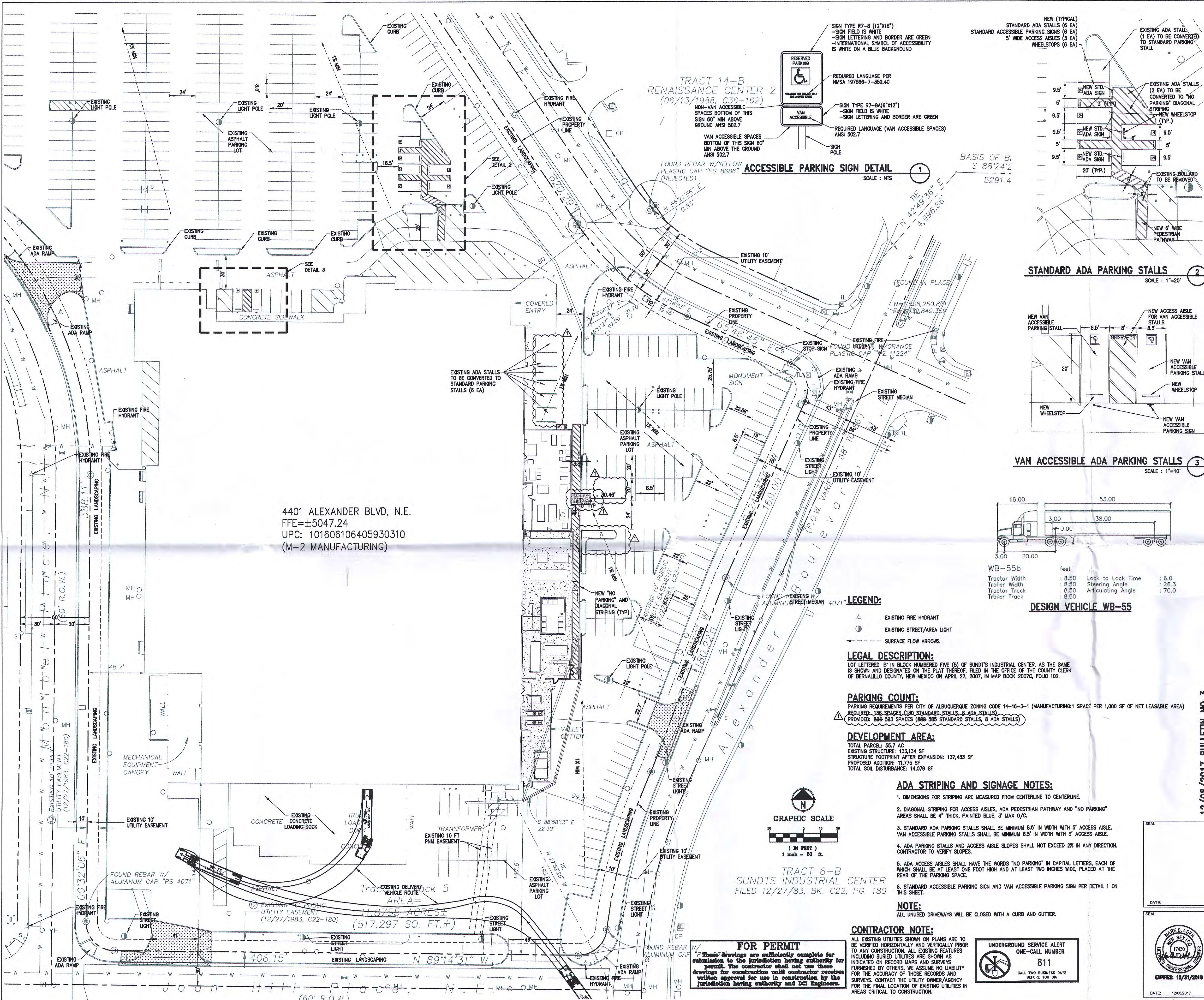

4401 ALEXANDER BLVD, N.E.
 FFE=±5047.24
 UPC: 101606106405930310
 (M-2 MANUFACTURING)

TRACT 14-B
 RENAISSANCE CENTER 2
 (06/13/1983, C36-162)

ACCESSIBLE PARKING SIGN DETAIL
 SCALE: NTS

STANDARD ADA PARKING STALLS
 SCALE: 1"=20'

VAN ACCESSIBLE ADA PARKING STALLS
 SCALE: 1"=10'

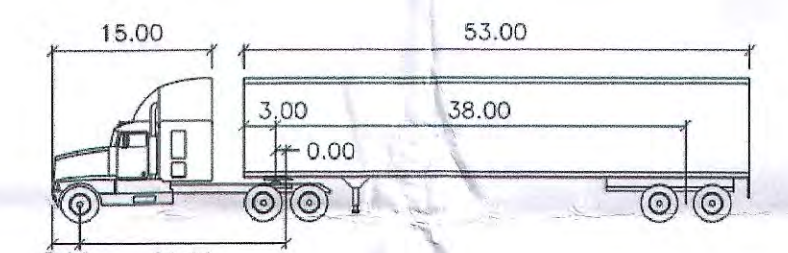

DESIGN VEHICLE WB-55

WB-55b	feet		
Tractor Width	: 8.50	Lock to Lock Time	: 6.0
Trailer Width	: 8.50	Steering Angle	: 26.3
Tractor Track	: 8.50	Articulating Angle	: 70.0
Trailer Track	: 8.50		

LEGEND:

- ⊙ EXISTING FIRE HYDRANT
- ⊙ EXISTING STREET/AREA LIGHT
- SURFACE FLOW ARROWS

LEGAL DESCRIPTION:

LOT LETTERED 'B' IN BLOCK NUMBERED FIVE (5) OF SANDT'S INDUSTRIAL CENTER, AS THE SAME IS SHOWN AND DESIGNATED ON THE PLAT THEREOF, FILED IN THE OFFICE OF THE COUNTY CLERK OF BERNALILLO COUNTY, NEW MEXICO ON APRIL 27, 2007, IN MAP BOOK 2007C, FOLD 102.

PARKING COUNT:

PARKING REQUIREMENTS PER CITY OF ALBUQUERQUE ZONING CODE 14-16-3-1 (MANUFACTURING: 1 SPACE PER 1,000 SF OF NET LEASABLE AREA)
 REQUIRED: 593 SPACES (593 STANDARD STALLS, 8 ADA STALLS)
 PROVIDED: 593 SPACES (593 STANDARD STALLS, 8 ADA STALLS)

DEVELOPMENT AREA:

TOTAL PARCEL: 55.7 AC
 EXISTING STRUCTURE: 133,134 SF
 STRUCTURE FOOTPRINT AFTER EXPANSION: 137,433 SF
 PROPOSED ADDITION: 11,775 SF
 TOTAL SOIL DISTURBANCE: 14,076 SF

ADA STRIPING AND SIGNAGE NOTES:

1. DIMENSIONS FOR STRIPING ARE MEASURED FROM CENTERLINE TO CENTERLINE.
2. DIAGONAL STRIPING FOR ACCESS AISLES, ADA PEDESTRIAN PATHWAY AND "NO PARKING" AREAS SHALL BE 4" THICK, PAINTED BLUE, 5" MAX O/C.
3. STANDARD ADA PARKING STALLS SHALL BE MINIMUM 8.5' IN WIDTH WITH 5' ACCESS AISLE. VAN ACCESSIBLE PARKING STALLS SHALL BE MINIMUM 9.5' IN WIDTH WITH 6' ACCESS AISLE.
4. ADA PARKING STALLS AND ACCESS AISLE SLOPES SHALL NOT EXCEED 2% IN ANY DIRECTION. CONTRACTOR TO VERIFY SLOPES.
5. ADA ACCESS AISLES SHALL HAVE THE WORDS "NO PARKING" IN CAPITAL LETTERS, EACH OF WHICH SHALL BE AT LEAST ONE FOOT HIGH AND AT LEAST TWO INCHES WIDE, PLACED AT THE REAR OF THE PARKING SPACE.
6. STANDARD ACCESSIBLE PARKING SIGN AND VAN ACCESSIBLE PARKING SIGN PER DETAIL 1 ON THIS SHEET.

NOTE:

ALL UNUSED DRIVEWAYS WILL BE CLOSED WITH A CURB AND GUTTER.

CONTRACTOR NOTE:

ALL EXISTING UTILITIES SHOWN ON PLANS ARE TO BE VERIFIED HORIZONTALLY AND VERTICALLY PRIOR TO ANY CONSTRUCTION. ALL EXISTING FEATURES INCLUDING BURIED UTILITIES ARE SHOWN AS INDICATED ON RECORD MAPS AND SURVEY'S FURNISHED BY OTHERS. WE ASSUME NO LIABILITY FOR THE ACCURACY OF THOSE RECORDS AND SURVEY'S. CONTACT THE UTILITY OWNER/AGENCY FOR THE FINAL LOCATION OF EXISTING UTILITIES IN AREAS CRITICAL TO CONSTRUCTION.

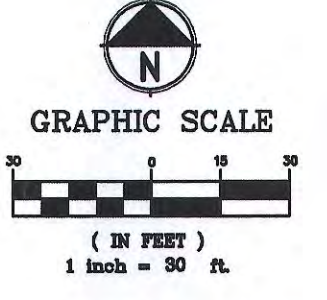
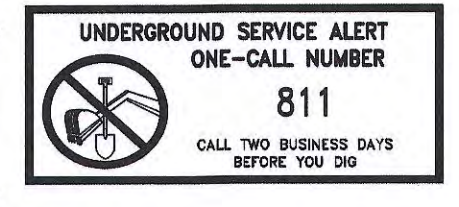

TRACT 6-B
 SUNDT'S INDUSTRIAL CENTER
 FILED 12/27/83, BK. C22, PG. 180

FOR PERMIT
 These drawings are sufficiently complete for submission to the jurisdiction having authority for permit. The contractor shall not use these drawings for construction until contractor receives written approval for use in construction by the jurisdiction having authority and DCI Engineers.

ips
 Integrated Project Services
 Engineering Design/Build Compliance Consulting
 IPS Professional Engineers and Architects, PC.
 3 CORPORATE PARK SUITE 100 IRVINE, CA 92606
 949.679.4682 PHONE 949.679.4683 FAX
 www.ipsd.com

REVISION	DATE	DESCRIPTION	BY
	6/12/2017	PERMIT ISSUE	
	7/31/2017	PERMIT RESUBMITAL	
	8/16/2017	REVISED PERMIT ISSUE	
	8/30/2017	CONSTRUCTION ISSUE	
	8/16/2017	BASELINE NO. 3	
	12/01/2018	REVISED PERMIT ISSUE	

EDCI ENGINEERS
 2300 MICHELSON DRIVE SUITE 930 IRVINE, CALIFORNIA 92612
 PHONE: (949) 892-4550 • FAX: (949) 892-4570
 WEBSITE: www.edci-engineers.com
 CHIVAL / AEC TECHNOLOGICAL
 © Copyright © 2018 EDCI Engineers Inc. All Rights Reserved
 No portion of this document may be reproduced, stored in a retrieval system, or transmitted in any form or by any means, electronic, mechanical, photocopying, recording, or by any information storage and retrieval system, without the prior written permission of EDCI Engineers Inc.

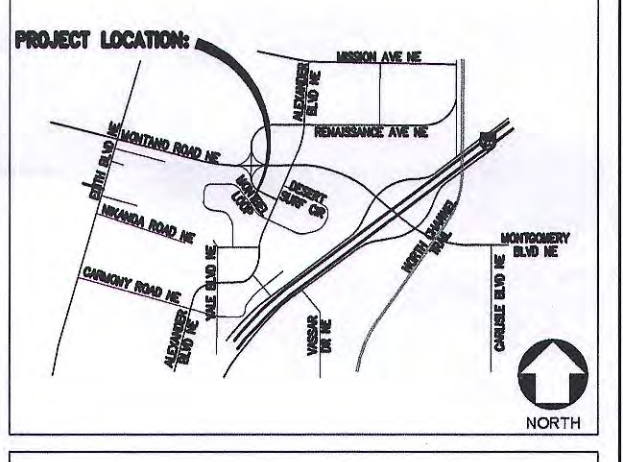

12/08/2017 BULLETIN NO 3

CONFIDENTIAL
 THE INFORMATION CONTAINED HEREIN MAY NOT BE USED OR REPRODUCED IN ANY MANNER WITHOUT WRITTEN PERMISSION OF INTEGRATED PROJECT SERVICES.

CLIENT

 A Division of Albany Molecular Research Inc.

4401 ALEXANDER BLVD, ALBUQUERQUE, NM
SYRINGE LINE PROJECT

DRAWING TITLE
TRAFFIC CIRCULATION PLAN

ENGINEER	ARCHITECT	DESIGNER	IPS PROJECT #
DCI	CSC	CSC	CAD10088.01
DRAWN BY	REVIEWED BY	SCALE	CADD FILE NAME
CSC	MHN	AS NOTED	

XREF FILE(S):
 DRAWING NUMBER
C1.4
 DATE: 12/08/2017

ADMINISTRATIVE AMENDMENT
 FILE # 202263 PROJECT # 201252
 New ramp, curb extension, and updated parking.
 R. B. [Signature]
 APPROVED BY DATE 23 Jan 2019