

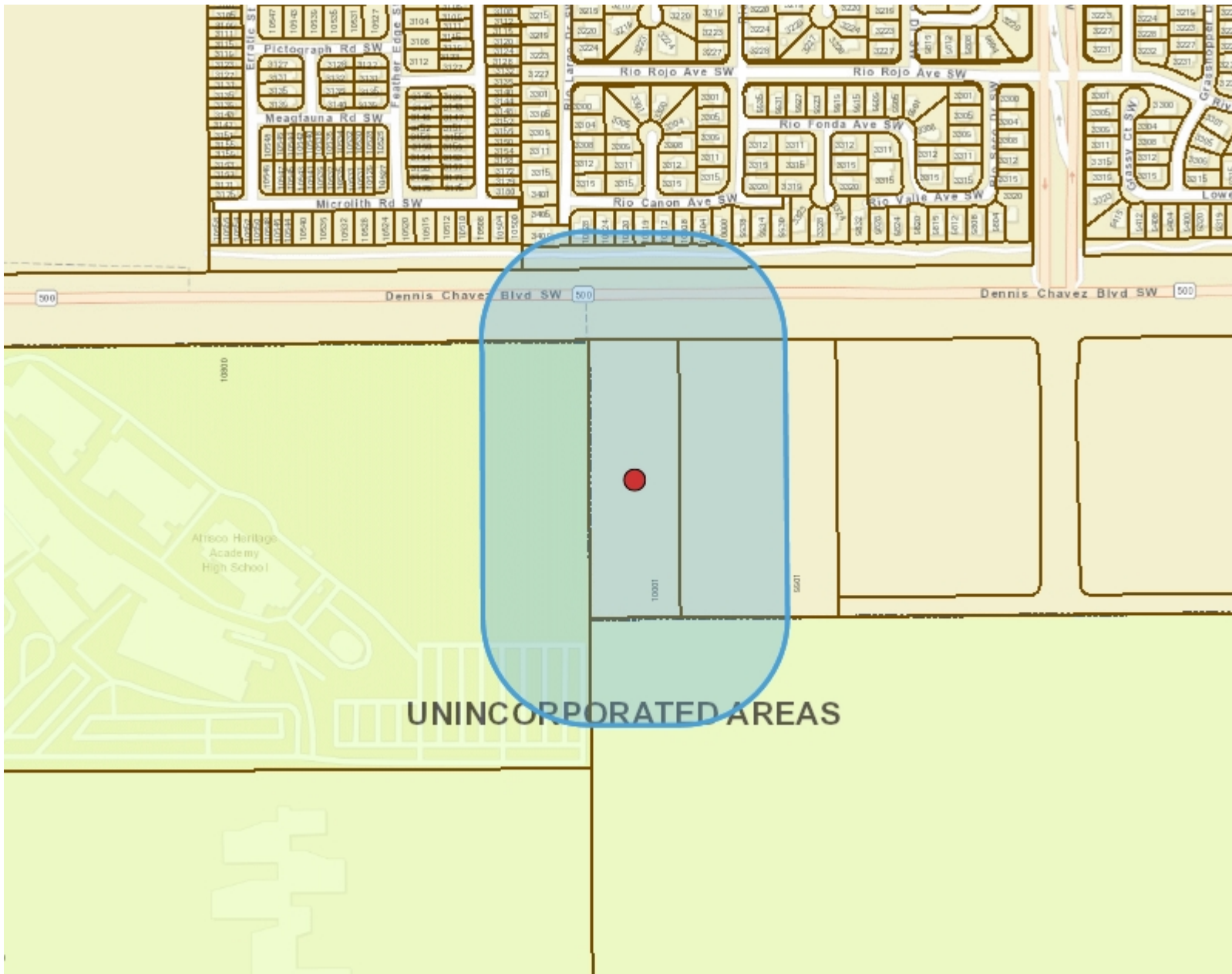

10001 Ceja Vista Rd.



Legend

- Bernalillo County Parcels
- Municipal Limits**
- Corrales
- Edgewood
- Los Ranchos
- Rio Rancho
- Tijeras
- UNINCORPORATED

Notes

Buffer: 328ft.
 ROW: Dennis Chavez Blvd. SW 228ft.

908 0 454 908 Feet

WGS_1984_Web_Mercator_Auxiliary_Sphere
 8/5/2019 © City of Albuquerque

1: 5,448

The City of Albuquerque ("City") provides the data on this website as a service to the public. The City makes no warranty, representation, or guaranty as to the content, accuracy, timeliness, or completeness of any of the data provided at this website. Please visit <http://www.cabq.gov/abq-data/abq-data-disclaimer-1> for more information.
 THIS MAP IS NOT TO BE USED FOR NAVIGATION

GRIEGO FABIAN C
3409 RIO LARGO DR SW
ALBUQUERQUE NM 87121-9369

GALE DIETRICH J & SHANA F
10024 RIO CANON AVE SW
ALBUQUERQUE NM 87121-9353

LY PETER HENPHUC
1844 PINE HOLLOW CIR
SAN JOSE CA 95133-1727

SALAS OSCAR MUNOZ & PROA DAISI
MARQUEZ
10028 RIO CANON AVE SW
ALBUQUERQUE NM 87121-9353

KB HOME NEW MEXICO INC
7807 E PEAKVIEW AVE SUITE 300
CENTENNIAL CO 80111-6849

VAN DENBURG JEFFERY L
10020 RIO CANON AVE SW
ALBUQUERQUE NM 87121-9353

MENDEZ RAMON A & MONTOYA
MARGARET
10008 RIO CANON AVE SW
ALBUQUERQUE NM 87121-9353

GOMEZ-HERNANDEZ RICARDO & LINO-
FLORES BRENDA
10000 RIO CANON AVE SW
ALBUQUERQUE NM 87121-9353

MONSHOWER RICHARD G & JANINE R
10012 RIO CANON AVE SW
ALBUQUERQUE NM 87121-9353

VON HAAS HERBERT N
10004 RIO CANON AVE SW
ALBUQUERQUE NM 87121-2623

ANDERSON HILLS HOMEOWNERS
ASSOCIATION INC
PO BOX 67590
ALBUQUERQUE NM 87193-7590

BERNALILLO COUNTY % COUNTY
MANAGER
1 CIVIC PLAZA NW
ALBUQUERQUE NM 87102

ALBUQUERQUE RIO BRAVO PARTNERS
LLC & PEORIA CAR WASH PARTNERS
LLC ETAL
503 BATH ST
SANTA BARBARA CA 93101-3403

BOARD OF EDUCATION
PO BOX 25704
ALBUQUERQUE NM 87125-0704

DBG PROPERTIES LLC
2164 SW PARK PL
PORTLAND OR 97205-1125