

DEVELOPER
 WHATABRANDS REAL ESTATE
 CONTACT: CINDY ESPINOZA
 300 CONCORD PLAZA DRIVE
 SAN ANTONIO, TX 78216
 PHONE: 210-476-6180
 EMAIL: CESPINOZA@WBHQ.COM

CIVIL ENGINEER
 SUSTAINABILITY ENGINEERING GROUP
 8280 E. GELDING DR, SUITE 101
 SCOTTSDALE, ARIZONA 85260
 PHONE: 480-237-2507
 ATTN: ALI FAKIH

OWNER
 GREEN JEANS WEST, LLC
 2929 MONTE VISTA BLVD NE
 ALBUQUERQUE, NM 87106

WHATABURGER

FIRE 1 SITE PLAN

6100 ALAMEDA NE BLVD, ALBUQUERQUE, NM
 LOT 1-A, BLOCK 29, TRACT A, UNIT B OF NORTH
 BERNALILLO COUNTY, NEW MEXICO.

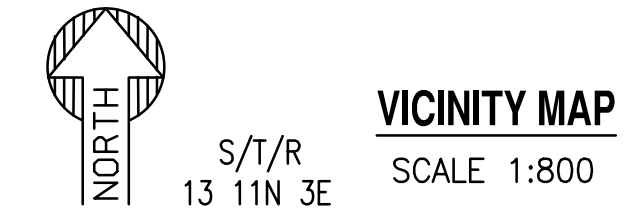
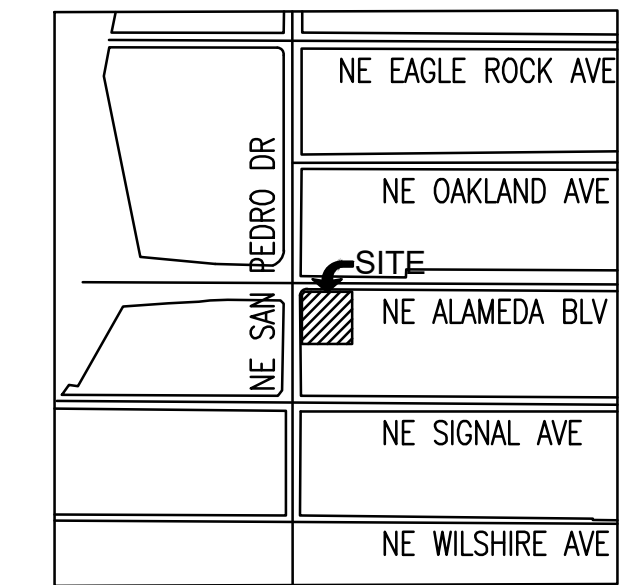

PROJECT DATA
 BUILDING TYPE: VB
 SQUARE FOOTAGE: 2,999
 FIRE FLOW: 1,500 GPM (IFC APPENDIX B)

FIRE APPARATUS ACCESS ROADS:
 HEAVY DUTY ASPHALT PAVEMENT TO BE CONSTRUCTED FOR ALL FIRE APPARATUS ACCESS ROADS.
 PER "GEOTECHNICAL ENGINEERING REPORT" PREPARED BY TERRACON CONSULTANTS, INC AND DATED JANUARY 7, 2022, HEAVY DUTY PAVEMENT DESIGN SHALL BE AS FOLLOWS:

-4 INCHES AC OVER 6 INCHES GRANULAR BASE.

PAVEMENT DESIGN PERIOD IS 20 YEARS FOR UP TO 1 DELIVERY TRUCK PER DAY AND 3 TRASH TRUCKS PER WEEK.

RED PAINTED FIRE CURB:

RED PAINT TO BE ON TOP AND FACE OF THE CURB TO INDICATE FIRE LANE. WHITE BLOCK CAPITAL LETTERS NOT LESS THAN 5 INCHES IN HEIGHT WITH A STROKE OF NOT LESS THAN 3/4 INCH. "NO PARKING-FIRE LANE" SHALL BE MARKED EVERY 15-FEET ALONG THE LENGTH OF THE FIRE LANE. ALL SIGNS AND MARKINGS SHALL BE AT EXPENSE OF THE OWNER, LESSEE, OR PERSON IN CONTROL OF THE PROPERTY.

PROPOSED LEGEND:

- VERTICAL CURB
- CURB AND GUTTER
- PAVEMENT STRIPING
- FIRE HYDRANT
- CONCRETE PAVEMENT/SIDEWALK
- HEAVY DUTY PAVEMENT
- EXISTING PAVEMENT
- 28' / 48' FIRE ACCESS TURN RADIUS
- RED PAINTED FIRE CURB
RE: DET. 6/C2.10

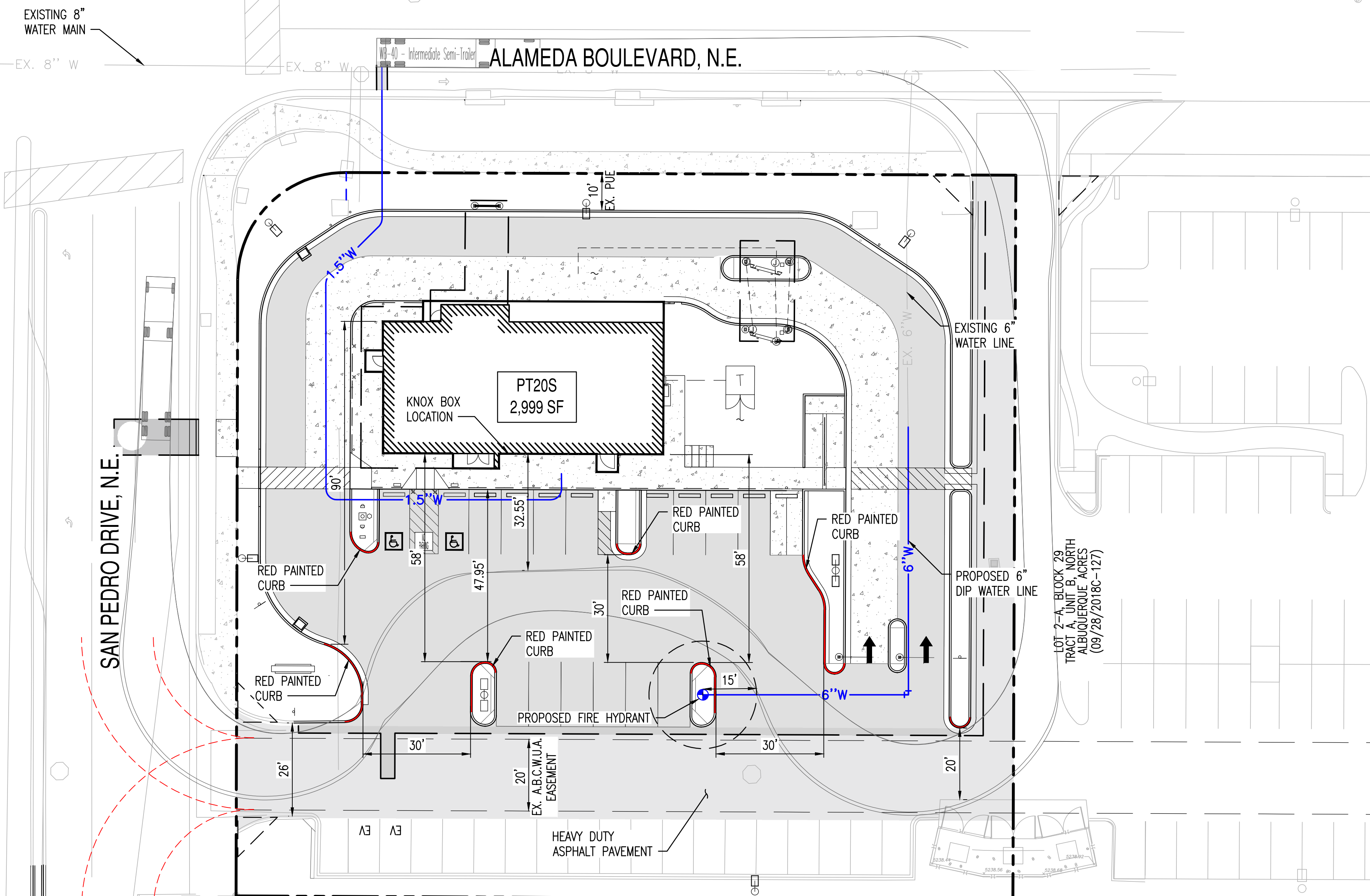
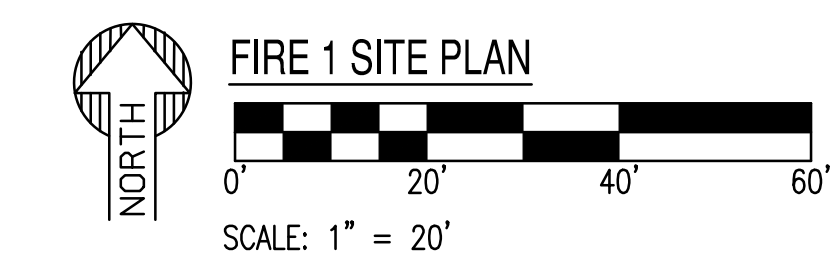

LOT 32, BLOCK 29
 TRACT A, UNIT B, NORTH
 ALBUQUERQUE ACRES
 (04/24/1936, D-130)

LOT 31, BLOCK 29
 TRACT A, UNIT B, NORTH
 ALBUQUERQUE ACRES
 (04/24/1936, D-130)

MONUMENT "10_C18"
 STANDARD C.O.A. ALUMINUM DISC
 (FOUND IN PLACE)
 NEW MEXICO STATE PLANE COORDINATES
 (CENTRAL ZONE-N.A.D. 1983)
 N=1,524,123.885 US SURVEY FEET
 E= 1,542,565.263 US SURVEY FEET
 PUBLISHED EL=5222.09 US SURVEY FEET
 (NAVD 1988)
 GROUND TO GRID FACTOR=0.999665042
 DELTA ALPHA ANGLE=-0°11'19.42"

A.G.R.S. MONUMENT "9_C18"
 STANDARD C.O.A. ALUMINUM DISC
 (FOUND IN PLACE)
 NEW MEXICO STATE PLANE COORDINATES
 (CENTRAL ZONE-N.A.D. 1983)
 N=1,521,497.624 US SURVEY FEET
 E= 1,542,501.428 US SURVEY FEET
 PUBLISHED EL=5232.47 US SURVEY FEET
 (NAVD 1988)
 GROUND TO GRID FACTOR=0.999664563
 DELTA ALPHA ANGLE=-0°11'19.69"

NOT FOR
 CONSTRUCTION

SUSTAINABILITY
 ENGINEERING
 GROUP

SEG

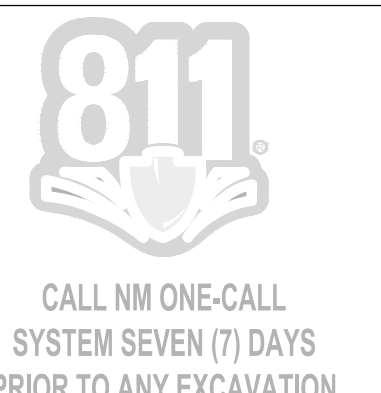

PROJECT WHATABURGER NM SEC ALAMEDA BLVD NE & SAN PEDRO AVE NE	LOCATION 6100 ALAMEDA BLVD NE ALBUQUERQUE, NM
DRAWN: GA 01/27/2022	DESIGNED: LP 01/27/2022
QC:	FINAL QC:
PROJ. MGR.: AF 03/23/2022	DATE: 03/23/2022
ISSUED FOR: DRB	
REVISION NO.:	DATE:
JOB NO.: 210907	
SHEET TITLE: FIRE 1 SITE PLAN	
PAGE NO.: 1 OF 1	SHEET NO.: C2.30

THIS DRAWING IS AN INSTRUMENT OF SERVICE AND THE PROPERTY OF SUSTAINABILITY ENGINEERING GROUP, AND SHALL REMAIN THEIR PROPERTY. THE USE OF THIS DRAWING SHALL BE RESTRICTED TO THE ORIGINAL SITE FOR WHICH IT IS PREPARED AND PUBLICATION THEREOF IS EXPRESSLY LIMITED TO SUCH USE.