

**CODE DATA**  
 city of Albuquerque  
 Location: 10131 Coors Blvd. NW  
 Suite L-05  
 Albuquerque, New Mexico 87114  
 Zoning: SU-1 for C-2 uses  
 Zoning Atlas Page: B-14  
 Setbacks: No Change  
 Height: No change  
 Parking: Existing Bldg.

**Total Shopping Center: 132,433 sq.ft.**  
 Parking Calculations: First 15,000 sq.ft. @ 200 sq.ft. 75  
 Next 45,000 sq.ft. @ 250 sq.ft. 180  
 Next 72,224 sq.ft. @ 300 sq.ft. 241

TOTAL 496  
 HC Required 16  
 Motorcycle Required 7  
 Provided 568  
 HC Provided 21  
 Motorcycle Provided 12

Note: A-01 (Albertsons not include in Retail Center)  
 (Albertsons Parcel- 66,700 sq.ft. building w/ 254 spaces)

AMEND SITE PLAN TO  
 SHOW PROPOSED LOT  
 P.P. 2018-001641

ADMINISTRATIVE AMENDMENT  
 FILE # 2018-001641 PROJECT # P.P. 2018-001641  
 SEE ABOVE  
 APPROVED BY DATE

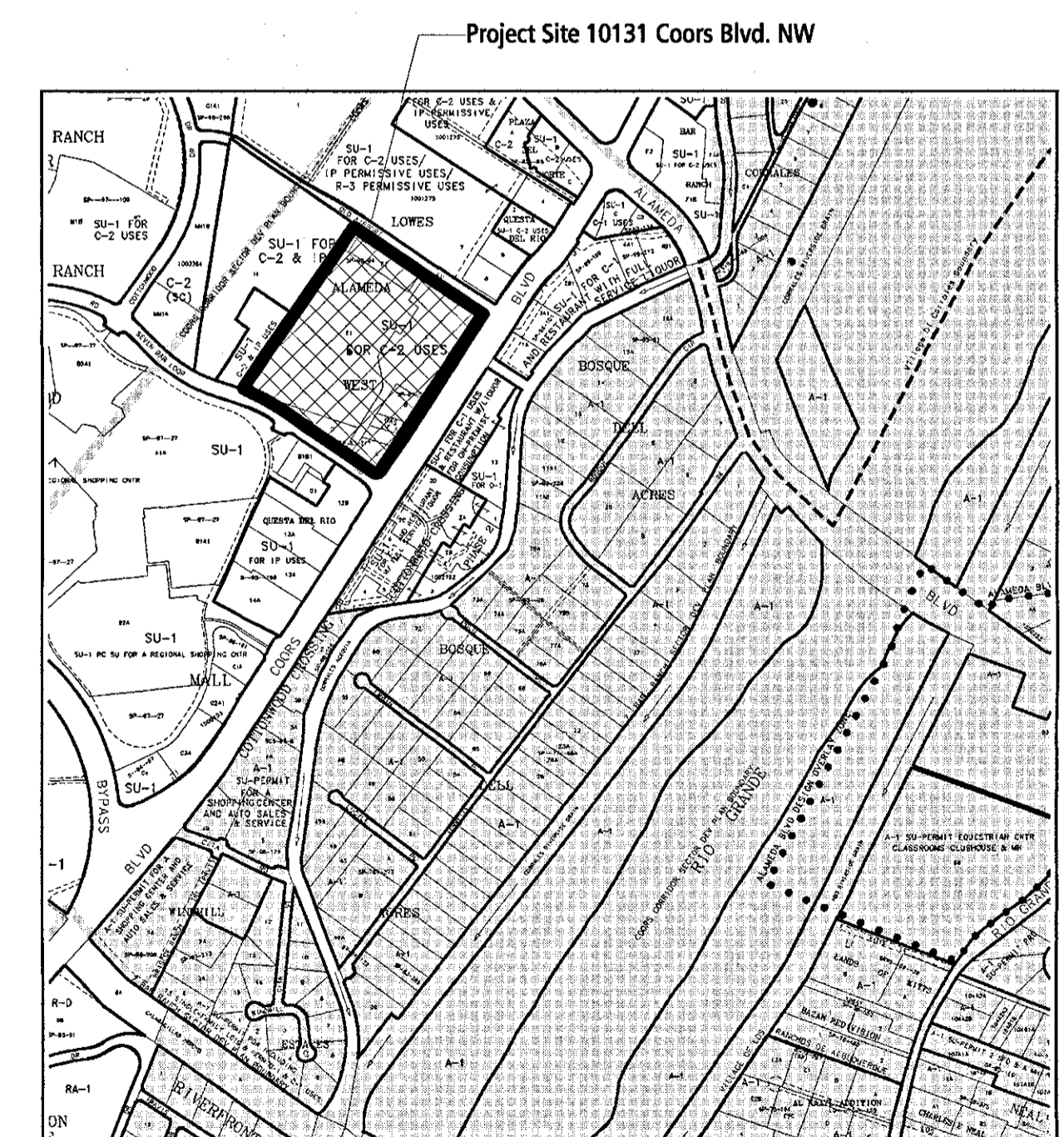

GRAPHIC SCALE IN FEET  
 250 0 750 1000  
**Zone Atlas Page**  
**B-14-Z**  
 Map Amended through December 31, 2014

TREVESTON ELLIOTT ARCHITECT

811 12TH ST. NW  
 ALBUQUERQUE, NEW MEXICO  
 87102  
 P: 505.759.4617  
 treveston@earthlink.net  
 www.trevestonarchitect.com

ALAMEDA WEST SHOPPING CENTER  
 ALBUQUERQUE, NEW MEXICO

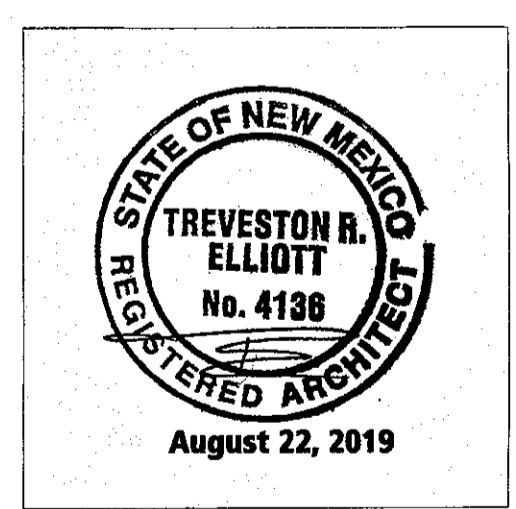

Date: August 22, 2019

Sheet: Site Plan

1 Site Plan- Proposed  
 Scale: 1" = 50'-0"