

PROPOSED DRIVE AISLE ASPHALT PAVEMENT SECTION

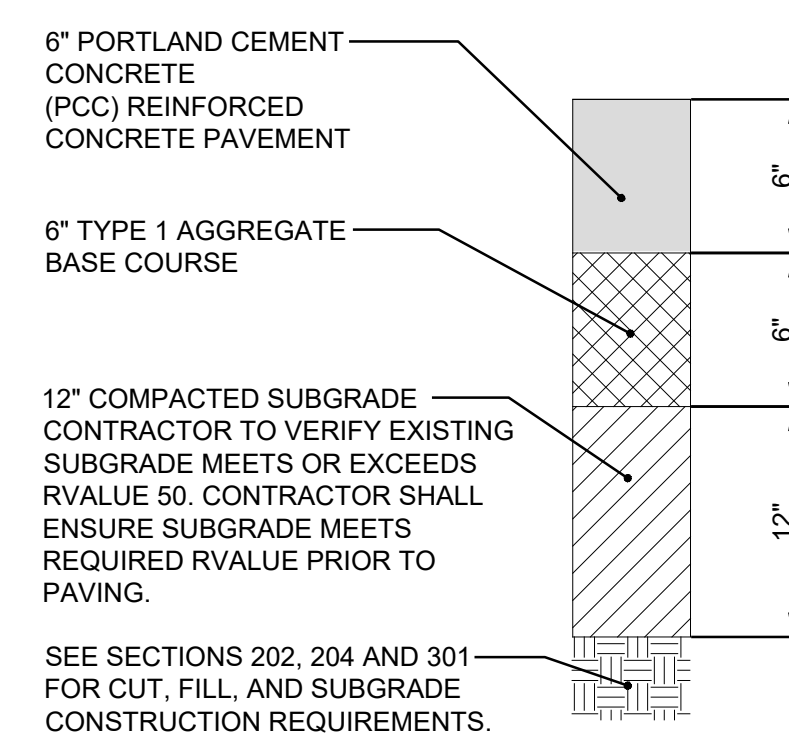

PROPOSED RAISED CROSSWALK CONCRETE PAVEMENT SECTION

Plotted: 3/20/2021 2:08:43 PM, By: Edinger, Scott  
 User: scott.edinger@cityofalbuquerque.gov  
 Last Saved: 3/20/2021 2:08:32 PM, Locking:

AS BUILT INFORMATION	
CONTRACTOR	DATE
WORK ORDER NO.	DATE
INSPECTOR'S ACCEPTANCE BY	DATE
VERIFICATION BY	DATE
COMPARISON BY	DATE
MICRO-FILM INFORMATION	
RECORDED BY	DATE
NO.	

BENCH MARKS	
FOUND MONUMENT "LH19A"	
A CITY OF ALBUQUERQUE BRASS DISK SET IN A CONCRETE POST	
0.1 FEET BELOW GROUND LEVEL AND IS STAMPED "LH19A, 1989"	
X = 1548398.44	
Y = 1483076.47	
ELEVATION IS 526.611 (NAD 1988)	

SURVEY INFORMATION	
FIELD NOTES	BY
NO.	DATE

ENGINEER'S SEAL	
DATE	BY
REVISIONS	
DESIGN	
DATE: SEPT. 6, 2017	
DATE: SEPT. 6, 2017	
DWG NAME: C400.dwg	
CHECKED BY: NV	
DATE: SEPT. 6, 2017	

DESIGNED BY:	HUITT-ZOLLARS
HUITT-ZOLLARS, Inc.	Albuquerque
6501 Americas Parkway NE, Suite 550	
Albuquerque, New Mexico 87110	
Phone (505) 883-8114	Fax (505) 883-5022

<b>THE LOFTS @ WINROCK</b> 7500 INDIAN SCHOOL ROAD NE ALBUQUERQUE, NM	
TITLE: <b>SITE DETAIL</b>	
Design Review Committee	City Engineer
City Project No.	Zone Map No.
XXXX.XX	J-19
Sheet	Of
C400	