

LEGAL DESCRIPTION

LEGAL DESCRIPTION: TRACTS L&M GATEWAY INDUSTRIAL PARK

SHEET KEYED NOTES

1. BIKE RACK
2. KNOX BOX LOCATION
3. EXISTING HANDICAP PARKING TO REMAIN
4. LANDSCAPE AREA
5. PAINTED STRIPES, NO PARKING AREA
6. LIGHT POLE
7. EXISTING 6' CMU FENCE TO REMAIN
8. PREMISE ID
9. EXISTING REFUSE ENCLOSURE
10. PROPERTY LINE
11. PEDESTRIAN WALKWAY
12. NEW ASPHALT
13. CURB CUT FOR WATER HARVESTING

PARKING REQUIRED FOR PROPOSED ADDITION (TABLE 5-5-1)

WAREHOUSE	5,892 SF	0
VOCATIONAL	4,900 SF /1000	15
		15

PARKING PROVIDED

EXISTING = 37
ADDITIONAL = 43
TOTAL PARKING = 80
HANDICAP PARKING = 4
2 MOTORCYCLE PARKING = 4

NOTE: BUILDING MOUNTED SIGNAGE IS EXISTING, NO NEW SIGNAGE AS PART OF THIS PROJECT

LEGEND

- EXISTING PARKING TO REMAIN.
- EXISTING BUILDING TO REMAIN.
- NEW BUILDING ADDITION
- NO PARKING STRIPING

KEYPLAN

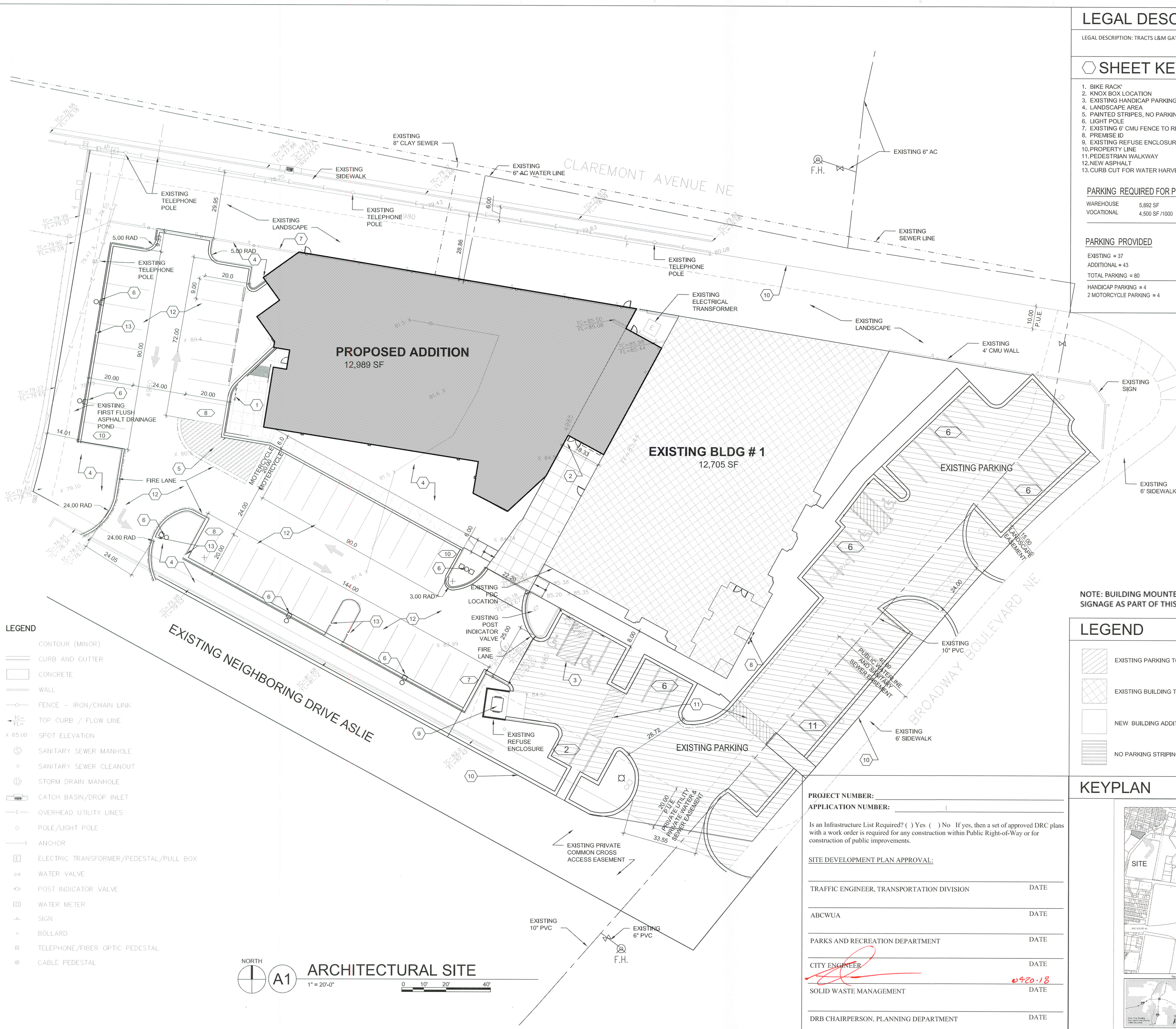
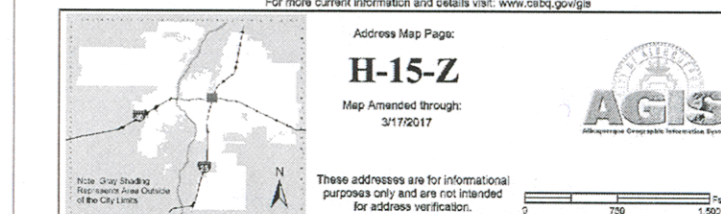

LEGEND

- CONTOUR (MINOR)
- CURB AND GUTTER
- CONCRETE
- WALL
- FENCE - IRON/CHAIN LINK
- TOP CURB / FLOW LINE
- SPOT ELEVATION
- SANITARY SEWER MANHOLE
- SANITARY SEWER CLEANOUT
- STORM DRAIN MANHOLE
- CATCH BASIN/DROP INLET
- OVERHEAD UTILITY LINES
- POLE/LIGHT POLE
- ANCHOR
- ELECTRIC TRANSFORMER/PEDESTAL/PULL BOX
- WATER VALVE
- POST INDICATOR VALVE
- WATER METER
- SIGN
- BOLLARD
- TELEPHONE/FIBER OPTIC PEDESTAL
- CABLE PEDESTAL



A1

ARCHITECTURAL SITE

1" = 20'-0" 0 10' 20' 40'

PROJECT NUMBER:

APPLICATION NUMBER:

Is an Infrastructure List Required? () Yes () No If yes, then a set of approved DRC plans with a work order is required for any construction within Public Right-of-Way or for construction of public improvements.

SITE DEVELOPMENT PLAN APPROVAL:

TRAFFIC ENGINEER, TRANSPORTATION DIVISION DATE

ABCWUA DATE

PARKS AND RECREATION DEPARTMENT DATE

CITY ENGINEER DATE

SOLID WASTE MANAGEMENT DATE

DRB CHAIRPERSON, PLANNING DEPARTMENT DATE

092018