

**BUILDING C: VEHICLE MAINTENANCE BUILDING**

**CODE ANALYSIS:** NEW BUILDING H-4 OCCUPANCY

**A. PROJECT ADDRESS:** 4600 EDITH BLVD NE, ALBUQUERQUE, NEW MEXICO 87107

**B. APPLICABLE REGULATORY INFORMATION:**

- 2015 NEW MEXICO COMMERCIAL BUILDING CODE
- 2014 NEW MEXICO ELECTRICAL CODE
- 2015 NEW MEXICO ENERGY CONSERVATION CODE (CITY BUILDINGS)
- 2015 NEW MEXICO EXISTING BUILDING CODE
- 2012 NEW MEXICO MECHANICAL CODE
- 2012 NEW MEXICO PLUMBING CODE
- ICCANSI A117.1-2010

**C. OCCUPANCY GROUP:** GROUP A-2, B, H-2 & S-1 (SECTION 507.5, IBC)  
SEPARATION OF OCCUPANCIES PER TABLE 508.4

**D. CONSTRUCTION TYPE:** I-B (TABLE 601, IBC)

**E. AUTOMATIC SPRINKLER SYSTEM: PROVIDED**

**F. ALLOWABLE BUILDING AREA: (GROSS) UNLIMITED (PER TABLE 507.5, IBC)**  
**ACTUAL BUILDING AREA: (GROSS) 52,037 SF (GROSS, AS MEASURED TO EXTERIOR FACE OF WALLS)**

**G. ALLOWABLE HEIGHT: 75 FEET (PER TABLE 504.3, IBC)**  
**APPROXIMATE HEIGHT: 35 FEET**

**H. ALLOWABLE STORIES: 3 STORIES (PER TABLE 504.4, IBC)**  
**ACTUAL STORIES: 2 STORIES**

**I. FIRE-RESISTANCE RATING REQUIREMENTS FOR EXTERIOR WALLS: ALL WALLS (FIRE SEPARATION DISTANCE = GREATER THAN 30' PER TABLE 602, IBC)**  
0 HOURS

**J. CORRIDOR FIRE-RESISTANCE RATING: 0 HOURS (CORRIDORS NOT USED)**

**K. INTERIOR WALL AND CEILING FINISH REQUIREMENTS BY OCCUPANCY (TABLE 603.11):**

- OCCUPANCY: A-2 (MOST RESTRICTIVE)
- EXIT ENCLOSURES AND EXIT PASSAGEWAYS FLAME SPREAD INDEX: B
- CORRIDORS FLAME SPREAD INDEX: B
- ROOMS AND ENCLOSED SPACES FLAME SPREAD INDEX: C

**L. MINIMUM ROOF COVERING CLASSIFICATION: CLASS C (TABLE 1505.1, IBC)**

**M. OCCUPANCY SEPARATION: 0 HOUR (NON-SEPARATED USES) (PER SECTION 508.4)**

**N. MAXIMUM DISTANCE, COMMON PATH OF EGRESS TRAVEL (SECTION 1006.2.1, IBC): 107'**  
**ACTUAL TRAVEL DISTANCE: 12 FT**

**O. MAXIMUM OCCUPANT LOAD FOR SPACES WITH ONE EXIT OR EXIT ACCESS DOORWAY (TABLE 1006.3.2(2)): N/A**

**P. MINIMUM NUMBER OF REQUIRED PLUMBING FIXTURES (TABLE 2902.1, IBC)**

SEE SHEET G-007 & SHEET G-008C

**BUILDING D: GUARD SHACK**

**CODE ANALYSIS:** NEW BUILDING B OCCUPANCY

**A. PROJECT ADDRESS:** 4600 EDITH BLVD NE, ALBUQUERQUE, NEW MEXICO 87107

**B. APPLICABLE REGULATORY INFORMATION:**

- 2015 NEW MEXICO COMMERCIAL BUILDING CODE
- 2014 NEW MEXICO ELECTRICAL CODE
- 2015 NEW MEXICO ENERGY CONSERVATION CODE (CITY BUILDINGS)
- 2015 NEW MEXICO EXISTING BUILDING CODE
- 2012 NEW MEXICO MECHANICAL CODE
- 2012 NEW MEXICO PLUMBING CODE
- ICCANSI A117.1-2010

**C. OCCUPANCY GROUP:** GROUP B (SECTION 304 IBC)  
NON-SEPARATED USES PER TABLE 508.4

**D. CONSTRUCTION TYPE:** V-B (TABLE 601, IBC)

**E. AUTOMATIC SPRINKLER SYSTEM: NOT PROVIDED**

**F. ALLOWABLE BUILDING AREA: (GROSS) 9,000 S.F. (PER TABLE 506.2, IBC)**  
**ACTUAL BUILDING AREA: (GROSS) 2,907 S.F. (GROSS, AS MEASURED TO EXTERIOR FACE OF WALLS)**

**G. ALLOWABLE HEIGHT: 40 FEET (PER TABLE 504.3, IBC)**  
**APPROXIMATE HEIGHT: 13 FEET**

**H. ALLOWABLE STORIES: 3 STORIES (PER TABLE 504.4, IBC)**  
**ACTUAL STORIES: 1 STORY**

**I. FIRE-RESISTANCE RATING REQUIREMENTS FOR EXTERIOR WALLS: ALL WALLS (FIRE SEPARATION DISTANCE = GREATER THAN 30' PER TABLE 602, IBC)**  
0 HOURS

**J. CORRIDOR FIRE-RESISTANCE RATING: 0 HOURS (CORRIDORS NOT USED)**

**K. INTERIOR WALL AND CEILING FINISH REQUIREMENTS BY OCCUPANCY (TABLE 603.11):**

- OCCUPANCY: B
- EXIT ENCLOSURES AND EXIT PASSAGEWAYS FLAME SPREAD INDEX: A
- CORRIDORS FLAME SPREAD INDEX: B
- ROOMS AND ENCLOSED SPACES FLAME SPREAD INDEX: C

**L. MINIMUM ROOF COVERING CLASSIFICATION: CLASS C (TABLE 1505.1, IBC)**

**M. OCCUPANCY SEPARATION: 0 HOUR (NON-SEPARATED USES) (PER SECTION 508.4)**

**N. MAXIMUM DISTANCE, COMMON PATH OF EGRESS TRAVEL (SECTION 1006.2.1, IBC): 107'**  
**ACTUAL TRAVEL DISTANCE: 12 FT**

**O. MAXIMUM OCCUPANT LOAD FOR SPACES WITH ONE EXIT OR EXIT ACCESS DOORWAY (TABLE 1006.3.2(2)): 10**

**P. ACTUAL OCCUPANT LOAD: 16 OCCUPANTS**  
**ACTUAL NUMBER OF EXITS: TWO**

**R. MINIMUM NUMBER OF REQUIRED PLUMBING FIXTURES (TABLE 2902.1, IBC)**

1 LAV & 1 WATER CLOSET UNISEX (PER SECTION 2902.2)

**FIRE 1 PLAN**



**DECEMBER 2, 2019**

**SHEET No. FP-1**

COA PROJECT No. 7006.92 JRMA No. 4907

**BUILDING A: ADMINISTRATION BUILDING**

**CODE ANALYSIS:** SWMD ADMINISTRATION BUILDING NEW BUILDING, B & S-1 OCCUPANCIES

**A. PROJECT ADDRESS:** 4600 EDITH BLVD NE, ALBUQUERQUE, NEW MEXICO 87107

**B. APPLICABLE REGULATORY INFORMATION:**

- 2015 NEW MEXICO COMMERCIAL BUILDING CODE
- 2014 NEW MEXICO ELECTRICAL CODE
- 2015 NEW MEXICO ENERGY CONSERVATION CODE (CITY BUILDINGS)
- 2015 NEW MEXICO EXISTING BUILDING CODE
- 2012 NEW MEXICO MECHANICAL CODE
- 2012 NEW MEXICO PLUMBING CODE
- ICCANSI A117.1-2010

**C. OCCUPANCY GROUP:** GROUP B (SECTION 304, IBC)  
GROUP S-1 (SECTION 311, IBC)

**D. CONSTRUCTION TYPE: B (TABLE 601, IBC)**

**E. AUTOMATIC SPRINKLER SYSTEM: PROVIDED THROUGHOUT IN ACCORDANCE WITH SECTION 903.5, IBC.**  
**FIRE SUPPRESSION SYSTEM: WET PIPE SYSTEM.**

**F. ALLOWABLE BUILDING AREA: (GROSS) UNLIMITED (PER TABLE 507.5, IBC)**  
**ACTUAL BUILDING AREA: (GROSS) 25,290 SF (GROSS, AS MEASURED TO EXTERIOR FACE OF WALLS)**

**G. ALLOWABLE HEIGHT: 75 FEET (PER TABLE 504.3, IBC)**  
**APPROXIMATE HEIGHT: 41 FEET**

**H. ALLOWABLE STORIES: 4 STORIES (PER TABLE 504.4, IBC)**  
**ACTUAL STORIES: 2 STORY**

**I. FIRE-RESISTANCE RATING REQUIREMENTS FOR EXTERIOR WALLS: ALL SIDES GREATER THAN 30 FEET (FIRE SEPARATION DISTANCE = GREATER THAN 30' PER TABLE 602, IBC)**  
NO EXTERIOR WALL FIRE RATING

**J. CORRIDOR FIRE-RESISTANCE RATING: 0 HOURS (CORRIDORS NOT USED)**

**K. INTERIOR WALL AND CEILING FINISH REQUIREMENTS BY OCCUPANCY (TABLE 603.11):**

- OCCUPANCY: B AND S-1
- EXIT ENCLOSURES AND EXIT PASSAGEWAYS FLAME SPREAD INDEX: B (C IN S-1)
- CORRIDORS FLAME SPREAD INDEX: B
- ROOMS AND ENCLOSED SPACES FLAME SPREAD INDEX: C

**L. MINIMUM ROOF COVERING CLASSIFICATION: CLASS C (TABLE 1505.1, IBC)**

**M. OCCUPANCY SEPARATION: 0 HOUR (NON-SEPARATED USES) (PER SECTION 508.4)**

**N. MAXIMUM DISTANCE, COMMON PATH OF EGRESS TRAVEL (SECTION 1006.2.1, IBC): 107'**  
**ACTUAL TRAVEL DISTANCE: 59 FT**

**O. TOTAL TRAVEL DISTANCE: 200 FEET**  
**ACTUAL TRAVEL DISTANCE: 200 FEET**

**P. MAXIMUM OCCUPANT LOAD FOR SPACES WITH ONE EXIT OR EXIT ACCESS DOORWAY (TABLE 1006.3.2(2)): 10**  
**ACTUAL OCCUPANT LOAD: 200**

**Q. ACTUAL OCCUPANT LOAD: 248 OCC**  
**ACTUAL NUMBER OF EXITS: 8 EXITS (FIRST FLOOR, 2 EXITS SECOND FLOOR)**

**R. MINIMUM NUMBER OF REQUIRED PLUMBING FIXTURES (TABLE 2902.1, IBC)**

- GROUP B AND S-1 OCCUPANCY: 248 OCCUPANTS = 124 MALE, 124 FEMALE
- WATER CLOSET REQUIRED, MALE = 2
- WATER CLOSET REQUIRED, FEMALE = 4
- LAVATORIES REQUIRED, MALE = 1
- LAVATORIES REQUIRED, FEMALE = 1
- DRINKING FOUNTAINS REQUIRED = 1
- SERVICE SINK REQUIRED = 1

**2. TOTAL PLUMBING FIXTURES PROVIDED:**

WATER CLOSET, MALE = 6 (4 WC + 2 UR)  
WATER CLOSET, FEMALE = 6  
LAVATORIES, MALE = 4  
LAVATORIES, FEMALE = 4  
DRINKING FOUNTAINS = 4  
SERVICE SINK = 2

**BUILDING B: BIN REPAIR/WELD SHOP BUILDING**

**CODE ANALYSIS:** NEW BUILDING H-4 OCCUPANCY

**A. PROJECT ADDRESS:** 4600 EDITH BLVD NE, ALBUQUERQUE, NEW MEXICO 87107

**B. APPLICABLE REGULATORY INFORMATION:**

- 2015 NEW MEXICO COMMERCIAL BUILDING CODE
- 2014 NEW MEXICO ELECTRICAL CODE
- 2015 NEW MEXICO ENERGY CONSERVATION CODE (CITY BUILDINGS)
- 2015 NEW MEXICO EXISTING BUILDING CODE
- 2012 NEW MEXICO MECHANICAL CODE
- 2012 NEW MEXICO PLUMBING CODE
- ICCANSI A117.1-2010

**C. OCCUPANCY GROUP:** GROUP H-4 (SECTION 307 IBC)  
NON-SEPARATED USES PER TABLE 508.4

**D. CONSTRUCTION TYPE: V-B (TABLE 601, IBC)**

**E. AUTOMATIC SPRINKLER SYSTEM: PROVIDED (PER NOTE C ON TABLE 506.2)**

**F. ALLOWABLE BUILDING AREA: (GROSS) 26,000 S.F. (PER TABLE 506.2, IBC)**  
**ACTUAL BUILDING AREA: (GROSS) 2,907 S.F. (GROSS, AS MEASURED TO EXTERIOR FACE OF WALLS)**

**G. ALLOWABLE HEIGHT: 60 FEET (PER TABLE 504.3, IBC)**  
**APPROXIMATE HEIGHT: 28 FEET**

**H. ALLOWABLE STORIES: 3 STORIES (PER TABLE 504.4, IBC)**  
**ACTUAL STORIES: 1 STORY**

**I. FIRE-RESISTANCE RATING REQUIREMENTS FOR EXTERIOR WALLS: ALL WALLS (FIRE SEPARATION DISTANCE = GREATER THAN 30' PER TABLE 602, IBC)**  
0 HOURS

**J. CORRIDOR FIRE-RESISTANCE RATING: 0 HOURS (CORRIDORS NOT USED)**  
**(H-4 OCCUPANCY WITH SPRINKLER SYSTEM TABLE 1020.1, IBC) NOT APPLICABLE**

**K. INTERIOR WALL AND CEILING FINISH REQUIREMENTS BY OCCUPANCY (TABLE 603.11):**

- OCCUPANCY: H-4
- EXIT ENCLOSURES AND EXIT PASSAGEWAYS FLAME SPREAD INDEX: B
- CORRIDORS FLAME SPREAD INDEX: B
- ROOMS AND ENCLOSED SPACES FLAME SPREAD INDEX: C

**L. MINIMUM ROOF COVERING CLASSIFICATION: CLASS C (TABLE 1505.1, IBC)**

**M. OCCUPANCY SEPARATION: 0 HOUR (NON-SEPARATED USES) (PER SECTION 508.4)**

**N. MAXIMUM DISTANCE, COMMON PATH OF EGRESS TRAVEL (SECTION 1006.2.1, IBC): 75'**  
**ACTUAL TRAVEL DISTANCE: 53 FT**

**O. MAXIMUM OCCUPANT LOAD FOR SPACES WITH ONE EXIT OR EXIT ACCESS DOORWAY (TABLE 1006.3.2(2)): 10**

**P. ACTUAL OCCUPANT LOAD: 16 OCCUPANTS**  
**ACTUAL NUMBER OF EXITS: TWO**

**R. MINIMUM NUMBER OF REQUIRED PLUMBING FIXTURES (TABLE 2902.1, IBC)**

1 LAV & 1 WATER CLOSET UNISEX (PER SECTION 2902.2)

**SITE NOTES:**

- ACCESS ROUTE GRADES (ENTRY DRIVEWAYS) ARE SHOWN ON THE PLAN. ALL OTHER GRADES THROUGHOUT SITE ARE APPROX. 2% WITH A MAX OF 4.4% IN THE COLLECTION TRUCK PARKING WEST OF BUILDING C.
- PAVEMENT SECTION FOR ACCESS ROUTE CONSISTS OF 6" OF ASPHALT (SPIII) OVER 6" AGGREGATE BASE COURSE WITH 12" SUBGRADE PREP.

**FIRE 1 PLAN**

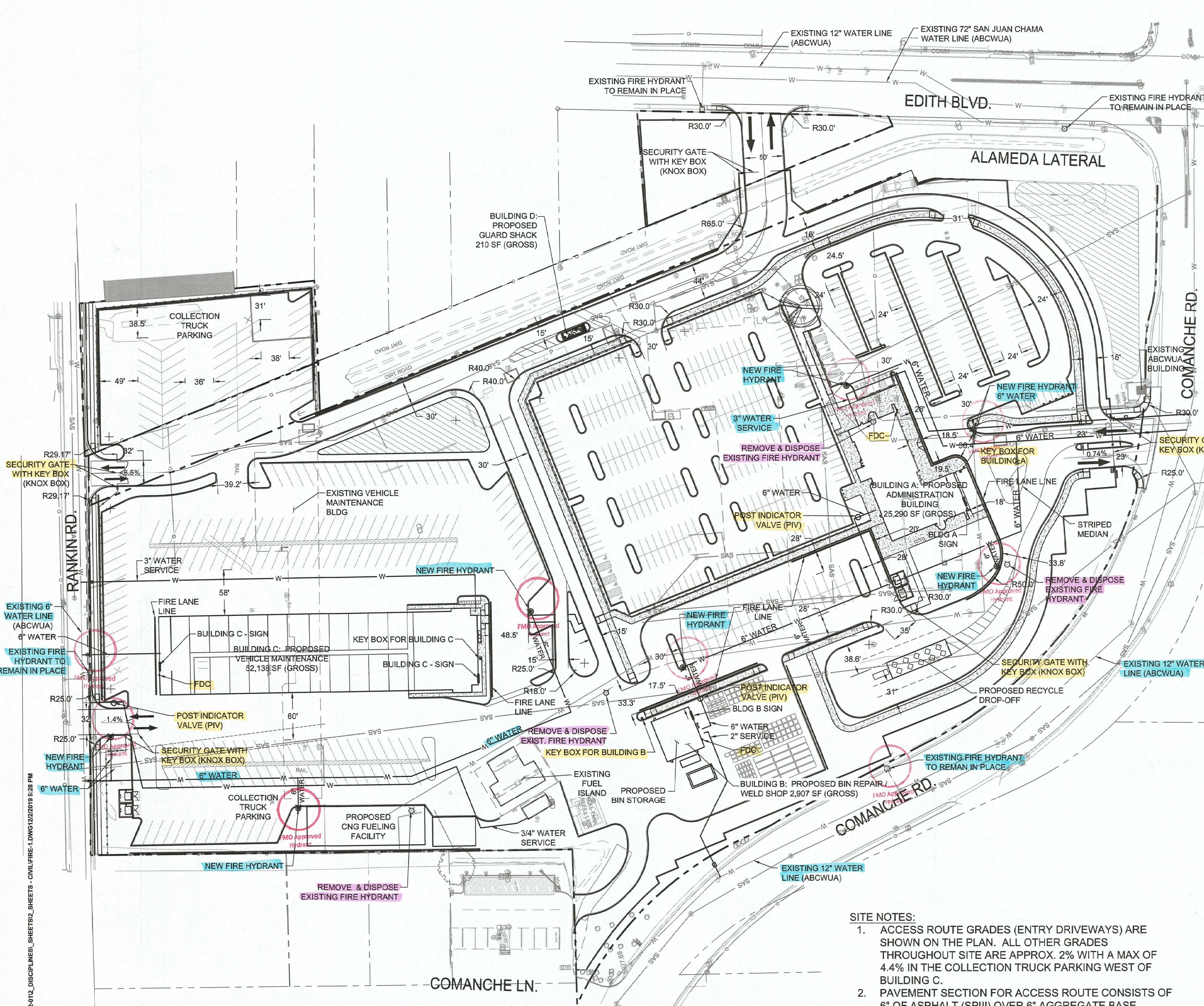
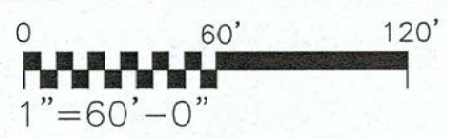

**Building A**  
 HYDRANT AND FIRE ACCESS  
 ALBUQUERQUE FIRE MARSHAL'S OFFICE  
 PLANS CHECKING DIVISION  
 SOFT 2,907 CONSTRUCTION TYPE V-B  
 GPM 1125 NUMBER OF HYDRANTS 1  
 APPROVED/DISAPPROVED  
 12/29/19  
 19-001301

**Building B**  
 HYDRANT AND FIRE ACCESS  
 ALBUQUERQUE FIRE MARSHAL'S OFFICE  
 PLANS CHECKING DIVISION  
 SOFT 2,907 CONSTRUCTION TYPE V-B  
 GPM 1500 NUMBER OF HYDRANTS 3  
 APPROVED/DISAPPROVED  
 12/29/19  
 19-001301

**Building C**  
 HYDRANT AND FIRE ACCESS  
 ALBUQUERQUE FIRE MARSHAL'S OFFICE  
 PLANS CHECKING DIVISION  
 SOFT 52,037 CONSTRUCTION TYPE I-B  
 GPM 2375 NUMBER OF HYDRANTS 3  
 APPROVED/DISAPPROVED  
 12/29/19  
 19-001301

**Building D**  
 HYDRANT AND FIRE ACCESS  
 ALBUQUERQUE FIRE MARSHAL'S OFFICE  
 PLANS CHECKING DIVISION  
 SOFT 2,907 CONSTRUCTION TYPE V-B  
 GPM 1500 NUMBER OF HYDRANTS 3  
 APPROVED/DISAPPROVED  
 12/29/19  
 19-001301

W:\14-100-132-012\_DISCIPLINES\14-100-132-012\_19-001301\_SHEETS - CIVIL\FIRE-1.DWG(12/29/2019 5:28 PM)

**REVISED FIRE 1 PLAN:**  
 ORIGINAL SUBMITTAL DATED  
 FEBRUARY 01, 2019. SECOND  
 SUBMITTAL DATED MAY 15, 2019.