

EXISTING PICKUP DEMOLITION PLAN

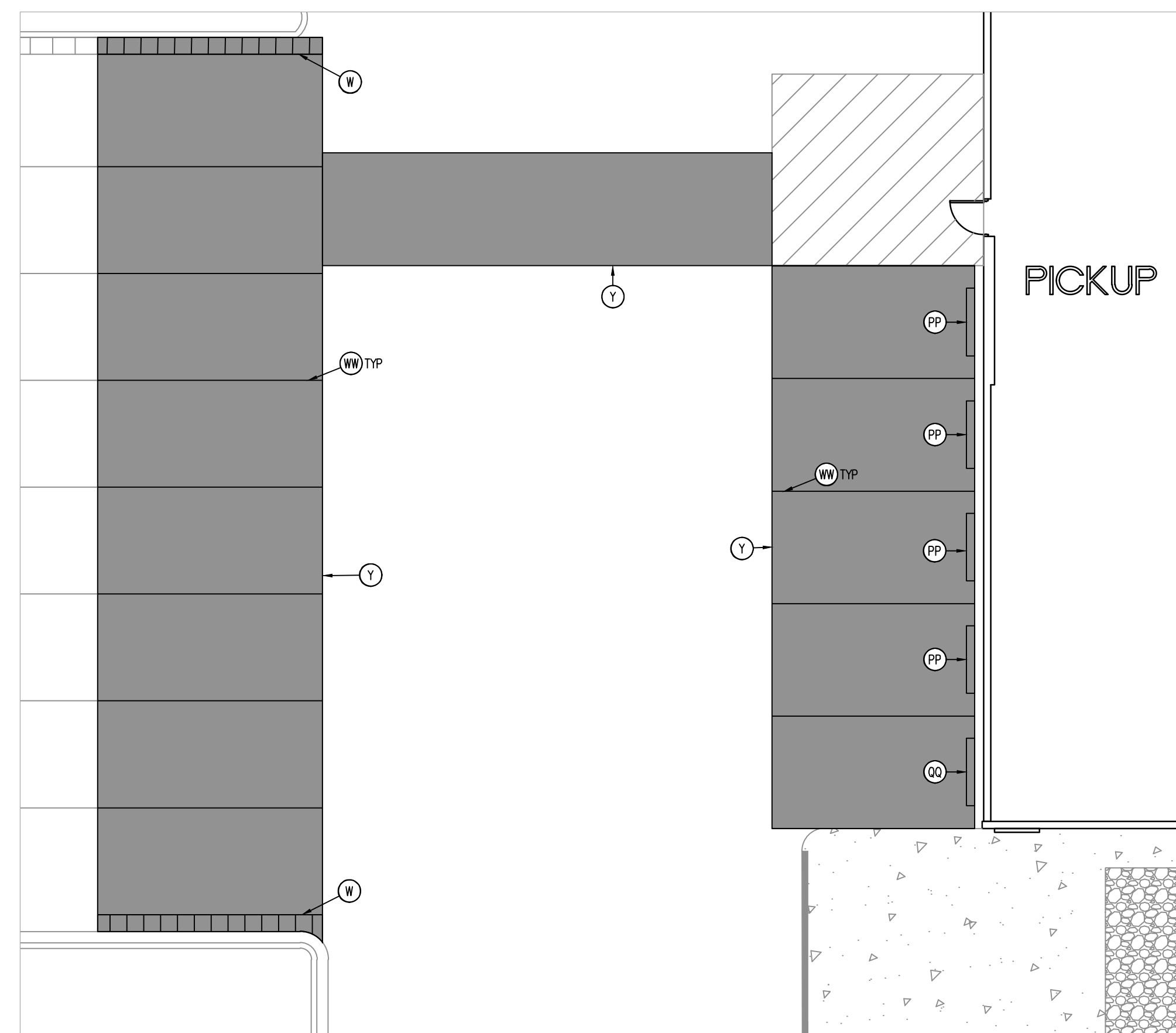

EXISTING PICKUP SITE CONSTRUCTION PLAN

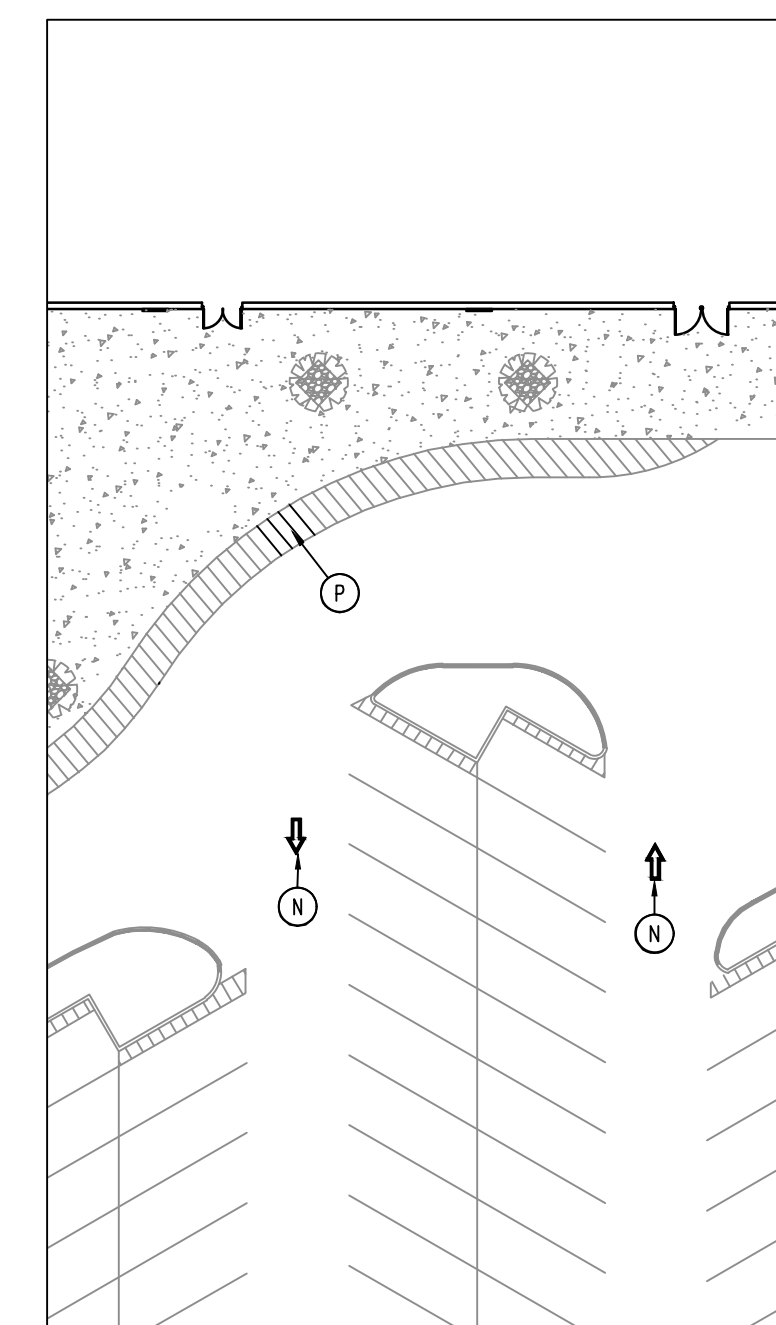

PROPOSED PICKUP DEMOLITION PLAN

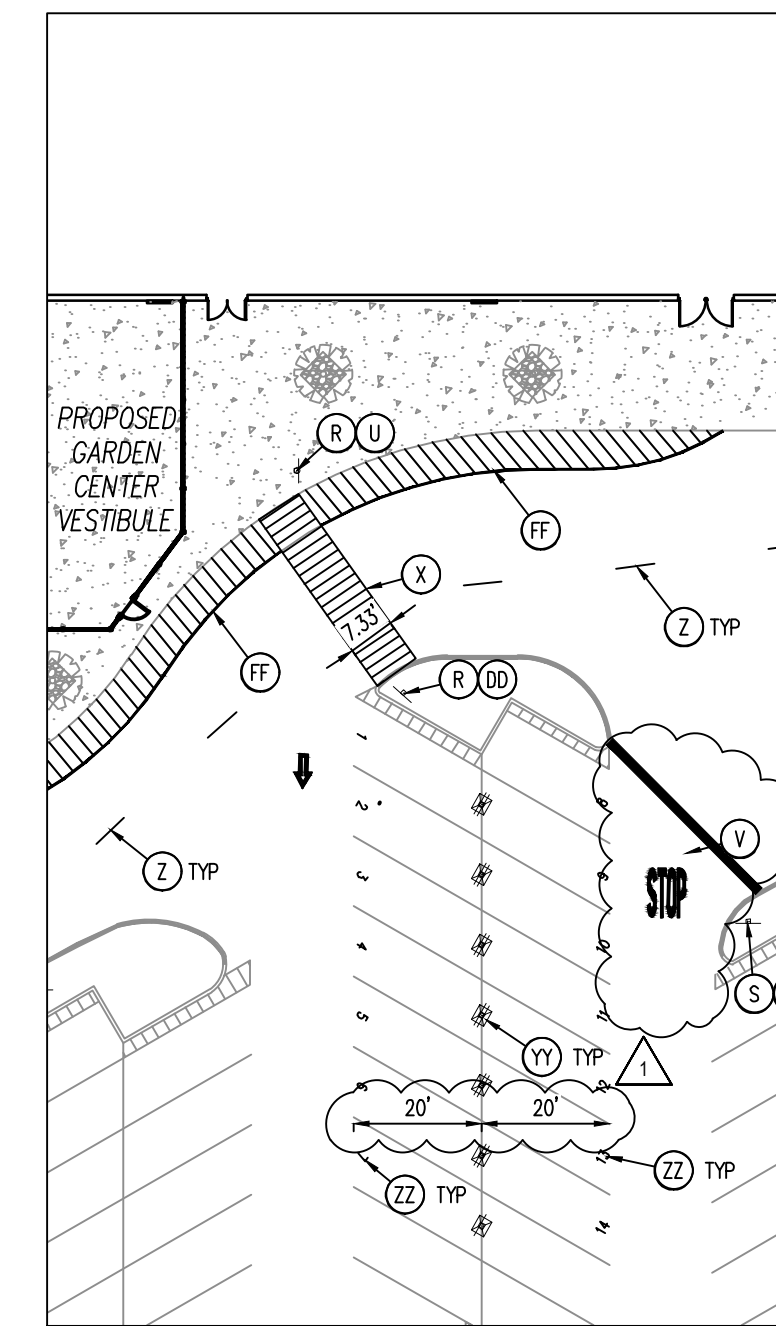

PROPOSED PICKUP SITE CONSTRUCTION PLAN

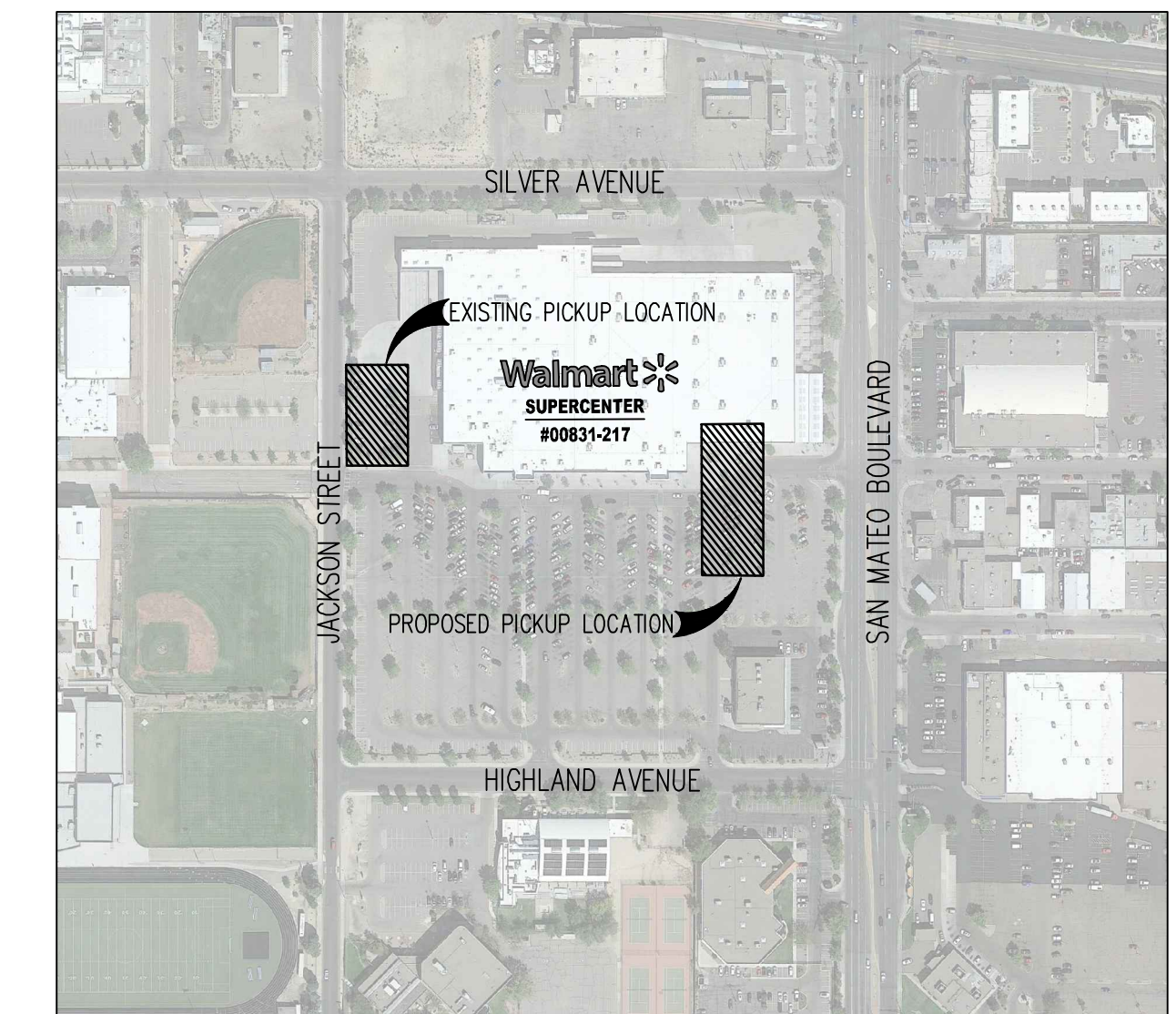

KEY MAP
APPROX. 1" = 300'

SITE AND DEMOLITION LEGEND

REFERENCE DETAIL SHEET

- (1) EXISTING PEDESTRIAN CROSSING SIGN TO BE REMOVED.
- (2) EXISTING STOP SIGN TO BE REMOVED.
- (3) EXISTING SIGN POST, BASE, AND BOLLARD BASE (WHERE APPLICABLE) TO BE REMOVED.
- (4) EXISTING SIGN POST AND BASE TO REMAIN. BOLLARD (WHERE APPLICABLE) TO BE RE-PAINTED.
- (5) EXISTING CROSSWALK STRIPING TO BE REMOVED.
- (6) EXISTING YIELD PAVEMENT MARKING TO BE REMOVED.
- (7) EXISTING CENTERLINE STRIPING TO BE REMOVED.
- (8) EXISTING CENTERLINE STRIPING TO REMAIN AND BE RE-PAINTED.
- (9) EXISTING SOLID DOUBLE YELLOW STRIPING TO BE REMOVED.
- (10) EXISTING STOP SIGN TO REMAIN.
- (11) EXISTING PEDESTRIAN CROSSING SIGN TO REMAIN.
- (12) EXISTING STOP BAR AND STOP TEXT PAVEMENT MARKING TO BE REMOVED.
- (13) EXISTING ARROW PAVEMENT MARKINGS TO BE REMOVED.
- (14) EXISTING FIRE LANE STRIPING TO REMAIN AND BE RE-PAINTED.
- (15) EXISTING STOP SIGN TO BE RAISED TO MATCH CURRENT DETAILS/GUIDELINES.
- (16) NEW "STOP HERE FOR PEDESTRIANS" (R1-58) SIGN.
- (17) NEW 30"x30" STOP SIGN.
- (18) NEW 36"x36" STOP SIGN.
- (19) NEW SIGN MOUNTING AND BASE WITH BOLLARD.
- (20) NEW STOP TEXT AND STOP BAR PAVEMENT MARKINGS.
- (21) NEW 4" WIDE PAINTED YELLOW STRIPES AT 45° @ 2'-0" O.C.
- (22) NEW CROSSWALK MARKINGS - 6" WIDE PAINTED WHITE STRIPING PARALLEL TO DIRECTION OF TRAFFIC AT 2'-0" O.C. AND (1)-8" WHITE STRIPES PERPENDICULAR ON BOTH ENDS UNLESS NOTED OTHERWISE. ENTIRE CROSSWALK SHALL BE RE-STRIPPED.
- (23) LIMITS OF SEAL COAT. APPLY SEAL COAT OVER WHERE STRIPING AND PAVEMENT MARKINGS WERE REMOVED AND WHERE NEW STRIPING AND PAVEMENT MARKINGS WILL BE APPLIED. APPLY NEW STRIPING AND PAVEMENT MARKINGS OVER SEAL COAT.
- (24) NEW 4" WIDE PAINTED YELLOW STRIPES - 6' LONG WITH 18' GAPS.
- (25) NEW OPEN ARROW PAVEMENT MARKINGS.
- (26) NEW SOLID ARROW PAVEMENT MARKINGS.
- (27) NEW 4" WIDE DOUBLE SOLID YELLOW STRIPE.
- (28) NEW SIGN MOUNTING AND BASE WITH BREAK AWAY POST.
- (29) NEW SIGN MOUNTING AND BASE WITH DOUBLE BREAK AWAY POSTS.
- (30) NEW FIRE LANE STRIPING.
- (31) EXISTING PAVEMENT MARKINGS/STRIPING TO BE INSPECTED AND REVISED/REFRESHED TO MATCH CURRENT DETAILS/GUIDELINES.
- (32) EXISTING VISIBILITY CONFLICT WITH SIGNAGE. CONTRACTOR SHALL TRIM LANDSCAPING AS REQUIRED TO CREATE UNOBSTRUCTED VIEW OF SIGNAGE.
- (33) NEW "ONCOMING TRAFFIC DOES NOT STOP" PLAQUE.
- (34) NEW "TRAFFIC FROM LEFT DOES NOT STOP" PLAQUE.
- (35) NEW "TRAFFIC FROM RIGHT DOES NOT STOP" PLAQUE.
- (36) NEW "CROSS TRAFFIC DOES NOT STOP" PLAQUE.
- (37) EXISTING "TRUCK-LIP" PAVEMENT MARKINGS TO BE REMOVED.
- (38) EXISTING WHEEL STOP TO BE REUSED.
- (39) NEW WHEEL STOP. CONTRACTOR TO MATCH EXISTING.
- (40) NEW CHANNELIZATION AT OCP DOOR. SEE DETAIL.
- (41) NEW 6" SOLID WHITE LINE AT EDGE OF DECORATIVE CONCRETE.
- (42) RE-STRIPING EXISTING ROW CROSSWALK STRIPING TO MEET CURRENT DETAILS/GUIDELINES.
- (43) EXISTING FIRE LANE STRIPING TO BE REMOVED.
- (44) EXISTING "TRUCK-LIP" SIGNAGE TO BE REMOVED.
- (45) NEW 4" WIDE PAINTED YELLOW STALL STRIPE.
- (46) EXISTING PARKING STALL STRIPING TO BE REMOVED.
- (47) NEW TEMPORARY SIGNAGE. SEE DETAIL.
- (48) NEW PICKUP STALL NUMBERING. SEE DETAIL.

NOTES TO CONTRACTOR:

1. REFERENCE SITE CONSTRUCTION PLAN FOR SITE SPECIFIC DIMENSIONS OF CROSSWALK STRIPING AND LOCATION OF SIGNAGE.
2. PROVIDE A COMPREHENSIVE CONSTRUCTION PHASING PLAN FOR THIS WORK TO THE STORE MANAGER 7 DAYS PRIOR TO STARTING ANY WORK. IT IS TO PROVIDE FOR DATES, TIMES AND DURATION OF LANE CLOSURES, TEMPORARY VEHICLE AND PEDESTRIAN TRAFFIC CONTROL.
3. ALL EXISTING STRIPING AND PAVEMENT MARKINGS OR TEXT ALONG THE BFR (BUILDING FRONTAGE ROAD) SHALL BE REMOVED. GRIND OUT ANY DIRECTIONAL ARROWS OR STOP BARS/TEXT THAT ARE NOT CORRECTLY LOCATED OR INCONSISTENT WITH THE DETAILS PROVIDED. APPLY SEAL COAT TO THE COMPLETE EXTENT THAT THE STRIPING OR TEXT HAS BEEN REMOVED IN A SINGLE COMPLETE RECTANGLE TO COVER ALL REMOVED STRIPING (DO NOT APPLY SEAL COAT OVER EXISTING STRIPING OR CONCRETE). INSTALL NEW STRIPING AND SIGNAGE AS SHOWN ON THE SITE CONSTRUCTION PLAN.
4. ALL SIGNS LOCATED ON THE BUILDING SIDE OF THE BFR SHALL BE INSTALLED ON A SINGLE POST WITH BOLLARD.

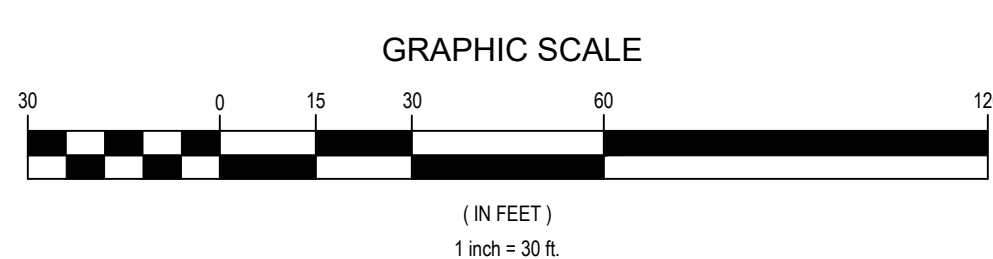
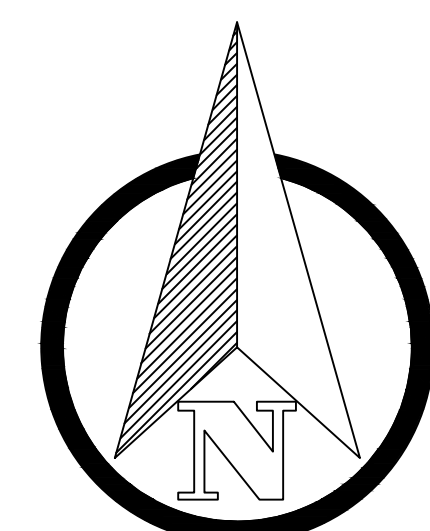

DEMOLITION AND SITE CONSTRUCTION PLAN

REVISIONS	BY
ADD #1 04/09/2021	DJS



SUPERCENTER #00831-217
301 SAN MATEO BOULEVARD
ALBUQUERQUE (ZUNI), BERNALILLO COUNTY, NEW MEXICO
WAL-MART STORES, INC.
BENTONVILLE, AR

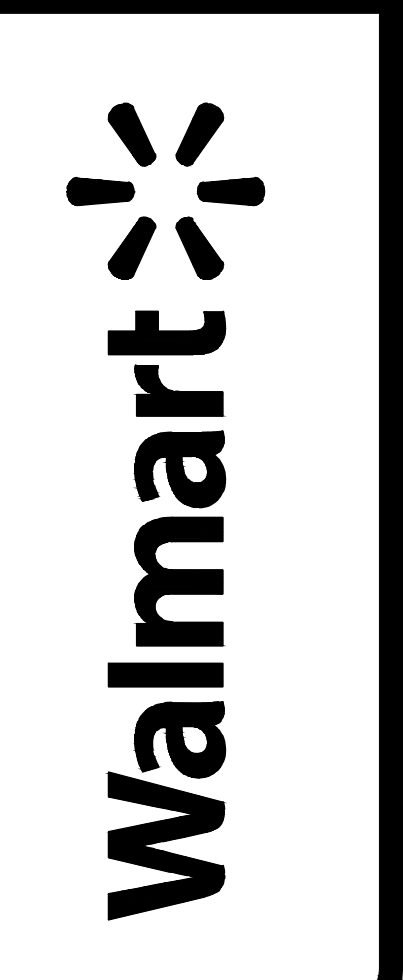

DRAWN	DJS
CHECKED	BOA
DATE	03/29/2021
SCALE	VARIABLES
JOB No.	SGA00831.20
SHEET	

SECP-2B