

PRESENTED TO

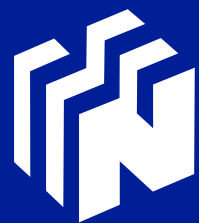

**#4107 (Coors FSU)**  
**Coors Blvd and Joseph Drive, Albuquerque, NM 87120**



**National Sign & Marketing Corporation**



**13580 5th Street • Chino, CA 91710 • Tel: 909.591.4742 • FAX: 909.591.9792 • Toll Free: 877.877.NSMC**

# Scope of Work

- A B C D** NEW 5'-0" ILLUM. "CHICK-FIL-A" CHANNEL LETTERS SIGN
- E F** NEW D/F ILLUM. DIRECTIONAL SIGN
- G** REFACE D/F ILLUM. MONUMENT SIGN TENANT PANEL

## Install Only Manufacturing By Others

- 1 2** DRIVE-THRU MENU BOARD

**NOTE:**  
ALL NEW SIGNAGE TO CONNECT  
TO CLIENT PROVIDED ELECTRICAL  
CIRCUITS

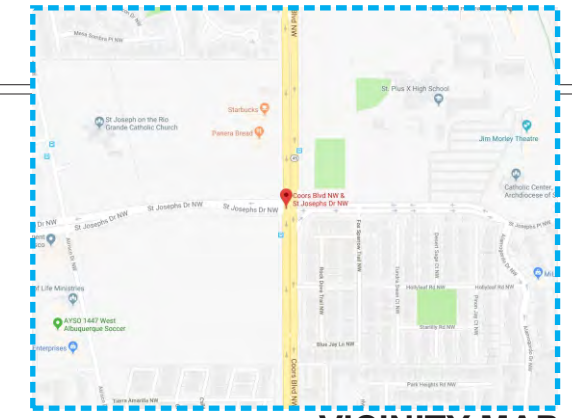
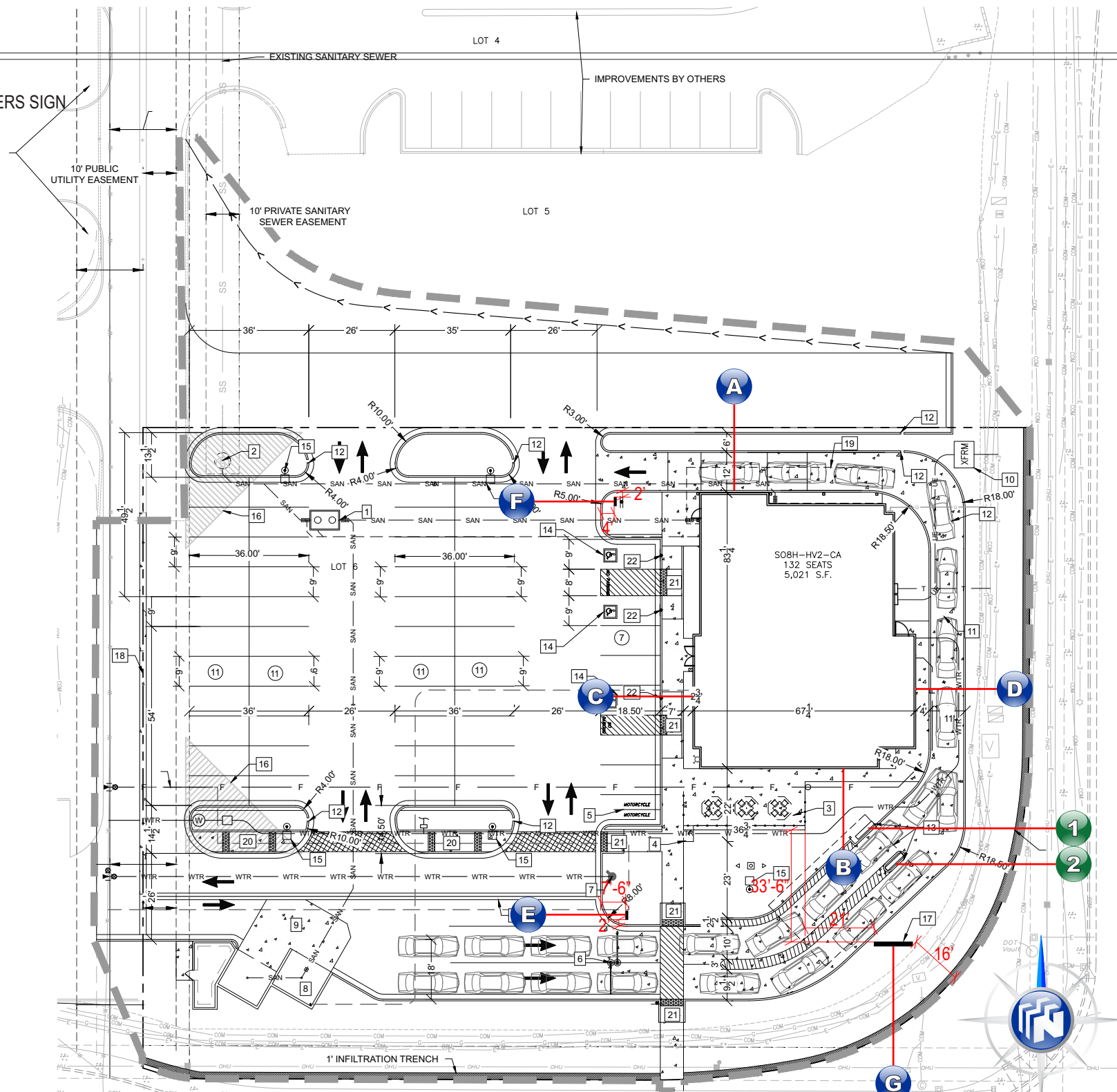

VICINITY MAP

SIGN ID LETTER	FACE A	FACE B
<b>A B C D</b>		N/A
<b>E</b>		
<b>F</b>		
<b>G</b>		
<b>1 2</b>		N/A

## CHICK-FIL-A - Albuquerque, NM. - Site Plan

SCALE: 1" = 40'-0"

THIS IS AN ORIGINAL UNPUBLISHED DRAWING CREATED FOR YOUR PERSONAL USE IN CONNECTION WITH A PROJECT PLANNED FOR YOU BY NSMC. IT IS NOT TO BE SHOWN OUTSIDE YOUR ORGANIZATION NOR USED, REPRODUCED, COPIED OR EXHIBITED IN ANY FASHION UNLESS AUTHORIZED IN WRITING BY AN OFFICER OF NSMC

**National Sign & Marketing Corporation**  
13580 5th St., Chino, CA 91710  
Tel 909.591.4742 Fax 909.591.9792  
e-mail : sales@nsmc.com  
Lic# 745030 - Exp. 01/31/20

**Project:** Chick-Fil-A #4107 (Coors FSU)  
**Address:** Coors Blvd and Joseph Drive, Albuquerque, NM 87120  
**Phone:** \_\_\_\_\_ **Account Mgr.:** S. Rosenbloom  
**Designer:** Duffy, S. **Scale:** Noted **Date:** 01/24/2018

**Client Approval:** \_\_\_\_\_  
**Date:** \_\_\_\_\_

This sign intended to be in accordance with the requirements of Article 600 of the National Electrical Code and/or other applicable local codes. This includes proper grounding and bonding of this sign.

**Revisions:**  
11/14/18 SD Change monument to tenant panel only

**Drawing Number**  
**28207**  
R1

# Scope of Work

- H** NEW SINTRA ADDRESS NUMERALS
- I J K** NEW HANDICAP PARKING SIGNS
- L M** NEW PEDESTRIAN SIGNS
- N** NEW CURBSIDE DELIVERY SIGN
- O** NEW WINDOW VINYL

## Install Only Manufacturing By Others

- 3** DRIVE-THRU CLEARANCE ARM
- 4** FLAG POLE

**NOTE:**  
ALL NEW SIGNAGE TO CONNECT  
TO CLIENT PROVIDED ELECTRICAL  
CIRCUITS

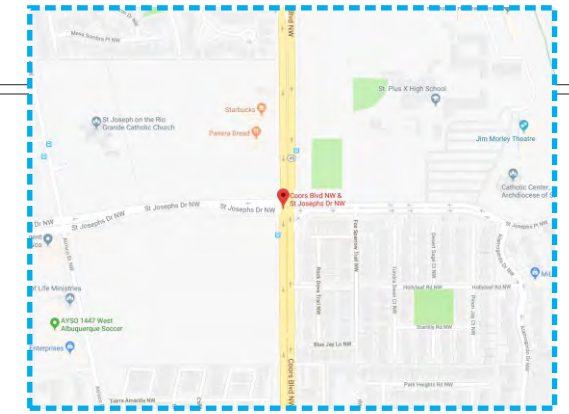
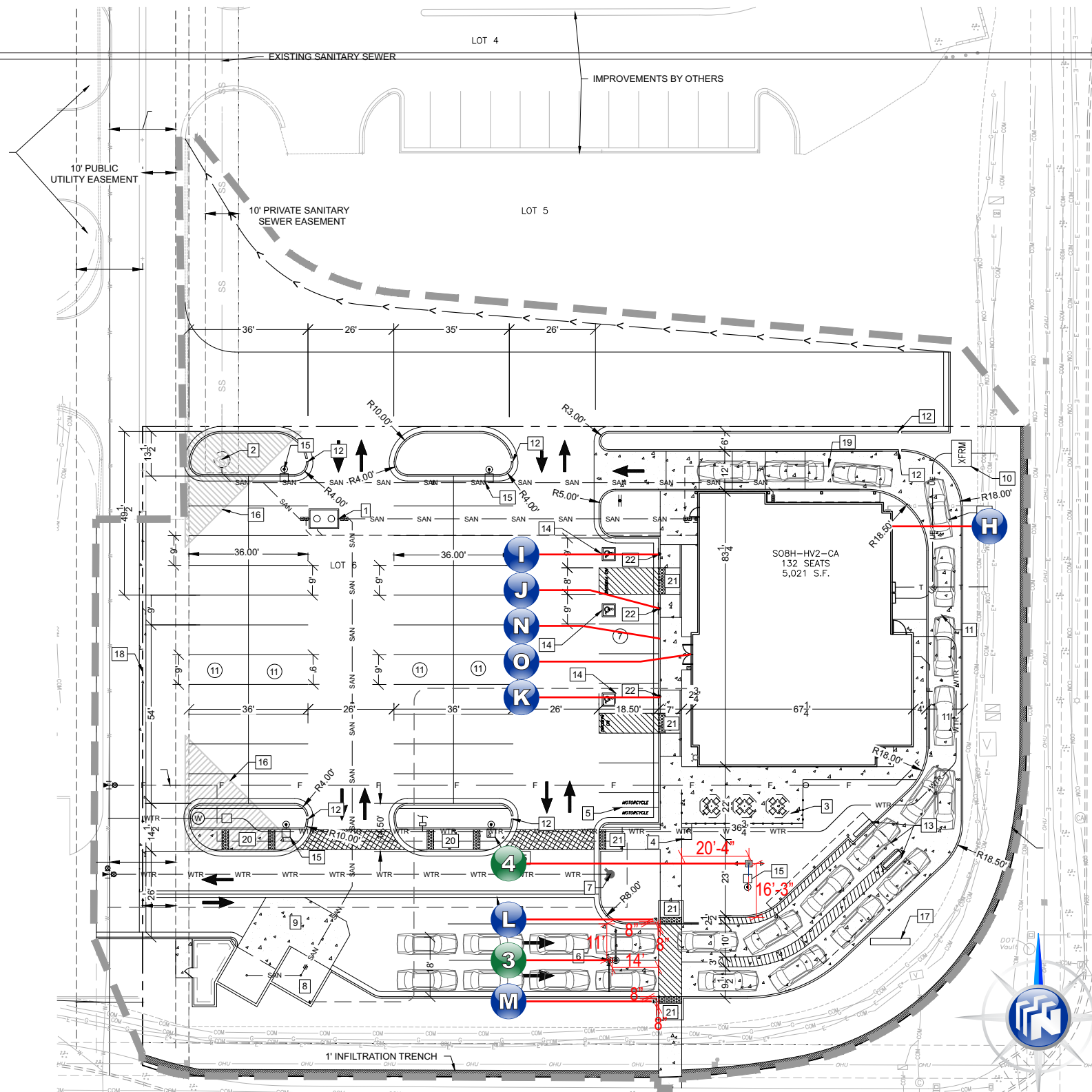

VICINITY MAP

SIGN ID LETTER	FACE A	FACE B
<b>I</b>	0000	N/A
<b>J</b>		N/A
<b>K</b>		N/A
<b>L M</b>		
<b>N</b>		N/A
<b>O</b>	0000 E	N/A
<b>3</b>		N/A
<b>4</b>		N/A

## CHICK-FIL-A - Albuquerque, NM. - Site Plan

SCALE: 1" = 40'-0"

THIS IS AN ORIGINAL UNPUBLISHED DRAWING CREATED FOR YOUR PERSONAL USE IN CONNECTION WITH A PROJECT PLANNED FOR YOU BY NSMC. IT IS NOT TO BE SHOWN OUTSIDE YOUR ORGANIZATION NOR USED, REPRODUCED, COPIED OR EXHIBITED IN ANY FASHION UNLESS AUTHORIZED IN WRITING BY AN OFFICER OF NSMC



**Project:** Chick-Fil-A #4107 (Coors FSU)  
**Address:** Coors Blvd and Joseph Drive, Albuquerque, NM 87120  
**Phone:** \_\_\_\_\_ **Account Mgr.:** S. Rosenbloom  
**Designer:** Duffy, S. **Scale:** Noted **Date:** 01/24/2018

**Client Approval:** \_\_\_\_\_  
**Date:** \_\_\_\_\_

This sign intended to be in accordance with the requirements of Article 600 of the National Electrical Code and/or other applicable local codes. This includes proper grounding and bonding of this sign.



**Revisions:**  
 11/14/18 SD Change monument to tenant panel only

**Drawing Number**  
**28207**  
 R1





**A** NEW 5'-0" ILLUM. "CHICK-FIL-A" CHANNEL LETTERS SIGN

**North Elevation**

SCALE: 3/32" = 1'-0"



**B** NEW 5'-0" ILLUM. "CHICK-FIL-A" CHANNEL LETTERS SIGN

**South Elevation**

SCALE: 3/32" = 1'-0"

THIS IS AN ORIGINAL UNPUBLISHED DRAWING CREATED FOR YOUR PERSONAL USE IN CONNECTION WITH A PROJECT PLANNED FOR YOU BY NSMC. IT IS NOT TO BE SHOWN OUTSIDE YOUR ORGANIZATION NOR USED, REPRODUCED, COPIED OR EXHIBITED IN ANY FASHION UNLESS AUTHORIZED IN WRITING BY AN OFFICER OF NSMC



**National Sign & MARKETING CORPORATION**  
 13580 5th St., Chino, CA 91710  
 Tel 909.591.4742 Fax 909.591.9792  
 e-mail : sales @nsmc.com  
 Lic# 745030 - Exp. 01/31/20

**Project:** Chick-Fil-A #4107 (Coors FSU)  
**Address:** Coors Blvd and Joseph Drive, Albuquerque, NM 87120  
**Phone:** \_\_\_\_\_ **Account Mgr.** S. Rosenbloom  
**Designer:** Duffy, S. **Scale:** Noted **Date:** 01/24/2018

**Client Approval:** \_\_\_\_\_  
 \_\_\_\_\_  
**Date:** \_\_\_\_\_

This sign intended to be in accordance with the requirements of Article 600 of the National Electrical Code and/or other applicable local codes. This includes proper grounding and bonding of this sign.



**Revisions:**  
 11/14/18 SD Change monument to tenant panel only  
 \_\_\_\_\_  
 \_\_\_\_\_  
 \_\_\_\_\_

**Drawing Number**  
**28207**  
 R1





**C** NEW 5'-0" ILLUM. "CHICK-FIL-A" CHANNEL LETTERS SIGN

**O** NEW WINDOW VINYL

**West Elevation**

SCALE: 3/32" = 1'-0"

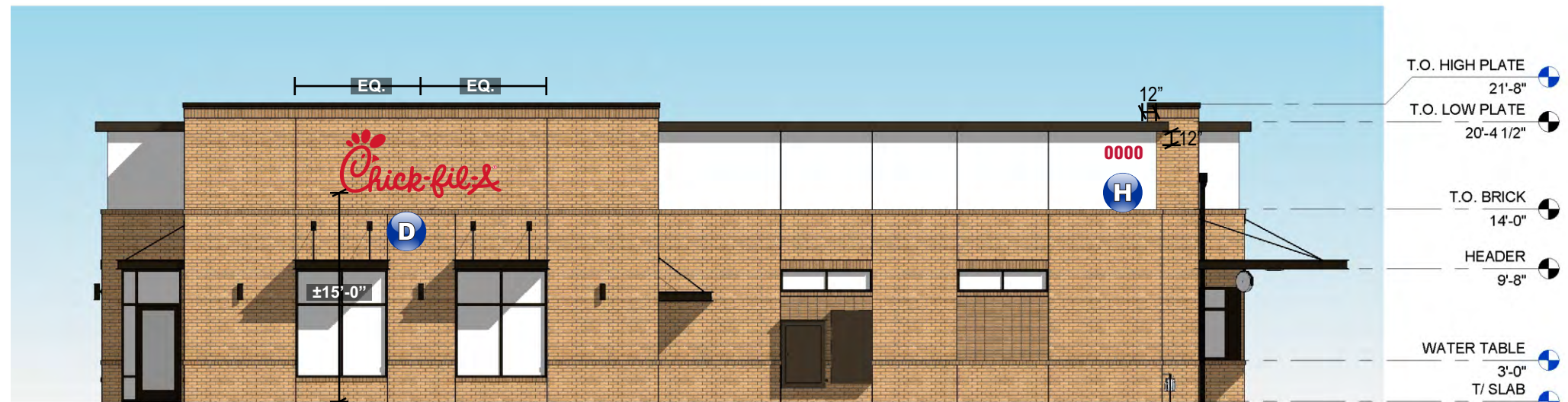

**D** NEW 5'-0" ILLUM. "CHICK-FIL-A" CHANNEL LETTERS SIGN

**H** NEW SINTRA ADDRESS NUMERALS

**East Elevation**

SCALE: 3/32" = 1'-0"



THIS IS AN ORIGINAL UNPUBLISHED DRAWING CREATED FOR YOUR PERSONAL USE IN CONNECTION WITH A PROJECT PLANNED FOR YOU BY NSMC. IT IS NOT TO BE SHOWN OUTSIDE YOUR ORGANIZATION NOR USED, REPRODUCED, COPIED OR EXHIBITED IN ANY FASHION UNLESS AUTHORIZED IN WRITING BY AN OFFICER OF NSMC



**Project:** Chick-Fil-A #4107 (Coors FSU)  
**Address:** Coors Blvd and Joseph Drive, Albuquerque, NM 87120  
**Phone:** \_\_\_\_\_ **Account Mgr.** S. Rosenbloom  
**Designer:** Duffy, S. **Scale:** Noted **Date:** 01/24/2018

**Client Approval:** \_\_\_\_\_  
 \_\_\_\_\_  
**Date:** \_\_\_\_\_

This sign intended to be in accordance with the requirements of Article 600 of the National Electrical Code and/or other applicable local codes. This includes proper grounding and bonding of this sign.

**Revisions:**  
 11/14/18 SD Change monument to tenant panel only

**Drawing Number**  
**28207**  
 R1





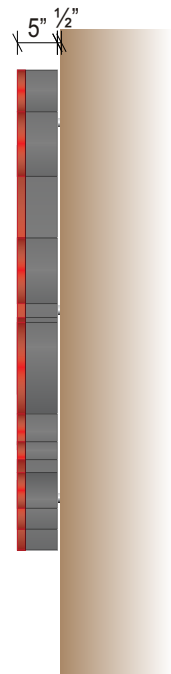

**A B C D** NEW 5'-0" ILLUM. "CHICK-FIL-A" CHANNEL LETTERS SIGN

AREA: 58.75 SQ. FT.  
 AREA: 35.15 SQ. FT.  
 8 STRAIGHT LINES

MOUNTING AND ELECTRICAL PENETRATIONS

**Specifications:**

- BODY: S/F CUSTOM FABRICATED ALUMINUM CABINET CONSTRUCTED OF .050 WITH .063 ALUMINUM BACKS. ALUMINUM RETURNS MECHANICALLY FASTENED TO BACKS. INTERIOR OF SIGN TO BE PAINTED MATTE WHITE.
- FACES: 3/16" #2793 RED ACRYLIC OR EQUIVALENT.
- TRIM CAP: 1"X.125 TRUE RED JEWELITE TRIM CAP (ADHERED VIA WELD ON RETURNS)
- RETURNS: 5" DEEP RETURNS PAINTED TO MATCH MOUNTING SURFACE COLOR
- STANDOFF: 3/8" SLEEVE ANCHORS WITH 1/2" ALUMINUM SPACERS.
- REGISTERED: 3/16" ACRYLIC DISK WITH RETURNS PAINTED TO MATCH MOUNTING SURFACE. 3M 3632-53 CARDINAL RED AND WHITE VINYL ® APPLIED FIRST SURFACE.
- DISCONNECT: ELECTRICAL TOGGLE DISCONNECT SWITCH WITH WATERPROOF BOOT
- ILLUMINATION: RED LED LIGHTING WITH REMOTE TRANSFORMERS.  
 ALL WIRING & COMPONENTS TO MEET U.L. STANDARDS

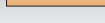
	R & H 2793 / 3M RED 3632-53
	WHITE
	SW 6385 DOVER WHITE SIGNS A & B
	TO MATCH BRICK VENEER CITADEL MP56122 C & D



PERSPECTIVE VIEW

**CHICK-FIL-A S/F LED ILLUMINATED CHANNEL LETTERS**

SCALE: 1/2" = 1'-0"

THIS IS AN ORIGINAL UNPUBLISHED DRAWING CREATED FOR YOUR PERSONAL USE IN CONNECTION WITH A PROJECT PLANNED FOR YOU BY NSMC. IT IS NOT TO BE SHOWN OUTSIDE YOUR ORGANIZATION NOR USED, REPRODUCED, COPIED OR EXHIBITED IN ANY FASHION UNLESS AUTHORIZED IN WRITING BY AN OFFICER OF NSMC



**Project:** Chick-Fil-A #4107 (Coors FSU)  
**Address:** Coors Blvd and Joseph Drive, Albuquerque, NM 87120  
**Phone:** \_\_\_\_\_ **Account Mgr.** S. Rosenbloom  
**Designer:** Duffy, S. **Scale:** Noted **Date:** 01/24/2018

**Client Approval:** \_\_\_\_\_  
 \_\_\_\_\_  
**Date:** \_\_\_\_\_

This sign intended to be in accordance with the requirements of Article 600 of the National Electrical Code and/or other applicable local codes. This includes proper grounding and bonding of this sign.



**Revisions:**  
 11/14/18 SD Change monument to tenant panel only

**Drawing Number**  
**28207**  
 R1





Load: 90.0  
 Modules: 75  
 Watts: 54.0 of 60.0  
 PS: 60w

Load: 61.2  
 Modules: 51  
 Watts: 36.7 of 60.0  
 PS: 60w

126 Modules: GOQ Samsung - 3LED RED  
 90.7 Watts  
 2 Power Supplies: 60w  
 2.4 AMPS  
 1 - 20 amp circuit 120v

**A B C D** NEW 5'-0" ILLUM. "CHICK-FIL-A" CHANNEL LETTERS SIGN

**5'-0" CHANNEL LETTERS LED LAYOUT**

SCALE: NTS

The location of the disconnect switch after installation shall comply with Article 600.6(A) (1) of the National Electrical Code.

THIS IS AN ORIGINAL UNPUBLISHED DRAWING CREATED FOR YOUR PERSONAL USE IN CONNECTION WITH A PROJECT PLANNED FOR YOU BY NSMC. IT IS NOT TO BE SHOWN OUTSIDE YOUR ORGANIZATION NOR USED, REPRODUCED, COPIED OR EXHIBITED IN ANY FASHION UNLESS AUTHORIZED IN WRITING BY AN OFFICER OF NSMC



**National Sign & MARKETING CORPORATION**  
 13580 5th St., Chino, CA 91710  
 Tel 909.591.4742 Fax 909.591.9792  
 e-mail : sales @nsmc.com  
 Lic# 745030 - Exp. 01/31/20

**Project:** Chick-Fil-A #4107 (Coors FSU)  
**Address:** Coors Blvd and Joseph Drive, Albuquerque, NM 87120  
**Phone:** \_\_\_\_\_ **Account Mgr.:** S. Rosenbloom  
**Designer:** Duffy, S. **Scale:** Noted **Date:** 01/24/2018

**Client Approval:** \_\_\_\_\_  
 \_\_\_\_\_  
**Date:** \_\_\_\_\_







This sign intended to be in accordance with the requirements of Article 600 of the National Electrical Code and/or other applicable local codes. This includes proper grounding and bonding of this sign.

**Revisions:**  
 11/14/18 SD Change monument to tenant panel only  
 \_\_\_\_\_  
 \_\_\_\_\_  
 \_\_\_\_\_

**Drawing Number**  
**28207**  
 R1



NOTE: THRU-BOLT FASTENERS ARE THE PREFERRED METHOD FOR ATTACHMENT

FASTENER SCHEDULE		
	3/8" LAG SCREW	FOR USE WITH WOOD OR EIFS WALL SYSTEMS. 1-1/2" MIN PENETRATION (EXCL. TIP)
	3/8" DIA. THREADED ROD	FOR USE WITH WOOD, CONCRETE BLOCK OR EIFS WALL SYSTEMS.
	3/8" RED HEAD L.D.T. (LARGE DIAMETER TAPCON)	FOR USE WITH CONCRETE BLOCK, BRICK OR CONCRETE. EMBED A MIN. OF 2 1/2".
	3/8" DIA. HILTI HIT ROD WITH HY150 MAX ADHESIVE	FOR USE WITH CONCRETE. EMBED A MIN. OF 2".
	3/8" DIA. HILTI HIT ROD WITH HY20 ADHESIVE	FOR USE WITH MASONRY AND BRICK. EMBED A MIN. OF 3 3/8".
	3/8" DIA. HILTI HIT ROD WITH HY20 ADHESIVE	FOR USE WITH CONCRETE BLOCK. EMBED A MIN. OF 2".
	3/8" DIA. HILTI HLC SLEEVE ANCHOR	FOR USE WITH CONCRETE, MASONRY AND BRICK. EMBED A MIN. OF 3 3/8".
INSTALLER SHALL VERIFY THAT FASTENERS CHOSEN ARE SUITABLE WITH WALL CONDITIONS		

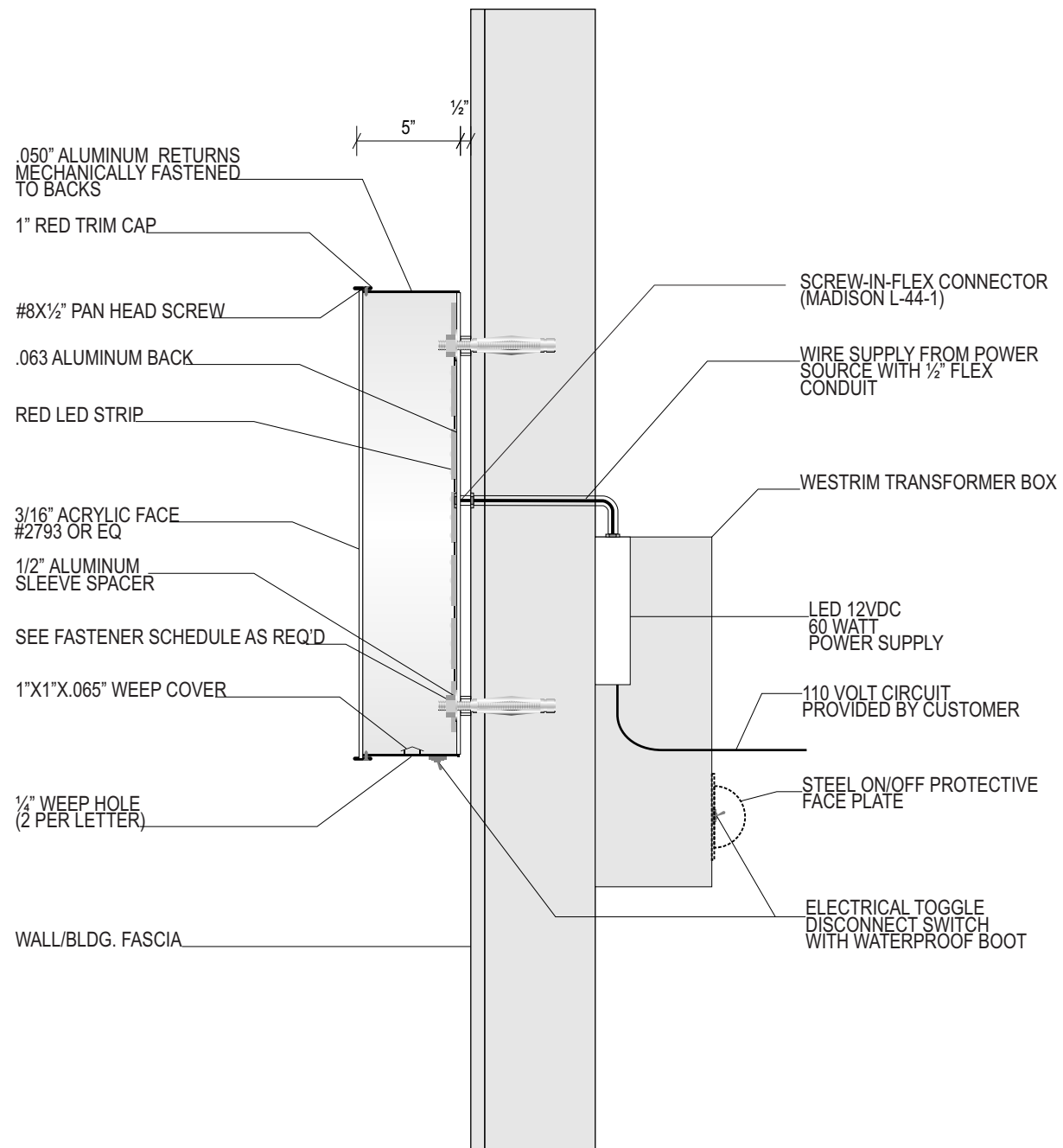

## LED ILLUMINATED CHANNEL LETTERS

SCALE: NTS

GC TO SUPPLY PRIMARY POWER SOURCE  
ALL COMPONENTS TO BE U.L. LISTED AND APPROVED

THIS IS AN ORIGINAL UNPUBLISHED DRAWING CREATED FOR YOUR PERSONAL USE IN CONNECTION WITH A PROJECT PLANNED FOR YOU BY NSMC. IT IS NOT TO BE SHOWN OUTSIDE YOUR ORGANIZATION NOR USED, REPRODUCED, COPIED OR EXHIBITED IN ANY FASHION UNLESS AUTHORIZED IN WRITING BY AN OFFICER OF NSMC



**National Sign & MARKETING CORPORATION**  
13580 5th St., Chino, CA 91710  
Tel 909.591.4742 Fax 909.591.9792  
e-mail : sales @nsmc.com  
Lic# 745030 - Exp. 01/31/20

**Project:** Chick-Fil-A #4107 (Coors FSU)  
**Address:** Coors Blvd and Joseph Drive, Albuquerque, NM 87120  
**Phone:** \_\_\_\_\_ **Account Mgr.:** S. Rosenbloom  
**Designer:** Duffy, S. **Scale:** Noted **Date:** 01/24/2018

**Client Approval:** \_\_\_\_\_  
Date: \_\_\_\_\_

This sign intended to be in accordance with the requirements of Article 600 of the National Electrical Code and/or other applicable local codes. This includes proper grounding and bonding of this sign.



Revisions:
11/14/18 SD Change monument to tenant panel only

**Drawing Number**  
**28207**  
R1





**Specifications:**

CABINETS: FABRICATED .080 ALUMINUM 8" DEEP, WITH ALUMINUM ANGLE FRAME CABINET PAINTED DARK BRONZE.

FACES: WHITE #7328 ACRYLIC WITH APPLIED FIRST SURFACE 3M RED #3632-53 TRANSLUCENT VINYL. RETAINERS TO BE 1".

POST: 4"X4" SQUARE STEEL TUBE WITH MATCH PLATE POLE PAINTED MATTE BLACK.

ILLUMINATION: WHITE LED.

SWITCH: ELECTRICAL TOGGLE DISCONNECT SWITCH WITH BOOT

NOTE: TRY TO KEEP DIRECTIONALS 5'-0" FROM CURBS WHEREVER POSSIBLE TO INSURE VEHICLES WILL NOT HIT THEM.

ALL COMPONENTS TO BE U.L. APPROVED

- 3M RED 3632-53
- MATTHEWS MP 74155 SV SATIN DARK BRONZE
- WHITE / #7328 ACRYLIC



**E** NEW D/F ILLUM. DIRECTIONAL SIGN



**F** NEW D/F ILLUM. DIRECTIONAL SIGN

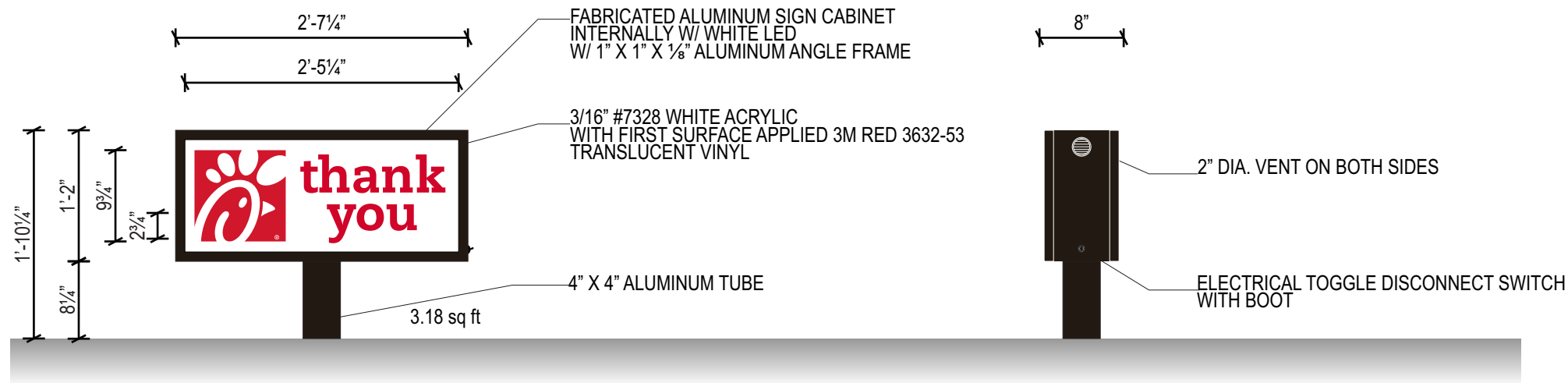

**CHICK-FIL-A - NEW D/F ILLUMINATED DIRECTIONAL SIGNS**

SCALE: 3/4" = 1'-0"

THIS IS AN ORIGINAL UNPUBLISHED DRAWING CREATED FOR YOUR PERSONAL USE IN CONNECTION WITH A PROJECT PLANNED FOR YOU BY NSMC. IT IS NOT TO BE SHOWN OUTSIDE YOUR ORGANIZATION NOR USED, REPRODUCED, COPIED OR EXHIBITED IN ANY FASHION UNLESS AUTHORIZED IN WRITING BY AN OFFICER OF NSMC



**Project:** Chick-Fil-A #4107 (Coors FSU)  
**Address:** Coors Blvd and Joseph Drive, Albuquerque, NM 87120  
**Phone:** \_\_\_\_\_ **Account Mgr.:** S. Rosenbloom  
**Designer:** Duffy, S. **Scale:** Noted **Date:** 01/24/2018

**Client Approval:** \_\_\_\_\_  
 Date: \_\_\_\_\_

This sign intended to be in accordance with the requirements of Article 600 of the National Electrical Code and/or other applicable local codes. This includes proper grounding and bonding of this sign.

**Revisions:**  
 11/14/18 SD Change monument to tenant panel only

**Drawing Number**  
**28207**  
 R1



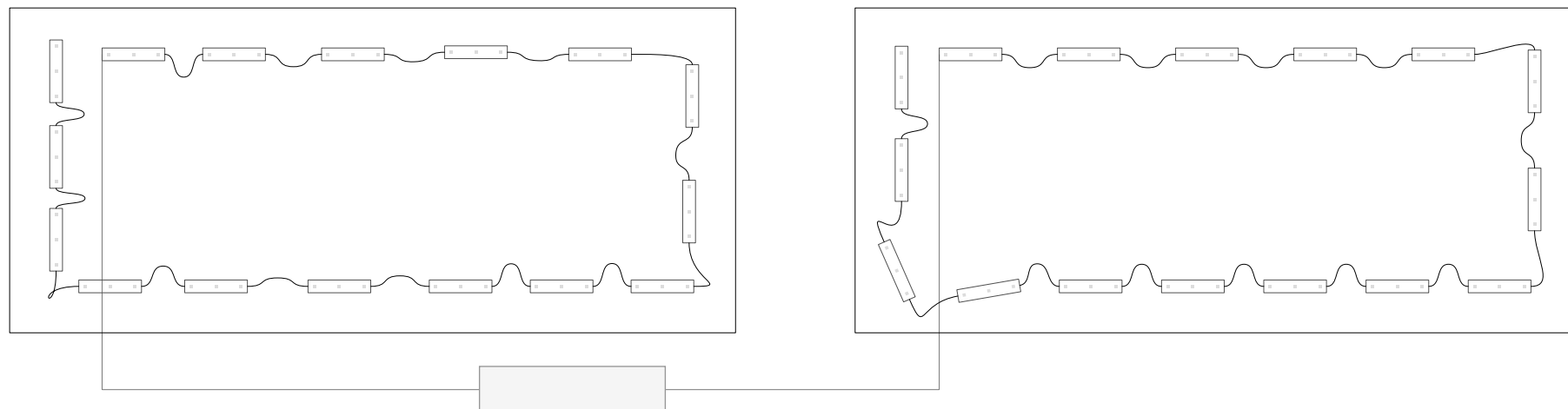

Load: 38.4  
 Modules: 32  
 Watts: 23.0 of 60.0  
 PS: Meanwell60w

32 Modules: GOQ Samsung - 3LED WHITE  
 23.0 Watts  
 1 Power Supply: GOQ Samsung - Meanwell60w  
 1.2 AMPS  
 1 - 20 amp circuit 120v

The location of the disconnect switch after installation shall comply with Article 600.6(A) (1) of the National Electrical Code.

**E F** NEW D/F ILLUM. DIRECTIONAL SIGN

**LED LAYOUT**

SCALE: NTS

THIS IS AN ORIGINAL UNPUBLISHED DRAWING CREATED FOR YOUR PERSONAL USE IN CONNECTION WITH A PROJECT PLANNED FOR YOU BY NSMC. IT IS NOT TO BE SHOWN OUTSIDE YOUR ORGANIZATION NOR USED, REPRODUCED, COPIED OR EXHIBITED IN ANY FASHION UNLESS AUTHORIZED IN WRITING BY AN OFFICER OF NSMC



**National Sign & Marketing Corporation**  
 13580 5th St., Chino, CA 91710  
 Tel 909.591.4742 Fax 909.591.9792  
 e-mail : sales @nsmc.com  
 Lic# 745030 - Exp. 01/31/20

**Project:** Chick-Fil-A #4107 (Coors FSU)  
**Address:** Coors Blvd and Joseph Drive, Albuquerque, NM 87120  
**Phone:** \_\_\_\_\_ **Account Mgr.:** S. Rosenbloom  
**Designer:** Duffy, S. **Scale:** Noted **Date:** 01/24/2018

**Client Approval:**  
 \_\_\_\_\_  
 \_\_\_\_\_  
**Date:** \_\_\_\_\_

This sign intended to be in accordance with the requirements of Article 600 of the National Electrical Code and/or other applicable local codes. This includes proper grounding and bonding of this sign.

**Revisions:**  
 11/14/18 SD Change monument to tenant panel only  
 \_\_\_\_\_  
 \_\_\_\_\_  
 \_\_\_\_\_

**Drawing Number**  
**28207**  
 R1





CABINET:  
INTERIOR PAINT MATTE WHITE  
RETURNS COLOR  
SEE PREVIOUS PAGE

FACE:  
#7328 WHITE ACRYLIC  
3M 3632-53 CARDINAL RED  
TRANSLUCENT VINYL APPLIED  
FIRST SURFACE.

POLE:  
4"x4"x1/8" ALUMINUM PAINT COLOR  
SEE PREVIOUS PAGE

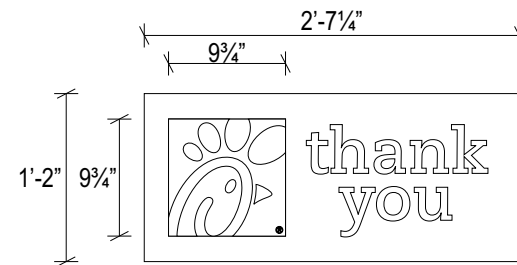
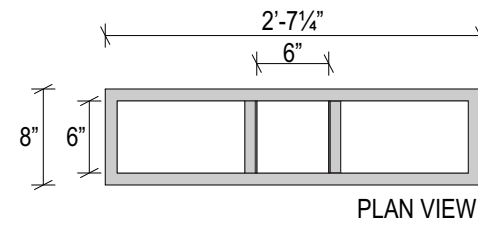
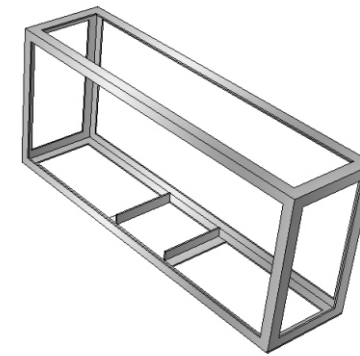
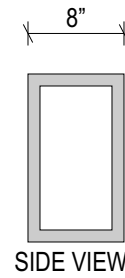
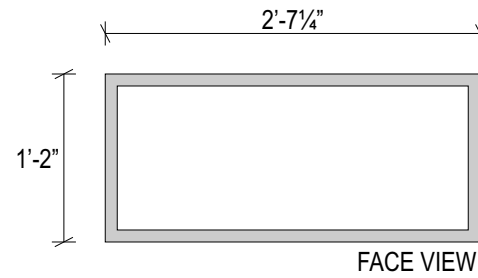

**COLOR AND COPY DETAIL:**

ALL EXTERIOR PAINTS TO HAVE SEMI-GLOSS FINISH, WITH THE EXCEPTION OF MATTE BLACK.

RENDERING AND GRAPHICS COLORS ARE FOR REFERENCE ONLY. ALL MATERIALS AND COPY SHOULD BE MANUFACTURED TO SPECIFICATIONS ON PREVIOUS PAGE

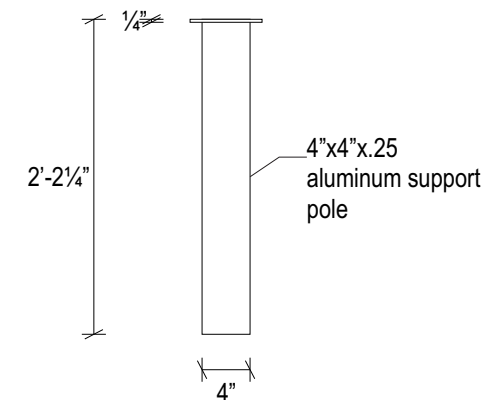
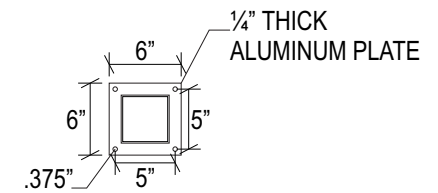
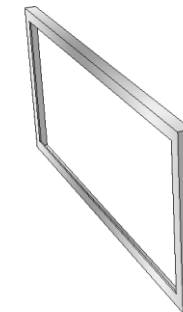
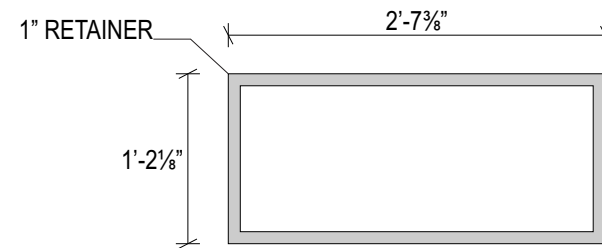

**CHICK-FIL-A - NEW D/F ILLUMINATED DIRECTIONAL SIGNS**

SCALE: NTS

THIS IS AN ORIGINAL UNPUBLISHED DRAWING CREATED FOR YOUR PERSONAL USE IN CONNECTION WITH A PROJECT PLANNED FOR YOU BY NSMC. IT IS NOT TO BE SHOWN OUTSIDE YOUR ORGANIZATION NOR USED, REPRODUCED, COPIED OR EXHIBITED IN ANY FASHION UNLESS AUTHORIZED IN WRITING BY AN OFFICER OF NSMC



**Project:** Chick-Fil-A #4107 (Coors FSU)  
**Address:** Coors Blvd and Joseph Drive, Albuquerque, NM 87120  
**Phone:** \_\_\_\_\_ **Account Mgr.:** S. Rosenbloom  
**Designer:** Duffy, S. **Scale:** Noted **Date:** 01/24/2018

**Client Approval:** \_\_\_\_\_  
Date: \_\_\_\_\_

This sign intended to be in accordance with the requirements of Article 600 of the National Electrical Code and/or other applicable local codes. This includes proper grounding and bonding of this sign.

**Revisions:**  
11/14/18 SD Change monument to tenant panel only

**Drawing Number**  
**28207**  
R1



**Specifications:**

MAIN CABINET: EXISTING.  
 FACES: 3/16" WHITE POLYCARBONATE WITH APPLIED FIRST SURFACE 3M RED #3632-53 TRANSLUCENT VINYL.  
 ILLUMINATION: EXISTING.

ALL COMPONENTS TO BE U.L. APPROVED

 3M RED 3632-53  
 WHITE LEXAN

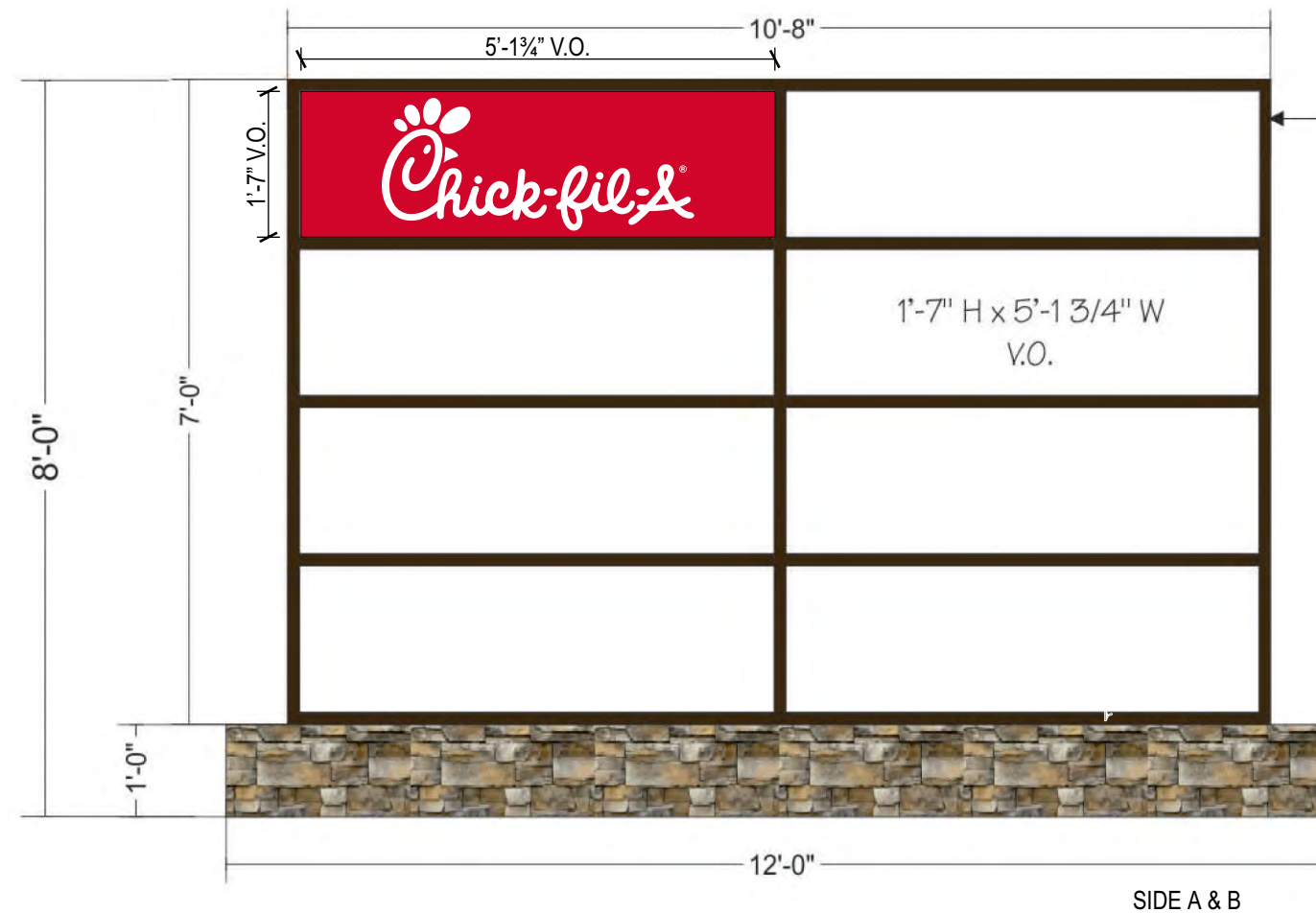

7'-0" x 10'-8" (75 SQ. FT.) D/F  
 ILLUMINATED CABINET DISPLAY  
 WHITE LEXAN FACES WITH 1.5" RETAINER  
 AND DIVIDER BARS PAINTED DK BROWN DURANODIC

**G** REFACE D/F ILLUM. MONUMENT SIGN TENANT PANEL

**REFACE D/F ILLUMINATED MONUMENT SIGN TENANT PANEL**

SCALE: 1/2" = 1'

THIS IS AN ORIGINAL UNPUBLISHED DRAWING CREATED FOR YOUR PERSONAL USE IN CONNECTION WITH A PROJECT PLANNED FOR YOU BY NSMC. IT IS NOT TO BE SHOWN OUTSIDE YOUR ORGANIZATION NOR USED, REPRODUCED, COPIED OR EXHIBITED IN ANY FASHION UNLESS AUTHORIZED IN WRITING BY AN OFFICER OF NSMC



**Project:** Chick-Fil-A #4107 (Coors FSU)  
**Address:** Coors Blvd and Joseph Drive, Albuquerque, NM 87120  
**Phone:** \_\_\_\_\_ **Account Mgr.:** S. Rosenbloom  
**Designer:** Duffy, S. **Scale:** Noted **Date:** 01/24/2018

**Client Approval:** \_\_\_\_\_  
 Date: \_\_\_\_\_

This sign intended to be in accordance with the requirements of Article 600 of the National Electrical Code and/or other applicable local codes. This includes proper grounding and bonding of this sign.  

**Revisions:**  
 11/14/18 SD Change monument to tenant panel only

**Drawing Number**  
**28207**  
 R1



1'-0"

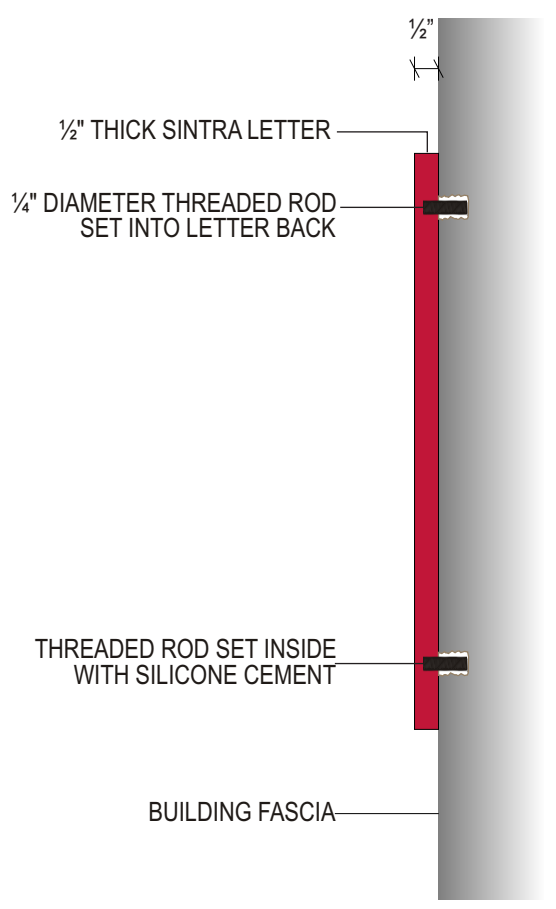

**Specifications:**

**NUMERALS:** TO BE 1/2" THICK FLAT CUT NON-ILLUMINATED SINTRA NUMERALS WITH FACES AND RETURNS TO BE PAINTED MATTHEWS RED MP10252.  
**MOUNTING:** NUMERALS TO BE MOUNTED FLUSH TO FASCIA WITH THREADED RODS INTO NUMERAL BACK AND SET INTO PRE-DRILLED HOLES WITH SILICONE.

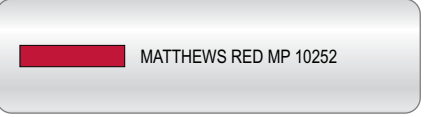

**NEW SINTRA NON-ILLUMINATED ADDRESS NUMERALS**

SCALE: 3" = 1'

THIS IS AN ORIGINAL UNPUBLISHED DRAWING CREATED FOR YOUR PERSONAL USE IN CONNECTION WITH A PROJECT PLANNED FOR YOU BY NSMC. IT IS NOT TO BE SHOWN OUTSIDE YOUR ORGANIZATION NOR USED, REPRODUCED, COPIED OR EXHIBITED IN ANY FASHION UNLESS AUTHORIZED IN WRITING BY AN OFFICER OF NSMC

**National Sign & Marketing Corporation**  
13580 5th St., Chino, CA 91710  
Tel 909.591.4742 Fax 909.591.9792  
e-mail : sales@nsmc.com  
Lic# 745030 - Exp. 01/31/20

**Project:** Chick-Fil-A #4107 (Coors FSU)  
**Address:** Coors Blvd and Joseph Drive, Albuquerque, NM 87120  
**Phone:** \_\_\_\_\_ **Account Mgr.:** S. Rosenbloom  
**Designer:** Duffy, S. **Scale:** Noted **Date:** 01/24/2018

**Client Approval:** \_\_\_\_\_  
Date: \_\_\_\_\_

This sign intended to be in accordance with the requirements of Article 600 of the National Electrical Code and/or other applicable local codes. This includes proper grounding and bonding of this sign.

**Revisions:**

11/14/18 SD Change monument to tenant panel only

**Drawing Number**  
**28207**  
R1



**BOLLARD TO BE SET BY OTHERS  
FINISHED WITH POST AND PANEL SIGN BY NSMC**

**Specifications:**

PANEL: .080 ALUMINUM PANELS WITH 2 1/4" RADIUS CORNERS. ATTACHED TO POLE WITH CARRIAGE BOLTS. BACKS PAINTED DARK BRONZE.  
 BACKGROUND: REFLECTIVE WHITE.  
 COPY & GRAPHICS: TO BE REFLECTIVE BLUE, GREEN, AND WHITE  
 POST: 2" X 2" ALUMINUM POLE CAPPED ON TOP, WITH 6" DIAMETER CONCRETE BOLLARD. POLE TO BE PAINTED DARK BRONZE.  
 FOOTING: CONCRETE FOOTING PER CITY REGULATIONS.

- 3M 680-76 REFLECTIVE BLUE
- 3M 680-77 REFLECTIVE GREEN
- 3M 680-10 REFLECTIVE WHITE
- MATTHEWS MP 74155 SV SATIN DARK BRONZE

**I NEW HANDICAP PARKING SIGNS**

**J K NEW HANDICAP PARKING SIGNS**

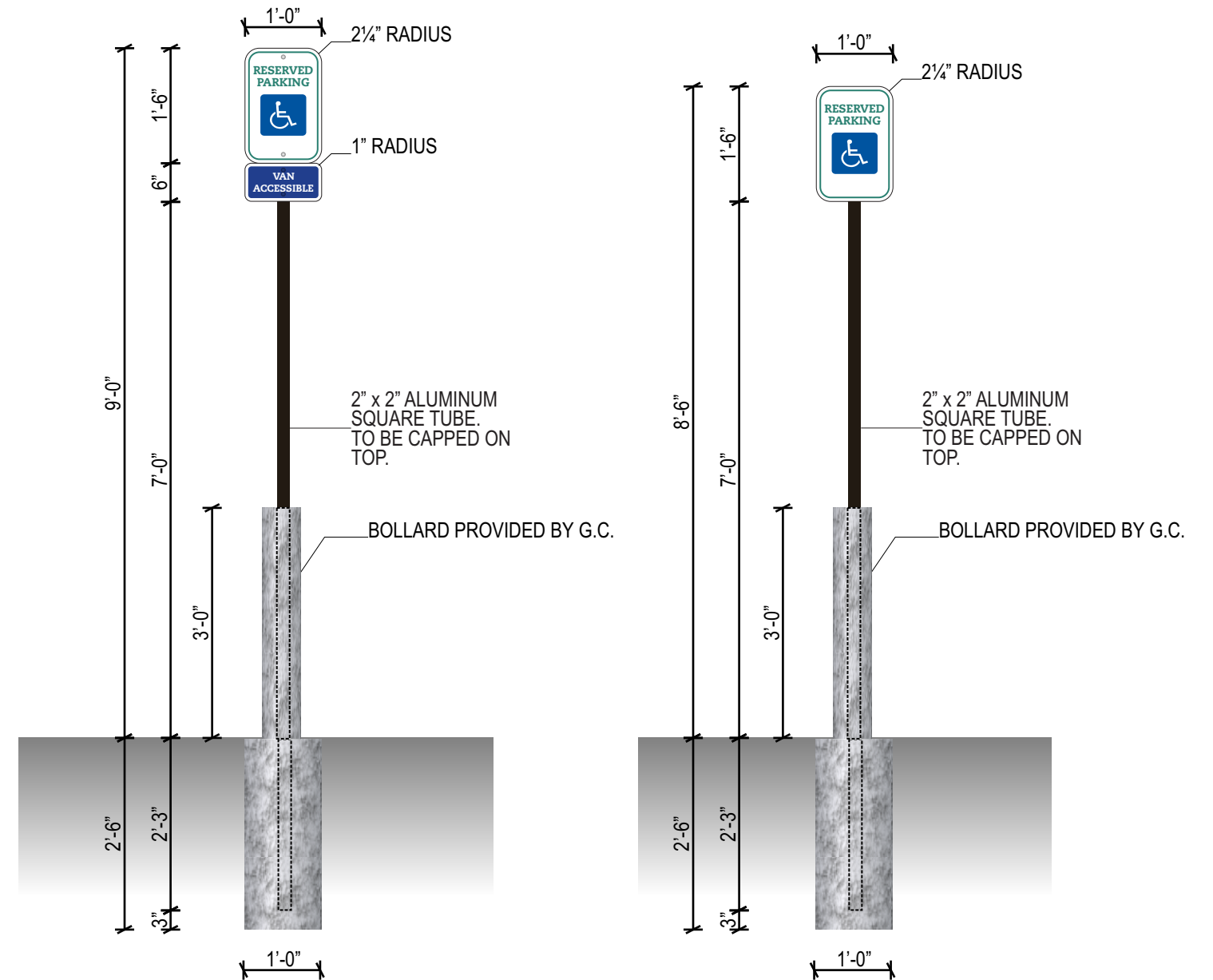

**NON-ILLUMINATED HANDICAPPED PARKING SIGN**

SCALE: 1/2" = 1'-0"

THIS IS AN ORIGINAL UNPUBLISHED DRAWING CREATED FOR YOUR PERSONAL USE IN CONNECTION WITH A PROJECT PLANNED FOR YOU BY NSMC. IT IS NOT TO BE SHOWN OUTSIDE YOUR ORGANIZATION NOR USED, REPRODUCED, COPIED OR EXHIBITED IN ANY FASHION UNLESS AUTHORIZED IN WRITING BY AN OFFICER OF NSMC



**Project:** Chick-Fil-A #4107 (Coors FSU)  
**Address:** Coors Blvd and Joseph Drive, Albuquerque, NM 87120  
**Phone:** \_\_\_\_\_ **Account Mgr.** S. Rosenbloom  
**Designer:** Duffy, S. **Scale:** Noted **Date:** 01/24/2018

**Client Approval:** \_\_\_\_\_  
 Date: \_\_\_\_\_

This sign intended to be in accordance with the requirements of Article 600 of the National Electrical Code and/or other applicable local codes. This includes proper grounding and bonding of this sign.

**Revisions:**  
 11/14/18 SD Change monument to tenant panel only

**Drawing Number**  
**28207**  
 R1



## Specifications:

PANEL: .080 ALUMINUM PANELS WITH 1" RADIUS CORNERS. ATTACHED TO POLE WITH CARRIAGE BOLTS. BACKS PAINTED DARK BRONZE.

BACKGROUND: REFLECTIVE WHITE.

COPY & GRAPHICS: TO BE REFLECTIVE PANTONE 186C, AND WHITE

POST: 2" X 2" ALUMINUM POLE PAINTED DARK BRONZE.

FOOTING: CONCRETE FOOTING PER CITY REGULATIONS.

 PANTONE 186 C RED

 MATTHEWS #N6425SP WHITE

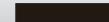
 MATTHEWS MP 74155 SV SATIN DARK BRONZE



## NEW PEDESTRIAN SIGNS

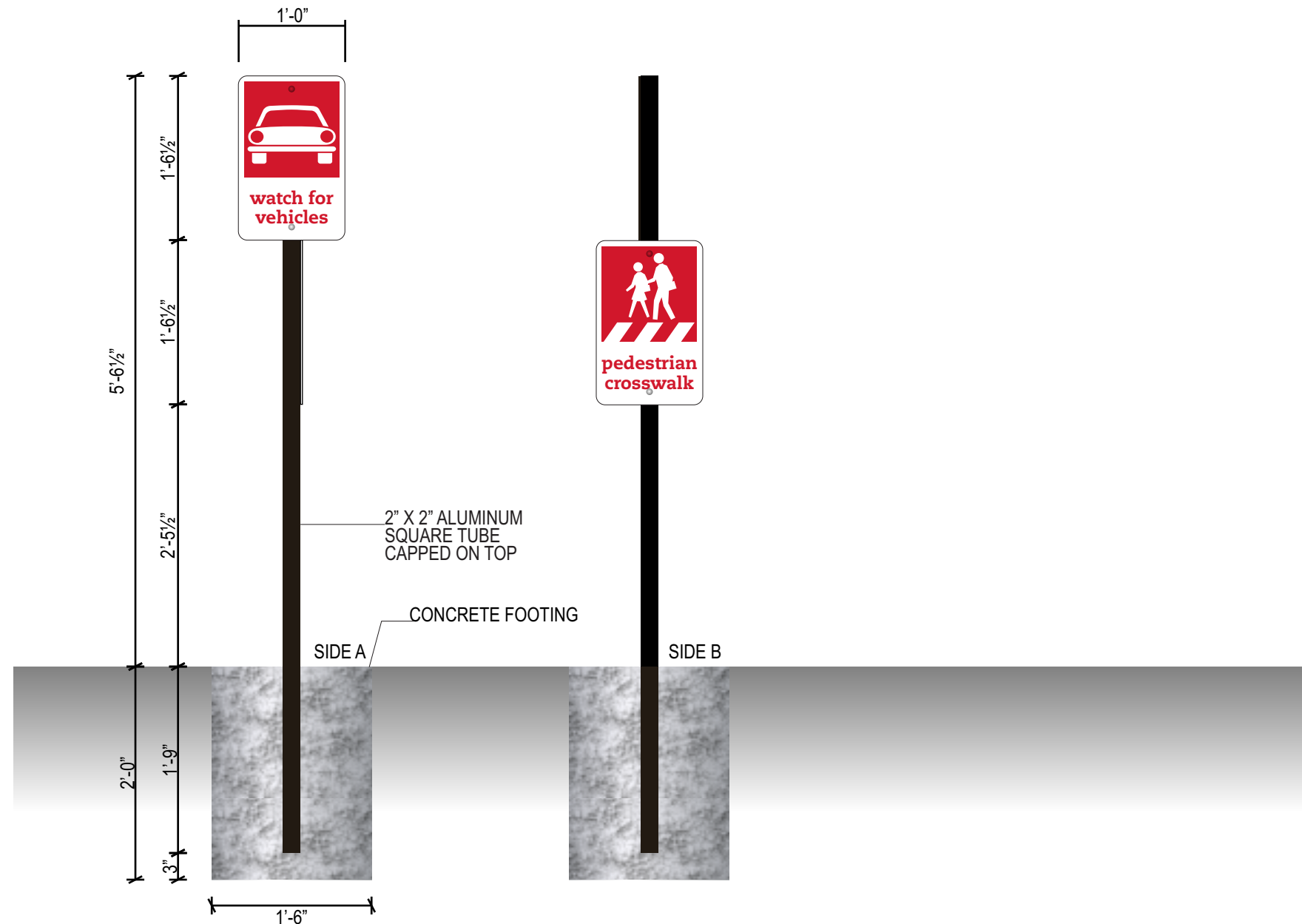

## NON-ILLUMINATED PEDESTRIAN CROSSWALK AND VEHICLE CROSSING SIGNS

SCALE: 3/4" = 1'

THIS IS AN ORIGINAL UNPUBLISHED DRAWING CREATED FOR YOUR PERSONAL USE IN CONNECTION WITH A PROJECT PLANNED FOR YOU BY NSMC. IT IS NOT TO BE SHOWN OUTSIDE YOUR ORGANIZATION NOR USED, REPRODUCED, COPIED OR EXHIBITED IN ANY FASHION UNLESS AUTHORIZED IN WRITING BY AN OFFICER OF NSMC



**National Sign & Marketing Corporation**  
 13580 5th St., Chino, CA 91710  
 Tel 909.591.4742 Fax 909.591.9792  
 e-mail : sales@nsmc.com  
 Lic# 745030 - Exp. 01/31/20

**Project:** Chick-Fil-A #4107 (Coors FSU)  
**Address:** Coors Blvd and Joseph Drive, Albuquerque, NM 87120  
**Phone:** \_\_\_\_\_ **Account Mgr.:** S. Rosenbloom  
**Designer:** Duffy, S. **Scale:** Noted **Date:** 01/24/2018

**Client Approval:** \_\_\_\_\_  
 Date: \_\_\_\_\_

This sign intended to be in accordance with the requirements of Article 600 of the National Electrical Code and/or other applicable local codes. This includes proper grounding and bonding of this sign.



**Revisions:**  
 11/14/18 SD Change monument to tenant panel only

**Drawing Number**  
**28207**  
 R1



## Specifications:

PANEL: .080 ALUMINUM PANELS WITH 1" RADIUS CORNERS. ATTACHED TO POLE WITH CARRIAGE BOLTS. BACKS PAINTED DARK BRONZE.

BACKGROUND: REFLECTIVE WHITE.

COPY & GRAPHICS: TO BE REFLECTIVE PANTONE 186C, AND WHITE

POST: 2" X 2" ALUMINUM POLE PAINTED DARK BRONZE.

FOOTING: CONCRETE FOOTING PER CITY REGULATIONS.

 PANTONE 186 C RED

 MATTHEWS #N6425SP WHITE

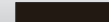
 MATTHEWS MP 74155 SV SATIN DARK BRONZE



## M NEW PEDESTRIAN SIGNS

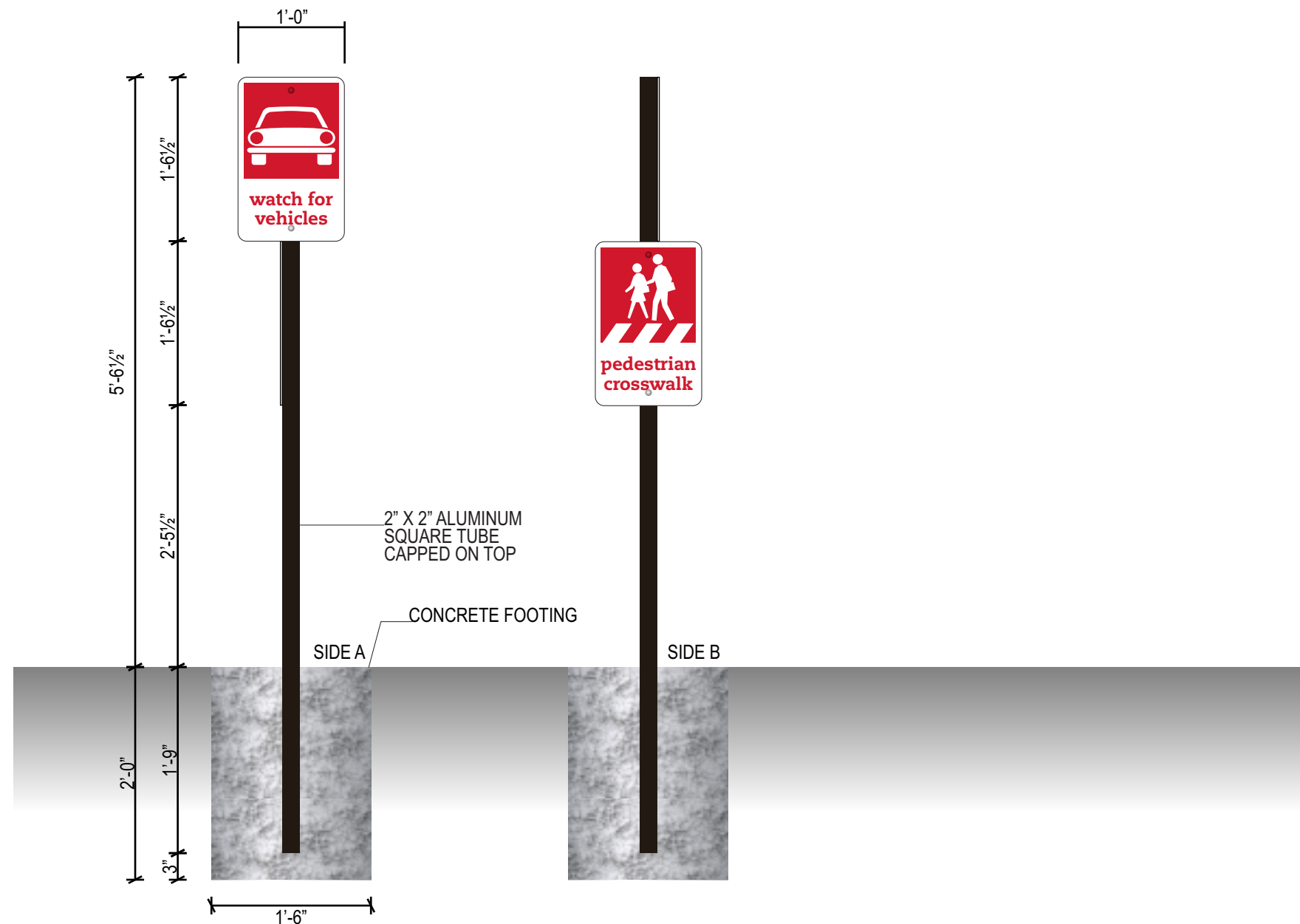

## NON-ILLUMINATED PEDESTRIAN CROSSWALK AND VEHICLE CROSSING SIGNS

SCALE: 3/4" = 1'

THIS IS AN ORIGINAL UNPUBLISHED DRAWING CREATED FOR YOUR PERSONAL USE IN CONNECTION WITH A PROJECT PLANNED FOR YOU BY NSMC. IT IS NOT TO BE SHOWN OUTSIDE YOUR ORGANIZATION NOR USED, REPRODUCED, COPIED OR EXHIBITED IN ANY FASHION UNLESS AUTHORIZED IN WRITING BY AN OFFICER OF NSMC



**National Sign & Marketing Corporation**  
 13580 5th St., Chino, CA 91710  
 Tel 909.591.4742 Fax 909.591.9792  
 e-mail : sales@nsmc.com  
 Lic# 745030 - Exp. 01/31/20

**Project:** Chick-Fil-A #4107 (Coors FSU)  
**Address:** Coors Blvd and Joseph Drive, Albuquerque, NM 87120  
**Phone:** \_\_\_\_\_ **Account Mgr.:** S. Rosenbloom  
**Designer:** Duffy, S. **Scale:** Noted **Date:** 01/24/2018

**Client Approval:** \_\_\_\_\_  
 Date: \_\_\_\_\_

This sign intended to be in accordance with the requirements of Article 600 of the National Electrical Code and/or other applicable local codes. This includes proper grounding and bonding of this sign.



**Revisions:**  
 11/14/18 SD Change monument to tenant panel only

**Drawing Number**  
**28207**  
 R1







**BOLLARD TO BE SET BY OTHERS  
FINISHED WITH POST AND PANEL SIGN BY NSMC**

**Specifications:**

PANEL: .080 ALUMINUM PANELS WITH 2 1/4" RADIUS CORNERS. ATTACHED TO POLE WITH CARRIAGE BOLTS. BACKS PAINTED DARK BRONZE.  
 BACKGROUND: REFLECTIVE WHITE.  
 COPY & GRAPHICS: TO BE REFLECTIVE PANTONE 186C, AND WHITE  
 POST: 2" X 2" ALUMINUM POLE CAPPED ON TOP, WITH 6" DIAMETER CONCRETE BOLLARD . POLE TO BE PAINTED DARK BRONZE.  
 FOOTING: CONCRETE FOOTING PER CITY REGULATIONS.

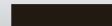
 PANTONE 186 C RED  
 MATTHEWS #N6425SP WHITE  
 MATTHEWS MP 74155 SV SATIN DARK BRONZE

**N NEW CURBSIDE DELIVERY SIGN**

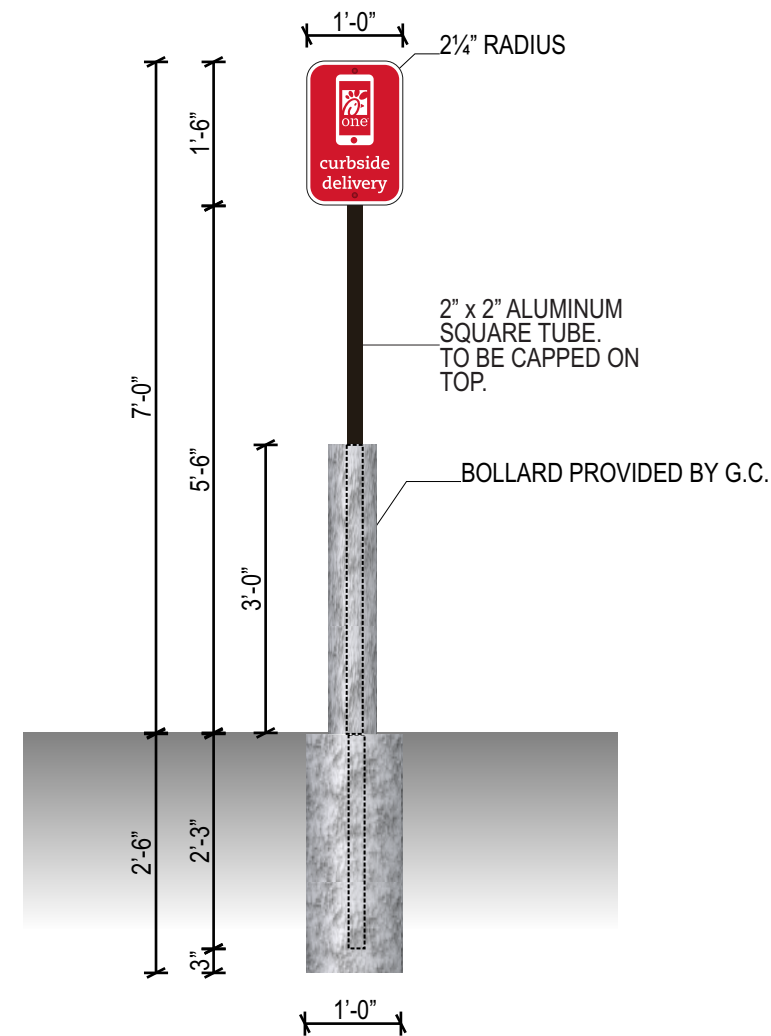

**NON-ILLUMINATED HANDICAPPED PARKING SIGN**

SCALE: 1/2" = 1'-0"

THIS IS AN ORIGINAL UNPUBLISHED DRAWING CREATED FOR YOUR PERSONAL USE IN CONNECTION WITH A PROJECT PLANNED FOR YOU BY NSMC. IT IS NOT TO BE SHOWN OUTSIDE YOUR ORGANIZATION NOR USED, REPRODUCED, COPIED OR EXHIBITED IN ANY FASHION UNLESS AUTHORIZED IN WRITING BY AN OFFICER OF NSMC



**Project:** Chick-Fil-A #4107 (Coors FSU)  
**Address:** Coors Blvd and Joseph Drive, Albuquerque, NM 87120  
**Phone:** \_\_\_\_\_ **Account Mgr.:** S. Rosenbloom  
**Designer:** Duffy, S. **Scale:** Noted **Date:** 01/24/2018

**Client Approval:** \_\_\_\_\_  
 Date: \_\_\_\_\_

This sign intended to be in accordance with the requirements of Article 600 of the National Electrical Code and/or other applicable local codes. This includes proper grounding and bonding of this sign.  
 

**Revisions:**  
 11/14/18 SD Change monument to tenant panel only

**Drawing Number**  
**28207**  
 R1



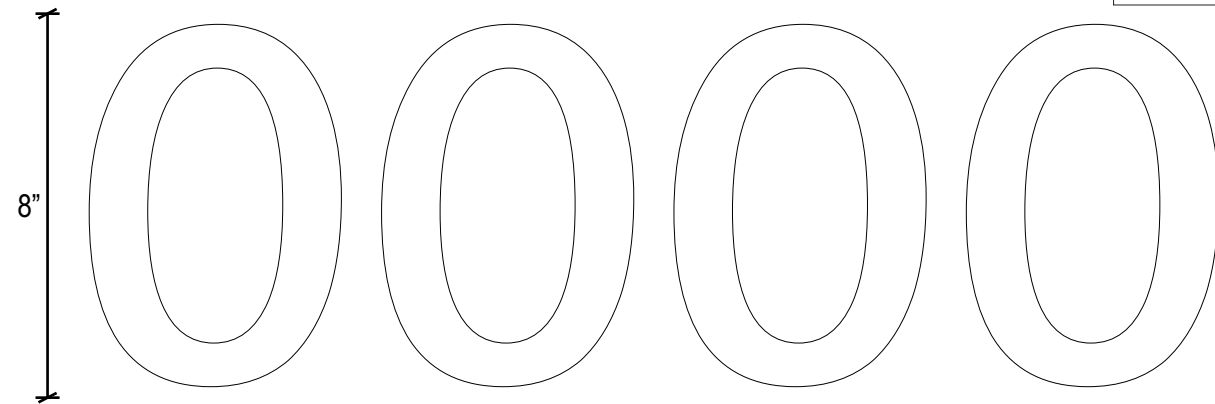

ADDRESS APPLIED  
FIRST SURFACE

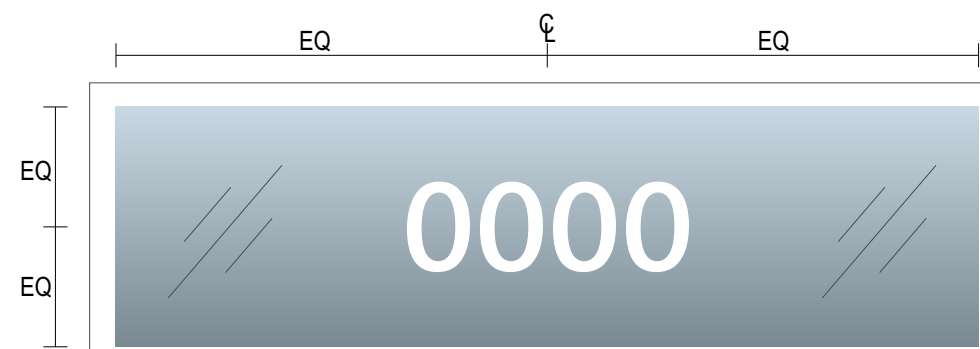

Credit Card icons should be individually cut out, not printed on clear substrate  
Blue line around credit cards represents the die line DOES NOT PRINT

STORE HOURS TO BE VERIFIED

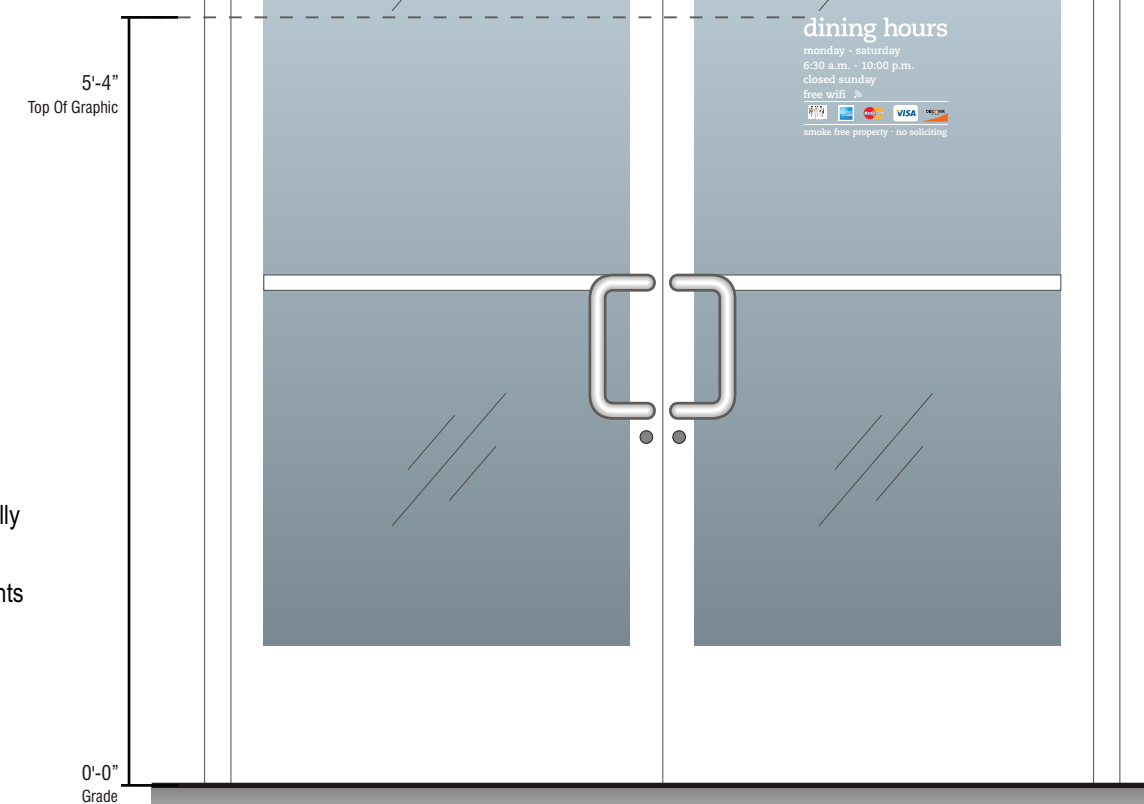

DOOR ELEVATION  
SCALE: 3/4" = 1'

3M 7025-510 OPAQUE WHITE

NEW WINDOW VINYL

**WHITE DOOR WINDOW VINYL APPLIED SECOND SURFACE**

SCALE: 3" = 1'

THIS IS AN ORIGINAL UNPUBLISHED DRAWING CREATED FOR YOUR PERSONAL USE IN CONNECTION WITH A PROJECT PLANNED FOR YOU BY NSMC. IT IS NOT TO BE SHOWN OUTSIDE YOUR ORGANIZATION NOR USED, REPRODUCED, COPIED OR EXHIBITED IN ANY FASHION UNLESS AUTHORIZED IN WRITING BY AN OFFICER OF NSMC

**National Sign & Marketing Corporation**  
13580 5th St., Chino, CA 91710  
Tel 909.591.4742 Fax 909.591.9792  
e-mail : sales@nsmc.com  
Lic# 745030 - Exp. 01/31/20

**Project:** Chick-Fil-A #4107 (Coors FSU)  
**Address:** Coors Blvd and Joseph Drive, Albuquerque, NM 87120  
**Phone:** \_\_\_\_\_ **Account Mgr.:** S. Rosenbloom  
**Designer:** Duffy, S. **Scale:** Noted **Date:** 01/24/2018

**Client Approval:** \_\_\_\_\_  
Date: \_\_\_\_\_

This sign intended to be in accordance with the requirements of Article 600 of the National Electrical Code and/or other applicable local codes. This includes proper grounding and bonding of this sign.

**Revisions:**

11/14/18 SD Change monument to tenant panel only

**Drawing Number**  
**28207**  
R1

# FOOTINGS BY OTHERS, FINAL SETTING BY NSMC

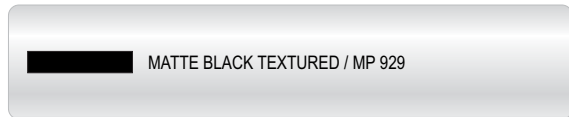
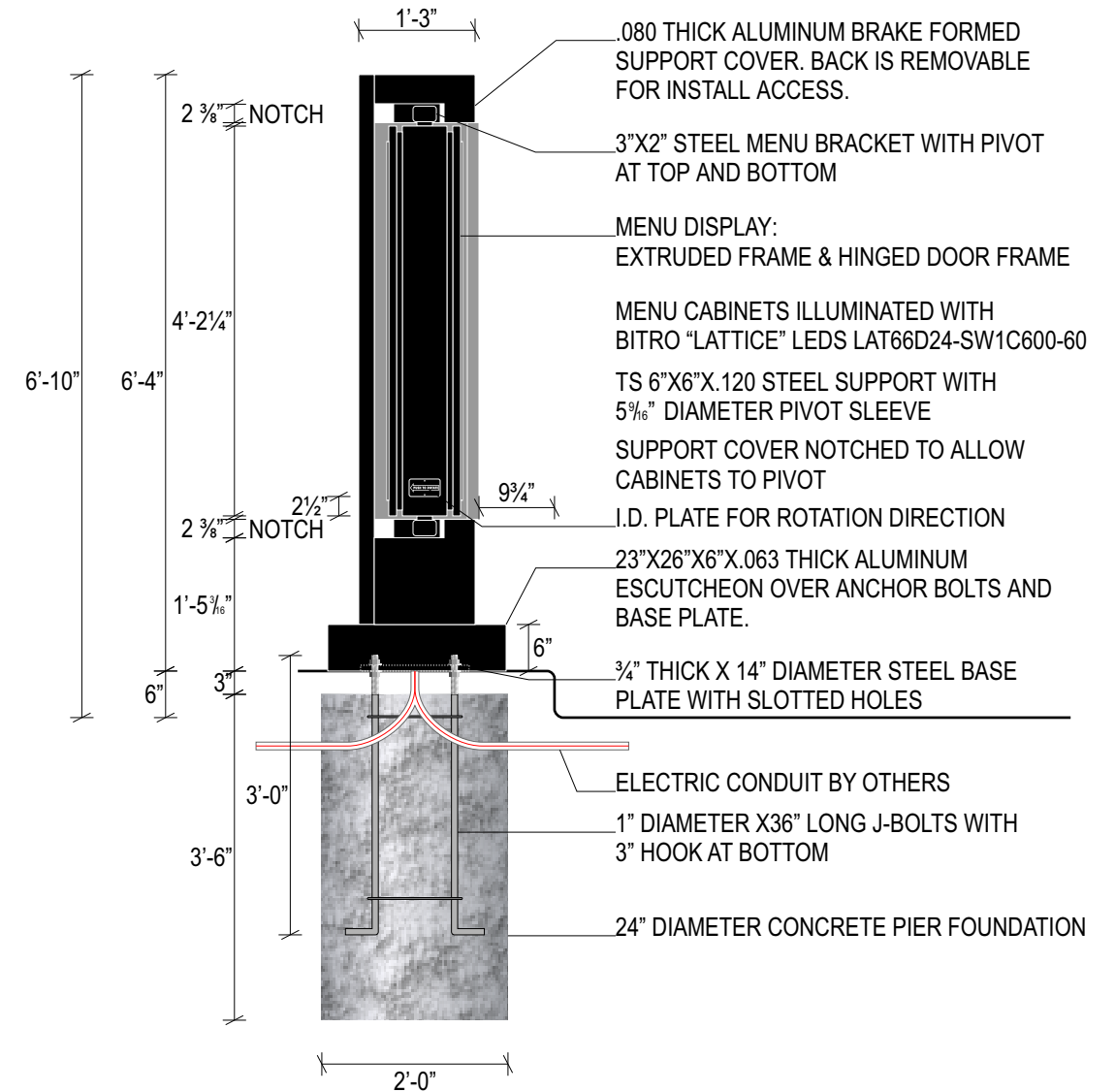
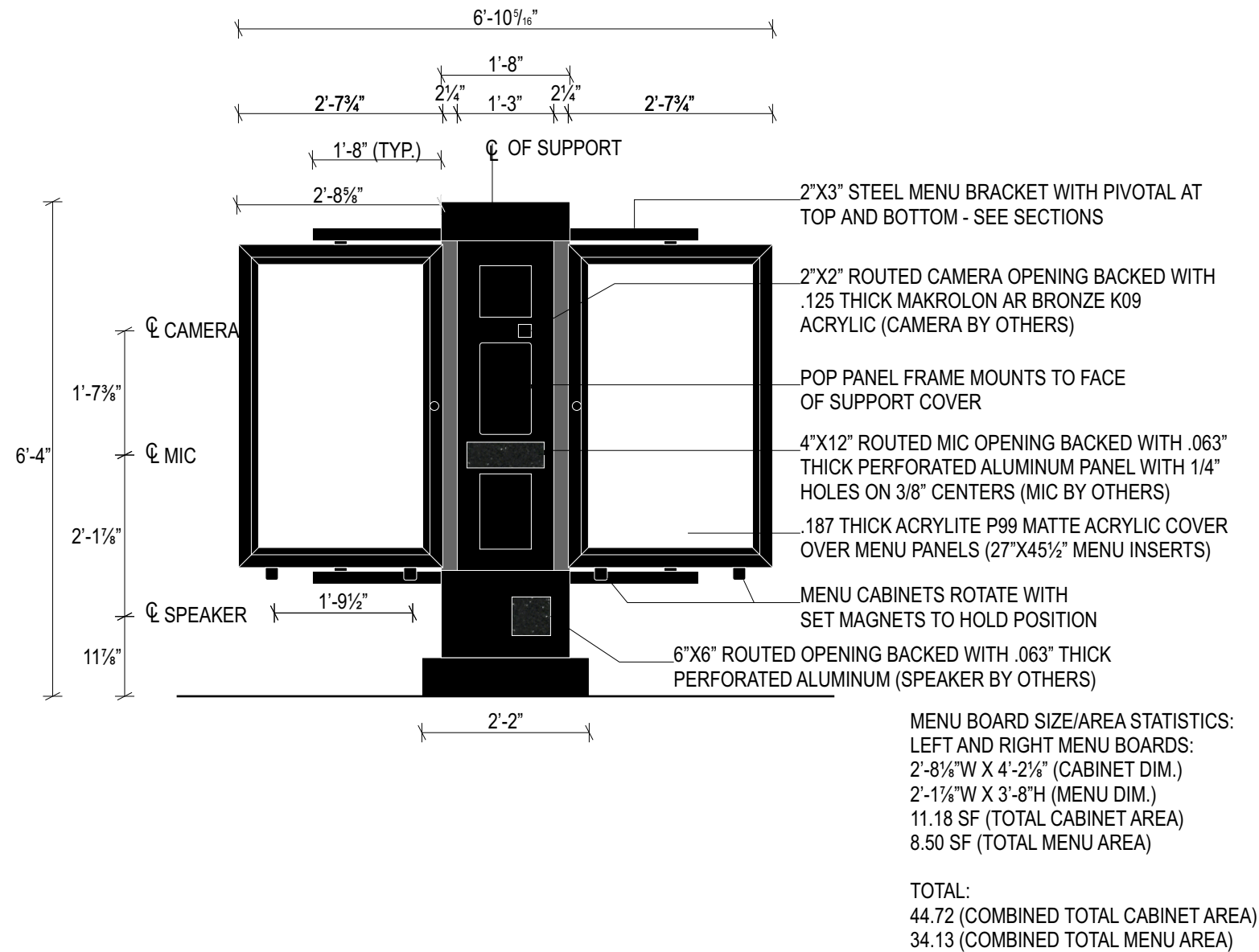

1 2 DRIVE-THRU MENU BOARD

## DRIVE THRU MENU BOARD (TO BE FABRICATED BY OTHERS)

SCALE: 1/2" = 1'-0"

THIS IS AN ORIGINAL UNPUBLISHED DRAWING CREATED FOR YOUR PERSONAL USE IN CONNECTION WITH A PROJECT PLANNED FOR YOU BY NSMC. IT IS NOT TO BE SHOWN OUTSIDE YOUR ORGANIZATION NOR USED, REPRODUCED, COPIED OR EXHIBITED IN ANY FASHION UNLESS AUTHORIZED IN WRITING BY AN OFFICER OF NSMC



**Project:** Chick-Fil-A #4107 (Coors FSU)  
**Address:** Coors Blvd and Joseph Drive, Albuquerque, NM 87120  
**Phone:** \_\_\_\_\_ **Account Mgr.:** S. Rosenbloom  
**Designer:** Duffy, S. **Scale:** Noted **Date:** 01/24/2018

**Client Approval:** \_\_\_\_\_  
 \_\_\_\_\_  
**Date:** \_\_\_\_\_

This sign intended to be in accordance with the requirements of Article 600 of the National Electrical Code and/or other applicable local codes. This includes proper grounding and bonding of this sign.

UL

**Revisions:**  
 11/14/18 SD Change monument to tenant panel only

**Drawing Number**  
**28207**  
 R1



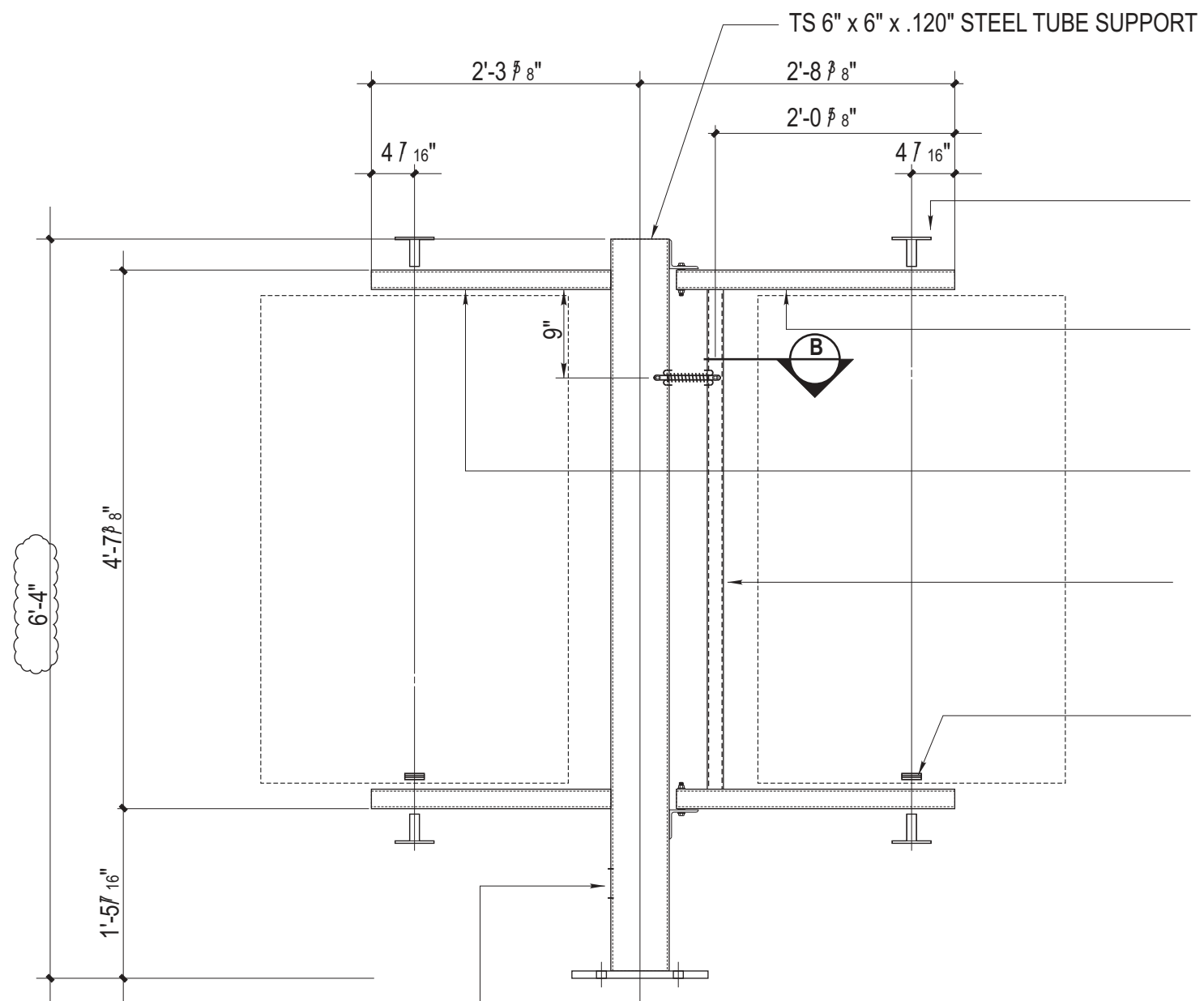

1" DIA. ALUM. TUBE with 1/4" THK. ALUM. PLATE AT PIVOT (TYP.) SEE DETAIL

TS 2" x 3" x .187" STEEL TUBE MENU BRACKET THRU BOLTED TO 3" x 3" x 1/4" ANGLE IRON CLIP AT TOP and BOTTOM. BRACKET PIVOTS with DRAWBAR SPRING ON TUBE TO RETURN TO ORIGINAL POSITION WHEN BUMPED.

TS 2" x 3" x .187" STEEL TUBE MENU BRACKET WELDED IN A STATIONARY POSITION TO THE PRIMARY SUPPORT. CAP END.

1 1/4" DIA. SCHEDULE 40 STEEL VERTICAL STIFFENER ON BACK OF PIVOT FRAME.

2" DIA. LEXAN SPACERS UNDER CABINET (2) 3/16" THICK (1) 1/4" THICK

3" x 3" SQ. HAND HOLE CENTERED ON SUPPORT. 45°

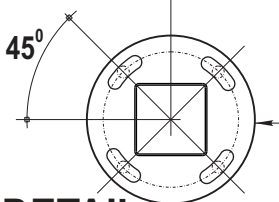

3/4" THK. x 14" DIA. STL. BASE PLATE. 1 1/8" x 3 3/4" SLOTTED HOLES. SEE SHT. 17 FOR DETAILS.

3/4" = 1'-0"

**SUPPORT STEEL DETAIL**

(1) AS SHOWN PER STATION

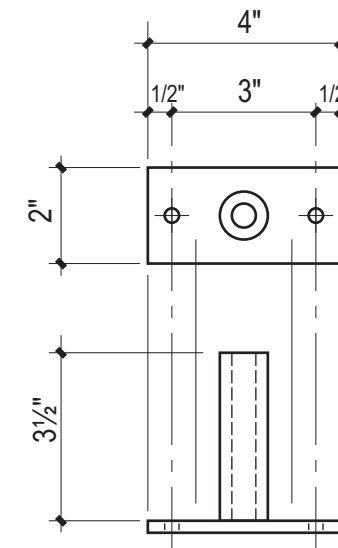

**TOP / BOTTOM PIVOT TUBE DETAIL**

(4) REQUIRED (SIMILAR @ TOP) SCALE: 3" = 1'-0"

1" DIA. x .250" ALUM. TUBE WELDED TO 1/4" THK. ALUM. PLATE. ATTACH TO BRACKET ARM with (2) THREAD-CUTTING SCREWS.

**DRIVE THRU CANOPY STEEL DETAIL**

SCALE: NOTED

THIS IS AN ORIGINAL UNPUBLISHED DRAWING CREATED FOR YOUR PERSONAL USE IN CONNECTION WITH A PROJECT PLANNED FOR YOU BY NSMC. IT IS NOT TO BE SHOWN OUTSIDE YOUR ORGANIZATION NOR USED, REPRODUCED, COPIED OR EXHIBITED IN ANY FASHION UNLESS AUTHORIZED IN WRITING BY AN OFFICER OF NSMC

**National Sign & Marketing Corporation**  
 13580 5th St., Chino, CA 91710  
 Tel 909.591.4742 Fax 909.591.9792  
 e-mail : sales@nsmc.com  
 Lic# 745030 - Exp. 01/31/20

**Project:** Chick-Fil-A #4107 (Coors FSU)  
**Address:** Coors Blvd and Joseph Drive, Albuquerque, NM 87120  
**Phone:** \_\_\_\_\_ **Account Mgr.:** S. Rosenbloom  
**Designer:** Duffy, S. **Scale:** Noted **Date:** 01/24/2018

**Client Approval:** \_\_\_\_\_  
 \_\_\_\_\_  
**Date:** \_\_\_\_\_

This sign intended to be in accordance with the requirements of Article 600 of the National Electrical Code and/or other applicable local codes. This includes proper grounding and bonding of this sign.

**Revisions:**  
 11/14/18 SD Change monument to tenant panel only

**Drawing Number**  
**28207**  
 R1

**VSCO**  
 ELECTRONIC SIGNS

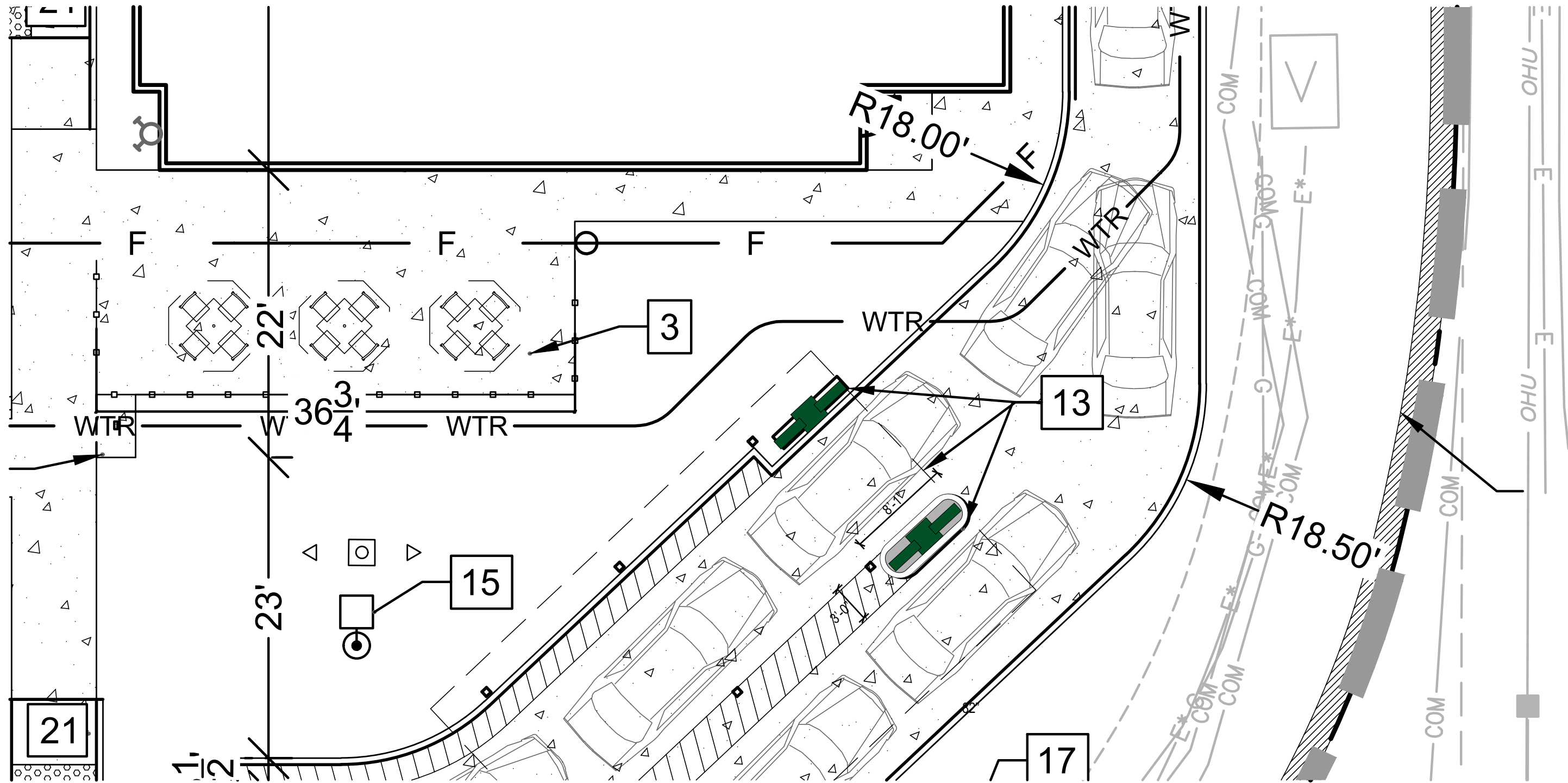

1 2 DRIVE-THRU CANOPY

**DRIVE THRU CANOPY WITH MENU BOARD LAYOUT**

SCALE: 1/8" = 1'-0"

THIS IS AN ORIGINAL UNPUBLISHED DRAWING CREATED FOR YOUR PERSONAL USE IN CONNECTION WITH A PROJECT PLANNED FOR YOU BY NSMC. IT IS NOT TO BE SHOWN OUTSIDE YOUR ORGANIZATION NOR USED, REPRODUCED, COPIED OR EXHIBITED IN ANY FASHION UNLESS AUTHORIZED IN WRITING BY AN OFFICER OF NSMC



**National Sign & Marketing Corporation**  
 13580 5th St., Chino, CA 91710  
 Tel 909.591.4742 Fax 909.591.9792  
 e-mail : sales@nsmc.com  
 Lic# 745030 - Exp. 01/31/20

**Project:** Chick-Fil-A #4107 (Coors FSU)  
**Address:** Coors Blvd and Joseph Drive, Albuquerque, NM 87120  
**Phone:** \_\_\_\_\_ **Account Mgr.** S. Rosenbloom  
**Designer:** Duffy, S. **Scale:** Noted **Date:** 01/24/2018

**Client Approval:** \_\_\_\_\_  
 \_\_\_\_\_  
**Date:** \_\_\_\_\_

This sign intended to be in accordance with the requirements of Article 600 of the National Electrical Code and/or other applicable local codes. This includes proper grounding and bonding of this sign.



**Revisions:**  
 11/14/18 SD Change monument to tenant panel only

**Drawing Number**  
**28207**  
 R1



# FOOTINGS BY OTHERS, FINAL SETTING BY NSMC

**NOTE:**  
CLEARANCE BAR ARM TO ROTATE WHEN STRUCK AND RETURN TO ORIGINAL POSITION.

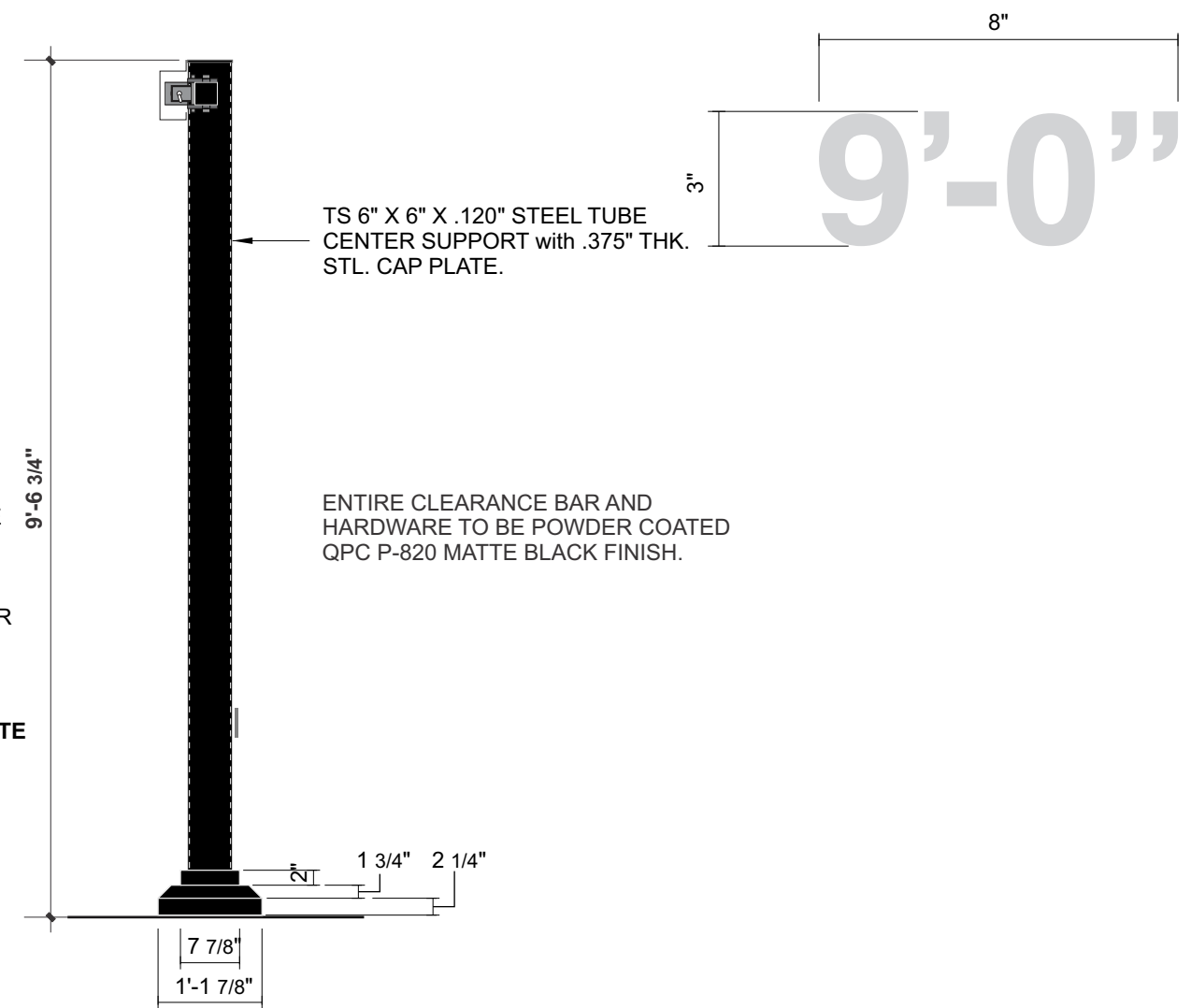
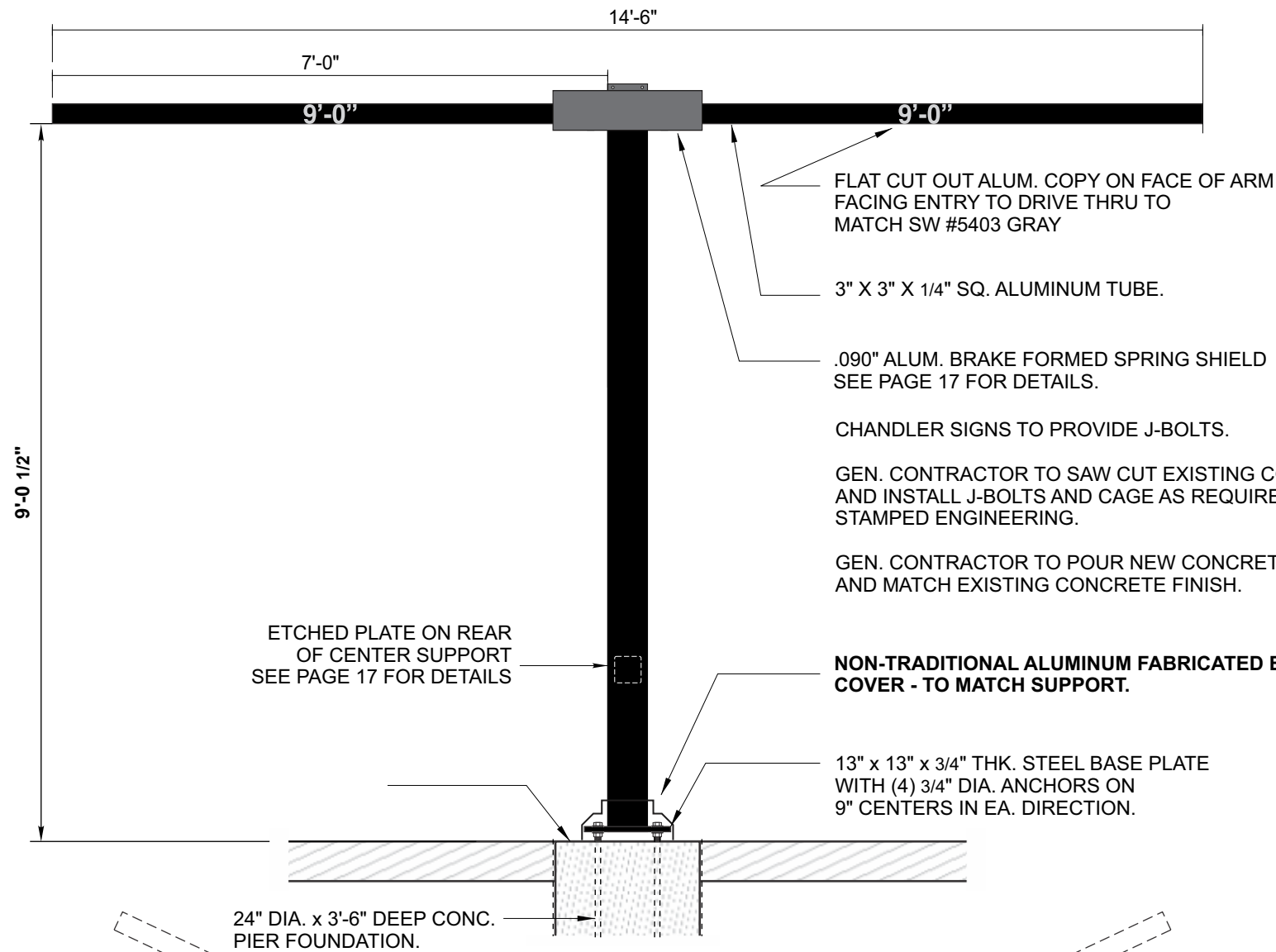

ETCHED PLATE ON REAR OF CENTER SUPPORT SEE PAGE 17 FOR DETAILS

FLAT CUT OUT ALUM. COPY ON FACE OF ARM FACING ENTRY TO DRIVE THRU TO MATCH SW #5403 GRAY

3" X 3" X 1/4" SQ. ALUMINUM TUBE.

.090" ALUM. BRAKE FORMED SPRING SHIELD SEE PAGE 17 FOR DETAILS.

CHANDLER SIGNS TO PROVIDE J-BOLTS.

GEN. CONTRACTOR TO SAW CUT EXISTING CONCRETE AND INSTALL J-BOLTS AND CAGE AS REQUIRED BY STAMPED ENGINEERING.

GEN. CONTRACTOR TO POUR NEW CONCRETE FOOTER AND MATCH EXISTING CONCRETE FINISH.

**NON-TRADITIONAL ALUMINUM FABRICATED BASE PLATE COVER - TO MATCH SUPPORT.**

13" x 13" x 3/4" THK. STEEL BASE PLATE WITH (4) 3/4" DIA. ANCHORS ON 9" CENTERS IN EA. DIRECTION.

24" DIA. x 3'-6" DEEP CONC. PIER FOUNDATION.

### Specifications

**CLEARANCE ARM:** TO BE FABRICATED BY OTHERS TO BE PAINTED MATTE BLACK TEXTURED.

**COPY:** 9'-0" TO BE FLAT CUT OUT ALUMINUM COPY ON FACE OF ARM FACING ENTRY TO DRIVE THRU PAINTED TO MATCH SW #5403 GRAY ATTACHED WITH VHB.

**NOTES:** STANDARD HEIGHT ACCORDING TO CLEARANCE, DRIVE THRU GRADE TO BOTTOM OF CLEARANCE ARM. HEIGHT OF CAGE WILL NEED TO BE ADJUSTED TO ACCOMMODATE THE DISTANCE BETWEEN THE ARM AND GRADE. THERE MUST BE AT LEAST 3/2" OF BOLT THREAD ABOVE BASE PLATE.

SHERWIN WILLIAMS #5403 GRAY  
 MATTE BLACK TEXTURED

**3** DRIVE-THRU CLEARANCE ARM

## CHICK-FIL-A - NEW CLEARANCE ARM (TO BE FABRICATED BY OTHERS)

SCALE: 1/2" = 1'-0"

THIS IS AN ORIGINAL UNPUBLISHED DRAWING CREATED FOR YOUR PERSONAL USE IN CONNECTION WITH A PROJECT PLANNED FOR YOU BY NSMC. IT IS NOT TO BE SHOWN OUTSIDE YOUR ORGANIZATION NOR USED, REPRODUCED, COPIED OR EXHIBITED IN ANY FASHION UNLESS AUTHORIZED IN WRITING BY AN OFFICER OF NSMC

**National Sign & Marketing Corporation**  
 13580 5th St., Chino, CA 91710  
 Tel 909.591.4742 Fax 909.591.9792  
 e-mail : sales@nsmc.com  
 Lic# 745030 - Exp. 01/31/20

**Project:** Chick-Fil-A #4107 (Coors FSU)  
**Address:** Coors Blvd and Joseph Drive, Albuquerque, NM 87120  
**Phone:** \_\_\_\_\_ **Account Mgr.:** S. Rosenbloom  
**Designer:** Duffy, S. **Scale:** Noted **Date:** 01/24/2018

**Client Approval:** \_\_\_\_\_  
 Date: \_\_\_\_\_

This sign intended to be in accordance with the requirements of Article 600 of the National Electrical Code and/or other applicable local codes. This includes proper grounding and bonding of this sign.

**Revisions:**  
 11/14/18 SD Change monument to tenant panel only

**Drawing Number**  
**28207**  
 R1

# FOOTINGS BY OTHERS, FINAL SETTING BY NSMC

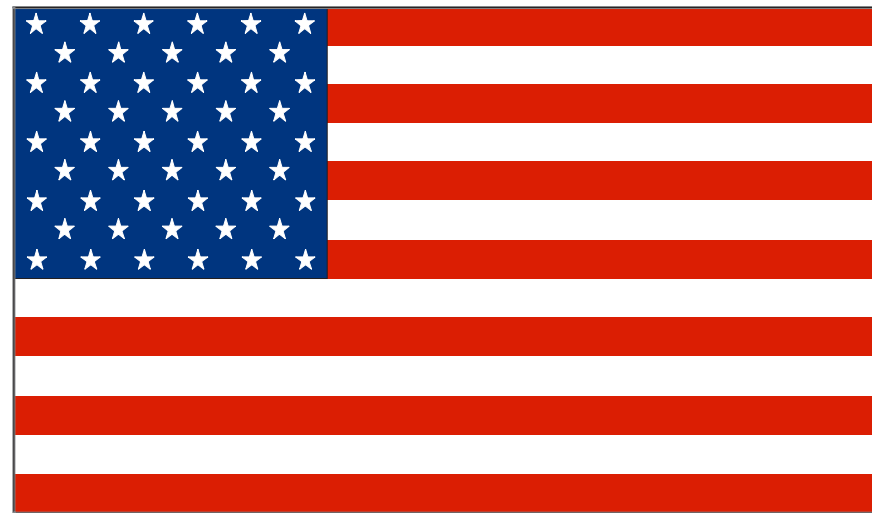

Flag

### FOUNDATION SIZES

HEIGHT	A	B	C	FLAG SIZE
20'	3'-6"	30"	24"	6'-10'
25'	3'-6"	30"	24"	6'-10'
30'	3'-6"	30"	24"	6'-10'
35'	4'-0"	36"	30"	6'-10'
40'	4'-6"	42"	36"	12'-18'
45'	5'-0"	48"	42"	12'-18'
50'	5'-6"	48"	42"	12'-18'

### Size Chart

Ground sleeve and concrete installed by the general contractor

Pole installed on pre-installed ground sleeve by sign contractor

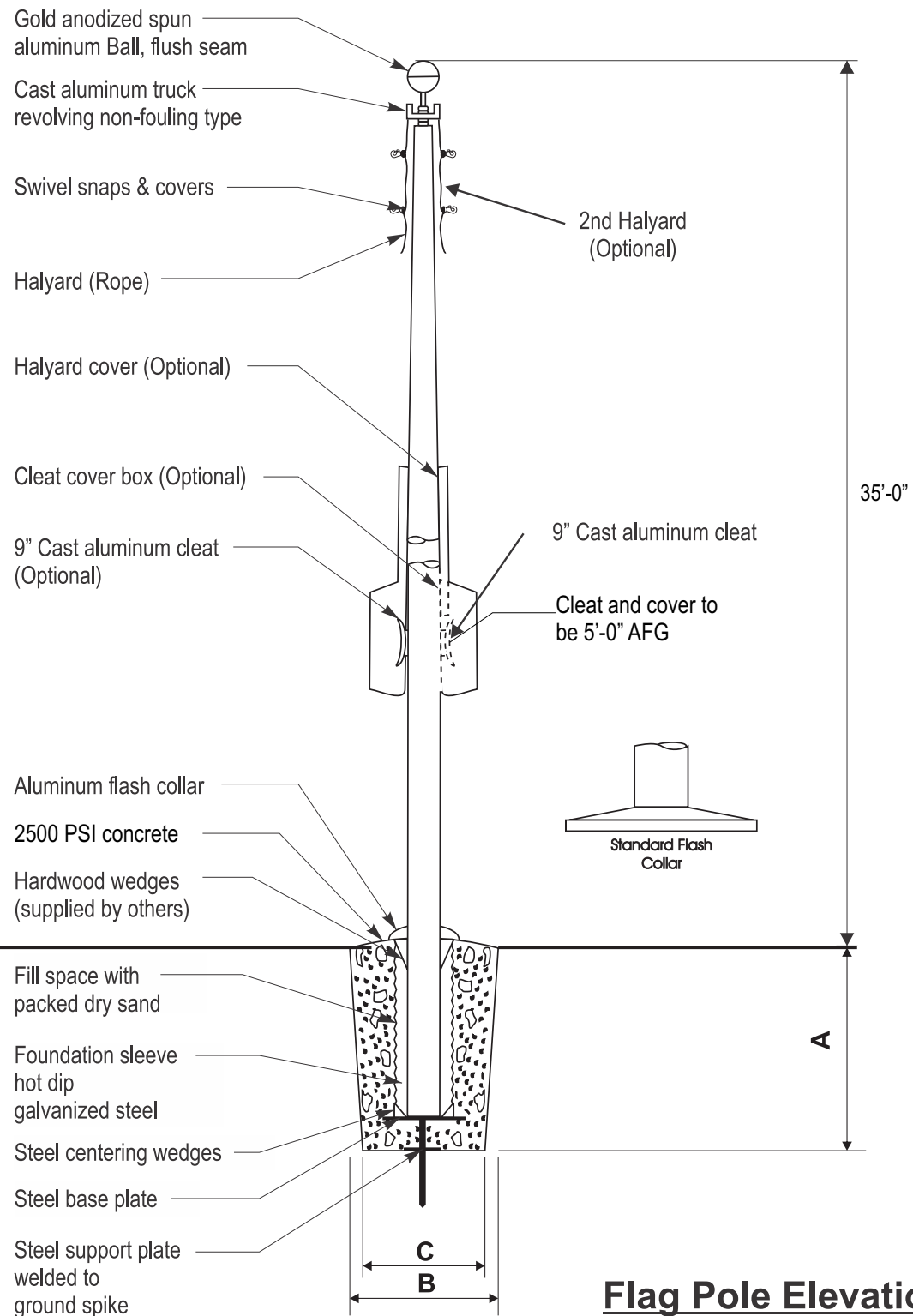

Flag Pole Elevation

4 FLAG POLE

## FLAG POLE

SCALE: NTS

THIS IS AN ORIGINAL UNPUBLISHED DRAWING CREATED FOR YOUR PERSONAL USE IN CONNECTION WITH A PROJECT PLANNED FOR YOU BY NSMC. IT IS NOT TO BE SHOWN OUTSIDE YOUR ORGANIZATION NOR USED, REPRODUCED, COPIED OR EXHIBITED IN ANY FASHION UNLESS AUTHORIZED IN WRITING BY AN OFFICER OF NSMC



**National Sign & Marketing Corporation**  
 13580 5th St., Chino, CA 91710  
 Tel 909.591.4742 Fax 909.591.9792  
 e-mail : sales@nsmc.com  
 Lic# 745030 - Exp. 01/31/20

**Project:** Chick-Fil-A #4107 (Coors FSU)  
**Address:** Coors Blvd and Joseph Drive, Albuquerque, NM 87120  
**Phone:** \_\_\_\_\_ **Account Mgr.:** S. Rosenbloom  
**Designer:** Duffy, S. **Scale:** Noted **Date:** 01/24/2018

**Client Approval:** \_\_\_\_\_  
 \_\_\_\_\_  
**Date:** \_\_\_\_\_

This sign intended to be in accordance with the requirements of Article 600 of the National Electrical Code and/or other applicable local codes. This includes proper grounding and bonding of this sign.

**Revisions:**  
 11/14/18 SD Change monument to tenant panel only

**Drawing Number**  
**28207**  
 R1



# Scope of Work

C1 C2 C3 C4 C5 C6 C7 NEW CANOPY

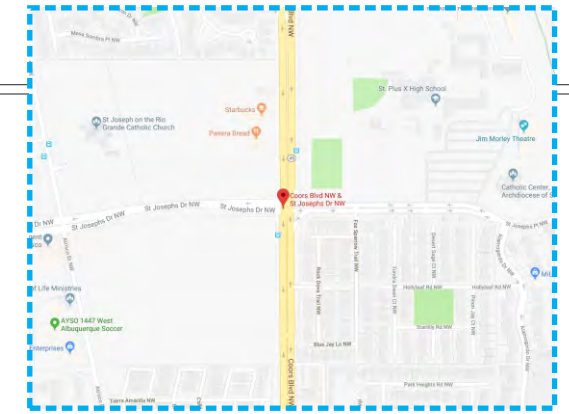
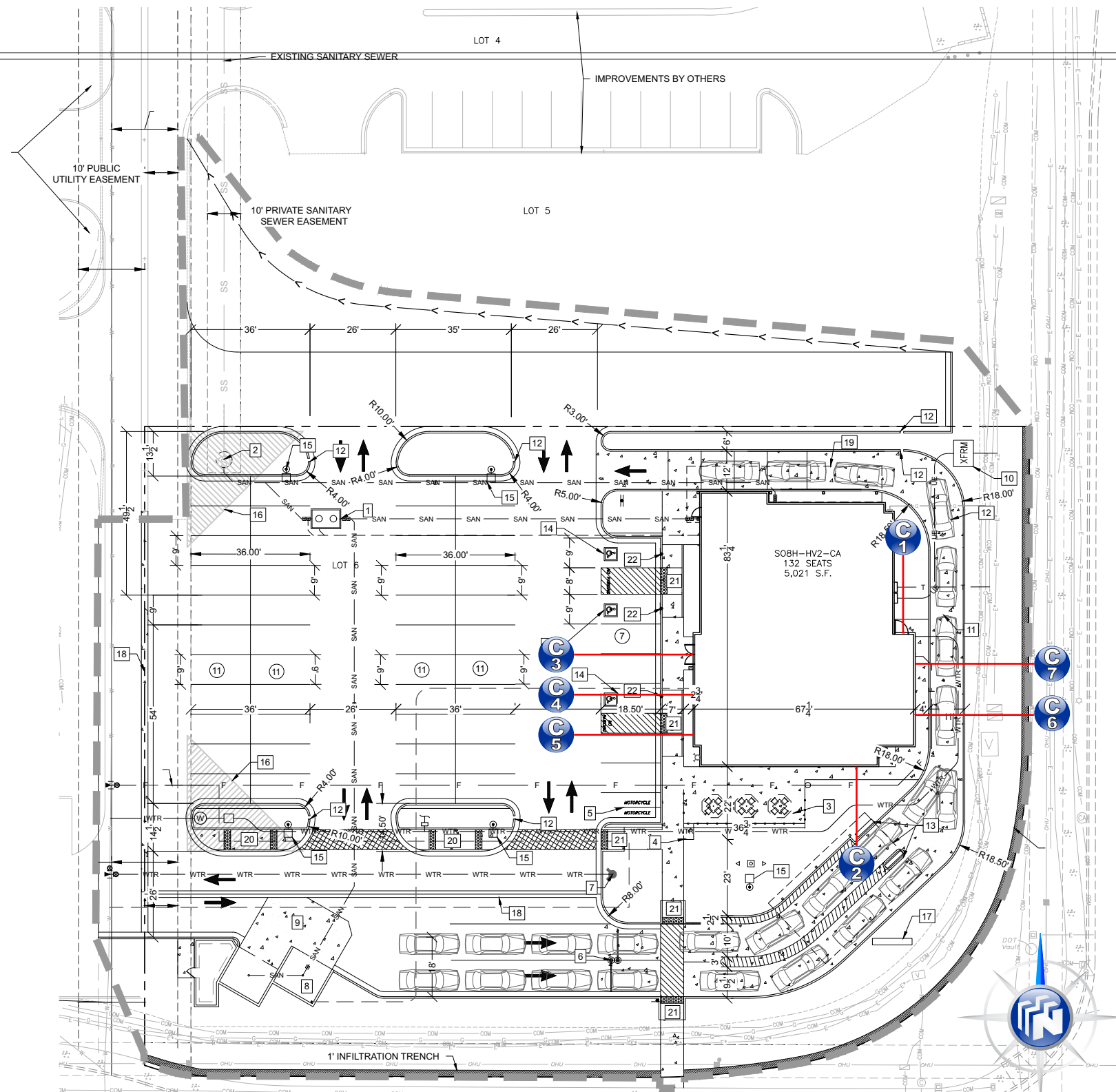

VICINITY MAP

SIGN ID LETTER	FACE A	FACE B
-		N/A

**NOTE:**  
ALL NEW SIGNAGE TO CONNECT TO CLIENT PROVIDED ELECTRICAL CIRCUITS

## CHICK-FIL-A - Albuquerque, NM. - Site Plan

SCALE: 1" = 40'-0"

THIS IS AN ORIGINAL UNPUBLISHED DRAWING CREATED FOR YOUR PERSONAL USE IN CONNECTION WITH A PROJECT PLANNED FOR YOU BY NSMC. IT IS NOT TO BE SHOWN OUTSIDE YOUR ORGANIZATION NOR USED, REPRODUCED, COPIED OR EXHIBITED IN ANY FASHION UNLESS AUTHORIZED IN WRITING BY AN OFFICER OF NSMC

**National Sign & Marketing Corporation**  
13580 5th St., Chino, CA 91710  
Tel 909.591.4742 Fax 909.591.9792  
e-mail : sales@nsmc.com  
Lic# 745030 - Exp. 01/31/20

**Project:** Chick-Fil-A #4107 (Coors FSU)  
**Address:** Coors Blvd and Joseph Drive, Albuquerque, NM 87120  
**Phone:** \_\_\_\_\_ **Account Mgr.:** S. Rosenbloom  
**Designer:** Duffy, S. **Scale:** Noted **Date:** 01/24/2018

**Client Approval:** \_\_\_\_\_  
**Date:** \_\_\_\_\_

This sign intended to be in accordance with the requirements of Article 600 of the National Electrical Code and/or other applicable local codes. This includes proper grounding and bonding of this sign.

**Revisions:**  
11/14/18 SD Change monument to tenant panel only

**Drawing Number**  
**28207**  
R1



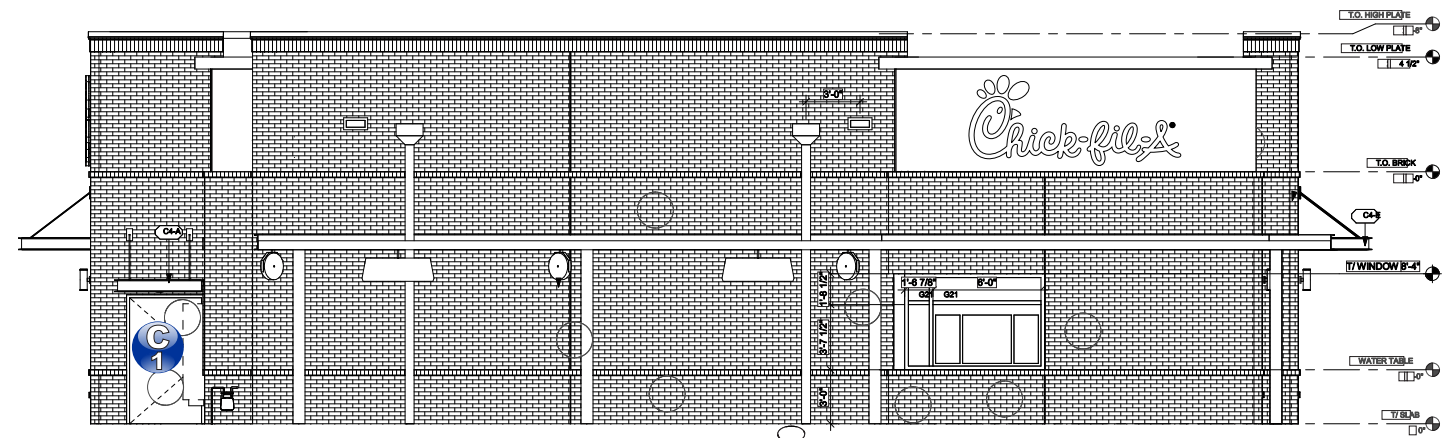

**C1** NEW CANOPY

### North Elevation

SCALE: 3/32" = 1'-0"

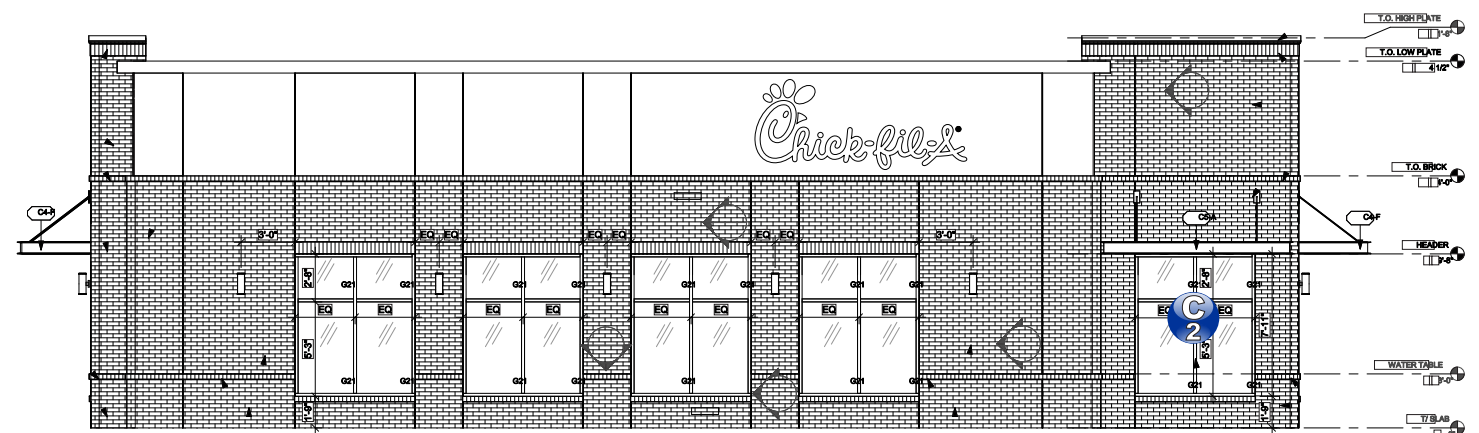

**C2** NEW CANOPY

### South Elevation

SCALE: 3/32" = 1'-0"

THIS IS AN ORIGINAL UNPUBLISHED DRAWING CREATED FOR YOUR PERSONAL USE IN CONNECTION WITH A PROJECT PLANNED FOR YOU BY NSMC. IT IS NOT TO BE SHOWN OUTSIDE YOUR ORGANIZATION NOR USED, REPRODUCED, COPIED OR EXHIBITED IN ANY FASHION UNLESS AUTHORIZED IN WRITING BY AN OFFICER OF NSMC



**National Sign & Marketing Corporation**  
 13580 5th St., Chino, CA 91710  
 Tel 909.591.4742 Fax 909.591.9792  
 e-mail : sales@nsmc.com  
 Lic# 745030 - Exp. 01/31/20

**Project:** Chick-Fil-A #4107 (Coors FSU)  
**Address:** Coors Blvd and Joseph Drive, Albuquerque, NM 87120  
**Phone:** \_\_\_\_\_ **Account Mgr.:** S. Rosenbloom  
**Designer:** Duffy, S. **Scale:** Noted **Date:** 01/24/2018

**Client Approval:**  
 \_\_\_\_\_  
**Date:** \_\_\_\_\_

This sign intended to be in accordance with the requirements of Article 600 of the National Electrical Code and/or other applicable local codes. This includes proper grounding and bonding of this sign.



**Revisions:**  
 11/14/18 SD Change monument to tenant panel only  
 \_\_\_\_\_  
 \_\_\_\_\_  
 \_\_\_\_\_

**Drawing Number**  
**28207**  
 R1





1'-10"

DO NOT WALK, STAND, OR SIT ON THIS CANOPY

1"

**Specifications**

VINYL TO BE PLACED ON TOP OF ALL CANOPIES. FOR CANOPIES LONGER THAN 14'-0", MULTIPLE COPIES OF THIS TEXT TO BE PLACED EVERY 8'-0" TO 10'-0".  
 COPY TO BE PLACED TOWARDS THE FRONT EDGE OF THE TOP OF THE CANOPY.  
 FOR ALL DARK COLORED CANOPIES WHITE VINYL IS TO BE USED. FOR LIGHT COLORED CANOPIES BLACK IS TO BE USED.

 NEW CANOPY

**CANOPY WARNING STICKERS**

SCALE: 6" = 1'-0"

THIS IS AN ORIGINAL UNPUBLISHED DRAWING CREATED FOR YOUR PERSONAL USE IN CONNECTION WITH A PROJECT PLANNED FOR YOU BY NSMC. IT IS NOT TO BE SHOWN OUTSIDE YOUR ORGANIZATION NOR USED, REPRODUCED, COPIED OR EXHIBITED IN ANY FASHION UNLESS AUTHORIZED IN WRITING BY AN OFFICER OF NSMC



**National Sign & Marketing Corporation**  
 13580 5th St., Chino, CA 91710  
 Tel 909.591.4742 Fax 909.591.9792  
 e-mail : sales@nsmc.com  
 Lic# 745030 - Exp. 01/31/20

**Project:** Chick-Fil-A #4107 (Coors FSU)  
**Address:** Coors Blvd and Joseph Drive, Albuquerque, NM 87120  
**Phone:** \_\_\_\_\_ **Account Mgr.** S. Rosenbloom  
**Designer:** Duffy, S. **Scale:** Noted **Date:** 01/24/2018

**Client Approval:**  
 \_\_\_\_\_  
**Date:** \_\_\_\_\_

This sign intended to be in accordance with the requirements of Article 600 of the National Electrical Code and/or other applicable local codes. This includes proper grounding and bonding of this sign.  

**Revisions:**  
 11/14/18 SD Change monument to tenant panel only

**Drawing Number**  
**28207**  
 R1



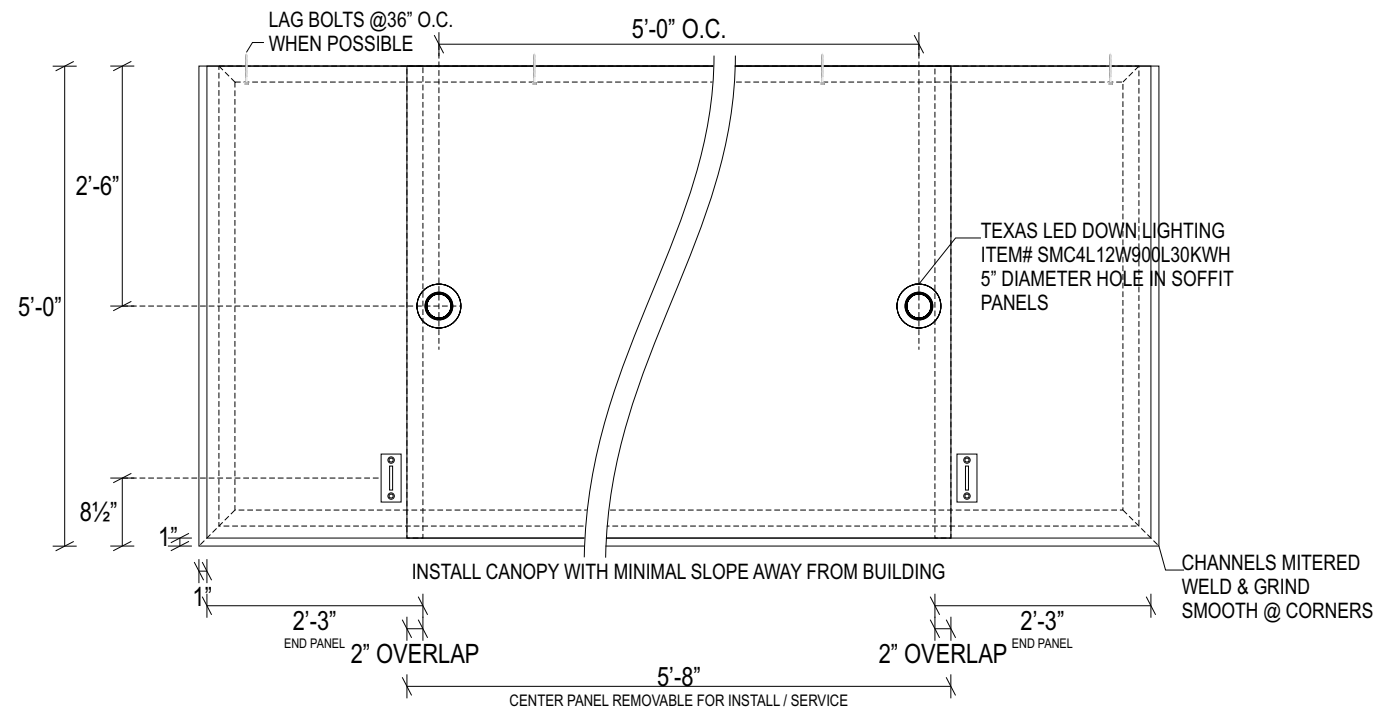
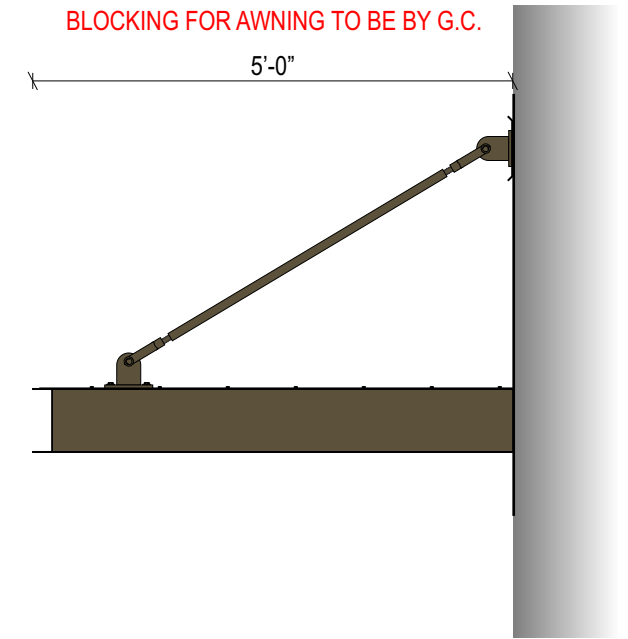
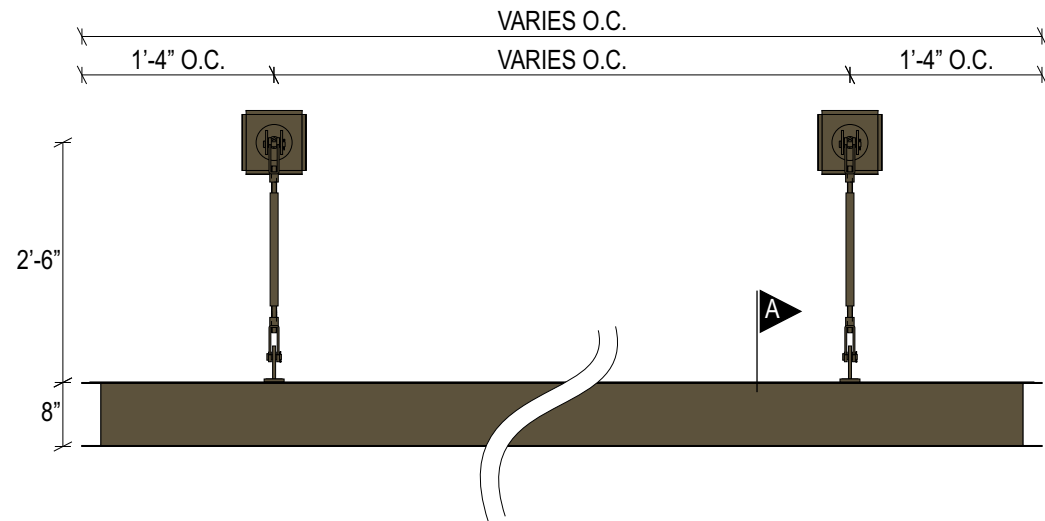

ALL TOP PANELS TO BE ATTACHED TO FRAME WITH #8 TEK SCREWS APPROXIMATELY 12" O.C.

NEW CANOPY 10'-8"

MATTHEWS MP 74155 SV SATIN DARK BRONZE

### NEW C-CANNEL CANOPY WITH DOWN LIGHTING

SCALE: 1/2" = 1'-0"

THIS IS AN ORIGINAL UNPUBLISHED DRAWING CREATED FOR YOUR PERSONAL USE IN CONNECTION WITH A PROJECT PLANNED FOR YOU BY NSMC. IT IS NOT TO BE SHOWN OUTSIDE YOUR ORGANIZATION NOR USED, REPRODUCED, COPIED OR EXHIBITED IN ANY FASHION UNLESS AUTHORIZED IN WRITING BY AN OFFICER OF NSMC



**Project:** Chick-Fil-A #4107 (Coors FSU)  
**Address:** Coors Blvd and Joseph Drive, Albuquerque, NM 87120  
**Phone:** \_\_\_\_\_ **Account Mgr.:** S. Rosenbloom  
**Designer:** Duffy, S. **Scale:** Noted **Date:** 01/24/2018

**Client Approval:** \_\_\_\_\_  
 \_\_\_\_\_  
**Date:** \_\_\_\_\_

This sign intended to be in accordance with the requirements of Article 600 of the National Electrical Code and/or other applicable local codes. This includes proper grounding and bonding of this sign.

**Revisions:**  
 11/14/18 SD Change monument to tenant panel only

**Drawing Number**  
**28207**  
 R1



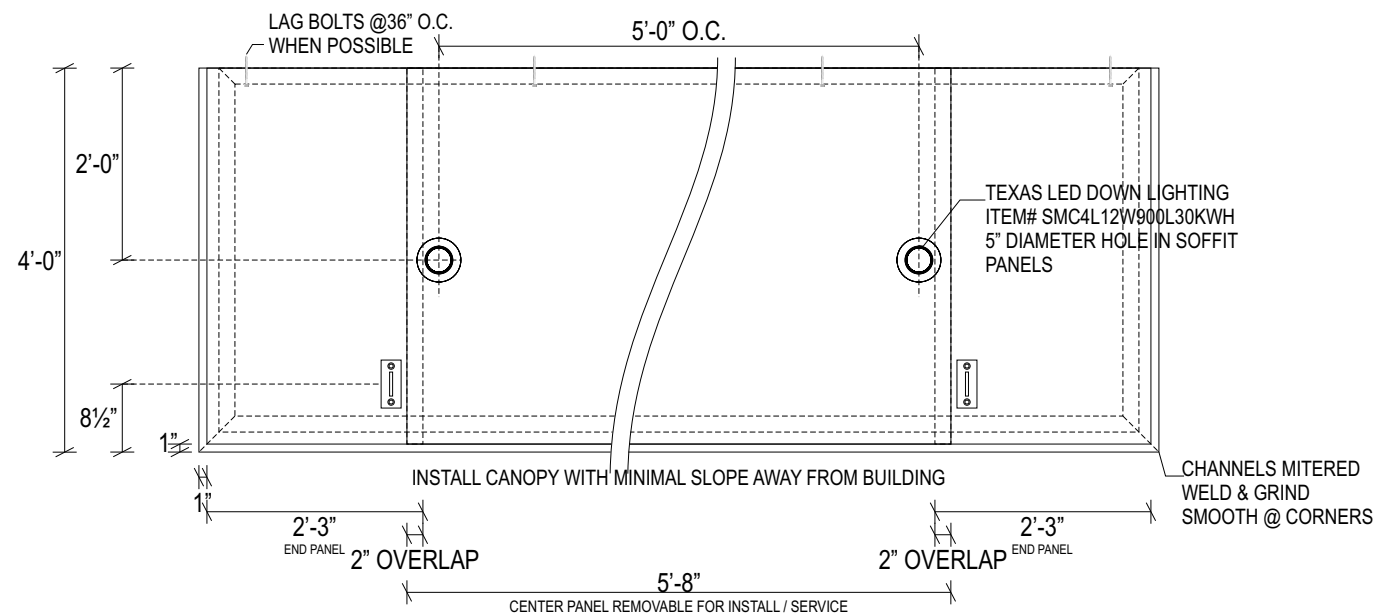
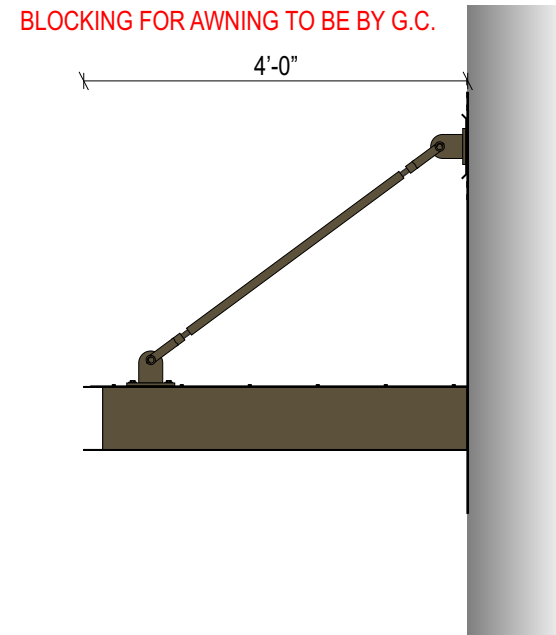
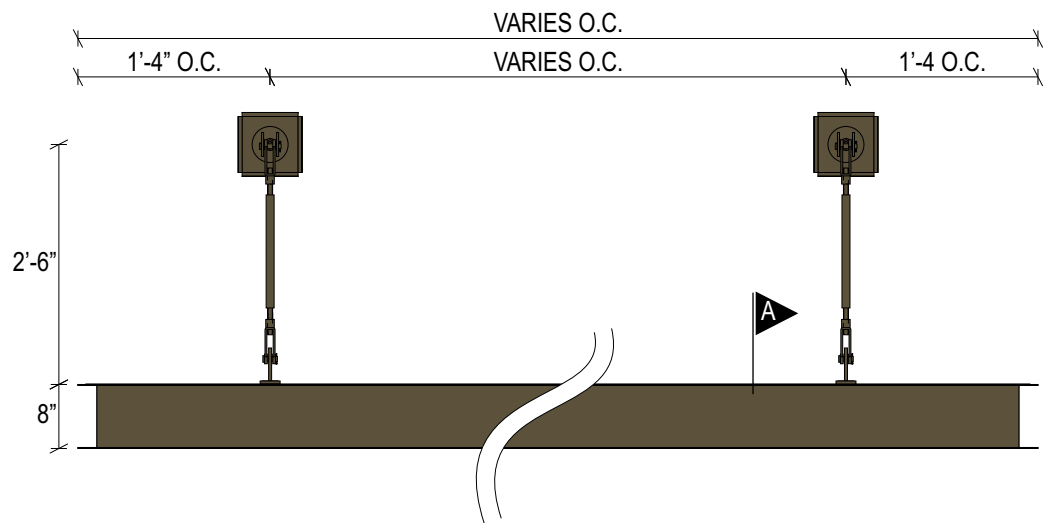

ALL TOP PANELS TO BE ATTACHED TO FRAME WITH #8 TEK SCREWS APPROXIMATELY 12" O.C.

- C1** NEW CANOPY 5'-0"
- C3** NEW CANOPY 7'-1"
- C4 C5 C6 C7** NEW CANOPY 7'-1" NON-ILLUMINATED

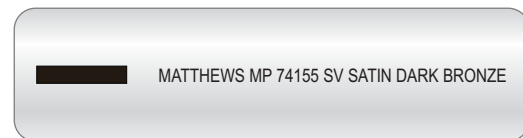

### NEW C-CHANNEL CANOPY WITH DOWN LIGHTING

SCALE: 1/2" = 1'-0"

THIS IS AN ORIGINAL UNPUBLISHED DRAWING CREATED FOR YOUR PERSONAL USE IN CONNECTION WITH A PROJECT PLANNED FOR YOU BY NSMC. IT IS NOT TO BE SHOWN OUTSIDE YOUR ORGANIZATION NOR USED, REPRODUCED, COPIED OR EXHIBITED IN ANY FASHION UNLESS AUTHORIZED IN WRITING BY AN OFFICER OF NSMC



**Project:** Chick-Fil-A #4107 (Coors FSU)  
**Address:** Coors Blvd and Joseph Drive, Albuquerque, NM 87120  
**Phone:** \_\_\_\_\_ **Account Mgr.:** S. Rosenbloom  
**Designer:** Duffy, S. **Scale:** Noted **Date:** 01/24/2018

**Client Approval:** \_\_\_\_\_  
 \_\_\_\_\_  
**Date:** \_\_\_\_\_

This sign intended to be in accordance with the requirements of Article 600 of the National Electrical Code and/or other applicable local codes. This includes proper grounding and bonding of this sign.

**Revisions:**  
 11/14/18 SD Change monument to tenant panel only

**Drawing Number**  
**28207**  
 R1



**INSTALL CANOPY W/ MINIMAL SLOPE AWAY FROM THE BUILDING**

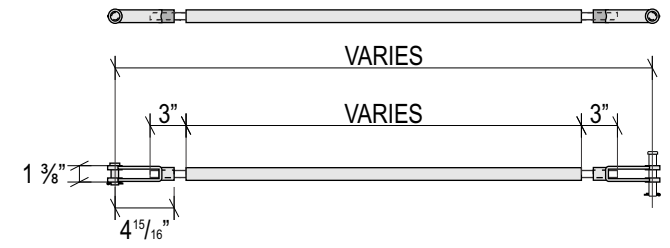
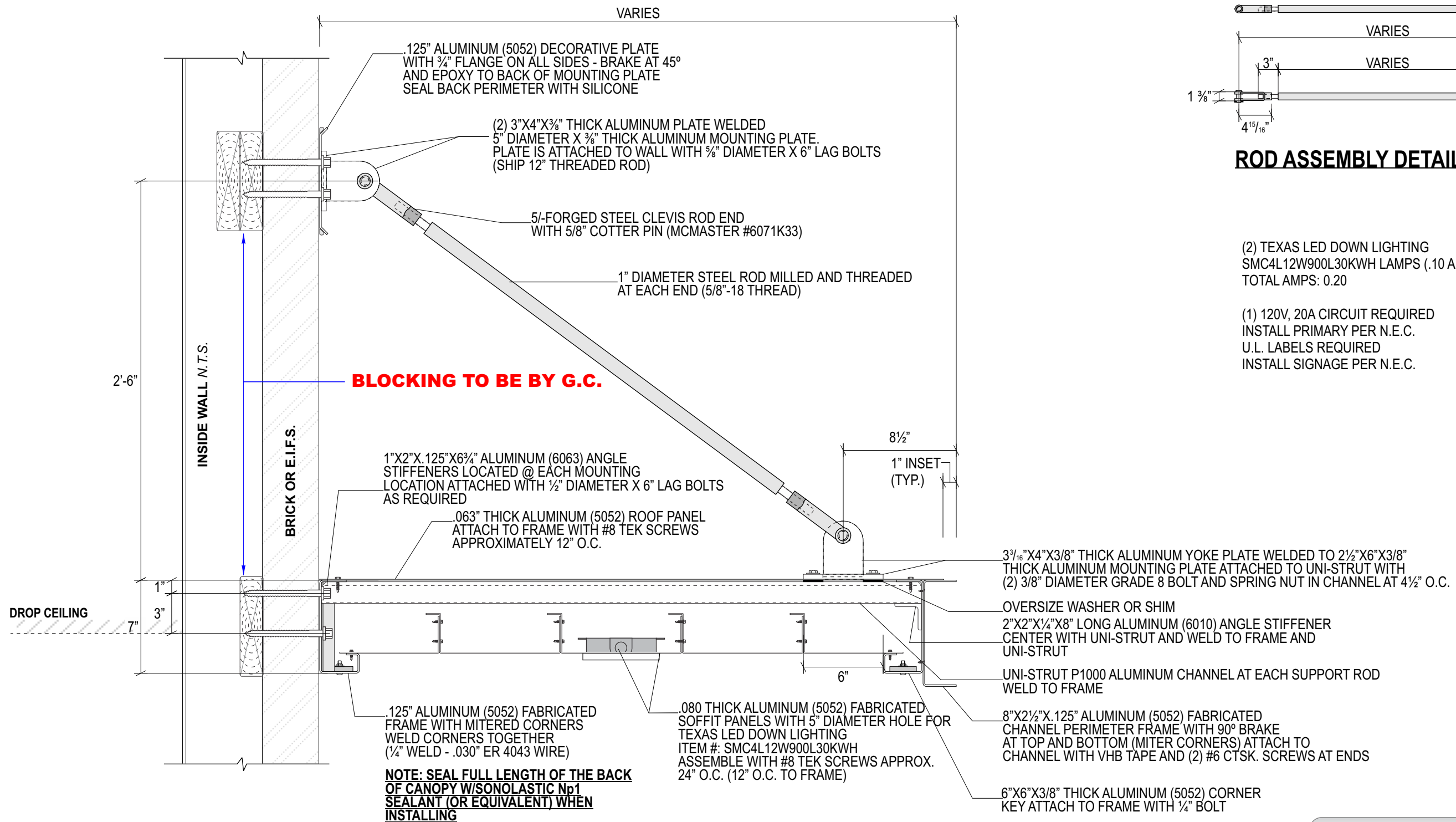

**ROD ASSEMBLY DETAIL** SCALE 3/4" = 1'-0"

(2) TEXAS LED DOWN LIGHTING  
SMC4L12W900L30KWH LAMPS (.10 AMPS EACH)  
TOTAL AMPS: 0.20

(1) 120V, 20A CIRCUIT REQUIRED  
INSTALL PRIMARY PER N.E.C.  
U.L. LABELS REQUIRED  
INSTALL SIGNAGE PER N.E.C.

**NEW C-CHANNEL CANOPY WITH DOWN LIGHTING**

SCALE: 1/2" = 1'-0"



THIS IS AN ORIGINAL UNPUBLISHED DRAWING CREATED FOR YOUR PERSONAL USE IN CONNECTION WITH A PROJECT PLANNED FOR YOU BY NSMC. IT IS NOT TO BE SHOWN OUTSIDE YOUR ORGANIZATION NOR USED, REPRODUCED, COPIED OR EXHIBITED IN ANY FASHION UNLESS AUTHORIZED IN WRITING BY AN OFFICER OF NSMC

**National Sign & MARKETING CORPORATION**  
13580 5th St., Chino, CA 91710  
Tel 909.591.4742 Fax 909.591.9792  
e-mail : sales @nsmc.com  
Lic# 745030 - Exp. 01/31/20

**Project:** Chick-Fil-A #4107 (Coors FSU)  
**Address:** Coors Blvd and Joseph Drive, Albuquerque, NM 87120  
**Phone:** \_\_\_\_\_ **Account Mgr.:** S. Rosenbloom  
**Designer:** Duffy, S. **Scale:** Noted **Date:** 01/24/2018

**Client Approval:** \_\_\_\_\_  
**Date:** \_\_\_\_\_

This sign intended to be in accordance with the requirements of Article 600 of the National Electrical Code and/or other applicable local codes. This includes proper grounding and bonding of this sign.

**Revisions:**

11/14/18 SD Change monument to tenant panel only

**Drawing Number**  
**28207**  
R1

**VSCO**  
ELECTRONIC SIGNS

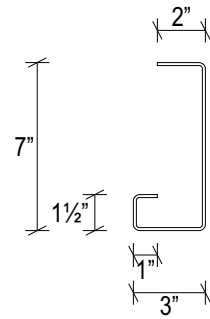

**FRAME DETAIL** SCALE: 1 1/2" = 1'-0"  
 .125" ALUM. (5052) FABRICATED FRAME

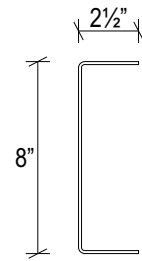

**CHANNEL DETAIL** SCALE: 1 1/2" = 1'-0"  
 .125" ALUM. (5052) FABRICATED CHANNEL PERIMETER FRAME

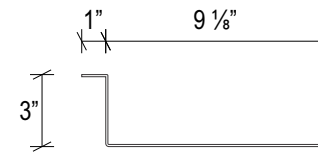

**SOFFIT PANEL DETAIL** SCALE: 1 1/2" = 1'-0"  
 .080" ALUM. (5052) FABRICATED SOFFIT PANEL

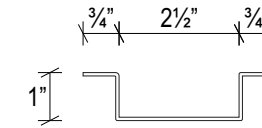

**DRIP CHANNEL DETAIL** SCALE: 3" = 1'-0"  
 .063" THICK ALUM. (5052) FABRICATED DRIP CHANNEL

**ALL BRAKES ARE 90° UNLESS OTHERWISE NOTED**

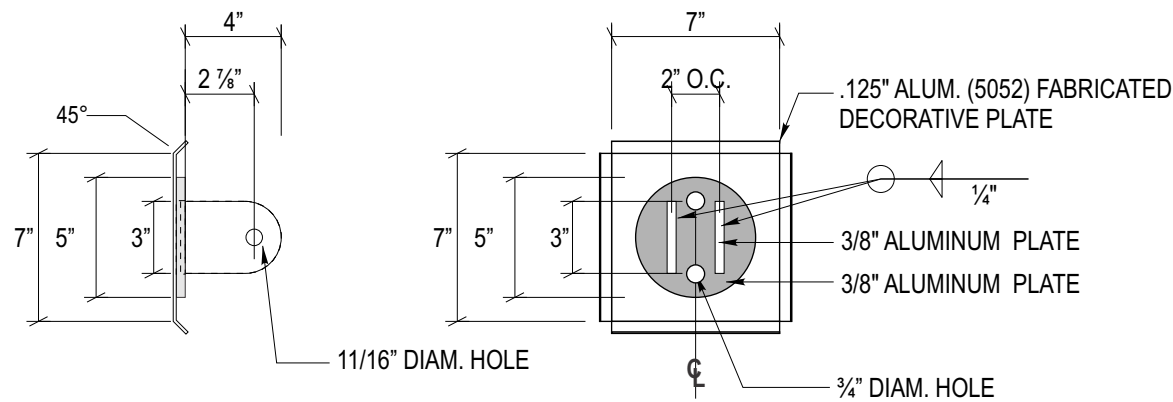

**WALL PLATE DETAIL** SCALE: 1 1/2" = 1'-0"

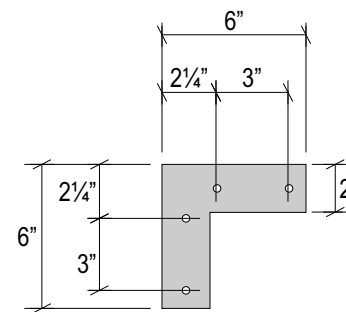

**CORNER KEY DETAIL** SCALE: 1 1/2" = 1'-0"  
 3/8" THICK ALUM. (5052) CORNER KEY  
 W/ 5/16" MOUNTING HOLES AS SHOWN

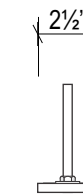

**CANOPY PLATE DETAIL** SCALE: 1 1/2" = 1'-0"

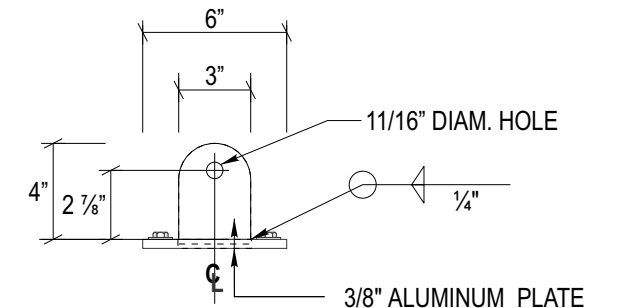
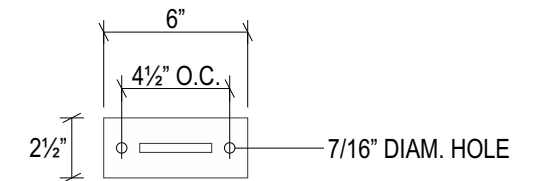

**NEW C-CHANNEL CANOPY PARTS**

SCALE: NOTED



THIS IS AN ORIGINAL UNPUBLISHED DRAWING CREATED FOR YOUR PERSONAL USE IN CONNECTION WITH A PROJECT PLANNED FOR YOU BY NSMC. IT IS NOT TO BE SHOWN OUTSIDE YOUR ORGANIZATION NOR USED, REPRODUCED, COPIED OR EXHIBITED IN ANY FASHION UNLESS AUTHORIZED IN WRITING BY AN OFFICER OF NSMC



**Project:** Chick-Fil-A #4107 (Coors FSU)  
**Address:** Coors Blvd and Joseph Drive, Albuquerque, NM 87120  
**Phone:** \_\_\_\_\_ **Account Mgr.:** S. Rosenbloom  
**Designer:** Duffy, S. **Scale:** Noted **Date:** 01/24/2018

**Client Approval:** \_\_\_\_\_  
 \_\_\_\_\_  
**Date:** \_\_\_\_\_

This sign intended to be in accordance with the requirements of Article 600 of the National Electrical Code and/or other applicable local codes. This includes proper grounding and bonding of this sign.

**Revisions:**  
 11/14/18 SD Change monument to tenant panel only

**Drawing Number**  
**28207**  
 R1

