

Specifications:

PANEL: .080 ALUMINUM PANELS WITH 1" RADIUS CORNERS, ATTACHED TO POLE WITH VHB. BACKS PAINTED MATTE BLACK.
 BACKGROUND: REFLECTIVE WHITE.
 COPY & GRAPHICS: TO BE REFLECTIVE PANTONE 186C, AND WHITE.
 POST: 2" X 2" ALUMINUM POLE PAINTED MATTE BLACK.
 FOOTING: CONCRETE FOOTING PER CITY REGULATIONS.

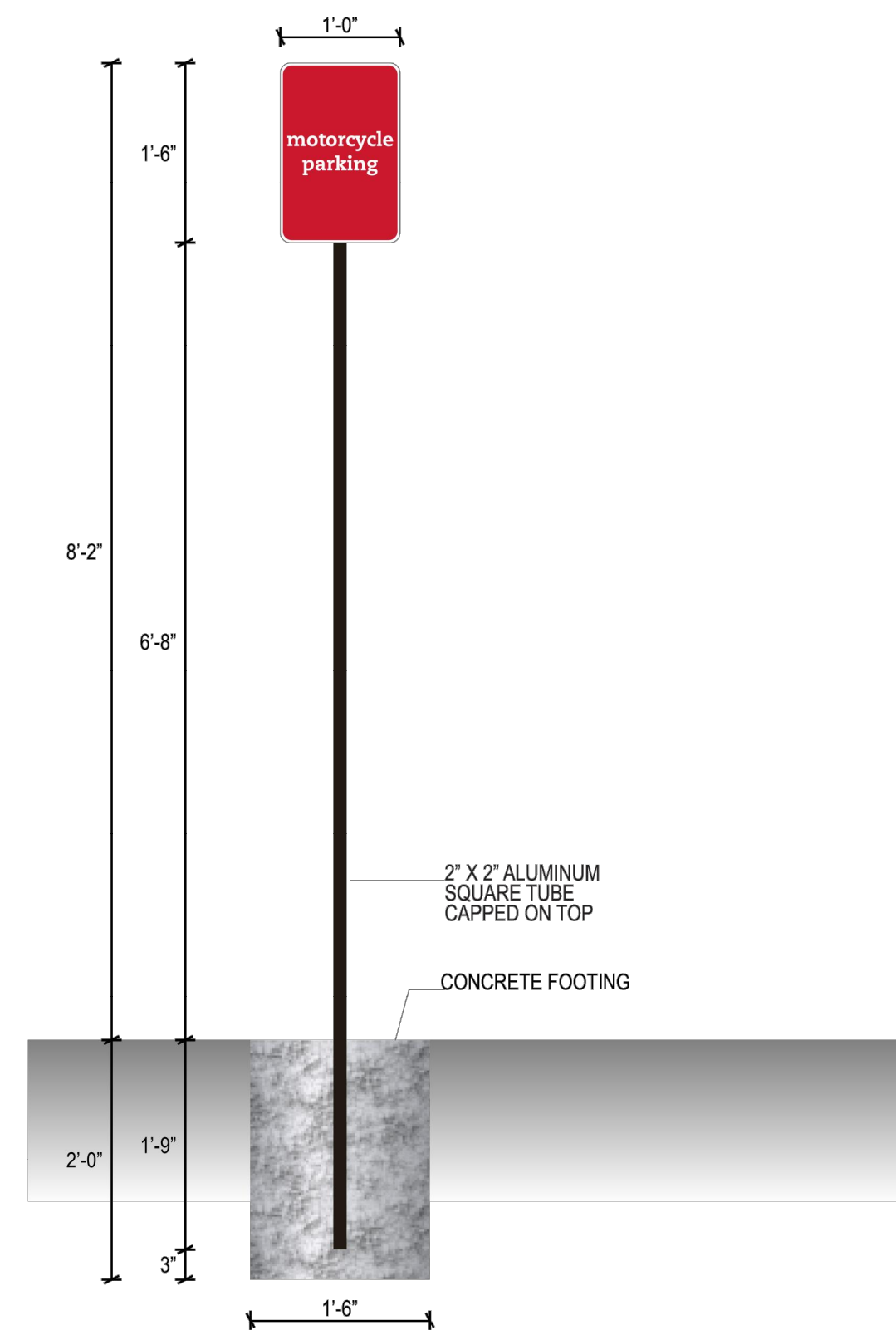
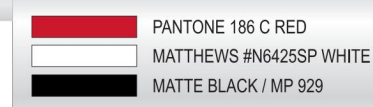

NEW MOTORCYCLE PARKING SIGN

NON-ILLUMINATED S/F CAUTION SIGN

SCALE: 3/4" = 1'

THIS IS AN ORIGINAL UNPUBLISHED DRAWING CREATED FOR YOUR PERSONAL USE IN CONNECTION WITH A PROJECT PLANNED FOR YOU BY NSMC. IT IS NOT TO BE SHOWN OUTSIDE YOUR ORGANIZATION NOR USED, REPRODUCED, COPIED OR EXHIBITED IN ANY FASHION UNLESS AUTHORIZED IN WRITING BY AN OFFICER OF NSMC.

National Sign & Marketing Corporation
 13580 5th St., Chino, CA 91710
 Tel 909.591.4742 Fax 909.591.9792
 e-mail: sales@nsmc.com
 Lic# 745030 - Exp. 01/31/18

Project: Chick-Fil-A # 3498
 Address: 1400 Gibson Blvd. SE, Albuquerque, NM 87106
 Phone: Account Mgr. S. Rosenbloom
 Designer: Duffy, S. Scale: Noted Date: 09/19/2017

Client Approval: _____
 Date: _____

This sign intended to be in accordance with the requirements of Article 600 of the National Electrical Code and/or other applicable local codes. This includes proper grounding and bonding of this sign.

Revisions: _____
 Drawing Number: 27742



Specifications:

CABINETS: FABRICATED .080 ALUMINUM 8" DEEP, WITH ALUMINUM ANGLE FRAME CABINET PAINTED DARK BRONZE.
 FACES: WHITE #7328 ACRYLIC WITH APPLIED FIRST SURFACE 3M RED #3632-53 TRANSLUCENT VINYL. RETAINERS TO BE 1".
 POST: 4"x4" SQUARE STEEL TUBE WITH MATCH PLATE POLE PAINTED MATTE BLACK.
 ILLUMINATION: WHITE LED.
 SWITCH: ELECTRICAL TOGGLE DISCONNECT SWITCH WITH BOOT.
 NOTE: TRY TO KEEP DIRECTIONALS 5'-0" FROM CURBS WHEREVER POSSIBLE TO INSURE VEHICLES WILL NOT HIT THEM.
 ALL COMPONENTS TO BE U.L. APPROVED



NEW D/F ILLUM. DIRECTIONAL SIGN

NEW D/F ILLUM. DIRECTIONAL SIGN

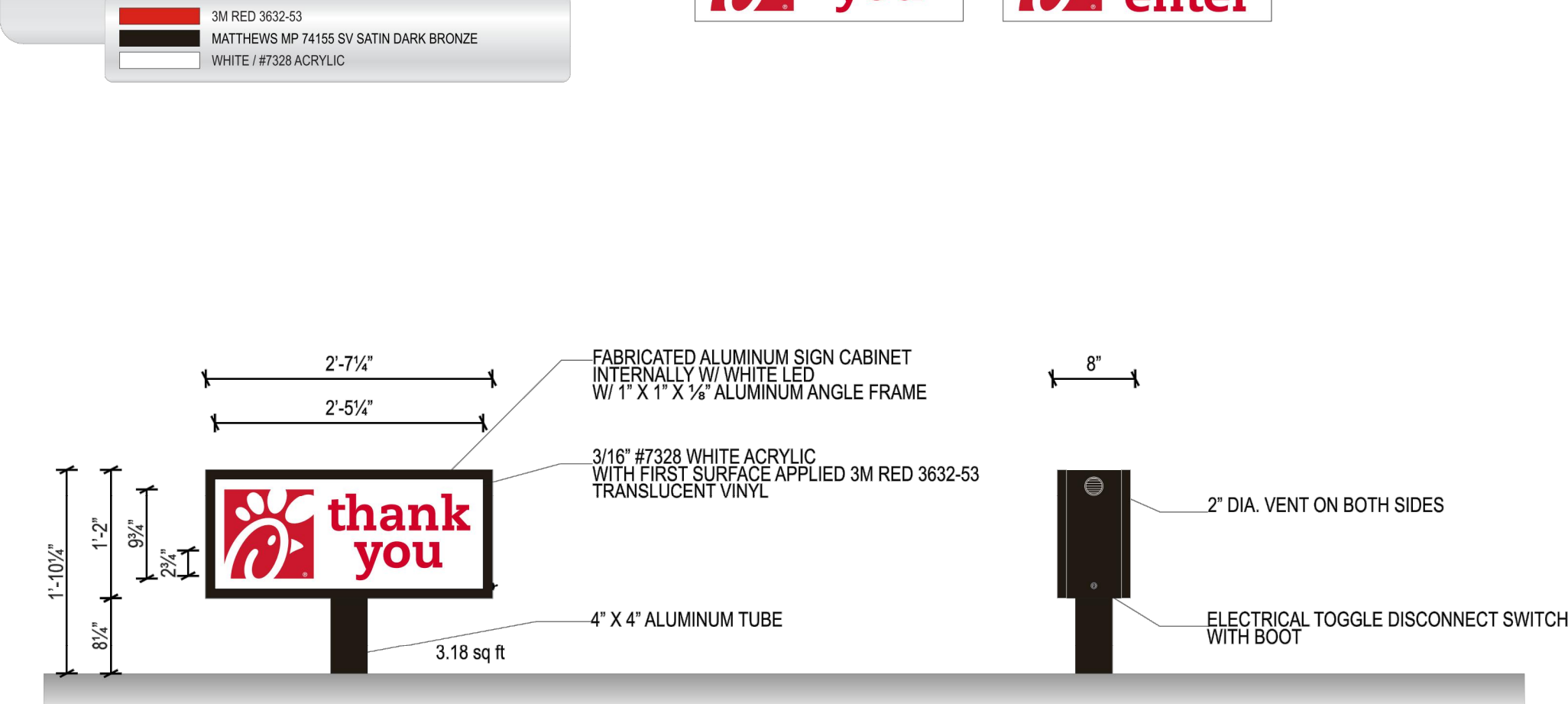

CHICK-FIL-A - NEW D/F ILLUMINATED DIRECTIONAL SIGNS

SCALE: 3/4" = 1'-0"

THIS IS AN ORIGINAL UNPUBLISHED DRAWING CREATED FOR YOUR PERSONAL USE IN CONNECTION WITH A PROJECT PLANNED FOR YOU BY NSMC. IT IS NOT TO BE SHOWN OUTSIDE YOUR ORGANIZATION NOR USED, REPRODUCED, COPIED OR EXHIBITED IN ANY FASHION UNLESS AUTHORIZED IN WRITING BY AN OFFICER OF NSMC.

National Sign & Marketing Corporation
 13580 5th St., Chino, CA 91710
 Tel 909.591.4742 Fax 909.591.9792
 e-mail: sales@nsmc.com
 Lic# 745030 - Exp. 01/31/20

Project: Chick-Fil-A #4107 (Coors FSU)
 Address: Coors Blvd and Joseph Drive, Albuquerque, NM 87120
 Phone: Account Mgr. S. Rosenbloom
 Designer: Duffy, S. Scale: Noted Date: 01/24/2018

Client Approval: _____
 Date: _____

This sign intended to be in accordance with the requirements of Article 600 of the National Electrical Code and/or other applicable local codes. This includes proper grounding and bonding of this sign.

Revisions: _____
 Drawing Number: 28207 R1



New Mexico One Call, Inc.
NMOC
 CALL NMOC BEFORE YOU DIG
 TWO WORKING DAYS
 1-888-NM-GAS-CO
 NM811
 Professional Resources for Damage Prevention

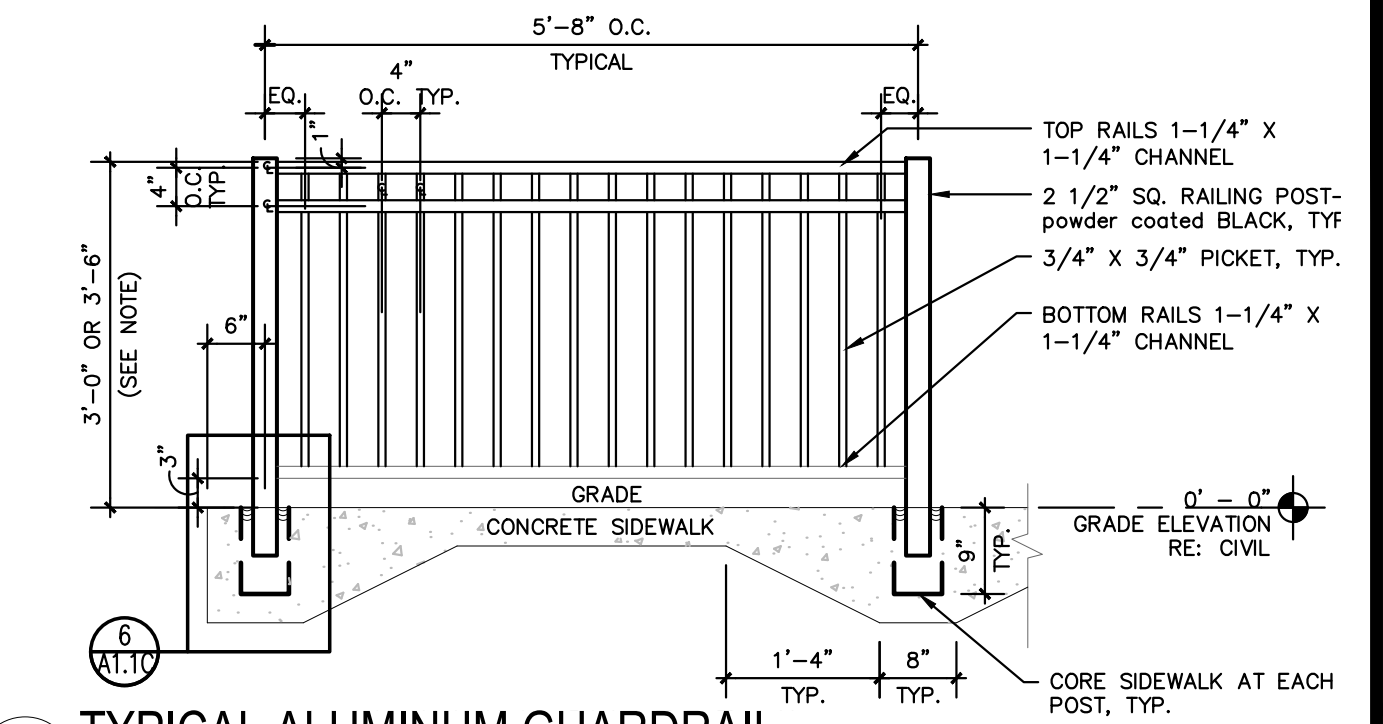

TYPICAL ALUMINUM GUARDRAIL

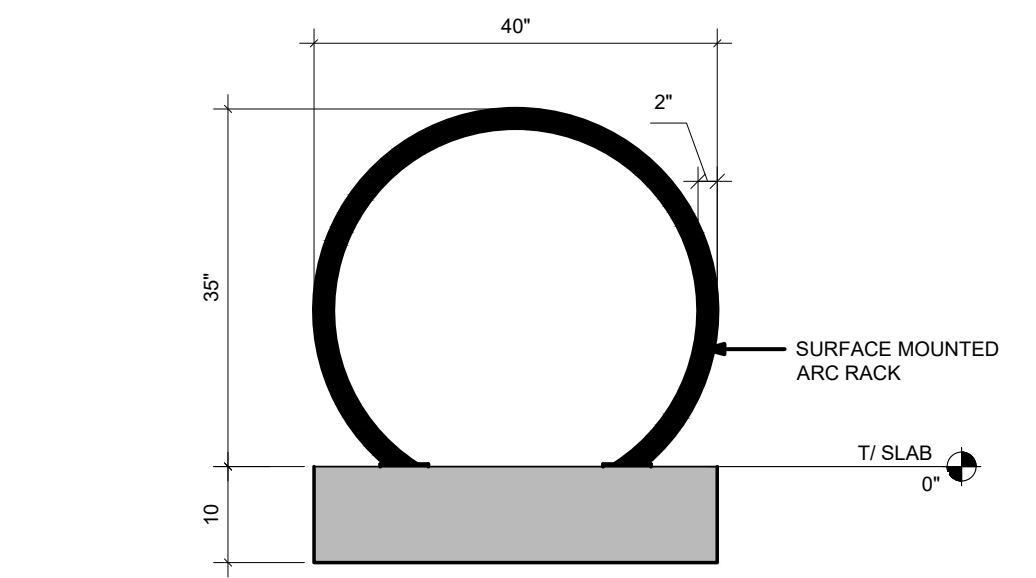

BIKE RACK DETAIL

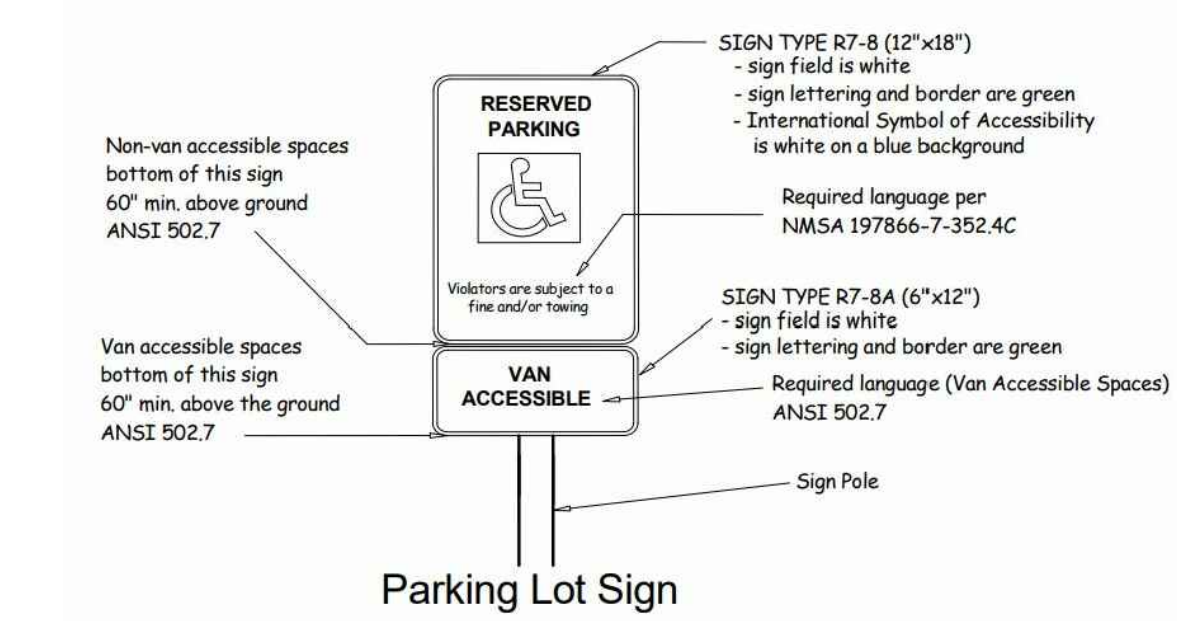

Parking Lot Sign
 * PARKING SIGN FOR REFERENCE ONLY, FORMAL DETAIL TO BE PROVIDED WITH CONSTRUCTION DOCUMENTS

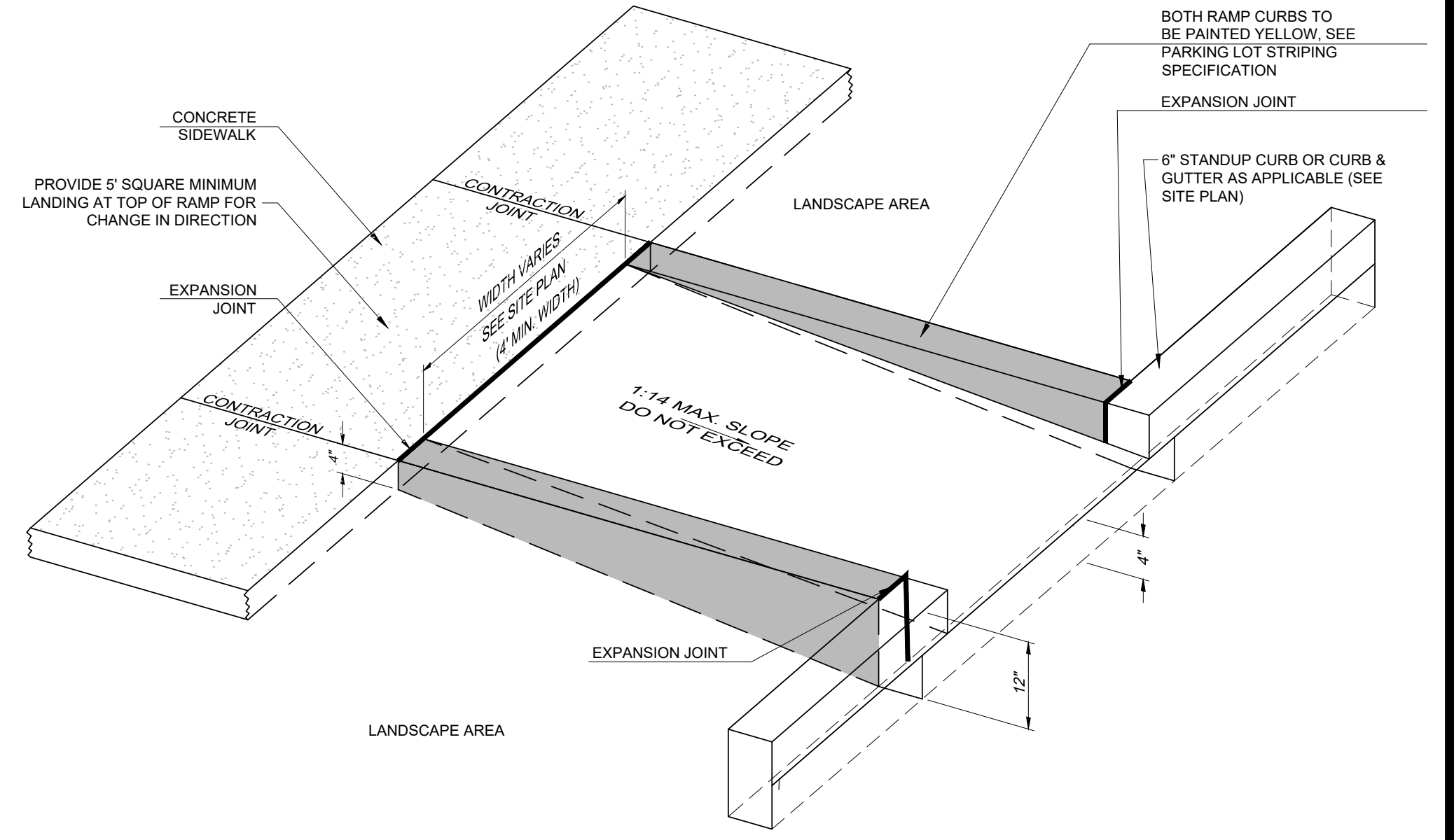

RETURNED CURB ACCESSIBLE RAMP

NOT TO SCALE

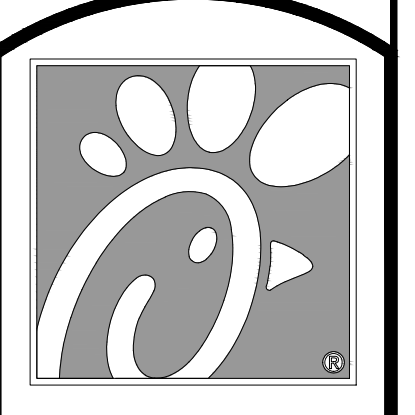

Chick-fil-A
 5200 Buffington Rd.
 Atlanta, Georgia
 30349-2998

Revisions:	Mark	Date	By
△			
△			
△			

Seal

MERRICK
 5970 GREENWOOD PLAZA BLVD
 GREENWOOD VILLAGE, CO 80111
 303-751-0741

STORE
 CHICK-FIL-A
 FSU #04107
 COORS BLVD.
 4001 COORS BLVD NW
 ALBUQUERQUE, NM
 87120

SHEET TITLE

DETAILS

DWG EDITION

Job No. : 65119594
 Store : 04107
 Date : 8/1/19
 Drawn By : LV
 Checked By : KW

Sheet
8