

KEYED NOTES

- (A) INSTALL 8" C-900 CL 150 WATER LINE
- (B) INSTALL 1-2" WATER METER
- (C) INSTALL 8" SDR-35 PVC SEWER LINE
- (D) INSTALL 1 - 8" SANITARY SEWER WYE WITH SINGLE CLEANOUT
- (E) INSTALL 4' SAS MANHOLE PER NMAPWA STD. DWG. 2101
- (F) INSTALL 1 - 12" x 6" HDPE TEE WITH SINGLE CLEANOUT
- (G) INSTALL 4' SD MANHOLE PER NMAPWA STD. DWG. 2101
- (H) INSTALL TRIPLE GRATE TYPE C STORM INLET PER NMAPWA STD. DWG. 2205
- (J) INSTALL DOUBLE GRATE TYPE D STORM INLET PER NMAPWA STD. DWG. 2206

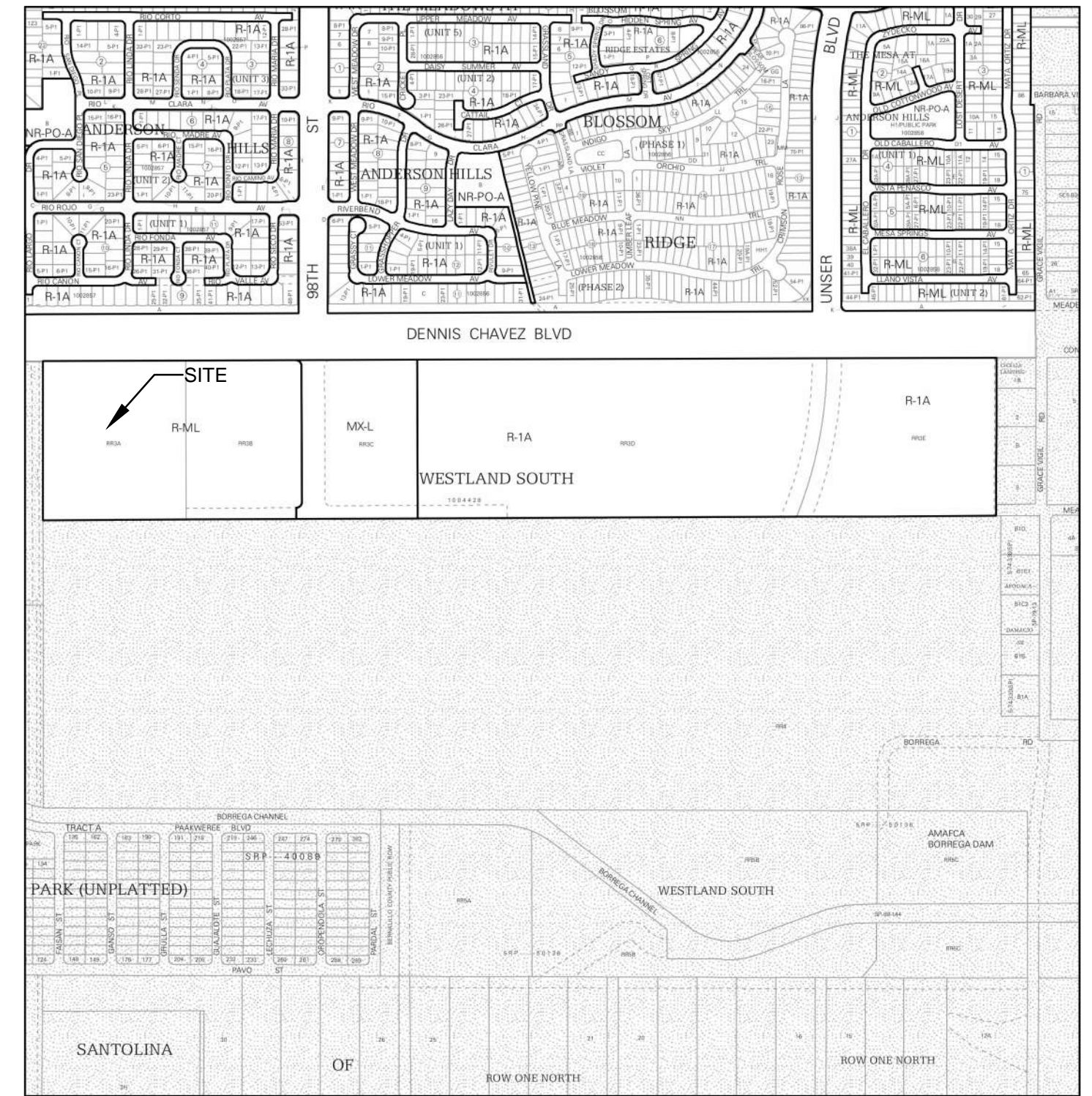

For more details about the Integrated Development Ordinance visit: <http://www.cabq.gov/planning/codes-policies-regulations/integrated-development-ordinance>

IDO Zone Atlas May 2018

AGIS

IDO Zoning information as of May 17, 2018. The Zone Districts and Overlay Zones are established by the Integrated Development Ordinance (IDO).

Zone Atlas Page: P-09-Z

- Escarpment
- Petatehugh National Monument
- Areas Outside of City Limits
- Historic Protection Overlay (HPO) Zone
- View Protection Overlay (VPO) Zone
- Character Protection Overlay (CPO) Zone
- Airport Protection Overlay (APO) Zone

Scale: 0 250 500 1,000 Feet

GENERAL NOTES

1. PRIOR TO ANY CONSTRUCTION, THE CONTRACTOR SHALL EXCAVATE AND VERIFY THE LOCATION OF ALL POTENTIAL OBSTRUCTIONS. SHOULD A CONFLICT EXIST, THE CONTRACTOR SHALL NOTIFY THE ENGINEER AS SOON AS POSSIBLE TO RESOLVE THE CONFLICT WITH A MINIMUM AMOUNT OF DELAY.
2. ALL WORK ON THIS PLAN SHALL BE PERFORMED IN ACCORDANCE WITH APPLICABLE FEDERAL, STATE AND LOCAL LAWS, RULES AND REGULATIONS CONCERNING CONSTRUCTION SAFETY AND HEALTH.
3. IF ANY UTILITY LINES, PIPELINES, OR UNDERGROUND UTILITY LINES ARE SHOWN ON THESE DRAWINGS, THEY ARE SHOWN IN AN APPROXIMATE LOCATION ONLY, AND LINES MAY EXIST WHERE NONE ARE SHOWN. THE LOCATION IS BASED UPON INFORMATION PROVIDED BY THE UTILITY OWNER OR FROM EXISTING PLANS, AND THIS INFORMATION MAY BE INCOMPLETE, OR OBSOLETE AT THE TIME OF CONSTRUCTION. THE ENGINEER HAS NOT UNDERTAKEN ANY FIELD VERIFICATION OF THESE LOCATIONS. LINE SIZES OR MATERIAL TYPE, MAKES NO REPRESENTATION THEREOF, AND ASSUMES NO RESPONSIBILITY OR LIABILITY THEREFOR. THE CONTRACTOR SHALL INFORM ITSELF OF THE LOCATION OF ANY UTILITY LINE, PIPELINE OR UNDERGROUND INSTALLATION IN OR NEAR THE AREA IN ADVANCE OF AND DURING ANY EXCAVATION WORK. THE CONTRACTOR IS FULLY RESPONSIBLE FOR ANY AND ALL DAMAGES CAUSED BY ITS FAILURE TO LOCATE, IDENTIFY AND PRESERVE ANY AND ALL EXISTING UTILITIES, PIPELINES AND UNDERGROUND FACILITIES. IN PLANNING AND CONDUCTING EXCAVATIONS, THE CONTRACTOR SHALL COMPLY WITH ALL STATE STATUTES, MUNICIPAL AND LOCAL ORDINANCES, RULES AND REGULATIONS, IF ANY, PERTAINING TO THE LOCATION OF THESE LINES AND FACILITIES.
4. THE CONTRACTOR SHALL INSURE THAT NO SOIL ERODES FROM THE SITE INTO PUBLIC RIGHT-OF-WAY OR ONTO PRIVATE PROPERTY. THIS CAN BE ACHIEVED BY CONSTRUCTING TEMPORARY BERMS AND BY WETTING THE SOIL TO KEEP IT FROM BLOWING.
5. THE CONTRACTOR SHALL OBTAIN ANY AND ALL PERMITS REQUIRED BY CITY OF ALBUQUERQUE FOR THE COMPLETION OF THE WORK PRIOR TO BEGINNING CONSTRUCTION.

LANDS OF WESTLAND DEVELOPMENT CO., INC "SOUTH TRACT" (2-10-77, 8-76-03865)

ATRISCO HERITAGE ACADEMY HIGH SCHOOL

PRV STATION TO 2WR ZONE

PER ATRISCO HERITAGE ACADEMY H.S. PLANS, DATED 8/20/98, THE ALLOWABLE DISCHARGE FROM THE AFS SITE IS: 25 CFS (2100) AND VOLUME-33,600 CUFT

TRACT RR-4 WESTLAND SOUTH (04-25-91, BK. 91-7, PG. 830-831)

HUITT-ZOLIARS
333 Rio Rancho Drive NE, Ste. 101
Rio Rancho, NM 87124
505-892-5141
www.huilt-zollars.com

SEAL

PROJECT

CEJA VISTA
10 001 CEJA VISTA ROAD SW
ALBUQUERQUE, NM 87121

40%
CONSTRUCTION
DOCUMENTS

REVISIONS

DRAWN BY NV
REVIEWED BY SE
DATE 09/18/2019
PROJECT NO 19-0019

DRAWING NAME
Utility Plan

SHEET NO
C106

Project: 9182019-0-24-09 P&I, R, V&A, N&A
 Hydro: 911002-01 - Ceja Vista Apartment Complex 10 CADDS & BIM V01 - AutoCAD/CEJA VISTA GRADING PLAN.dwg
 User: Served/10/2019 8:02:27 AM