

**PARKING CALCULATIONS**  
PER W/REGULATED DEVELOPMENT ORDINANCE  
PART 14-10-5 TABLE 5-5-1

**GROSS BUILDING AREA - SITE PLAN**

GROSS CONDITIONED BUILDING AREA	8366 SF
PATIO AREA	1288 SF
TOTAL GROSS AREA	9654 SF

TOTAL REQUIRED PARKING SPACES	49
TOTAL REQUIRED ACCESSIBLE PARKING SPACES	3
TOTAL REQUIRED ACCESSIBLE VAN SPACES	1
TOTAL REQUIRED BICYCLE SPACES	5
TOTAL REQUIRED MOTORCYCLE SPACES	2

\*\*\*\*\*EXISTING SHARED PARKING TO REMAIN\*\*\*\*\*

TOTAL AVAILABLE PARKING SPACES	273
TOTAL AVAILABLE ACCESSIBLE PARKING SPACES	8
TOTAL AVAILABLE ACCESSIBLE VAN SPACES	5
TOTAL AVAILABLE BICYCLE SPACES	PER LANDLORD
TOTAL AVAILABLE MOTORCYCLE SPACES	PER LANDLORD

**Coronado Parking Analysis**

GLA Data	Existing GLA	Demo / Decommission	Proposed GLA	Total GLA
DEVELOPER AFFILIATE ANCHOR	77,645			77,645
JCPENNEY	135,134			135,134
MACY'S	146,000			146,000
KOHL'S	118,272			118,272
GORDMANS	52,650			52,650
DICKS SPORTING GOODS	47,703			47,703
Outparcels	33,251			33,251
Developer Mall Stores & Storage	467,343			467,343
<b>Grand Total</b>	<b>1,077,998</b>			<b>1,077,998</b>

<b>Parking Data</b>	
Existing Parking	5,377
Existing Parking Ratio	4.99
Stall (+ Surplus / - Deficit) @ 4.50 Ratio (REA)	526

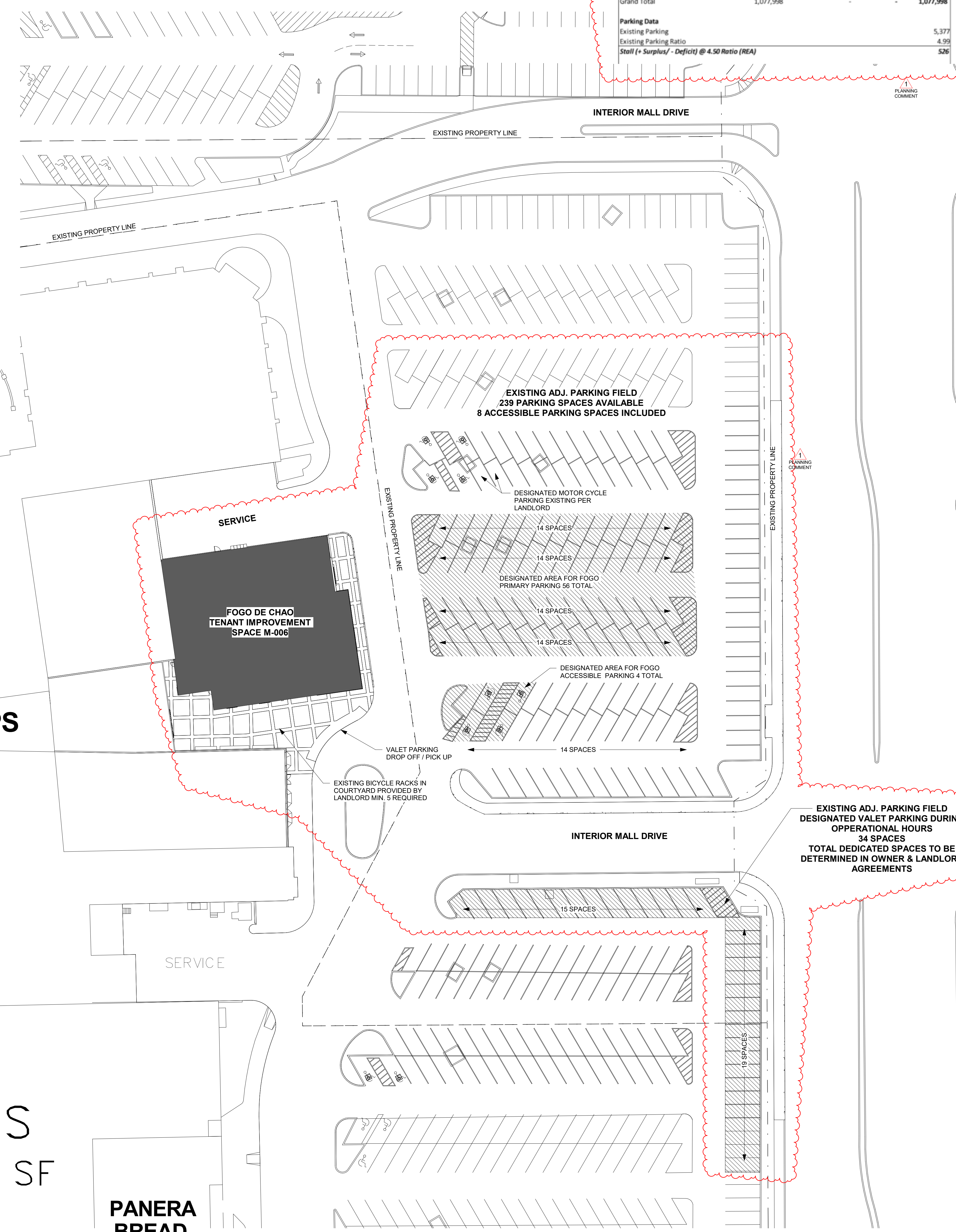
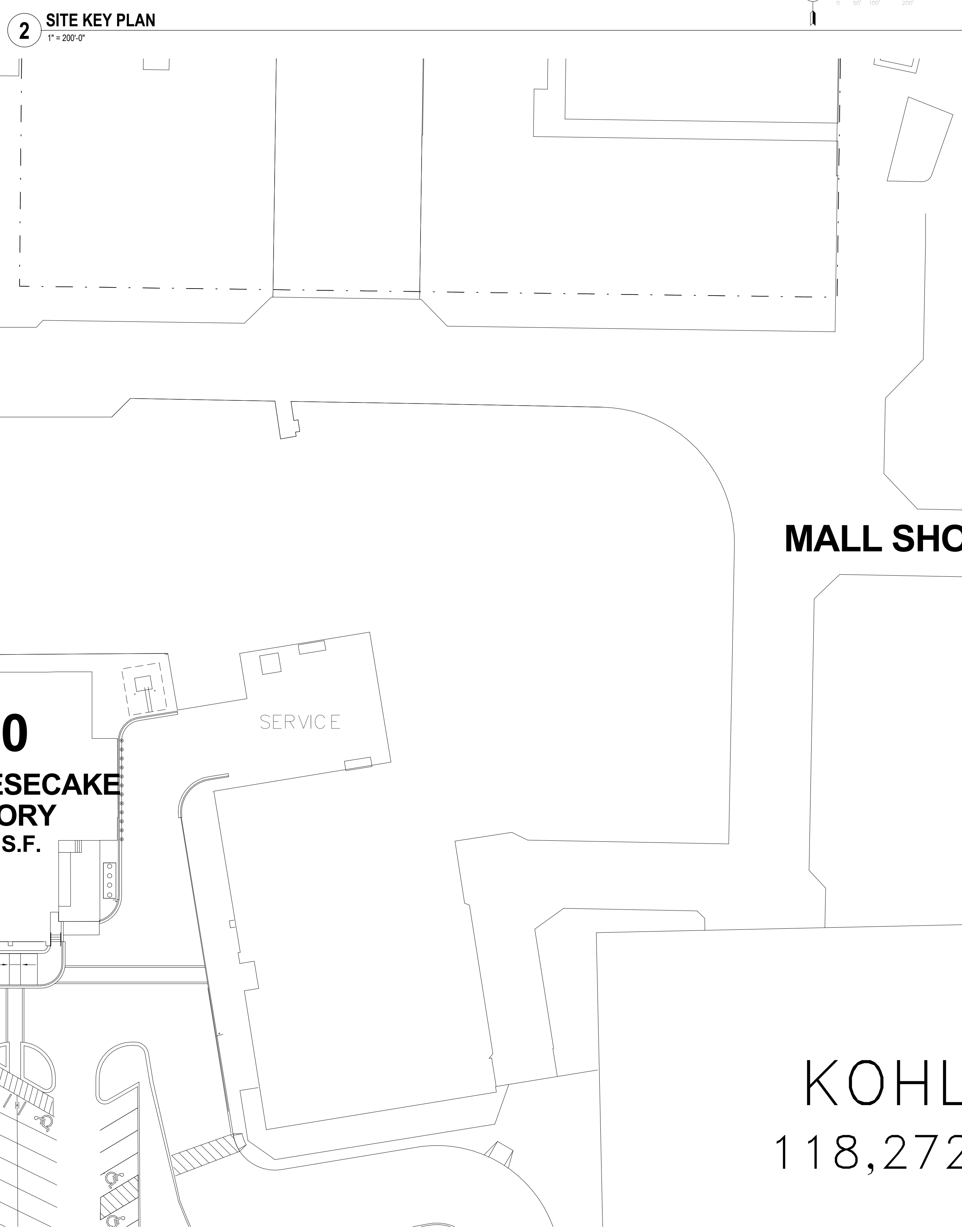
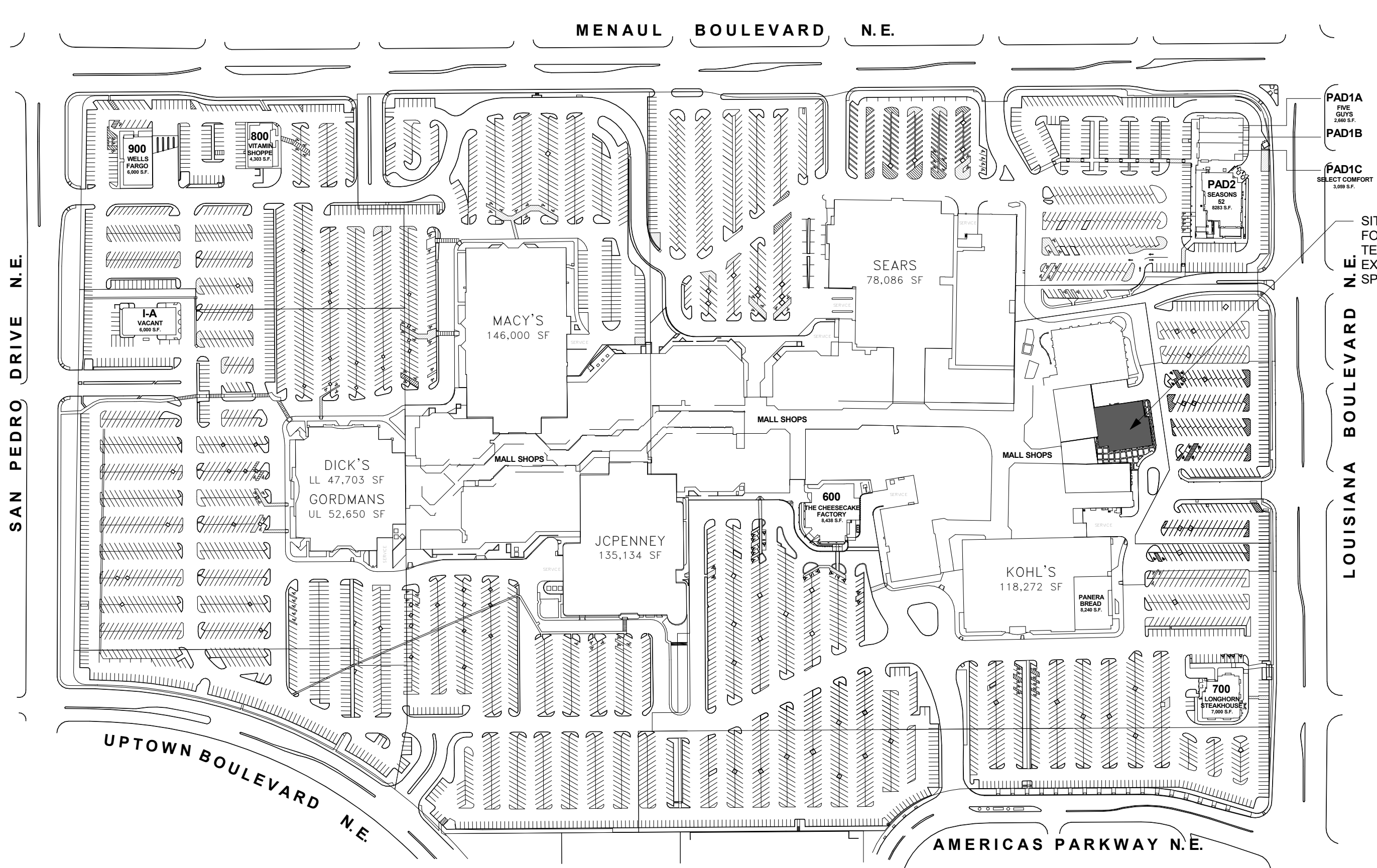

City of Albuquerque Electronic Stamp:

Design Consultant:  
**INNOVATION & DESIGN IN ARCHITECTURE, Inc.**  
218 The Promenade North  
Long Beach, CA 90802  
www.idexperience.com

Architect:  
**GEOFFREY B. LIM**  
AIA, NCARB, LEED AP

Engineering Consultant:

Stamp:  
STATE OF NEW MEXICO  
GEOFFREY B. LIM  
NO. 30698

Project Owner:  
**FOGO DE CHÃO**  
BRAZILIAN STEAKHOUSE

5908 HEADQUARTERS DRIVE  
SUITE K200  
PLANO, TX 75024

TENANT IMPROVEMENT  
Project Address:  
**FOGO - ALBUQUERQUE, NM**  
CORONADO CENTER, 6600 MENAUL BLVD.,  
SPACE M006  
ALBUQUERQUE, NM 87110

Issue For:  
PERMIT  
Issue Date:  
02/21/2020

Revisions:  
NO. REASON DATE  
1 PLANNING COMMENTS 06/30/20

Principal in Charge:  
JOSH COOL  
Project Manager:  
WESLEY STEPHENS  
Drawn By:  
WESLEY STEPHENS

Project Number:  
140-012-19  
Sheet Title:  
SITE PLAN

Sheet Number:  
PD-1

**LOUISIANA BOULEVARD N.E.**

