

CITY OF ALBUQUERQUE
15% CONSTRUCTION PLANS

NORTH FOURTH STREET
REDEVELOPMENT STUDY

MOUNTAIN RD. TO CAMINO ESPANOL
COA Project 5878.91

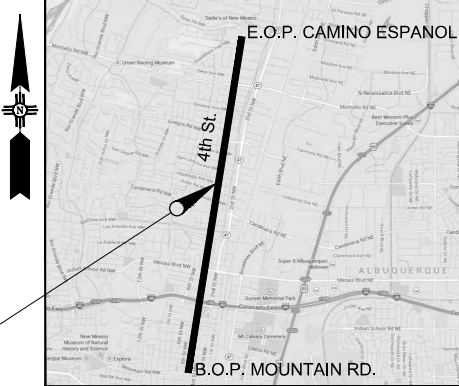

PROJECT LOCATION

VICINITY MAP
Zone Atlas Maps E thru J-14-Z

**PRELIMINARY
NOT FOR CONSTRUCTION
SUBMITTED NOVEMBER 26, 2014**

SHEET NO.	DESCRIPTION	GROUP
1	TITLE SHEET	GENERAL INFORMATION
2 TO 3	EXISTING TYPICAL SECTIONS	TYPICAL SECTIONS
4 TO 7	PROPOSED TYPICAL SECTIONS	
8	PLAN SHEET - B.O.P. TO STA. 7+00.00	ROADWAY PLANS
9	PLAN SHEET - STA. 7+00.00 TO STA. 17+00.00	
10	PLAN SHEET - STA. 17+00.00 TO STA. 27+00.00	
11	PLAN SHEET - STA. 27+00.00 TO STA. 37+00.00	
12	PLAN SHEET - STA. 37+00.00 TO STA. 47+00.00	
13	PLAN SHEET - STA. 47+00.00 TO STA. 57+00.00	
14	PLAN SHEET - STA. 57+00.00 TO STA. 67+00.00	
15	PLAN SHEET - STA. 67+00.00 TO STA. 77+00.00	
16	PLAN SHEET - STA. 77+00.00 TO STA. 87+00.00	
17	PLAN SHEET - STA. 87+00.00 TO STA. 97+00.00	
18	PLAN SHEET - STA. 97+00.00 TO STA. 107+00.00	
19	PLAN SHEET - STA. 107+00.00 TO STA. 117+00.00	
20	PLAN SHEET - STA. 117+00.00 TO STA. 127+00.00	
21	PLAN SHEET - STA. 127+00.00 TO STA. 137+00.00	
22	PLAN SHEET - STA. 137+00.00 TO STA. 147+00.00	
23	PLAN SHEET - STA. 147+00.00 TO STA. 157+00.00	
24	PLAN SHEET - STA. 157+00.00 TO STA. 167+00.00	
25	PLAN SHEET - STA. 167+00.00 TO STA. 177+00.00	
26	PLAN SHEET - STA. 177+00.00 TO STA. 187+00.00	
27	PLAN SHEET - STA. 187+00.00 TO STA. 197+00.00	
28	PLAN SHEET - STA. 197+00.00 TO E.O.P.	
TOTAL = 28		



**PARSONS
BRINCKERHOFF**

REV.	SHEETS	CITY ENGINEER	DATE	USER DEPARTMENT	DATE	USER DEPARTMENT	DATE
ENGINEERS STAMP & SIGNATURE		APPROVALS		ENGINEER		DATE	
		DRC Chairman				APPROVED FOR CONSTRUCTION	
		Transportation					
		ABC/MIA					
		Hydrology					
		Parks					
		Constr. Coord.				City Engineer Date	
		Traffic Eng.					
		Transit					
		AMAFCA				SHEET 1 of 28	
		PROJECT NO.	5878.91				

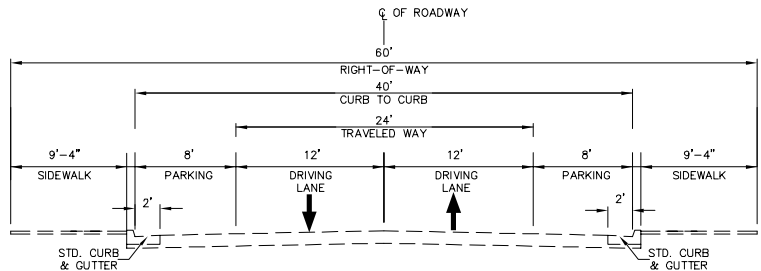

EXISTING TYPICAL SECTION
MOUNTAIN RD. TO I-40

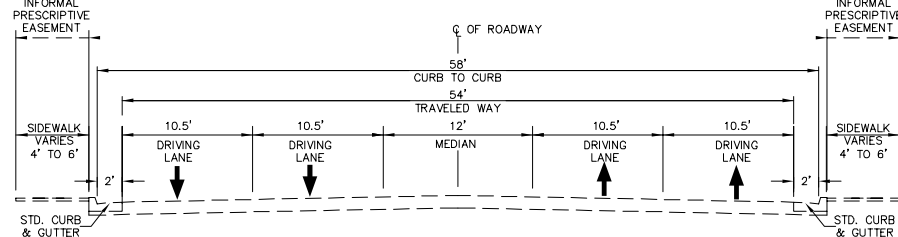

EXISTING TYPICAL SECTION
I-40 TO WOODLAND AVE.
HUDSON AVE. TO HEADINGLY AVE.

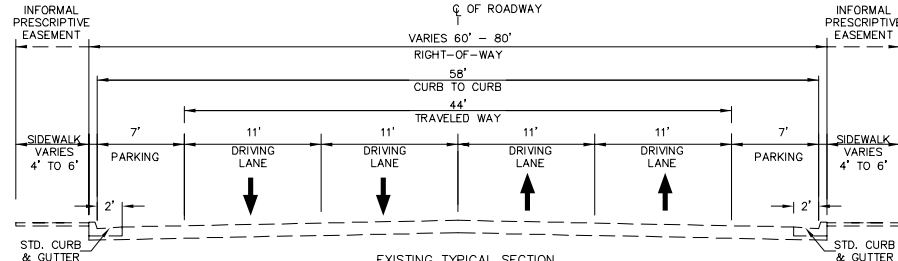

EXISTING TYPICAL SECTION
WOODLAND AVE. TO HUDSON AVE.
HEADINGLY AVE. TO GRIEGOS RD.

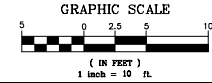

PARSONS BRINCKERHOFF

CITY OF ALBUQUERQUE
DEPARTMENT OF MUNICIPAL DEVELOPMENT
TRANSPORTATION DIVISION
NORTH FOURTH STREET REDEVELOPMENT STUDY
MOUNTAIN RD. TO CAMINO ESPANOL
EXISTING TYPICAL SECTIONS

DESIGN REVIEW COMMITTEE	CITY ENGINEER APPROVAL	MO./DAY/YR.	MO./DAY/YR.

City Project No. COA 5878.91 Zone Map No. Sheet 2 of 28

AS BUILT INFORMATION

CONTRACTOR	NO.
DESIGNED BY	DATE
ACCEPTED BY	DATE
REVISION BY	DATE
RECORDED BY	DATE
MICRO-FILM INFORMATION	DATE

BENCH MARKS

ENGINEER'S SEAL SURVEY INFORMATION FIELD NOTES

NO.	DATE

PRELIMINARY
NOT FOR CONSTRUCTION

REMARKS	BY	DATE
DESIGN		11/24/14
		11/24/14
		11/24/14

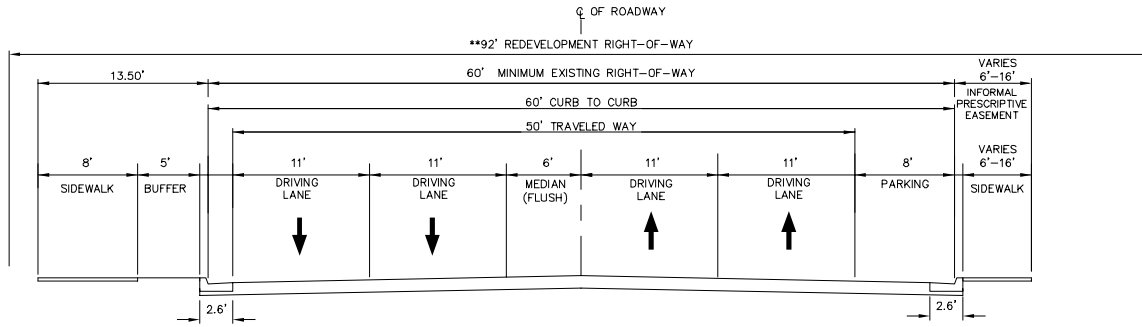

INTERIM TYPICAL SECTION 4
FREEMAN AVE. TO BELLROSE AVE.

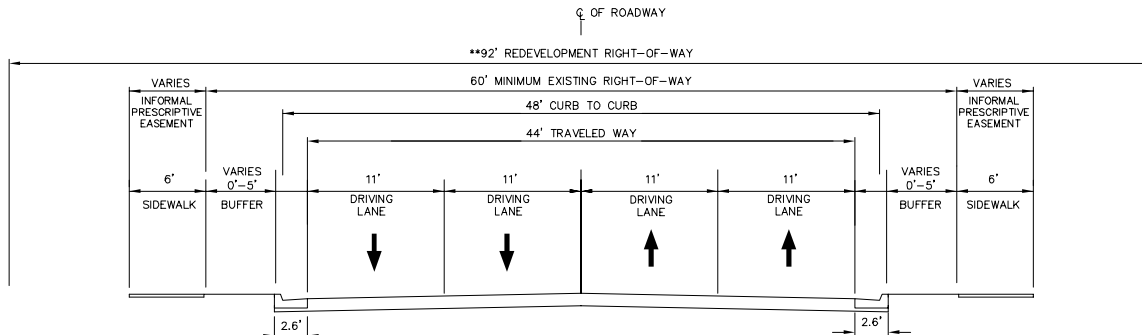

INTERIM TYPICAL SECTION 5
MENAUL BLVD. TO CLAREMONT RD.
MILDRED AVE. TO CANDELARIA BLVD.
MESCALERO RD. TO SAN CLEMENTE RD.

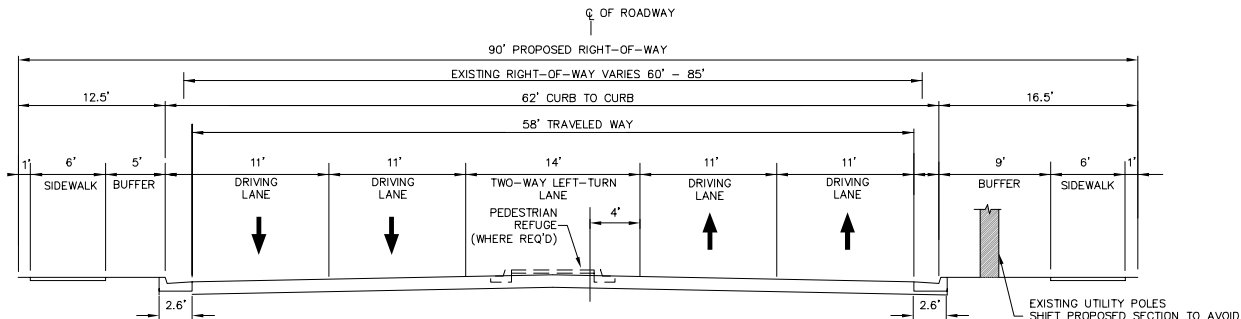

PROPOSED TYPICAL SECTION 6
GRIEGOS RD. TO MONTANO RD.

NOTE: TYPICAL SECTIONS 3 THRU 5 ARE FOR INTERIM CONSTRUCTION UNTIL REDEVELOPMENT ALONG THE CORRIDOR OCCURS, AND THE PROPOSED ULTIMATE TYPICAL SECTION CAN BE IMPLEMENTED.

** REDEVELOPMENT RIGHT-OF-WAY INDICATES THE FULL WIDTH OF RIGHT-OF-WAY REQUIRED TO CONSTRUCT THE RECOMMENDED TYPICAL SECTION. SEE SHEET 6 FOR PROPOSED ULTIMATE TYPICAL SECTION.

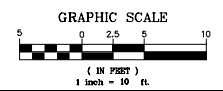

PARSONS BRINCKERHOFF

CITY OF ALBUQUERQUE
DEPARTMENT OF MUNICIPAL DEVELOPMENT
TRANSPORTATION DIVISION
NORTH FOURTH STREET REDEVELOPMENT STUDY
MOUNTAIN RD. TO CAMINO ESPANOL
PROPOSED TYPICAL SECTIONS

DESIGN REVIEW COMMITTEE	CITY ENGINEER APPROVAL	MO/24Y/14	MO/24Y/14

City Project No. COA 5878.91 Zone Map No. Sheet 5 of 28

AS BUILT INFORMATION		BENCH MARKS		SURVEY INFORMATION		ENGINEER'S SEAL	
CONTRACTOR	NO.	NO.	DATE	NO.	DATE	NO.	DATE
DESIGNED BY	DATE	NO.	DATE	NO.	DATE	NO.	DATE
DRAWN BY	DATE	NO.	DATE	NO.	DATE	NO.	DATE
CHECKED BY	DATE	NO.	DATE	NO.	DATE	NO.	DATE
RECORDED BY	DATE	NO.	DATE	NO.	DATE	NO.	DATE
NO.	DATE	NO.	DATE	NO.	DATE	NO.	DATE

**PRELIMINARY
NOT FOR CONSTRUCTION**

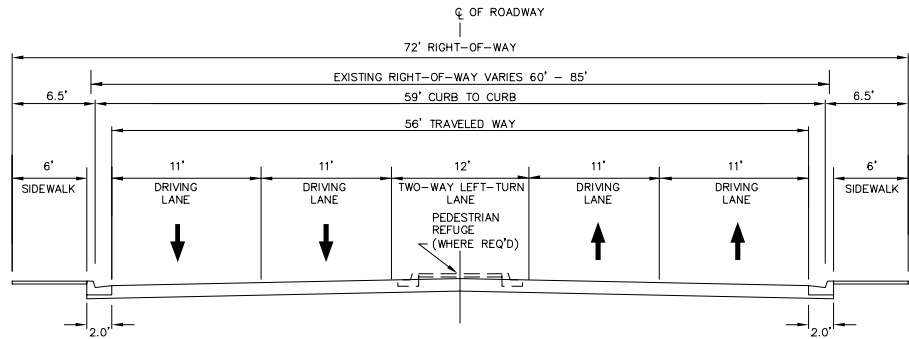

PROPOSED TYPICAL SECTION 7
MONTANO RD. TO CAMINO ESPANOL

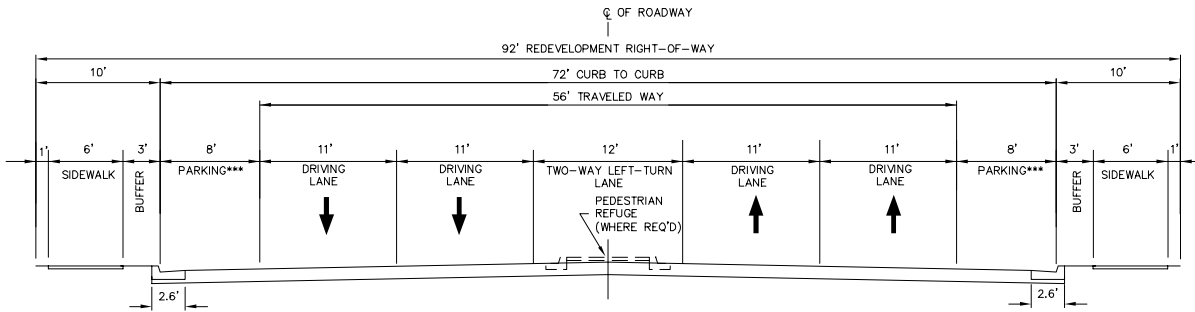

*** PARKING AISLE AT DISCRETION OF PROPERTY OWNER. MAY BE ELIMINATED OR CONVERTED TO BUFFER/LANDSCAPING.

PROPOSED ULTIMATE TYPICAL SECTION
I-40 TO GRIEGOS RD.

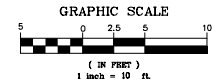

PARSONS BRINCKERHOFF

CITY OF ALBUQUERQUE
DEPARTMENT OF MUNICIPAL DEVELOPMENT
TRANSPORTATION DIVISION
NORTH FOURTH STREET REDEVELOPMENT STUDY
MOUNTAIN RD. TO CAMINO ESPANOL
PROPOSED TYPICAL SECTIONS

DESIGN REVIEW COMMITTEE	CITY ENGINEER APPROVAL	MO, 2014	MO, 2014

City Project No. COA 5878.91 Zone Map No. Sheet 6 of 28

AS BUILT INFORMATION		BENCH MARKS		SURVEY INFORMATION		ENGINEER'S SEAL	
CONTRACTOR	DATE	NO.	DATE	NO.	DATE	NO.	DATE
DESIGNED BY	DATE	NO.	DATE	NO.	DATE	NO.	DATE
ACCEPTANCE BY	DATE	NO.	DATE	NO.	DATE	NO.	DATE
REVISION BY	DATE	NO.	DATE	NO.	DATE	NO.	DATE
CONDUCTED BY	DATE	NO.	DATE	NO.	DATE	NO.	DATE
MICRO-FILM INFORMATION	DATE	NO.	DATE	NO.	DATE	NO.	DATE
RECORDED BY	DATE	NO.	DATE	NO.	DATE	NO.	DATE

**PRELIMINARY
NOT FOR CONSTRUCTION**

NO.	DATE	BY	REMARKS

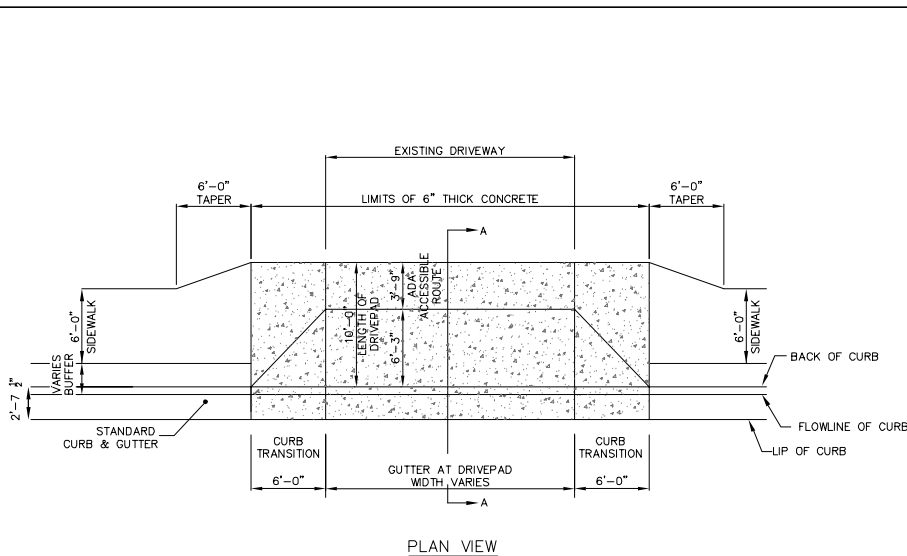

PLAN VIEW

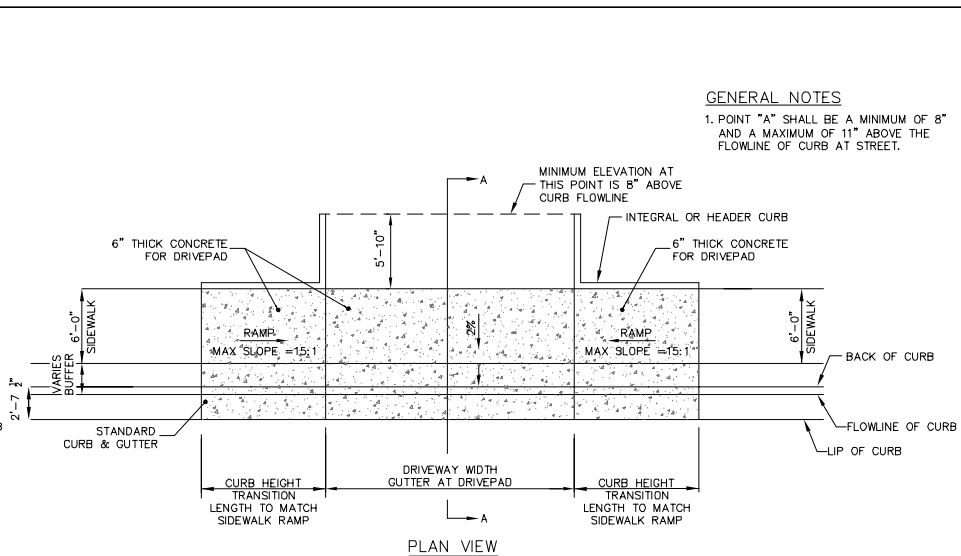

PLAN VIEW

GENERAL NOTES

1. POINT "A" SHALL BE A MINIMUM OF 8" AND A MAXIMUM OF 11" ABOVE THE FLOWLINE OF CURB AT STREET.

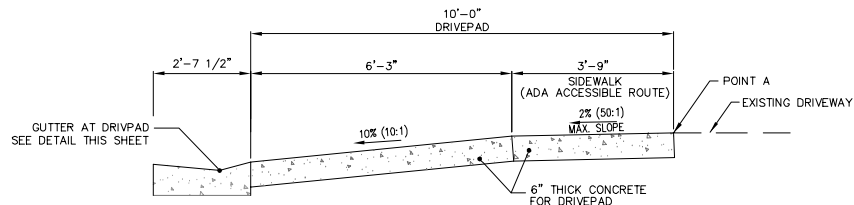

SECTION A-A
(SLOPE UP TO EXISTING)

DRIVEPAD TYPE 1

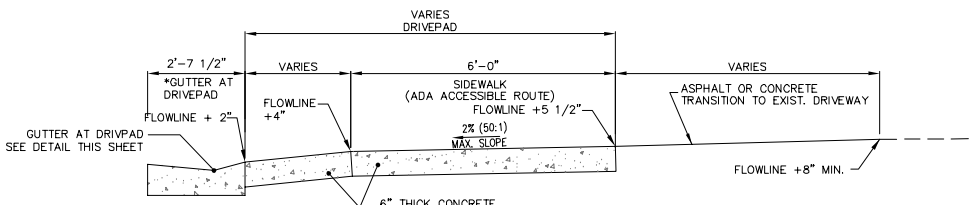

SECTION A-A
(SLOPE UP TO EXISTING)

DRIVEPAD TYPE 2

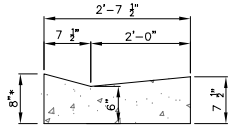

GUTTER AT DRIVEPAD
(SEE DWG. 2415A)
*USE 8" OPTION FOR 2" HEIGHT FROM FLOWLINE TO BACK OF CURB

AS BUILT INFORMATION		CONTRACTOR	NO.
DESIGNED BY	DATE	RECORDED BY	DATE
DRAWN BY	DATE	INDEXED BY	DATE
CHECKED BY	DATE	APPROVED BY	DATE
MICRO-FILM INFORMATION		NO.	DATE
BENCH MARKS			
SURVEY INFORMATION			
FIELD NOTES	NO.	DATE	BY
ENGINEER'S SEAL			
PRELIMINARY NOT FOR CONSTRUCTION			
DESIGNED BY	DATE	REMARKS	BY
DOS	11/24/14	DESIGN	
DOS	11/24/14		
CHEK	11/24/14		
CITY OF ALBUQUERQUE DEPARTMENT OF MUNICIPAL DEVELOPMENT TRANSPORTATION DIVISION NORTH FOURTH STREET REDEVELOPMENT STUDY			
DRIVEPAD DETAILS			
DESIGN REVIEW COMMITTEE	CITY ENGINEER APPROVAL	MS, DAY/HR.	MS, DAY/HR.
City Project No. COA 5878.91		Zone Map No.	Sheet 7 of 28

PROPOSED TYPICAL SECTION 1
NO ADDITIONAL RIGHT OF WAY REQUIRED

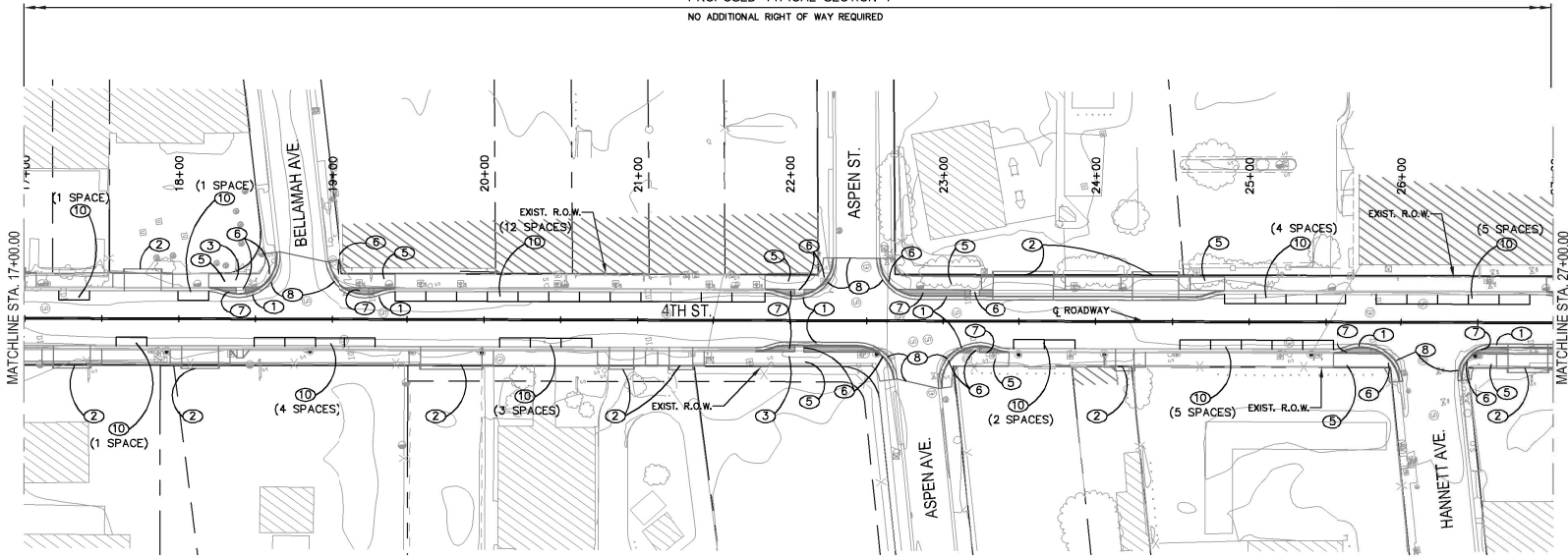

- KEYED NOTES:
- ① NEW STANDARD CURB & GUTTER, SEE COA STD. DWG. 2415A.
 - ② NEW ADA COMPLIANT DRIVEPAD, SEE DETAIL SHT. 7
 - ③ REMOVE EXISTING DRIVEPAD
 - ④ NEW 6' WIDE CONCRETE SIDEWALK SEE COA STD. DWG. 2430
 - ⑤ NEW 9' WIDE CONCRETE SIDEWALK SEE COA STD. DWG. 2430
 - ⑥ NEW ADA COMPLIANT CURB RAMP SEE COA STD. DWG. 2441
 - ⑦ NEW LANDSCAPE AREA
 - ⑧ SAWCUT EXISTING ASPHALT
 - ⑨ NEW FULL DEPTH ASPHALT SEE COA STD. DWG. 2407
 - ⑩ PARALLEL PARKING SPACE 8' WIDE X 20' LONG
 - ⑪ RELOCATE EXISTING PNM POLE

- LEGEND:
- PROPOSED CURB & GUTTER
 - PROPOSED SIDEWALK/DRIVEPAD
 - ▨ PROPOSED ASPHALT
 - PROPOSED BUFFER

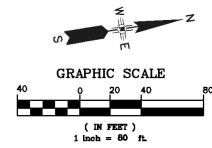

**PARSONS
BRINCKERHOFF**

CITY OF ALBUQUERQUE
DEPARTMENT OF MUNICIPAL DEVELOPMENT
TRANSPORTATION DIVISION
NORTH FOURTH STREET
MOUNTAIN ROAD TO CAMINO ESPANOL
15% ROADWAY PLANS

DESIGN REVIEW COMMITTEE	CITY ENGINEER APPROVAL	NO. / DAY / YR.	NO. / DAY / YR.

City Project No. COA 5678.91 Zone Map No. Sheet 10 of 28

AS BUILT INFORMATION		BENCH MARKS		SURVEY INFORMATION		ENGINEER'S SEAL	
CONTRACTOR	DATE	NO.	DATE	FIELD NOTES	NO.	DATE	PRELIMINARY NOT FOR CONSTRUCTION
DESIGNED BY	DATE						DESIGN
DRAWN BY	DATE						
CHECKED BY	DATE						
RECORDED BY	DATE						

INTERIM TYPICAL SECTION 3

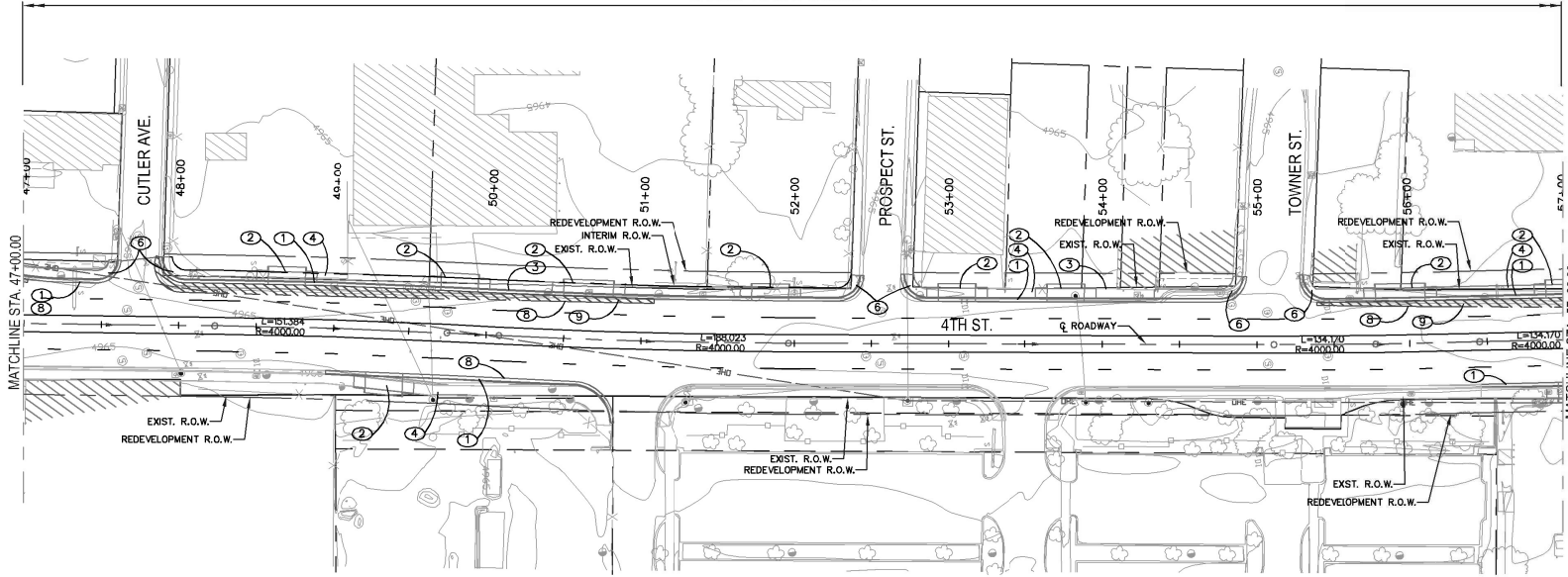

KEYED NOTES:

- ① NEW STANDARD CURB & GUTTER, SEE COA STD. DWG. 2415A.
- ② NEW ADA COMPLIANT DRIVEPAD, SEE DETAIL SHIT. 7
- ③ REMOVE EXISTING DRIVEPAD
- ④ NEW 6' WIDE CONCRETE SIDEWALK SEE COA STD. DWG. 2430
- ⑤ NEW 9' WIDE CONCRETE SIDEWALK SEE COA STD. DWG. 2430
- ⑥ NEW ADA COMPLIANT CURB RAMP SEE COA STD. DWG. 2441
- ⑦ NEW LANDSCAPE AREA
- ⑧ SAWCUT EXISTING ASPHALT
- ⑨ NEW FULL DEPTH ASPHALT SEE COA STD. DWG. 2407
- ⑩ PARALLEL PARKING SPACE 8' WIDE X 20' LONG
- ⑪ RELOCATE EXISTING PNM POLE

LEGEND:

- PROPOSED CURB & GUTTER
- PROPOSED SIDEWALK/DRIVEPAD
- ▨ PROPOSED ASPHALT
- PROPOSED BUFFER

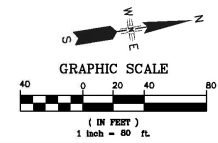

**PARSONS
BRINCKERHOFF**

CITY OF ALBUQUERQUE
DEPARTMENT OF MUNICIPAL DEVELOPMENT
TRANSPORTATION DIVISION
NORTH FOURTH STREET
MOUNTAIN ROAD TO CAMINO ESPANOL
15% ROADWAY PLANS

DESIGN REVIEW COMMITTEE	CITY ENGINEER APPROVAL	NO. / DAY / YR.	NO. / DAY / YR.

City Project No. COA 5678.91 Zone Map No. Sheet 13 of 28

AS BUILT INFORMATION		BENCH MARKS		SURVEY INFORMATION		ENGINEER'S SEAL	
CONTRACTOR	DATE	NO.	DATE	FIELD NOTES	NO.	DATE	PRELIMINARY NOT FOR CONSTRUCTION
DESIGNED BY	DATE	NO.	DATE	NO.	NO.	DATE	PRELIMINARY NOT FOR CONSTRUCTION
DRAWN BY	DATE	NO.	DATE	NO.	NO.	DATE	
CHECKED BY	DATE	NO.	DATE	NO.	NO.	DATE	
RECORDED BY	DATE	NO.	DATE	NO.	NO.	DATE	

INTERIM TYPICAL SECTION 5

TRANSITION TO
PROPOSED
TYPICAL SECTION 6

PROPOSED TYPICAL SECTION 6

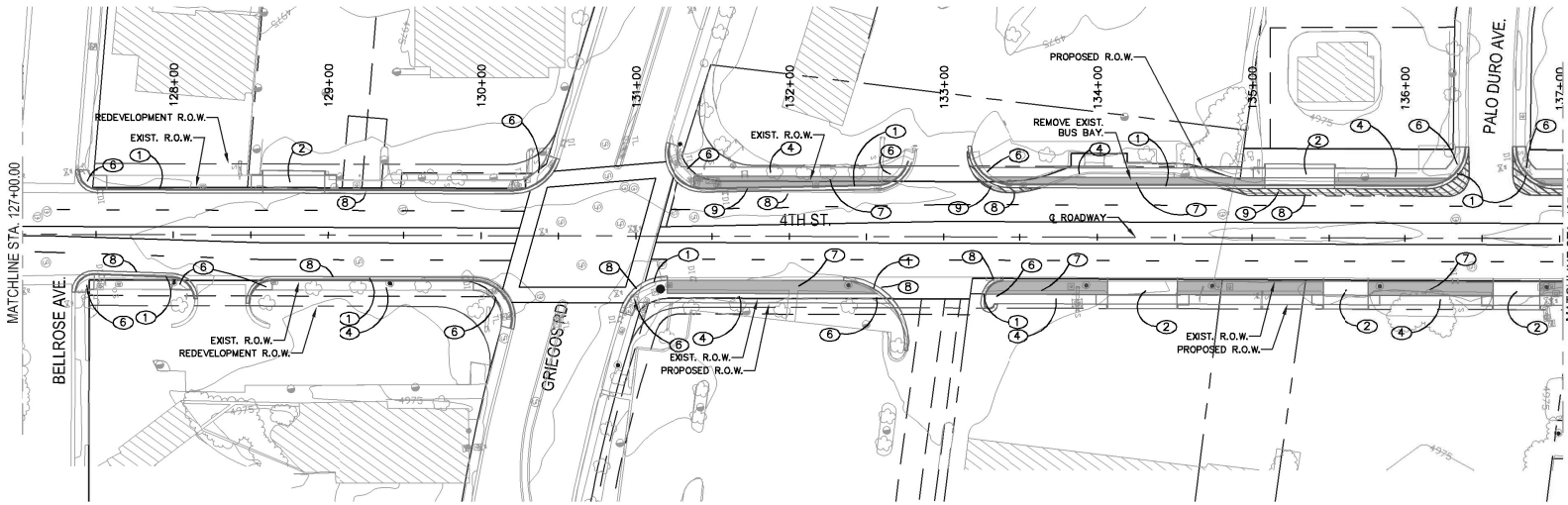

KEYED NOTES:

- ① NEW STANDARD CURB & GUTTER, SEE COA STD. DWG. 2415A.
- ② NEW ADA COMPLIANT DRIVEPAD, SEE DETAIL SHT. 7
- ③ REMOVE EXISTING DRIVEPAD
- ④ NEW 6' WIDE CONCRETE SIDEWALK SEE COA STD. DWG. 2430
- ⑤ NEW 9' WIDE CONCRETE SIDEWALK SEE COA STD. DWG. 2430
- ⑥ NEW ADA COMPLIANT CURB RAMP SEE COA STD. DWG. 2441
- ⑦ NEW LANDSCAPE AREA
- ⑧ SAWCUT EXISTING ASPHALT
- ⑨ NEW FULL DEPTH ASPHALT SEE COA STD. DWG. 2407
- ⑩ PARALLEL PARKING SPACE 8' WIDE X 20' LONG
- ⑪ RELOCATE EXISTING PNM POLE

LEGEND:

- PROPOSED CURB & GUTTER
- PROPOSED SIDEWALK/DRIVEPAD
- ▨ PROPOSED ASPHALT
- PROPOSED BUFFER

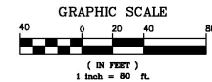

**PARSONS
BRINCKERHOFF**

CITY OF ALBUQUERQUE
DEPARTMENT OF MUNICIPAL DEVELOPMENT
TRANSPORTATION DIVISION
NORTH FOURTH STREET
MOUNTAIN ROAD TO CAMINO ESPANOL
15% ROADWAY PLANS

DESIGN REVIEW COMMITTEE: CITY ENGINEER APPROVAL

City Project No. COA 5678.91 Zone Map No. Sheet 21 of 28

AS BUILT INFORMATION		BENCH MARKS		SURVEY INFORMATION		ENGINEER'S SEAL	
CONTRACTOR	DATE	NO.	DATE	FIELD NOTES	NO.	DATE	PRELIMINARY NOT FOR CONSTRUCTION
REVISION BY	DATE	NO.	DATE	NO.	DATE	NO.	REMARKS
APPROVED BY	DATE	NO.	DATE	NO.	DATE	NO.	BY
DESIGNED BY	DATE	NO.	DATE	NO.	DATE	NO.	DESIGN
DRAWN BY	DATE	NO.	DATE	NO.	DATE	NO.	DSS
CHECKED BY	DATE	NO.	DATE	NO.	DATE	NO.	JRH
RECORDED BY	DATE	NO.	DATE	NO.	DATE	NO.	CHECKED BY

PROPOSED TYPICAL SECTION 6

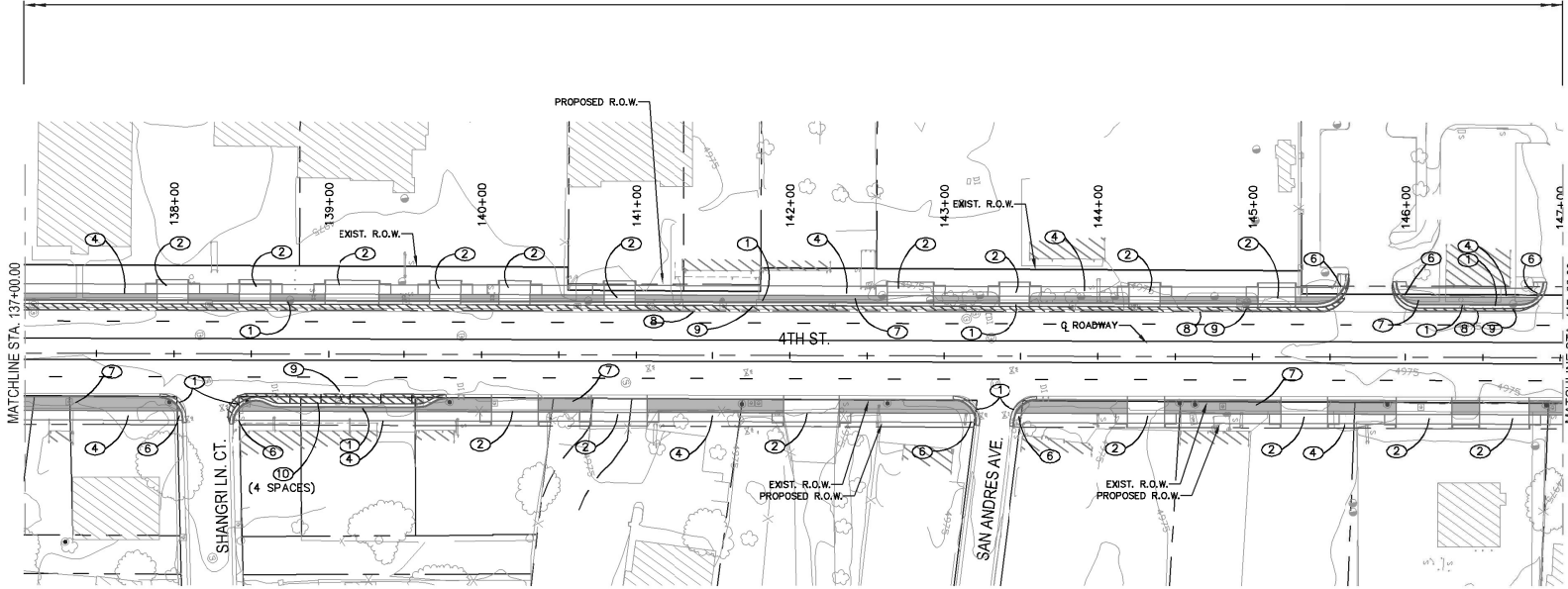

KEYED NOTES:

- ① NEW STANDARD CURB & GUTTER, SEE COA STD. DWG. 2415A.
- ② NEW ADA COMPLIANT DRIVEPAD, SEE DETAIL SHT. 7
- ③ REMOVE EXISTING DRIVEPAD
- ④ NEW 6" WIDE CONCRETE SIDEWALK SEE COA STD. DWG. 2430
- ⑤ NEW 9" WIDE CONCRETE SIDEWALK SEE COA STD. DWG. 2430
- ⑥ NEW ADA COMPLIANT CURB RAMP SEE COA STD. DWG. 2441
- ⑦ NEW LANDSCAPE AREA
- ⑧ SAWCUT EXISTING ASPHALT
- ⑨ NEW FULL DEPTH ASPHALT SEE COA STD. DWG. 2407
- ⑩ PARALLEL PARKING SPACE 8' WIDE X 20' LONG
- ⑪ RELOCATE EXISTING PNM POLE

LEGEND:

- PROPOSED CURB & GUTTER
- PROPOSED SIDEWALK/DRIVEPAD
- ▨ PROPOSED ASPHALT
- PROPOSED BUFFER

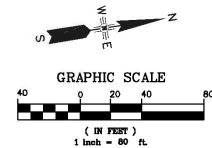

**PARSONS
BRINCKERHOFF**

CITY OF ALBUQUERQUE
DEPARTMENT OF MUNICIPAL DEVELOPMENT
TRANSPORTATION DIVISION
NORTH FOURTH STREET
MOUNTAIN ROAD TO CAMINO ESPANOL
15% ROADWAY PLANS

DESIGN REVIEW COMMITTEE	CITY ENGINEER APPROVAL	NO./DAY/YR.	NO./DAY/YR.

City Project No. COA 5676.91 Zone Map No. Sheet 22 of 28

AS BUILT INFORMATION		BENCH MARKS		SURVEY INFORMATION		ENGINEER'S SEAL	
CONTRACTOR	DATE	NO.	DATE	NO.	DATE	NO.	DATE
REMOVED BY	DATE	NO.	DATE	NO.	DATE	NO.	DATE
ACCEPTED BY	DATE	NO.	DATE	NO.	DATE	NO.	DATE
DESIGNED BY	DATE	NO.	DATE	NO.	DATE	NO.	DATE
DRAWN BY	DATE	NO.	DATE	NO.	DATE	NO.	DATE
CHECKED BY	DATE	NO.	DATE	NO.	DATE	NO.	DATE
RECORDED BY	DATE	NO.	DATE	NO.	DATE	NO.	DATE

**PRELIMINARY
NOT FOR CONSTRUCTION**

NO.	DATE	REMARKS	BY
	11/24/14	DESIGN	
	11/24/14		
	11/24/14		

PROPOSED TYPICAL SECTION 6

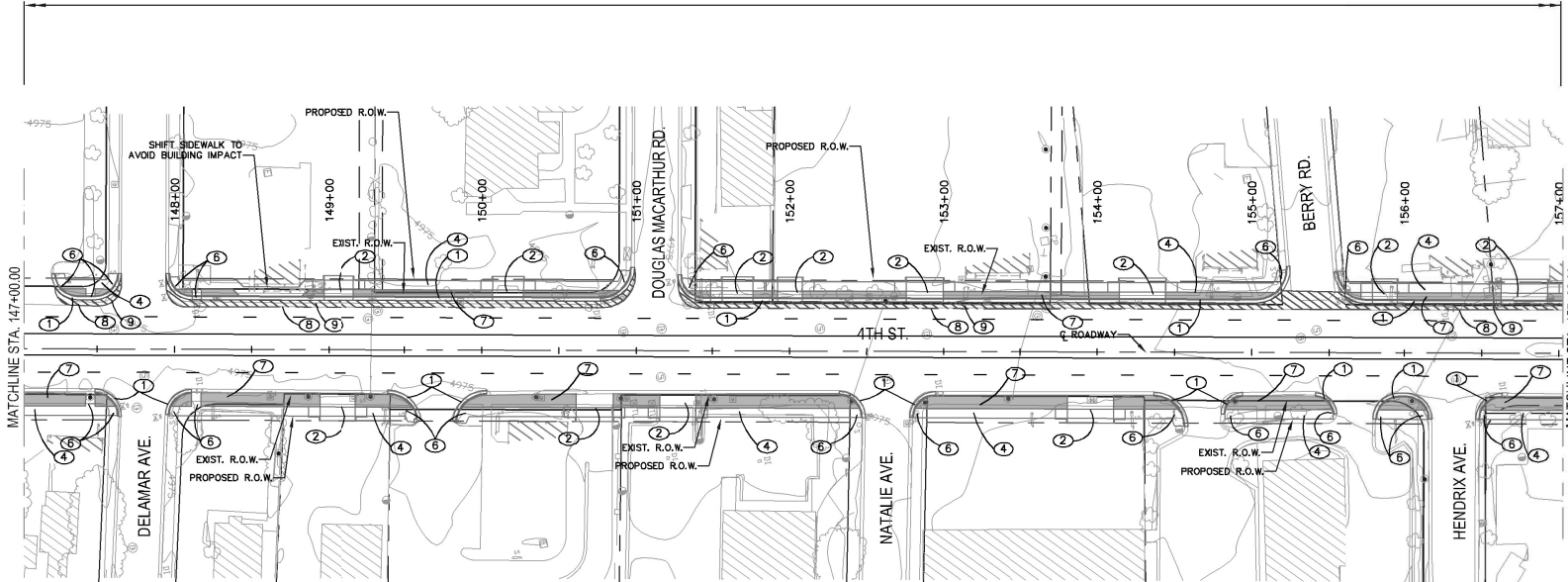

- KEYED NOTES:**
- ① NEW STANDARD CURB & GUTTER, SEE COA STD. DWG. 2415A.
 - ② NEW ADA COMPLIANT DRIVEPAD, SEE DETAIL SHIT. 7
 - ③ REMOVE EXISTING DRIVEPAD
 - ④ NEW 6' WIDE CONCRETE SIDEWALK SEE COA STD. DWG. 2430
 - ⑤ NEW 9' WIDE CONCRETE SIDEWALK SEE COA STD. DWG. 2430
 - ⑥ NEW ADA COMPLIANT CURB RAMP SEE COA STD. DWG. 2441
 - ⑦ NEW LANDSCAPE AREA
 - ⑧ SAWCUT EXISTING ASPHALT
 - ⑨ NEW FULL DEPTH ASPHALT SEE COA STD. DWG. 2407
 - ⑩ PARALLEL PARKING SPACE 8' WIDE X 20' LONG
 - ⑪ RELOCATE EXISTING PNM POLE

- LEGEND:**
- PROPOSED CURB & GUTTER
 - PROPOSED SIDEWALK/DRIVEPAD
 - ▨ PROPOSED ASPHALT
 - PROPOSED BUFFER

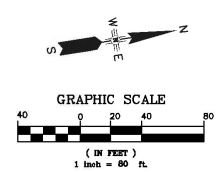

PARSONS BRINCKERHOFF

CITY OF ALBUQUERQUE
 DEPARTMENT OF MUNICIPAL DEVELOPMENT
 TRANSPORTATION DIVISION
 NORTH FOURTH STREET
 MOUNTAIN ROAD TO CAMINO ESPANOL
 15% ROADWAY PLANS

City Project No. COA 5678.91 Zone Map No. Sheet 23 of 28

AS BUILT INFORMATION		BENCH MARKS		SURVEY INFORMATION		ENGINEER'S SEAL	
CONTRACTOR	DATE	NO.	DATE	FIELD NOTES	NO.	DATE	NO.
DESIGNED BY	DATE	NO.	DATE	NO.	DATE	NO.	DATE
DRAWN BY	DATE	NO.	DATE	NO.	DATE	NO.	DATE
CHECKED BY	DATE	NO.	DATE	NO.	DATE	NO.	DATE
RECORDED BY	DATE	NO.	DATE	NO.	DATE	NO.	DATE
NO.	DATE	NO.	DATE	NO.	DATE	NO.	DATE

**PRELIMINARY
NOT FOR CONSTRUCTION**

NO.	DATE	REMARKS	BY
DESIGN	11/24/14		
DSS	11/24/14		
JRH	11/24/14		

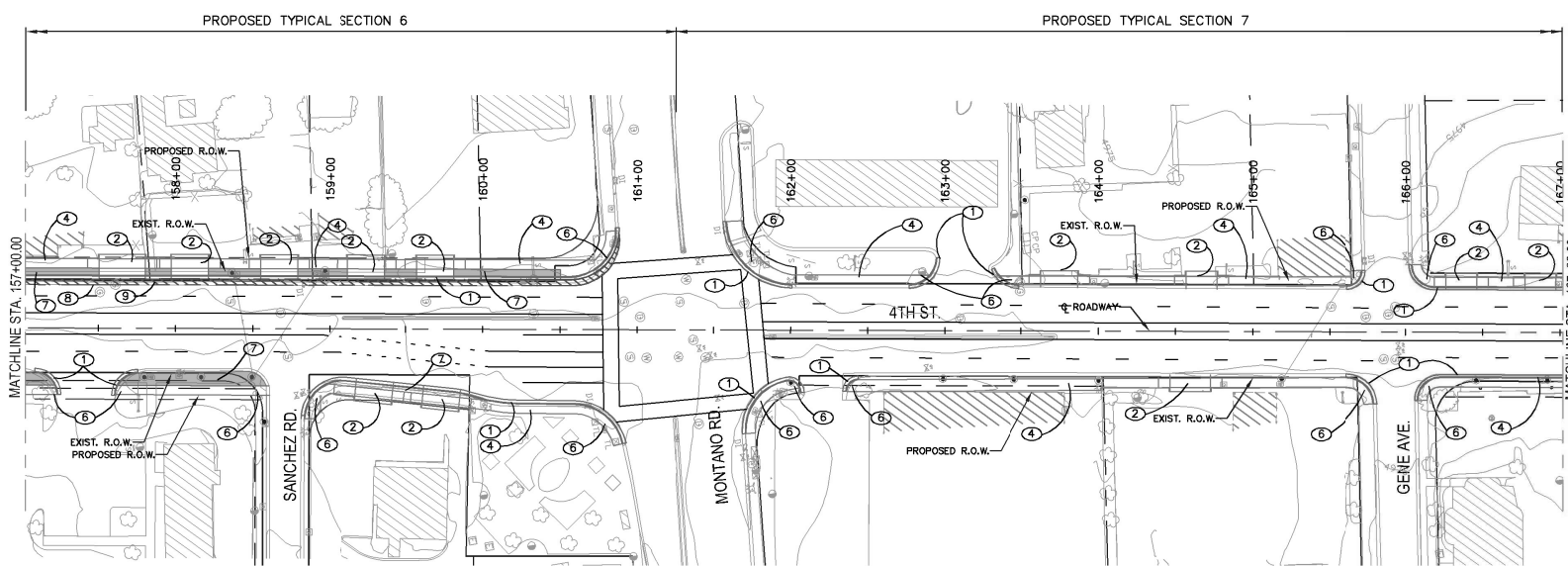

- KEYED NOTES:**
- ① NEW STANDARD CURB & GUTTER, SEE COA STD. DWG. 2415A.
 - ② NEW ADA COMPLIANT DRIVEPAD, SEE DETAIL SHT. 7
 - ③ REMOVE EXISTING DRIVEPAD
 - ④ NEW 6' WIDE CONCRETE SIDEWALK SEE COA STD. DWG. 2430
 - ⑤ NEW 9' WIDE CONCRETE SIDEWALK SEE COA STD. DWG. 2430
 - ⑥ NEW ADA COMPLIANT CURB RAMP SEE COA STD. DWG. 2441
 - ⑦ NEW LANDSCAPE AREA
 - ⑧ SAWCUT EXISTING ASPHALT
 - ⑨ NEW FULL DEPTH ASPHALT SEE COA STD. DWG. 2407
 - ⑩ PARALLEL PARKING SPACE 8' WIDE X 20' LONG
 - ⑪ RELOCATE EXISTING PNM POLE

- LEGEND:**
- PROPOSED CURB & GUTTER
 - PROPOSED SIDEWALK/DRIVEPAD
 - ▨ PROPOSED ASPHALT
 - PROPOSED BUFFER

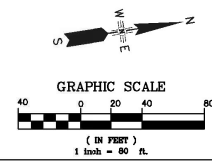

**PARSONS
BRINCKERHOFF**

CITY OF ALBUQUERQUE
DEPARTMENT OF MUNICIPAL DEVELOPMENT
TRANSPORTATION DIVISION
NORTH FOURTH STREET
MOUNTAIN ROAD TO CAMINO ESPANOL
15% ROADWAY PLANS

DESIGN REVIEW COMMITTEE	CITY ENGINEER APPROVAL	NO. / DAY / YR.	NO. / DAY / YR.

City Project No. COA 5678.91 Zone Map No. Sheet 24 of 28

AS BUILT INFORMATION		BENCH MARKS		SURVEY INFORMATION		ENGINEER'S SEAL	
CONTRACTOR	DATE	NO.	DATE	FIELD NOTES	NO.	DATE	PRELIMINARY NOT FOR CONSTRUCTION
DESIGNED BY	DATE						DESIGNED BY: DGS 11/24/14 DRAWN BY: DGS 11/24/14 CHECKED BY: JEH 11/24/14
APPROVED BY	DATE						
DESIGNED BY	DATE						
APPROVED BY	DATE						

