

60572657.ctb\\drawing\\aecom..._de18_no\\brandia.long@aecom.com\0118030\A30161_3_SPP.dwg PLOTTED: 7/12/18 - 4:35pm brandia.long

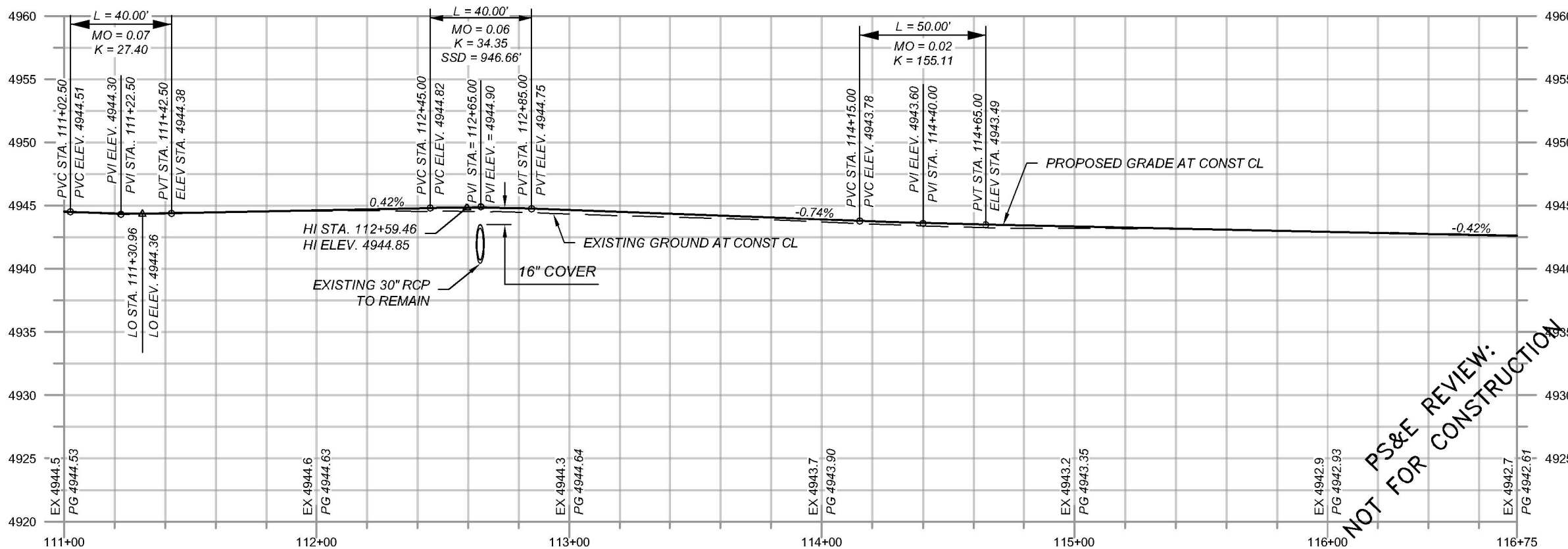

- CONSTRUCTION NOTES**
- DIMENSIONS ARE TO LIP OF GUTTER, FACE OF BARRIER, OR LIMITS OF FULL DEPTH PAVEMENT UNLESS OTHERWISE INDICATED.
 - SEE 4-SERIES FOR TURNOUT/DRIVEWAY INFORMATION

- KEYED NOTES**
- BUILD STANDARD CURB & GUTTER PER COA 2415A.
 - BUILD CONCRETE SIDEWALK, 4" PER COA 2430
 - BUILD DRIVEPAD, 6".
 - BUILD COMBINED TURNOUT DRIVEPAD, 6"
 - BUILD RCP PIPE- SEE 5-SERIES FOR INFORMATION
 - BUILD HEADWALL WITH PEDESTRIAN/BICYCLE RAIL PER 607-20-1/4 THROUGH 4/4. SEE 5-SERIES FOR INFORMATION
 - BUILD PEDESTRIAN/ BICYCLE RAIL PER 607-20-1/4 THROUGH 4/4, SEE 2-5 FOR MODIFIED FOUNDATION
 - EXISTING MANHOLE- ADJUST TO GRADE. BUILD CONCRETE COLLAR PER COA 2461
 - REMOVE AND DISPOSE OF EXISTING RAILROAD SPUR GRADE CROSSING WITHIN RIGHT OF WAY
 - LIMITS OF CONSTRUCTION
 - EXISTING EDGE OF PAVEMENT
 - EXISTING RIGHT-OF-WAY
 - EXISTING ACEQUIA - PROTECT DURING CONSTRUCTION
 - EXISTING WATER VALVE - ADJUST TO GRADE. BUILD CONCRETE COLLAR PER COA 2461
 - EXISTING UTILITY TO BE ADJUSTED/RELOCATED BY OTHERS
 - REMOVE AND RELOCATE EXISTING MAILBOX AND POST
 - REMOVE AND DISPOSE OF EXISTING WOOD POLE
 - REMOVE AND DISPOSE OF EXISTING PAVEMENT
 - EXISTING CULVERT TO REMAIN. PROTECT DURING CONSTRUCTION

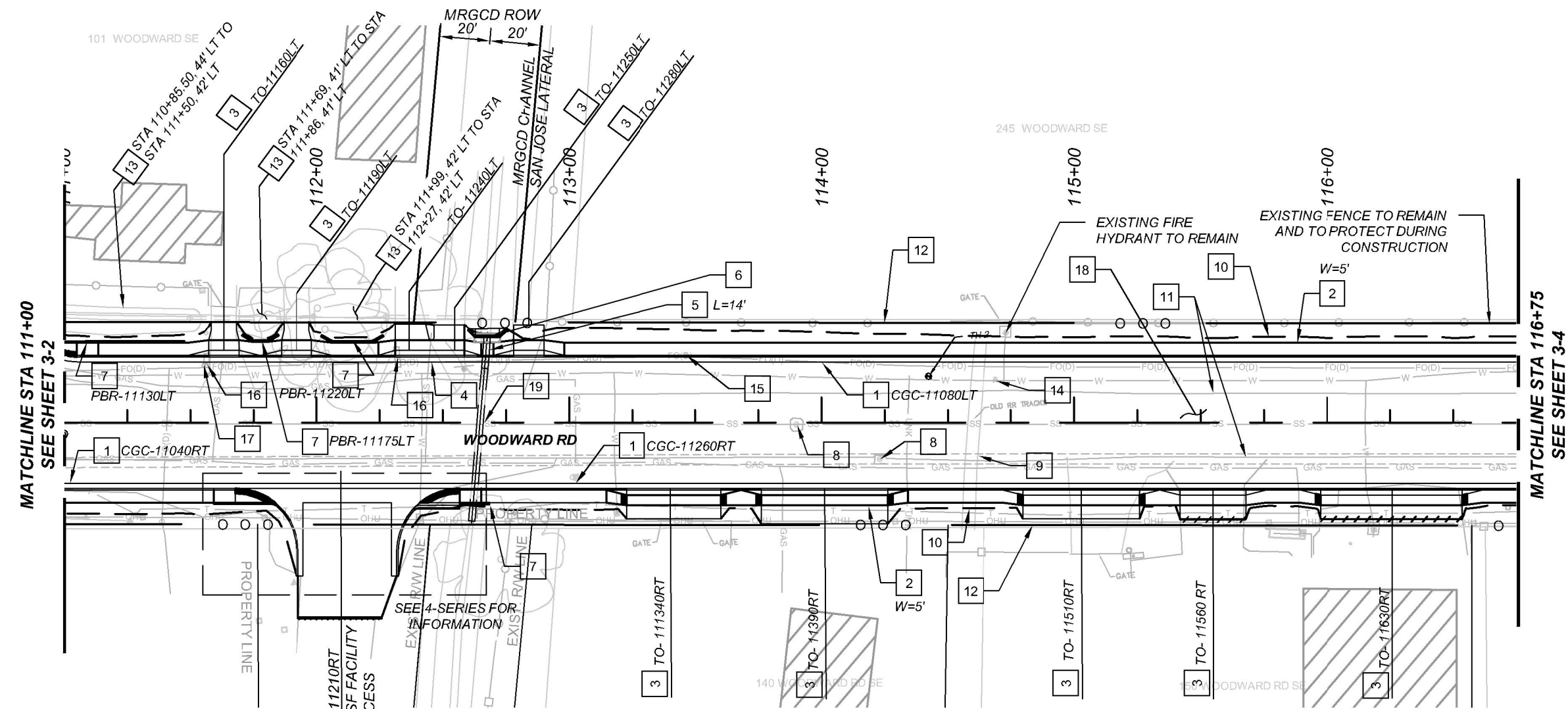
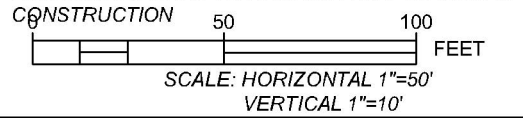

NO	DATE	DESCRIPTION
6		
5		
4		
3		
2		
1		

AECOM
 AECOM TECHNICAL SERVICES, INC
 6501 AMERICAS PKWY NE STE 900
 ALBUQUERQUE, NM 87110
 (505) 855-7500 www.aecom.com
 AECOM PROJECT NO.: 60572657

COUNTY OF BERNALILLO
 PUBLIC WORKS DIVISION
 TECHNICAL SERVICES DEPARTMENT

**WOODWARD ROAD IMPROVEMENTS
 PLAN AND PROFILE
 STA 111+00 TO STA 116+75**

NOT FOR CONSTRUCTION
 PS&E REVIEW:

