

ROSA PARKS RD. NW  
64' ROW

UNIVERSE BOULEVARD NW  
64' ROW

UNIVERSE BOULEVARD NW  
64' ROW

SPINNING BALL AVE NW

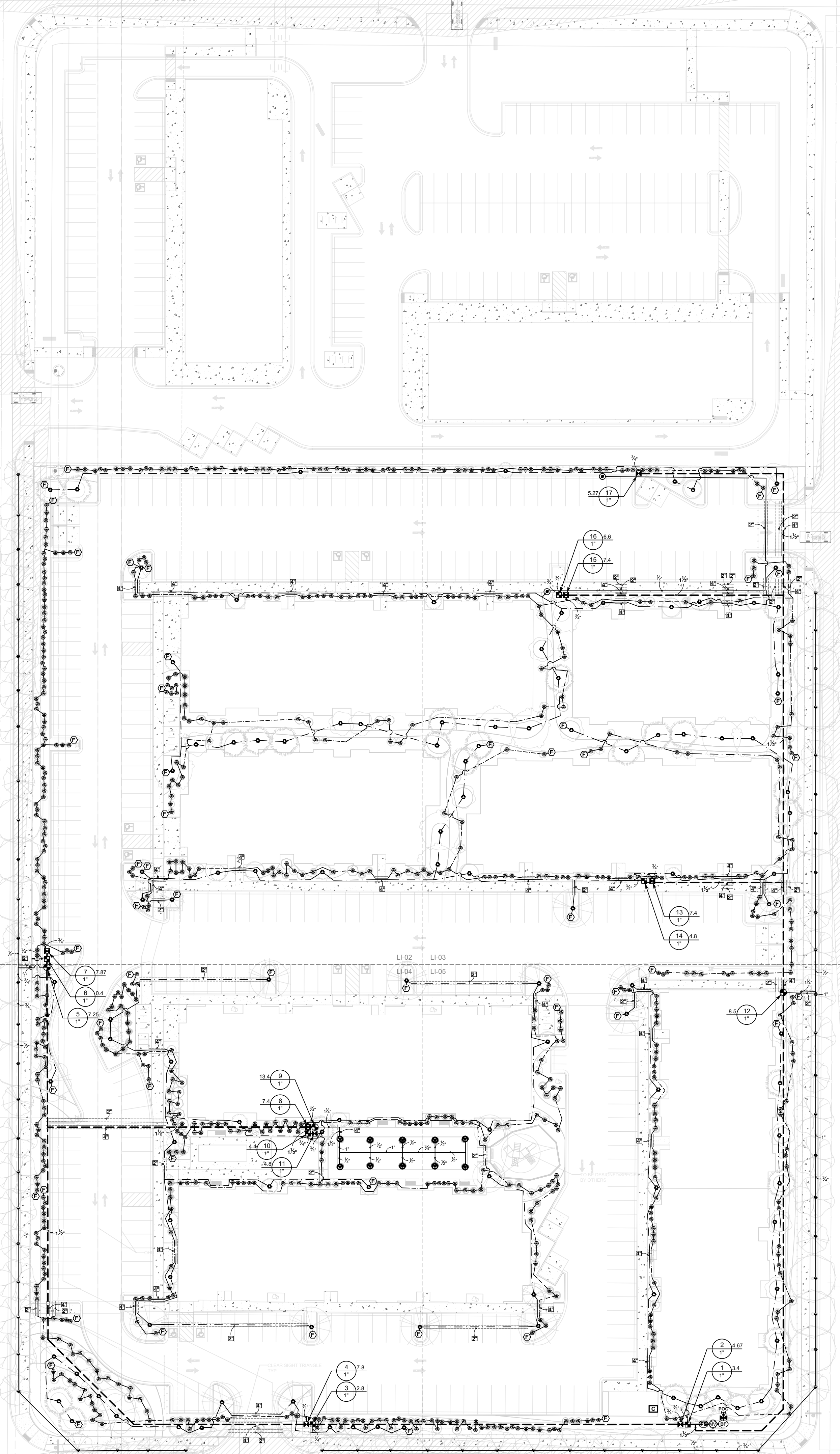

### IRRIGATION SCHEDULE

SYMBOL	MANUFACTURER/MODEL/DESCRIPTION
	RAIN BIRD R-VAN24 - TURF ROTARY 1804-SAM-P45, 17FT.-24FT. 45-270 DEGREES AND 360 DEGREES, HAND ADJUSTABLE MULTI-STREAM ROTARY W/1800 TURF SPRAY BODY ON 4IN. POP-UP, WITH CHECK VALVE AND 45 PSI IN-STEM PRESSURE REGULATOR, 1/2IN. NPT FEMALE THREADED INLET.
	RAIN BIRD 1800-1400 FLOOD FIXED FLOW RATE 0.25 GPM - 2.0 GPM, FULL CIRCLE BUBBLER, 1/2IN. FIPT.
	DRIP CONTROL VALVE - SHRUB RAIN BIRD XZ-100-PRF, MEDIUM FLOW DRIP CONTROL KIT, 1IN. DV VALVE, 1IN. PRESSURE REGULATING FILTER, 40PSI PRESSURE REGULATOR. 5 GPM-20 GPM.
	DRIP CONTROL VALVE - TREE RAIN BIRD XZ-100-PRF, MEDIUM FLOW DRIP CONTROL KIT, 1IN. DV VALVE, 1IN. PRESSURE REGULATING FILTER, 40PSI PRESSURE REGULATOR. 3 GPM-15 GPM.
	TRANSITION FITTING PIPE TRANSITION POINT FROM PVC LATERAL TO DRIP TUBING WITH RISER IN 6IN. DRIP BOX.
	FLUSH CAP NDS CEP900
	DRIP EMITTER - SHRUB (2) NDS TAE 20 DRIP EMITTERS
	DRIP EMITTER - TREE (6) NDS TAE 20 DRIP EMITTERS
SYMBOL	MANUFACTURER/MODEL/DESCRIPTION
	CONTROL VALVE RAIN BIRD PEB, 1IN., 1-1/2IN., 2IN. PLASTIC INDUSTRIAL VALVES. LOW FLOW OPERATING CAPABILITY, GLOBE CONFIGURATION.
	MAIN SHUT OFF VALVE SPEARS SCH80 PVC COMPACT BALL VALVE
	MASTER VALVE 1" RAIN BIRD PEB, 1IN., 1-1/2IN., 2IN. PLASTIC INDUSTRIAL MASTER VALVES. LOW FLOW OPERATING CAPABILITY, GLOBE CONFIGURATION.
	REDUCED PRESSURE BACKFLOW PREVENTER 1" FEBCO 825Y
	CONTROLLER - RAIN BIRD ESP-LXD 50-200 STATION, 2-WIRE DECODER BASED CONTROLLER. (1) ESP-LXD 50-STATION, INDOOR/OUTDOOR, PLASTIC WALL-MOUNT ENCLOSURE. SYSTEM REQUIREMENTS: RAIN BIRD FD-XXX-TURF FIELD DECODERS, PAIGE ELECTRIC CABLE P7072D & RAIN BIRD WC20 DRY SPLICES ONLY. GROUND SYSTEM W/ (X) LSP-1TURF LINE SURGE PROTECTORS IN RAIN BIRD ROUND VALVE BOXES. INSTALL PER MANUFACTURERS RECOMMENDATIONS.
	FLOW SENSOR CREATIVE SENSOR TECHNOLOGY FSI-T10-001 1IN. PVC TEE TYPE FLOW SENSOR W/SOCKET ENDS, CUSTOM MOUNTING TEE AND ULTRA-LIGHTWEIGHT IMPELLER ENHANCES LOW FLOW MEASUREMENT. 2 WIRE DIGITAL OUTPUT COMPATIBLE W/ALL IRRIGATION CONTROLLERS. FLOW RANGE: .86 GPM - 52 GPM.
	POINT OF CONNECTION 1 1/2"
	IRRIGATION LATERAL LINE: PVC SCHEDULE 40
	IRRIGATION LATERAL LINE: A940 DRIP POLYLINE
	IRRIGATION LATERAL LINE: A940RDS DRIP POLYLINE
	IRRIGATION MAINLINE: PVC SCHEDULE 40
	PIPE SLEEVE: PVC CLASS 200 SDR 21

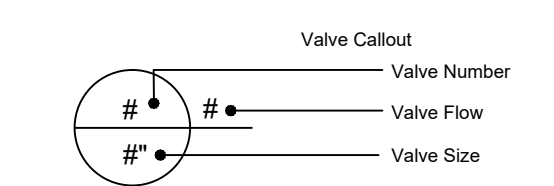

### IRRIGATION NOTES

- THE LANDSCAPE CONTRACTOR SHALL FURNISH LABOR, MATERIALS AND EQUIPMENT TO INSTALL PROPOSED IRRIGATION SYSTEM AS SHOWN PER PLAN AND DETAILS.
- IF ANY ERRORS OR DISCREPANCIES APPEAR ON THE PLAN, THEY MUST BE BROUGHT TO THE ATTENTION OF THE LANDSCAPE ARCHITECT BEFORE CONSTRUCTION OF THE IRRIGATION SYSTEM BEGINS.
- LANDSCAPE INSTALLER SHALL PERFORM PRESSURE/GPM TEST AT POINT OF CONNECTION BEFORE INSTALLING IRRIGATION SYSTEM TO VERIFY PSI AND GPM FOR THE SITE.
- IRRIGATION SYSTEM HAS BEEN DESIGNED TO A MINIMUM DYNAMIC PRESSURE OF 75 PSI AT 50 GPM. IF THE PSI/GPM ARE LOWER THAN 75/50 THE LANDSCAPE ARCHITECT MUST BE NOTIFIED IMMEDIATELY.
- THE CONTRACTOR SHALL FIELD VERIFY UTILITY LOCATIONS AND MAKE ANY NECESSARY FIELD ADJUSTMENTS WITH GENERAL CONTRACTOR.
- THE LOCATION OF IRRIGATION EQUIPMENT IS APPROXIMATE AND SHALL BE LOCATED IN THE LANDSCAPE AREAS. ANY IRRIGATION EQUIPMENT AND PIPING SHOWN OUTSIDE OF LANDSCAPE AREAS ARE FOR GRAPHIC CLARITY ONLY.
- THE LANDSCAPE CONTRACTOR SHALL PROVIDE TO OWNER AN ACCURATE AS-BUILT IRRIGATION PLAN WHEN THE WORK IS COMPLETED. AS-BUILT DOCUMENTS SHOULD BE UPDATED WEEKLY FOR ACCURATE RECORDING OF IRRIGATION SYSTEM.
- VALVE LOCATIONS TO BE APPROVED BY LANDSCAPE ARCHITECT. VALVE BOX LIDS TO BE TAN IN GRAVEL AREAS AND GREEN IN SOD/SEED AREAS.
- ALL PLANTS WITHIN THE PROPERTY LINE SHALL BE IRRIGATED BY LOW FLOW POINT-SOURCE DRIP IRRIGATION SYSTEM.
- ALL PLANTS WITHIN PUBLIC RIGHT-OF-WAY SHALL BE IRRIGATED BY BUBBLER IRRIGATION SYSTEM PER COA SPEC. ALL PLANTS WITHIN THE PUBLIC RIGHT-OF-WAY SHALL BE ZONED SEPARATELY FROM THE PLANTS WITHIN THE PROPERTY LINE.
- POWER FOR IRRIGATION SYSTEM TO BE PROVIDED BY THE GENERAL CONTRACTOR. 110V POWER IS REQUIRED AT THE LOCATIONS OF THE IRRIGATION CONTROLLER AND BACKFLOW PREVENTER.
- BACKFLOW PREVENTER MUST BE TESTED AND CERTIFIED BEFORE FINAL ACCEPTANCE OF THE JOB.
- CONTROLLER LOCATION IS APPROXIMATE AND THE FINAL LOCATION WILL BE DETERMINED IN THE FIELD.
- SLEEVES TO BE INSTALLED, AS SHOWN PER PLAN, BEFORE HARDSCAPE IS INSTALLED. THE LANDSCAPE CONTRACTOR MUST BE GIVEN A MINIMUM OF 72 HOUR NOTICE BEFORE SLEEVE LOCATIONS ARE PAVED OVER. WATER METER TO BE PROVIDED BY OTHERS.
- PER 5-6(C)(14)(a), IRRIGATION SYSTEMS SHALL COMPLY WITH SECTION 8 OF THE ABCWUA LEGISLATION AND ORDINANCES (CROSS CONNECTION PREVENTION AND CONTROL ORDINANCE)
- PER 5-6(C)(14)(b), ALL IRRIGATION SYSTEMS SHALL BE DESIGNED TO MINIMIZE THE USE OF WATER.
- PER 5-6(C)(14)(c), ALL NON-RESIDENTIAL LANDSCAPE IRRIGATION SHALL HAVE AUTOMATIC TIMERS AND/OR PROGRAMMABLE SETTINGS TO AVOID OVERWATERING.
- PER 5-6(C)(14)(d), THE IRRIGATION SYSTEM SHALL NOT SPRAY OR IRRIGATE IMPERVIOUS SURFACES, INCLUDING SIDEWALKS, DRIVEWAYS, DRIVE AISLES, STREETS, AND PARKING AND LOADING AREAS.

**YELLOWSTONE**  
LANDSCAPE

www.yellowstonelandscape.com  
 P O Box 10597  
 Albuquerque, NM 87184  
 505.898.9615  
 design@yellowstonelandscape.com

STATE OF NEW MEXICO  
 CODY McALLEN  
 555  
 REGISTERED  
 LANDSCAPE ARCHITECT

Date: 04/02/2024  
 Revisions:  
 △  
 △  
 △  
 △

Drawn by: PL  
 Reviewed by: CM

Universe View  
 Apartment  
 Albuquerque, New Mexico

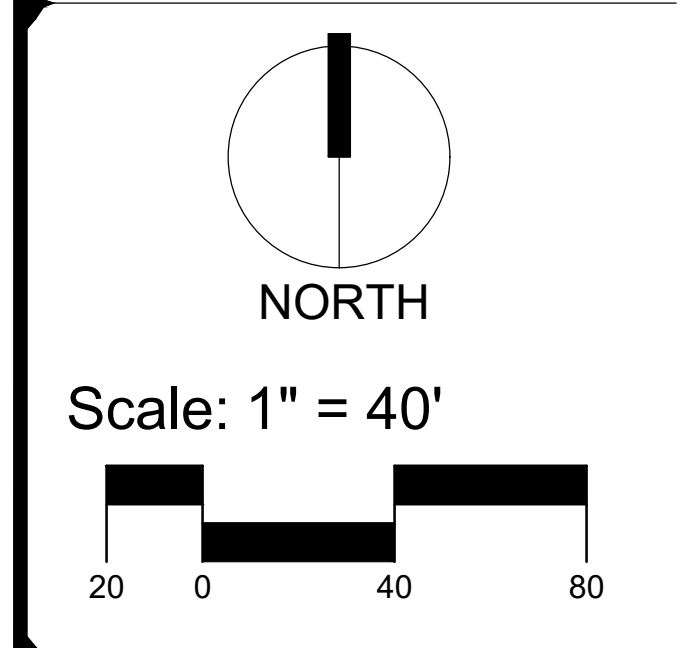

Sheet Title:  
**Irrigation  
 Plan**

Sheet Number:  
**LI-01**



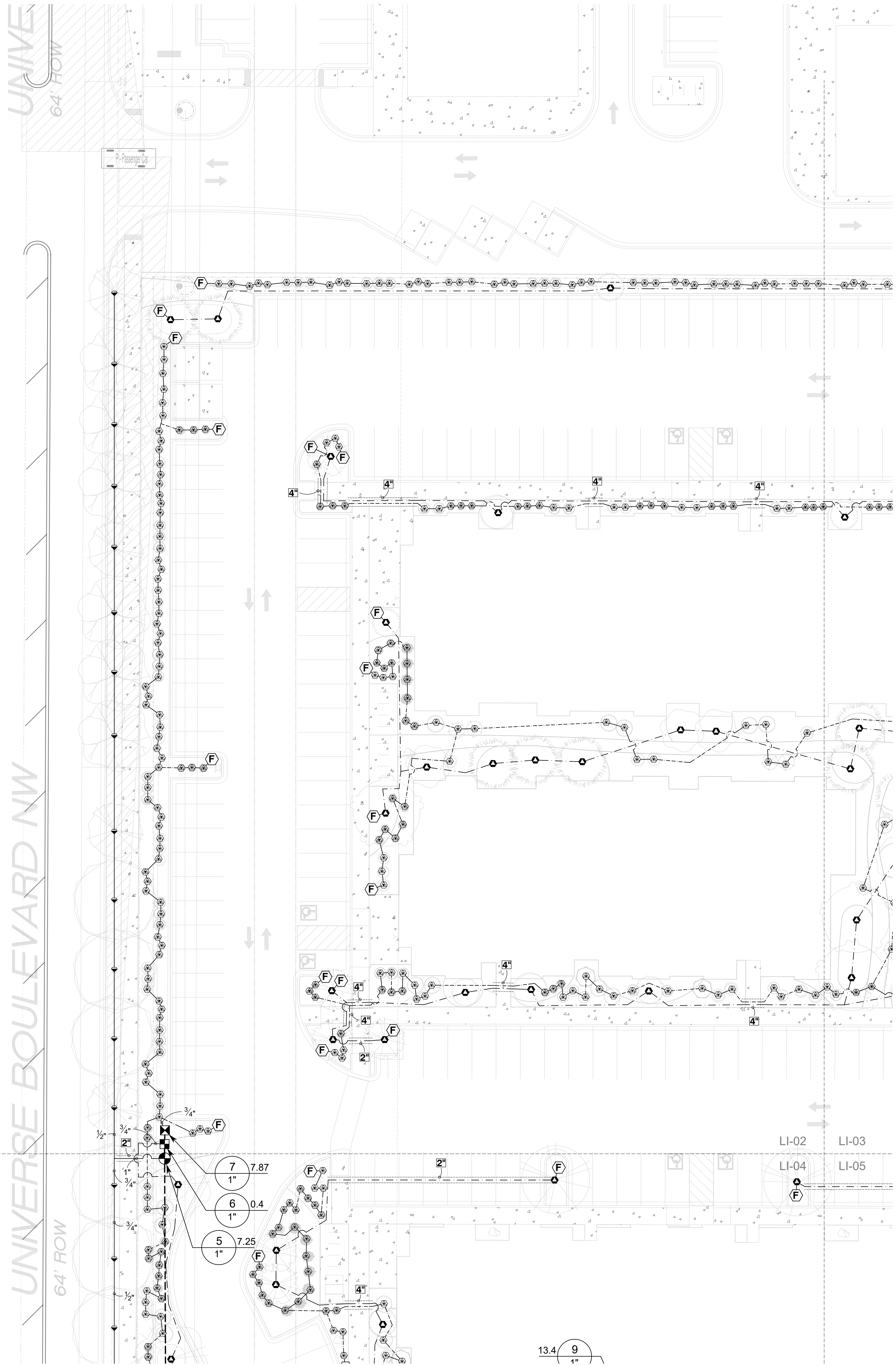

## IRRIGATION SCHEDULE

SYMBOL	MANUFACTURER/MODEL/DESCRIPTION
	RAIN BIRD R-VAN24 - TURF ROTARY 1804-SAM-P45, 17FT.-24FT. 45-270 DEGREES AND 360 DEGREES, HAND ADJUSTABLE MULTI-STREAM ROTARY W/1800 TURF SPRAY BODY ON 4IN. POP-UP, WITH CHECK VALVE AND 45 PSI IN-STEM PRESSURE REGULATOR, 1/2IN. NPT FEMALE THREADED INLET.
	RAIN BIRD 1800-1400 FLOOD FIXED FLOW RATE 0.25 GPM - 2.0 GPM, FULL CIRCLE BUBBLER, 1/2IN. FIPT.
	RAIN BIRD 1401-1402-1404-1408
	DRIP CONTROL VALVE - SHRUB RAIN BIRD XZC-100-PRF, MEDIUM FLOW DRIP CONTROL KIT, 1IN. DV VALVE, 1IN. PRESSURE REGULATING FILTER, 40PSI PRESSURE REGULATOR. 5 GPM-20 GPM.
	DRIP CONTROL VALVE - TREE RAIN BIRD XZC-100-PRF, MEDIUM FLOW DRIP CONTROL KIT, 1IN. DV VALVE, 1IN. PRESSURE REGULATING FILTER, 40PSI PRESSURE REGULATOR. 3 GPM-15 GPM.
	TRANSITION FITTING PIPE TRANSITION POINT FROM PVC LATERAL TO DRIP TUBING WITH RISER IN 6IN. DRIP BOX.
	FLUSH CAP NDS CEP900
	DRIP EMITTER - SHRUB (2) NDS TAE 20 DRIP EMITTERS
	DRIP EMITTER - TREE (6) NDS TAE 20 DRIP EMITTERS
	CONTROL VALVE RAIN BIRD PEB, 1IN., 1-1/2IN., 2IN. PLASTIC INDUSTRIAL VALVES. LOW FLOW OPERATING CAPABILITY, GLOBE CONFIGURATION.
	MAIN SHUT OFF VALVE SPEARS SCH80 PVC COMPACT BALL VALVE
	MASTER VALVE 1" RAIN BIRD PEB, 1IN., 1-1/2IN., 2IN. PLASTIC INDUSTRIAL MASTER VALVES. LOW FLOW OPERATING CAPABILITY, GLOBE CONFIGURATION.
	REDUCED PRESSURE BACKFLOW PREVENTER 1" FEBCO 825Y
	CONTROLLER - RAIN BIRD ESP-LXD 50-200 STATION, 2-WIRE DECODER BASED CONTROLLER. (1) ESP-LXD 50-STATION, INDOOR/OUTDOOR, PLASTIC WALL-MOUNT ENCLOSURE. SYSTEM REQUIREMENTS: RAIN BIRD FD-XXX-TURF FIELD DECODERS, PAIGE ELECTRIC CABLE P7072D & RAIN BIRD WC20 DRY SPLICES ONLY. GROUND SYSTEM W/ (X) LSP-1TURF LINE SURGE PROTECTORS IN RAIN BIRD ROUND VALVE BOXES. INSTALL PER MANUFACTURERS RECOMMENDATIONS.
	FLOW SENSOR CREATIVE SENSOR TECHNOLOGY FSI-T10-001 1IN. PVC TEE TYPE FLOW SENSOR W/SOCKET ENDS, CUSTOM MOUNTING TEE AND ULTRA-LIGHTWEIGHT IMPELLER ENHANCES LOW FLOW MEASUREMENT. 2 WIRE DIGITAL OUTPUT COMPATIBLE W/ALL IRRIGATION CONTROLLERS. FLOW RANGE: .86 GPM - 52 GPM.
	POINT OF CONNECTION 1 1/2"
	IRRIGATION LATERAL LINE: PVC SCHEDULE 40
	IRRIGATION LATERAL LINE: A940 DRIP POLYLINE
	IRRIGATION LATERAL LINE: A940RDS DRIP POLYLINE
	IRRIGATION MAINLINE: PVC SCHEDULE 40
	PIPE SLEEVE: PVC CLASS 200 SDR 21

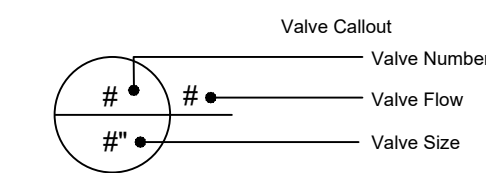

## IRRIGATION NOTES

- THE LANDSCAPE CONTRACTOR SHALL FURNISH LABOR, MATERIALS AND EQUIPMENT TO INSTALL PROPOSED IRRIGATION SYSTEM AS SHOWN PER PLAN AND DETAILS.
- IF ANY ERRORS OR DISCREPANCIES APPEAR ON THE PLAN, THEY MUST BE BROUGHT TO THE ATTENTION OF THE LANDSCAPE ARCHITECT BEFORE CONSTRUCTION OF THE IRRIGATION SYSTEM BEGINS.
- LANDSCAPE INSTALLER SHALL PERFORM PRESSURE/GPM TEST AT POINT OF CONNECTION BEFORE INSTALLING IRRIGATION SYSTEM TO VERIFY PSI AND GPM FOR THE SITE.
- IRRIGATION SYSTEM HAS BEEN DESIGNED TO A MINIMUM DYNAMIC PRESSURE OF 75 PSI AT 50 GPM. IF THE PSI/GPM ARE LOWER THAN 75/50 THE LANDSCAPE ARCHITECT MUST BE NOTIFIED IMMEDIATELY.
- THE CONTRACTOR SHALL FIELD VERIFY UTILITY LOCATIONS AND MAKE ANY NECESSARY FIELD ADJUSTMENTS WITH GENERAL CONTRACTOR.
- THE LOCATION OF IRRIGATION EQUIPMENT IS APPROXIMATE AND SHALL BE LOCATED IN THE LANDSCAPE AREAS. ANY IRRIGATION EQUIPMENT AND PIPING SHOWN OUTSIDE OF LANDSCAPE AREAS ARE FOR GRAPHIC CLARITY ONLY.
- THE LANDSCAPE CONTRACTOR SHALL PROVIDE TO OWNER AN ACCURATE AS-BUILT IRRIGATION PLAN WHEN THE WORK IS COMPLETED. AS-BUILT DOCUMENTS SHOULD BE UPDATED WEEKLY FOR ACCURATE RECORDING OF IRRIGATION SYSTEM.
- VALVE LOCATIONS TO BE APPROVED BY LANDSCAPE ARCHITECT. VALVE BOX LIDS TO BE TAN IN GRAVEL AREAS AND GREEN IN SOD/SEED AREAS.
- ALL PLANTS WITHIN THE PROPERTY LINE SHALL BE IRRIGATED BY LOW FLOW POINT-SOURCE DRIP IRRIGATION SYSTEM.
- ALL PLANTS WITHIN PUBLIC RIGHT-OF-WAY SHALL BE IRRIGATED BY BUBBLER IRRIGATION SYSTEM PER COA SPEC. ALL PLANTS WITHIN THE PUBLIC RIGHT-OF-WAY SHALL BE ZONED SEPARATELY FROM THE PLANTS WITHIN THE PROPERTY LINE.
- POWER FOR IRRIGATION SYSTEM TO BE PROVIDED BY THE GENERAL CONTRACTOR. 110V POWER IS REQUIRED AT THE LOCATIONS OF THE IRRIGATION CONTROLLER AND BACKFLOW PREVENTER.
- BACKFLOW PREVENTER MUST BE TESTED AND CERTIFIED BEFORE FINAL ACCEPTANCE OF THE JOB.
- CONTROLLER LOCATION IS APPROXIMATE AND THE FINAL LOCATION WILL BE DETERMINED IN THE FIELD.
- SLEEVES TO BE INSTALLED, AS SHOWN PER PLAN, BEFORE HARDSCAPE IS INSTALLED. THE LANDSCAPE CONTRACTOR MUST BE GIVEN A MINIMUM OF 72 HOUR NOTICE BEFORE SLEEVE LOCATIONS ARE PAVED OVER.
- WATER METER TO BE PROVIDED BY OTHERS.
- PER 5-6(C)(14)(a), IRRIGATION SYSTEMS SHALL COMPLY WITH SECTION 8 OF THE ABCWUA LEGISLATION AND ORDINANCES (CROSS CONNECTION PREVENTION AND CONTROL ORDINANCE)
- PER 5-6(C)(14)(b), ALL IRRIGATION SYSTEMS SHALL BE DESIGNED TO MINIMIZE THE USE OF WATER.
- PER 5-6(C)(14)(c), ALL NON-RESIDENTIAL LANDSCAPE IRRIGATION SHALL HAVE AUTOMATIC TIMERS AND/OR PROGRAMMABLE SETTINGS TO AVOID OVERWATERING.
- PER 5-6(C)(14)(d), THE IRRIGATION SYSTEM SHALL NOT SPRAY OR IRRIGATE IMPERVIOUS SURFACES, INCLUDING SIDEWALKS, DRIVEWAYS, DRIVE AISLES, STREETS, AND PARKING AND LOADING AREAS.

**YELLOWSTONE**  
LANDSCAPE  
www.yellowstonelandscape.com  
P O Box 10597  
Albuquerque, NM 87184  
505.898.9615  
design@yellowstonelandscape.com

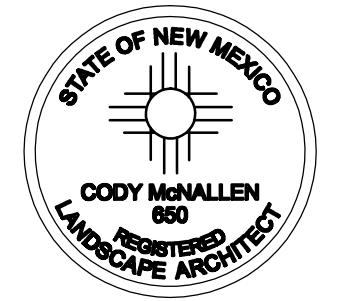

Date: 04/02/2024  
Revisions:  
△  
△  
△  
△

Drawn by: PL  
Reviewed by: CM

Universe View  
Apartment  
Albuquerque, New Mexico

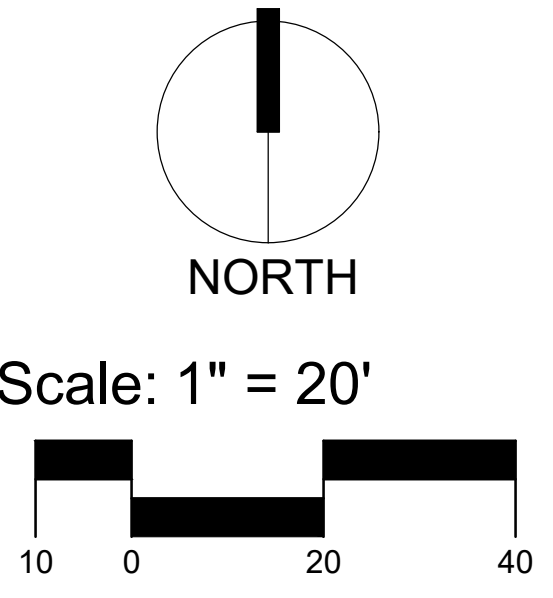

Sheet Title:  
**Irrigation  
Plan**

Sheet Number:  
**LI-02**



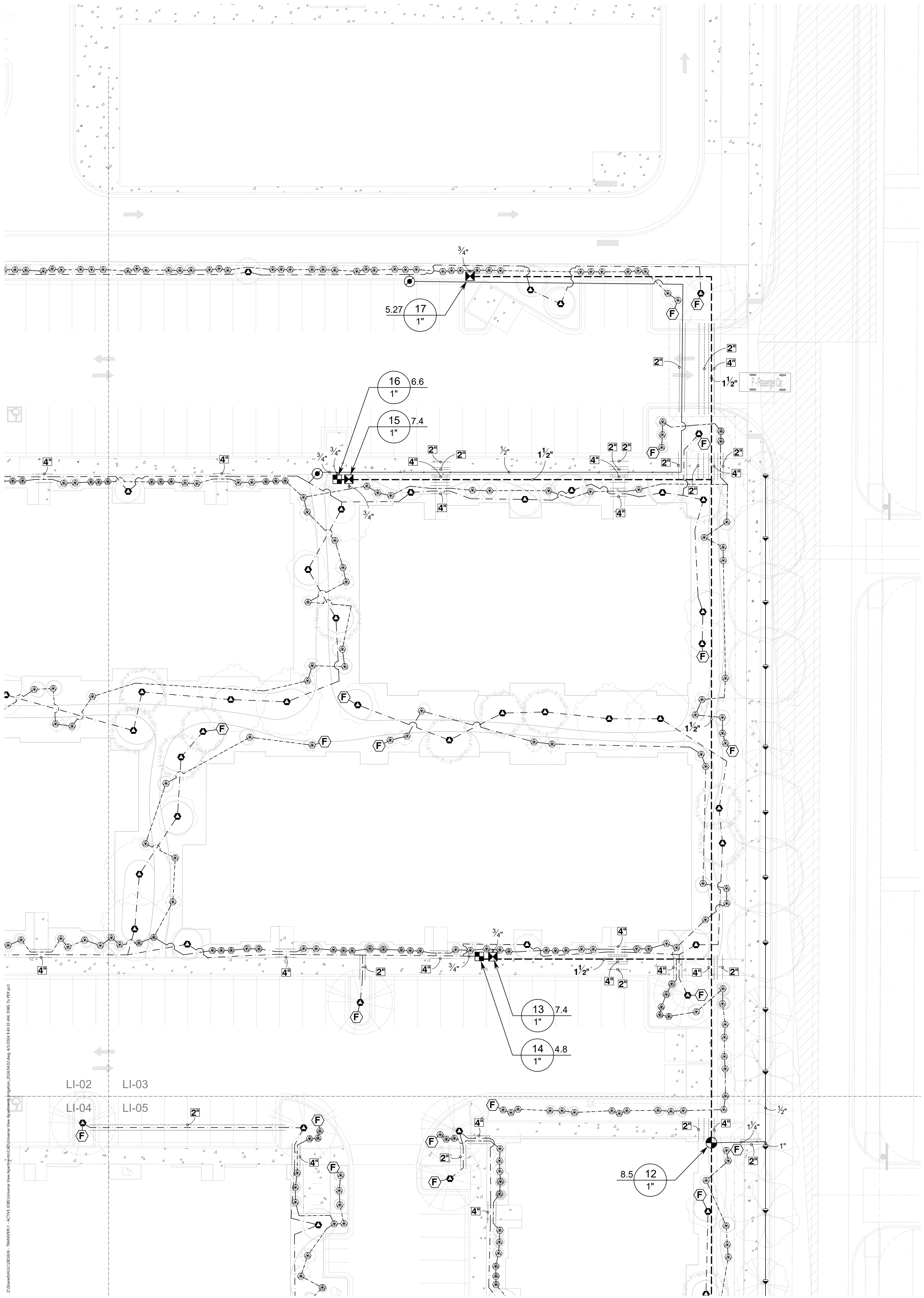

### IRRIGATION SCHEDULE

SYMBOL	MANUFACTURER/MODEL/DESCRIPTION
	RAIN BIRD R-VAN24 - TURF ROTARY 1804-SAM-P45, 17FT.-24FT. 45-270 DEGREES AND 360 DEGREES, HAND ADJUSTABLE MULTI-STREAM ROTARY W/1800 TURF SPRAY BODY ON 4IN. POP-UP, WITH CHECK VALVE AND 45 PSI IN-STEM PRESSURE REGULATOR, 1/2IN. NPT FEMALE THREADED INLET.
	RAIN BIRD 1800-1400 FLOOD FIXED FLOW RATE 0.25 GPM - 2.0 GPM, FULL CIRCLE BUBBLER, 1/2IN. FIPT.

SYMBOL	MANUFACTURER/MODEL/DESCRIPTION
	DRIP CONTROL VALVE - SHRUB RAIN BIRD XCZ-100-PRF, MEDIUM FLOW DRIP CONTROL KIT, 1IN. DV VALVE, 1IN. PRESSURE REGULATING FILTER, 40PSI PRESSURE REGULATOR. 5 GPM-20 GPM.
	DRIP CONTROL VALVE - TREE RAIN BIRD XCZ-100-PRF, MEDIUM FLOW DRIP CONTROL KIT, 1IN. DV VALVE, 1IN. PRESSURE REGULATING FILTER, 40PSI PRESSURE REGULATOR. 3 GPM-15 GPM.
	TRANSITION FITTING PIPE TRANSITION POINT FROM PVC LATERAL TO DRIP TUBING WITH RISER IN 6IN. DRIP BOX.
	FLUSH CAP NDS CEP900
	DRIP EMITTER - SHRUB (2) NDS TAE 20 DRIP EMITTERS
	DRIP EMITTER - TREE (6) NDS TAE 20 DRIP EMITTERS

SYMBOL	MANUFACTURER/MODEL/DESCRIPTION
	CONTROL VALVE RAIN BIRD PEB, 1IN., 1-1/2IN., 2IN. PLASTIC INDUSTRIAL VALVES. LOW FLOW OPERATING CAPABILITY, GLOBE CONFIGURATION.
	MAIN SHUT OFF VALVE SPEARS SCH80 PVC COMPACT BALL VALVE
	MASTER VALVE 1" RAIN BIRD PEB, 1IN., 1-1/2IN., 2IN. PLASTIC INDUSTRIAL MASTER VALVES. LOW FLOW OPERATING CAPABILITY, GLOBE CONFIGURATION.
	REDUCED PRESSURE BACKFLOW PREVENTER 1" FEBCO 825Y
	CONTROLLER - RAIN BIRD ESP-LXD 50-200 STATION, 2-WIRE DECODER BASED CONTROLLER. (1) ESP-LXD 50-STATION, INDOOR/OUTDOOR, PLASTIC WALL-MOUNT ENCLOSURE. SYSTEM REQUIREMENTS: RAIN BIRD FD-XXX-TURF FIELD DECODERS, PAIGE ELECTRIC CABLE P7072D & RAIN BIRD WC20 DRY SPLICES ONLY. GROUND SYSTEM W/ (X) LSP-1TURF LINE SURGE PROTECTORS IN RAIN BIRD ROUND VALVE BOXES. INSTALL PER MANUFACTURERS RECOMMENDATIONS.
	FLOW SENSOR CREATIVE SENSOR TECHNOLOGY FSI-T10-001 1IN. PVC TEE TYPE FLOW SENSOR W/SOCKET ENDS, CUSTOM MOUNTING TEE AND ULTRA-LIGHTWEIGHT IMPELLER ENHANCES LOW FLOW MEASUREMENT. 2 WIRE DIGITAL OUTPUT COMPATIBLE W/ALL IRRIGATION CONTROLLERS. FLOW RANGE: .86 GPM - 52 GPM.
	POINT OF CONNECTION 1 1/2"
	IRRIGATION LATERAL LINE: PVC SCHEDULE 40
	IRRIGATION LATERAL LINE: A940 DRIP POLYLINE
	IRRIGATION LATERAL LINE: A940RDS DRIP POLYLINE
	IRRIGATION MAINLINE: PVC SCHEDULE 40
	PIPE SLEEVE: PVC CLASS 200 SDR 21

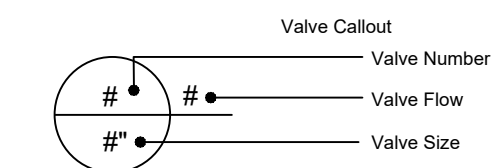

### IRRIGATION NOTES

- THE LANDSCAPE CONTRACTOR SHALL FURNISH LABOR, MATERIALS AND EQUIPMENT TO INSTALL PROPOSED IRRIGATION SYSTEM AS SHOWN PER PLAN AND DETAILS.
- IF ANY ERRORS OR DISCREPANCIES APPEAR ON THE PLAN, THEY MUST BE BROUGHT TO THE ATTENTION OF THE LANDSCAPE ARCHITECT BEFORE CONSTRUCTION OF THE IRRIGATION SYSTEM BEGINS.
- LANDSCAPE INSTALLER SHALL PERFORM PRESSURE/GPM TEST AT POINT OF CONNECTION BEFORE INSTALLING IRRIGATION SYSTEM TO VERIFY PSI AND GPM FOR THE SITE.
- IRRIGATION SYSTEM HAS BEEN DESIGNED TO A MINIMUM DYNAMIC PRESSURE OF 75 PSI AT 50 GPM. IF THE PSI/GPM ARE LOWER THAN 75/50 THE LANDSCAPE ARCHITECT MUST BE NOTIFIED IMMEDIATELY.
- THE CONTRACTOR SHALL FIELD VERIFY UTILITY LOCATIONS AND MAKE ANY NECESSARY FIELD ADJUSTMENTS WITH GENERAL CONTRACTOR.
- THE LOCATION OF IRRIGATION EQUIPMENT IS APPROXIMATE AND SHALL BE LOCATED IN THE LANDSCAPE AREAS. ANY IRRIGATION EQUIPMENT AND PIPING SHOWN OUTSIDE OF LANDSCAPE AREAS ARE FOR GRAPHIC CLARITY ONLY.
- THE LANDSCAPE CONTRACTOR SHALL PROVIDE TO OWNER AN ACCURATE AS-BUILT IRRIGATION PLAN WHEN THE WORK IS COMPLETED. AS-BUILT DOCUMENTS SHOULD BE UPDATED WEEKLY FOR ACCURATE RECORDING OF IRRIGATION SYSTEM.
- VALVE LOCATIONS TO BE APPROVED BY LANDSCAPE ARCHITECT. VALVE BOX LIDS TO BE TAN IN GRAVEL AREAS AND GREEN IN SOD/SEED AREAS.
- ALL PLANTS WITHIN THE PROPERTY LINE SHALL BE IRRIGATED BY LOW FLOW POINT-SOURCE DRIP IRRIGATION SYSTEM.
- ALL PLANTS WITHIN PUBLIC RIGHT-OF-WAY SHALL BE IRRIGATED BY BUBBLER IRRIGATION SYSTEM PER COA SPEC. ALL PLANTS WITHIN THE PUBLIC RIGHT-OF-WAY SHALL BE ZONED SEPARATELY FROM THE PLANTS WITHIN THE PROPERTY LINE.
- POWER FOR IRRIGATION SYSTEM TO BE PROVIDED BY THE GENERAL CONTRACTOR. 110V POWER IS REQUIRED AT THE LOCATIONS OF THE IRRIGATION CONTROLLER AND BACKFLOW PREVENTER.
- BACKFLOW PREVENTER MUST BE TESTED AND CERTIFIED BEFORE FINAL ACCEPTANCE OF THE JOB.
- CONTROLLER LOCATION IS APPROXIMATE AND THE FINAL LOCATION WILL BE DETERMINED IN THE FIELD.
- SLEEVES TO BE INSTALLED, AS SHOWN PER PLAN, BEFORE HARDSCAPE IS INSTALLED. THE LANDSCAPE CONTRACTOR MUST BE GIVEN A MINIMUM OF 72 HOUR NOTICE BEFORE SLEEVE LOCATIONS ARE PAVED OVER.
- WATER METER TO BE PROVIDED BY OTHERS.
- PER 5-6(C)(14)(a), IRRIGATION SYSTEMS SHALL COMPLY WITH SECTION 8 OF THE ABCWUA LEGISLATION AND ORDINANCES (CROSS CONNECTION PREVENTION AND CONTROL ORDINANCE)
- PER 5-6(C)(14)(b), ALL IRRIGATION SYSTEMS SHALL BE DESIGNED TO MINIMIZE THE USE OF WATER.
- PER 5-6(C)(14)(c), ALL NON-RESIDENTIAL LANDSCAPE IRRIGATION SHALL HAVE AUTOMATIC TIMERS AND/OR PROGRAMMABLE SETTINGS TO AVOID OVERWATERING.
- PER 5-6(C)(14)(d), THE IRRIGATION SYSTEM SHALL NOT SPRAY OR IRRIGATE IMPERVIOUS SURFACES, INCLUDING SIDEWALKS, DRIVEWAYS, DRIVE AISLES, STREETS, AND PARKING AND LOADING AREAS.

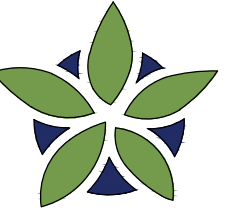

**YELLOWSTONE**  
LANDSCAPE

www.yellowstonelandscape.com  
P O Box 10597  
Albuquerque, NM 87184  
505.898.9615  
design@yellowstonelandscape.com



Date: 04/02/2024

Revisions:

- △
- △
- △
- △

Drawn by: PL

Reviewed by: CM

Universe View  
Apartment

Albuquerque, New Mexico

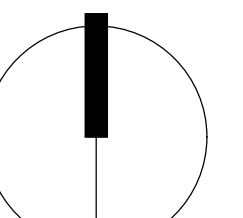

NORTH

Scale: 1" = 20'

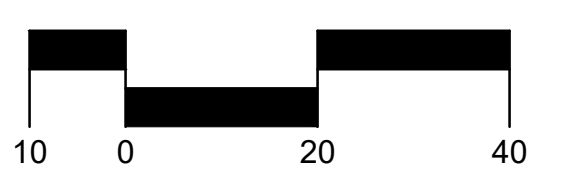

Sheet Title:

**Irrigation  
Plan**

Sheet Number:

**LI-03**



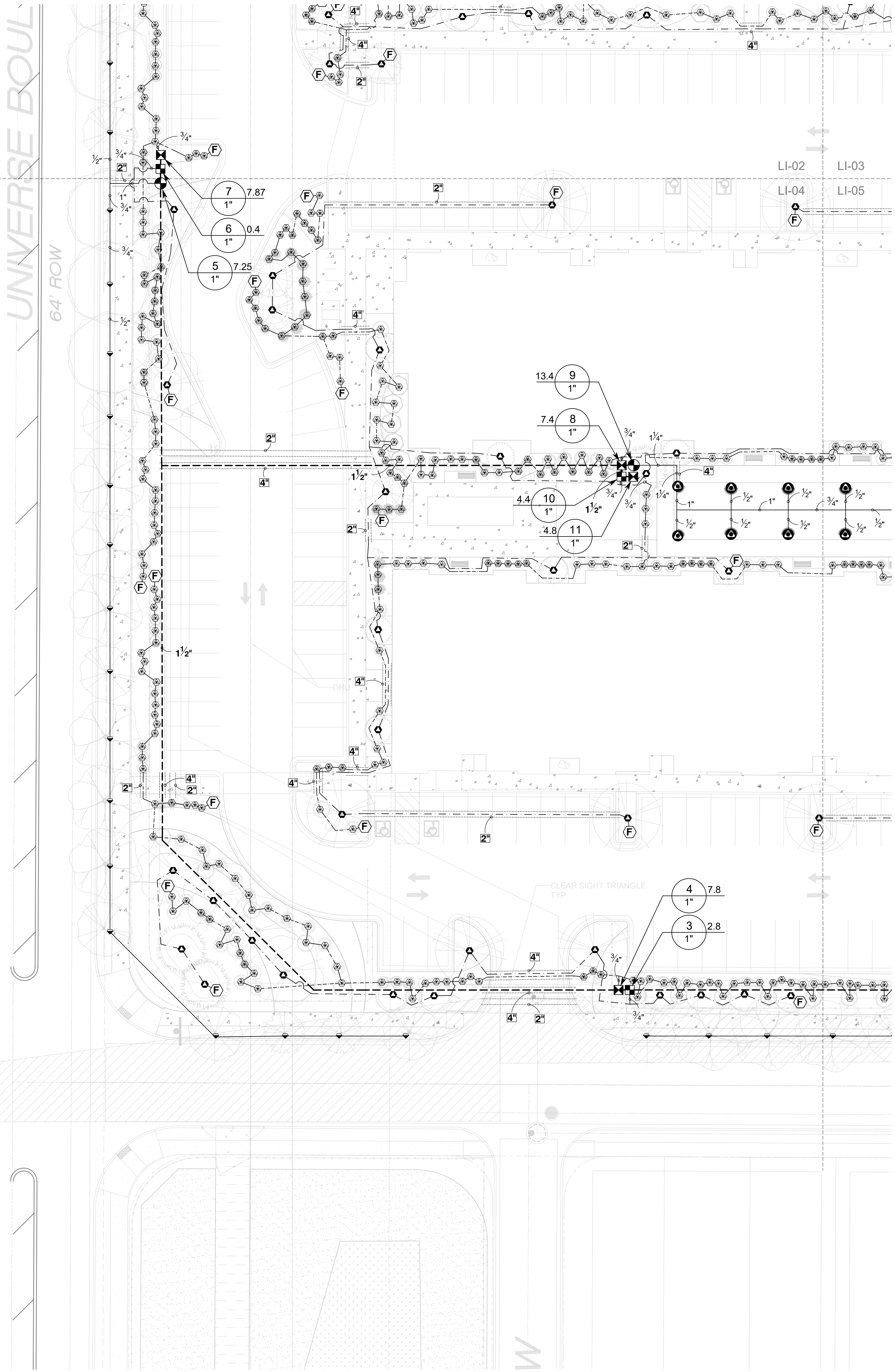

**IRRIGATION SCHEDULE**

SYMBOL	MANUFACTURER/MODEL/DESCRIPTION
	RAIN BIRD R-VAN24 - TURF ROTARY 1804-SAM-P45, 17FT.-24FT. 45-270 DEGREES AND 360 DEGREES, HAND ADJUSTABLE MULTI-STREAM ROTARY W/1800 TURF SPRAY BODY ON 4IN. POP-UP, WITH CHECK VALVE AND 45 PSI IN-STEM PRESSURE REGULATOR, 1/2IN. NPT FEMALE THREADED INLET.
	RAIN BIRD 1800-1400 FLOOD FIXED FLOW RATE 0.25 GPM - 2.0 GPM, FULL CIRCLE BUBBLER, 1/2IN. FIPT.
	RAIN BIRD 1401-1402-1404-1408 DRIP CONTROL VALVE - SHRUB RAIN BIRD XCZ-100-PRF, MEDIUM FLOW DRIP CONTROL KIT, 1IN. DV VALVE, 1IN. PRESSURE REGULATING FILTER, 40PSI PRESSURE REGULATOR. 5 GPM-20 GPM.
	RAIN BIRD 1401-1402-1404-1408 DRIP CONTROL VALVE - TREE RAIN BIRD XCZ-100-PRF, MEDIUM FLOW DRIP CONTROL KIT, 1IN. DV VALVE, 1IN. PRESSURE REGULATING FILTER, 40PSI PRESSURE REGULATOR. 3 GPM-15 GPM.
	TRANSITION FITTING PIPE TRANSITION POINT FROM PVC LATERAL TO DRIP TUBING WITH RISER IN 6IN. DRIP BOX.
	FLUSH CAP NDS CEP900
	DRIP EMITTER - SHRUB (2) NDS TAE 20 DRIP EMITTERS
	DRIP EMITTER - TREE (6) NDS TAE 20 DRIP EMITTERS
	CONTROL VALVE RAIN BIRD PEB, 1IN., 1-1/2IN., 2IN. PLASTIC INDUSTRIAL VALVES. LOW FLOW OPERATING CAPABILITY, GLOBE CONFIGURATION.
	MAIN SHUT OFF VALVE SPEARS SCH80 PVC COMPACT BALL VALVE
	MASTER VALVE 1" RAIN BIRD PEB, 1IN., 1-1/2IN., 2IN. PLASTIC INDUSTRIAL MASTER VALVES. LOW FLOW OPERATING CAPABILITY, GLOBE CONFIGURATION.
	REDUCED PRESSURE BACKFLOW PREVENTER 1" FEBCO 825Y
	CONTROLLER - RAIN BIRD ESP-LXD 50-200 STATION, 2-WIRE DECODER BASED CONTROLLER. (1) ESP-LXD 50-STATION, INDOOR/OUTDOOR, PLASTIC WALL-MOUNT ENCLOSURE. SYSTEM REQUIREMENTS: RAIN BIRD FD-XXX-TURF FIELD DECODERS, PAIGE ELECTRIC CABLE P7072D & RAIN BIRD WC20 DRY SPLICES ONLY. GROUND SYSTEM W/ (X) LSP-1TURF LINE SURGE PROTECTORS IN RAIN BIRD ROUND VALVE BOXES. INSTALL PER MANUFACTURERS RECOMMENDATIONS.
	FLOW SENSOR CREATIVE SENSOR TECHNOLOGY FSI-T10-001 1IN. PVC TEE TYPE FLOW SENSOR W/SOCKET ENDS, CUSTOM MOUNTING TEE AND ULTRA-LIGHTWEIGHT IMPELLER ENHANCES LOW FLOW MEASUREMENT. 2 WIRE DIGITAL OUTPUT COMPATIBLE W/ALL IRRIGATION CONTROLLERS. FLOW RANGE: .86 GPM - 52 GPM.
	POINT OF CONNECTION 1 1/2"
	IRRIGATION LATERAL LINE: PVC SCHEDULE 40
	IRRIGATION LATERAL LINE: A940 DRIP POLYLINE
	IRRIGATION LATERAL LINE: A940RDS DRIP POLYLINE
	IRRIGATION MAINLINE: PVC SCHEDULE 40
	PIPE SLEEVE: PVC CLASS 200 SDR 21

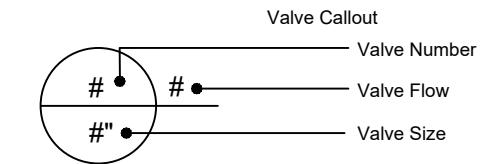

**IRRIGATION NOTES**

- THE LANDSCAPE CONTRACTOR SHALL FURNISH LABOR, MATERIALS AND EQUIPMENT TO INSTALL PROPOSED IRRIGATION SYSTEM AS SHOWN PER PLAN AND DETAILS.
- IF ANY ERRORS OR DISCREPANCIES APPEAR ON THE PLAN, THEY MUST BE BROUGHT TO THE ATTENTION OF THE LANDSCAPE ARCHITECT BEFORE CONSTRUCTION OF THE IRRIGATION SYSTEM BEGINS.
- LANDSCAPE INSTALLER SHALL PERFORM PRESSURE/GPM TEST AT POINT OF CONNECTION BEFORE INSTALLING IRRIGATION SYSTEM TO VERIFY PSI AND GPM FOR THE SITE.
- IRRIGATION SYSTEM HAS BEEN DESIGNED TO A MINIMUM DYNAMIC PRESSURE OF 75 PSI AT 50 GPM. IF THE PSI/GPM ARE LOWER THAN 75/50 THE LANDSCAPE ARCHITECT MUST BE NOTIFIED IMMEDIATELY.
- THE CONTRACTOR SHALL FIELD VERIFY UTILITY LOCATIONS AND MAKE ANY NECESSARY FIELD ADJUSTMENTS WITH GENERAL CONTRACTOR.
- THE LOCATION OF IRRIGATION EQUIPMENT IS APPROXIMATE AND SHALL BE LOCATED IN THE LANDSCAPE AREAS. ANY IRRIGATION EQUIPMENT AND PIPING SHOWN OUTSIDE OF LANDSCAPE AREAS ARE FOR GRAPHIC CLARITY ONLY.
- THE LANDSCAPE CONTRACTOR SHALL PROVIDE TO OWNER AN ACCURATE AS-BUILT IRRIGATION PLAN WHEN THE WORK IS COMPLETED. AS-BUILT DOCUMENTS SHOULD BE UPDATED WEEKLY FOR ACCURATE RECORDING OF IRRIGATION SYSTEM.
- VALVE LOCATIONS TO BE APPROVED BY LANDSCAPE ARCHITECT. VALVE BOX LIDS TO BE TAN IN GRAVEL AREAS AND GREEN IN SOD/SEED AREAS.
- ALL PLANTS WITHIN THE PROPERTY LINE SHALL BE IRRIGATED BY LOW FLOW POINT-SOURCE DRIP IRRIGATION SYSTEM.
- ALL PLANTS WITHIN PUBLIC RIGHT-OF-WAY SHALL BE IRRIGATED BY BUBBLER IRRIGATION SYSTEM PER COA SPEC. ALL PLANTS WITHIN THE PUBLIC RIGHT-OF-WAY SHALL BE ZONED SEPARATELY FROM THE PLANTS WITHIN THE PROPERTY LINE.
- POWER FOR IRRIGATION SYSTEM TO BE PROVIDED BY THE GENERAL CONTRACTOR. 110V POWER IS REQUIRED AT THE LOCATIONS OF THE IRRIGATION CONTROLLER AND BACKFLOW PREVENTER.
- BACKFLOW PREVENTER MUST BE TESTED AND CERTIFIED BEFORE FINAL ACCEPTANCE OF THE JOB.
- CONTROLLER LOCATION IS APPROXIMATE AND THE FINAL LOCATION WILL BE DETERMINED IN THE FIELD.
- SLEEVES TO BE INSTALLED, AS SHOWN PER PLAN, BEFORE HARDSCAPE IS INSTALLED. THE LANDSCAPE CONTRACTOR MUST BE GIVEN A MINIMUM OF 72 HOUR NOTICE BEFORE SLEEVE LOCATIONS ARE PAVED OVER.
- WATER METER TO BE PROVIDED BY OTHERS.
- PER 5-6(C)(14)(a), IRRIGATION SYSTEMS SHALL COMPLY WITH SECTION 8 OF THE ABCWUA LEGISLATION AND ORDINANCES (CROSS CONNECTION PREVENTION AND CONTROL ORDINANCE)
- PER 5-6(C)(14)(b), ALL IRRIGATION SYSTEMS SHALL BE DESIGNED TO MINIMIZE THE USE OF WATER.
- PER 5-6(C)(14)(c), ALL NON-RESIDENTIAL LANDSCAPE IRRIGATION SHALL HAVE AUTOMATIC TIMERS AND/OR PROGRAMMABLE SETTINGS TO AVOID OVERWATERING.
- PER 5-6(C)(14)(d), THE IRRIGATION SYSTEM SHALL NOT SPRAY OR IRRIGATE IMPERVIOUS SURFACES, INCLUDING SIDEWALKS, DRIVEWAYS, DRIVE AISLES, STREETS, AND PARKING AND LOADING AREAS.

**YELLOWSTONE**  
LANDSCAPE  
www.yellowstonelandscape.com  
P O Box 10597  
Albuquerque, NM 87184  
505.898.9615  
design@yellowstonelandscape.com

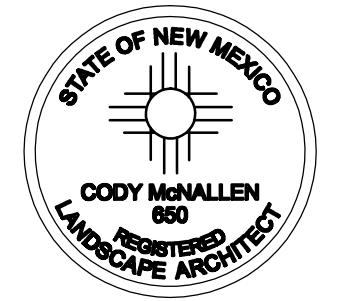

Date: 04/02/2024  
Revisions:  
 △  
 △  
 △  
 △

Drawn by: PL  
Reviewed by: CM

**Universe View**  
**Apartment**  
 Albuquerque, New Mexico

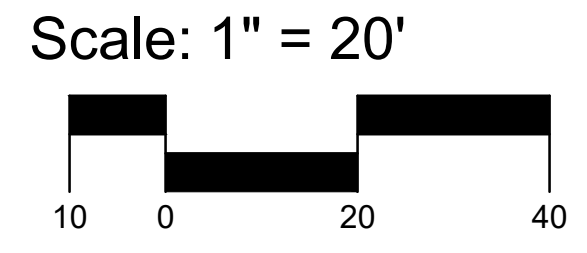
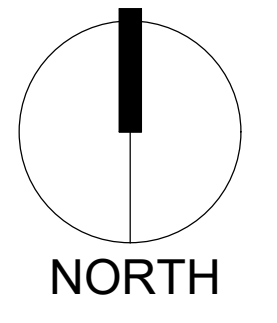

Sheet Title:  
**Irrigation**  
**Plan**

Sheet Number:  
**LI-04**



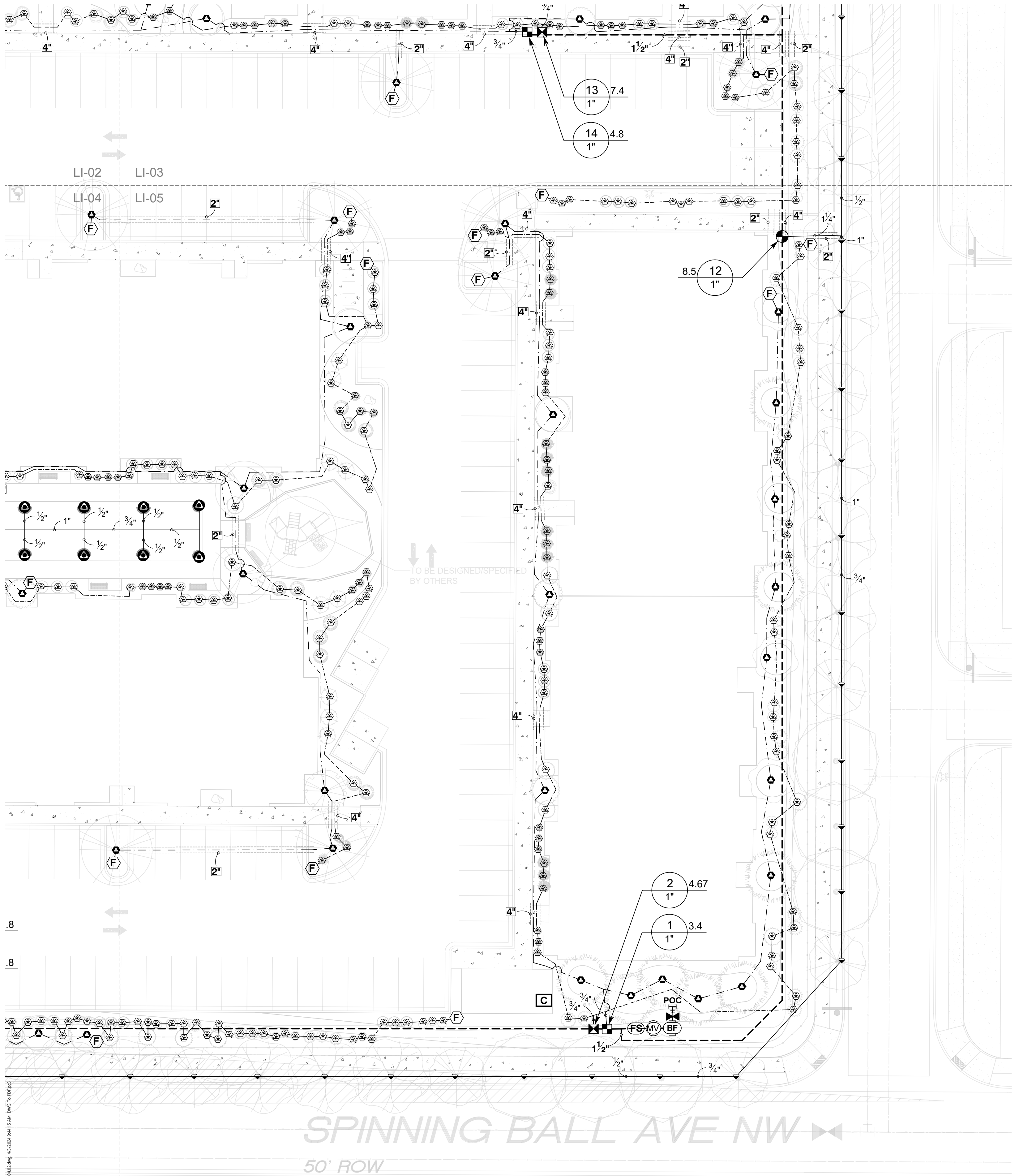

**IRRIGATION SCHEDULE**

SYMBOL	MANUFACTURER/MODEL/DESCRIPTION
	RAIN BIRD R-VAN24 - TURF ROTARY 1804-SAM-P45, 17FT.-24FT. 45-270 DEGREES AND 360 DEGREES, HAND ADJUSTABLE MULTI-STREAM ROTARY W/1800 TURF SPRAY BODY ON 4IN. POP-UP, WITH CHECK VALVE AND 45 PSI IN-STEM PRESSURE REGULATOR, 1/2IN. NPT FEMALE THREADED INLET.
	RAIN BIRD 1800-1400 FLOOD FIXED FLOW RATE 0.25 GPM - 2.0 GPM, FULL CIRCLE BUBBLER, 1/2IN. FIPT.
SYMBOL	MANUFACTURER/MODEL/DESCRIPTION
	DRIP CONTROL VALVE - SHRUB RAIN BIRD XCZ-100-PRF, MEDIUM FLOW DRIP CONTROL KIT, 1IN. DV VALVE, 1IN. PRESSURE REGULATING FILTER, 40PSI PRESSURE REGULATOR. 5 GPM-20 GPM.
	DRIP CONTROL VALVE - TREE RAIN BIRD XCZ-100-PRF, MEDIUM FLOW DRIP CONTROL KIT, 1IN. DV VALVE, 1IN. PRESSURE REGULATING FILTER, 40PSI PRESSURE REGULATOR. 3 GPM-15 GPM.
	TRANSITION FITTING PIPE TRANSITION POINT FROM PVC LATERAL TO DRIP TUBING WITH RISER IN 6IN. DRIP BOX.
	FLUSH CAP NDS CEP900
	DRIP EMITTER - SHRUB (2) NDS TAE 20 DRIP EMITTERS
	DRIP EMITTER - TREE (6) NDS TAE 20 DRIP EMITTERS
SYMBOL	MANUFACTURER/MODEL/DESCRIPTION
	CONTROL VALVE RAIN BIRD PEB, 1IN., 1-1/2IN., 2IN. PLASTIC INDUSTRIAL VALVES. LOW FLOW OPERATING CAPABILITY, GLOBE CONFIGURATION.
	MAIN SHUT OFF VALVE SPEARS SCH80 PVC COMPACT BALL VALVE
	MASTER VALVE 1" RAIN BIRD PEB, 1IN., 1-1/2IN., 2IN. PLASTIC INDUSTRIAL MASTER VALVES. LOW FLOW OPERATING CAPABILITY, GLOBE CONFIGURATION.
	REDUCED PRESSURE BACKFLOW PREVENTER 1" FEBCO 825Y
	CONTROLLER - RAIN BIRD ESP-LXD 50-200 STATION, 2-WIRE DECODER BASED CONTROLLER. (1) ESP-LXD 50-STATION, INDOOR/OUTDOOR, PLASTIC WALL-MOUNT ENCLOSURE. SYSTEM REQUIREMENTS: RAIN BIRD FD-XXX-TURF FIELD DECODERS, PAIGE ELECTRIC CABLE P7072D & RAIN BIRD WC20 DRY SPLICES ONLY. GROUND SYSTEM W/ (X) LSP-1TURF LINE SURGE PROTECTORS IN RAIN BIRD ROUND VALVE BOXES. INSTALL PER MANUFACTURERS RECOMMENDATIONS.
	FLOW SENSOR CREATIVE SENSOR TECHNOLOGY FSI-T10-001 1IN. PVC TEE TYPE FLOW SENSOR W/SOCKET ENDS, CUSTOM MOUNTING TEE AND ULTRA-LIGHTWEIGHT IMPELLER ENHANCES LOW FLOW MEASUREMENT. 2 WIRE DIGITAL OUTPUT COMPATIBLE W/ALL IRRIGATION CONTROLLERS. FLOW RANGE: .86 GPM - 52 GPM.
	POINT OF CONNECTION 1 1/2"
	IRRIGATION LATERAL LINE: PVC SCHEDULE 40
	IRRIGATION LATERAL LINE: A940 DRIP POLYLINE
	IRRIGATION LATERAL LINE: A940RDS DRIP POLYLINE
	IRRIGATION MAINLINE: PVC SCHEDULE 40
	PIPE SLEEVE: PVC CLASS 200 SDR 21

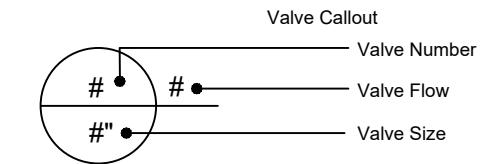

**IRRIGATION NOTES**

- THE LANDSCAPE CONTRACTOR SHALL FURNISH LABOR, MATERIALS AND EQUIPMENT TO INSTALL PROPOSED IRRIGATION SYSTEM AS SHOWN PER PLAN AND DETAILS.
- IF ANY ERRORS OR DISCREPANCIES APPEAR ON THE PLAN, THEY MUST BE BROUGHT TO THE ATTENTION OF THE LANDSCAPE ARCHITECT BEFORE CONSTRUCTION OF THE IRRIGATION SYSTEM BEGINS.
- LANDSCAPE INSTALLER SHALL PERFORM PRESSURE/GPM TEST AT POINT OF CONNECTION BEFORE INSTALLING IRRIGATION SYSTEM TO VERIFY PSI AND GPM FOR THE SITE.
- IRRIGATION SYSTEM HAS BEEN DESIGNED TO A MINIMUM DYNAMIC PRESSURE OF 75 PSI AT 50 GPM. IF THE PSI/GPM ARE LOWER THAN 75/50 THE LANDSCAPE ARCHITECT MUST BE NOTIFIED IMMEDIATELY.
- THE CONTRACTOR SHALL FIELD VERIFY UTILITY LOCATIONS AND MAKE ANY NECESSARY FIELD ADJUSTMENTS WITH GENERAL CONTRACTOR.
- THE LOCATION OF IRRIGATION EQUIPMENT IS APPROXIMATE AND SHALL BE LOCATED IN THE LANDSCAPE AREAS. ANY IRRIGATION EQUIPMENT AND PIPING SHOWN OUTSIDE OF LANDSCAPE AREAS ARE FOR GRAPHIC CLARITY ONLY.
- THE LANDSCAPE CONTRACTOR SHALL PROVIDE TO OWNER AN ACCURATE AS-BUILT IRRIGATION PLAN WHEN THE WORK IS COMPLETED. AS-BUILT DOCUMENTS SHOULD BE UPDATED WEEKLY FOR ACCURATE RECORDING OF IRRIGATION SYSTEM.
- VALVE LOCATIONS TO BE APPROVED BY LANDSCAPE ARCHITECT. VALVE BOX LIDS TO BE TAN IN GRAVEL AREAS AND GREEN IN SOD/SEED AREAS.
- ALL PLANTS WITHIN THE PROPERTY LINE SHALL BE IRRIGATED BY LOW FLOW POINT-SOURCE DRIP IRRIGATION SYSTEM.
- ALL PLANTS WITHIN PUBLIC RIGHT-OF-WAY SHALL BE IRRIGATED BY BUBBLER IRRIGATION SYSTEM PER COA SPEC. ALL PLANTS WITHIN THE PUBLIC RIGHT-OF-WAY SHALL BE ZONED SEPARATELY FROM THE PLANTS WITHIN THE PROPERTY LINE.
- POWER FOR IRRIGATION SYSTEM TO BE PROVIDED BY THE GENERAL CONTRACTOR. 110V POWER IS REQUIRED AT THE LOCATIONS OF THE IRRIGATION CONTROLLER AND BACKFLOW PREVENTER.
- BACKFLOW PREVENTER MUST BE TESTED AND CERTIFIED BEFORE FINAL ACCEPTANCE OF THE JOB.
- CONTROLLER LOCATION IS APPROXIMATE AND THE FINAL LOCATION WILL BE DETERMINED IN THE FIELD.
- SLEEVES TO BE INSTALLED, AS SHOWN PER PLAN, BEFORE HARDSCAPE IS INSTALLED. THE LANDSCAPE CONTRACTOR MUST BE GIVEN A MINIMUM OF 72 HOUR NOTICE BEFORE SLEEVE LOCATIONS ARE PAVED OVER. WATER METER TO BE PROVIDED BY OTHERS.
- PER 5-6(C)(14)(a), IRRIGATION SYSTEMS SHALL COMPLY WITH SECTION 8 OF THE ABCWUA LEGISLATION AND ORDINANCES (CROSS CONNECTION PREVENTION AND CONTROL ORDINANCE)
- PER 5-6(C)(14)(b), ALL IRRIGATION SYSTEMS SHALL BE DESIGNED TO MINIMIZE THE USE OF WATER.
- PER 5-6(C)(14)(c), ALL NON-RESIDENTIAL LANDSCAPE IRRIGATION SHALL HAVE AUTOMATIC TIMERS AND/OR PROGRAMMABLE SETTINGS TO AVOID OVERWATERING.
- PER 5-6(C)(14)(d), THE IRRIGATION SYSTEM SHALL NOT SPRAY OR IRRIGATE IMPERVIOUS SURFACES, INCLUDING SIDEWALKS, DRIVEWAYS, DRIVE AISLES, STREETS, AND PARKING AND LOADING AREAS.

**YELLOWSTONE**  
LANDSCAPE  
www.yellowstonelandscape.com  
P O Box 10597  
Albuquerque, NM 87184  
505.898.9615  
design@yellowstonelandscape.com

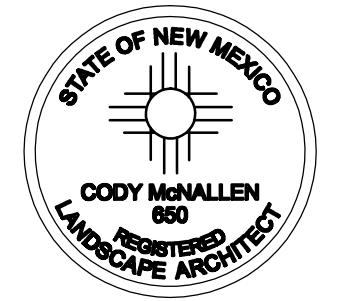

Date: 04/02/2024  
Revisions:  
△  
△  
△  
△

Drawn by: PL  
Reviewed by: CM

Universe View  
Apartment  
Albuquerque, New Mexico

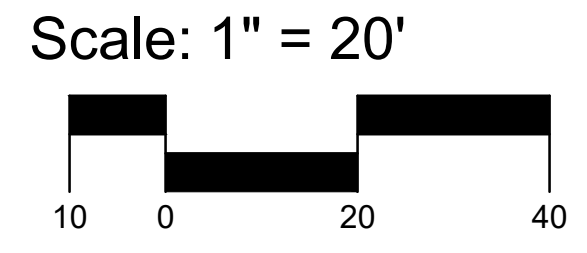
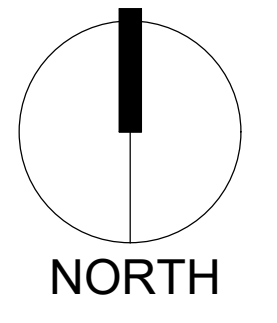

Sheet Title:  
**Irrigation  
Plan**

Sheet Number:  
**LI-05**



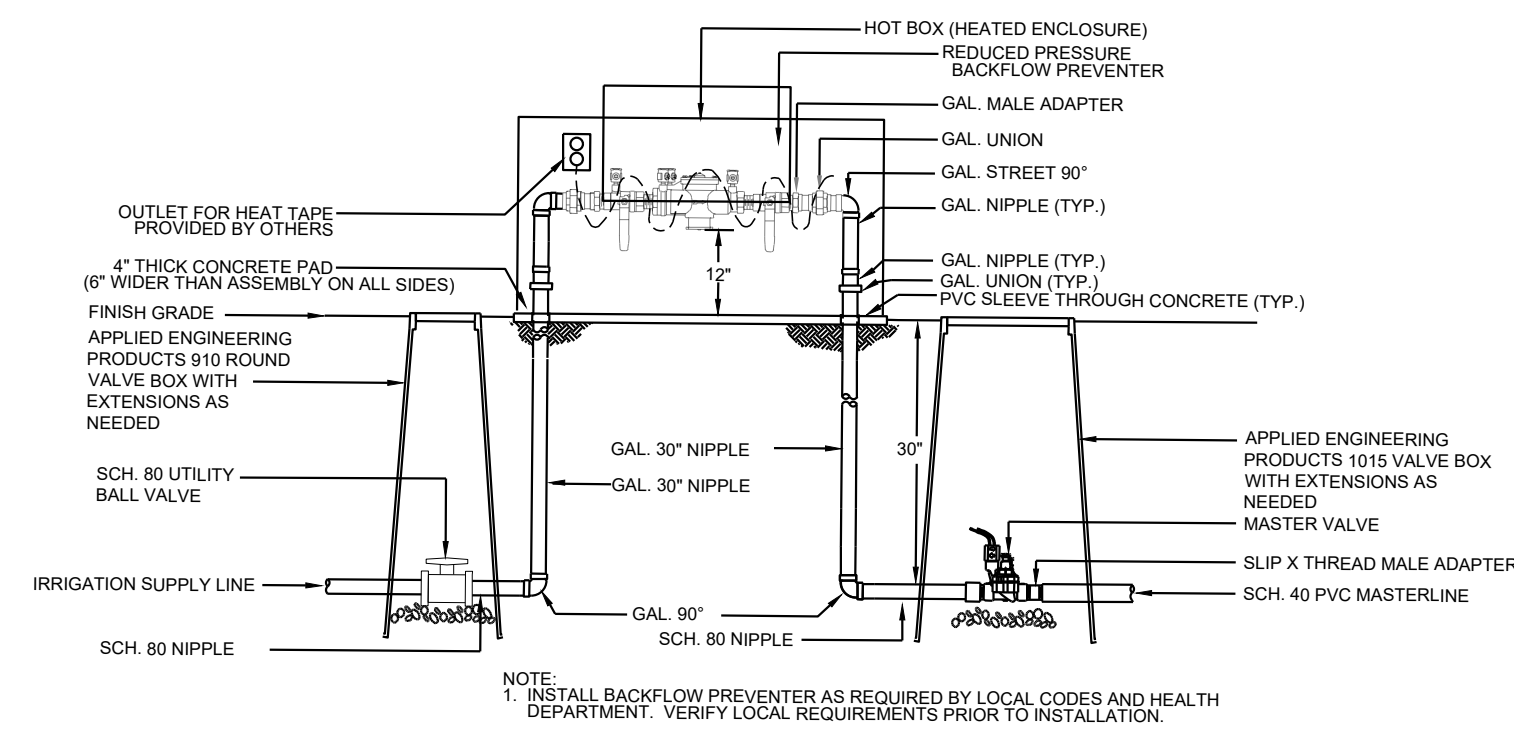

1 RP BACKFLOW/MASTER VALVE DETAIL N.T.S.

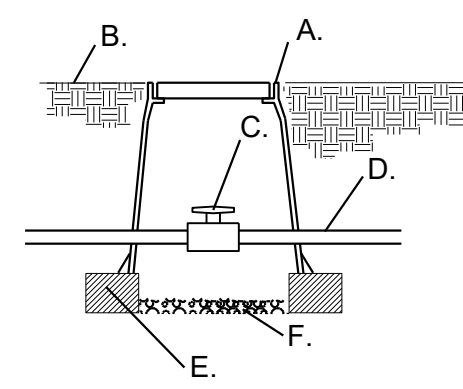

- A. APPLIED ENGINEERING PRODUCTS 910 ROUND VALVE BOX WITH EXTENSIONS AS NEEDED
- B. FINISH GRADE
- C. SCH. 80 UTILITY BALL VALVE
- D. MAINLINE/24" BURY
- E. 8" X 8" X 16" CMU CONCRETE BLOCK
- F. 4" LAYER OF 3/4" GRAVEL

2 MAINLINE ISOLATION VALVE DETAIL N.T.S.

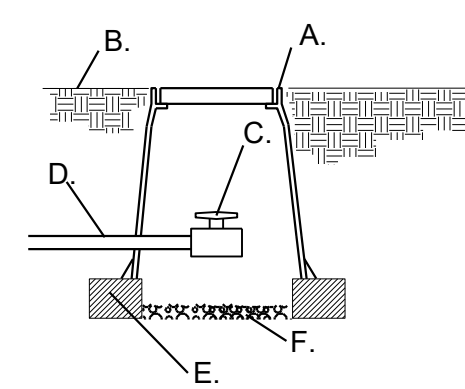

- A. APPLIED ENGINEERING PRODUCTS 910 ROUND VALVE BOX WITH EXTENSIONS AS NEEDED
- B. FINISH GRADE
- C. SCH. 80 UTILITY BALL VALVE
- D. MAINLINE/24" BURY
- E. 8" X 8" X 16" CMU CONCRETE BLOCK
- F. 3/4" GRAVEL SUMP UNDER MANUAL DRAIN TO BE A MINIMUM OF 12" DEEP

3 MANUAL DRAIN VALVE DETAIL N.T.S.

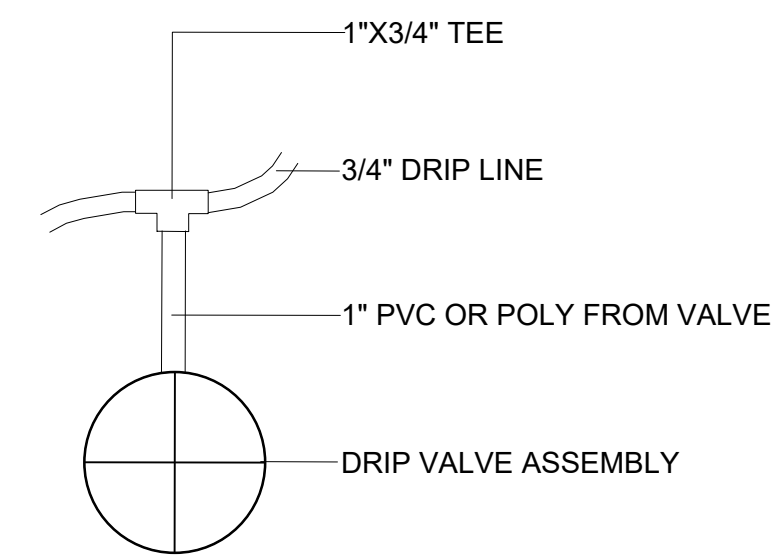

4 DRIP VALVE DETAIL N.T.S.

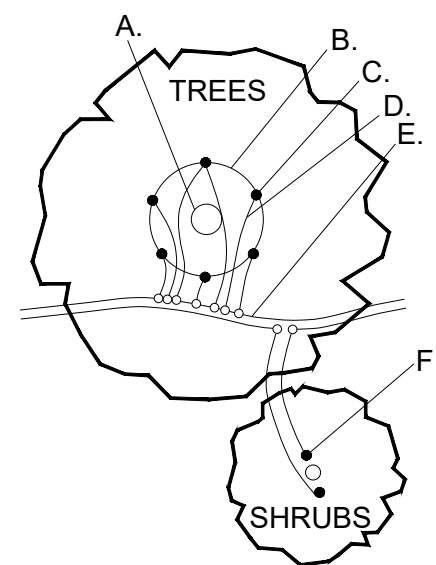

- A. TREE TRUNK/ ROOT CROWN
  - B. 24" CIRCLE FROM TRUNK
  - C. EMITTERS
  - D. 1/4" DISTRIBUTION LINE
  - E. PE DRIFLINE
  - F. EMITTER PLACED WITHIN 6" OF PLANT STEM
- NOTE: INSTALL EMITTERS ABOVE THE ROOT BALL IF PLANT IS INSTALLED ON A SLOPE.

5 EMITTER PLACEMENT DETAIL N.T.S.

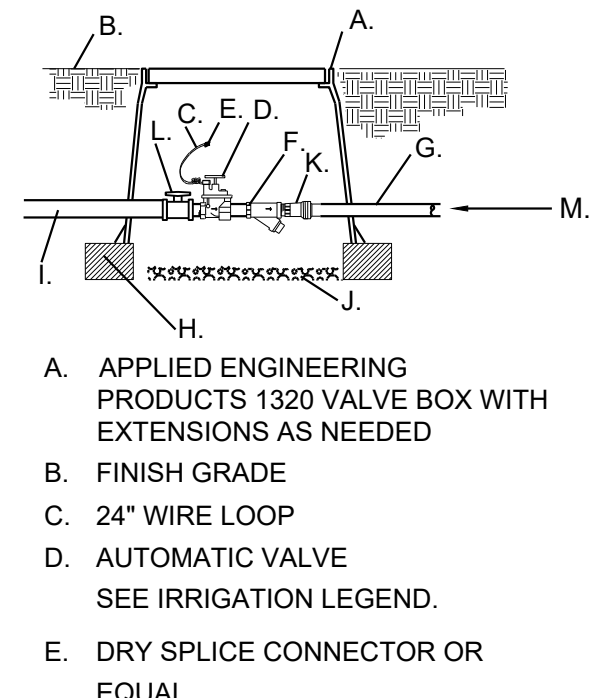

- F. "WYE" STRAINER STRAINER SHALL BE INSTALLED TO PROVIDE ACCESS FOR MAINTENANCE AND REPLACEMENT OF FILTER
  - G. LATERAL LINE/24" BURY
  - H. 8" X 8" X 16" CMU CONCRETE BLOCK
  - I. MASTERLINE/24" BURY
  - J. 4" LAYER OF 3/4" GRAVEL
  - K. PRESSURE REGULATOR
  - L. SCH. 80 TRUE UNION BALL VALVE
  - M. SCH. 40 PVC LATERAL LINE
- A. APPLIED ENGINEERING PRODUCTS 1320 VALVE BOX WITH EXTENSIONS AS NEEDED
  - B. FINISH GRADE
  - C. 24" WIRE LOOP
  - D. AUTOMATIC VALVE SEE IRRIGATION LEGEND.
  - E. DRY SPLICE CONNECTOR OR EQUAL

6 DRIP VALVE WITH FILTER & PRESSURE REGULATOR N.T.S.

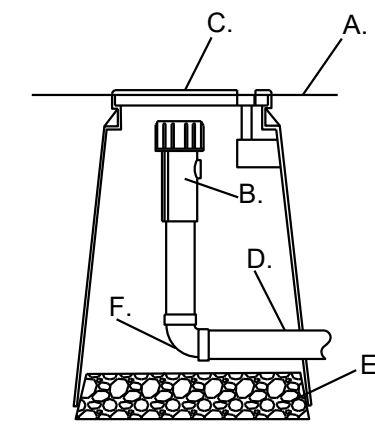

- A. FINISH GRADE
- B. END FLUSH CAP
- C. 6" ROUND BOX WITH LID
- D. 3/4" POLY DRIP PIPE
- E. 2" DEPTH OF GRAVEL
- F. 90° FITTING

7 END FLUSH CAP N.T.S.

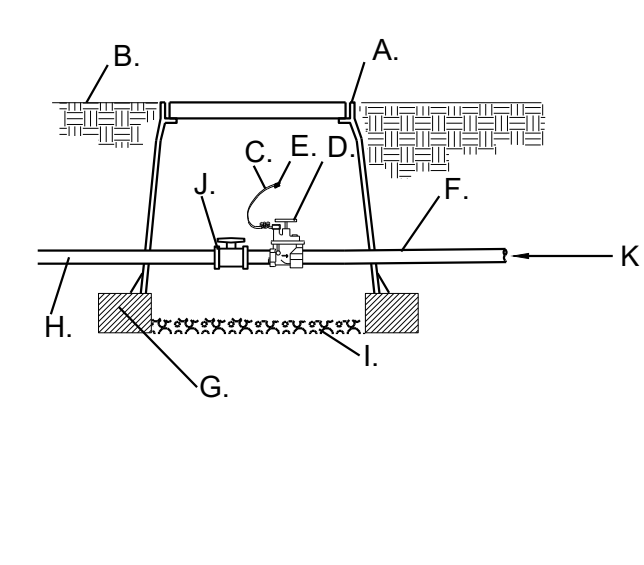

- A. APPLIED ENGINEERING PRODUCTS 1320 VALVE BOX WITH EXTENSIONS AS NEEDED
- B. FINISH GRADE
- C. 24" WIRE LOOP
- D. AUTOMATIC VALVE- SEE IRRIGATION LEGEND.
- E. DRY SPLICE CONNECTOR OR EQUAL
- F. LATERAL LINE/24" BURY
- G. 8" X 8" X 16" CMU CONCRETE BLOCK
- H. MASTERLINE/24" BURY
- I. 4" LAYER OF 3/4" GRAVEL
- J. SCH. 80 TRUE UNION BALL VALVE
- K. SCH. 40 PVC LATERAL LINE

8 AUTOMATIC VALVE N.T.S.

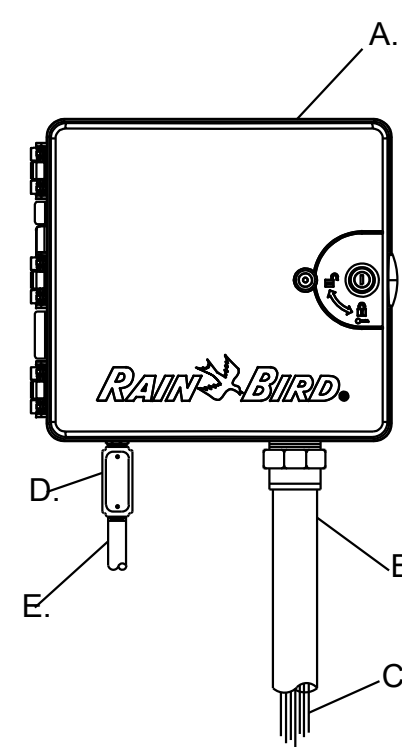

- A. CONTROLLER (see plan for model)
- B. 2" PVC SCH. 40 CONDUIT AND FITTINGS
- C. WIRES TO REMOTE CONTROL VALVES
- D. JUNCTION BOX
- E. 1" PVC SCH. 40 CONDUIT AND FITTINGS TO POWER SUPPLY

9 WALL MOUNTED AUTOMATIC CONTROLLER N.T.S.

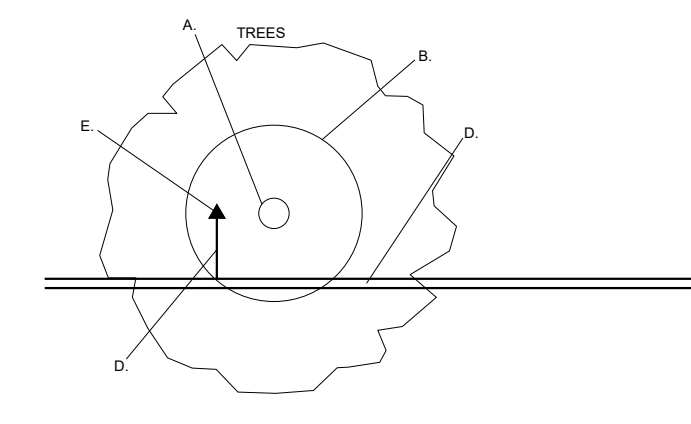

- A. TREE TRUNK/ ROOT CROWN
  - B. 36" DIA BERM AROUND TREE
  - C. 24" DIA BERM AROUND SHRUB
  - D. PVC LATERAL PIPE (SIZE VARIES)
  - E. BUBBLER PLACED 6" INSIDE BERM
- NOTE: INSTALL BUBBLER(S) ABOVE THE ROOT BALL IF PLANT IS INSTALLED ON A SLOPE.

10 BUBBLER PLACEMENT DETAIL N.T.S.

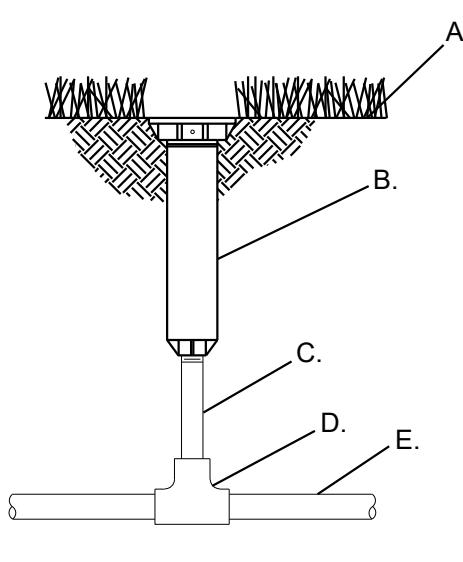

- A. FINISH GRADE
- B. POP-UP SPRAY SPRINKLER: RAIN BIRD 1804-SAM-PRS BODY WITH RAINBIRD R-VAN NOZZLE
- C. PVC SCH.40 NIPPLE
- D. PVC SCH.40 TEE
- E. PVC LATERAL LINE

11 ROTATOR SPRINKLER N.T.S.

IRRIGATION NOTES

1. THE LANDSCAPE CONTRACTOR SHALL FURNISH LABOR, MATERIALS AND EQUIPMENT TO INSTALL PROPOSED IRRIGATION SYSTEM AS SHOWN PER PLAN AND DETAILS.
2. IF ANY ERRORS OR DISCREPANCIES APPEAR ON THE PLAN, THEY MUST BE BROUGHT TO THE ATTENTION OF THE LANDSCAPE ARCHITECT BEFORE CONSTRUCTION OF THE IRRIGATION SYSTEM BEGINS.
3. LANDSCAPE INSTALLER SHALL PERFORM PRESSURE/GPM TEST AT POINT OF CONNECTION BEFORE INSTALLING IRRIGATION SYSTEM TO VERIFY PSI AND GPM FOR THE SITE.
4. IRRIGATION SYSTEM HAS BEEN DESIGNED TO A MINIMUM DYNAMIC PRESSURE OF 75 PSI AT 50 GPM. IF THE PSI/GPM ARE LOWER THAN 75/50 THE LANDSCAPE ARCHITECT MUST BE NOTIFIED IMMEDIATELY.
5. THE CONTRACTOR SHALL FIELD VERIFY UTILITY LOCATIONS AND MAKE ANY NECESSARY FIELD ADJUSTMENTS WITH GENERAL CONTRACTOR.
6. THE LOCATION OF IRRIGATION EQUIPMENT IS APPROXIMATE AND SHALL BE LOCATED IN THE LANDSCAPE AREAS. ANY IRRIGATION EQUIPMENT AND PIPING SHOWN OUTSIDE OF LANDSCAPE AREAS ARE FOR GRAPHIC CLARITY ONLY.
7. THE LANDSCAPE CONTRACTOR SHALL PROVIDE TO OWNER AN ACCURATE AS-BUILT IRRIGATION PLAN WHEN THE WORK IS COMPLETED. AS-BUILT DOCUMENTS SHOULD BE UPDATED WEEKLY FOR ACCURATE RECORDING OF IRRIGATION SYSTEM.
8. VALVE LOCATIONS TO BE APPROVED BY LANDSCAPE ARCHITECT. VALVE BOX LIDS TO BE TAN IN GRAVEL AREAS AND GREEN IN SOD/SEED AREAS.
9. ALL PLANTS WITHIN THE PROPERTY LINE SHALL BE IRRIGATED BY LOW FLOW POINT-SOURCE DRIP IRRIGATION SYSTEM.
10. ALL PLANTS WITHIN PUBLIC RIGHT-OF-WAY SHALL BE IRRIGATED BY BUBBLER IRRIGATION SYSTEM PER COA SPEC. ALL PLANTS WITHIN THE PUBLIC RIGHT-OF-WAY SHALL BE ZONED SEPARATELY FROM THE PLANTS WITHIN THE PROPERTY LINE.
11. POWER FOR IRRIGATION SYSTEM TO BE PROVIDED BY THE GENERAL CONTRACTOR. 110V POWER IS REQUIRED AT THE LOCATIONS OF THE IRRIGATION CONTROLLER AND BACKFLOW PREVENTER.
12. BACKFLOW PREVENTER MUST BE TESTED AND CERTIFIED BEFORE FINAL ACCEPTANCE OF THE JOB.
13. CONTROLLER LOCATION IS APPROXIMATE AND THE FINAL LOCATION WILL BE DETERMINED IN THE FIELD.
14. SLEEVES TO BE INSTALLED, AS SHOWN PER PLAN, BEFORE HARDSCAPE IS INSTALLED. THE LANDSCAPE CONTRACTOR MUST BE GIVEN A MINIMUM OF 72 HOUR NOTICE BEFORE SLEEVE LOCATIONS ARE PAVED OVER. WATER METER TO BE PROVIDED BY OTHERS.
15. PER 5-6(C)(14)(a), IRRIGATION SYSTEMS SHALL COMPLY WITH SECTION 8 OF THE ABCWUA LEGISLATION AND ORDINANCES (CROSS CONNECTION PREVENTION AND CONTROL ORDINANCE)
17. PER 5-6(C)(14)(b), ALL IRRIGATION SYSTEMS SHALL BE DESIGNED TO MINIMIZE THE USE OF WATER.
18. PER 5-6(C)(14)(c), ALL NON-RESIDENTIAL LANDSCAPE IRRIGATION SHALL HAVE AUTOMATIC TIMERS AND/OR PROGRAMMABLE SETTINGS TO AVOID OVERWATERING.
19. PER 5-6(C)(14)(d), THE IRRIGATION SYSTEM SHALL NOT SPRAY OR IRRIGATE IMPERVIOUS SURFACES, INCLUDING SIDEWALKS, DRIVEWAYS, DRIVE AISLES, STREETS, AND PARKING AND LOADING AREAS.

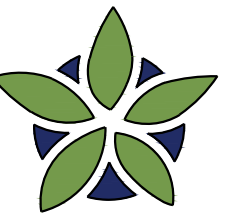

**YELLOWSTONE**  
LANDSCAPE  
www.yellowstonelandscape.com  
PO Box 10597  
Albuquerque, NM 87184  
505.898.9615  
design@yellowstonelandscape.com



Date: 04/02/2024

- Revisions:
- △
  - △
  - △
  - △
  - △

Drawn by: PL  
Reviewed by: CM

Universe View  
Apartment  
Albuquerque, New Mexico

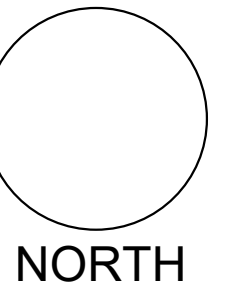

Sheet Title:  
**Irrigation  
Plan**

Sheet Number:

**LI-06**