

CASE NUMBER: Z-94-87

1. Verify that this site is in a Zoned... and that this...
 Environmental Planning Commission (EPC) on July 21, 1994 and that the...
 change in the Official Maps have been completed.

Site Development Plan
 Date: 9-14-94
 Date: 8-9-94
 Date: 8-9-94
 Date: 10-5-94
 Date: 10-12-94

ALAMEDA CENTER NORTH DESIGN GUIDELINES
 WALK: WALK WITH A CHILDREN'S WALKER (WALKER)
 WALK: WALK WITH A WHEELCHAIR (WHEELCHAIR)
 WALK: WALK WITH A STROLLER (STROLLER)
 WALK: WALK WITH A BICYCLE (BICYCLE)
 WALK: WALK WITH A MOTORCYCLE (MOTORCYCLE)
 WALK: WALK WITH A CAR (CAR)
 WALK: WALK WITH A TRUCK (TRUCK)
 WALK: WALK WITH A BUS (BUS)
 WALK: WALK WITH A TRAIN (TRAIN)
 WALK: WALK WITH A PLANE (PLANE)
 WALK: WALK WITH A SHIP (SHIP)
 WALK: WALK WITH A BOAT (BOAT)
 WALK: WALK WITH A SUBMARINE (SUBMARINE)
 WALK: WALK WITH A SPACE SHUTTLE (SPACE SHUTTLE)
 WALK: WALK WITH A ROCKET (ROCKET)
 WALK: WALK WITH A MISSILE (MISSILE)
 WALK: WALK WITH A BOMB (BOMB)
 WALK: WALK WITH A NUCLEAR BOMB (NUCLEAR BOMB)
 WALK: WALK WITH A THERMOCORE (THERMOCORE)
 WALK: WALK WITH A HYDROGEN BOMB (HYDROGEN BOMB)
 WALK: WALK WITH A THERMOCORE (THERMOCORE)
 WALK: WALK WITH A HYDROGEN BOMB (HYDROGEN BOMB)



design: collaborative
 architect: southwest inc.
 engineer: 105 4th st. sw. albuquerque, nm. 87102
 phone: 505-843-8839

job no: 9414
 date: 8-2-94
 sheet: DRBA.1 of 3

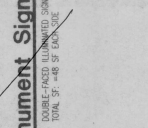
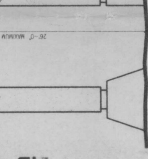
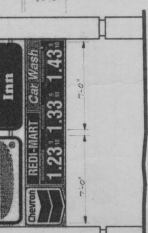
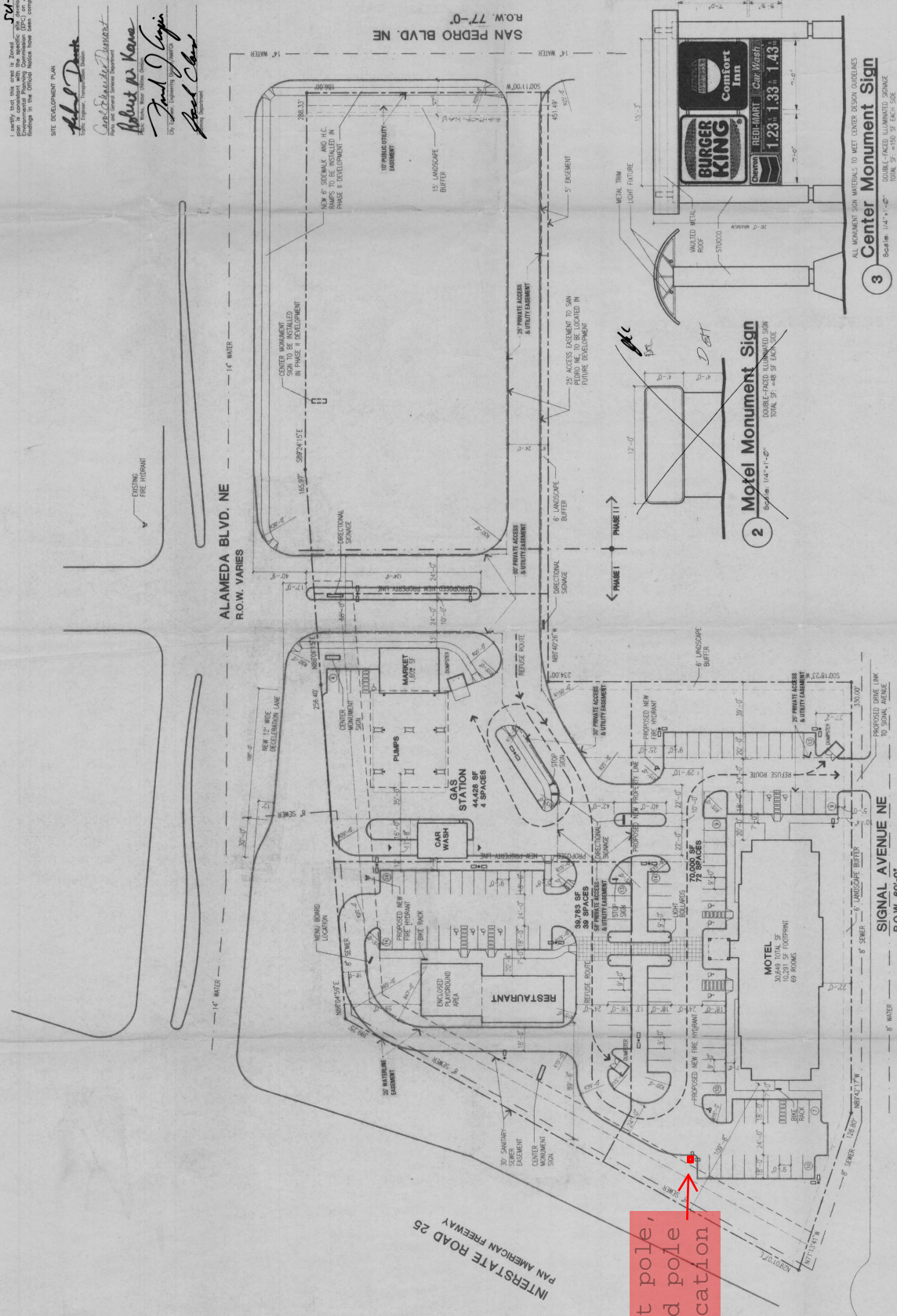

Center Monument Sign
 Scale: 1/4" = 1'-0"
 ALL MONUMENT SIGN MATERIALS TO MEET CENTER DESIGN GUIDELINES
 SIGN: 12'-3" x 13'-3" x 14'-3"
 SIGN: 12'-3" x 13'-3" x 14'-3"

PARKING CALCULATIONS

RESTAURANT	: 1 CAR/4 SEATS, 1 CAR/200 SF, 25-100-35
MOTEL	: 1 CAR/1 REVENUE UNIT
GAS STATION	: 1 CAR/200 SF
TOTAL	: 112
TOTAL PARKING PROVIDED	: 104
STANDARD STALL (9'x20')	: 104
HANDICAP PARKING (15'x20')	: 0
TOTAL	: 104
NET V.N. PARKING (10'x20')	: 115

LAND USE DATA

RESTAURANT	: 12,13,14,15,16,20,21,22,23,24,25,26,27,28,29,30,31,32,33,34,35,36,37,38,39,40,41,42,43,44,45,46,47,48,49,50,51,52,53,54,55,56,57,58,59,60,61,62,63,64,65,66,67,68,69,70,71,72,73,74,75,76,77,78,79,80,81,82,83,84,85,86,87,88,89,90,91,92,93,94,95,96,97,98,99,100
MOTEL	: 101,102,103,104,105,106,107,108,109,110,111,112,113,114,115,116,117,118,119,120,121,122,123,124,125,126,127,128,129,130,131,132,133,134,135,136,137,138,139,140,141,142,143,144,145,146,147,148,149,150,151,152,153,154,155,156,157,158,159,160,161,162,163,164,165,166,167,168,169,170,171,172,173,174,175,176,177,178,179,180,181,182,183,184,185,186,187,188,189,190,191,192,193,194,195,196,197,198,199,200
GAS STATION	: 201,202,203,204,205,206,207,208,209,210,211,212,213,214,215,216,217,218,219,220,221,222,223,224,225,226,227,228,229,230,231,232,233,234,235,236,237,238,239,240,241,242,243,244,245,246,247,248,249,250,251,252,253,254,255,256,257,258,259,260,261,262,263,264,265,266,267,268,269,270,271,272,273,274,275,276,277,278,279,280,281,282,283,284,285,286,287,288,289,290,291,292,293,294,295,296,297,298,299,300
MARKET	: 301,302,303,304,305,306,307,308,309,310,311,312,313,314,315,316,317,318,319,320,321,322,323,324,325,326,327,328,329,330,331,332,333,334,335,336,337,338,339,340,341,342,343,344,345,346,347,348,349,350,351,352,353,354,355,356,357,358,359,360,361,362,363,364,365,366,367,368,369,370,371,372,373,374,375,376,377,378,379,380,381,382,383,384,385,386,387,388,389,390,391,392,393,394,395,396,397,398,399,400

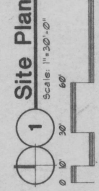

Z-94-87

No light pole,
 proposed pole
 sign location