

**ADMINISTRATIVE AMENDMENT**

**FILE # \_\_\_\_\_ PROJECT # \_\_\_\_\_**

\_\_\_\_\_

\_\_\_\_\_

\_\_\_\_\_

**APPROVED BY**

**DATE**

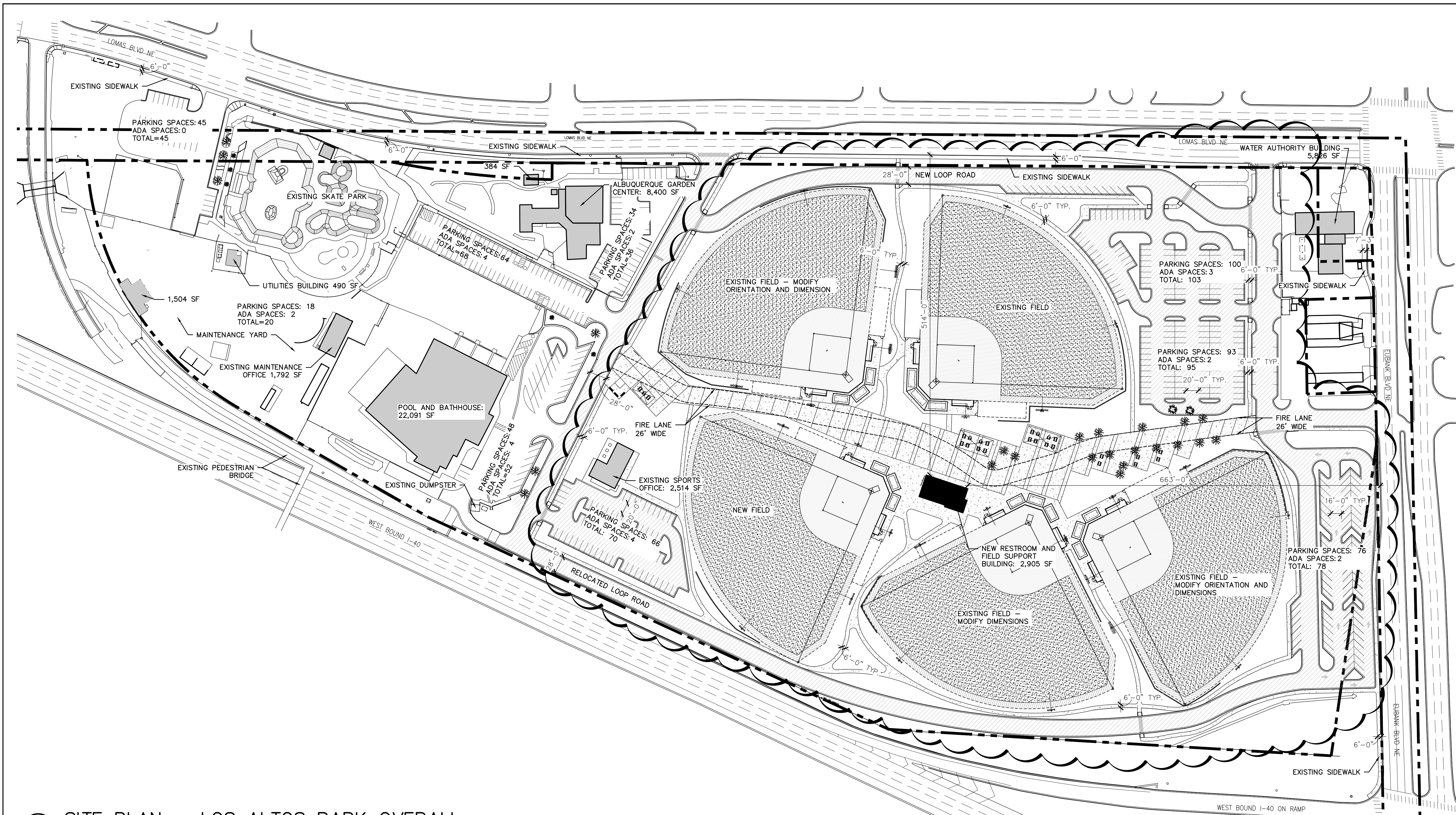

**A1 SITE PLAN – LOS ALTOS PARK OVERALL**  
 SCALE: 1"=80'-0"

**PARKING CALCULATIONS: LOS ALTOS PARK**

STANDARD PARKING STALLS: PURSUANT TO 14.16.2.22 SU-1 ZONE REQUIREMENTS, OFF-STREET PARKING SHALL BE PROVIDED AS REQUIRED BY THE PLANNING COMMISSION. NO OTHER SPECIFIC OFF-STREET PARKING REGULATIONS FOR PARK FACILITIES ARE INCLUDED IN THE ZONING CODE.

CURRENT TOTAL PARKING SPACES: 629	REQUIRED: N/A
PROPOSED TOTAL PARKING SPACES PROVIDED: 567 (9.8% REDUCTION)	REQUIRED: N/A
CURRENT ACCESSIBLE PARKING SPACES: 19	REQUIRED: 16
PROPOSED ADA PARKING SPACES PROVIDED: 23	REQUIRED: 23
CURRENT MOTORCYCLE PARKING SPACES: UNKNOWN	REQUIRED: N/A
PROPOSED MOTORCYCLE PARKING SPACES PROVIDED: 6	REQUIRED: 6
CURRENT BICYCLE PARKING: UNKNOWN	REQUIRED: 6
PROPOSED BICYCLE PARKING SPACES PROVIDED: 12	REQUIRED: 6

	TOTAL EXISTING DEVELOPMENT.....	44,057 SF
	DEMO BUILDING AREA (511 SF) (DECREASE TO EXISTING).....	511 SF
	NEW BUILDING AREA (6.65% INCREASE TO EXISTING).....	2,905 SF
TOTAL PROPOSED BUILDING AREA:		46,451 SF

**SITE INFORMATION**

SITE AREA: LOS ALTOS PARK 34.5 ACRES APPROX.  
 CURRENT ZONING: NR-PO-A FOR A PARK, GARDEN CENTER, AND RECREATION FACILITIES.  
 LAND USE: PARK, ACTIVE AND PASSIVE RECREATION, PUBLIC SWIMMING POOL.  
 MAXIMUM BUILDING HEIGHT: 26' NOMINAL; RESTROOM BLDG IS SINGLE-STORY AND SHALL BE LESS THAN 26' IN HEIGHT.  
 MAXIMUM BUILDING SETBACK: 15' FRONT; 15' REAR  
 MAXIMUM FLOOR AREA RATIOS (FAR): N/A  
 ALL PEDESTRIAN WAYS SHALL HAVE A MAXIMUM CROSS SLOPE OF 2%.  
 ALL CURBS SEPARATING PARKING SPACES FROM LANDSCAPED ISLANDS AND SIDEWALK SHALL BE BETWEEN 6" TO 8" HIGH, OR PARKING BUMPERS SHALL BE PROVIDED.  
 ALL PARKING STALL DIMENSIONS, SIGNAGE, AISLE WIDTHS, AND CURB RADII SHALL BE PER THE DPM.  
**2020 AMENDMENT:**  
 1. REMOVE TENNIS COURTS AND HORSESHOE PITS.  
 2. RECONFIGURE AND ADD A 5TH SOFTBALL FIELD.  
 3. RECONFIGURE THREE EXISTING PARKING AREAS.  
 4. ADD A NEW RESTROOM AND FIELD SUPPORT BUILDING AT 2,905 S.F.

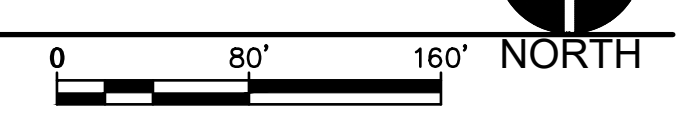

**MRWM**  
 LANDSCAPE ARCHITECTS  
 mrwmla.com 505 268 2266

CITY OF ALBUQUERQUE  
 DEPARTMENT OF MUNICIPAL DEVELOPMENT

LOS ALTOS PARK  
 SITE PLAN – EPC MINOR AMENDMENT

Design Review Committee	City Engineer Approval	Mo./Day/Yr.	Mo./Day/Yr.
City Project No. <b>3858.93</b>	Zone Map No. <b>K-20</b>	Sheet <b>LS101</b>	

REVISIONS		ARCHITECTURAL SEAL		SURVEY INFORMATION		BENCH MARKS		AS-BUILT INFORMATION	
NO.	DATE	NO.	DATE	NO.	DATE	NO.	DATE	NO.	DATE

LOS ALTOS PARK  
 PROJECT# 3858.93  
 ADMINISTRATION AMENDMENT FOR REVIEW  
 DATE: XXXX  
 RECORD DRAWINGS  
 DATE: XXXX/XXX/XXXX