

Copper Ave

| | |
|---------------------|---------------------------------|
| City of Albuquerque | San Jacinto Ave NE |
| Location: | Albuquerque, New Mexico 87114 |
| Zone: | MXM |
| Zoning Area Page: | K-22 |
| Setbacks: | 5' Front 5' Side 15' Rear |
| Height: | 45' Max |
| Parking: | 1 Space per DU |
| Bill Area: | Approx. 126 sq. ft. ea. |
| Occupancy: | Residential |
| Construction Type: | NA |
| Separation: | C |
| Semantic: | C |
| Sprinkler: | None |
| 10 Spaces Required | |

CODE DATA
 2015 International Residential Building Code
 2009 International Energy Conservation Code
 2015 International Fire Code

- GENERAL NOTES**
- A. DO NOT SCALE DRAWINGS
 - B. CONTRACTOR TO COORDINATE ALL DRAWINGS PRIOR TO CONSTRUCTION.
 - C. VERIFY EXISTING CONDITIONS IN FIELD BEING DISCREPANCIES TO ATTENTION OF ARCHITECT
 - D. DIMENSIONS ARE TO FACE OF STUDS UNLESS OTHERWISE NOTED.
 - E. DIMENSIONS TO FACE OF FINISH

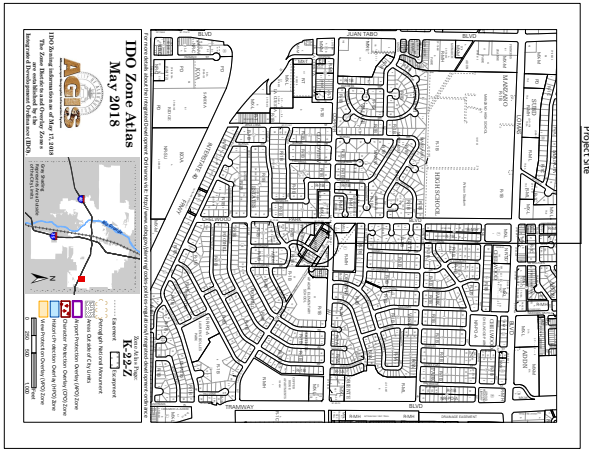

San Jacinto Ave

ALBUQUERQUE, NEW MEXICO 87114

TREVESTON ELLIOTT ARCHITECT
 811 1215 ST. SE, NW
 ALBUQUERQUE, NEW MEXICO 87102
 C 505.259.9917
 treveston@searchitect.com
 www.searchitect.com

A-082

Date: February 8, 2021
 Sheet: Site Plan