

DEMOLITION PLAN – EXISTING PARKING  
SCALE: 1"=10'

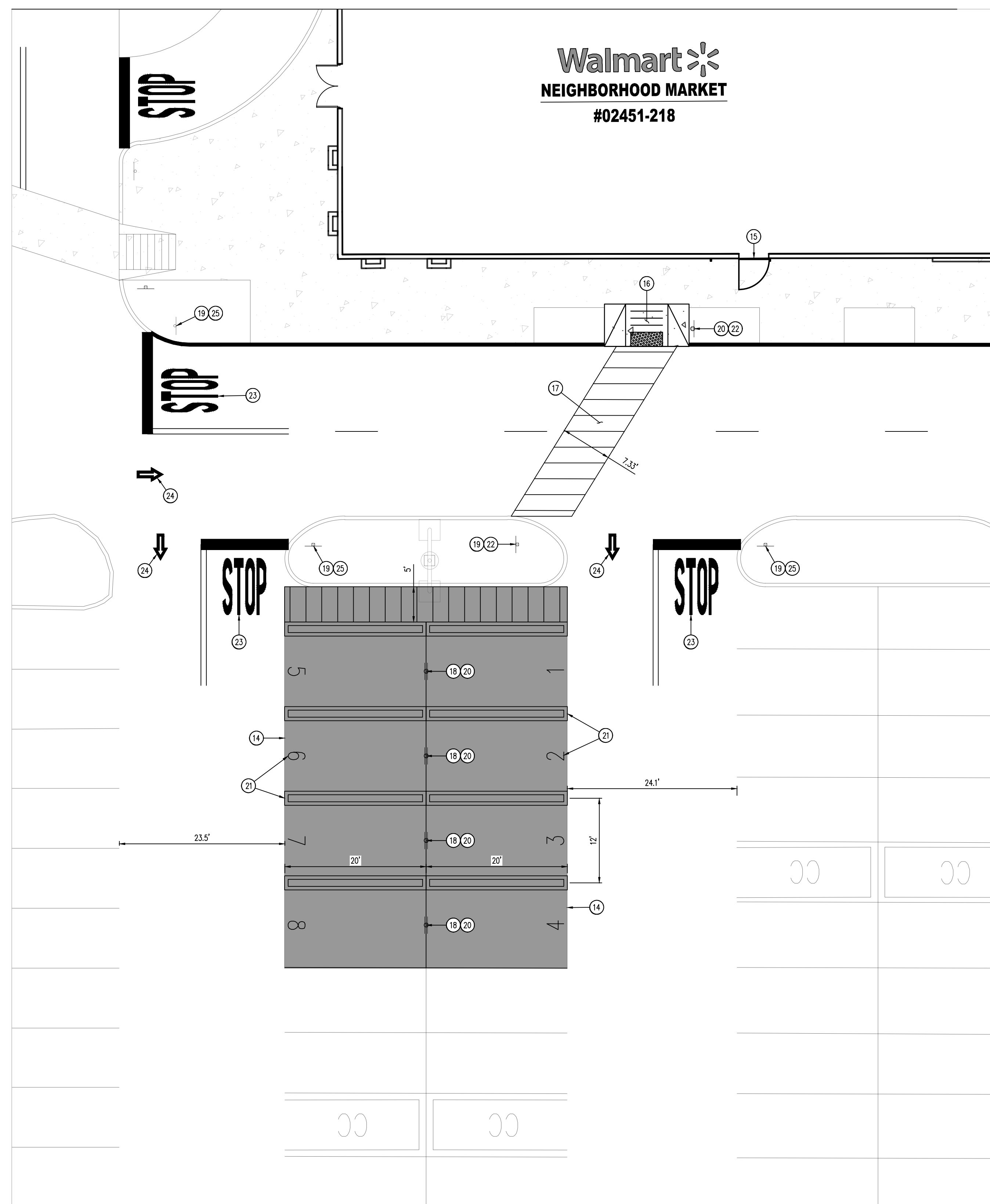

SITE PLAN – PROPOSED PICKUP PARKING  
SCALE: 1"=10'

DEMOLITION NOTES

1. THE CONTRACTOR IS RESPONSIBLE FOR THE DEMOLITION, REMOVAL, AND DISPOSAL (IN A LOCATION APPROVED BY ALL GOVERNING AUTHORITIES) ALL STRUCTURES, PAIS, WALLS, FLOORS, FOUNDATIONS, PARKING, DRIVES, DRAINAGE STRUCTURES, UTILITIES, ETC. SUCH THAT THE IMPROVEMENTS SHOWN ON THE PROPOSED PLANS CAN BE CONSTRUCTED. ALL FACILITIES TO BE REMOVED SHALL BE UNDERCUT TO SUITABLE MATERIAL AND BROUGHT TO GRADE WITH SUITABLE COMPACTED FILL MATERIAL PER THE SPECIFICATIONS. PRIOR TO DEMOLITION OCCURRING, ALL EROSION CONTROL DEVICES ARE TO BE INSTALLED.
2. THE CONTRACTOR IS RESPONSIBLE FOR REMOVING ALL DEBRIS FROM THE SITE AND DISPOSING THE DEBRIS IN A LAWFUL MANNER. THE CONTRACTOR IS RESPONSIBLE FOR OBTAINING ALL PERMITS REQUIRED FOR DEMOLITION AND DISPOSAL.
3. THE CONTRACTOR SHALL COORDINATE WITH RESPECTIVE UTILITY COMPANIES PRIOR TO THE REMOVAL AND/OR RELOCATION OF UTILITIES. THE CONTRACTOR SHALL COORDINATE WITH THE UTILITY COMPANY CONCERNING PORTIONS OF WORK WHICH MAY BE PERFORMED BY THE UTILITY COMPANY THEMSELVES AND ANY FEES WHICH ARE TO BE PAID TO THE UTILITY COMPANY FOR THEIR SERVICES. THE CONTRACTOR IS RESPONSIBLE FOR PAYING ALL FEES AND CHARGES.
4. THE LOCATIONS OF ALL EXISTING UTILITIES SHOWN ON THIS PLAN HAVE BEEN DETERMINED FROM THE BEST INFORMATION AVAILABLE AND ARE GIVEN FOR THE CONVENIENCE OF THE CONTRACTOR. THE ENGINEER ASSUMES NO RESPONSIBILITY FOR THEIR ACCURACY. PRIOR TO THE START OF ANY DEMOLITION ACTIVITY, THE CONTRACTOR SHALL NOTIFY THE UTILITY COMPANIES FOR MARKING ON-SITE LOCATIONS OF EXISTING UTILITIES.
5. ALL EXISTING SEWERS, PIPING AND UTILITIES SHOWN ARE NOT TO BE INTERPRETED AS THE EXACT LOCATION, OR AS THE ONLY STRUCTURES THAT MAY OCCUR ON THE SITE. VERIFY EXISTING CONDITIONS AND PROCEED WITH CAUTION AROUND ANY ANTICIPATED FEATURES. GIVE NOTICE TO ALL UTILITY COMPANIES REGARDING DEMOLITION AND REMOVAL OF ALL SERVICE LINES AND CAP ALL LINES BEFORE PROCEEDING WITH THE WORK. UTILITIES DETERMINED TO BE ABANDONED AND LEFT IN PLACE SHALL BE GROUNDED IF UNDER BUILDING.
6. CONTRACTOR MUST PROTECT THE PUBLIC AT ALL TIMES WITH FENCING, BARRICADES, ENCLOSURES, ETC., (AND OTHER APPROPRIATE BEST MANAGEMENT PRACTICES) AS APPROVED BY CITY AND OWNER. SHOULD REMOVAL AND/OR RELOCATION ACTIVITIES DAMAGE EXISTING FACILITIES TO REMAIN, THE CONTRACTOR SHALL PROVIDE NEW MATERIALS/ STRUCTURES IN ACCORDANCE WITH THE CONTRACT DOCUMENTS. EXCEPT FOR MATERIALS DESIGNED TO BE RELOCATED ON THIS PLAN, ALL OTHER CONSTRUCTION MATERIALS SHALL BE NEW. DAMAGE TO ALL EXISTING CONDITIONS TO REMAIN WILL BE REPLACED AT CONTRACTOR'S EXPENSE.
7. CONTRACTOR SHALL LIMIT SAW-CUT & PAVEMENT REMOVAL TO ONLY THOSE AREAS WHERE IT IS REQUIRED AS SHOWN ON THESE CONSTRUCTION PLANS, BUT IF ANY DAMAGE IS INCURRED ON ANY OF THE SURROUNDING PAVEMENT, ETC. THE CONTRACTOR SHALL BE RESPONSIBLE FOR ITS REMOVAL AND REPAIR.
8. IT IS THE CONTRACTOR'S RESPONSIBILITY TO CONTACT THE VARIOUS UTILITY COMPANIES WHO MAY HAVE BURIED OR AERIAL UTILITIES WITHIN OR NEAR THE CONSTRUCTION AREA BEFORE COMMENCING WORK. THE CONTRACTOR SHALL PROVIDE 72 HOURS MINIMUM NOTICE TO ALL UTILITY COMPANIES PRIOR TO BEGINNING CONSTRUCTION.
9. ALL EXISTING UTILITIES SHOWN ARE LOCATED ACCORDING TO THE INFORMATION AVAILABLE TO THE ENGINEER AT THE TIME THE DRAWINGS WERE PREPARED AND HAVE NOT BEEN INDEPENDENTLY VERIFIED BY THE OWNER OR THE ENGINEER. GUARANTEE IS NOT MADE THAT ALL EXISTING UNDERGROUND UTILITIES ARE SHOWN OR THAT THE LOCATION OF THOSE SHOWN ARE ACCURATE. FINDING THE ACTUAL LOCATION OF ANY EXISTING UTILITIES IS THE CONTRACTOR'S RESPONSIBILITY AND SHALL BE DONE BEFORE HE COMMENCES ANY WORK IN THE VICINITY. FURTHERMORE, THE CONTRACTOR SHALL BE SOLELY RESPONSIBLE FOR ANY AND ALL DAMAGE DUE TO THE CONTRACTOR'S FAILURE TO EXACTLY LOCATE AND PRESERVE ANY AND ALL UNDERGROUND UTILITIES. THE OWNER OR ENGINEER WILL ASSUME NO LIABILITY FOR ANY DAMAGES SUSTAINED OR COST INCURRED BECAUSE OF THE OPERATIONS IN THE VICINITY OF EXISTING UTILITIES OR STRUCTURES. NOB FOR TEMPORARY BRACING AND SHORING OF SAME. IF IT IS NECESSARY TO SHORE, BRACE, SWING OR RELOCATE A UTILITY, THE UTILITY COMPANY OR DEPARTMENT AFFECTED SHALL BE CONTACTED BY THE CONTRACTOR AND THEIR PERMISSION OBTAINED REGARDING THE METHOD TO USE FOR SUCH WORK.
10. THE CONTRACTOR SHALL HAVE AVAILABLE AT THE JOB SITE AT ALL TIMES ONE COPY OF THE CONTRACT DOCUMENTS INCLUDING PLANS, SPECIFICATIONS, COPIES OF ANY REQUIRED CONSTRUCTION PERMITS, AND EROSION CONTROL PLANS AND INSPECTION REPORTS (CUTS).
11. ANY DISCREPANCIES ON THE DRAWINGS SHALL BE IMMEDIATELY BROUGHT TO THE ATTENTION OF THE OWNER/ENGINEER BEFORE COMMENCING WORK. NO FIELD CHANGES OR DEVIATIONS FROM DESIGN ARE TO BE MADE WITHOUT PRIOR APPROVAL OF THE OWNER AND NOTIFICATION TO THE ENGINEER. NO CONSIDERATION WILL BE GIVEN TO CHANGE ORDERS FOR WHICH THE OWNER AND ENGINEER WERE NOT CONTACTED PRIOR TO CONSTRUCTION OF THE AFFECTED ITEM.
12. CONTRACTOR SHALL COMPLY TO THE FULLEST EXTENT WITH THE LATEST OSHA STANDARDS FOR EXCAVATION AND TRENCHING PROCEDURES. CONTRACTOR SHALL USE SUPPORT SYSTEMS, SLOPING, BENCHING, ETC. AS NECESSARY FOR THESE OPERATIONS, AND SHALL COMPLY WITH ALL OSHA PERFORMANCE CRITERIA.
13. DO NOT INTERRUPT EXISTING UTILITIES SERVING FACILITIES OCCUPIED AND USED BY THE OWNER OR OTHERS DURING OCCURED HOURS EXCEPT WHEN SUCH INTERRUPTIONS HAVE BEEN AUTHORIZED IN WRITING BY THE OWNER AND THE LOCAL MUNICIPALITIES. INTERRUPTIONS SHALL ONLY OCCUR AFTER ACCEPTABLE TEMPORARY SERVICE HAS BEEN PROVIDED.
14. ANY RECYCLED MATERIAL TO BE STOCKPILED ON THE SITE SHALL BE STORED IN AS SMALL AN AREA AS PRACTICAL AND THE LOCATION OF ANY STOCKPILE SHALL BE WELL CLEAR OF THE BUILDING PAD AREA AND THE LOCATION MUST BE PRE-APPROVED BY THE ENGINEER AND OWNER PRIOR TO STOCKPILING.
15. QUANTITIES SHOWN HERE ARE APPROXIMATE AND ARE PROVIDED FOR CONVENIENCE ONLY AND NOT FOR BID PURPOSES. CONTRACTOR SHALL VERIFY QUANTITIES NECESSARY TO DEMO FACILITIES SHOWN.
16. ASBESTOS OR HAZARDOUS MATERIAL, IF FOUND ON SITE, SHALL BE REMOVED BY A LICENSED HAZARDOUS MATERIAL CONTRACTOR. REFERENCE ARCHITECTURAL PLANS FOR LIMITS OF BUILDING DEMOLITION.

SITE NOTES

1. ALL WORK AND MATERIALS SHALL COMPLY WITH ALL CITY/COUNTY REGULATIONS AND CODES AND O.S.H.A. STANDARDS.
2. CONTRACTOR SHALL REFER TO THE ARCHITECTURAL PLANS FOR EXACT LOCATIONS AND DIMENSIONS OF VESTIBULES, SLOPE PAVING, SIDEWALKS, EXIT PORCHES, TRUCK DOCKS, PRECISE BUILDING DIMENSIONS AND EXACT BUILDING UTILITY ENTRANCE LOCATIONS.
3. ALL DIMENSIONS ARE TO THE FACE OF CURB UNLESS OTHERWISE NOTED.
4. EXISTING STRUCTURES WITHIN CONSTRUCTION LIMITS ARE TO BE ABANDONED, REMOVED OR RELOCATED AS NECESSARY. ALL COST SHALL BE INCLUDED IN BASE BID.
5. CONTRACTOR SHALL BE RESPONSIBLE FOR ALL RELOCATIONS, (UNLESS OTHERWISE NOTED ON PLANS) INCLUDING BUT NOT LIMITED TO, ALL UTILITIES, STORM DRAINAGE, SIGNS, TRAFFIC SIGNALS & POLES, ETC. AS REQUIRED. ALL WORK SHALL BE IN ACCORDANCE WITH GOVERNING AUTHORITIES REQUIREMENTS AND PROJECT SITE WORK SPECIFICATIONS AND SHALL BE APPROVED BY SUCH. ALL COST SHALL BE INCLUDED IN BASE BID.
6. THE SITE WORK FOR THIS PROJECT SHALL MEET OR EXCEED "THE SITE SPECIFICATIONS".

CAUTION – NOTICE TO CONTRACTOR

1. ALL UTILITY LOCATIONS SHOWN ARE BASED ON MAPS PROVIDED BY THE APPROPRIATE UTILITY COMPANY AND FIELD SURFACE EXISTING AT THE TIME OF SURVEY AND IS TO BE CONSIDERED AN APPROXIMATE LOCATION ONLY. IT IS THE CONTRACTOR'S RESPONSIBILITY TO FIELD VERIFY THE FIELD LOCATION OF ALL UTILITIES, PUBLIC OR PRIVATE, WHETHER SHOWN ON THE PLANS OR NOT, PRIOR TO CONSTRUCTION. REPORT ANY DISCREPANCIES TO THE ENGINEER PRIOR TO CONSTRUCTION.
2. WHERE A PROPOSED UTILITY CROSSES AN EXISTING UTILITY, IT IS THE CONTRACTOR'S RESPONSIBILITY TO FIELD VERIFY THE HORIZONTAL AND VERTICAL LOCATION OF SUCH EXISTING UTILITY, EITHER THROUGH PINGING OR ALTERNATIVE METHOD. REPORT INFORMATION TO THE ENGINEER PRIOR TO CONSTRUCTION.

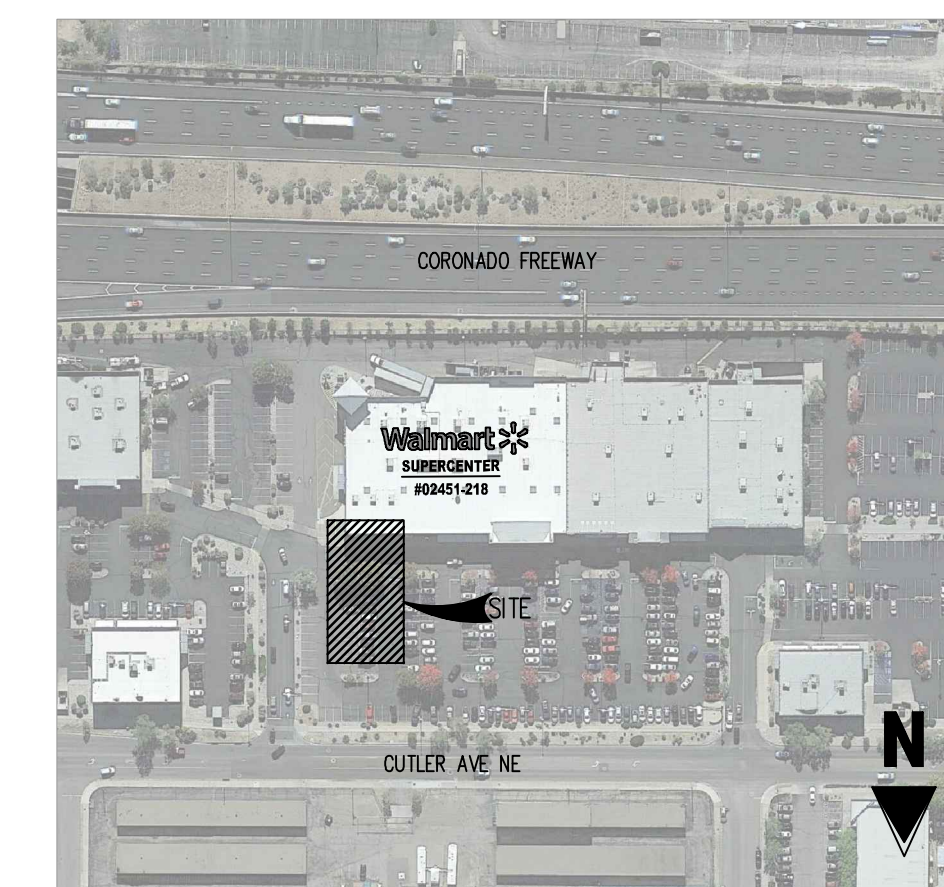

KEY MAP  
APPROX. 1" = 200'

LEGEND

- EXISTING TO REMAIN
- EXISTING TO BE REMOVED
- EXISTING ASPHALT PAVEMENT TO REMAIN
- EXISTING CONCRETE PAVEMENT TO REMAIN
- PROPOSED SEAL COAT OF EXISTING PAVEMENT
- EXISTING SIGN TO REMAIN
- EXISTING SIGN TO BE REMOVED
- PROPOSED PICKUP SIGNAGE

SITE & DEMOLITION SCHEDULE

1. EXISTING WALMART BUILDING TO REMAIN.
2. EXISTING BUILDING WALL TO BE REMOVED FOR PICKUP DOOR INSTALLATION (REF. ARCH PLANS)
3. EXISTING CONCRETE SIDEWALK TO REMAIN.
4. EXISTING CONCRETE SIDEWALK TO BE REMOVED.
5. EXISTING ASPHALT PAVEMENT TO REMAIN
6. EXISTING PLANTER BOX TO REMAIN. LANDSCAPING TO BE PROTECTED IN PLACE THROUGHOUT CONSTRUCTION
7. EXISTING PARKING LOT STRIPING TO REMAIN.
8. EXISTING PARKING LOT STRIPING TO BE REMOVED.
9. EXISTING STOP BAR AND LETTERING TO BE REMOVED.
10. EXISTING 6" CURB TO REMAIN.
11. EXISTING 6" CURB TO BE REMOVED.
12. EXISTING LIGHT POLE AND BASE TO REMAIN.
13. EXISTING CART CORRAL TO REMAIN.
14. PROPOSED SEAL COAT OF EXISTING PAVEMENT.
15. PROPOSED PICKUP DOOR (REF. ARCH PLANS).
16. PROPOSED CURB RAMP (REF. SITE DETAILS).
17. PROPOSED ASSOCIATE PATH CROSSWALK STRIPING (REF. SITE DETAILS).
18. PROPOSED PICKUP SIGNAGE (REF. SITE DETAILS).
19. PROPOSED SIGN MOUNTING WITH BREAKAWAY POST (REF. SITE DETAILS).
20. PROPOSED SIGN MOUNTING AND BASE WITH BOLLARD (REF. SITE DETAILS).
21. PROPOSED PICKUP STALL STRIPING AND PICKUP NUMBER MARKING (REF. SITE DETAILS).
22. PROPOSED R1-9B – "STOP HERE FOR PEDESTRIANS" SIGNAGE (REF. SITE DETAILS).
23. PROPOSED STOP BAR LETTERING (REF. SSM/SECP PLANS).
24. PROPOSED OPEN ARROW PAVEMENT MARKING (REF. SSM/SECP PLANS).
24. PROPOSED 30"x30" STOP SIGN (REF. SSM/SECP PLANS).

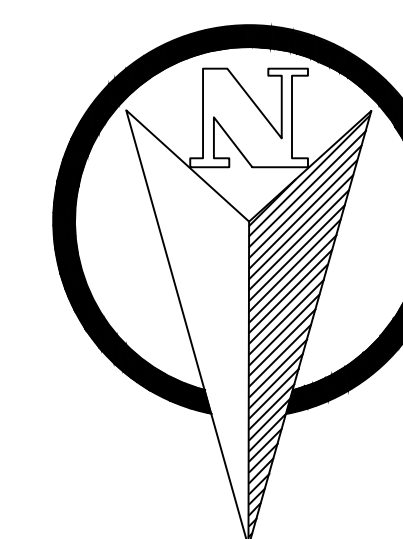

GRAPHIC SCALE

(IN FEET)  
1 inch = 10 ft.

**Galloway**  
1718 Main Drive, Suite 107  
Albuquerque, NM 87102  
771.880.2325  
galloway.com

STIPULATION FOR REUSE:  
THIS DRAWING WAS PREPARED FOR THE PROJECT DESCRIBED ABOVE. IT IS NOT TO BE REUSED FOR ANY OTHER PROJECT WITHOUT THE WRITTEN PERMISSION OF THE ENGINEER. ANY REUSE OF THIS DRAWING FOR ANY OTHER PROJECT WITHOUT THE WRITTEN PERMISSION OF THE ENGINEER SHALL BE AT THE USER'S SOLE RISK AND WITHOUT LIABILITY TO THE ENGINEER.

BRANDON ALLEN  
NEW MEXICO  
25037  
PROFESSIONAL ENGINEER  
02/25/2021

**Walmart**  
ALBUQUERQUE, NM  
STORE NO. 02451-218  
JOB NUMBER: SGA02451.20 [PROJ. PICKUP] ENTINCMENT

ISSUE BLOCK		
ADD#2	DATE	DESCRIPTION
	02/25/21	

CHECKED BY: RCJ  
DRAWN BY: JSB  
PROTO CYCLE: -  
DOCUMENT DATE: 02/25/21

DEMOLITION & SITE PLAN  
SHEET: CS1