

DEMOLITION PLAN

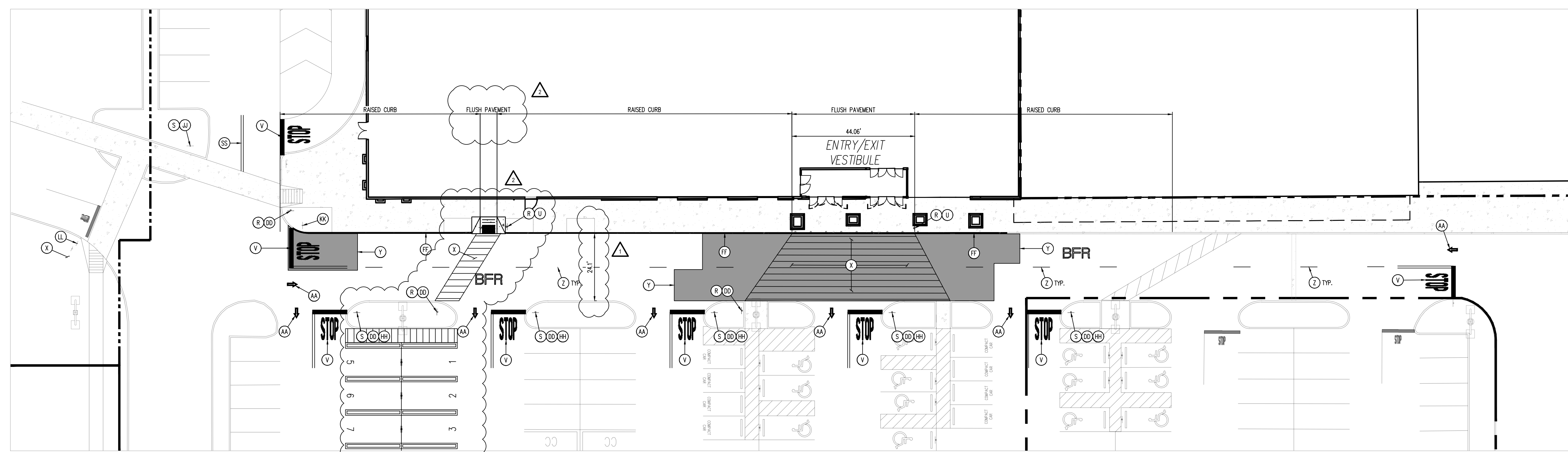

SITE CONSTRUCTION PLAN

NOTES TO CONTRACTOR:

- REFERENCE SITE CONSTRUCTION PLAN FOR SITE SPECIFIC DIMENSIONS OF CROSSWALK STRIPING AND LOCATION OF SIGNAGE.
- PROVIDE A COMPREHENSIVE CONSTRUCTION PHASING PLAN FOR THIS WORK TO THE STORE MANAGER 7 DAYS PRIOR TO STARTING ANY WORK. IT IS TO PROVIDE FOR DATES, TIMES AND DURATION OF LANE CLOSURES, TEMPORARY VEHICLE AND PEDESTRIAN TRAFFIC CONTROL.
- ALL EXISTING STRIPING AND PAVEMENT MARKINGS OR TEXT ALONG THE BFR (BUILDING FRONTAGE ROAD) SHALL BE REMOVED. GRIND OUT ANY DIRECTIONAL ARROWS OR STOP BARS/TEXT THAT ARE NOT CORRECTLY LOCATED OR INCONSISTENT WITH THE DETAILS PROVIDED. APPLY SEAL COAT TO THE COMPLETE EXTENT THAT THE STRIPING OR TEXT HAS BEEN REMOVED IN A SINGLE COMPLETE RECTANGLE TO COVER ALL REMOVED STRIPING (DO NOT APPLY SEAL COAT OVER EXISTING STRIPING OR CONCRETE). INSTALL NEW STRIPING AND SIGNAGE AS SHOWN ON THE SITE CONSTRUCTION PLAN.
- ALL SIGNS LOCATED ON THE BUILDING SIDE OF THE BFR SHALL BE INSTALLED ON A SINGLE POST WITH BOLLARD.

SITE AND DEMOLITION LEGEND

- REFERENCE DETAIL SHEET
- | | |
|---|---|
| (A) EXISTING PEDESTRIAN CROSSING SIGN TO BE REMOVED. | (Z) NEW 4" WIDE PAINTED YELLOW STRIPES - 6' LONG WITH 18" GAPS. |
| (B) EXISTING STOP SIGN TO BE REMOVED. | (AA) NEW OPEN ARROW PAVEMENT MARKINGS. |
| (C) EXISTING SIGN POST, BASE, AND BOLLARD BASE (WHERE APPLICABLE) TO BE REMOVED. | (BB) NEW SOLID ARROW PAVEMENT MARKINGS. |
| (D) EXISTING SIGN POST AND BASE TO REMAIN, BOLLARD (WHERE APPLICABLE) TO BE RE-PAINTED. | (CC) NEW 4" WIDE DOUBLE SOLID YELLOW STRIPES. |
| (E) EXISTING CROSSWALK STRIPING TO BE REMOVED. | (DD) NEW SIGN MOUNTING AND BASE WITH BREAK AWAY POST. |
| (F) EXISTING YIELD PAVEMENT MARKING TO BE REMOVED. | (EE) NEW SIGN MOUNTING AND BASE WITH DOUBLE BREAK AWAY POSTS. |
| (G) EXISTING CENTERLINE STRIPING TO BE REMOVED. | (FF) NEW FIRE LANE STRIPING. |
| (H) EXISTING CENTERLINE STRIPING TO REMAIN AND BE RE-PAINTED. | (GG) EXISTING PAVEMENT MARKINGS/STRIPING TO BE INSPECTED AND RE-PAINTED/REFRESHED TO MATCH CURRENT DETAILS/GUIDELINES. |
| (I) EXISTING SOLID DOUBLE YELLOW STRIPING TO BE REMOVED. | (HH) EXISTING VISIBILITY CONFLICT WITH SIGNAGE. CONTRACTOR SHALL TRIM LANDSCAPING AS REQUIRED TO CREATE UNOBSTRUCTED VIEW OF SIGNAGE. |
| (J) EXISTING STOP SIGN TO REMAIN. | (II) NEW "ONCOMING TRAFFIC DOES NOT STOP" PLAQUE. |
| (K) EXISTING PEDESTRIAN CROSSING SIGN TO REMAIN. | (JJ) NEW "TRAFFIC FROM LEFT DOES NOT STOP" PLAQUE. |
| (L) EXISTING STOP BAR AND STOP TEXT PAVEMENT MARKING TO BE REMOVED. | (KK) NEW "TRAFFIC FROM RIGHT DOES NOT STOP" PLAQUE. |
| (M) EXISTING ARROW PAVEMENT MARKINGS TO BE REMOVED. | (LL) NEW "ALL WAY" PLAQUE. |
| (N) EXISTING FIRE LANE STRIPING TO REMAIN AND BE RE-PAINTED. | (MM) EXISTING "PICK-UP" PAVEMENT MARKINGS TO BE REMOVED. |
| (O) EXISTING STOP SIGN TO BE RAISED TO MATCH CURRENT DETAILS/GUIDELINES. | (NN) PROPOSED PICKUP STALL STRIPING AND NUMBERING (REF. PICKUP PLAN SET). |
| (P) NEW "STOP HERE FOR PEDESTRIANS" (R1-S0) SIGN. | (OO) NEW PICKUP CROSSWALK MARKINGS. |
| (Q) NEW 30"x30" STOP SIGN. | (PP) PROPOSED PICKUP SIGNAGE PER PICKUP PLANS (REF. PICKUP PLAN SET). |
| (R) NEW 36"x36" STOP SIGN. | (SS) PROPOSED DOUBLE YELLOW STRIPING. |
| (S) NEW SIGN MOUNTING AND BASE WITH BOLLARD. | (TT) NEW "ONLY" PAVEMENT MARKINGS. |
| (T) NEW STOP TEXT AND STOP BAR PAVEMENT MARKINGS. | (VV) EXISTING PARKING LOT STRIPING TO BE REMOVED. |
| (U) NEW 4" WIDE PAINTED YELLOW STRIPES AT 45° @ 2'-0" O.C. | |
| (V) NEW CROSSWALK MARKINGS - 6" WIDE PAINTED WHITE STRIPING PARALLEL TO DIRECTION OF TRAFFIC AT 2'-0" O.C. AND (1)-3" WHITE STRIPING PERPENDICULAR ON BOTH ENDS UNLESS NOTED OTHERWISE. EXTERIOR CROSSWALK SHALL BE RE-STRIPED. | |
| (W) LIMITS OF SEAL COAT. APPLY SEAL COAT OVER WHERE STRIPING AND PAVEMENT MARKINGS WERE REMOVED AND WHERE NEW STRIPING AND PAVEMENT MARKINGS WILL BE APPLIED. APPLY NEW STRIPING AND PAVEMENT MARKINGS OVER SEAL COAT. | |

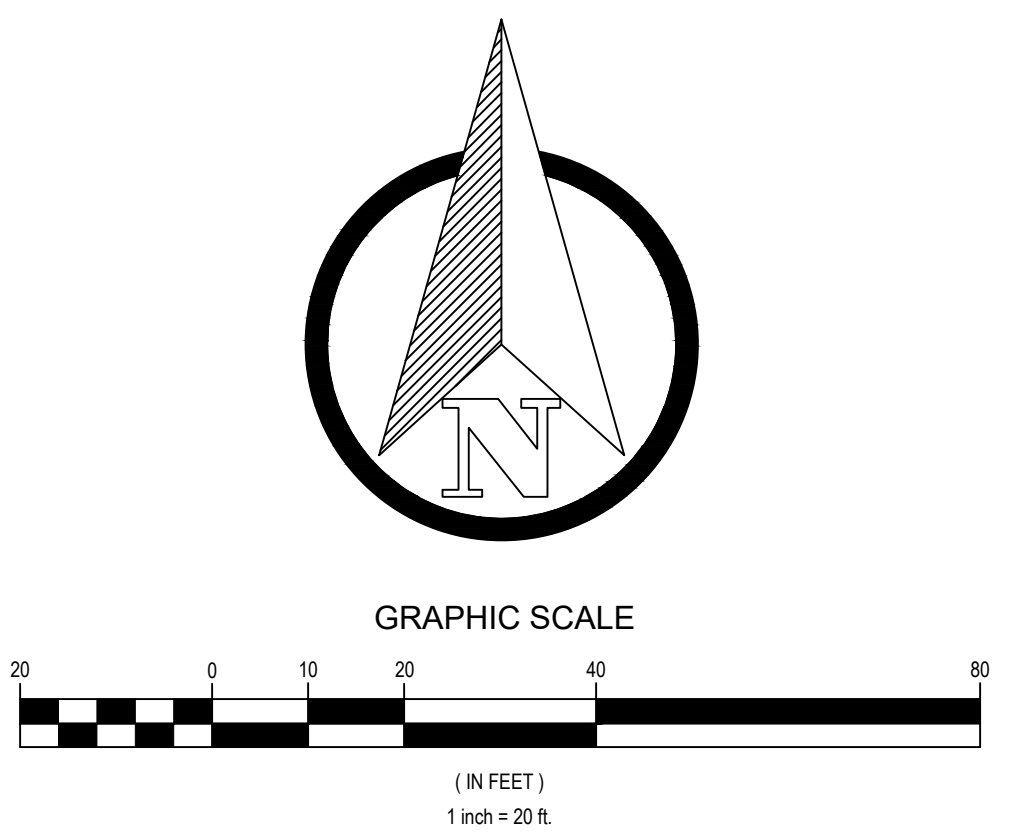

DEMOLITION AND SITE CONSTRUCTION PLAN

REVISIONS	BY
PRP# - 01/27/21	JSB
ADD# - 02/25/21	JSB
COO# - 03/04/21	DDJ

Galloway
 6002 S. Willow Drive, Suite 300
 Albuquerque, NM 87111
 505.770.8884
 GallowayUS.com

BRANDON ALLET
 NEW MEXICO
 25037
 PROFESSIONAL ENGINEER
 03/12/2021

NEIGHBORHOOD MARKET #02451-218
 4700 CUTLER AVE NE
 ALBUQUERQUE, BERNALILLO COUNTY, NEW MEXICO
 WAL-MART STORES, INC.
 BENTONVILLE, AR

Walmart

DRAWN	JSB
CHECKED	BDA
DATE	11/05/20
SCALE	AS NOTED
JOB NO.	5GAD002451.20
SHEET	

SECP-1