

# ADMINISTRATIVE AMENDMENT

FILE #: \_\_\_\_\_ PROJECT #: \_\_\_\_\_

---

---

---

---

---

\_\_\_\_\_  
**APPROVED BY**

\_\_\_\_\_  
**DATE**



### LEGEND

	3/4" Ø TAN ROCK MULCH, 3" DEPTH OVER WEED FABRIC
	SHREDDED WOOD MULCH, 4" DEPTH WITHOUT WEED FABRIC
	IRRIGATED NATIVE SEED MIX
	UNIRRIGATED NATIVE SEED MIX
	PROPERTY LINE
	EAST DEVELOPMENT PACKAGE BOUNDARY
	NORTH DEVELOPMENT PACKAGE BOUNDARY
	LEVEL B BOUNDARY

ARCHITECT

ENGINEER

**NOT FOR CONSTRUCTION**

PROJECT

### KEYPLAN

REVISIONS

- △
- △
- △
- △

DRAWN BY	DC
REVIEWED BY	MB
DATE	10/29/2021
PROJECT NO.	20-0072.008
DRAWING NAME	

OVERALL ALTERNATIVE LANDSCAPE PLAN

SHEET NO.

# SDP 2.0

# DEKKER PERICH SABATINI

ARCHITECT

ENGINEER

**NOT FOR CONSTRUCTION**

PROJECT

ABQ Studios Expansion  
EAST DEVELOPMENT PACKAGE

5650 University Blvd SE  
Albuquerque, NM 87106

REVISIONS

- △
- △
- △
- △

DRAWN BY	DC
REVIEWED BY	MB
DATE	10/29/2021
PROJECT NO.	20-0072.008
DRAWING NAME	

OVERALL ALTERNATIVE LANDSCAPE PLAN

SHEET NO.

# SDP 2.0

**A1** OVERALL ALTERNATIVE LANDSCAPE PLAN

1" = 150'-0"

0 150' 300'

0 1000' 2000'

## GENERAL SHEET NOTES

- A. RESPONSIBILITY FOR MAINTENANCE: THE CONTRACTOR WILL BE RESPONSIBLE FOR MAINTENANCE OF THE LANDSCAPE DURING CONSTRUCTION AND DURING A 90 DAY-MAINTENANCE PERIOD FOLLOWING SUBSTANTIAL COMPLETION. THE OWNER WILL BE RESPONSIBLE FOR MAINTENANCE FOLLOWING THE 90-DAY MAINTENANCE PERIOD.
- B. STATEMENT OF COMPLIANCE WITH CITY OF ALBUQUERQUE: THE LANDSCAPE DESIGN WILL COMPLY WITH THE CITY OF ALBUQUERQUE'S LANDSCAPING, BUFFERING, AND SCREENING REGULATIONS (14-16-5-6), WATER CONSERVATION ORDINANCE AND POLLEN ORDINANCE.
- C. TIMING OF LANDSCAPE INSTALLATION: INSTALLATION OF THE LANDSCAPING SHALL BE COMPLETE WITHIN 60 DAYS OF THE RELATED BUILDING'S OCCUPANCY.
- D. SURFACE TREATMENT: ALL LANDSCAPE AREAS SHALL BE COVERED WITH VEGETATION AND/OR MULCH. ORGANIC MULCH IS REQUIRED AT EACH TREE ROOTBALL AREA OR PLANT.
- E. LANDSCAPE AND SIGNAGE WILL NOT INTERFERE WITH CLEAR SIGHT REQUIREMENTS. THEREFORE SIGNS, WALLS, TREES AND SHRUBS BETWEEN 3 AND 8 FEET TALL (AS MEASURED FROM THE GUTTER PAN) WILL NOT BE PERMITTED IN THE CLEAR SIGHT TRIANGLE.**
- F. MINIMUM PLANT SIZES ARE AS PER CITY OF ALBUQUERQUE STANDARDS PER TABLE 5-6-1 OF THE IDO.
- G. AREAS DISTURBED DURING CONSTRUCTION, INCLUDING AREAS NOT WITHIN THE PROPERTY LINE, WILL BE STABILIZED.
- H. VEGETATIVE SCREENING SURROUNDING GROUND-MOUNTED TRANSFORMERS AND UTILITY PADS SHALL ALLOW 10' OF CLEARANCE MINIMUM IN FRONT OF THE EQUIPMENT DOOR AND 5' OF CLEARANCE MINIMUM ON THE REMAINING SIDES FOR SAFE OPERATION AND MAINTENANCE.

## IRRIGATION NOTES

- A. PLANTS SHALL BE IRRIGATED BY AN AUTOMATED IRRIGATION SYSTEM WITH PROGRAMMABLE SETTINGS, AUTOMATED IRRIGATION CONTROLLER, AND WEATHER SENSOR TO AVOID OVER-WATERING.
- B. THE IRRIGATION SYSTEM SHALL BE DESIGNED TO MINIMIZE THE USE OF WATER.
- C. THE IRRIGATION SYSTEM SHALL NOT IRRIGATE IMPERVIOUS SURFACES, INCLUDING SIDEWALKS, DRIVEWAYS, STREETS, PARKING, AND LOADING AREAS.
- D. IRRIGATION POINT OF CONNECTION TO THE CITY WATER WILL BE LOCATED WITHIN PROPERTY LIMITS AND SHALL COMPLY WITH THE CITY OF ALBUQUERQUE REDUCED PRESSURE BACKFLOW PREVENTER STANDARDS AND SPECIFICATIONS.
- E. RUN TIMES AND IRRIGATION ZONES SHALL BE BASED UPON PLANT SPECIES AND THEIR ESTABLISHMENT. RUN TIMES SHALL BE REGULARLY ADJUSTED BY THE OWNER ACCORDING TO PLANT MATURITY, SEASON, LOCATION AND PERFORMANCE.

## TREE PLANTING DETAIL

NOTE:

- PRIOR TO BACKFILLING, MATERIAL SUCH AS CONTAINERS, WIRE, BURLAP AND ROPE SHALL BE COMPLETELY REMOVED.
- PLANT MATERIAL SHALL BE PLANTED IN UNCOMPACTED SOIL.

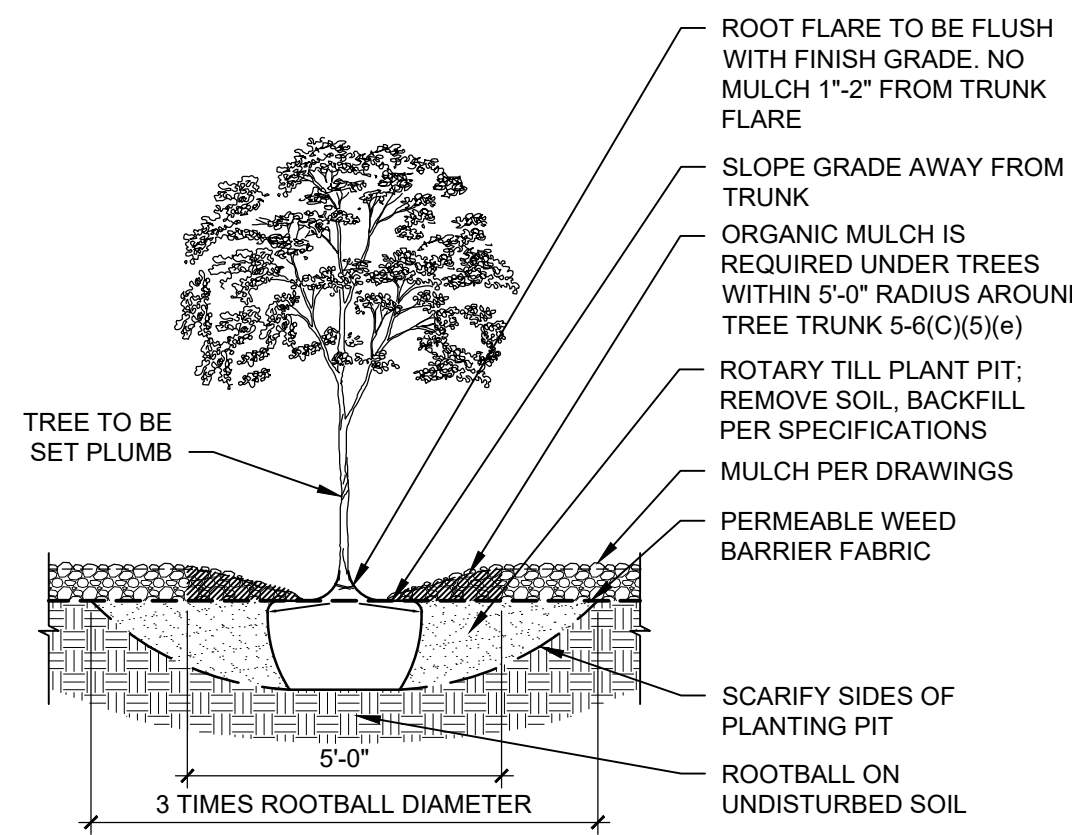

## LANDSCAPE DATA

TOTAL EAST BOUNDARY SITE AREA = 117,527.9 ACRES = 5,119,515 SF  
 MINUS EXISTING CAMPUS (508,560 SF see previously approved plan)  
 MINUS UNDISTURBED AREAS TO REMAIN AND UNIMPROVED AREAS  
 = TOTAL SITE = 4,315,355 SF  
 AREA OF LOT COVERED BY BUILDINGS = 460,909 SF  
 NET LOT AREA = 3,854,446 SF

**REQUIRED LANDSCAPE**  
 REQUIRED LANDSCAPE AREA (15% OF NET LOT AREA) = 578,169 SF  
 PROVIDED LANDSCAPE AREA = 579,712 SF = 15%

**REQUIRED TREES**  
 TOTAL NUMBER OF PARKING SPACES = 3,044 SPACES  
 REQUIRED PARKING LOT TREES (1 TREE PER 10 SPACES) = 304 TREES  
 PROVIDED NUMBER OF TOTAL TREES = 617 TREES  
 SEE ALTERNATIVE LANDSCAPE PLAN INFORMATION

**REQUIRED VEGETATIVE COVERAGE**  
 REQUIRED GROUND COVERAGE = 434,784 SF = 75% OF PROVIDED LANDSCAPE AREA  
 A MINIMUM 25% OF REQUIRED VEGETATIVE COVERAGE BY GROUND PLANTS  
 PROVIDED TOTAL GROUND COVERAGE = 483,169 SF = 83% OF TOTAL PROVIDED LANDSCAPE  
*assumed 200 sf per tree and 20 sf per shrub*  
 TREE CANOPY COVERAGE = 123,400 SF (617 TREES)  
 = 28% OF REQUIRED VEGETATIVE COVERAGE  
 GROUND PLANT COVERAGE (4,242 SHRUBS + IRRIGATED NATIVE SEED)  
 = 84,840 SF + 274,929 SF = 359,769 SF = 82% OF REQUIRED VEGETATIVE COVERAGE

**GROUND COVER MATERIAL**  
 TOTAL ROCK MULCH GROUND COVER = 246,617 SF = 42%  
 TOTAL ORGANIC MULCH GROUND COVER = 333,095 SF = 58% (274,929 SF IRRIGATED NATIVE SEED IS INCLUDED IN THIS NUMBER)  
 A MAXIMUM OF 75% OF GRAVEL OR CRUSHER FINES IS PERMITTED 14-16-5-6(C)(5)(d)

## PLANT LEGEND

	<b>RIPARIAN TREE</b> ARIZONA WALNUT ARIZONA SYCAMORE RIO GRANDE COTTONWOOD
	<b>STREET / CANOPY TREE</b> CHINESE PISTACHE ESCARPMENT LIVE OAK CHINQUAPIN OAK LACEBARK ELM
	<b>SMALL TO MEDIUM TREE</b> RED WING MAPLE SHANTUNG MAPLE NETLEAF HACKBERRY MEXICAN REDBUD DESERT WILLOW RUSSIAN HAWTHORN GOLDEN RAIN TREE HONEY MESQUITE
	<b>DWARF / PATIO TREE</b> HAIRY MOUNTAIN MAHOGANY NEW MEXICO PRIVET YAUPON HOLLY ARIZONA ROSEWOOD
	<b>CONIFEROUS TREE</b> ONESEED JUNIPER COLOGREEN JUNIPER PINYON PINE AFGHAN PINE
	<b>LARGE / SCREENING SHRUB</b> FOURWING SALTBUCH EVERGREEN SILVERBERRY APACHE PLUME ARIZONA SILKTASSEL RIO BRAVO SAGE SKUNKBUSH SUMAC EVERGREEN SUMAC
	<b>MEDIUM SHRUB</b> SAND SAGEBRUSH AGUIRRE TURPENTINE BUSH COMPACT TEXAS RANGER INDIAN HAWTHORN ROSEMARY
	<b>FLOWERING SHRUB</b> THREADLEAF GIANT HYSSOP BLUE MIST BLUEBEARD CALIFORNIA FUCHSIA
	<b>SMALL SHRUB</b> PANCHITO MANZANITA WINTER GEM BOXWOOD GROSSO LAVENDER BLUEBERRY MUFFIN HAWTHORN
	<b>VERTICAL ACCENT</b> TREE CHOLLA OCOTILLO SOAP TREE YUCCA MEXICAN BLUE YUCCA
	<b>LARGE ACCENT</b> BLUE SOTOL GIANT HESPERALOE ARIZONA BEARGRASS DESERT PRICKLY PEAR
	<b>MEDIUM ACCENT</b> CHISO'S AGAVE TEXAS SOTOL RED YUCCA BEARGRASS BLACKSPINE PRICKLY PEAR BANANA YUCCA MARGARITAVILLE YUCCA
	<b>SMALL ACCENT</b> NEW MEXICO AGAVE BRAKELIGHTS RED YUCCA PALE YUCCA TWIST LEAF YUCCA
	<b>LARGE ORNAMENTAL GRASS</b> BULLGRASS AUTUMN GLOW MUHLY GIANT SACATON
	<b>SMALL ORN. GRASS, SEDGE</b> LITTLE BLUESTEM SIDE OATS GRAMA BLONDE AMBITION BLUE GRAMA EUROPEAN GREY SEDGE PINK MUHLY GRASS PURPLE MUHLY ALKALI SACATON
	<b>SMALL GROUND COVER</b> CHOCOLATE DAISY GOPHER PLANT BLACKFOOT DAISY ORANGE GLOBEMALLOW PROSTRATE GERMANDER

**DEKKER  
PERICH  
SABATINI**

ARCHITECT



ENGINEER

**NOT FOR  
CONSTRUCTION**

PROJECT

**ABQ Studios Expansion  
EAST DEVELOPMENT PACKAGE**  
 5650 University Blvd SE  
 Albuquerque, NM 87106

REVISIONS

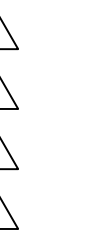

DRAWN BY DC

REVIEWED BY MB

DATE 10/29/2021

PROJECT NO. 20-0072.008

DRAWING NAME

**ALTERNATIVE  
LANDSCAPE PLAN  
DATA**

SHEET NO.

**SDP 2.1**

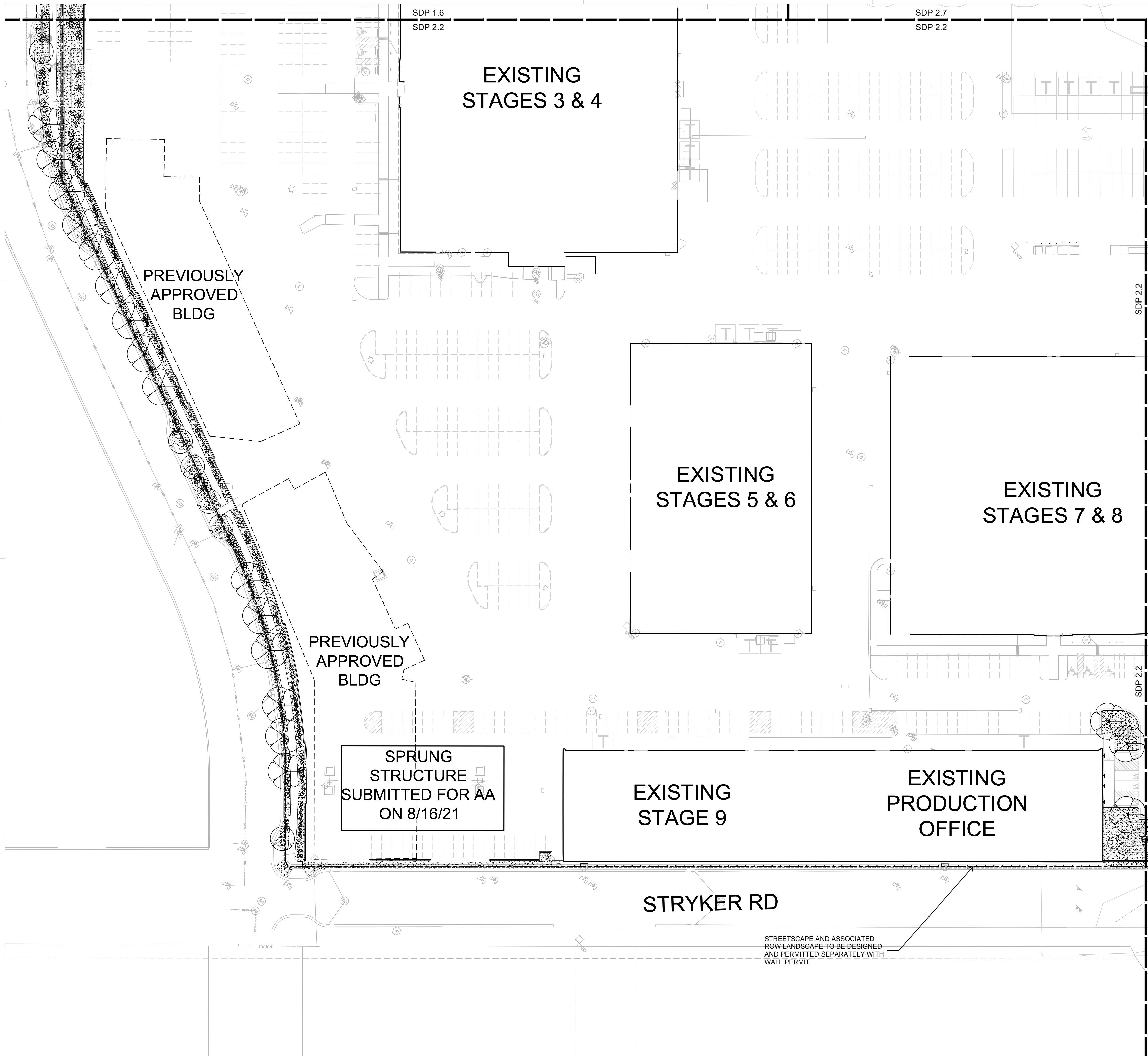

**SHEET KEYED NOTES**

1. EXISTING LANDSCAPE TO REMAIN.
2. CLEAR SIGHT TRIANGLE.
3. STORMWATER POND. SEE CIVIL.
4. UNDISTURBED AREAS TO REMAIN.

**LEGEND**

- 3/4" Ø TAN ROCK MULCH, 3" DEPTH OVER WEED FABRIC
- SHREDDED WOOD MULCH, 4" DEPTH WITHOUT WEED FABRIC
- IRRIGATED NATIVE SEED MIX
- UNIRRIGATED NATIVE SEED MIX
- MATCH LINE
- PROPERTY LINE
- EAST DEVELOPMENT PACKAGE BOUNDARY
- NORTH DEVELOPMENT PACKAGE BOUNDARY
- LEVEL B BOUNDARY

**KEYPLAN**

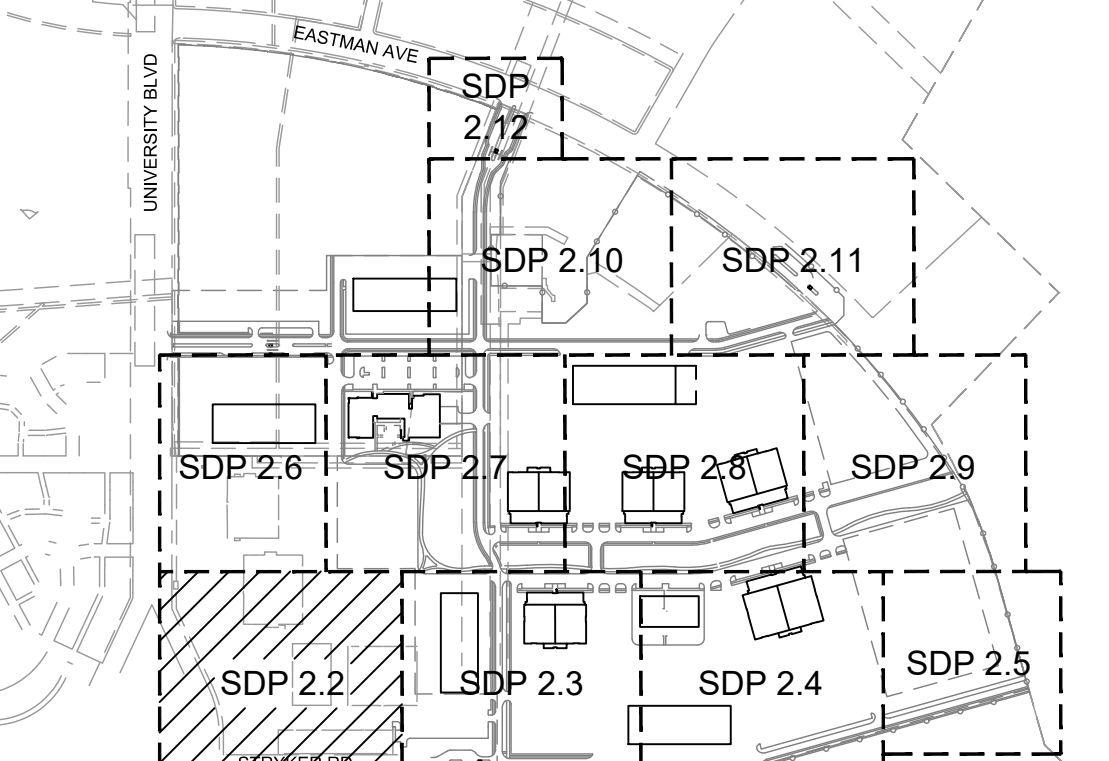

**DEKKER  
PERICH  
SABATINI**

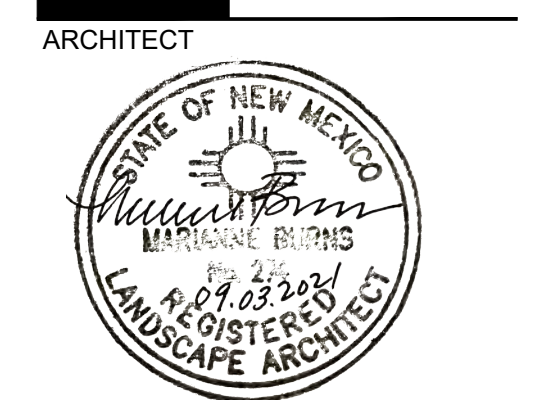

ARCHITECT  
ENGINEER  
**NOT FOR  
CONSTRUCTION**

PROJECT  
**ABQ Studios Expansion  
EAST DEVELOPMENT PACKAGE**  
5650 University Blvd SE  
Albuquerque, NM 87106

REVISIONS

DRAWN BY	DC
REVIEWED BY	MB
DATE	10/29/2021
PROJECT NO.	20-0072.008
DRAWING NAME	ALTERNATIVE LANDSCAPE PLAN

**A1 ALTERNATIVE LANDSCAPE PLAN**  
1" = 40'-0"  
0 20' 40' 80'

**SDP 2.2**  
0 1000' 2000'

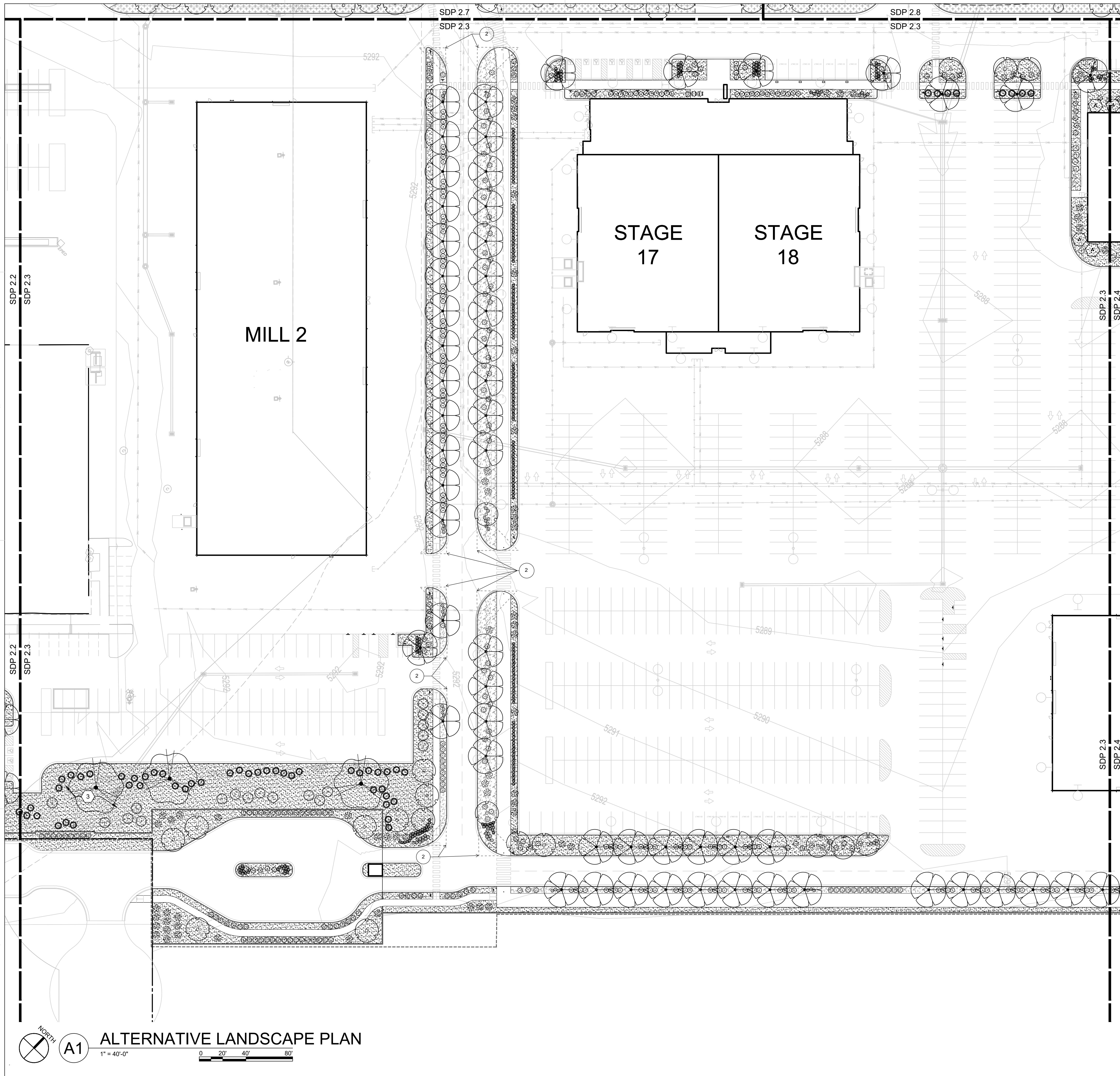

**SHEET KEYED NOTES**

1. EXISTING LANDSCAPE TO REMAIN.
2. CLEAR SIGHT TRIANGLE.
3. STORMWATER POND. SEE CIVIL.
4. UNDISTURBED AREAS TO REMAIN.

**DEKKER  
PERICH  
SABATINI**

ARCHITECT



ENGINEER

**NOT FOR  
CONSTRUCTION**

PROJECT

**ABQ Studios Expansion  
EAST DEVELOPMENT PACKAGE**  
5650 University Blvd SE  
Albuquerque, NM 87106

**LEGEND**

- 3/4" Ø TAN ROCK MULCH, 3" DEPTH OVER WEED FABRIC
- SHREDDED WOOD MULCH, 4" DEPTH WITHOUT WEED FABRIC
- IRRIGATED NATIVE SEED MIX
- UNIRRIGATED NATIVE SEED MIX
- MATCH LINE
- PROPERTY LINE
- EAST DEVELOPMENT PACKAGE BOUNDARY
- NORTH DEVELOPMENT PACKAGE BOUNDARY
- LEVEL B BOUNDARY

**KEYPLAN**

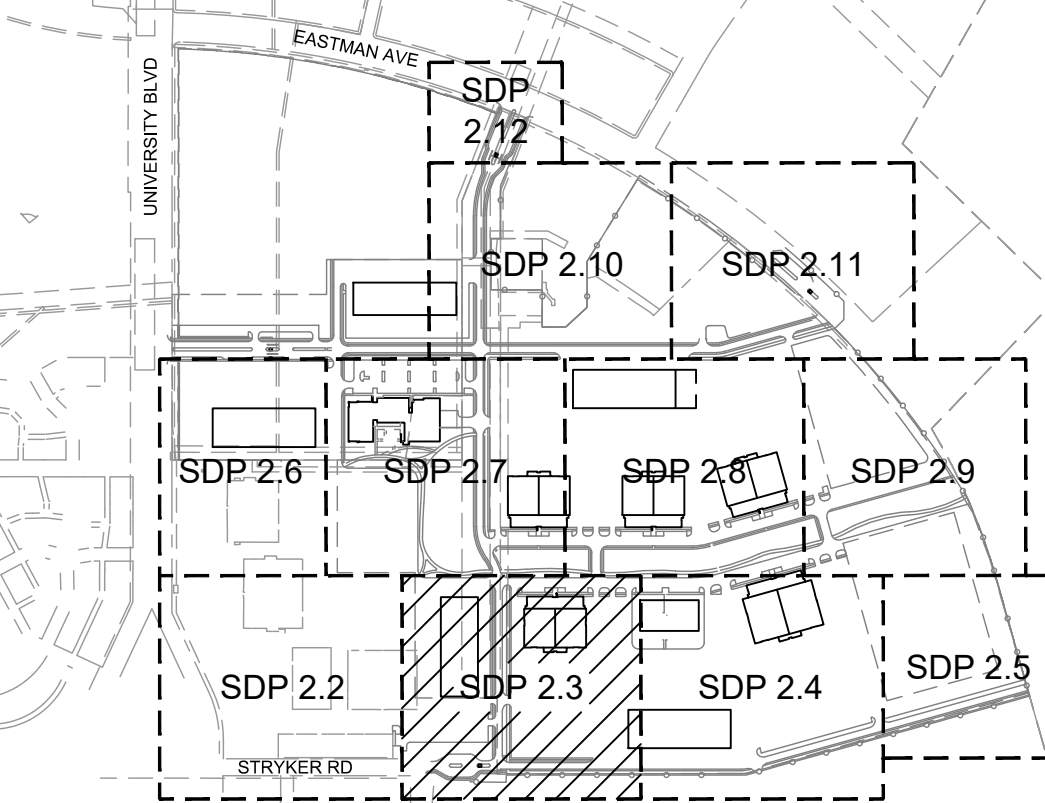

**ALTERNATIVE LANDSCAPE PLAN**  
A1  
1" = 40'-0"  
0 20' 40' 80'

REVISIONS

- △
- △
- △
- △

DRAWN BY DC  
REVIEWED BY MB  
DATE 10/29/2021  
PROJECT NO. 20-0072.008  
DRAWING NAME

**ALTERNATIVE  
LANDSCAPE PLAN**

SHEET NO.

**SDP 2.3**

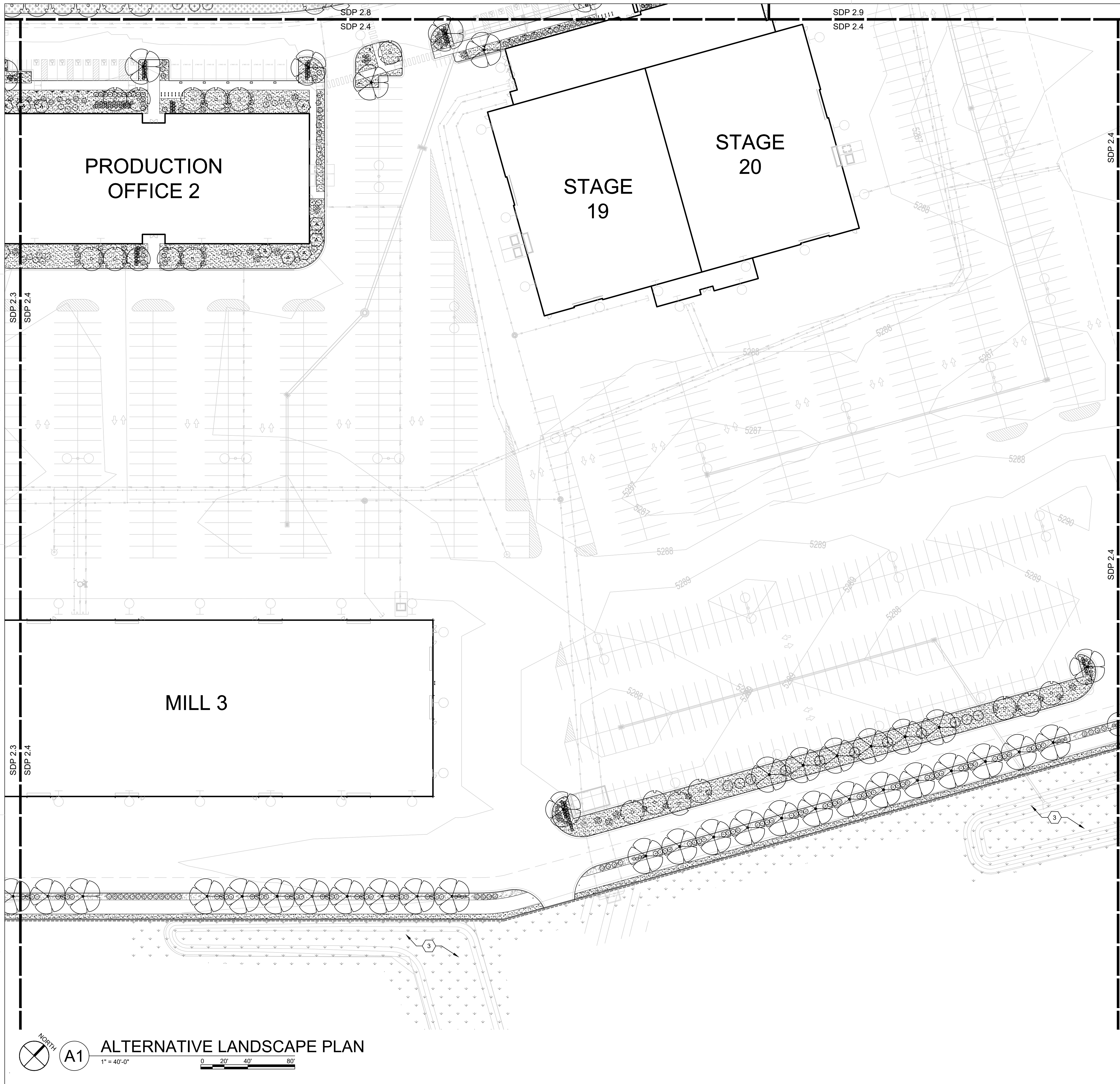

**SHEET KEYED NOTES**

1. EXISTING LANDSCAPE TO REMAIN.
2. CLEAR SIGHT TRIANGLE.
3. STORMWATER POND. SEE CIVIL.
4. UNDISTURBED AREAS TO REMAIN.

**LEGEND**

- 3/4" Ø TAN ROCK MULCH, 3" DEPTH OVER WEED FABRIC
- SHREDDED WOOD MULCH, 4" DEPTH WITHOUT WEED FABRIC
- IRRIGATED NATIVE SEED MIX
- UNIRRIGATED NATIVE SEED MIX
- MATCH LINE
- PROPERTY LINE
- EAST DEVELOPMENT PACKAGE BOUNDARY
- NORTH DEVELOPMENT PACKAGE BOUNDARY
- LEVEL B BOUNDARY

**KEYPLAN**

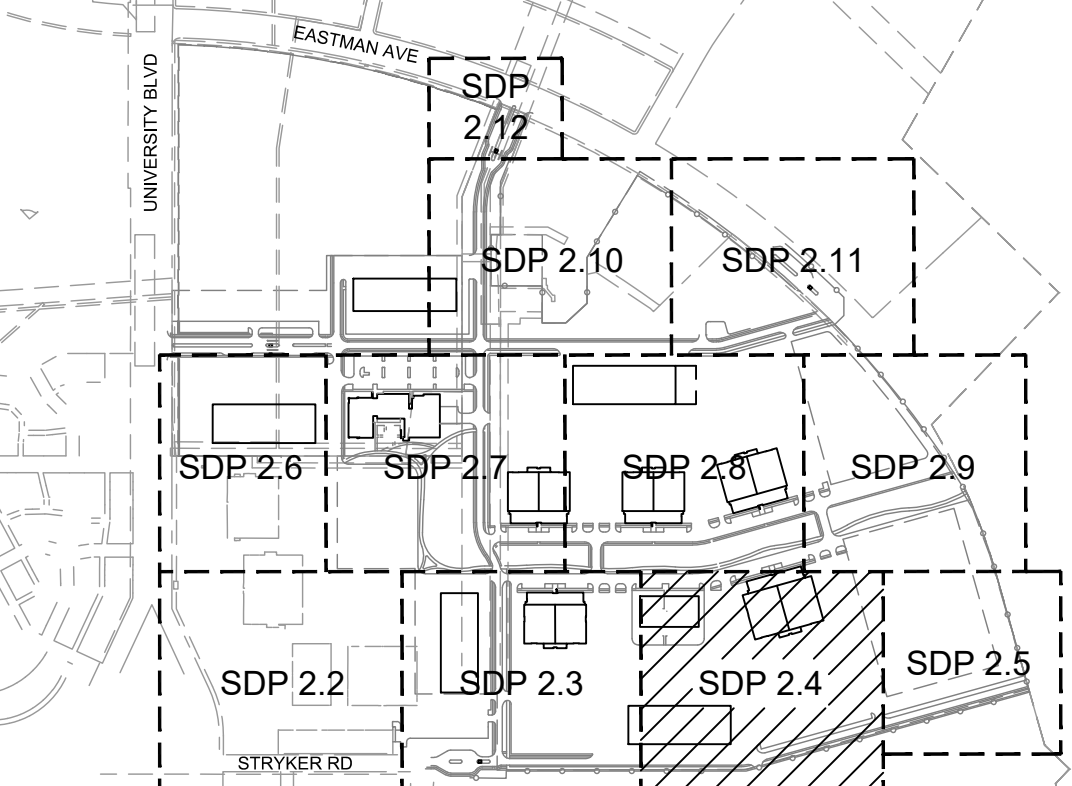

**DEKKER  
PERICH  
SABATINI**

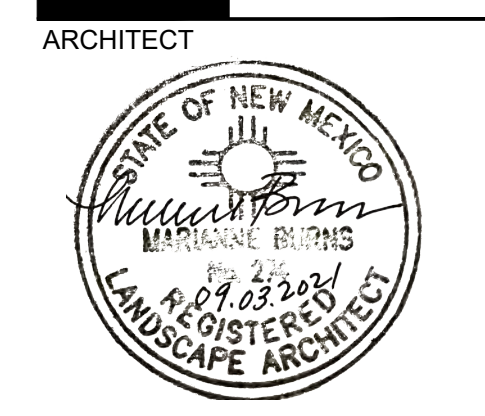

ARCHITECT  
ENGINEER  
**NOT FOR  
CONSTRUCTION**

PROJECT  
**ABQ Studios Expansion  
EAST DEVELOPMENT PACKAGE**  
5650 University Blvd SE  
Albuquerque, NM 87106

REVISIONS

DRAWN BY	DC
REVIEWED BY	MB
DATE	10/29/2021
PROJECT NO.	20-0072.008
DRAWING NAME	

**ALTERNATIVE  
LANDSCAPE PLAN**

SHEET NO.  
**SDP 2.4**

**A1 ALTERNATIVE LANDSCAPE PLAN**  
1" = 40'-0"  
0 20' 40' 80'

SHEET KEYED NOTES

1. EXISTING LANDSCAPE TO REMAIN.
2. CLEAR SIGHT TRIANGLE.
3. STORMWATER POND. SEE CIVIL.
4. UNDISTURBED AREAS TO REMAIN.

**DEKKER  
PERICH  
SABATINI**

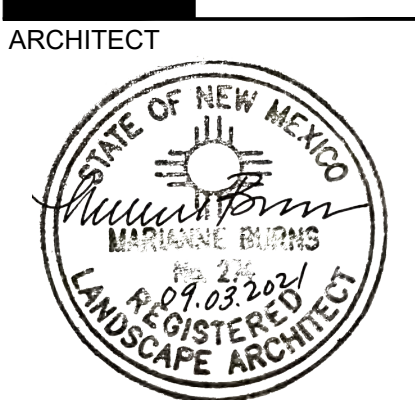

ARCHITECT  
  
ENGINEER  
  
**NOT FOR  
CONSTRUCTION**

PROJECT  
  
ABQ Studios Expansion  
EAST DEVELOPMENT PACKAGE  
5650 University Blvd SE  
Albuquerque, NM 87106

LEGEND

- 3/4" Ø TAN ROCK MULCH, 3" DEPTH OVER WEED FABRIC
- SHREDDED WOOD MULCH, 4" DEPTH WITHOUT WEED FABRIC
- IRRIGATED NATIVE SEED MIX
- UNIRRIGATED NATIVE SEED MIX
- MATCH LINE
- PROPERTY LINE
- EAST DEVELOPMENT PACKAGE BOUNDARY
- NORTH DEVELOPMENT PACKAGE BOUNDARY
- LEVEL B BOUNDARY

KEYPLAN

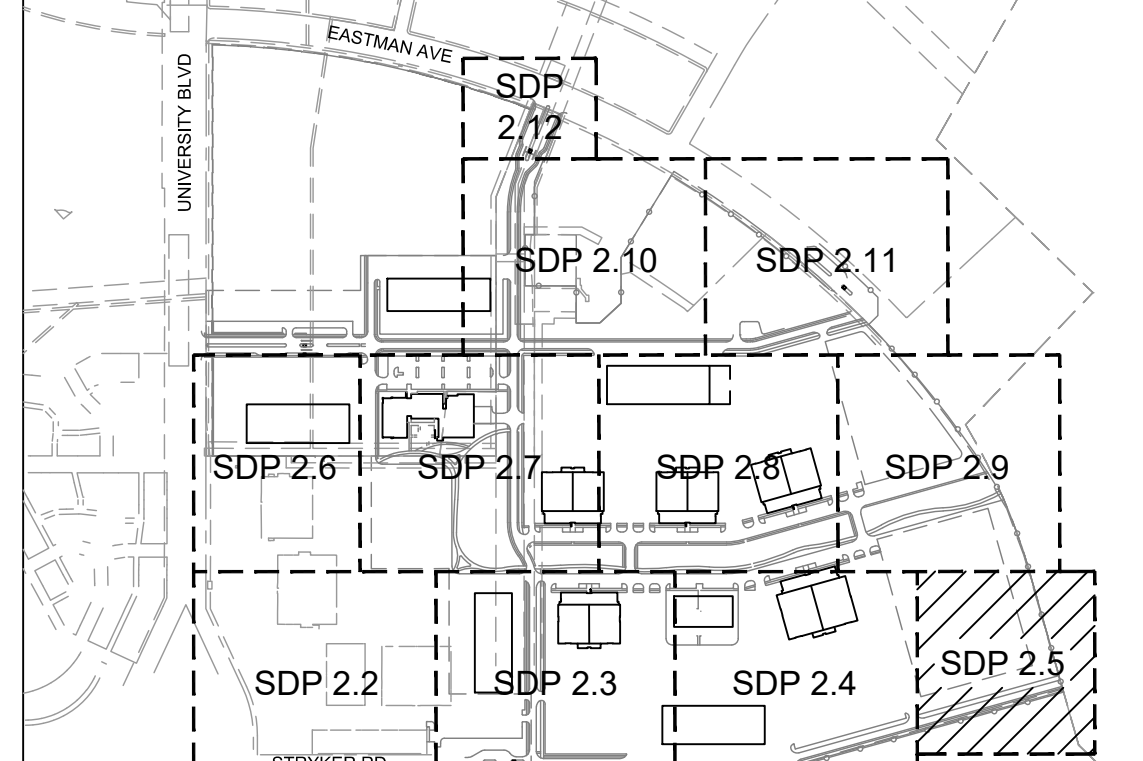

REVISIONS

DRAWN BY	DC
REVIEWED BY	MB
DATE	10/29/2021
PROJECT NO.	20-0072.008
DRAWING NAME	

ALTERNATIVE  
LANDSCAPE PLAN

SHEET NO.  
**SDP 2.5**

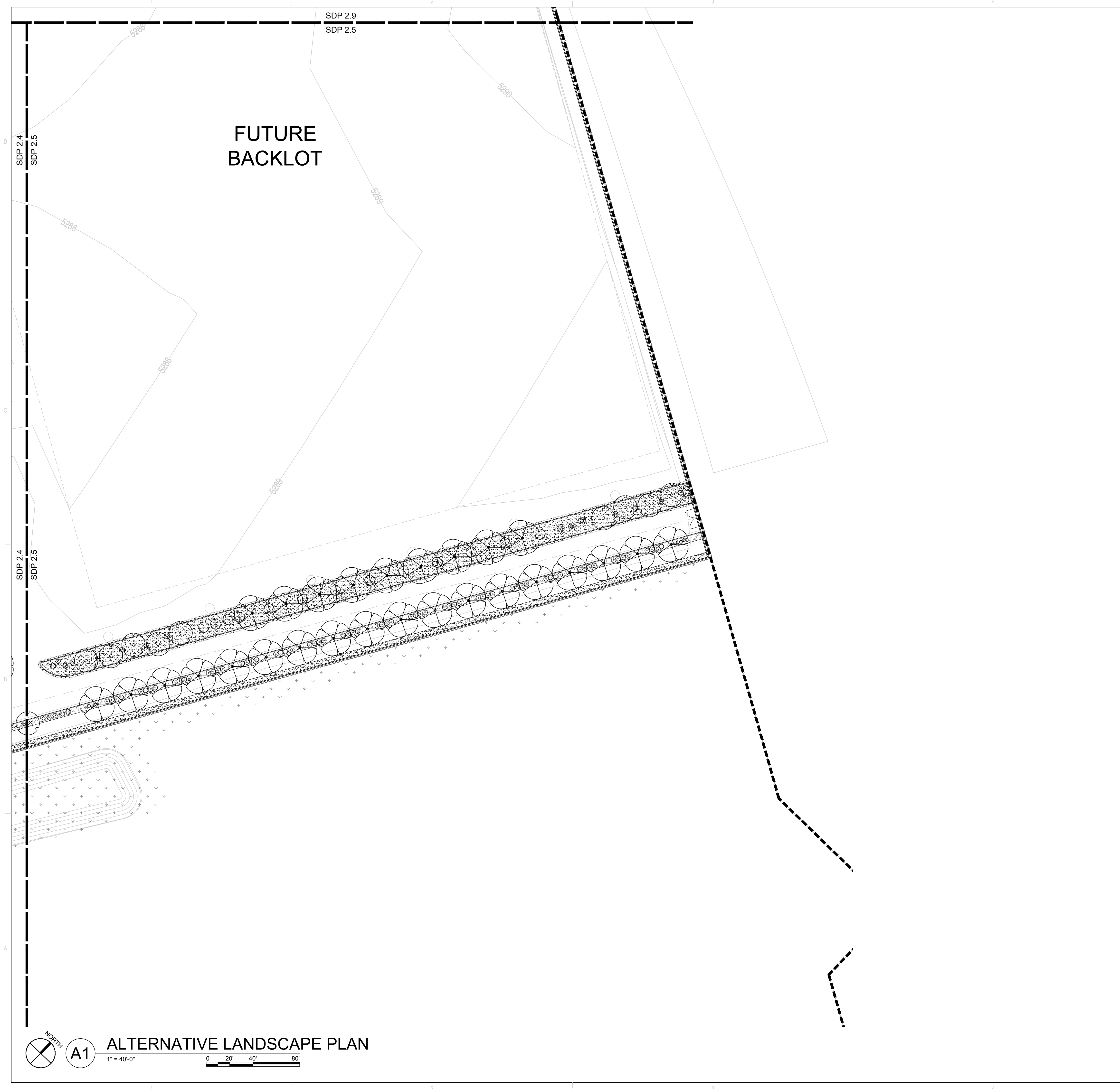

**ALTERNATIVE LANDSCAPE PLAN**  
A1  
1" = 40'-0"  
0 20' 40' 80'

**SHEET KEYED NOTES**

1. EXISTING LANDSCAPE TO REMAIN.
2. CLEAR SIGHT TRIANGLE.
3. STORMWATER POND. SEE CIVIL.
4. UNDISTURBED AREAS TO REMAIN.

**DEKKER  
PERICH  
SABATINI**

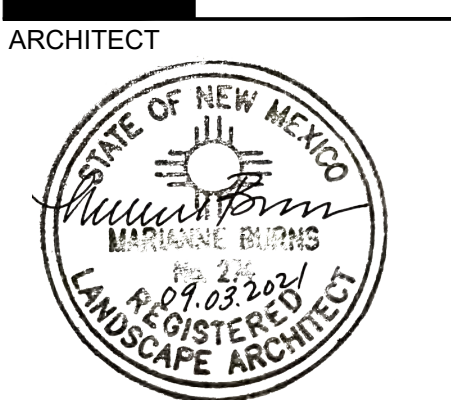

ARCHITECT  
ENGINEER  
**NOT FOR  
CONSTRUCTION**

PROJECT

**ABQ Studios Expansion  
EAST DEVELOPMENT PACKAGE**  
5650 University Blvd SE  
Albuquerque, NM 87106

REVISIONS

DRAWN BY	DC
REVIEWED BY	MB
DATE	10/29/2021
PROJECT NO.	20-0072.008
DRAWING NAME	

**ALTERNATIVE  
LANDSCAPE PLAN**

SHEET NO.  
**SDP 2.6**

**LEGEND**

- 3/4" Ø TAN ROCK MULCH, 3" DEPTH OVER WEED FABRIC
- SHREDDED WOOD MULCH, 4" DEPTH WITHOUT WEED FABRIC
- IRRIGATED NATIVE SEED MIX
- UNIRRIGATED NATIVE SEED MIX
- MATCH LINE
- PROPERTY LINE
- EAST DEVELOPMENT PACKAGE BOUNDARY
- NORTH DEVELOPMENT PACKAGE BOUNDARY
- LEVEL B BOUNDARY

**KEYPLAN**

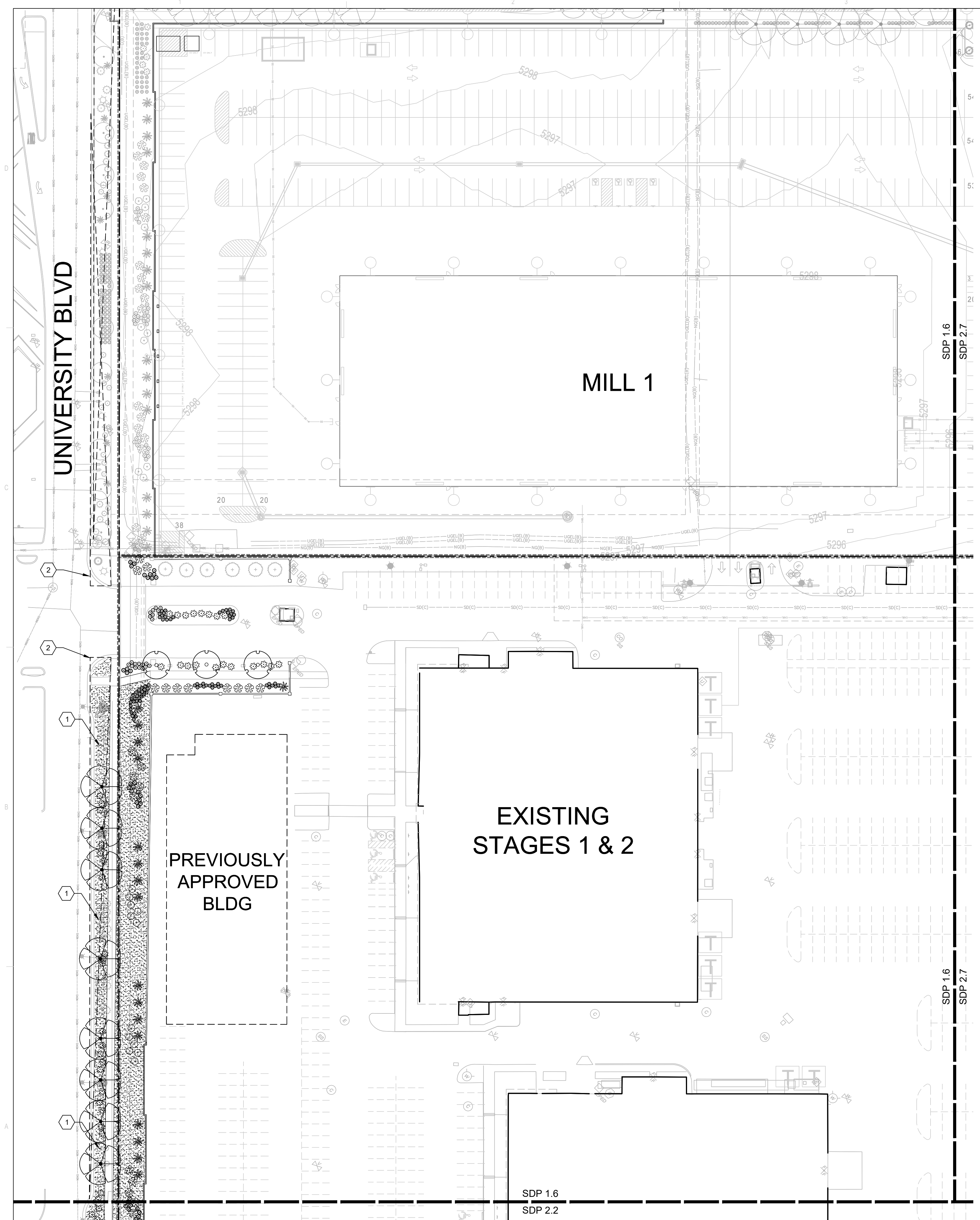
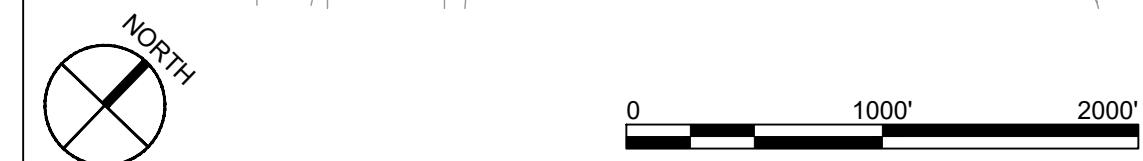
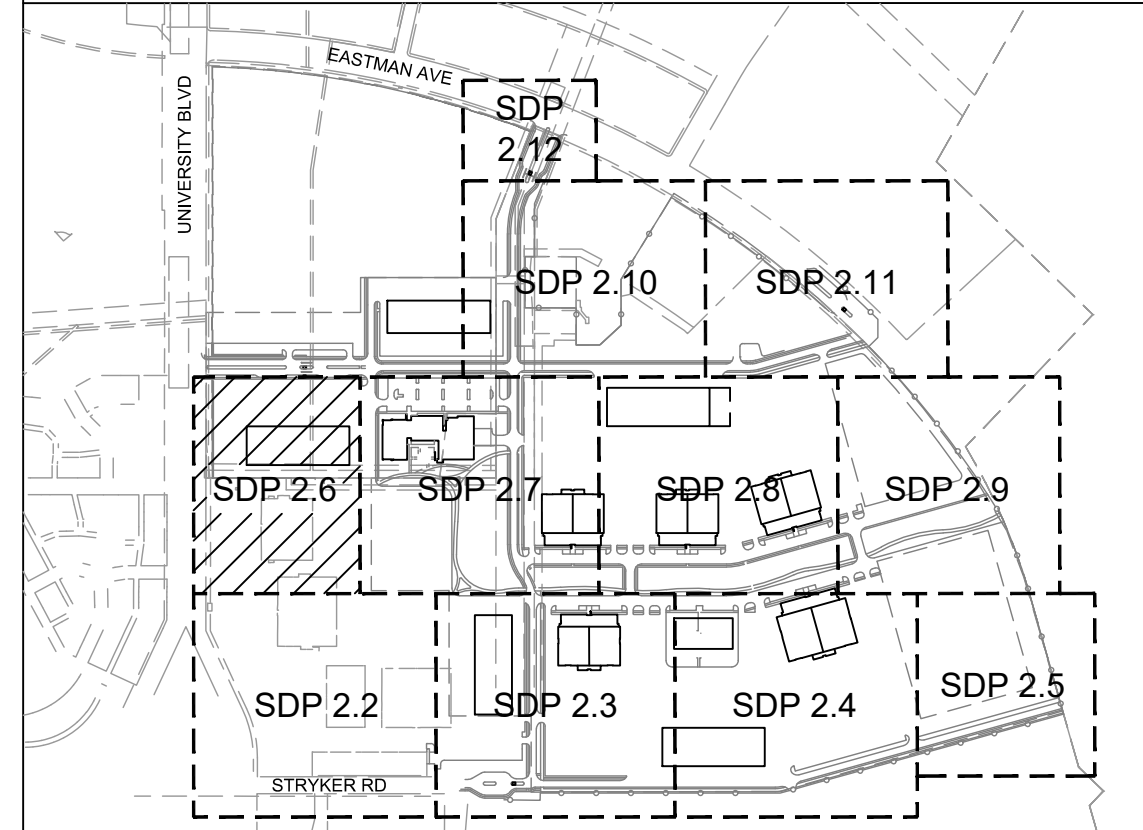

**A1 ALTERNATIVE LANDSCAPE PLAN**  
1" = 40'-0"  
0 20' 40' 80'



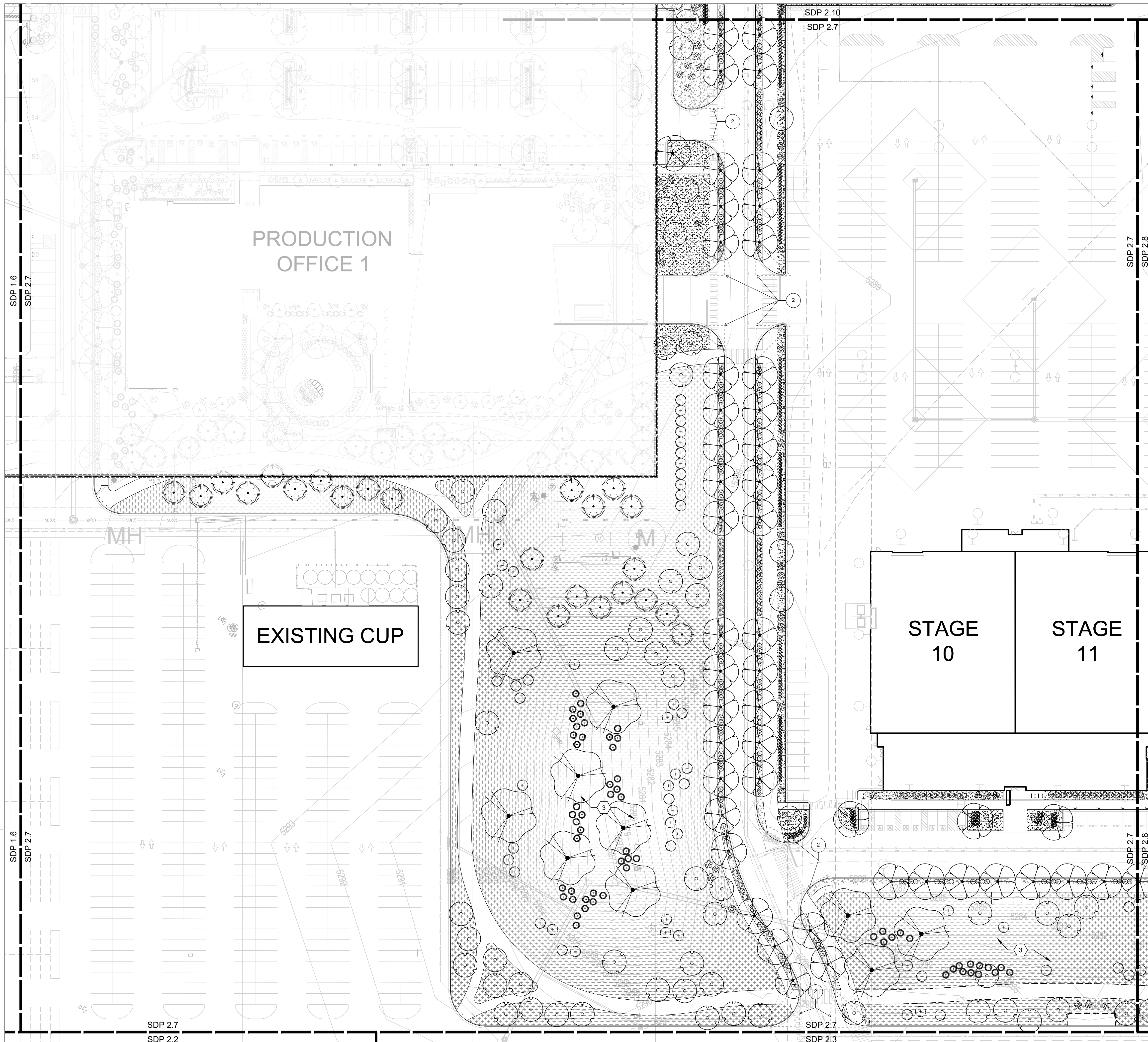

**SHEET KEYED NOTES**

1. EXISTING LANDSCAPE TO REMAIN.
2. CLEAR SIGHT TRIANGLE.
3. STORMWATER POND. SEE CIVIL.
4. UNDISTURBED AREAS TO REMAIN.

**LEGEND**

- 3/4" Ø TAN ROCK MULCH, 3" DEPTH OVER WEED FABRIC
- SHREDDED WOOD MULCH, 4" DEPTH WITHOUT WEED FABRIC
- IRRIGATED NATIVE SEED MIX
- UNIRRIGATED NATIVE SEED MIX
- MATCH LINE
- PROPERTY LINE
- EAST DEVELOPMENT PACKAGE BOUNDARY
- NORTH DEVELOPMENT PACKAGE BOUNDARY
- LEVEL B BOUNDARY

**KEYPLAN**

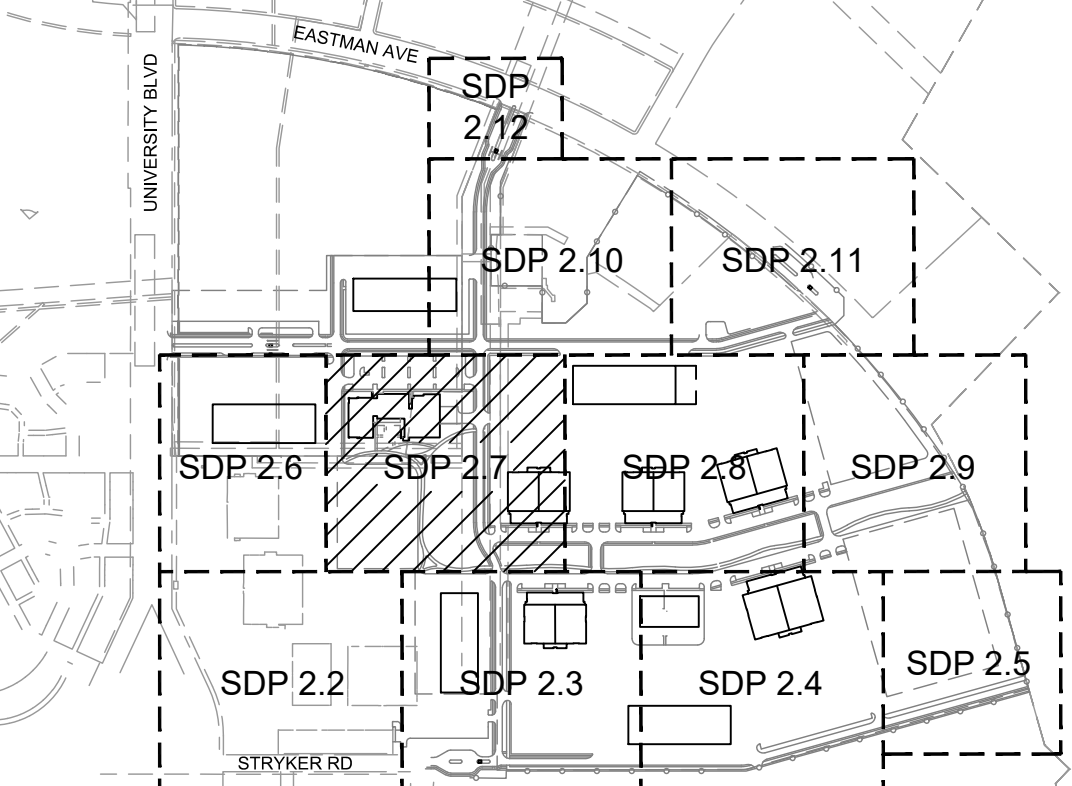

**DEKKER  
PERICH  
SABATINI**

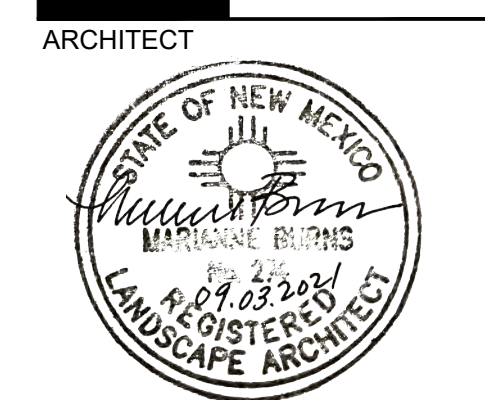

ARCHITECT  
**NOT FOR  
CONSTRUCTION**

PROJECT  
**ABQ Studios Expansion  
EAST DEVELOPMENT PACKAGE**  
5650 University Blvd SE  
Albuquerque, NM 87106

REVISIONS  
▲  
▲  
▲  
▲

DRAWN BY DC  
REVIEWED BY MB  
DATE 10/29/2021  
PROJECT NO. 20-0072.008  
DRAWING NAME

**ALTERNATIVE  
LANDSCAPE PLAN**

SHEET NO.  
**SDP 2.7**

**A1 ALTERNATIVE LANDSCAPE PLAN**  
1" = 40'-0"  
0 20' 40' 80'

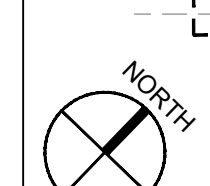
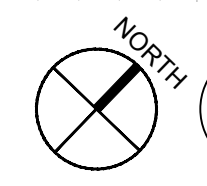



**SHEET KEYED NOTES**

1. EXISTING LANDSCAPE TO REMAIN.
2. CLEAR SIGHT TRIANGLE.
3. STORMWATER POND. SEE CIVIL.
4. UNDISTURBED AREAS TO REMAIN.

**LEGEND**

- 3/4" Ø TAN ROCK MULCH, 3" DEPTH OVER WEED FABRIC
- SHREDDED WOOD MULCH, 4" DEPTH WITHOUT WEED FABRIC
- IRRIGATED NATIVE SEED MIX
- UNIRRIGATED NATIVE SEED MIX
- MATCH LINE
- PROPERTY LINE
- EAST DEVELOPMENT PACKAGE BOUNDARY
- NORTH DEVELOPMENT PACKAGE BOUNDARY
- LEVEL B BOUNDARY

**KEYPLAN**

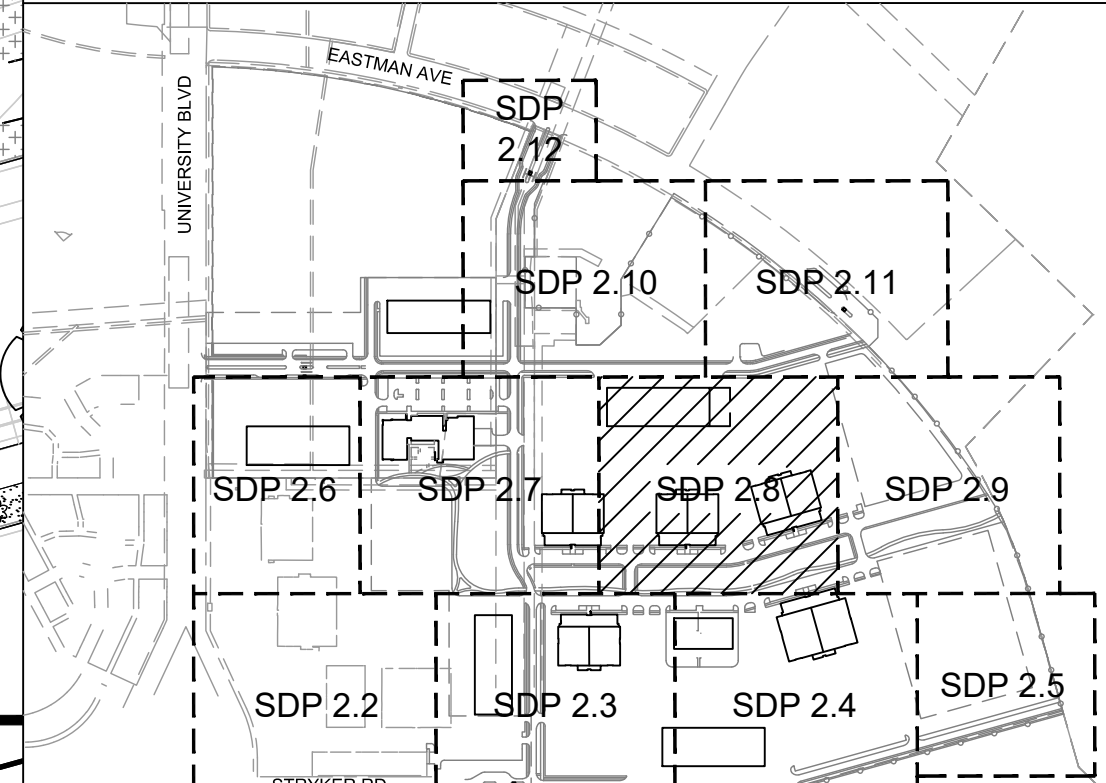

**DEKKER  
PERICH  
SABATINI**

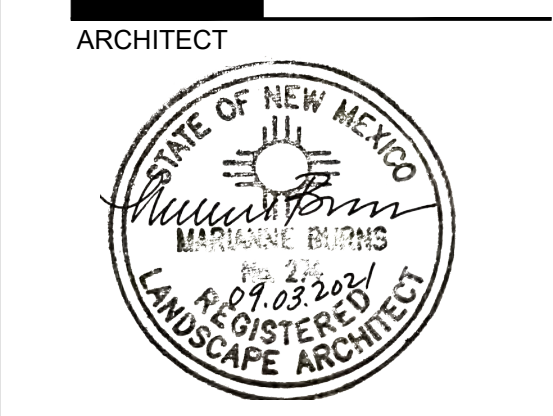

ARCHITECT  
ENGINEER

**NOT FOR  
CONSTRUCTION**

PROJECT

**ABQ Studios Expansion  
EAST DEVELOPMENT PACKAGE**  
5650 University Blvd SE  
Albuquerque, NM 87106

REVISIONS

DRAWN BY	DC
REVIEWED BY	MB
DATE	10/29/2021
PROJECT NO.	20-0072.008
DRAWING NAME	ALTERNATIVE LANDSCAPE PLAN

ALTERNATIVE  
LANDSCAPE PLAN

SHEET NO.  
**SDP 2.8**

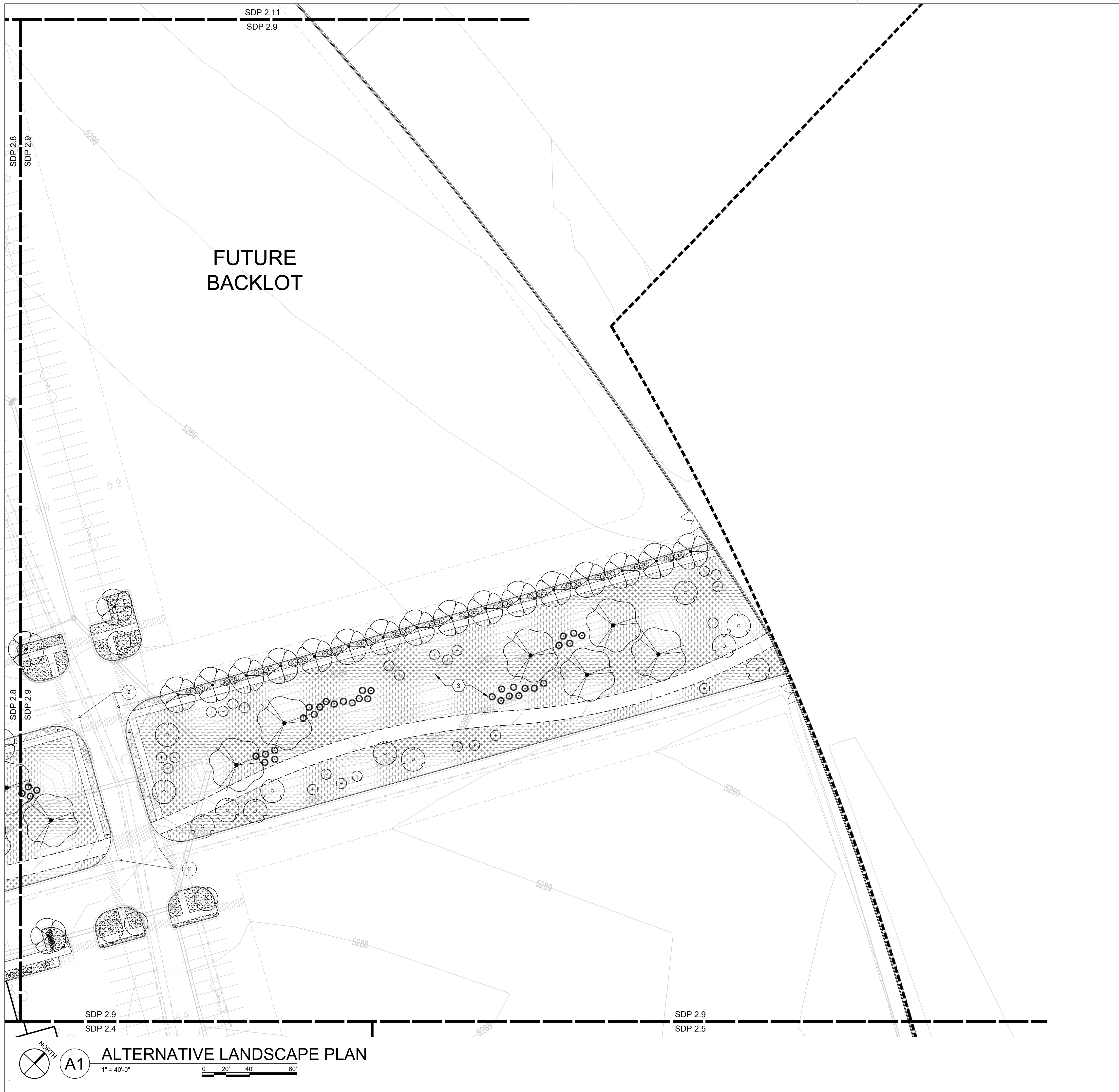

**SHEET KEYED NOTES**

1. EXISTING LANDSCAPE TO REMAIN.
2. CLEAR SIGHT TRIANGLE.
3. STORMWATER POND. SEE CIVIL.
4. UNDISTURBED AREAS TO REMAIN.

**LEGEND**

- 3/4" Ø TAN ROCK MULCH, 3" DEPTH OVER WEED FABRIC
- SHREDDED WOOD MULCH, 4" DEPTH WITHOUT WEED FABRIC
- IRRIGATED NATIVE SEED MIX
- UNIRRIGATED NATIVE SEED MIX
- MATCH LINE
- PROPERTY LINE
- EAST DEVELOPMENT PACKAGE BOUNDARY
- NORTH DEVELOPMENT PACKAGE BOUNDARY
- LEVEL B BOUNDARY

**KEYPLAN**

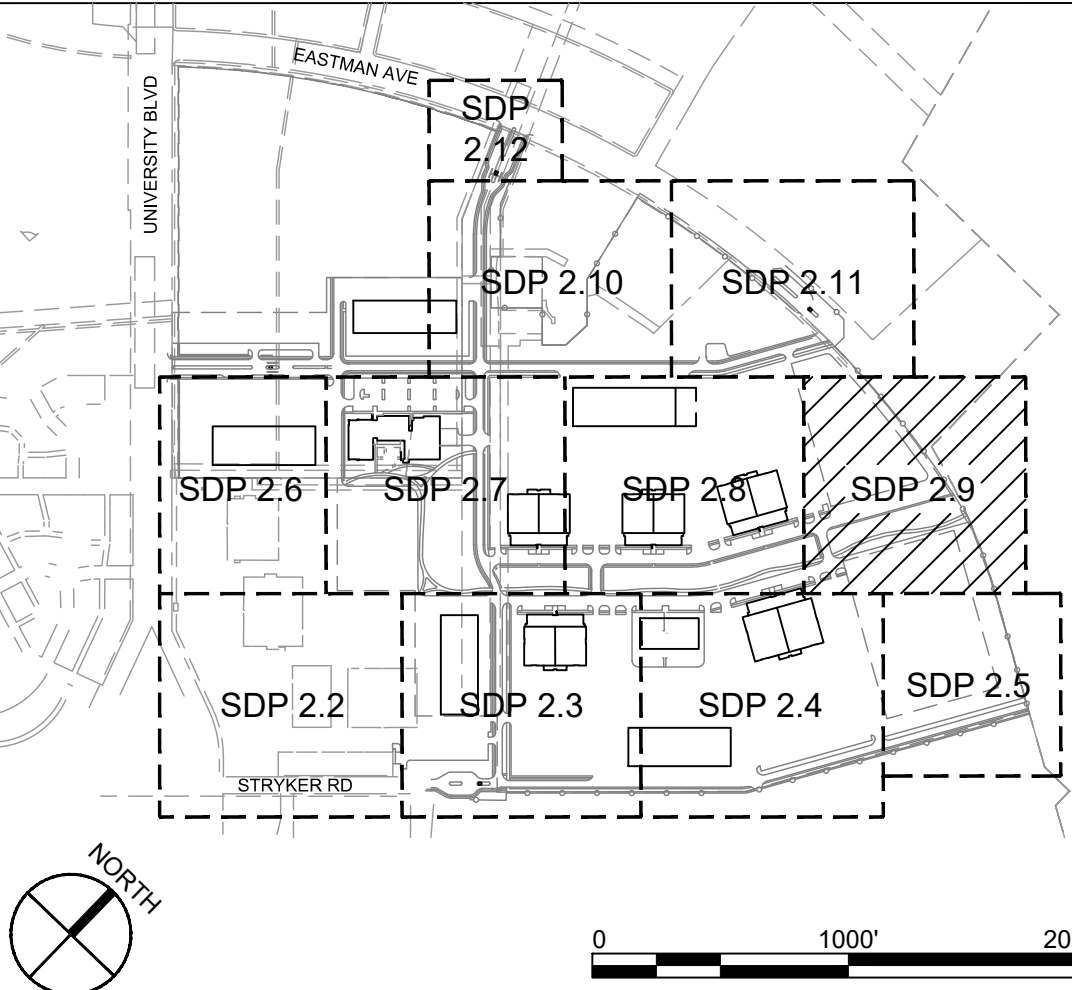

**DEKKER  
PERICH  
SABATINI**

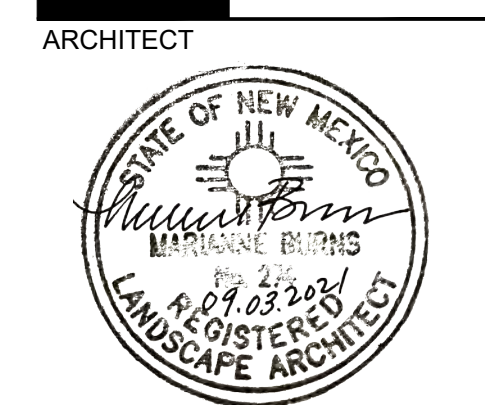

ARCHITECT  
**NOT FOR  
CONSTRUCTION**

ENGINEER  
PROJECT  
**ABQ Studios Expansion  
EAST DEVELOPMENT PACKAGE**  
5650 University Blvd SE  
Albuquerque, NM 87106

REVISIONS

DRAWN BY	DC
REVIEWED BY	MB
DATE	10/29/2021
PROJECT NO.	20-0072.008
DRAWING NAME	

**ALTERNATIVE  
LANDSCAPE PLAN**

SHEET NO.  
**SDP 2.9**

**A1 ALTERNATIVE LANDSCAPE PLAN**  
1" = 40'-0"  
0 20' 40' 80'

SHEET KEYED NOTES

1. EXISTING LANDSCAPE TO REMAIN.
2. CLEAR SIGHT TRIANGLE.
3. STORMWATER POND. SEE CIVIL.
4. UNDISTURBED AREAS TO REMAIN.

**DEKKER  
PERICH  
SABATINI**

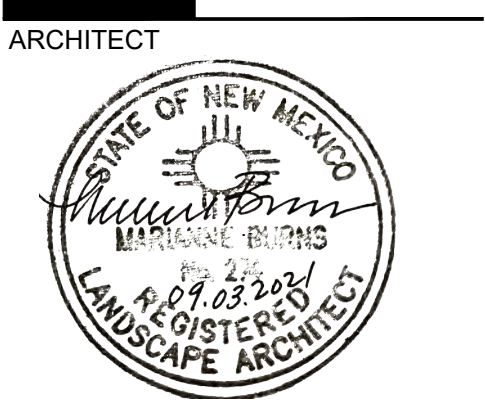

ARCHITECT  
ENGINEER  
**NOT FOR  
CONSTRUCTION**

PROJECT

**ABQ Studios Expansion  
EAST DEVELOPMENT PACKAGE**  
5650 University Blvd SE  
Albuquerque, NM 87106

LEGEND

- 3/4" Ø TAN ROCK MULCH, 3" DEPTH OVER WEED FABRIC
- SHREDDED WOOD MULCH, 4" DEPTH WITHOUT WEED FABRIC
- IRRIGATED NATIVE SEED MIX
- UNIRRIGATED NATIVE SEED MIX
- MATCH LINE
- PROPERTY LINE
- EAST DEVELOPMENT PACKAGE BOUNDARY
- NORTH DEVELOPMENT PACKAGE BOUNDARY
- LEVEL B BOUNDARY

KEYPLAN

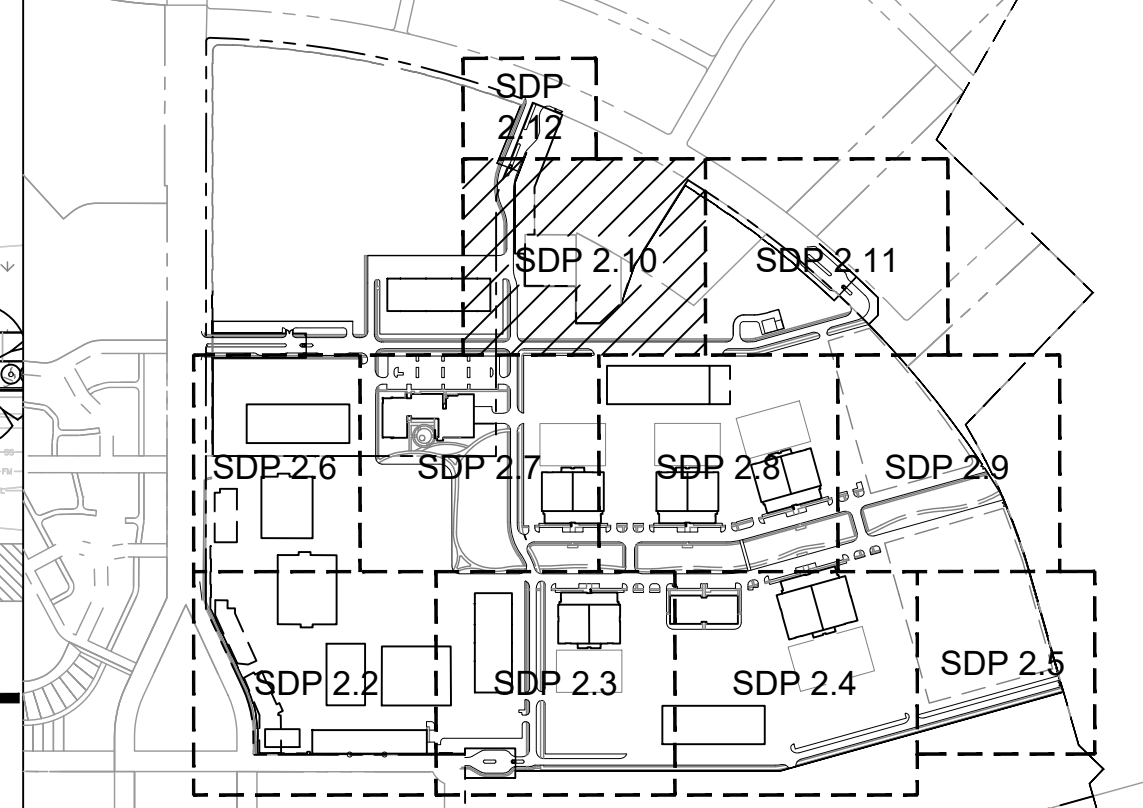

REVISIONS



DRAWN BY	DC
REVIEWED BY	MB
DATE	10/29/2021
PROJECT NO.	20-0072.008
DRAWING NAME	

**ALTERNATIVE  
LANDSCAPE PLAN**

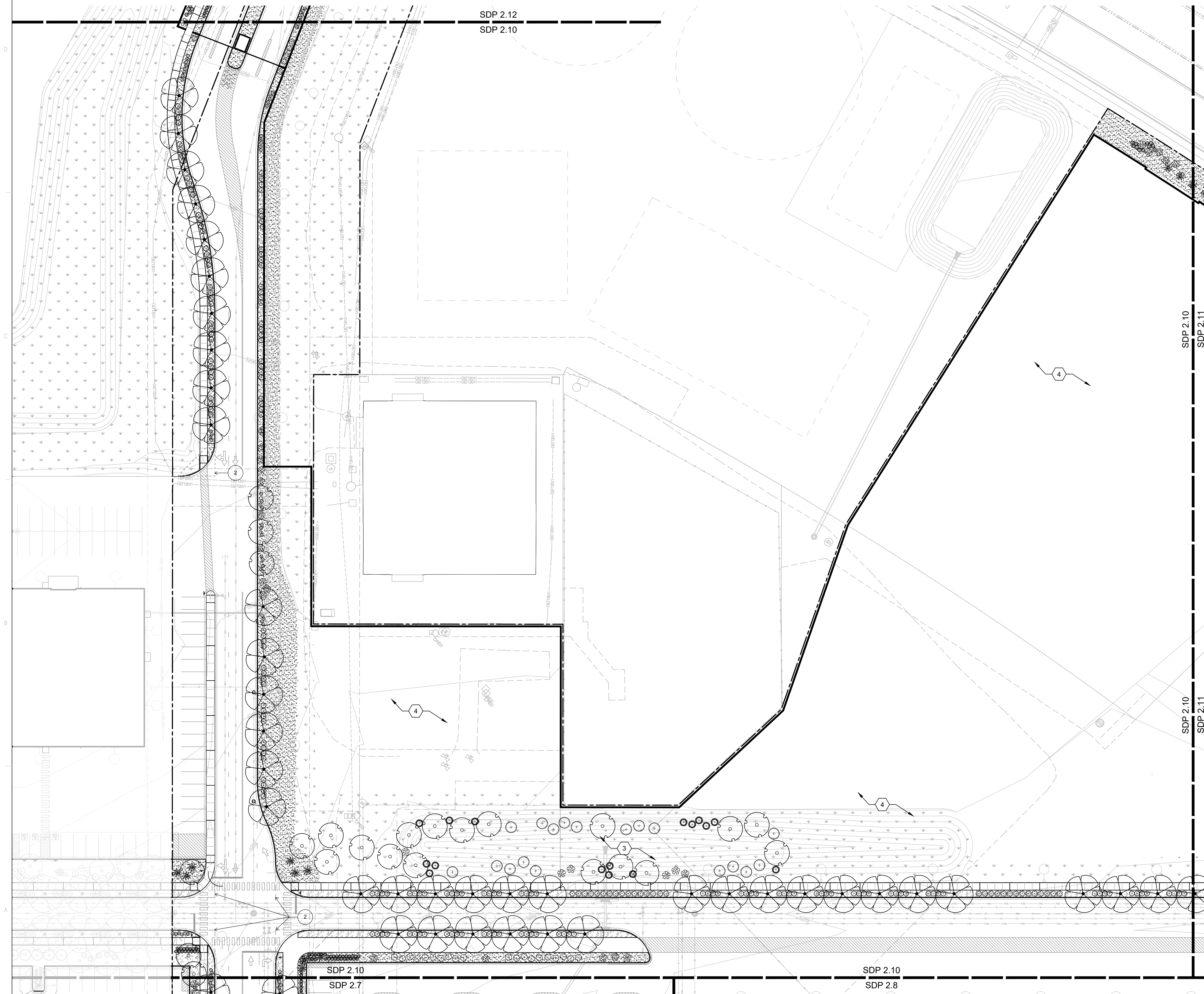
SHEET NO.  
**SDP 2.10**

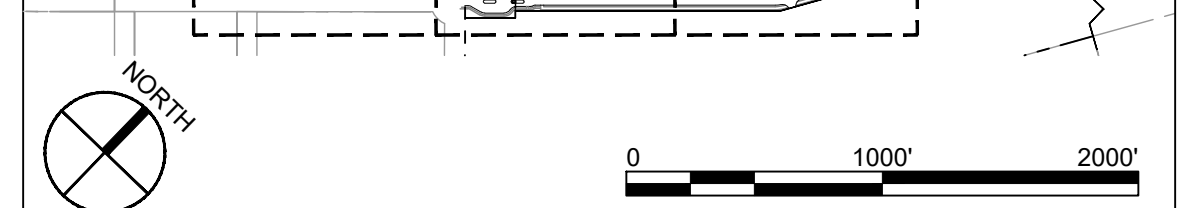

**ALTERNATIVE LANDSCAPE PLAN**  
1" = 40'-0"  
0 20' 40' 80'



**SHEET KEYED NOTES**

1. EXISTING LANDSCAPE TO REMAIN.
2. CLEAR SIGHT TRIANGLE.
3. STORMWATER POND. SEE CIVIL.
4. UNDISTURBED AREAS TO REMAIN.

**DEKKER  
PERICH  
SABATINI**

ARCHITECT



ENGINEER

**NOT FOR  
CONSTRUCTION**

PROJECT

**ABQ Studios Expansion  
EAST DEVELOPMENT PACKAGE**  
5650 University Blvd SE  
Albuquerque, NM 87106

REVISIONS

- △
- △
- △
- △

DRAWN BY: DC  
REVIEWED BY: MB  
DATE: 11/19/2021  
PROJECT NO.: 20-0072.008  
DRAWING NAME:

**ALTERNATIVE  
LANDSCAPE PLAN**

SHEET NO.

**SDP 2.11**

**BACKLOT  
C**

**LEGEND**

- 3/4" Ø TAN ROCK MULCH, 3" DEPTH OVER WEED FABRIC
- SHREDDED WOOD MULCH, 4" DEPTH WITHOUT WEED FABRIC
- IRRIGATED NATIVE SEED MIX
- UNIRRIGATED NATIVE SEED MIX
- MATCH LINE
- PROPERTY LINE
- EAST DEVELOPMENT PACKAGE BOUNDARY
- NORTH DEVELOPMENT PACKAGE BOUNDARY
- LEVEL B BOUNDARY

**KEYPLAN**

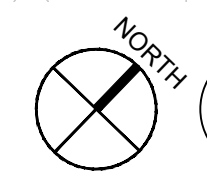
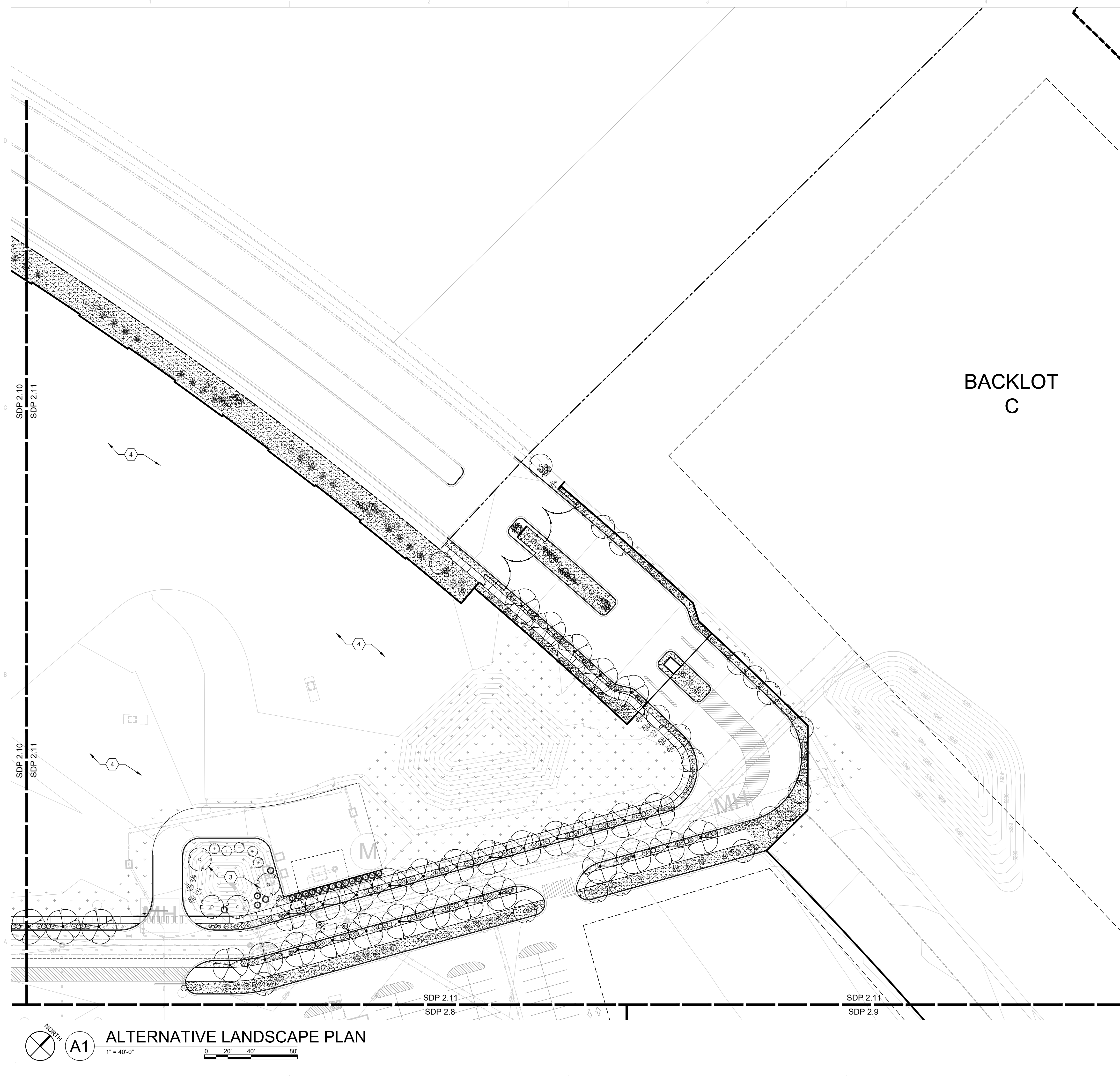
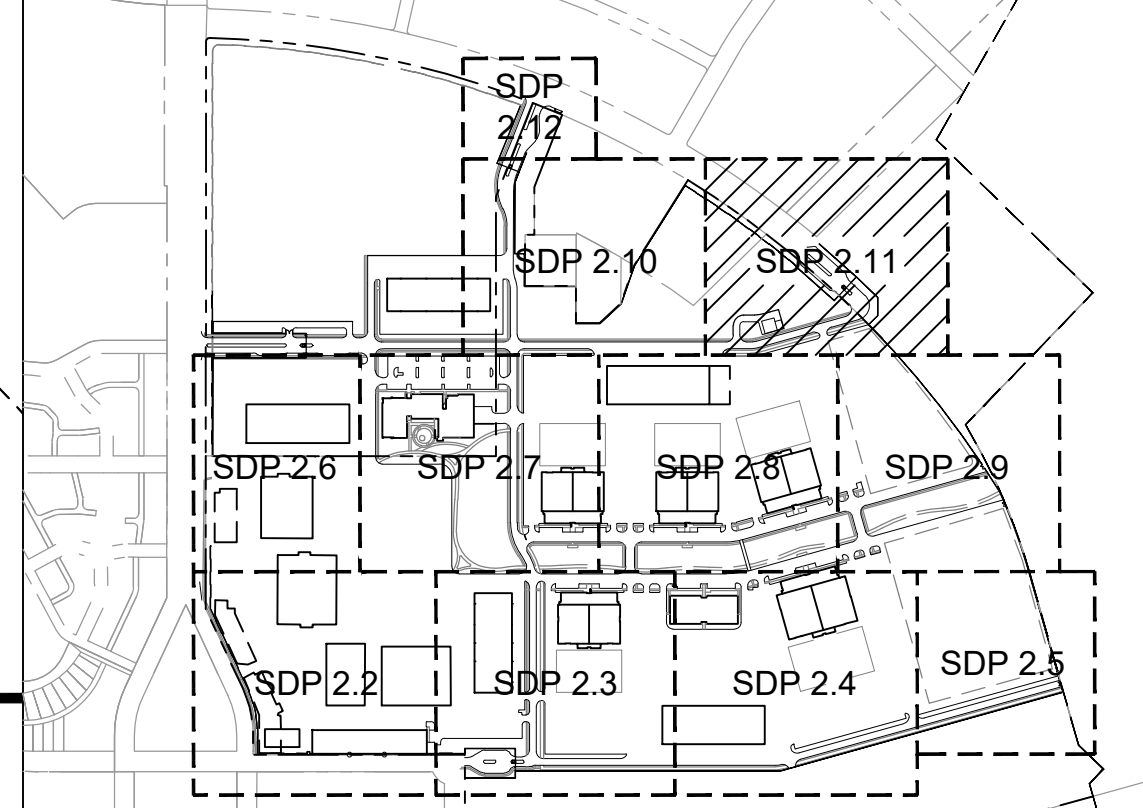

**A1**

**ALTERNATIVE LANDSCAPE PLAN**

1" = 40'-0"  
0 20' 40' 80'

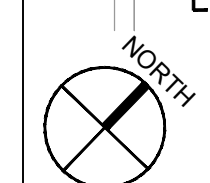





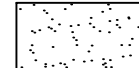
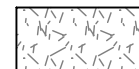

0 1000' 2000'

◇ SHEET KEYED NOTES

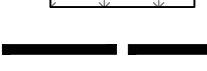
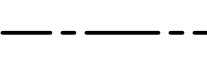
1. EXISTING LANDSCAPE TO REMAIN.
2. CLEAR SIGHT TRIANGLE.
3. STORMWATER POND. SEE CIVIL.
4. UNDISTURBED AREAS TO REMAIN.

LEGEND

-  3/4" Ø TAN ROCK MULCH, 3" DEPTH OVER WEED FABRIC
-  SHREDDED WOOD MULCH, 4" DEPTH WITHOUT WEED FABRIC
-  IRRIGATED NATIVE SEED MIX
-  UNIRRIGATED NATIVE SEED MIX
-  MATCH LINE
-  PROPERTY LINE
-  EAST DEVELOPMENT PACKAGE BOUNDARY
-  NORTH DEVELOPMENT PACKAGE BOUNDARY
-  LEVEL B BOUNDARY

KEYPLAN

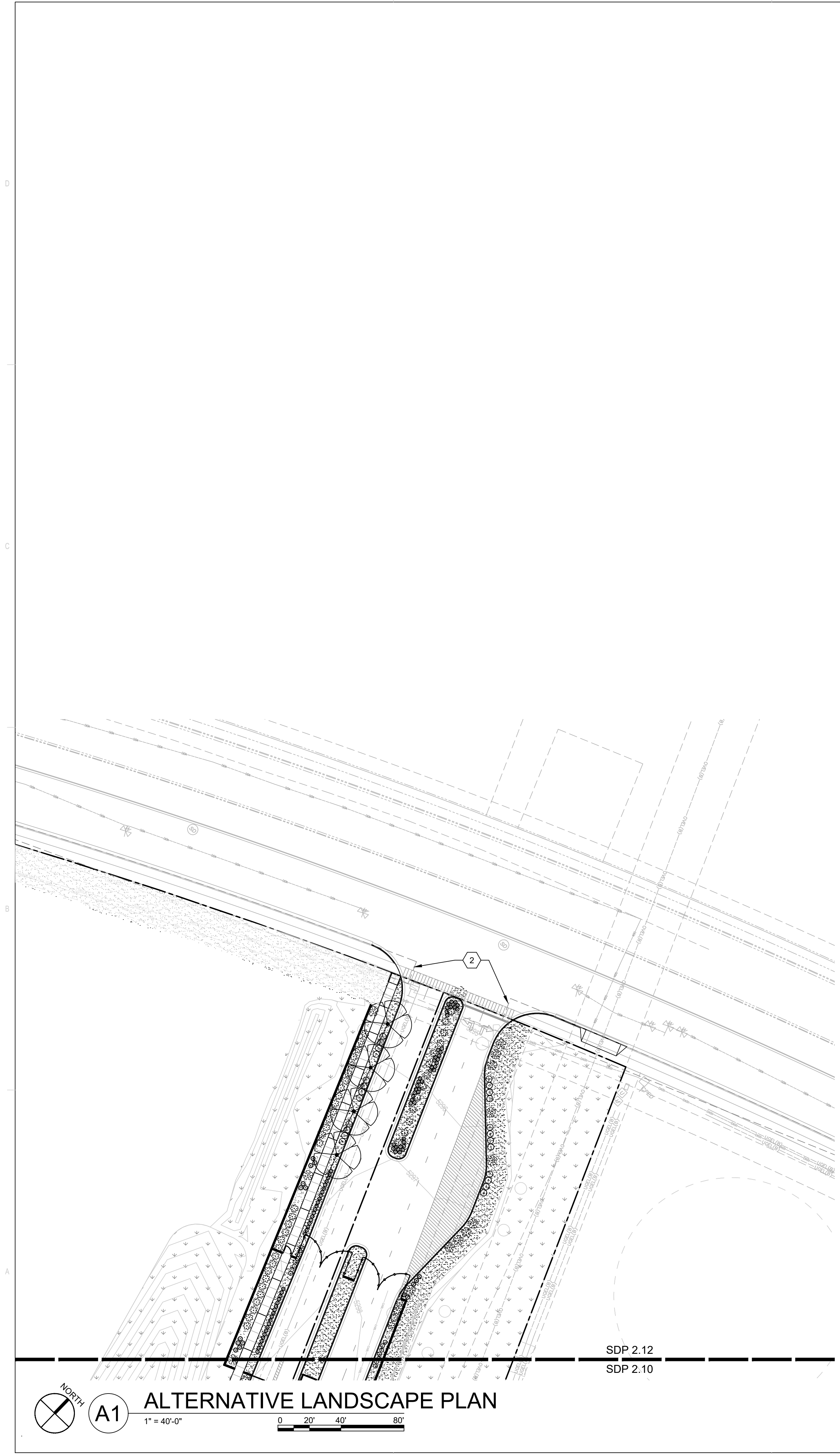
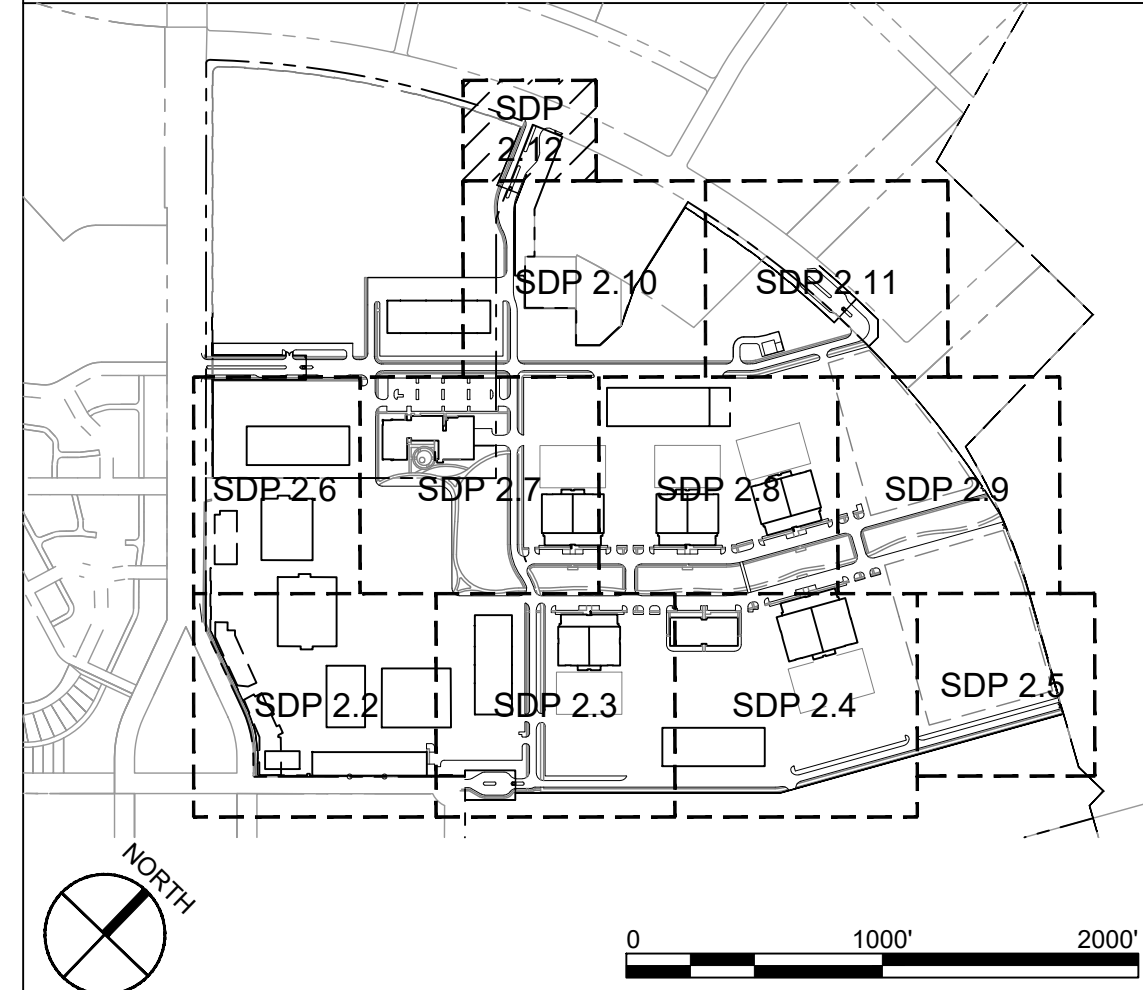

**DEKKER  
PERICH  
SABATINI**

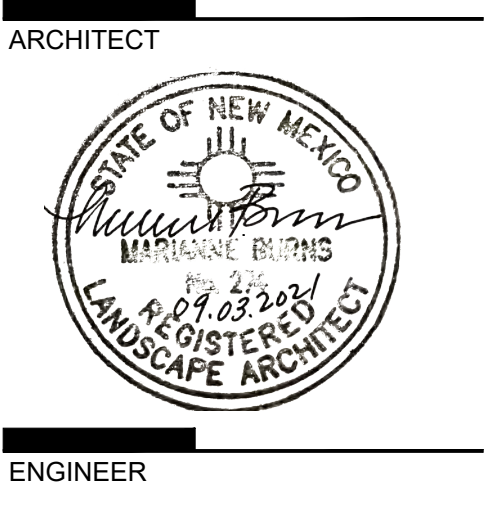

**NOT FOR  
CONSTRUCTION**

PROJECT

**ABQ Studios Expansion  
EAST DEVELOPMENT PACKAGE**  
5650 University Blvd SE  
Albuquerque, NM 87106

REVISIONS

DRAWN BY	DC
REVIEWED BY	MB
DATE	10/29/2021
PROJECT NO.	20-0072.008
DRAWING NAME	

**ALTERNATIVE  
LANDSCAPE PLAN**

SHEET NO.  
**SDP 2.12**