

NOTE:
 -THIS DEVELOPMENT IS A FOOD TRUCK PARKING AREA WITH PUBLIC RESTROOMS
 - WOMEN'S - 3 TOILETS, 1 SINK
 - MEN'S - 1 TOILET, 2 URNIALS AND 1 SINK

 -THE BATHROOM STRUCTURE ON SITE WILL NOT HAVE A FIRE SPRINKLER SYSTEM.

 -THERE WILL BE ONE FIRE HYDRANT TO SUPPORT THE DEVELOPMENT.

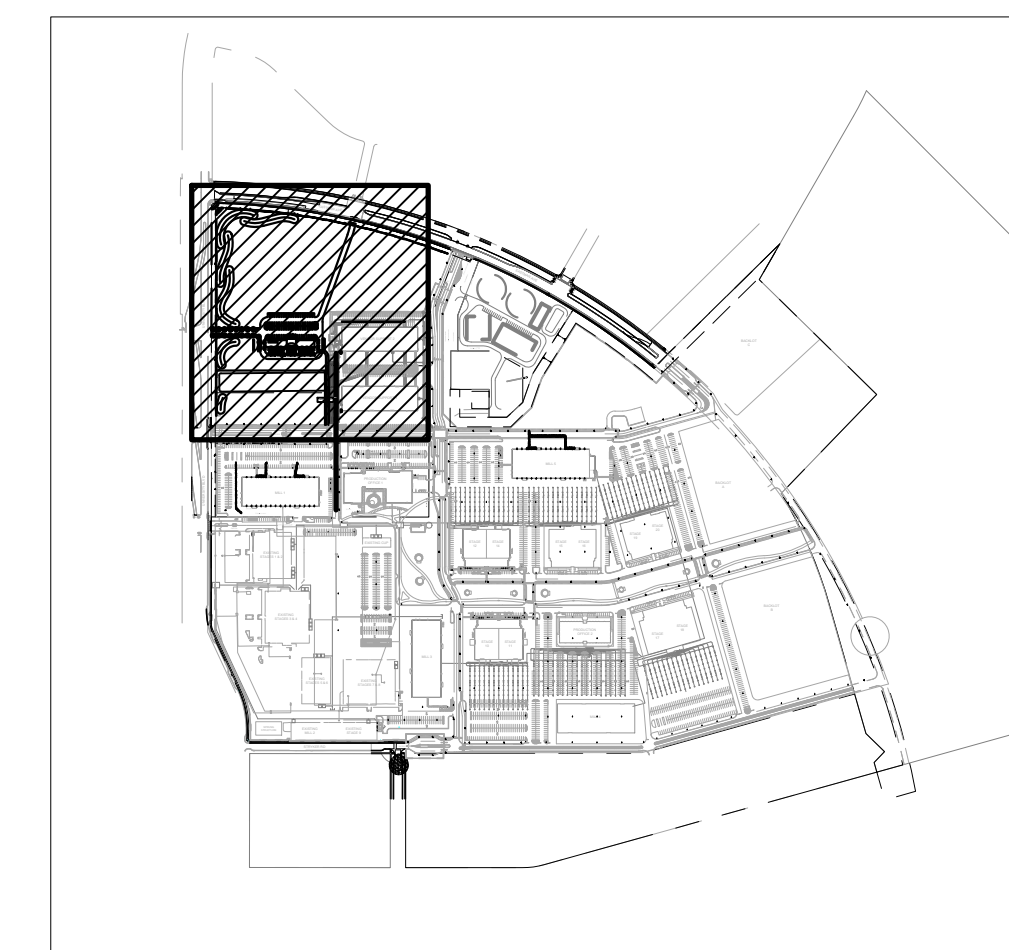

MATCHLINE C206

VENDOR SUPPORT 1

VENDOR SUPPORT 2

Existing sanitary stub
to be used for
NETFLIX - MOON
PROJECT (FOOD
TRUCK FACILITY)

New Fire Hydrant

Existing 6" Fire Line
Extension to serve
new Fire Hydrant
for NETFLIX -
MOON PROJECT
(FOOD TRUCK
FACILITY)

Existing 1" Meter
Box to be used for
NETFLIX - MOON
PROJECT (FOOD
TRUCK FACILITY)

Existing 3/4"
Meter Box TO BE
USED FOR
IRRIGATION OF
LANDSCAPE
AREAS.

Extend service line
to NETFLIX
MOON PROJECT
(FOOD TRUCK
FACILITY)