

# ADMINISTRATIVE AMENDMENT

FILE #: \_\_\_\_\_ PROJECT #: \_\_\_\_\_

---

---

---

---

---

\_\_\_\_\_  
**APPROVED BY**

\_\_\_\_\_  
**DATE**





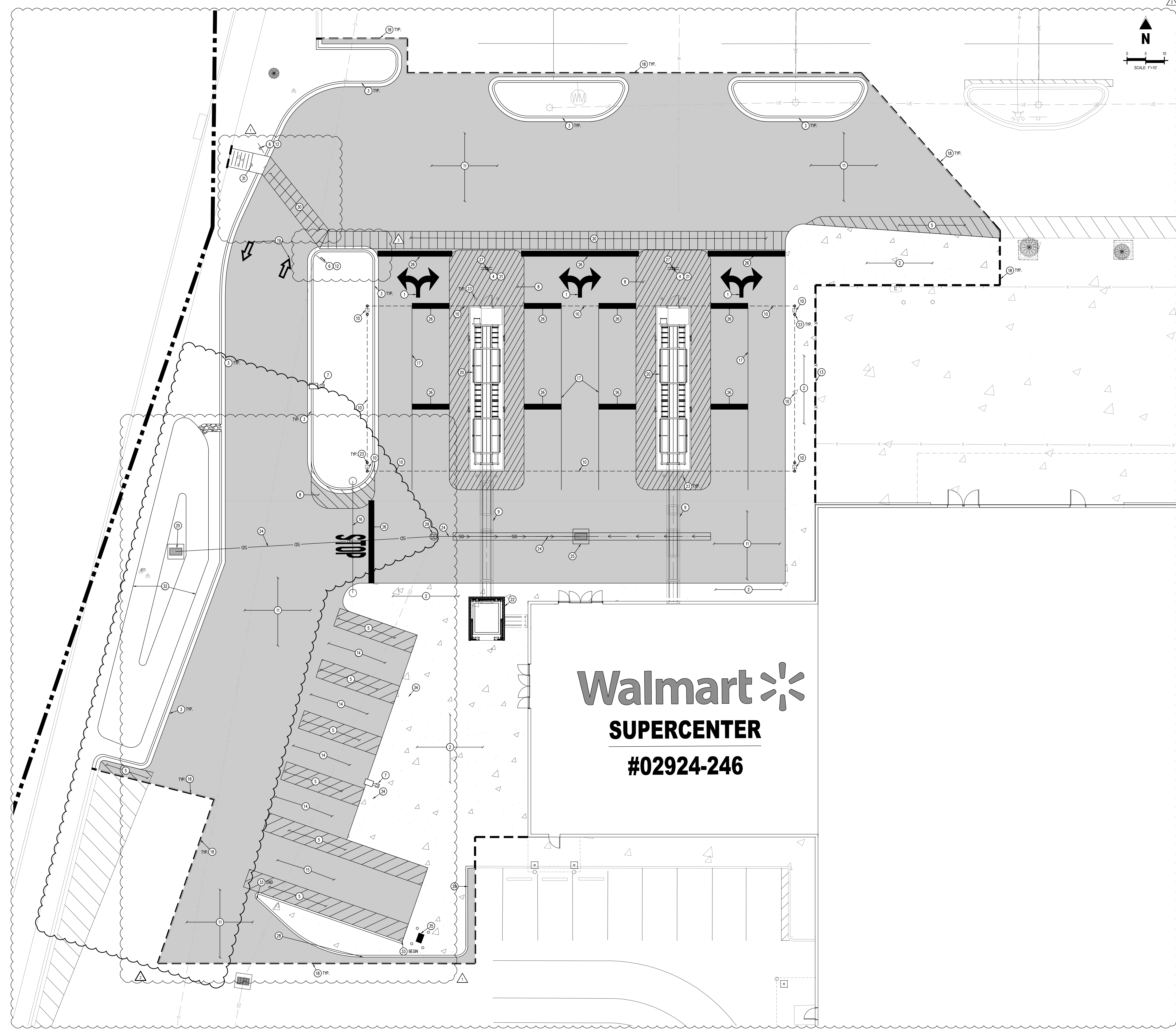

**LEGEND**

---	PROPOSED SAWCUT LINE
---	EXISTING CURB AND GUTTER
---	PROPOSED CURB AND GUTTER
---	EXISTING STORM DRAIN PIPE
---	PROPOSED STORM DRAIN PIPE
---	EXISTING SANITARY SEWER PIPE
---	EXISTING GAS LINE
---	EXISTING WATER LINE
---	EXISTING FENCE TO REMAIN
---	PROPOSED FENCE
---	EXISTING CONCRETE PAVING
---	PROPOSED CONCRETE PAVING
---	PROPOSED ASPHALT PAVING
○	EXISTING LIGHT POST
□	PROPOSED LIGHT POST
○	EXISTING WATER METER
□	PROPOSED INLET
○	EXISTING FIRE HYDRANT
○	EXISTING IRRIGATION VALVE
□	EXISTING IRRIGATION VALVE
□	EXISTING INLET
□	EXISTING ELECTRIC BOX

- SCHEDULE**
- PROPOSED MUTED ARROW PAVEMENT MARKINGS (REF. DETAIL SHEET).
  - PROPOSED SIDEWALK FLUSH WITH ASPHALT PAVING.
  - PROPOSED CURB AND GUTTER (REF. DETAIL SHEET).
  - PROPOSED 30"x30" STOP SIGN (REF. DETAIL SHEET).
  - PROPOSED 4" SOLID YELLOW PAINTED STRIPES AT 45° @ 2'-0" O.C.
  - PROPOSED R1-SB "STOP HERE FOR PEDESTRIANS" SIGNAGE.
  - PROPOSED RELOCATED SITE LIGHT POLE ON NEW LIGHT POLE BASE (REF. DETAIL SHEET FOR BASE DETAIL). CONTRACTOR TO RE-NEW ELECTRICAL IN TO EXISTING.
  - PROPOSED 4" SOLID WHITE PAINTED STRIPES AT 45° @ 2'-0" O.C.
  - PROPOSED MFC OVERHEAD TOWER RAILING (REF. ARCH. PLANS).
  - PROPOSED CANOPY AND COLUMNS (REF. ARCH. PLANS).
  - PROPOSED ASPHALT PAVEMENT (REF. DETAIL SHEET).
  - PROPOSED SIGN MOUNTING WITH BREAKAWAY POST (REF. DETAIL SHEET).
  - PROPOSED FENCE (REF. ARCH. PLANS).
  - PROPOSED VAN PICKUP STALL.
  - PROPOSED BOX TRUCK STALL.
  - PROPOSED HEADACHE BAR (REF. ARCH. PLANS).
  - PROPOSED 4" WHITE PAINTED LANE STRIPING.
  - PROPOSED SAWCUT.
  - PROPOSED THRU OPEN ARROW PAVEMENT MARKINGS.
  - PROPOSED MFC TOWER (REF. ARCH. PLANS).
  - PROPOSED SIGN MOUNTING WITH BOLLARD POST (REF. DETAIL SHEET).
  - PROPOSED MFC TURNING TOWER (REF. ARCH. PLANS).
  - PROPOSED SITE BOLLARD (REF. SITE DETAILS).
  - PROPOSED STORM DRAIN LINE.
  - PROPOSED STORM INLET.
  - PROPOSED STOP BAR PAVEMENT MARKING (REF. SITE DETAILS).
  - PROPOSED "DO NOT ENTER SIGN" (REF. SITE DETAILS).
  - PROPOSED CURB AND GUTTER (TRANSITIONS TO ZERO CURB ALONG THIS DISTANCE).
  - PROPOSED 4" DIAMETER STORM MANHOLE.
  - NEW CROSSWALK MARKINGS - 6" WIDE PAINTED WHITE STRIPING PARALLEL TO DIRECTION OF TRAFFIC AT 2'-0" O.C. AND (1)-8" WHITE STRIPE PERPENDICULAR TO BOTH ENDS UNLESS NOTED OTHERWISE.
  - PROPOSED ADA RAMP (REF. SITE DETAILS).
  - PROPOSED WATER QUALITY RAIN GARDEN (REF. GRADING & DRAINAGE PLAN).
  - 0" TO 6" CURB TRANSITION.
  - PROPOSED DUAL PORT SLOW CHARGER
  - PROPOSED FAST CHARGER

**BASIS OF BEARINGS:**  
 REFERENCE FRAME: NAD1983 (2011) (EPOCH: 2010.0000)  
 ZONE: MODIFIED U.S. STATE PLANE NEW MEXICO CENTRAL  
 VERTICAL DATUM: NAVD83 (COMPUTED USING GEOID 18)  
 GRID TO GROUND SCALE FACTOR 1.003209020  
 GRID TO GROUND SCALE: N= 1495624.99  
 E= 1507456.68  
 (N35° 06'36.01321", W106°41'40.47592")  
 CITY OF ALBUQUERQUE BENCHMARK "SMU-J", 3.1" ALUMINUM CAP, STAMPED "SMU-7, 5202"  
 ELEVATION USED FOR SCALE: 5110.15'  
 CONVERGENCE: -0" 15' 20.52"  
 ALL DISTANCES ARE GROUND DISTANCES  
 UNITS ARE U.S. SURVEY FEET

**CAUTION - NOTICE TO CONTRACTOR**

- ALL UTILITY LOCATIONS SHOWN ARE BASED ON MAPS PROVIDED BY THE APPROPRIATE UTILITY COMPANY AND FIELD SURFACE EVIDENCE AT THE TIME OF SURVEY AND IS TO BE CONSIDERED AN APPROXIMATE LOCATION ONLY. IT IS THE CONTRACTOR'S RESPONSIBILITY TO FIELD VERIFY THE LOCATION OF ALL UTILITIES, PUBLIC OR PRIVATE, WHETHER SHOWN ON THE PLANS OR NOT, PRIOR TO CONSTRUCTION. REPORT ANY DISCREPANCIES TO THE ENGINEER PRIOR TO CONSTRUCTION.
- WHERE A PROPOSED UTILITY CROSSES AN EXISTING UTILITY, IT IS THE CONTRACTOR'S RESPONSIBILITY TO FIELD VERIFY THE HORIZONTAL AND VERTICAL LOCATION OF SUCH EXISTING UTILITY, EITHER THROUGH POT-HOLING OR ALTERNATIVE METHOD. REPORT INFORMATION TO THE ENGINEER PRIOR TO CONSTRUCTION.
- THE CONTRACTOR SHALL VERIFY THE LOCATION OF ALL EXISTING UTILITIES PRIOR TO ANY CONSTRUCTION. AGENCIES INVOLVED SHALL BE NOTIFIED WITHIN A REASONABLE TIME PRIOR TO THE START OF CONSTRUCTION.
- CALL 1-800-424-5555 BEFORE YOU DIG.

**PARKING TABLE**  
 EXISTING BUILDING SF: 224,161 SQ FT  
 PROPOSED BUILDING SF: 217,165 SQ FT  
 PARKING REQUIREMENTS: 4.0/1,000 SF

**PARKING STALL COUNT**  
 \*\*PARKING COUNT BASED ON AERIAL IMAGERY FROM GOOGLE EARTH\*\*

	TYP. PARKING STALLS	ADA STALLS	TOTAL	RATIO
EXISTING CONDITION	1033	26	1059	4.72
PROPOSED CONDITION	1025	26	1051	4.84

**Galloway**  
 1000 B. WILSON BLVD. SUITE 200  
 ALBUQUERQUE, NM 87102  
 505.776.8888  
 www.galloway.com



**Walmart**  
 ALBUQUERQUE, NM  
 2550 COORS BLVD., NW  
 STORE NO: 02924-246  
 JOB NUMBER: SGA02024.20 | PROJECT: MFC ENTRICAMENT  
 2022 MAJOR PROJECT

**ISSUE BLOCK**

PR #	DATE
PR #1	11/19/21
PR #2	02/28/22
PR #3	06/08/22

CHECKED BY: BDA  
 DRAWN BY: DMH  
 PHOTO CYCLE: 06/25/2021  
 DOCUMENT DATE: 09/08/2021

**SITE PLAN**

SHEET: **C1.1**



