

**A PLAT OF
STATE OF NEW MEXICO
GENERAL SERVICES DIVISION RADIO COMMUNICATIONS TRACT**

PRELIMINARY
THIS PRELIMINARY EXHIBIT IS RELEASED FOR
THE PURPOSES OF INTERIM REVIEW ONLY
AND SHALL NOT BE VIEWED OR USED OR
RELIED UPON AS A FINAL SURVEY DOCUMENT.

IN THE ELENA GALLEGOS GRANT,
SECTION 24, TOWNSHIP 11 NORTH, RANGE 3 EAST, N.M.P.M.
AND BEING HEREBY DIVIDED OUT OF THE EXISTING
NEW MEXICO STATE HIGHWAY DEPARTMENT TRACT
AS SHOWN AND DESIGNATED ON THE PLAT RECORDED IN
BOOK C27, FOLIO 158
OF THE RECORDS OF BERNALILLO COUNTY, NEW MEXICO

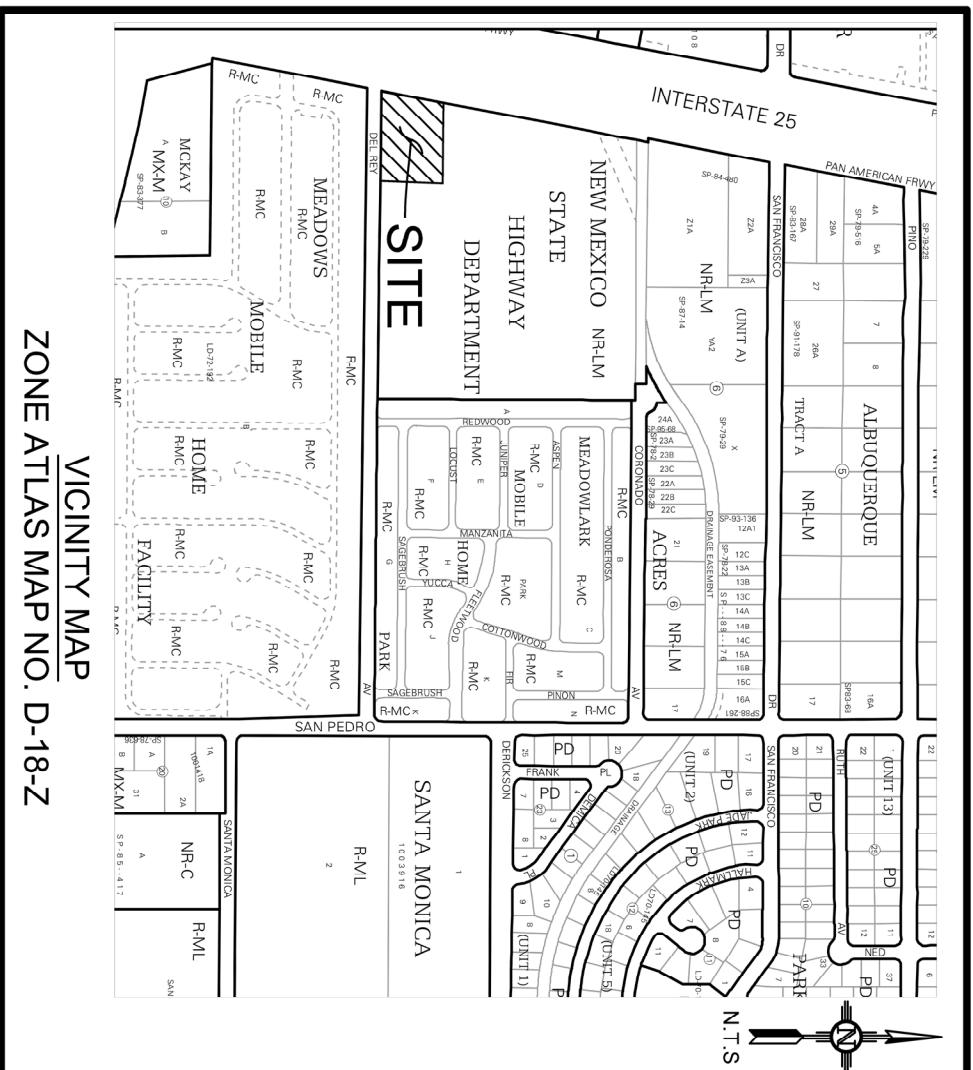

SUBDIVISION DATA:
ZONE ATLAS INDEX NO.: D-18-Z
NO. OF LOTS CREATED: 1
MILES OF FULL-WIDTH STREETS CREATED: 0

NOTES:

1. PLAT SHOWS ALL KNOWN EASEMENTS OF RECORD. THIS PLAT WAS PREPARED WITHOUT THE BENEFIT OF A TITLE REPORT. NOT ALL EASEMENTS OR OTHER TITLE MATTERS MAY BE REFLECTED HEREON.
2. EASEMENT BEARINGS AND DISTANCES SHOWN HEREON ARE PER RECORD AND HAVE BEEN ROTATED TO MATCH BASIS OF BEARINGS AND BOUNDARY UNLESS OTHERWISE INDICATED.
3. BEARINGS SHOWN ARE NEW MEXICO STATE PLANE GRID BEARINGS (CENTRAL ZONE MAD 83) BASED UPON A LINE FROM ACS "125-14" TO ACS "18_D18". SAID BEARING BEING S 87°05'57" E.
4. ALL SHOWN DISTANCES ARE GROUND DISTANCES BASED ON A GRID TO GROUND CONVERSION FACTOR OF 1.000333471.
5. RECORD PLAT BEARINGS AND DISTANCES, WHERE THEY DIFFER FROM THOSE ESTABLISHED BY THIS SURVEY, ARE SHOWN IN PARENTHESES ().
6. THE FOLLOWING DOCUMENT(S) WERE USED IN THE PREPARATION OF THIS PLAT:
 - A) PLAT OF SURVEY, DATED 6/3/85, VOL. C27, FOLIO 158.
 - B) WARRANTY DEED, DATED 3/14/07, BOOK A133, PAGE 9495.
 - C) WARRANTY DEED, DATED 10/15/97, BOOK 97-28, PAGES 7187-7188.
 - D) CONSTRUCTION & OCCUPATION EASEMENT, DATED 12/6/89, BOOK MSC, 158, PAGES 113-115.
 - E) ELECTRIC LINE EASEMENT, DATED 6/15/12, DOC. #2012060342
 - F) EASEMENT, DATED 10/5/67, MSC, BOOK 82, PAGE 347.
 - G) PERMANENT EASEMENT, DATED 8/6/96, BOOK 98-21, PAGES 5542-5545
 - H) PARTIAL RELEASE & TERMINATION OF EASEMENT, DATED 2/18/99, BOOK 99-03, PAGES 1984-1985.
7. NO PROPERTY WITHIN THE AREA OF REQUESTED FINAL ACTION SHALL AT ANY TIME BE SUBJECT TO A DEED RESTRICTION COVENANT OR BINDING AGREEMENT PROHIBITING SOLAR COLLECTORS FROM BEING INSTALLED ON BUILDINGS OR ERECTED ON THE LOTS OR PARCELS WITHIN THE AREA OF PROPOSED PLAT. THE FOREGOING REQUIREMENT SHALL BE A CONDITION TO APPROVAL OF THIS OR SITE DEVELOPMENT PLAT FOR SUBDIVISION.

PURPOSE OF PLAT:

THE PURPOSE OF THIS PLAT IS TO CREATE NEW PARCEL "A-1" TO BE SUBDIVIDED OUT OF THE NEW MEXICO STATE HIGHWAY DEPARTMENT TRACT RECORDED IN VOLUME C27, FOLIO 158 OF THE PLAT RECORDS OF BERNALILLO COUNTY, NEW MEXICO.

THIS IS TO CERTIFY THAT TAXES ARE CURRENT AND PAID ON
UNIFORM PROPERTY CODE #1-018-063-085-145-30301
PROPERTY OWNER OF RECORD: NEW MEXICO STATE HIGHWAY DEPT

BERNALILLO COUNTY TREASURER'S OFFICE _____ DATE _____

INDEXING INFORMATION FOR COUNTY CLERK:
OWNER(S): NEW MEXICO STATE HIGHWAY DEPARTMENT
SECTION 24, TOWNSHIP 11 NORTH, RANGE 3 EAST, N.M.P.M.
SUBDIVISION: NEW MEXICO STATE HIGHWAY DEPT

FREE CONSENT:

THE SUBDIVISION SHOWN HEREON IS PLATTED WITH THE FREE CONSENT AND IN ACCORDANCE WITH THE DESIRES OF THE UNDERSIGNED OWNER(S), EXISTING PUBLIC UTILITY EASEMENTS SHOWN HEREON ARE FOR THE COMMON AND JOINT USE OF GAS, ELECTRICAL POWER AND COMMUNICATION SERVICES FOR BURIED AND/OR OVERHEAD DISTRIBUTION LINES, CONDUIITS, AND PIPES FOR UNDERGROUND UTILITIES WHERE SHOWN OR INDICATED, AND INCLUDING THE RIGHT OF INGRESS AND EGRESS FOR INTERFERING TREES AND SHRUBS. SAID OWNER DOES HEREBY CERTIFY THAT THIS SUBDIVISION IS THEIR FREE ACT AND DEED. SAID OWNERS WARRANT THAT THEY HOLD AMONG THEM COMPLETE AND INDEFEASIBLE TITLE IN FEE SIMPLE TO THE LAND SUBDIVIDED. SAID OWNER DOES HEREBY GRANT ALL EASEMENTS AS SHOWN HEREON WITH LISTED BENEFICIARIES AND STIPULATIONS.

PRINTED NAME: _____ DATE _____
TITLE: _____
ORGANIZATION: _____

ACKNOWLEDGEMENT:

STATE OF NEW MEXICO
COUNTY OF SANTA FE
THIS INSTRUMENT WAS ACKNOWLEDGED BEFORE ME THIS ____ DAY
OF _____, 2021 BY _____

BY _____ NOTARY PUBLIC
MY COMMISSION EXPIRES _____

LEGAL DESCRIPTION:

A PARCEL OF LAND HEREBY DESIGNATED AS "GENERAL SERVICES DIVISION RADIO COMMUNICATIONS TRACT" LYING AND SITUATED IN THE ELENA GALLEGOS GRANT, SECTION 24, TOWNSHIP 11 NORTH, RANGE 3 EAST N.M.P.M., BERNALILLO COUNTY, NEW MEXICO AND BEING HEREBY DIVIDED OUT OF THE REMAINDER OF THE NEW MEXICO STATE HIGHWAY DEPARTMENT TRACT AS SHOWN AND DESIGNATED ON THE PLAT RECORDED IN BOOK C27, FOLIO 158 OF THE RECORDS OF BERNALILLO COUNTY, NEW MEXICO.

SAID "GENERAL SERVICES DIVISION RADIO COMMUNICATIONS TRACT" BEING MORE PARTICULARLY DESCRIBED BY NEW MEXICO STATE PLANE COORDINATE SYSTEM GRID BEARINGS (MAD 83, CENTRAL ZONE) AND GROUND DISTANCES (U.S. SURVEY FEET) AS FOLLOWS:

BEGINNING AT AN EXISTING BRASS DISK IN CONCRETE STAMPED STATE OF NEW MEXICO HIGHWAY COMMISSION S.W. CORNER L.S. 8911', SAID BRASS DISK MARKING THE SOUTHWEST CORNER OF THE REMAINDER OF SAID NEW MEXICO STATE HIGHWAY DEPARTMENT TRACT AS SHOWN IN PLAT BOOK C27, FOLIO 158:

THENCE NORTH 10°44'10" EAST A DISTANCE OF 152.37 FEET WITH THE WEST LINE OF SAID REMAINDER OF NEW MEXICO STATE HIGHWAY DEPARTMENT TRACT, SAME BEING THE EAST RIGHT-OF-WAY LINE OF INTERSTATE HIGHWAY 25, TO A MONUMENT SET WHENCE A BRASS DISK IN CONCRETE STAMPED STATE OF NEW MEXICO HIGHWAY COMMISSION 1:25-14 BEARS NORTH 09°47'44" EAST A DISTANCE OF 45.93 FEET AND AN ALUMINUM DISK ON AN IRON ROD STAMPED "N.M. STATE HIGHWAY DEPT., PS 11255" MARKING THE PRESENT NORTHWEST CORNER OF THE REMAINDER OF SAID NEW MEXICO STATE HIGHWAY DEPARTMENT TRACT BEARS NORTH 10°44'10" EAST A DISTANCE OF 779.97 FEET.

THENCE SOUTH 79°25'44" EAST A DISTANCE OF 204.97 FEET TURNING ACROSS SAID REMAINDER OF NEW MEXICO STATE HIGHWAY DEPARTMENT TRACT TO A MONUMENT SET:

THENCE SOUTH 33°53'22" EAST A DISTANCE OF 17.83 FEET TO A MONUMENT SET:

THENCE SOUTH 40°53'57" WEST A DISTANCE OF 98.96 FEET TO A MONUMENT SET IN THE SOUTH LINE OF SAID REMAINDER OF NEW MEXICO STATE HIGHWAY DEPARTMENT TRACT, SAME BEING THE NORTH RIGHT-OF-WAY LINE OF DEL REY AVENUE WHENCE A BRASS DISK IN CONCRETE STAMPED STATE OF NEW MEXICO HIGHWAY DEPT., MARKING THE SOUTHEAST CORNER OF THE REMAINDER OF SAID NEW MEXICO STATE HIGHWAY DEPARTMENT TRACT BEARS SOUTH 89°36'46" EAST A DISTANCE OF 948.03 FEET:

THENCE NORTH 00°59'38" EAST A DISTANCE OF 238.31 FEET WITH THE COMMON SOUTH LINE OF SAID REMAINDER OF NEW MEXICO STATE HIGHWAY DEPARTMENT TRACT AND NORTH RIGHT-OF-WAY LINE OF DEL REY AVENUE TO THE POINT OF BEGINNING AND CONTAINING 0.679 ACRES.

SURVEYOR'S CERTIFICATE:

I, BILLY W. BARR JR., NEW MEXICO PROFESSIONAL SURVEYOR NO. 25114, HEREBY CERTIFY THAT THIS SUBDIVISION SURVEY PLAT WAS PREPARED FROM AN ACTUAL GROUND SURVEY PERFORMED BY ME OR UNDER MY SUPERVISION, THAT I AM RESPONSIBLE FOR THIS SURVEY, THAT THIS SURVEY IS TRUE AND CORRECT TO THE BEST OF MY KNOWLEDGE AND BELIEF, AND THAT THIS SUBDIVISION SURVEY PLAT AND THE FIELD SURVEY UPON WHICH IT IS BASED MEET THE MINIMUM STANDARDS FOR SURVEYING IN NEW MEXICO.

BILLY W. BARR JR.,
NEW MEXICO DEPARTMENT OF TRANSPORTATION
ADDRESS: 1120 CERRILLOS ROAD, SANTA FE, NM 87505
PHONE: 505-795-1401

PROJECT NUMBER: _____
APPLICATION NUMBER: _____

PLAT APPROVAL
UTILITY APPROVALS:

PNM ELECTRIC SERVICES _____ DATE _____
NEW MEXICO GAS COMPANY _____ DATE _____

CENTURY LINK _____ DATE _____
COMCAST _____ DATE _____

CITY APPROVALS:
CITY SURVEYOR _____ DATE _____

REAL PROPERTY DIVISION (CONDITIONAL) _____ DATE _____
ENVIRONMENTAL HEALTH DEPARTMENT (CONDITIONAL) _____ DATE _____

TRAFFIC ENGINEERING, TRANSPORTATION DIVISION _____ DATE _____
ABCWUA _____ DATE _____

PARKS AND RECREATION DEPARTMENT _____ DATE _____
AMAFCA _____ DATE _____

CITY ENGINEER/HYDROLOGY _____ DATE _____
CODE ENFORCEMENT _____ DATE _____

DRB CHAIRPERSON, PLANNING DEPARTMENT _____ DATE _____



NEW MEXICO DEPARTMENT OF TRANSPORTATION
1120 CERRILLOS ROAD
SANTA FE, NM 87505
PH #(505) 827-5100