

Panda Express Building
 BULK OF STRUCTURE IS 10% OF AREA WITHIN VIEW FRAME
 BULK OF STRUCTURE <50% OF AREA WITHIN VIEW FRAME PER IDO 3-6(D)(5)(c) BUILDING AND STRUCTURE BULK
View Frame Area: 11,007
Panda Express Blocked Area: 937 (8.51%)

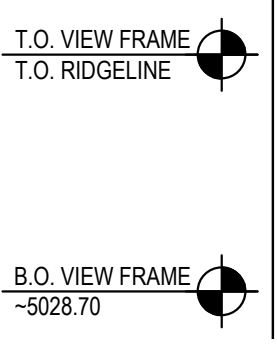

- DEMOLITION NOTE:**
 G.C. TO REMOVE ALL EXISTING ABOVE/GROUND STRUCTURAL WALLS, FOUNDATION, ASPHALT, CONC. CURBS AND DEBRIS PRIOR TO NEW CONSTRUCTION.
- GENERAL NOTE:**
- G.C. TO VERIFY AND PROVIDE ALL UNDERGROUND WIRING AND CONDUIT (INSTALLED BY LOCAL UTILITY COMPANY) FROM TRANSFORMER TO ELECTRICAL MAIN SWITCHGEAR, DRIVE THRU MENU BOARD, BY G.C. VERIFY WITH PANDA PM.
 - WATER METER FOR IRRIGATION SHALL BE A SEPARATE METER THAN MAIN WATER METER. G.C. TO REFERENCE CIVIL UTILITY PLAN FOR SIZE AND LOCATION.
 - PROVIDE & INSTALL CAGE AND COVER FOR THE BACK-FLOW PREVENTER AT 4" CONCRETE CURB IN LANDSCAPE AREA, GORILLA CAGE, MANUFACTURED BY HOUSTON IRRIGATION SERVICES SPRING, TEXAS (281-705-9701). PROVIDE INSULATED COVER, AQUA SHIELD MODEL # BFP1-S FOR COLDER REGIONS OF US. COORDINATE WITH PANDA PM. REFER TO DETAIL 11/A-407
 - FOR HORIZONTAL CONTROL PLAN REFER TO CIVIL DRAWINGS

SCALE: 1"=30'-0" SECTION 13

ESTIMATE VIEW FRAME 3

PANDA EXPRESS - SITE INFORMATION
 SITE AREA: 54,333 SF / 1.247 AC
 BUILDING AREA: 2,540 SF

PARKING CALCULATION:
 PER IDO TABLE 5-5-1
 REQUIRED: 8 SPACES PER 1000 GROSS SQ.FT
 2.5 x 8 = 20 SPACES REQUIRED

PROVIDED:
 46 REGULAR
 + 2 ACCESSIBLE
 = 48 PARKS PROVIDED

MOTORCYCLE PROVIDED: 2 STALLS

LEGEND
 - - - - - PROPERTY LINE
 - - - - - BUILDING SETBACK
 - - - - - SIGHT LINES
 - - - - - VIEW FRAME

- | | | |
|---|--|----------|
| 1 BUILDING SETBACKS | 19 ROOF DRAIN AND OVERFLOW DRAIN FROM ROOF TO EXIT TO DAYLIGHT THRU FACE OF WALL. COLD CLIMATES WILL REQUIRE CONNECTION TO STORM SEWER. ARCHITECT TO VERIFY WITH LOCAL JURISDICTION. | 15 A-107 |
| 2 PROPERTY LINE | 20 STEEL PIPE BOLLARD - BOLLARDS TO BE PAINTED SAFETY YELLOW PRIOR TO APPLICATION OF LOBE SLEEVE. | 18 A-407 |
| 3 NEW SITE LIGHT POLE | 21 UNDERGROUND GREASE INTERCEPTOR - SEE PLUMBING/CIVIL DRAWINGS | |
| 4 NEW SWITCHGEAR | 22 CONC. DRIVEWAY | |
| 5 PAVING - SEE CIVIL PLAN | 23 EDGE OF SIDEWALK AT PLANTER | |
| 6 IRRIGATED LANDSCAPING, REFER TO LANDSCAPE DRAWINGS | 24 CONCRETE CURB AT LANDSCAPE AREA. | |
| 7 HEAVY DUTY CONCRETE APRON FOR DUMPSTER ENCLOSURE. REFERENCE CIVIL DRAWINGS FOR SPECIFICATIONS | 25 EXPANSION JOINT @ 20'-0" O.C. MAX. | |
| 8 TRASH ENCLOSURE, CONFIRM BIN SIZE WITH LOCAL WASTE MANAGEMENT COMPANY. | 26 TOOLED JOINTS @ 5'-0"X5'-0" O.C. EXPANSION JOINT @ 20'-0" O.C. | |
| 9 GC TO COORDINATE LOCATION OF THE FREESTANDING SIGN WITH SIGN CO. THE SQUARE FOOTAGE OF SIGN IS 45 SQFT | 27 ACCESSIBLE RAMP | |
| 10 DRIVE THRU LANE SENSOR LOOP. INSTALL POSITION SO LOOP IS CENTERED ON ACTIVE PANEL OF DRIVE THROUGH WINDOW. SEE DETAIL. | 28 EXISTING TRANSFORMER PAD. REFER TO CIVIL AND ELECTRICAL DRAWINGS. | |
| 11 DRIVE THROUGH MENU BOARD-INSTALLED BY SIGN COMPANY. VERIFY WITH PANDA PM (SEE GENERAL NOTE ABOVE) | 29 ORDER CONFIRMATION BOARD | |
| 12 DIRECTIONAL ARROW | 30 RUBBER WHEEL STOP, REF. CIVIL DRAWINGS | |
| 13 ACCESSIBLE PATH OF TRAVEL | 31 MOTORCYCLE PARKING | |
| 14 ACCESSIBLE PARKING POLE SIGN | 32 BIKE RACK - REFER TO CIVIL DWG'S MANUF: DUMOR, INC MODEL NUMBER: 125-30 SERIES | |
| 15 INTERNATIONAL ACCESSIBILITY SYMBOL @ PARKING SPACE | 33 CLEARANCE BAR/BASE INSTALLED BY SIGN VENDOR. | |
| 16 ACCESSIBLE PARKING SPACE AND LOADING ZONE PAINT LOADING ZONE W/ 4" WIDE STRIPES @ 3'-0" O.C. | 34 GC TO REPAIR EXISTING WOOD FENCE. | |
| 17 PAINT 4" WIDE SOLID PARKING STRIPING W/ TWO (2) COATS HIGHWAY WHITE PAINT | 35 PAINT "DO NOT ENTER" SIGNAGE | |
| 18 DESIGNATED HANDICAP PARKING SPACE | 35 *LANDSCAPING, FENCING AND SIGNING WILL NOT INTERFERE WITH CLEAR SIGHT REQUIREMENTS. SIGNS, WALLS, TREES AND SHRUBBERY BETWEEN 3 AND 8 FEET TALL (AS MEASURED FROM THE GUTTER PAN) WILL NOT BE ACCEPTABLE IN THE CLEAR SIGHT TRIANGLE. | |

KEY NOTES A
 Scale= NTS A-100

PROJECT NUMBER: PR-2022-006547
Application Number: SI-2022-00216

This plan is consistent with the specific Site Development Plan approved by the Development Review Board Application (DRB), dated _____ and the Findings and Conditions in the Official Notification of Decision are satisfied.
DRB SITE DEVELOPMENT PLAN APPROVAL:

Traffic Engineering, Transportation Division	Date
ABCWUA	Date
Parks and Recreation Department	Date
City Engineer/Hydrology	Date
Code Enforcement	Date
* Environmental Health Department (conditional)	Date
Solid Waste Management	Date
DRB Chairperson, Planning Department	Date

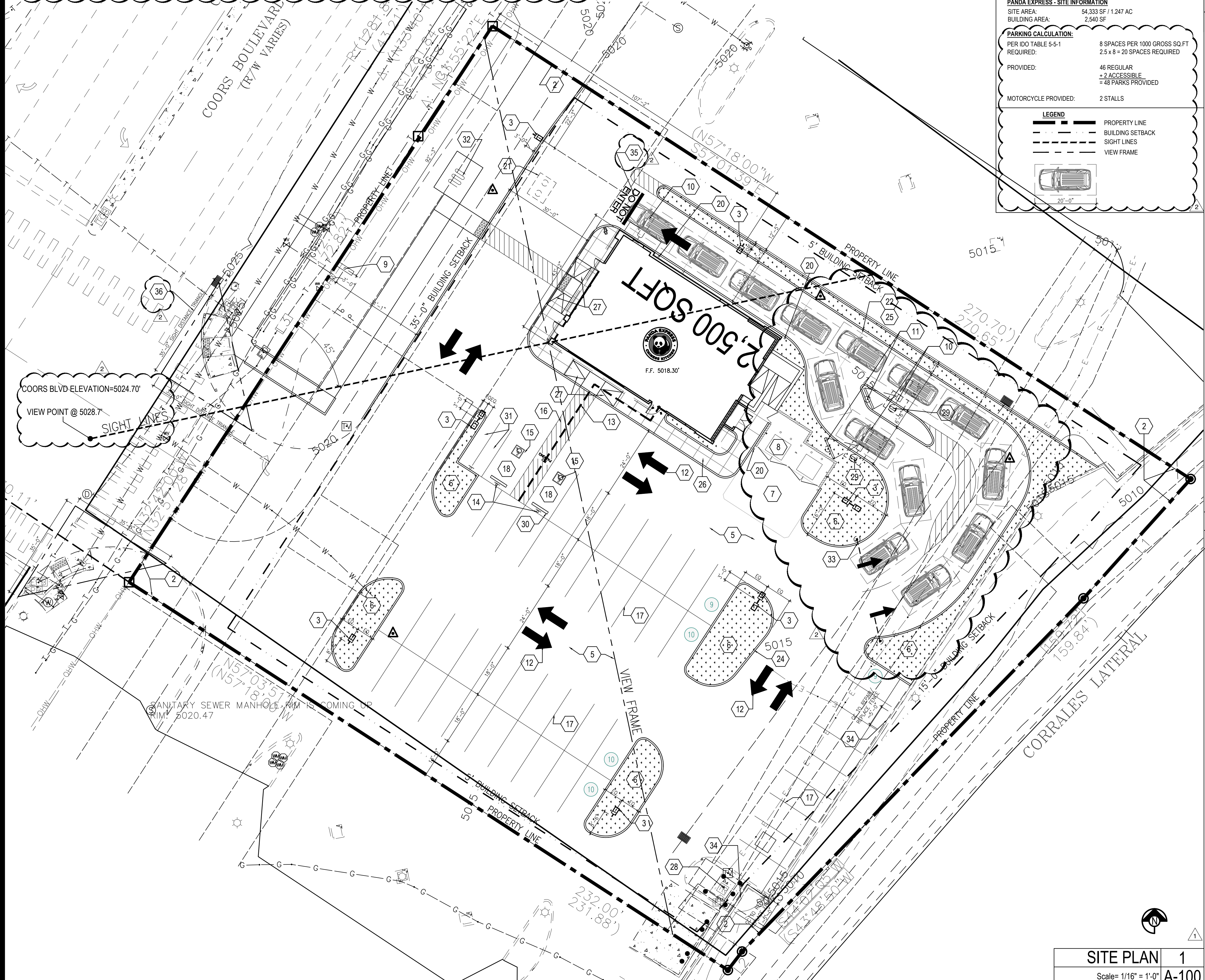

SITE PLAN 1
 Scale= 1/16" = 1'-0" A-100



PANDA EXPRESS, INC.
 1683 Walnut Grove Ave.
 Rosemead, California 91770
 Telephone: 626.799.9898
 Facsimile: 626.372.8288

All ideas, designs, arrangement and plans included or represented by this drawing are the property of Panda Express Inc. and were created for use on this specific project. None of these ideas, designs, arrangements or plans may be used by or disclosed to any person, firm, or corporation without the written permission of Panda Express Inc.

REVISIONS:

DRB RESUBMITTAL	04-06-22
DRB 2nd RESUBMITTAL	05-04-22

ISSUE DATE:

DRB SUBMITTAL	12-28-21
---------------	----------

DRAWN BY: RMKS

PANDA PROJECT #: S8-22-D8582
 PANDA STORE #: D8582
 ARCH PROJECT #: 21084



Heights Venture
 ARCHITECTURE + DESIGN

HOUSTON 1111 North Loop West, Suite 800 77008
 DALLAS 5741 Legacy Drive, Suite 320 Plano, Texas 75024
 713.869.1103 V 972.490.7292 V

PANDA EXPRESS
 TRUE WARM & WELCOME
 10126 COORS BLVD. NW
 ALBUQUERQUE, NM 87114

A-100
 SITE PLAN
 ARCHITECTURAL

DRB - PR-2022-006547 SI-2022-00216