



Mitchell C. Smith, Architect  
© MG2, Inc. All rights reserved. No part of this document may be reproduced in any form or by any means without permission in writing from MG2, Inc.



**LINE TYPE LEGEND**

- PROPERTY LINE
- ADA POINT OF TRAVEL

**PARKING SPACE CALCULATIONS**

PARKING SPACES	REQUIRED	CHUZE FITNESS PROPOSED PARKING	
		ALBERSONS APPROVED PARKING	CHUZE FITNESS PROPOSED PARKING
		N/A	128 2.5 SPACES PER 1000 SQ FT FLOOR AREA PER GFA IDO SECTION 5-5 (C)(2)
	PROVIDED	158	149
ADA PARKING SPACES	REQUIRED	8	8 3.3 SPACES PER 1000 SQ FT FLOOR AREA
	PROVIDED	11	8
BICYCLE PARKING SPACES	REQUIRED	N/A	12 10% OF REQUIRED OFF-STREET PARKING SPACES: 128 x 10% = 12.8 PER IDO TABLE 5-5.5: MINIMUM BICYCLE PARKING REQUIREMENTS
	PROVIDED	N/A	12
MOTORCYCLE PARKING SPACES	REQUIRED	N/A	4 PER IDO TABLE 5-5.4: MINIMUM MOTORCYCLE PARKING REQUIREMENTS
	PROVIDED	N/A	6
PERCENTAGE IN PARKING CHANGE		[(149-158)/158] x 100 = 6.96% INCREASE	

**KEYNOTES**

1. PROVIDE NEW ACCESSIBLE CURB RAMP: 1:12 SLOPE MAX.
  2. GRIND DOWN ASPHALT AS REQUIRED TO REMOVE ABRUPT EDGES OVER 1/4".
  3. PROVIDE NEW ACCESSIBLE CURB RAMP: 1:12 SLOPE MAX. & INSTALL NEW TRUNCATED DOME. SEE DETAILS 6 & 9A002A.
  4. EXISTING ACCESSIBLE PATH OF TRAVEL TO REMAIN.
  5. EXISTING FLASH CURB CONDITION.
  6. NEW ACCESSIBLE PATH OF TRAVEL ROUTE.
  7. PROVIDE ALL NEW 4" STRIPING IN FEDERAL BLUE AT ACCESSIBLE PATH OF TRAVEL.
  8. PROPERTY LINE
  9. REMOVE ALL EXISTING ACCESSIBLE PARKING SIGNAGE AND REPLACE WITH NEW CODE COMPLIANT SIGNAGE. RESTRIPE EXISTING PARKING WITH NEW ACCESSIBLE PATH OF TRAVEL.
  10. PARKING LOT TO BE SLURRY COATED AND RE-PAINTED BY LANDLORD.
  11. G.C. TO PROVIDE SIGNAGE AT ACCESSIBLE ROUTE PER DETAIL 7A002A.
  12. G.C. TO CONFIRM THE EXISTING SIGNAGE AT SITE ENTRANCE IN IN COMPLIANCE PER CODE AS NOTED ON DETAIL 8A002A.
  13. PROPOSED NEW TRASH ENCLOSURE.
  14. EXISTING ACCESSIBLE CURB RAMP: INSTALL NEW TRUNCATED DOME, DETECTABLE WARNING. SEE DETAILS 6, 9, 11 & 12A002A.
  15. EXISTING CITY TRANSIT BUS STOP.
  16. EXISTING ACCESSIBLE CURB RAMP WITH TRUNCATED DOME, DETECTABLE WARNING.
  17. REMOVE EXISTING ADA PARKING SYMBOLS, ACCESSIBLE PATH STRIPING AND SIGNAGE.
  18. 4" NEW MOTORCYCLE SPACES PER IDO SECTION 5-5(3), TABLE 5-5.4. MOTORCYCLE SPACES SHALL BE DESIGNATED BY ITS OWN CONSPICUOUSLY POSTED UPRIGHT SIGN PER THE IDO.
  19. LOCATION OF NEW BIKE RACK. SEE DETAIL 13A002A.
  20. EXISTING LOCATION OF TREES ON SITE.
  21. EXISTING CART CORRAL TO BE REMOVED COMPLETE. PATCH ASPHALT AS REQUIRED.
  22. EXISTING LANDSCAPE ISLANDS TO REMAIN.
- NOTE:
1. LANDSCAPING AND SIGNAGE WILL NOT INTERFERE WITH CLEAR SIGHT REQUIREMENTS. THEREFORE, SIGNS, WALLS, TREES AND SHUBBERY BETWEEN 3 AND 8 FEET TALL (AS MEASURED FROM THE GUTTER PAN) WILL NOT BE ACCEPTABLE IN CLEAR SIGHT TRIANGLE.
  2. ALL BROKEN OR CRACKED SIDEWALK MUST BE REPLACED WITH SIDEWALK AND CURB & GUTTER. SEE CITY STANDARD DRAWINGS, 2415C.
  3. ALL BROKEN OR CRACKED SIDEWALK MUST BE REPLACED WITH NEW SIDEWALK, CURB AND GUTTER.
  4. THE SLOPE FOR ALL CURB RAMP LANDING AREAS SHOULD BE 2% MAX. SLOPE IN ALL DIRECTIONS.



**1 SITE PLAN**  
SCALE: 1" = 40'-0"

**2 ENLARGED TRASH ENCLOSURE TURNING RADIUS**  
SCALE: 1" = 20'-0"

COORS & CENTRAL - CHUZE ALBUQUERQUE

6600 CENTRAL AVE, SW  
ALBUQUERQUE, NM 87121

#	Date	Issue/Description
1	3/11/2022	PLAN CH RE SUBMITTAL
5	05/04/2022	PLAN CH RE SUBMITTAL
7	06/06/2022	PLAN CH RE SUBMITTAL
8	06/10/2022	PLANNING COMMENTS
	12/17/21	25% SUBMITTAL
	01/05/22	75% SUBMITTAL
	01/14/22	PERMIT SET
	01/31/22	100% SUBMITTAL
	03/11/22	PERMIT SET

Project No: 21603901A  
Drawn By: MG2  
Checked By: MG2

SITE PLAN

**A001**



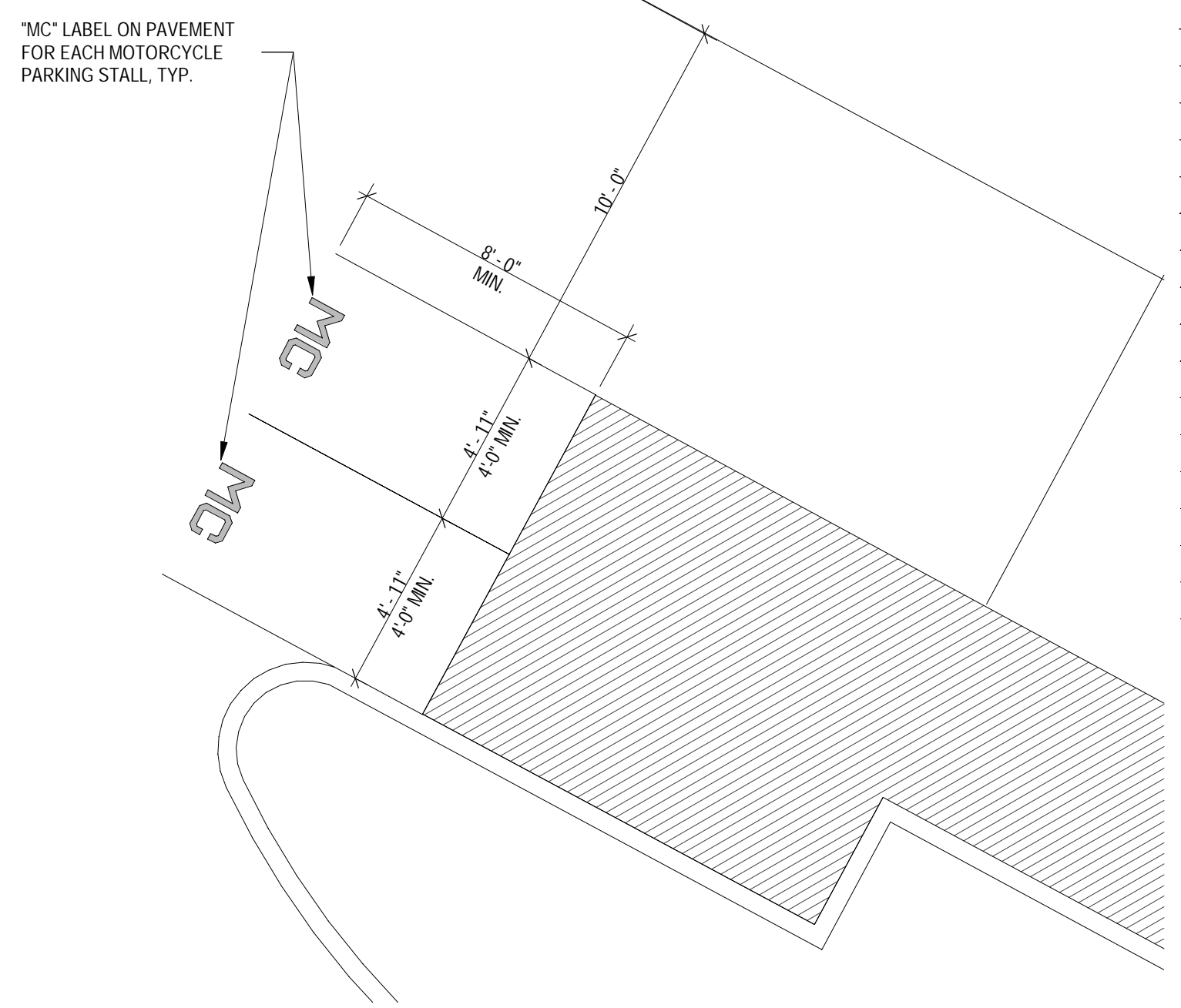

15 ENLARGED MOTORCYCLE PARKING SPACE  
SCALE: 1/4" = 1'-0"

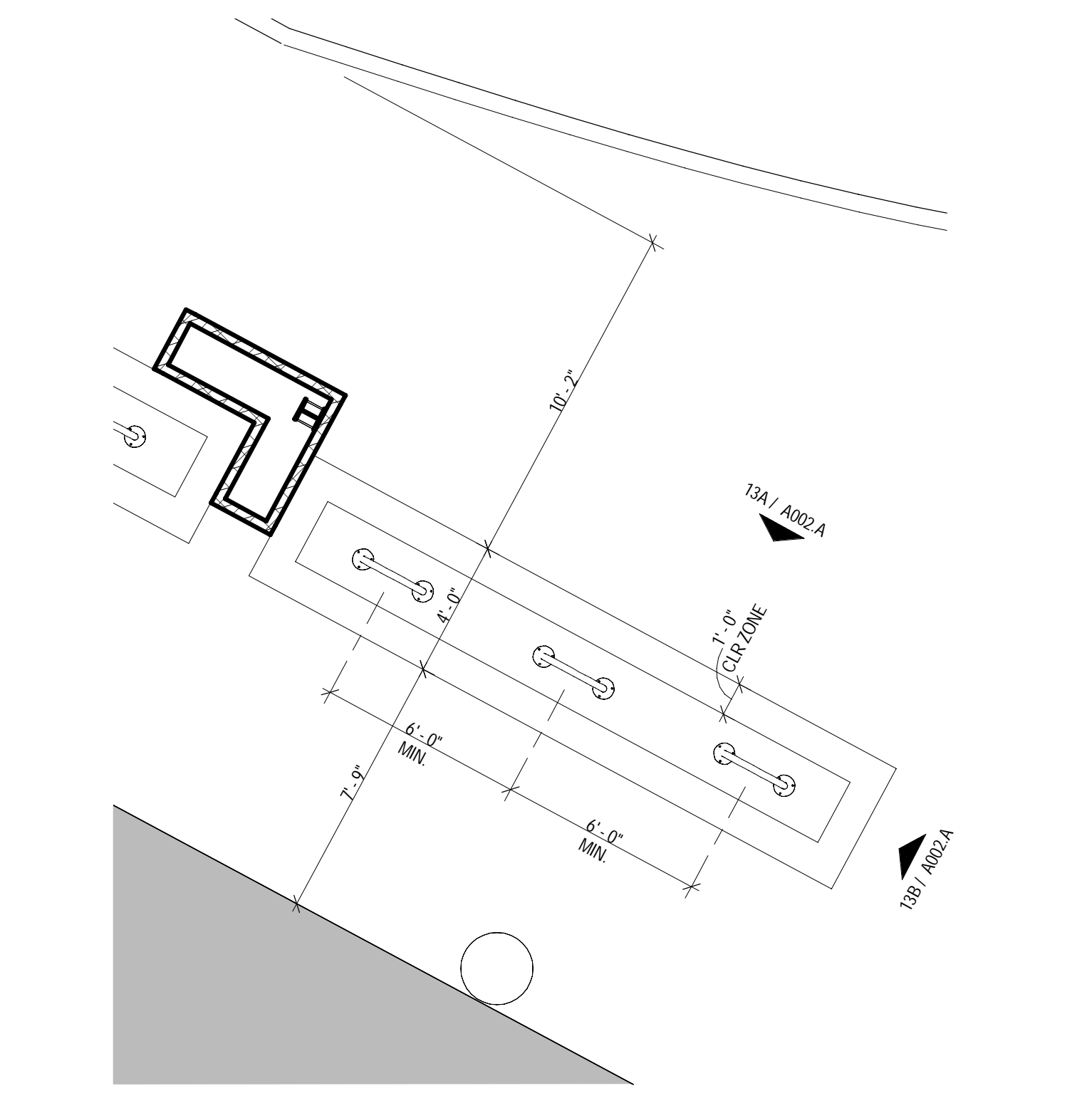

14 ENLARGED BIKE FLOOR PLAN  
SCALE: 1/4" = 1'-0"

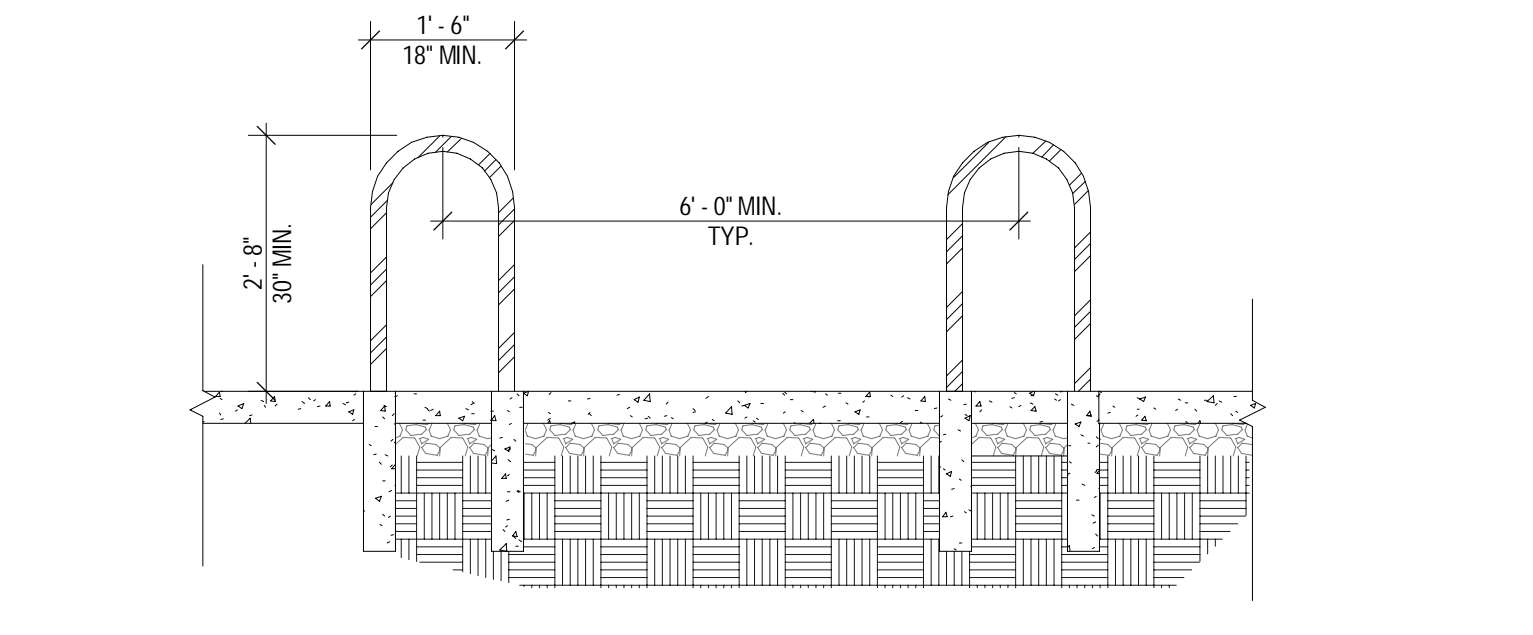

13 BIKE RACK  
SCALE: 1/2" = 1'-0"

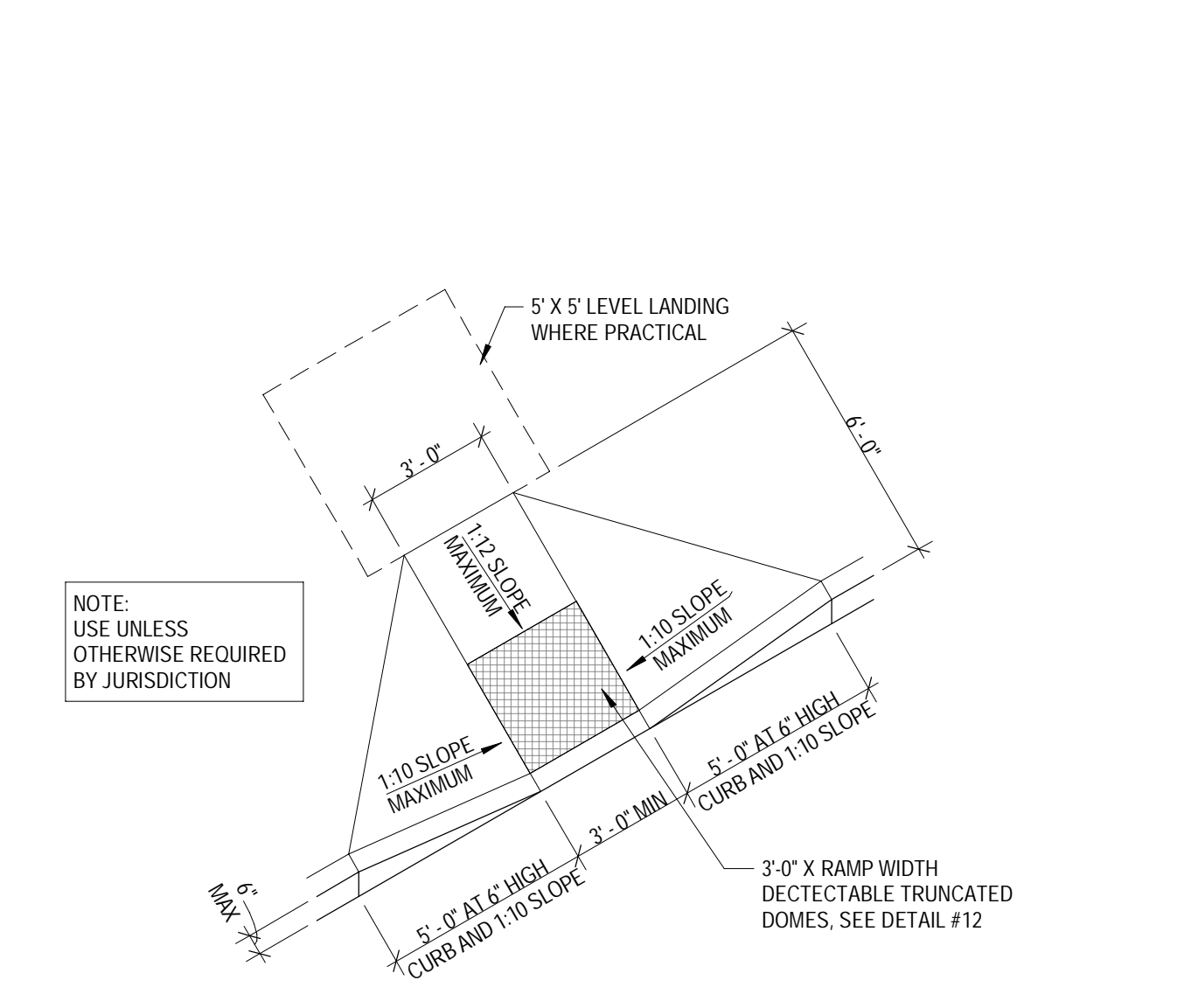

11 CURB RAMP  
SCALE: 1/4" = 1'-0"

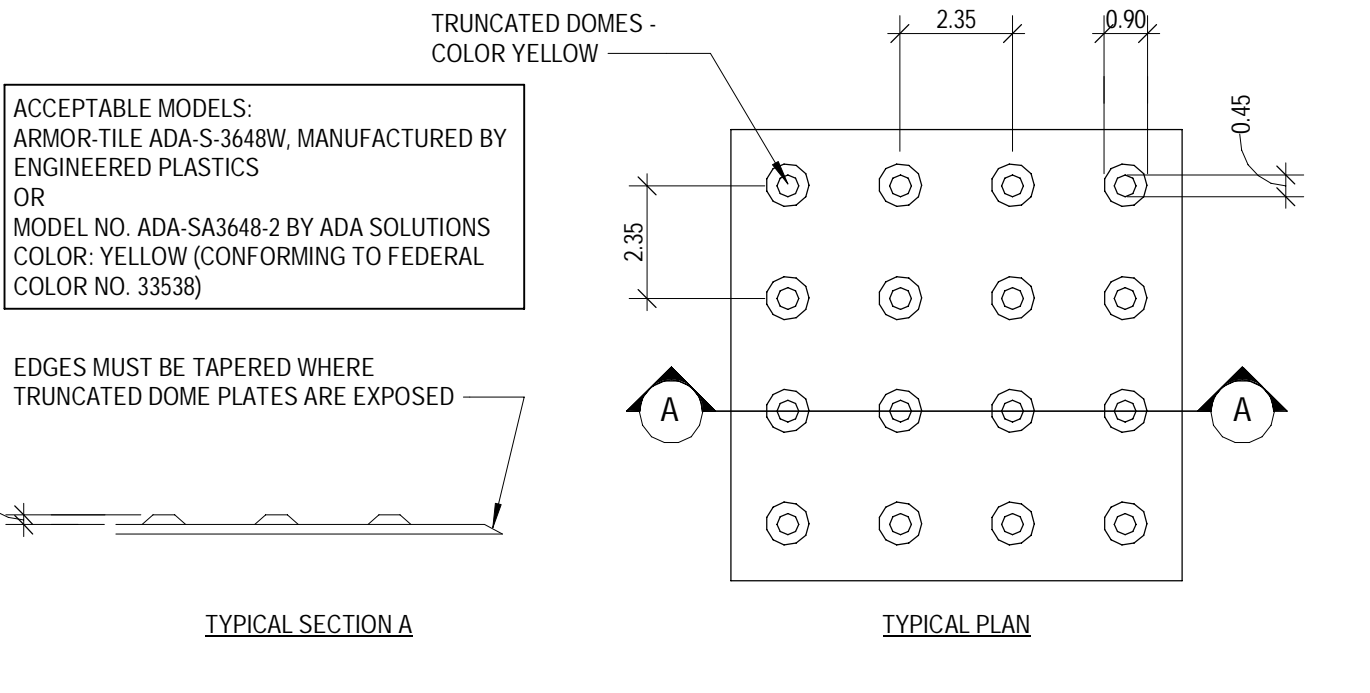

12 TRUNCATED DOMES  
SCALE: 3/8" = 1'-0"

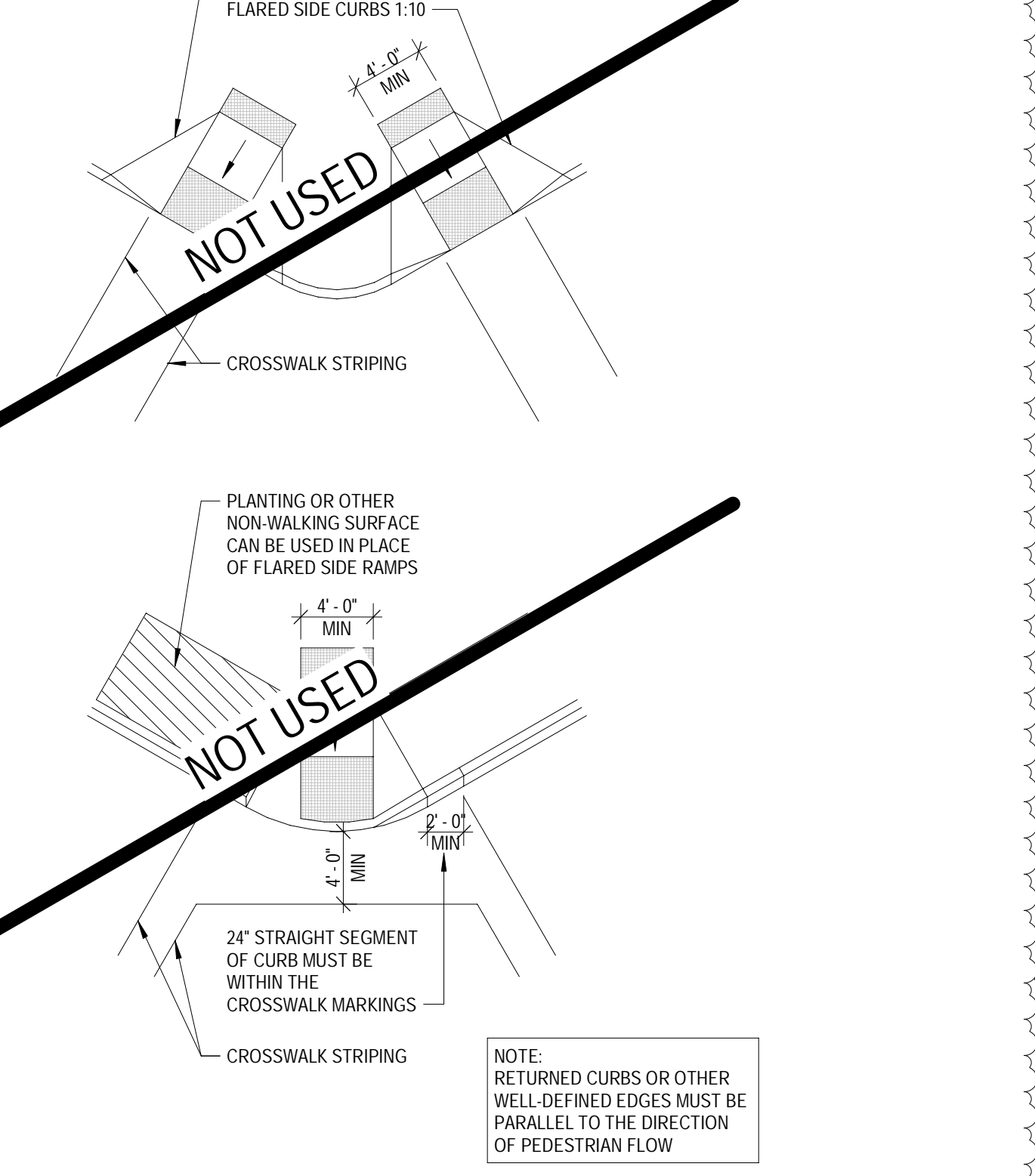

9 DIRECTIONAL CURB RAMP  
SCALE: 1/2" = 1'-0"

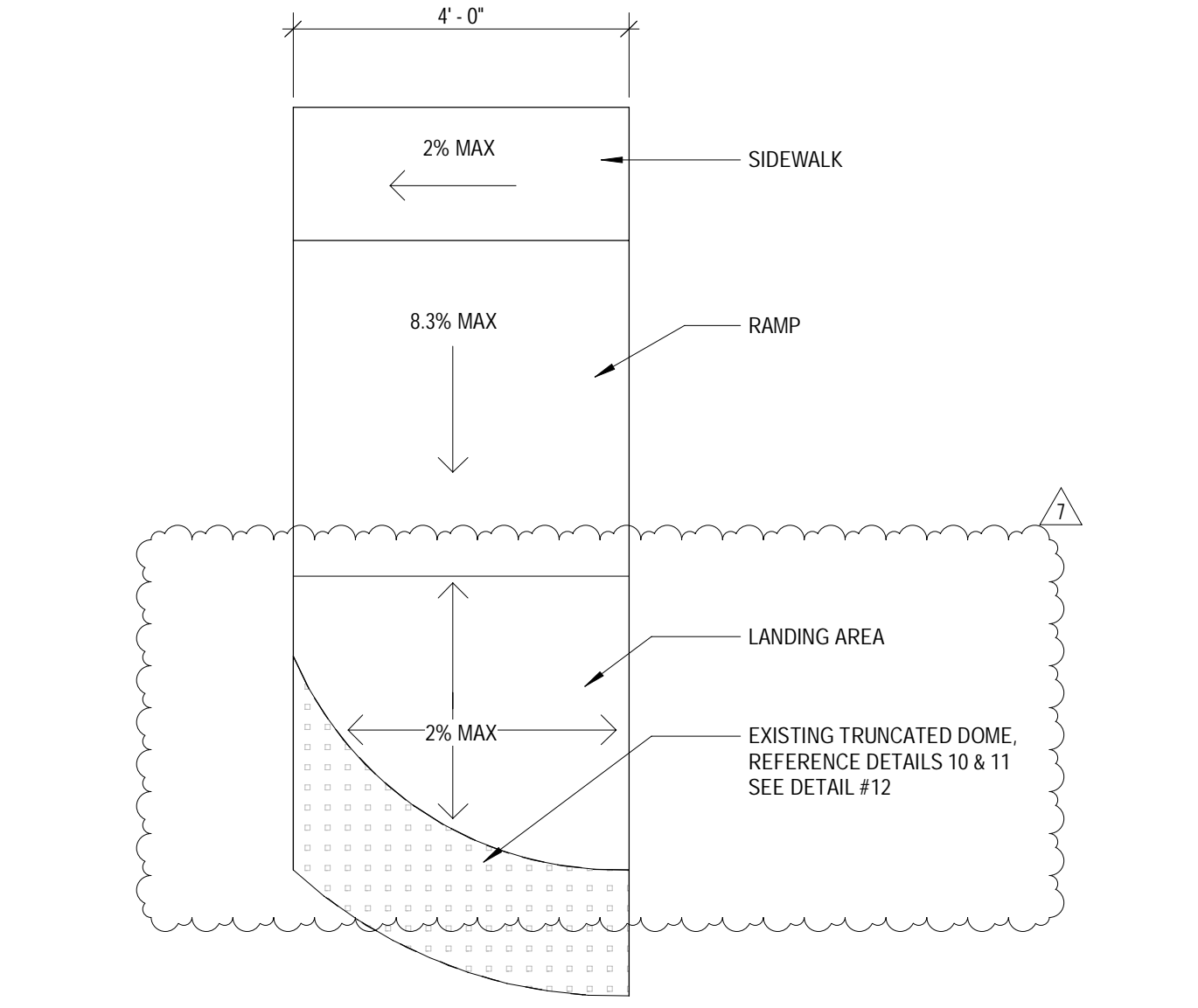

10 DIAGONAL CURB RAMPS  
SCALE: 1/2" = 1'-0"

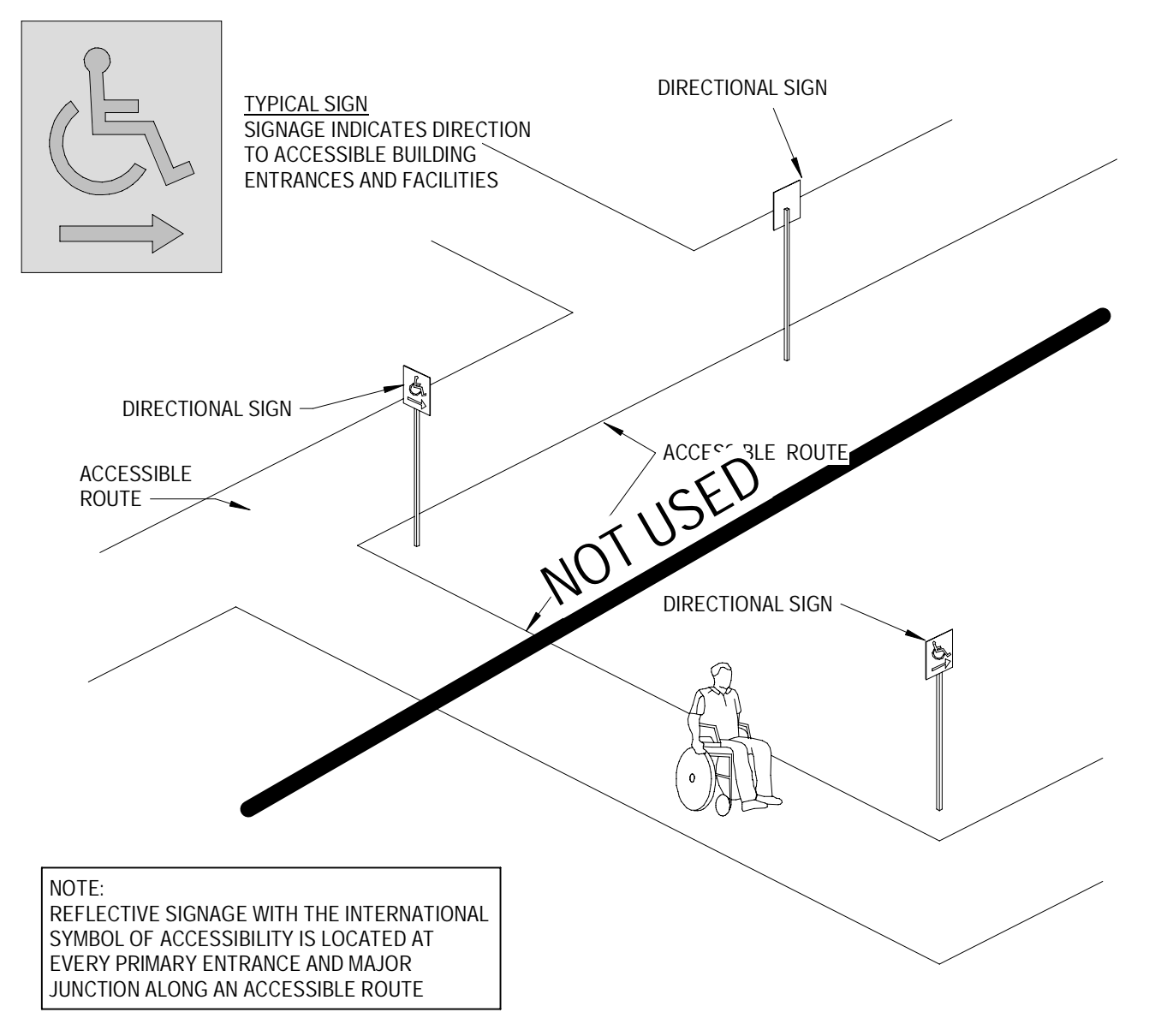

8 SIGNAGE AT ACCESSIBLE ROUTE (NOT USED)  
SCALE: 1 1/2" = 1'-0"

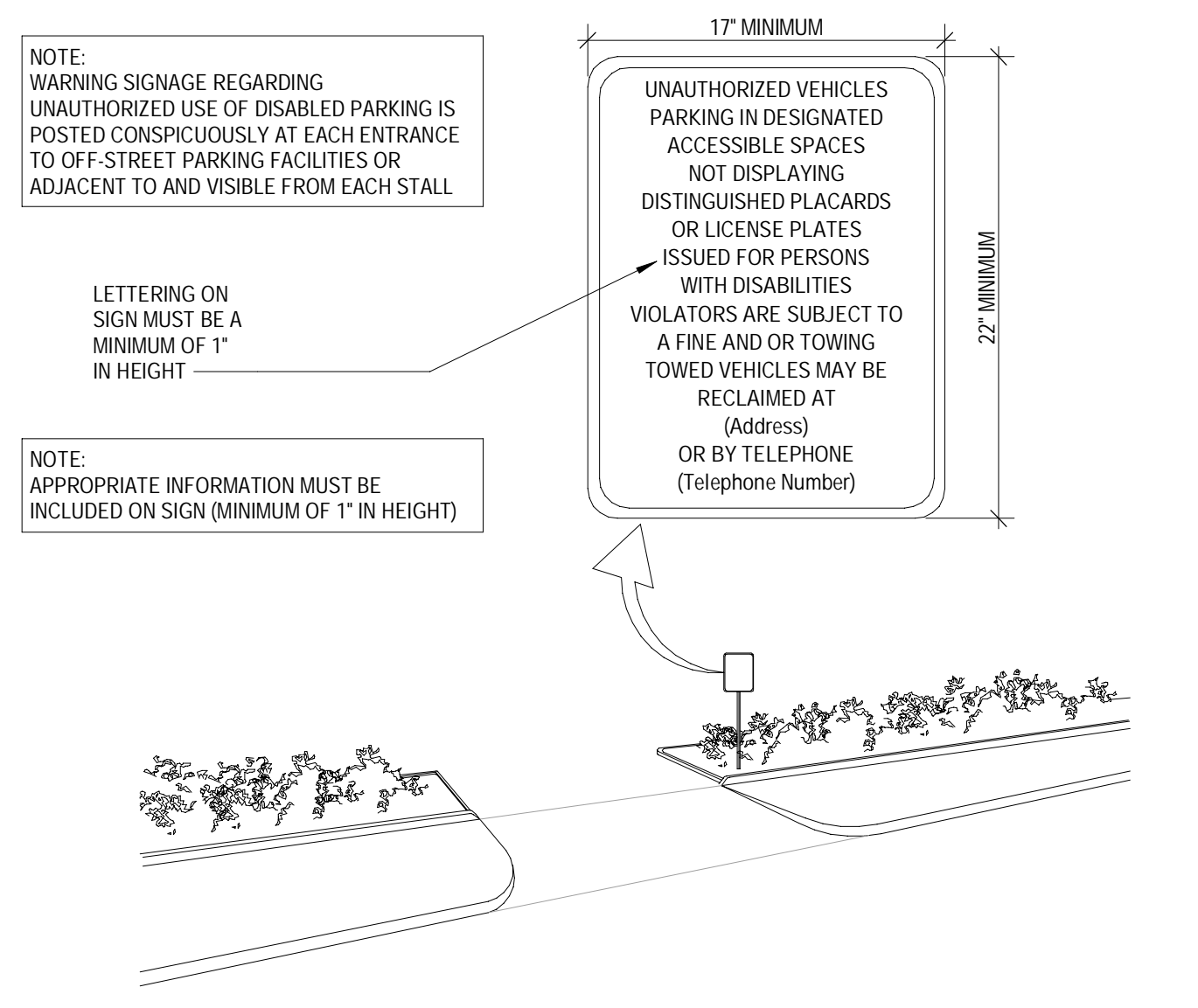

7 SIGNAGE AT SITE ENTRANCE (NOT USED)  
SCALE: 1 1/2" = 1'-0"

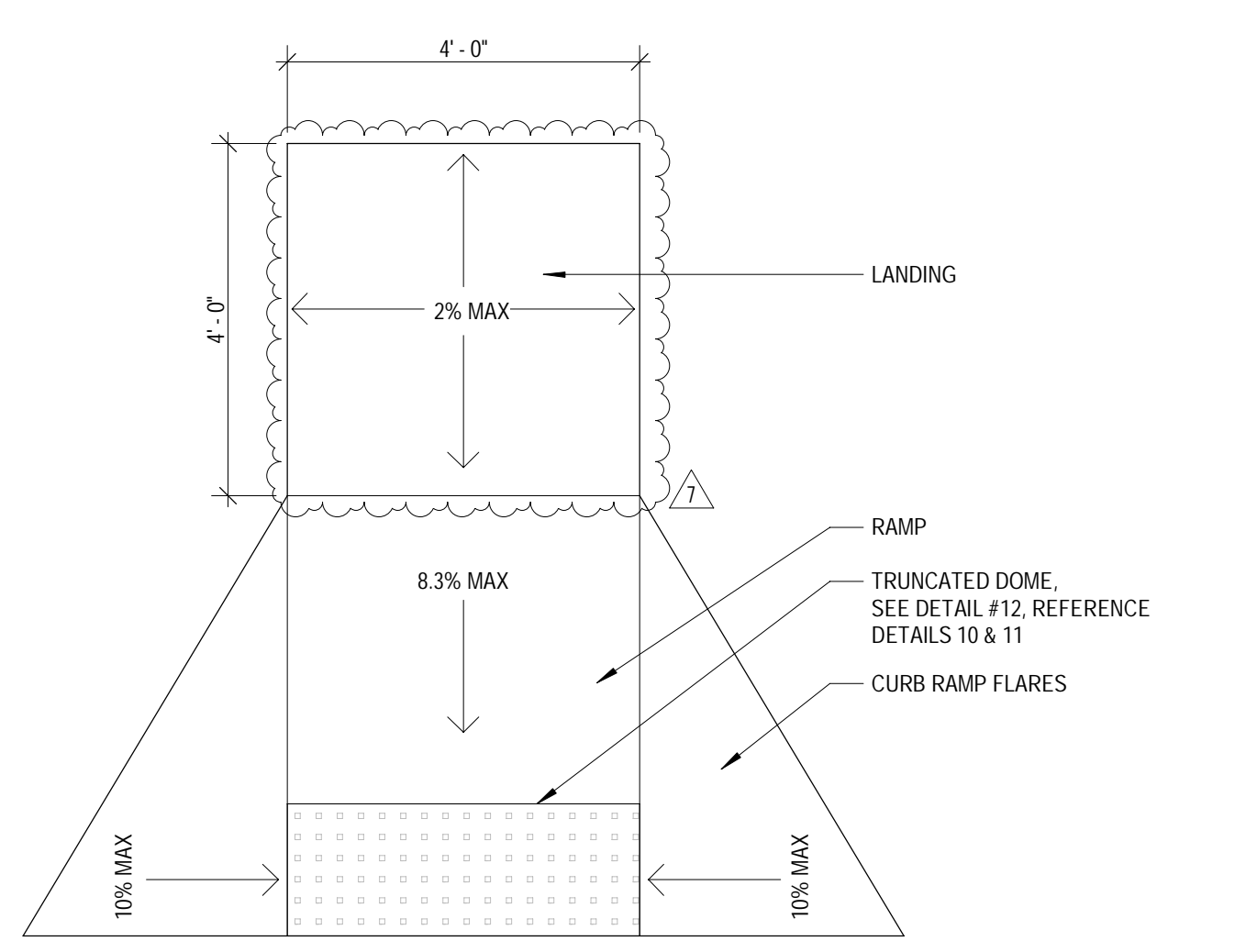

6 PERPENDICULAR CURB RAMP  
SCALE: 1/2" = 1'-0"

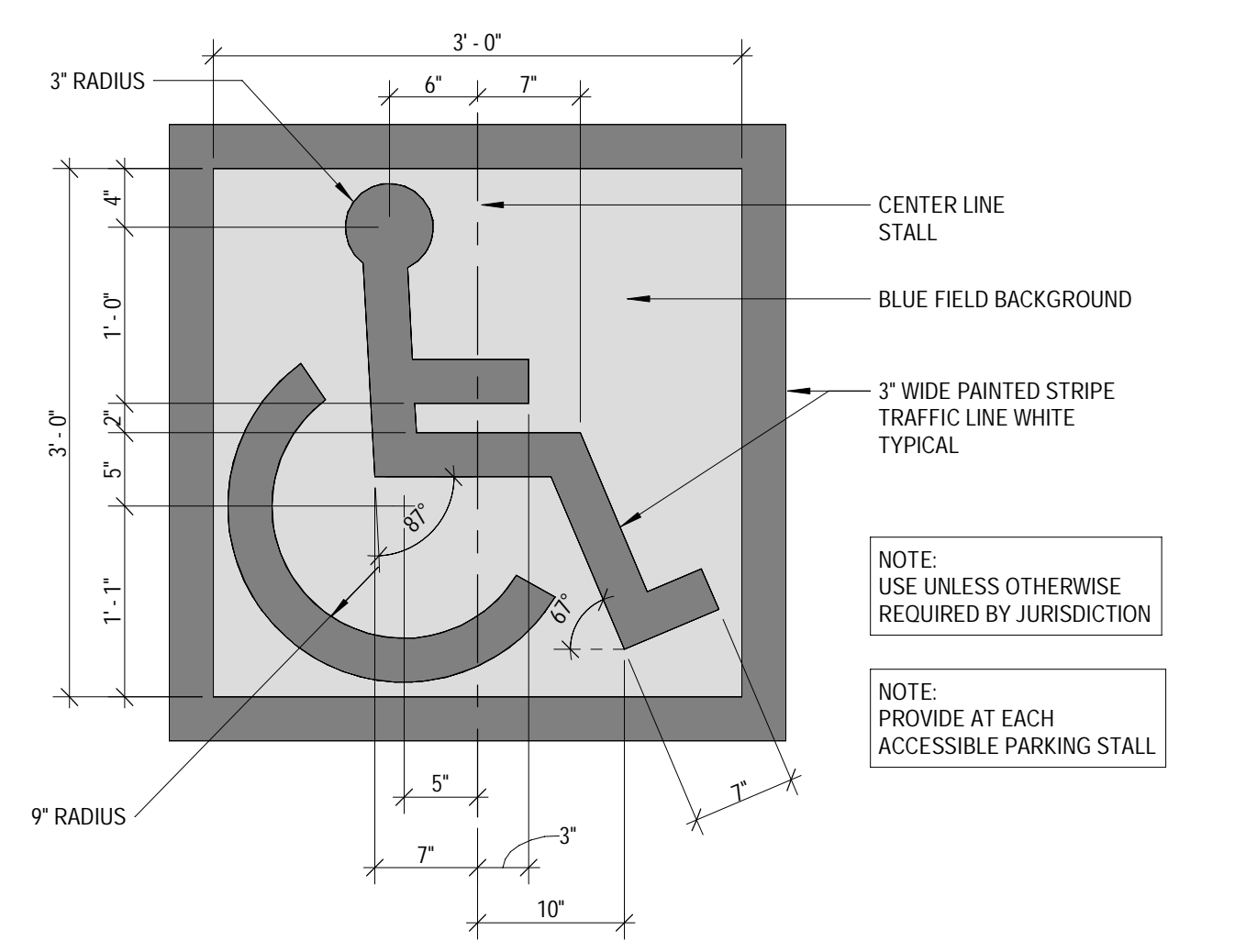

5 ACCESSIBLE PARKING SYMBOL  
SCALE: 1" = 1'-0"

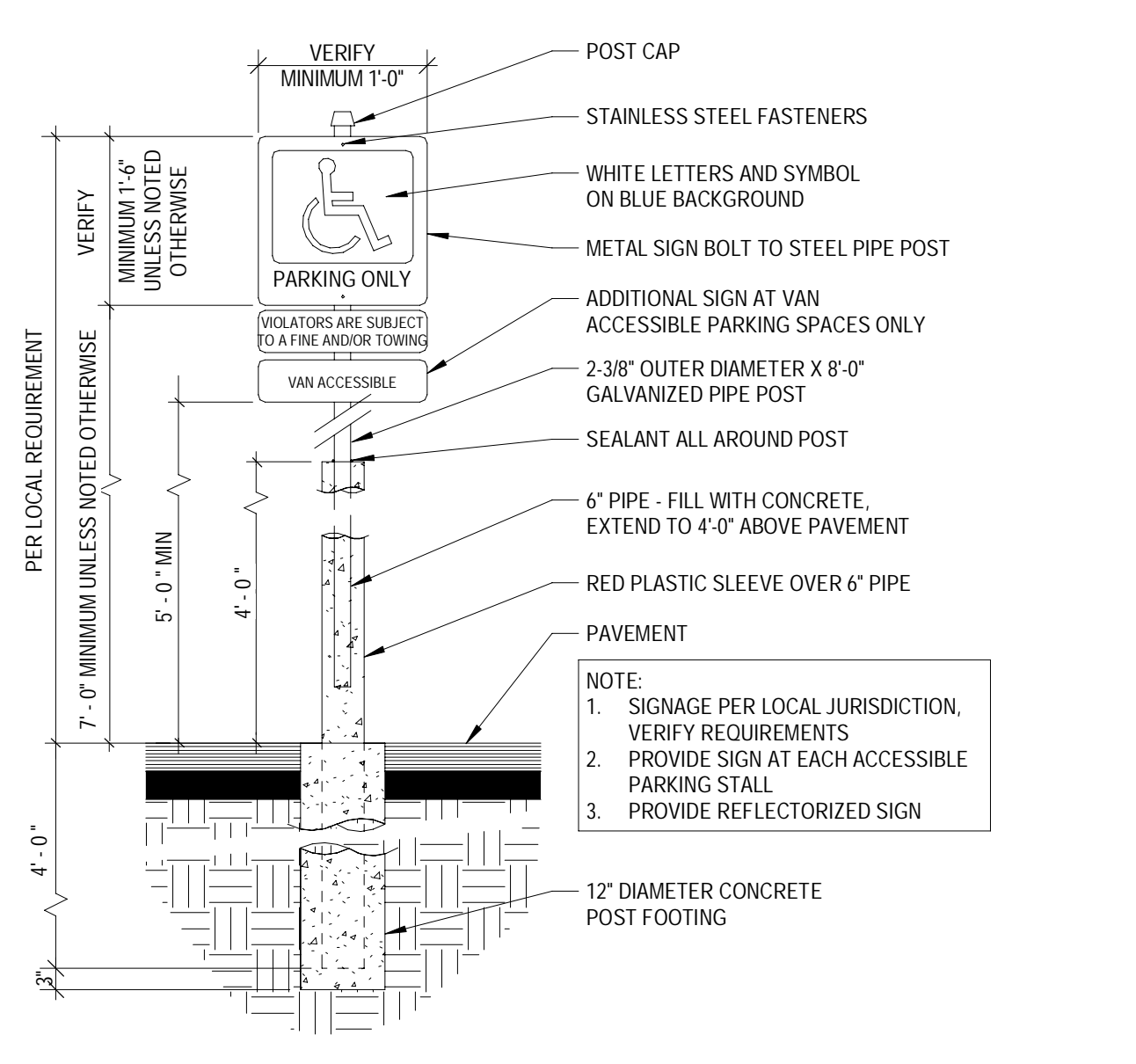

4 ADA ACCESSIBLE PARKING SIGN  
SCALE: 1/2" = 1'-0"

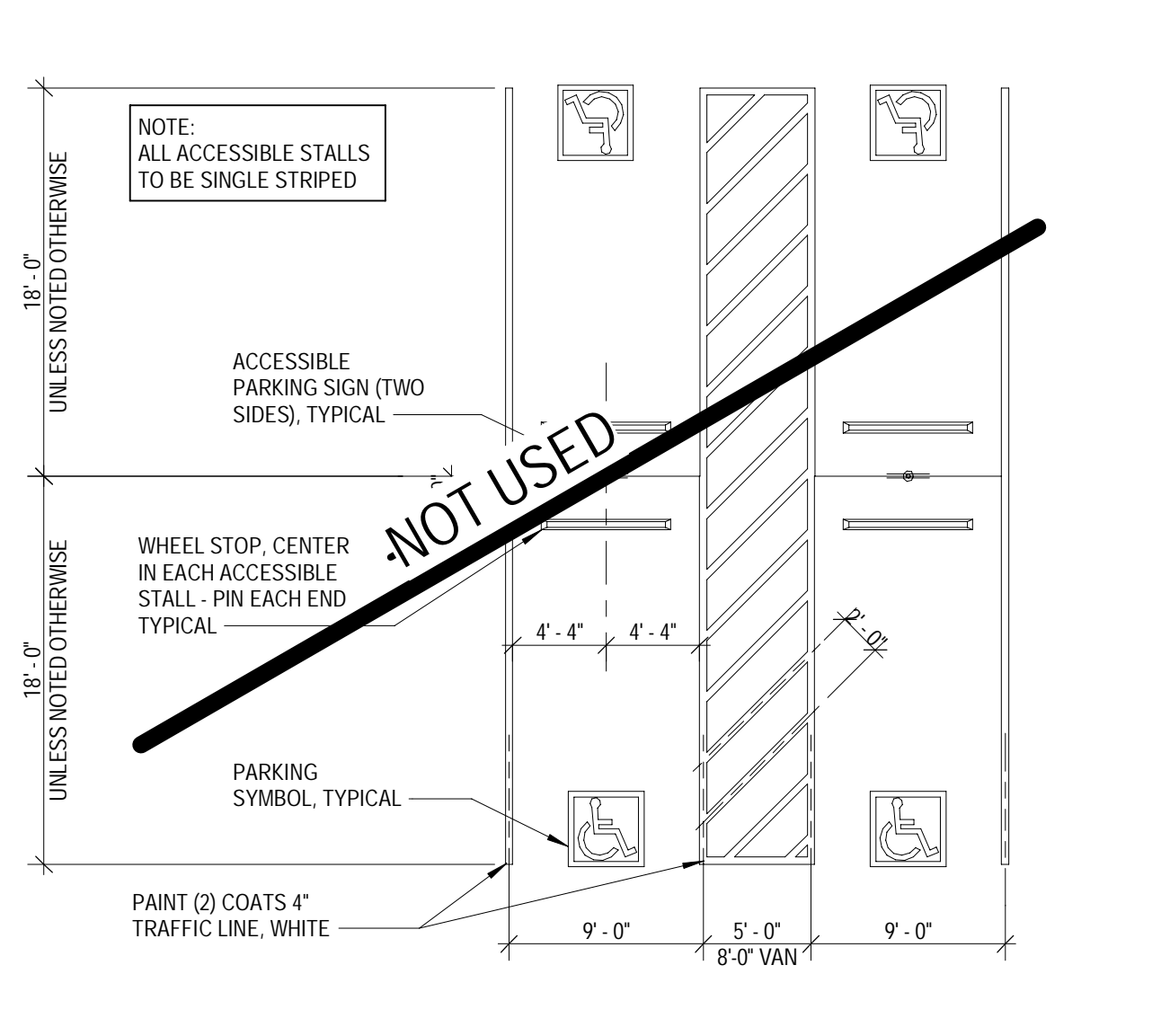

3 ACCESSIBLE PARKING STALLS - HEAD TO HEAD (NOT USED)  
SCALE: 1/8" = 1'-0"

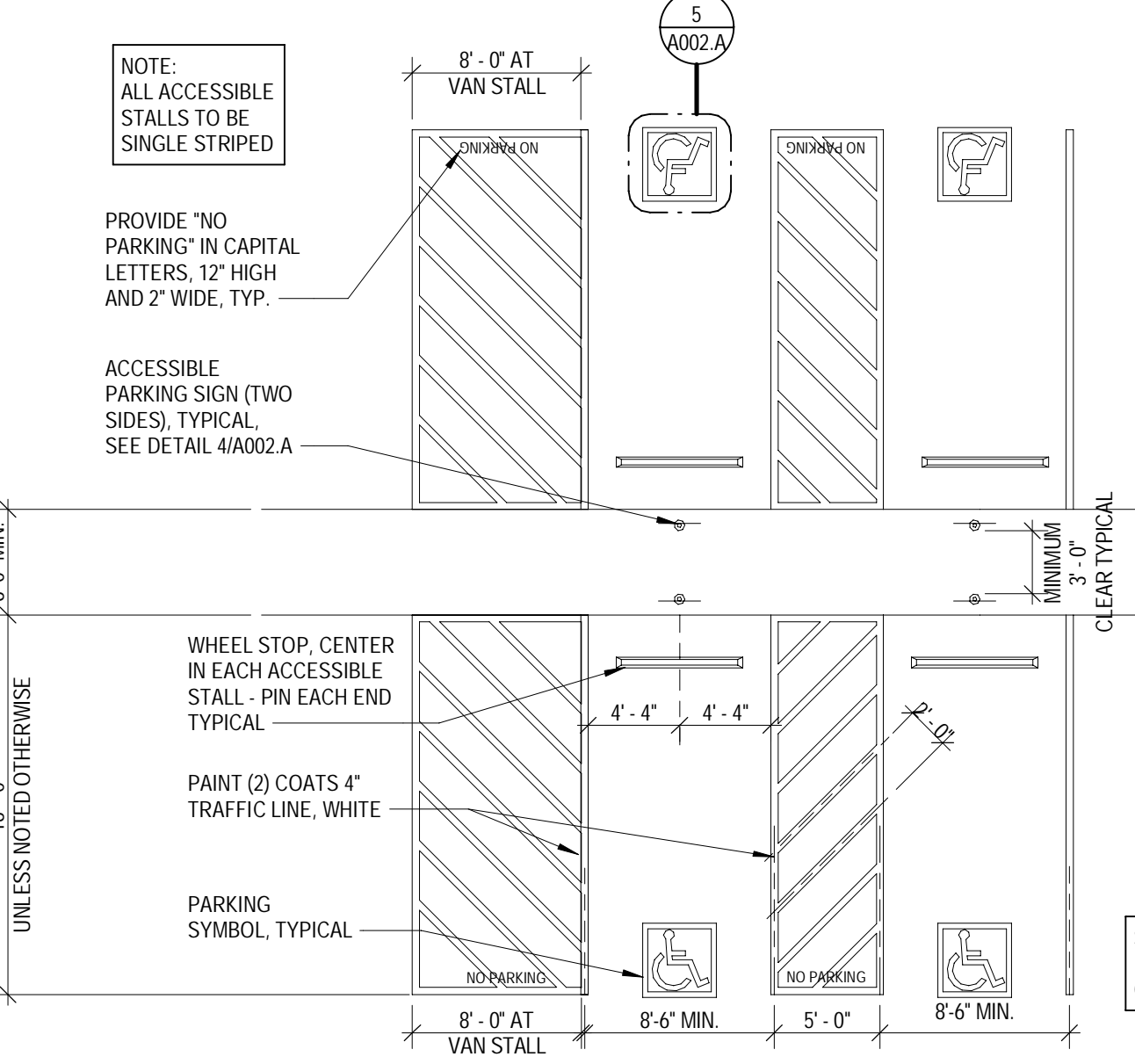

2 ACCESSIBLE PARKING STALLS WITH WALK  
SCALE: 1/8" = 1'-0"

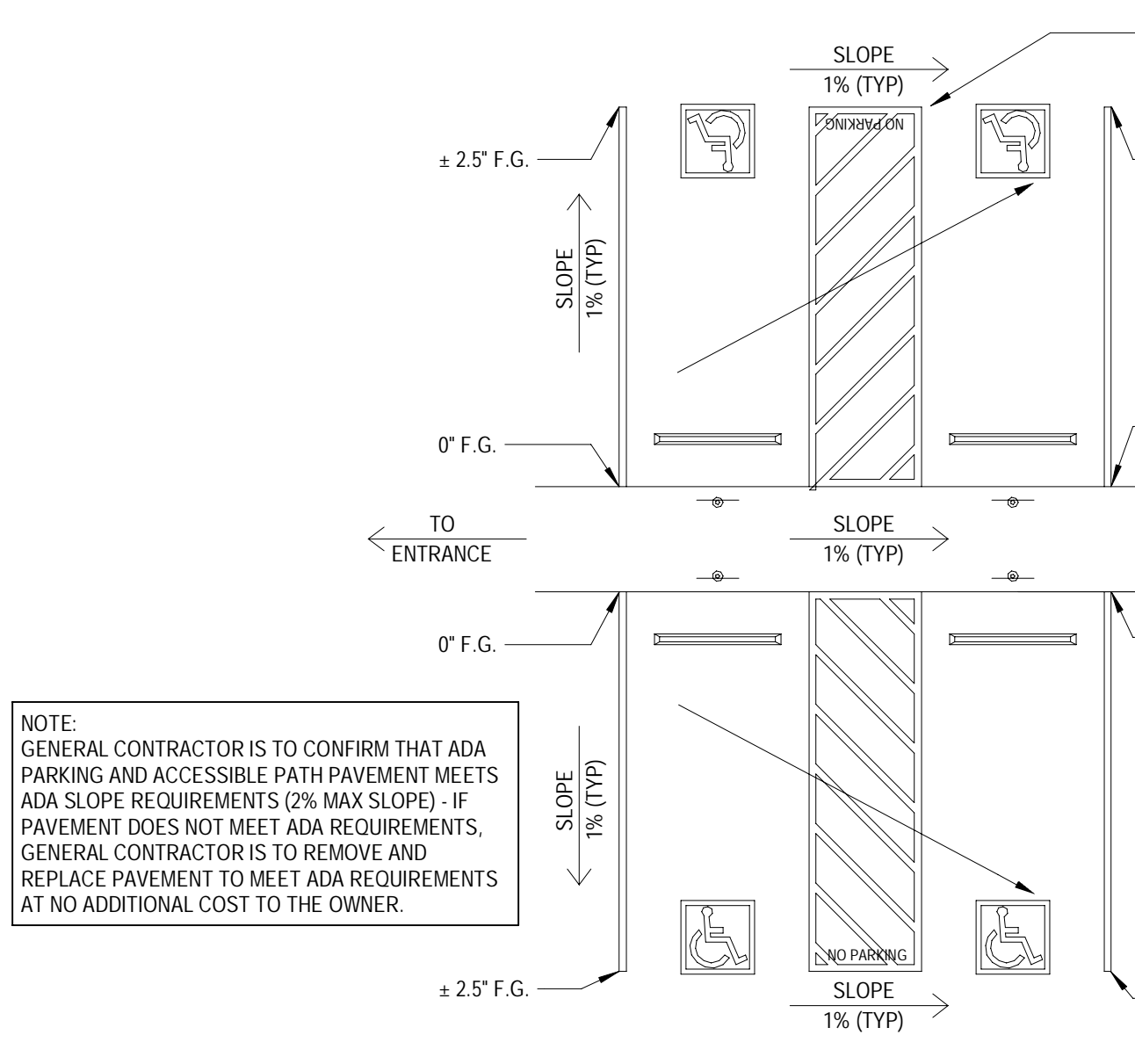

1 ACCESSIBLE PARKING GRADING  
SCALE: 1/8" = 1'-0"

**ACCESSIBILITY GENERAL NOTES**

- THE GENERAL CONTRACTOR IS RESPONSIBLE FOR THE CORRECT INSTALLATION OF ALL ACCESSIBILITY FEATURES ON SHEETS G004-G005 & A002-A002.A, INCLUDING BUT NOT LIMITED TO THE ACCESSIBLE PARKING CROSS SLOPES, LONGITUDINAL SLOPES, SIGNAGE, STRIPING, MOUNTING HEIGHTS, AND ALL REQUIRED CLEARANCES
- THE ARCHITECT WILL CONDUCT AN ACCESSIBILITY SURVEY AT THE TIME OF SUBSTANTIAL COMPLETION TO VERIFY FULL COMPLIANCE
- ALL OPERABLE PARTS REQUIRED TO BE ACCESSIBLE SHALL BE OPERABLE WITH ONE HAND AND SHALL NOT REQUIRE TIGHT GRASPING, PINCHING, OR TWISTING OF THE WRIST. THE FORCE REQUIRED TO ACTIVATE OPERABLE PARTS SHALL BE 5.0 POUNDS (22.2N) MAXIMUM.
- ALL WALL OR POST MOUNTED ITEMS IN CIRCULATION PATHS MUST BE LOCATED WITHIN PROTRUSION LIMITS, SEE DIAGRAM ON G004-G005.
- ALL NON-CONFORMING ITEMS WILL BE DOCUMENTED AND SUBMITTED TO THE GC FOR CORRECTIVE ACTION.
- FINAL PAYMENT AND RETAINAGE WILL BE HELD BY THE OWNER UNTIL ALL ITEMS HAVE BEEN CORRECTED AND THE SURVEY HAS BEEN CERTIFIED BY THE ARCHITECT.
- DIMENSIONS THAT ARE NOT STATED AS "MAXIMUM" OR "MINIMUM" ARE ABSOLUTE. ALL DIMENSIONS ARE SUBJECT TO CONVENTIONAL INDUSTRY TOLERANCES EXCEPT WHERE THE REQUIREMENT IS STATED AS A RANGE WITH SPECIFIC MINIMUM AND MAXIMUM END POINTS.

18200 Von Karman Ave, Ste 910  
Irvine, CA 92612  
949 705 0700  
MG2.com

**MG2**

Mitchell C. Smith, Architect  
© MG2, Inc. All rights reserved. No part of this document may be reproduced in any form or by any means without permission in writing from MG2, Inc.

**CHUZE**  
FITNESS

COORS & CENTRAL - CHUZE ALBUQUERQUE

6600 CENTRAL AVE, SW  
ALBUQUERQUE, NM 87121

#	Date	Issue/Description
5	05/04/2022	PLAN CH RESUBMITTAL
7	06/06/2022	PLAN CH RESUBMITTAL
12/17/21		25% SUBMITTAL
01/05/22		75% SUBMITTAL
01/14/22		PERMIT SET
01/31/22		100% SUBMITTAL
03/11/22		PERMIT SET

Project No: 21603901A  
Drawn By: MG2  
Checked By: MG2

SITE DETAILS - ALTERNATE IBC

**A002.A**