



Effective 3/01/2022

Please check the appropriate box(es) and refer to supplemental forms for submittal requirements. All fees must be paid at the time of application.

SUBDIVISIONS	<input type="checkbox"/> Final Sign off of EPC Site Plan(s) (Forms P2)	<input type="checkbox"/> Extension of IIA: Temp. Def. of SW (Form V2)
<input type="checkbox"/> Major – Preliminary Plat (Forms S & S1)	<input type="checkbox"/> Amendment to Site Plan (Forms P & P2)	<input type="checkbox"/> Vacation of Public Right-of-way (Form V)
<input type="checkbox"/> Major – Bulk Land Plat (Forms S & S1)	MISCELLANEOUS APPLICATIONS	<input type="checkbox"/> Vacation of Public Easement(s) DRB (Form V)
<input type="checkbox"/> Extension of Preliminary Plat (Form S1)	<input type="checkbox"/> Extension of Infrastructure List or IIA (Form S1)	<input type="checkbox"/> Vacation of Private Easement(s) (Form V)
<input type="checkbox"/> Minor Amendment - Preliminary Plat (Forms S & S2)	<input type="checkbox"/> Minor Amendment to Infrastructure List (Form S2)	PRE-APPLICATIONS
<input type="checkbox"/> Minor - Final Plat (Forms S & S2)	<input type="checkbox"/> Temporary Deferral of SW (Form V2)	<input checked="" type="checkbox"/> Sketch Plat Review and Comment (Form S2)
<input type="checkbox"/> Minor – Preliminary/Final Plat (Forms S & S2)	<input type="checkbox"/> Sidewalk Waiver (Form V2)	<input type="checkbox"/> Sketch Plan Review and Comment (Form P2)
SITE PLANS	<input type="checkbox"/> Waiver to IDO (Form V2)	APPEAL
<input type="checkbox"/> DRB Site Plan (Forms P & P2)	<input type="checkbox"/> Waiver to DPM (Form V2)	<input type="checkbox"/> Decision of DRB (Form A)
BRIEF DESCRIPTION OF REQUEST		
Combine two existing lots into one new lot.		

APPLICATION INFORMATION		
Applicant/Owner: Leo Nunez		Phone: 505-269-8503
Address: 2128 Central Ave SE		Email: leosnightclub@gmail.com
City: Albuquerque	State: NM	Zip: 87106
Professional/Agent (if any): Fierro + Company		Phone: 505-352-8930
Address: 3201 4th St. NW, Suite B		Email: robertfierro@fierrocompany.com
City: Albuquerque	State: NM	Zip: 87107
Proprietary Interest in Site:	List all owners:	
SITE INFORMATION (Accuracy of the existing legal description is crucial! Attach a separate sheet if necessary.)		
Lot or Tract No.: Lot 1 and 2	Block:	Unit:
Subdivision/Addition: TRUSWELL ADDITION	MRGCD Map No.:	UPC Code: SEE ATTACHMENT
Zone Atlas Page(s): G-14-Z	Existing Zoning:	Proposed Zoning:
# of Existing Lots: 2	# of Proposed Lots: 1	Total Area of Site (Acres): 1.07 ACRES
LOCATION OF PROPERTY BY STREETS		
Site Address/Street: 1119 Gandelaria NW	Between: 12th St. NW	and: 11th St. NW
CASE HISTORY (List any current or prior project and case number(s) that may be relevant to your request.)		

I certify that the information I have included here and sent in the required notice was complete, true, and accurate to the extent of my knowledge.

Signature: Robert Fierro	Date: 9-8-2022
Printed Name: Robert Robert Fierro	<input type="checkbox"/> Applicant or <input checked="" type="checkbox"/> Agent

UPC Code: 101 406 007 323 230 902

101 406 009 623 030 903

FORM S2: SUBDIVISION OF LAND – MINOR ACTIONS

Please refer to the DRB minor case schedule for meeting dates and deadlines unless noted differently below. Bring original Mylar of plat with property owner's and City Surveyor's signatures on it to the meeting. Your attendance is required.

A Variance – DRB for the Bulk Transfer of Land requires application on Form V in addition to this FORM S2.

>> INFORMATION REQUIRED FOR ALL MINOR SUBDIVISION APPLICATIONS

- Interpreter Needed for Hearing? if yes, indicate language: _____
- A Single PDF file of the complete application including all documents being submitted must be emailed to PLNDRS@cabq.gov prior to making a submittal. Zipped files or those over 9 MB cannot be delivered via email, in which case the PDF must be provided on a CD. PDF shall be organized with the Development Review Application and this Form S2 at the front followed by the remaining documents in the order provided on this form.
- Zone Atlas map with the entire site clearly outlined and labeled

SKETCH PLAT REVIEW AND COMMENT

- Letter describing, explaining, and justifying the request
- Scale drawing of the proposed subdivision plat (7 copies, folded)
- Site sketch with measurements showing structures, parking, building setbacks, adjacent rights-of-way and street improvements, if there is any existing land use (7 copies, folded)

MAJOR SUBDIVISION FINAL PLAT APPROVAL (requires published notice, heard on the DRB Major Case Schedule)

- Letter describing, explaining, and justifying the request
- Copy of recorded IIA
- Proposed Final Plat (7 copies, 24" x 36" folded)
- Design elevations & cross sections of perimeter walls (3 copies)
- Landfill disclosure and EHD signature line on the Mylar if property is within a landfill buffer
- DXF file and hard copy of final plat data for AGIS submitted and approved

MINOR SUBDIVISION PRELIMINARY/FINAL PLAT APPROVAL

- Letter describing, explaining, and justifying the request per the criteria in IDO Section 14-16-6-6(I)
- Sites 5 acres or greater: Archaeological Certificate in accordance with IDO Section 14-16-6-5(A)
- Form DRWS Drainage Report, Grading and Drainage Plan, and Water & Sewer Availability Statement submittal information
- Required notice with content per IDO Section 14-16-6-4(K)(6)
 - Office of Neighborhood Coordination Public Notice Inquiry response
 - Proof of emailed notice to applicable Neighborhood Association representatives
- Proposed Preliminary / Final Plat with property owner's and City Surveyor's signatures on the plat prior to submittal (7 copies, folded)
- Sidewalk Exhibit and/or cross sections of proposed streets (3 copies, 11" by 17" maximum)
- Site sketch with measurements showing structures, parking, building setbacks, adjacent rights-of-way and street improvements (to include sidewalk, curb & gutter with distance to property line noted) if there is any existing land use (7 copies, folded)
- Landfill disclosure statement per IDO Section 14-16-5-2(G) if site is within a designated landfill buffer zone
- Proposed Infrastructure List, if applicable
- DXF file and hard copy of final plat data for AGIS submitted and approved

MINOR AMENDMENT TO PRELIMINARY PLAT OR INFRASTRUCTURE LIST

- Letter describing, explaining, and justifying the request per the criteria in IDO Section 14-16-6-4(X)(2)
- Original Preliminary Plat, Infrastructure List, and/or Grading Plan (7 copies, folded)
- Proposed Amended Preliminary Plat, Infrastructure List, and/or Grading Plan (7 copies, folded)

Note: Any application that does not qualify as a Minor Amendment in IDO Section 14-16-6-4(X) must be processed as a Major Amendment. See Form S1.

<i>I, the applicant or agent, acknowledge that if any required information is not submitted with this application, the application will not be scheduled for a public meeting or hearing, if required, or otherwise processed until it is complete.</i>	
Signature: <u>Robert Fierro</u>	Date: <u>9-8-2022</u>
Printed Name: <u>Robert Fierro</u>	<input type="checkbox"/> Applicant or <input checked="" type="checkbox"/> Agent
FOR OFFICIAL USE ONLY	
Case Numbers: _____	Project Number _____
Staff Signature: _____	
Date: _____	

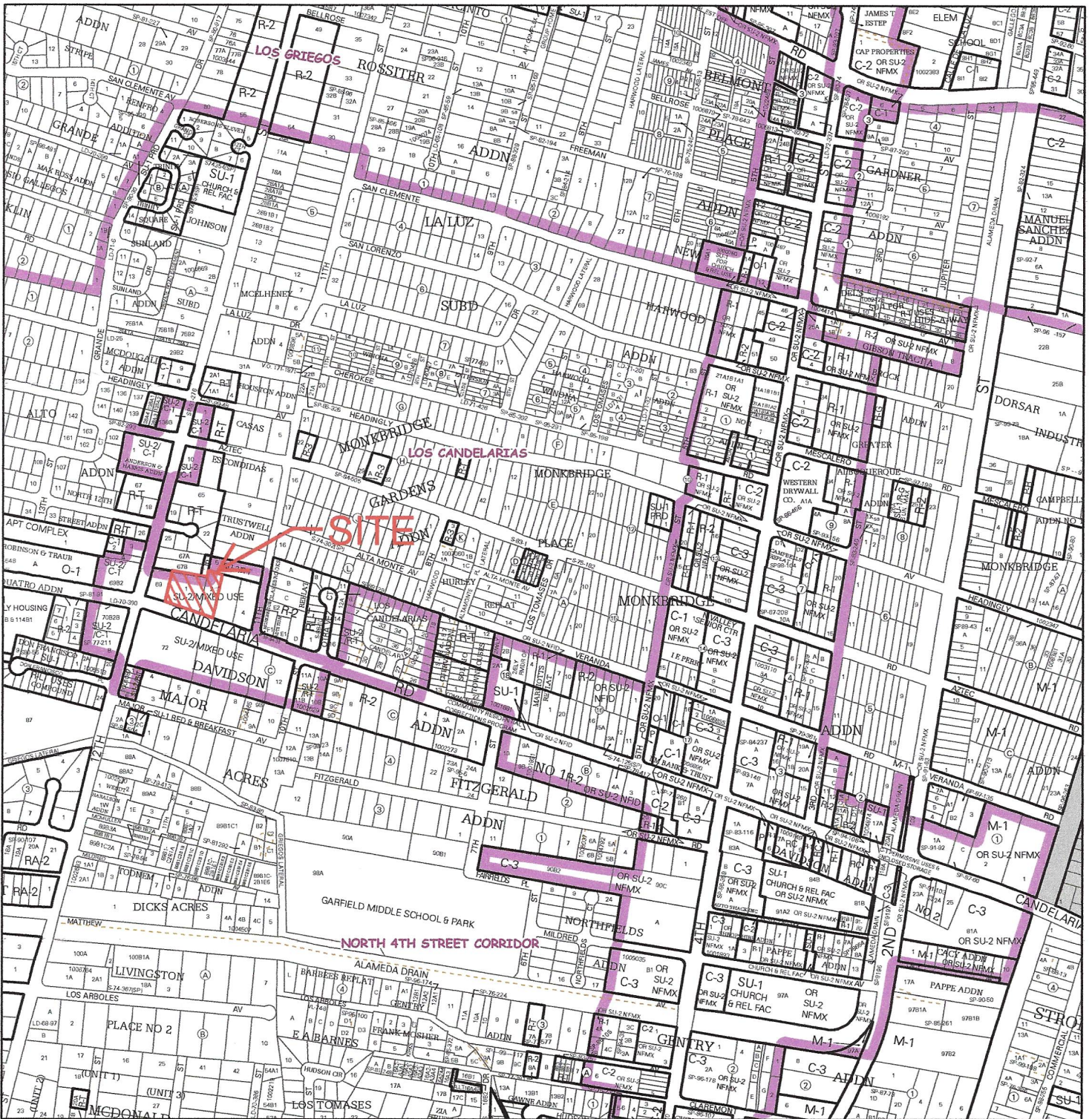

For more current information and details visit: <http://www.cabq.gov/gis>

Map amended through: 6/7/2013

Zone Atlas Page:
G-14-Z

Selected Symbols

- SECTOR PLANS
- Escarpment
- Design Overlay Zones
- 2 Mile Airport Zone
- City Historic Zones
- Airport Noise Contours
- H-1 Buffer Zone
- Wall Overlay Zone
- Petroglyph Mon.

Note: Grey Shading Represents Area Outside of the City Limits

0 750 1,500 Feet



Fierro & Company

3201 4th St. NW, Suite B
Albuquerque, NM 87107
(505) 352-8930 | www.fierrocompany.com

September 7, 2022

City of Albuquerque
Development Review Board

RE: Sketch Plat Lot 1-A, Truswell Addition

Fierro & Company, LLC is submitting a Sketch Plat to combine Lot 1 and Lot 2 of Truswell Addition as shown in the enclosed Sketch Plat.

Thank you.

FIERRO & COMPANY

Robert Fierro, P.E., P.S.
President