

REVISION	DATE	DESCRIPTION

IRRIGATION LEGEND

SYMB.	DESCRIPTION	NOTES
POC 1"	IRRIGATION POINT OF CONNECTION	1-1/2" SUPPLY LINE BY OTHERS, FIELD VERIFY LOCATION
W	WATER METER	
C	CONTROLLER <i>RAIN BIRD ESP-ME</i>	POLE MOUNT, POWER BY OTHERS.
BF	BACKFLOW PREVENTER <i>FEBCO 765 PRESSURE VACUUM BREAKER</i>	
VALVES		
X	ISOLATION VALVE	(NON POTABLE IRRIGATION)
MV	MASTER VALVE <i>RAIN BIRD PGA</i>	(NON POTABLE IRRIGATION)
ZV1	ZONE VALVE 1: SOD AREAS <i>RAIN BIRD PGA</i>	(NON POTABLE IRRIGATION)
ZV2	ZONE VALVE 2: LANDSCAPE DRIP <i>RAIN BIRD XCZ-PGA</i>	(NON POTABLE IRRIGATION)
PIPE		
---	MAINLINE <i>SCHEDULE 40 PVC-R</i>	BELL END, SOLVENT WELD PVC. (NON POTABLE IRRIGATION)
---	LATERAL <i>CLASS 200 PVC-R</i>	BELL END, SOLVENT WELD PVC. (NON POTABLE IRRIGATION)
●	PVC TO POLY	
---	DRIP SUPPLY TUBING <i>PLD-10-12-250-R</i>	LOPE, MAX 5 GPM (300 GPH) WITH COMPRESSION FITTINGS (NON POTABLE IRRIGATION)
---	WIRES <i>TO MOTOROLA 2-WIRE DECODER</i>	EXTEND ALONG WATER TRENCH TO MAIN BUILDING
---	SLEEVES <i>CLASS 200 PVC</i>	EXTEND MINIMUM OF 3" FROM CURB/SURFACES
HEADS AND EMITTERS		
●	POP UPS <i>LARGE AREA ROTATORS (1-40-04-SS-R)</i>	(NON POTABLE IRRIGATION)
◆	PRESSURE-COMPENSATING DRIP EMITTERS <i>RAIN BIRD DRIP FLAG EMITTERS FE-SERIES</i>	(NON POTABLE IRRIGATION)
◇	TREES: 50' Spiral of 12" O.C. 4 x 4 GAL	
◇	SHRUBS AND GRASSES: 2 X 2 GAL	
◇	DESERT ACCENTS: 1 X 1 GAL	
○	ROW TREES: PCB-25-R BUBBLERS	

NOTE: IRRIGATION SYSTEM TO USE NON POTABLE WATER

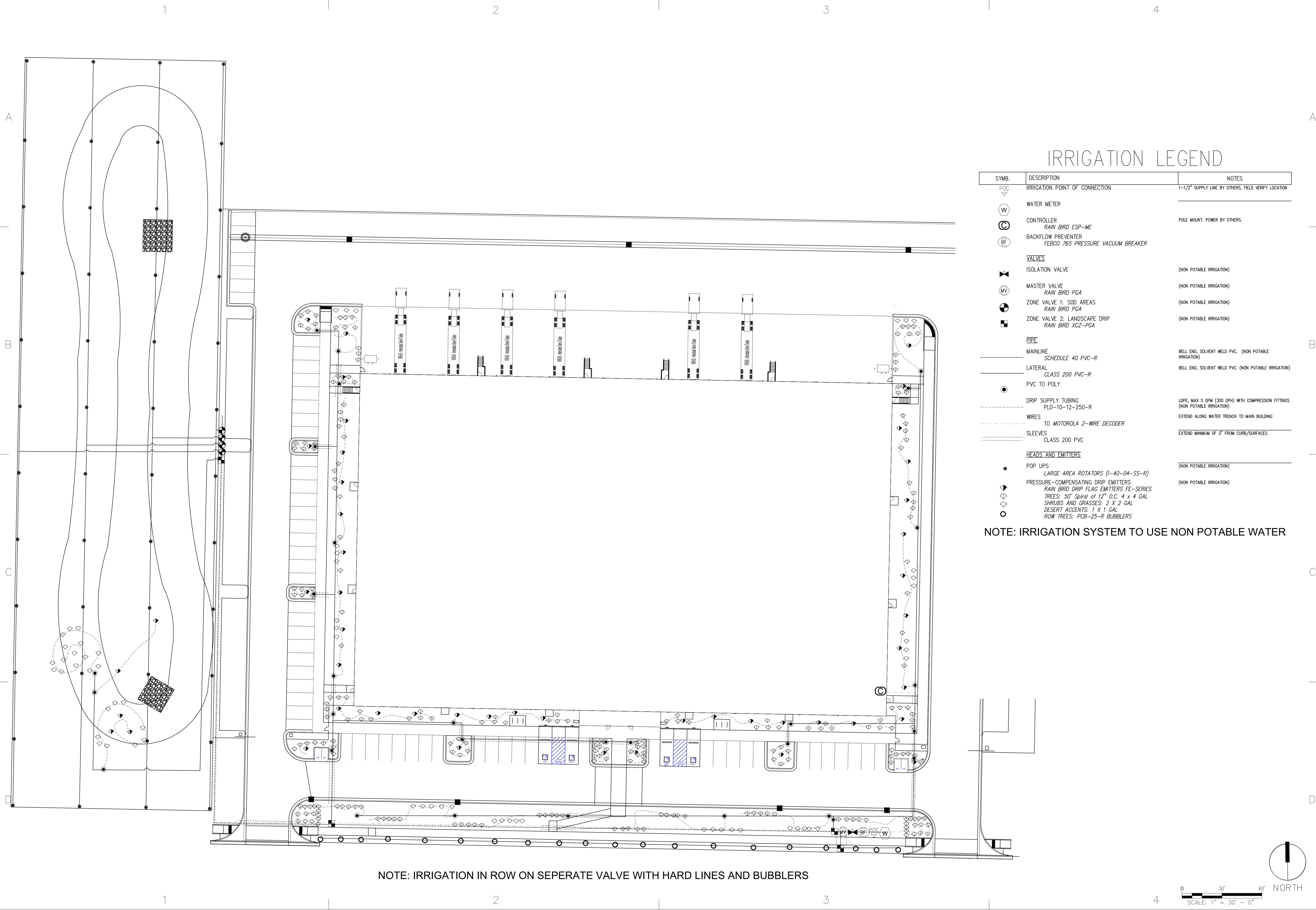

NOTE: IRRIGATION IN ROW ON SEPERATE VALVE WITH HARD LINES AND BUBBLERS