

KEYED NOTES

- 1 EXISTING 8" SAS.
- 2 EXISTING 8" WATER LINE.
- 3 INSTALL 6" SANITARY SEWER SERVICE PER ABCWUA STD DWG 2135.
- 4 CONTINUE UPSTREAM DESIGN PER THE PLUMBING PLANS.
- 5 INSTALL PRIVATE BACK FLOW PREVENTOR IN A HOT BOX CONTINUE DESIGN PER LANDSCAPING / IRRIGATION PLAN. IF EXISTING BACKFLOW PREVENTOR IS THE CORRECT SIZE AND IN GOOD CONDITION, IT MAY BE USED IN LIEU OF A NEW BACKFLOW PREVENTOR.
- 6 INSTALL 1 1/2" WATER METER ENCLOSURE AND WATER SERVICE PER ABCWUA STD DWG 2362.
- 7 EXISTING 3/4" WATER METER AND BACKFLOW PREVENTOR TO BE REUSED FOR IRRIGATION METER.
- 8 INSTALL 2" DIAMETER PEX WITH 4" MINIMUM BURY.
- 9 INSTALL TRAFFIC RATED 4" SINGLE CLEANOUT.
- 10 INSTALL PRIVATE 4" DIAMETER SAS MANHOLE PER NMAPWA STD DWG 2101. SEE SHEET C-109.
- 11 INSTALL 3 - 6 INCH PVC VACUUM LINES (PRESSURE TESTED PER VAC PRODUCER)
- 12 NOT IN USE
- 13 OIL WATER SEPARATOR. ALL OTHER TANKS ARE RECLAIM TANKS. SEE RECLAIM SYSTEM DETAILS ON SHEET C-109.
- 14 PVC ELECTRICAL CONDUIT. COORDINATE WITH MEP FOR EXACT LOCATION AND SIZE.
- 15 INSTALL PARK SO-1500-STD SAND-OIL INTERCEPTOR.

UTILITY GENERAL NOTES

1. THE CONTRACTOR SHALL OBTAIN AN ABCWUA CONNECTION PERMIT AND ANY OTHER APPLICABLE UTILITY PERMITS AND APPROVALS PRIOR TO CONSTRUCTION.
2. CONTRACTOR TO COORDINATE FINAL LOCATION, NUMBER, AND SIZE OF ELECTRICAL CONDUIT AND PVC VACUUM LINES WITH THE APPROPRIATE TRADES IN THE FIELD.
3. CONTRACTOR TO FIELD VERIFY SIZE'S AND LOCATION OF ALL EXISTING UTILITIES PRIOR TO ANY CONSTRUCTION.
4. ALL UTILITIES SHOWN ON THE PRIVATE PROPERTY SHALL BE PRIVATE UNLESS OTHERWISE NOTED.
5. SEE PLUMBING PLANS FOR UTILITY CONTINUATION INTERNAL TO THE BUILDING.
6. PARALLEL RPBA BACKFLOW PREVENTOR FOR THE PRIVATE WATERLINES WILL BE PROVIDED INTERNAL TO THE BUILDING. THE BACKFLOW PREVENTOR SHALL BE THE SAME SIZE AS THE TAP/CONNECTION AT THE MAIN LINE.
7. SITE PLAN LINEWORK HAS BEEN SCREENED BACK FOR VISUAL CLARITY.
8. COORDINATION WITH WATER AUTHORITY CROSS SECTION WILL BE REQUIRED TO ENSURE PROPER BACKFLOW CONTAINMENT IS IN PLACE PRIOR TO RELEASE OF METER FOR THE SITE. CONTACT THE CROSS CONNECTION SECTION AT 505-289-3454.
9. COORDINATION WITH THE WATER AUTHORITY PRE-TREATMENT ENGINEER IS REQUIRED TO ENSURE THE SITE COMPLIES WITH THE WATER AUTHORITY SEWER USE ORDINANCE. CONTACT THE PRE-TREATMENT ENGINEER AT 505-289-3439.
10. ALL PROPOSED WATER AND SEWER LINE IS PRIVATE UNLESS STATED OTHERWISE.

LEGEND

WATERLINE 2"	— W —
SEWER LINE 6"	— S —
ELECTRICAL CONDUIT	- - - - -

ABBREVIATIONS

AC	ACRE
CF	CUBIC FOOT
ELEV	ELEVATION
FF	FINISHED FLOOR
INV	INVERT
LF	LINEAR FOOT
NMAPWA	NEW MEXICO AMERICAN PUBLIC WORKS ASSOCIATION
MAX	MAXIMUM
MIN	MINIMUM
PVC	POLYVINYL CHLORIDE
ROW	PUBLIC RIGHT OF WAY
RPBA	REDUCED PRESSURE BACKFLOW ASSEMBLY
SAS	SANITARY SEWER
SD	STORM DRAIN
STD DWG	STANDARD DRAWING
VOL	VOLUME
WTR	WATER
WQ	WATER QUALITY
STD DWG	STANDARD DRAWING

SAS SEWER PROFILE

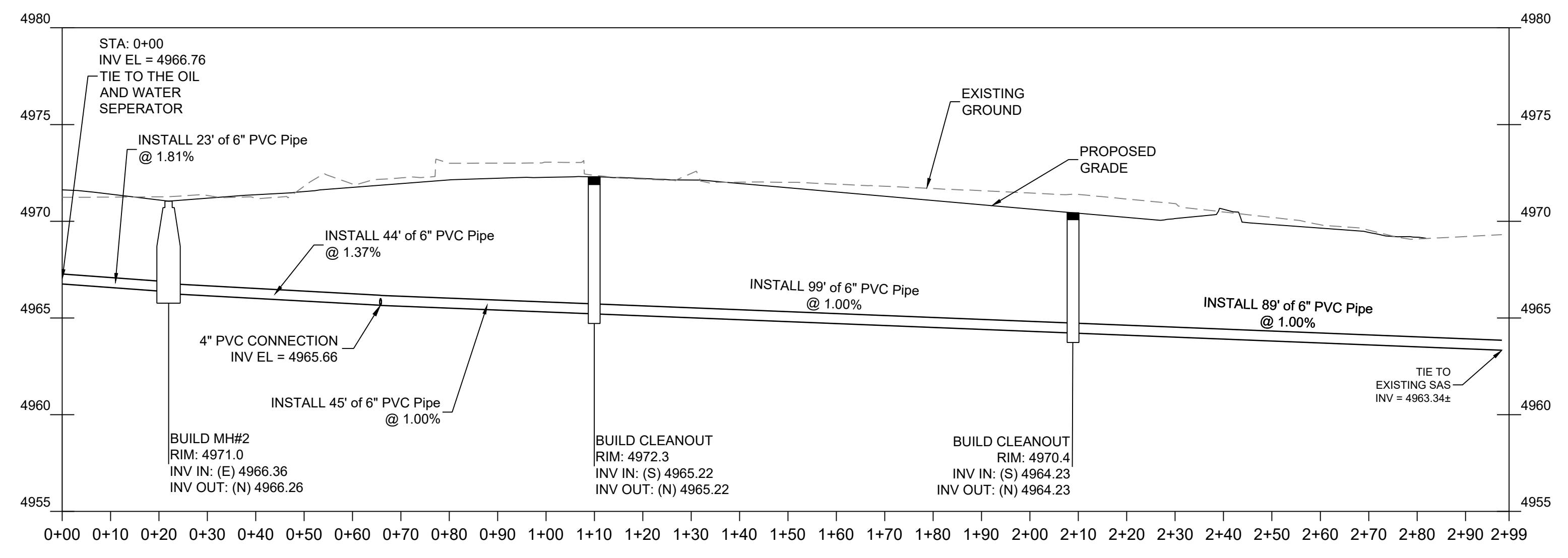

NAME: N:\Projects\W0378-Daniel Puzak-Projects\W0378-22002-2nd Menaul\3. DWG\3. Sheets\UtilityPlan.dwg PLOT DATE: Jun 14, 2024 1:14pm

	DESIGNED DRAWN CHECKED DATE 6.14.2024		REVISION
 COMMUNITY DESIGN SOLUTIONS 7770 JEFFERSON STREET SUITE 200 ALBUQUERQUE, NM 87117 WWW.RESPEC.COM PHONE: (505) 253-9718			
STAMP 01/22/2024 THIS DRAWING IS INCOMPLETE AND NOT TO BE USED FOR CONSTRUCTION UNLESS IT IS STAMPED, SIGNED AND DATED			
 Know what's below. Call before you dig.			
PROJECT NAME:		TIDAL WAVE 2ND MENAUL	
SHEET TITLE:		UTILITY PLAN	
SUBMITTED FOR:		BUILDING PERMIT	
SHEET NUMBER:		C-107	